

RAJWADA  
*Rosewood*



## Rajwada Rosewood: *A Resort to Serenity*

Calm and serene are two words that will describe your home at Rajwada Rosewood. Imagine yourself waking to the chirping of birds and breathing fresh morning air with a steaming cup of coffee. Feels awesome, isn't it?



This can now be a reality with Rajwada Rosewood. Having a serene place within Kolkata seems quite impossible right? But we are making it possible for you: a quite adobe in Kolkata but away from its din and bustle.

Rajwada Rosewood can be a perfect place to reside for busy city dwellers as it will give you a tranquil place to begin and end your hectic days. It is located in the quietness of Narendrapur opposite Chintamani Kar Bird Sanctuary. Its proximity to E.M. bypass and N.S.C Bose Road makes it an easy place to commute from. The nearest landmark is Narendrapur Ramkrishna Mission.

The residency will be covering an area of 52 kattha. There will be a total of 86 apartments in a total of 4 blocks. The minimum size of 2bhk is 885 sq.ft to 1075sq.ft and that of 3bhk is 1125sq.ft to 1340 sq.ft.

Its approximate distance is 4 km from Sahid khudiram Metro Station, 2km from Bigbazar Narendrapur, 200 meters from Chintamani Birdsanctury, 2 km from Ramakrishna Mission, 2 km from proposed Devi sethi Hospital, and 10 km from Ruby More.



Calm and serene are two words that will describe your home at Rajwada Rosewood. Imagine yourself waking to the chirping of birds and breathing fresh morning air with a steaming cup of coffee. Feels awesome, isn't it? This can now be a reality with Rajwada Rosewood. Having a serene place within Kolkata seems quite impossible right? But we are making it possible for you: a quite adobe in Kolkata but away from its din and bustle.





Unit	Area (sq. Ft.)	BHK
A	1235	3bhk
B	920	2bhk
C	1225	3bhk
D	1010	2bhk

**BLOCK - 1**



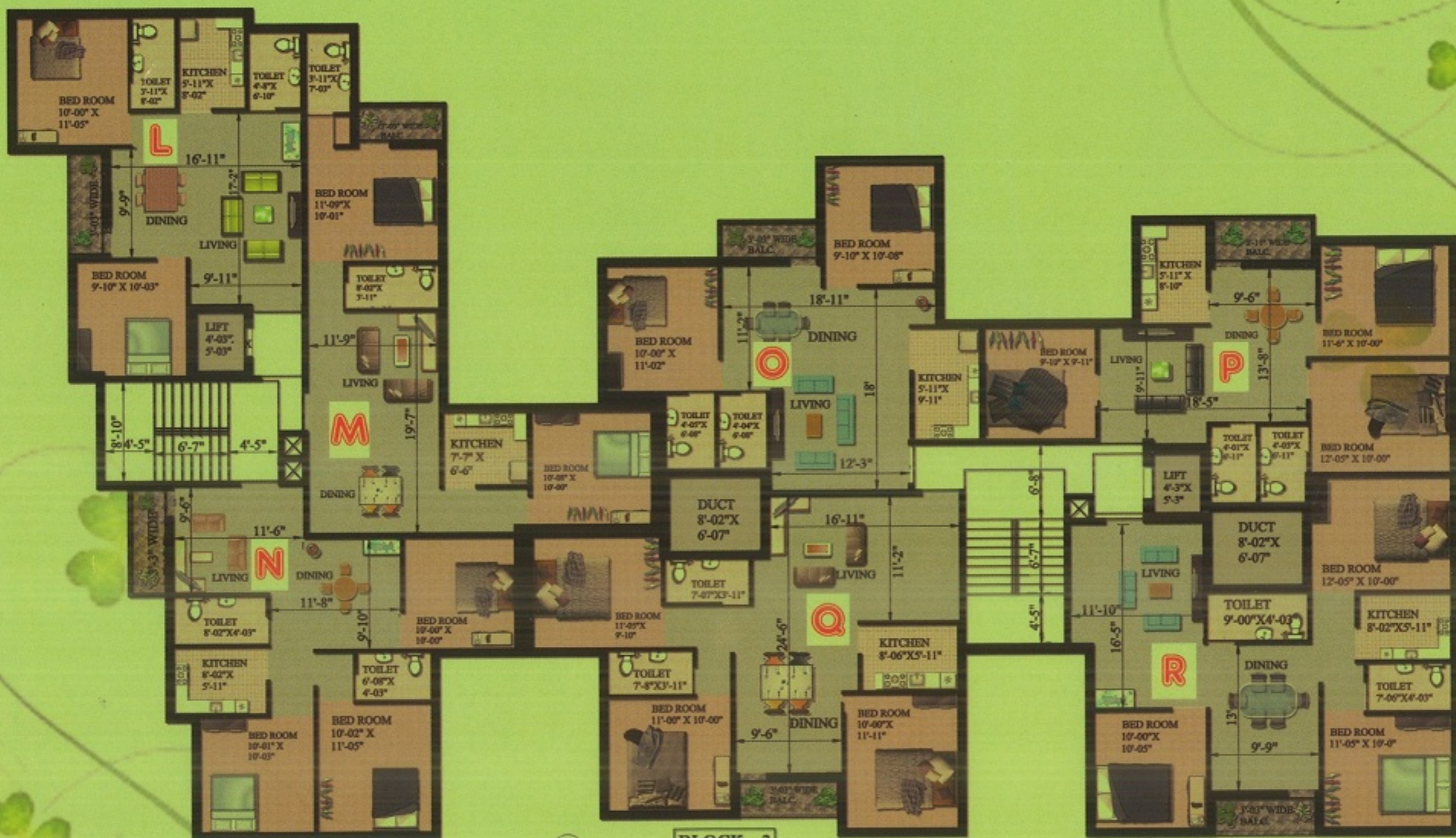

**BLOCK - 3**



AREA/UNIT	AREA	BHK
L	975	2bhk
M	1025	2bhk
N	1125	3bhk
U	1350	3bhk
D	1030	2bhk
P	1125	3bhk
R	1340	3bhk

FLOOR TYPE	AREA (sq.ft)	UNIT
S	980	2bhk
T	900	2bhk
U	1070	3bhk
V	1235	3bhk



**BLOCK - 4**



**Layout Plan**



**Amenities:**

- ★ Swimming Pool
- ★ Children Park
- ★ A/C Community Hall
- ★ Indoor Games
- ★ Gymnasium
- ★ Intercom
- ★ Water Filtration Plant
- ★ CCTV Camera
- ★ Power Back Up etc.



**CCTV Camera**



**Indoor Games**



**Community Hall**



**Children Park**



**24x7 Hr Power Backup**



**Gymnasium**

**Amenities :**

# Rajwada Rosewood - Specifications

## **Structure:**

RCC with bricks

## **Walls:**

Internal: Plaster of Paris finish

External: Finishing with Weather coat paint & graceful elevation

## **Flooring:**

Entire flat with Vitrified Tiles flooring

Stairs and lobby floor with Marble

Car parking area flooring with Wonder crete

## **Electricals:**

Concealed ISI copper wiring with Anchor switches

Adequate light and power points

T.V/ Telephone points at Living area

AC point in Master Bedroom

## **Kitchen:**

Cooking Platform with Granite

Stainless steel sink

Glazed tiles up to 2ft above cooking platform

## **Toilets:**

Glazed tiles up to a height of 6ft

CP bath fittings of parryware/marc, sanitary fittings of parryware make

Gyser point in one toilet

## **Doors:**

Main door panel teakwood.

Others - Flush doors

PVC doors at Toilet

Windows

Aluminium Sliding windows with glass panes

## **Water supply:**

Deep tubewell with water filtration plant

Overhead tank for sufficient storage and supply

## **Lift:**

Automatic 5 Passenger lift of Adams or equivalent make

## **Roof:**

Common roof with special treatment

## **Loft:**

One Loft at each flat

Rajwada Group  
Windsor Greens Appt.  
26, Mahamaya Mandir Road  
Mahamayatala, Kolkata - 700084

Ph: +91 9883322111

Ph: +91 9051127788

Web: [www.rajwadagroup.in](http://www.rajwadagroup.in)

Email: [rajwadagroup@gmail.com](mailto:rajwadagroup@gmail.com)



**RAJWADA**  
G R O U P

