



www.rajwadagroup.in

Rajwada Group
Windsor Greens Appt.
26, Mahamaya Mandir Road
Mahamayatala, Kolkata - 700084



Rajwada Grand located at Kamal Gazi more Garia

Hurry! Your dream home is here! Rajwada Grand brings to you an amazing assortment of residential flats in the heart of Kolkata itself. Situated in the prime location of Kamalgazi on NSC Bose Road, these flats are meant to make your life super-convenient and hassle-free. On one hand, you have easy access to metro rail which is just a 1 and half kilometers away while on the other, have close proximity to Sonarpur railway station.

Boasting of a square feet of around 1210 to 1535, the flats are quite spacious and airy. Moreover, it is equipped with all modern amenities including AC community hall, swimming pool, water filtration, power backup, super speed elevator etc. Security is top-notch with CCTV cameras placed at all strategic places for increased vigilance and monitoring. Thus you can expect a safe, secure and comfortable atmosphere in Rajwada Grand.



Your search for the ultimate home that smacks of both comfort and convenience ends here. Surrounded by greenery, this property promises you a respite from the dirt and pollution of city life while remaining well-connected to it at the same time.

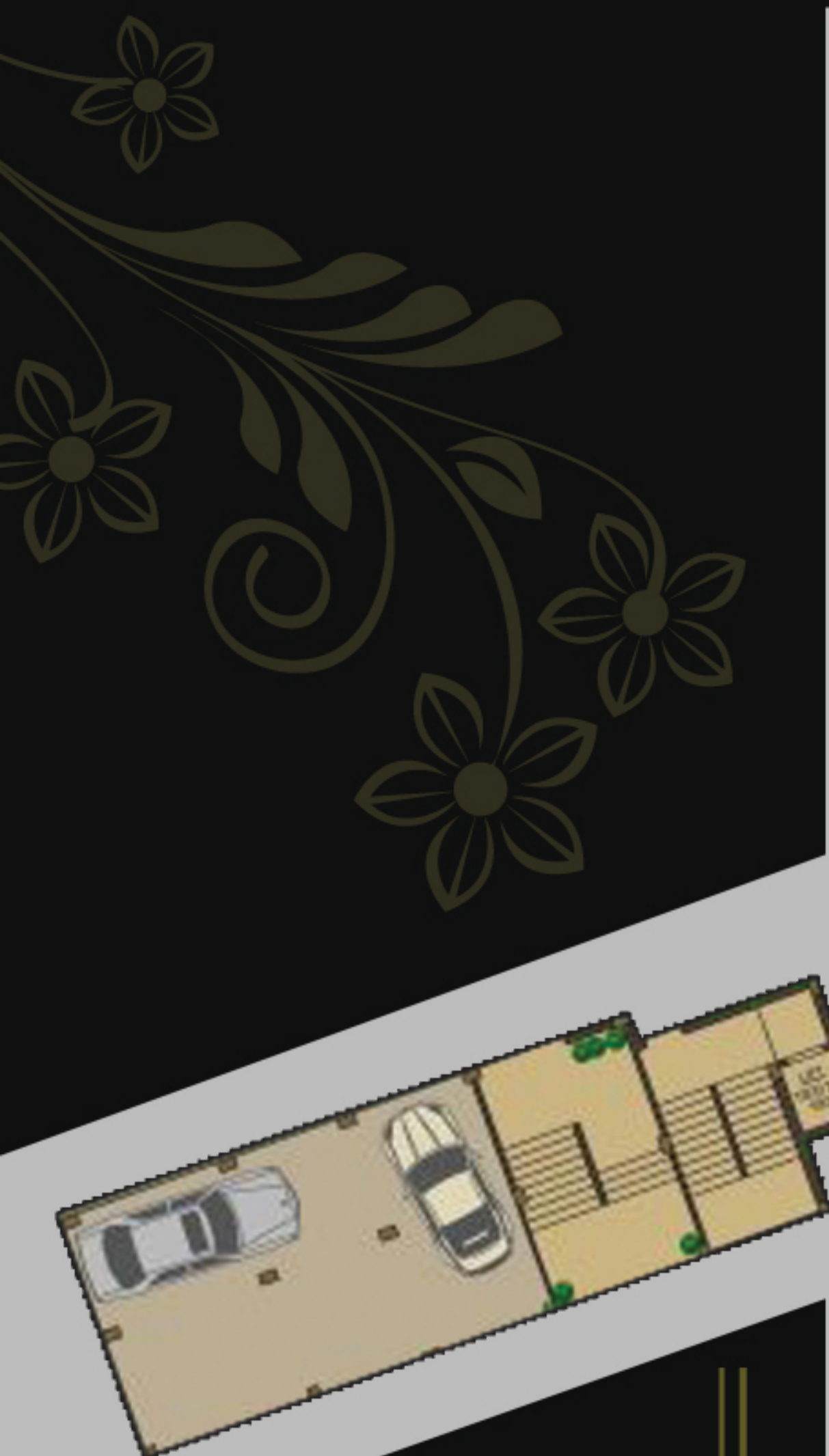

Block-1
G+ IV

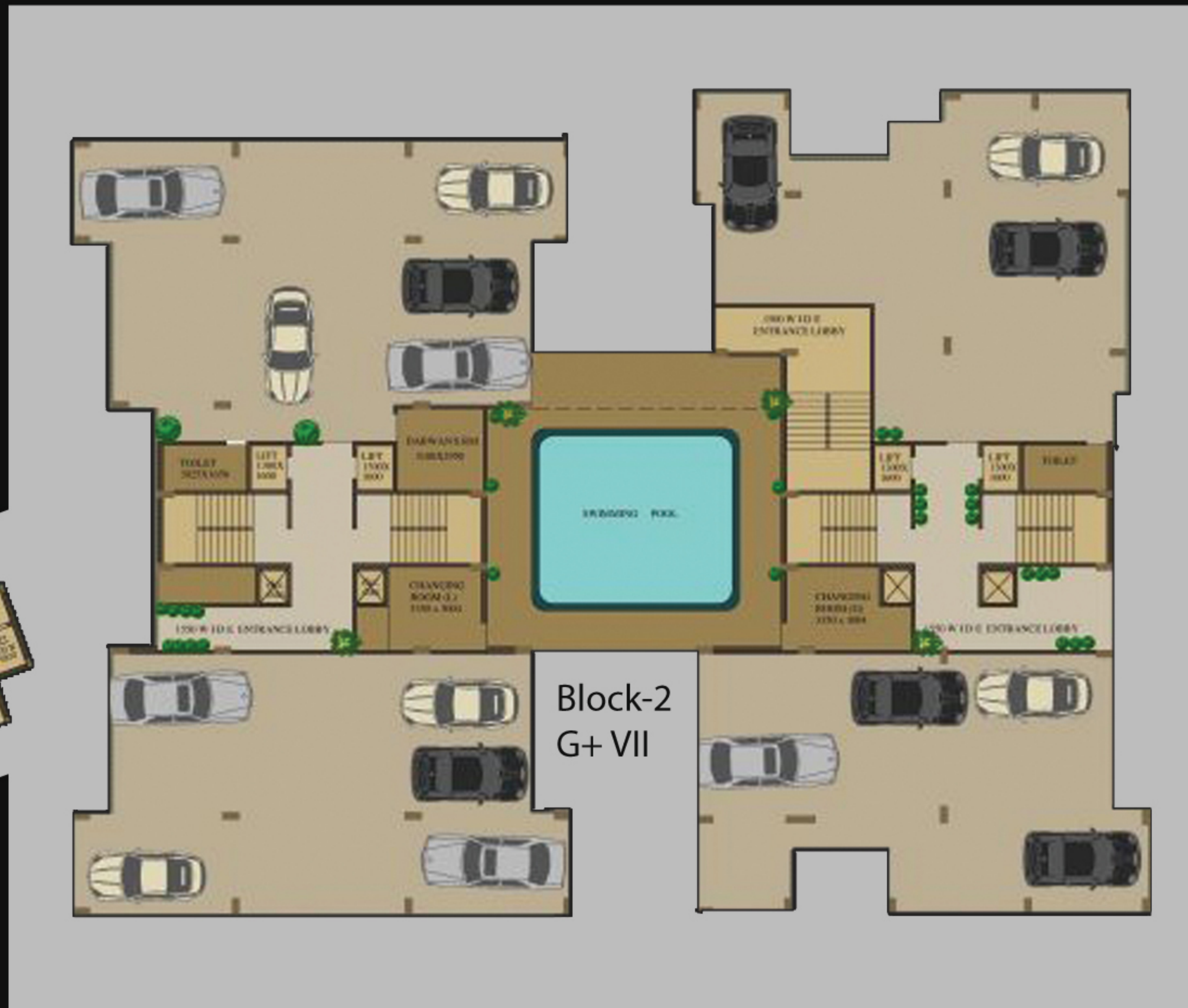

Block-2
G+ VII



BLOCK - 2
2ND TO 7TH FLOOR PLAN

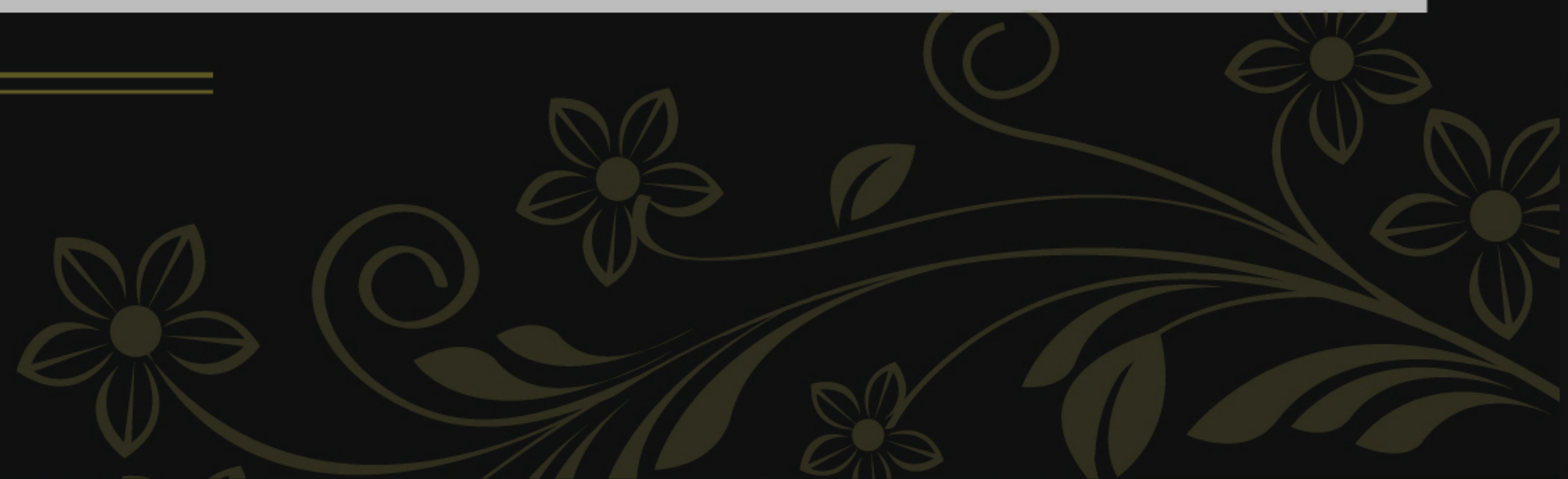



Rajwada Grand - Specifications

Painting Oil bound paint from inside and cement paint from outside.

Flooring:

Vitrified tiles in entire flat

Doors:

All internal doors are flush doors, main ent. door shall be teak wood frame.

Windows:

Aluminium windows with glass M.S. safety grille for window.

Kitchen:

Stainless steel sink , Green marble & kitchen exhaust fan point in each flat

Electrification:

All points in concealed copper wiring and 4 ½ points in each room with circuit breaker, AC, cable, telephone points in living room & master bedroom. Provision for inverter wiring.

Lift:

6-Passenger lift

Others facilities

- *Multi Gym*
- *Swimming Pool*
- *Indoor Games*
- *Community Hall*

Boasting of a square feet of around 1210 to 1535, the flats are quite spacious and airy. Moreover, it is equipped with all modern amenities including AC community hall, swimming pool, water filtration, power backup, super speed elevator etc. Security is top-notch with CCTV cameras placed at all strategic places for increased vigilance and monitoring. Thus you can expect a safe, secure and comfortable atmosphere in Rajvada Grand.



There are many variations:



Rajwada Grand Amenities



Rajwada Grand Amenities



Swimming Pool

Rajwada Grand offers all the amenities a city life needs. The simple emotions and joy of day-to-day affairs we're forgetting will find you rejuvenated.

Rajwada Grand will have:

Gym with all modern facilities
Swimming Pool
Banquet Hall



Community Hall



Intercom Connectivity

Rajwada Grand offers all the amenities a city life needs. The simple emotions and joy of day-to-day affairs we're forgetting will find you rejuvenated.

Rajwada Grand will have:

Games Room
Intercom Connectivity
CCTV



CCTV



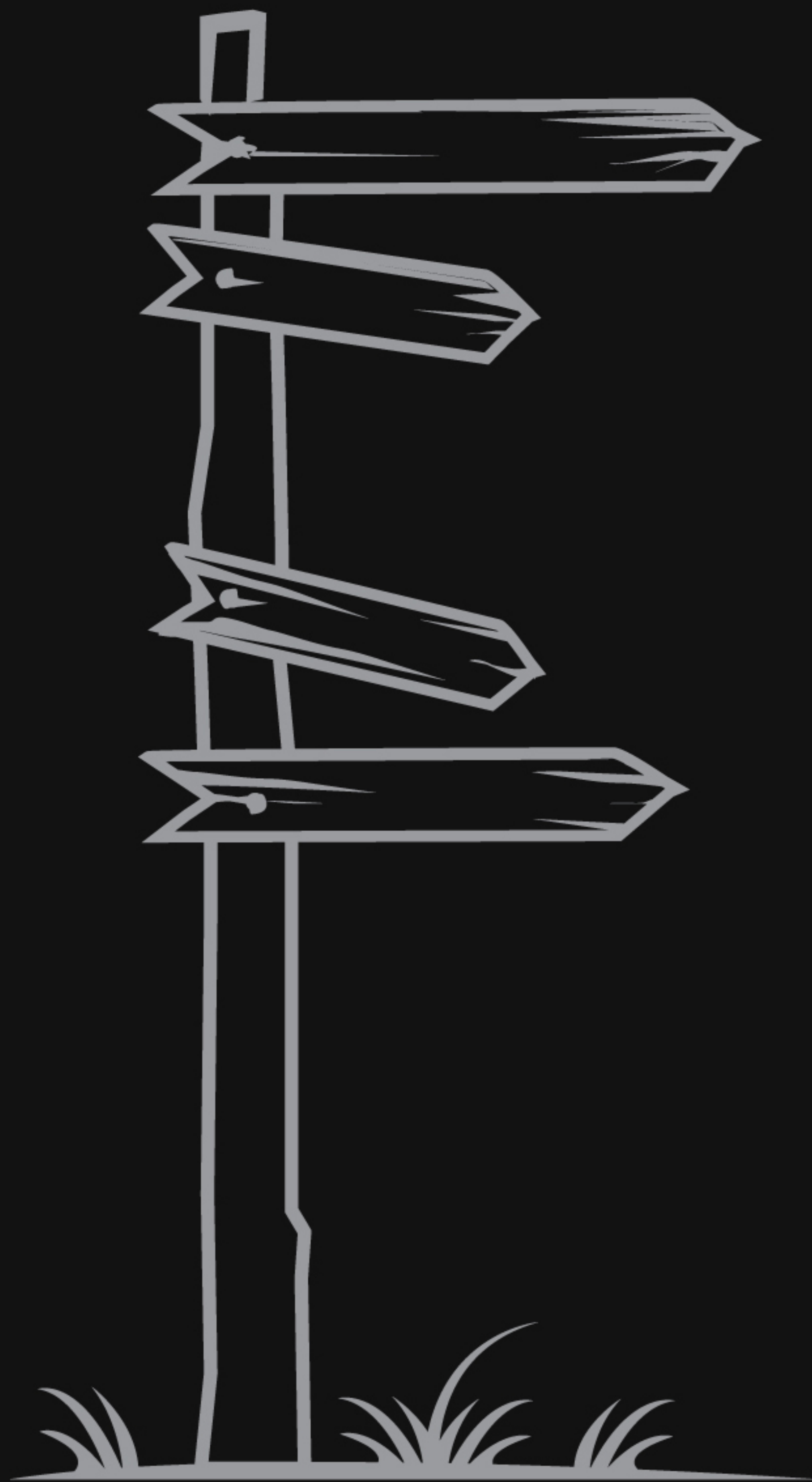

Major Points from Rajwada Grand:

- Khudiram Metro -
- Highland Park -
- Peerless Hospital -
- Ruby Hospital -
- Garia Metro -
- Tollygunj -
- Sealdah Station
- Howrah Station
- Airport

Night View, Rajwada Grand



Email: info@rajwadagroup.in

Ph: +91-9883322111

