



CONCORDE  
CUPPERTINO

Millionaire Homes for the new elite.



Wake up to a privileged existence, everyday.

When one finally discovers one's dream home, it should be more than a place to live; it should be a place that helps define the resident itself. In recognition of this belief, Millionaire Homes spread over 12 acres at the heart of Electronics City, the hub of tomorrow's affluent, have been crafted to suit your exacting standards. Located ideally, these 181 luxury villas at Concorde Cupertino provide you with the lifestyle of a millionaire as well as the convenience you need to conduct your business. If you're looking for a resplendent home that reflects your immaculate status, look no further than Concorde Cupertino.





A location that personifies the bright  
future ahead.

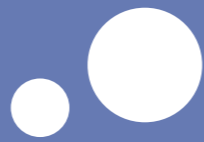

Die Cut

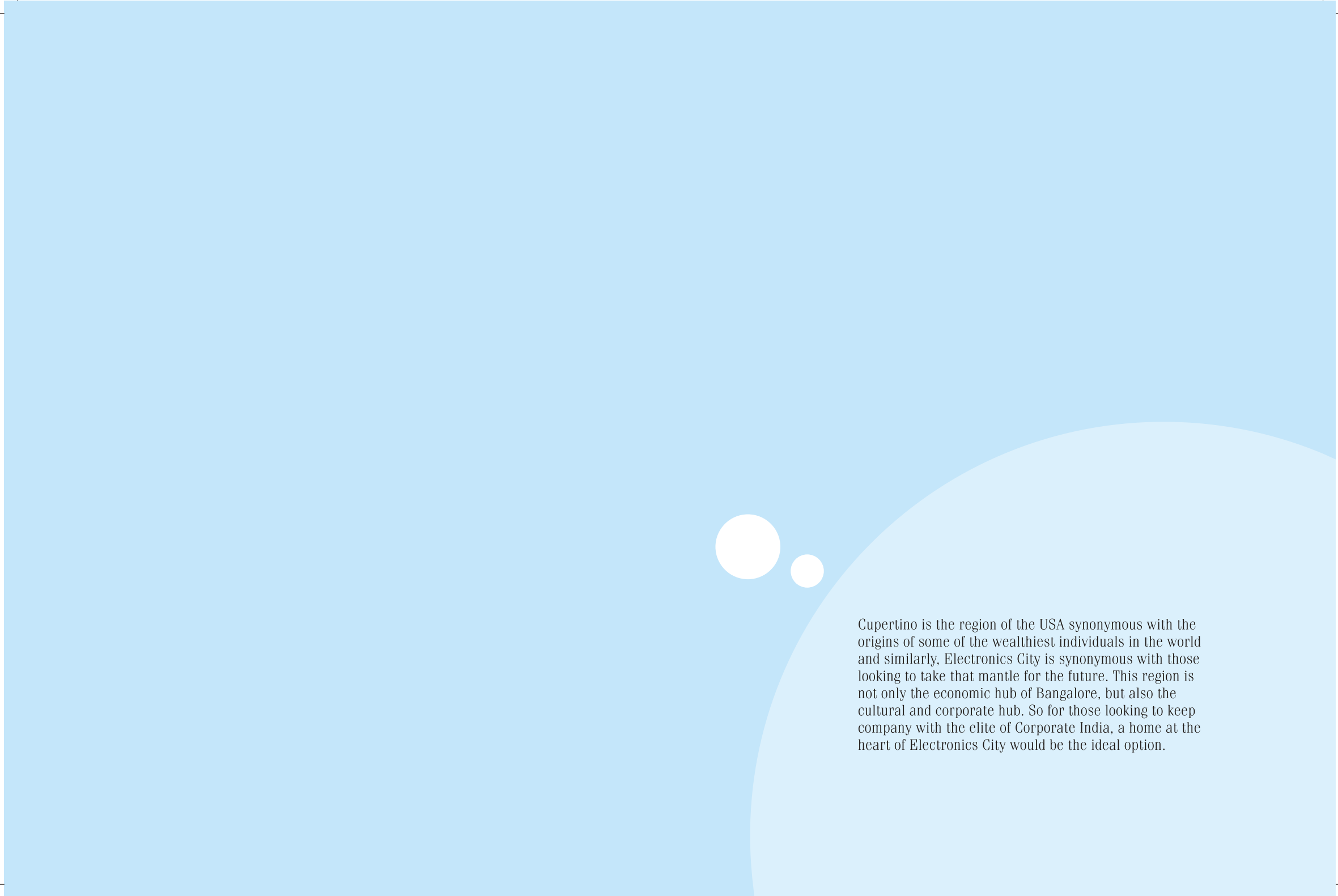

Cupertino is the region of the USA synonymous with the origins of some of the wealthiest individuals in the world and similarly, Electronics City is synonymous with those looking to take that mantle for the future. This region is not only the economic hub of Bangalore, but also the cultural and corporate hub. So for those looking to keep company with the elite of Corporate India, a home at the heart of Electronics City would be the ideal option.







Millionaire Homes are only complete when  
complemented by amenities to match.

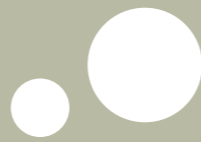

Die Cut

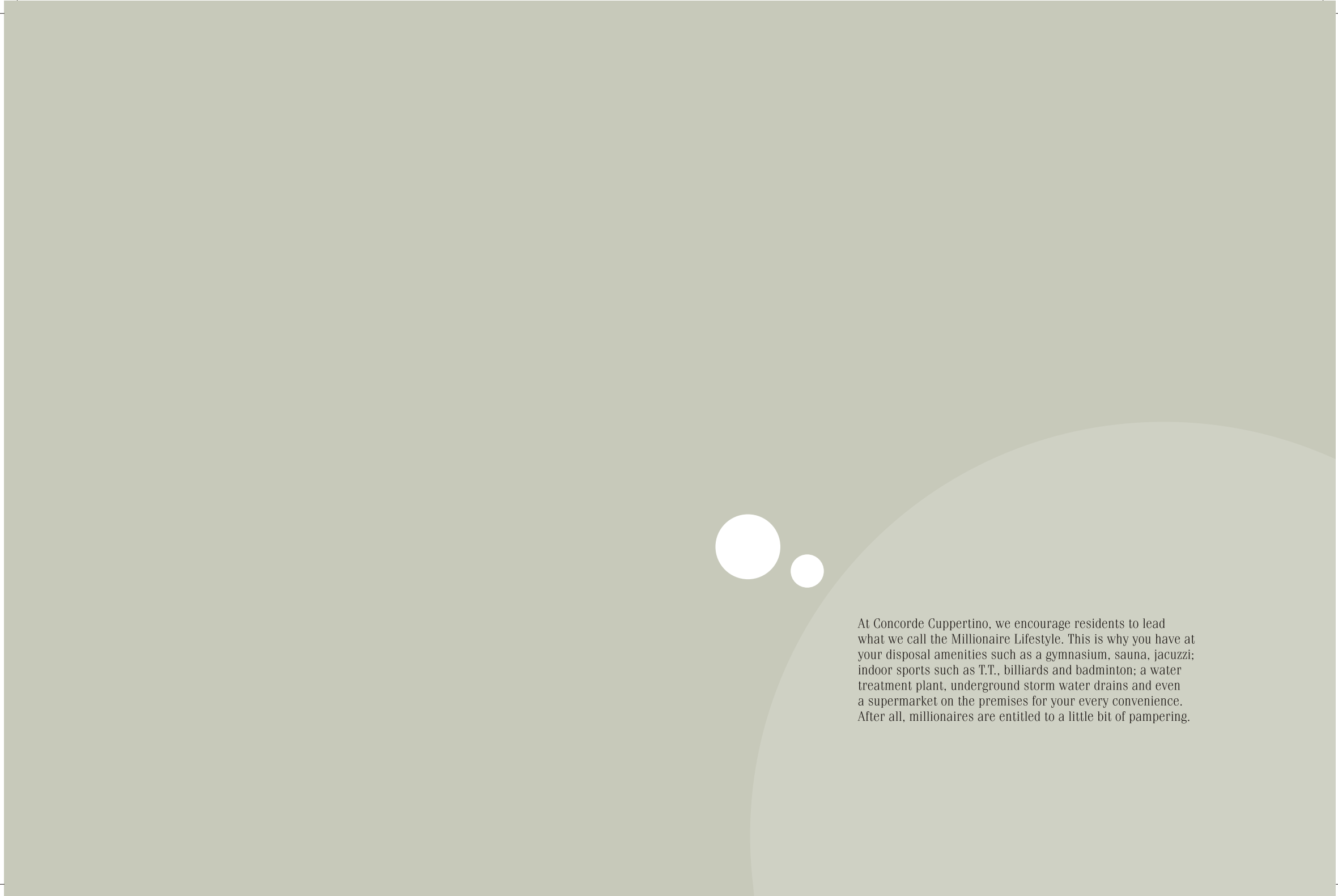

At Concorde Cupertino, we encourage residents to lead what we call the Millionaire Lifestyle. This is why you have at your disposal amenities such as a gymnasium, sauna, jacuzzi; indoor sports such as T.T., billiards and badminton; a water treatment plant, underground storm water drains and even a supermarket on the premises for your every convenience. After all, millionaires are entitled to a little bit of pampering.





For those who are used to being in control.

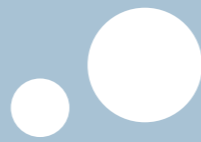

Die Cut



You're in control of just about every aspect of your life,  
so why not extend that control to your leisure time?  
At Cupertino, residents can enjoy the perks of a temperature-  
controlled indoor swimming pool, so that you can take a dip  
whenever you wish to.







For those who love sport, convenience  
begins indoors.



Die Cut

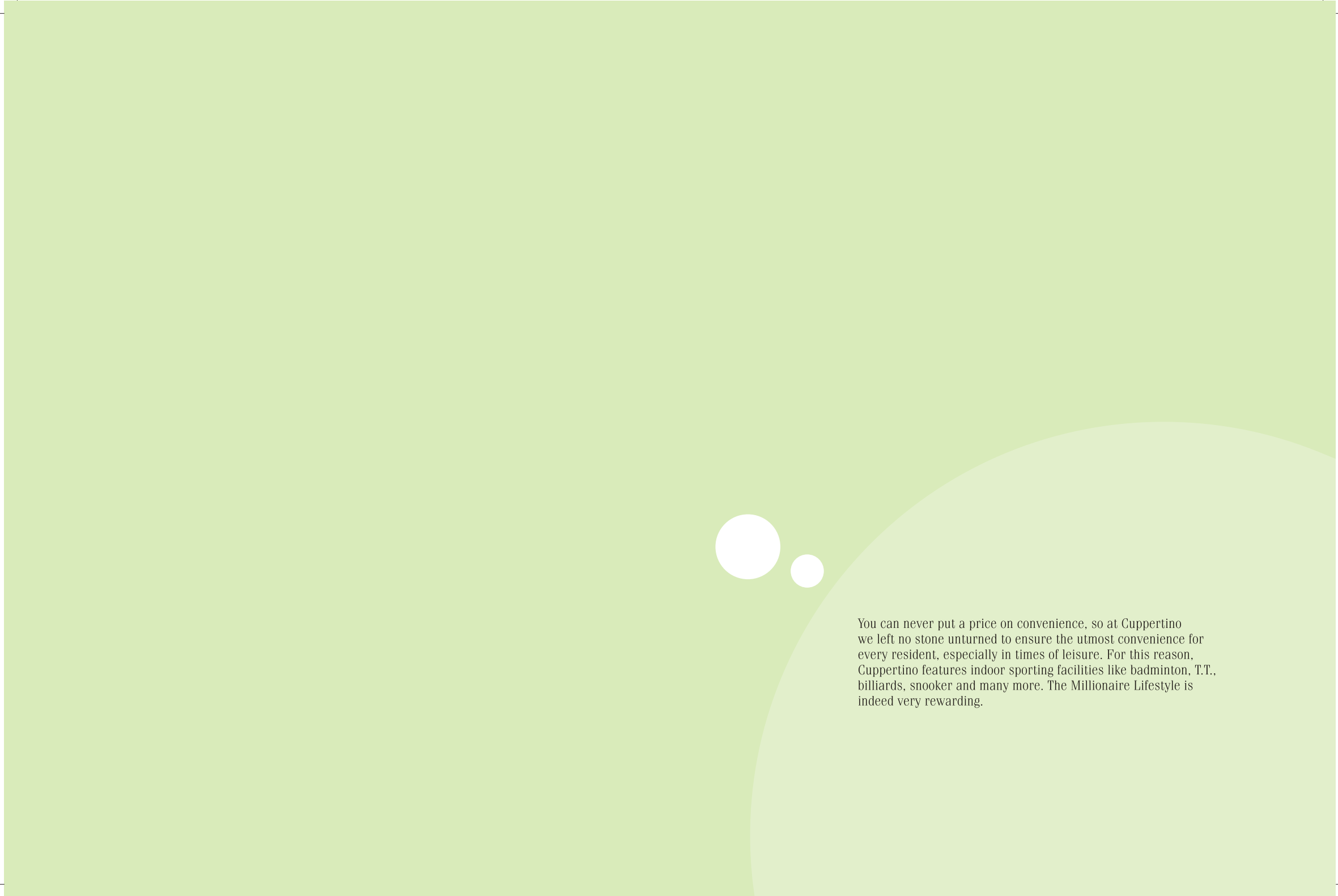

You can never put a price on convenience, so at Cupertino we left no stone unturned to ensure the utmost convenience for every resident, especially in times of leisure. For this reason, Cupertino features indoor sporting facilities like badminton, T.T., billiards, snooker and many more. The Millionaire Lifestyle is indeed very rewarding.





Vast space to hone and test your sporting skills.



Die Cut

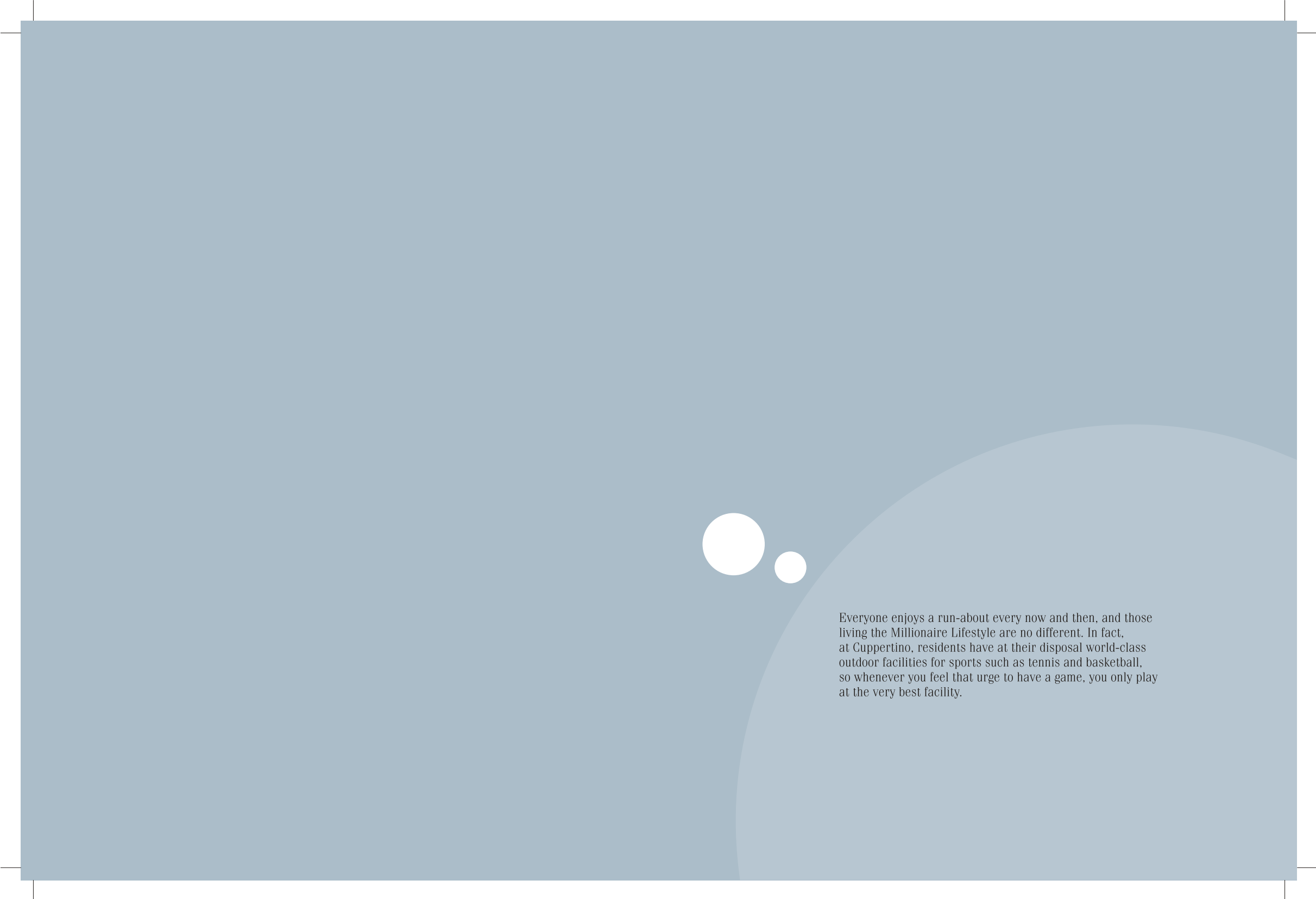

Everyone enjoys a run-about every now and then, and those living the Millionaire Lifestyle are no different. In fact, at Cupertino, residents have at their disposal world-class outdoor facilities for sports such as tennis and basketball, so whenever you feel that urge to have a game, you only play at the very best facility.







There's nothing like a good session at the sauna  
after a hard day's work.

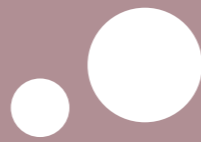

Die Cut

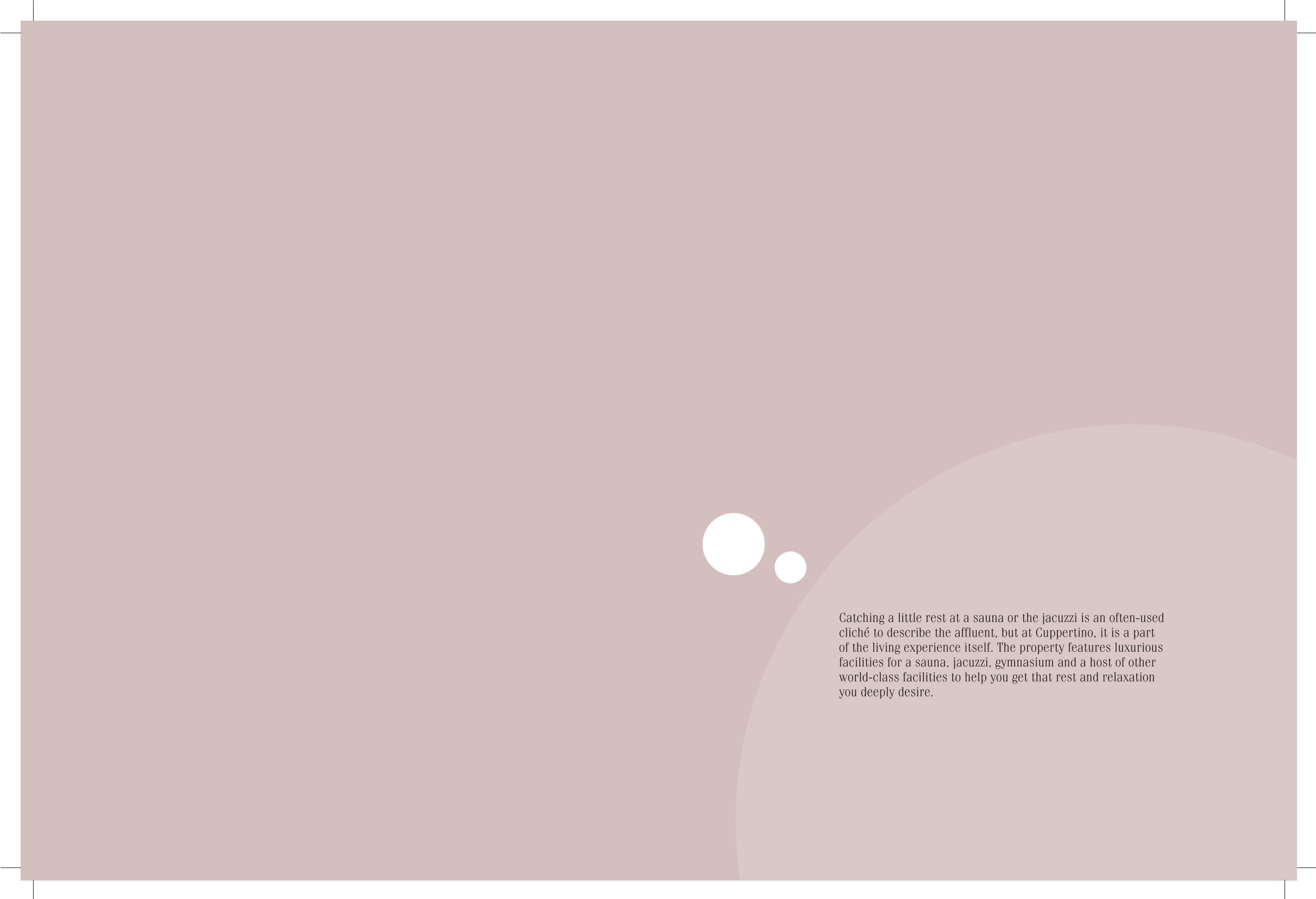

Catching a little rest at a sauna or the jacuzzi is an often-used cliché to describe the affluent, but at Cupertino, it is a part of the living experience itself. The property features luxurious facilities for a sauna, jacuzzi, gymnasium and a host of other world-class facilities to help you get that rest and relaxation you deeply desire.







### 13 Premium Villas in Concorde Cupertino

Feel the essence of Cupertino; in the comfort of your home.

The luxury villas at Concorde Cupertino have been created keeping in mind the Millionaire Lifestyle that people like you are accustomed to. So even if you haven't physically lived in the city of Cupertino, you can always proudly proclaim that you own a home at Concorde Cupertino.









## Maple

The villas in the Maple range are built in the dimensions of 30x40 sq. ft. and are west-facing.

Total Built up Area: 1850 sq.ft

Ground floor  
BUA: 835 sq.ft



First floor  
BUA: 630 sq.ft



Second floor  
BUA: 385 sq.ft





## Cypress

The villas in the Cypress range are built in the dimensions of 30x40 sq. ft. and are north-facing.

Total Built up Area: 1850 sq.ft

Ground floor  
BUA: 835 sq.ft



First floor  
BUA: 630 sq.ft



Second floor  
BUA: 385 sq.ft





## Sequoia

The villas in the Sequoia range are built in the dimensions of 30x40 sq. ft. and are south-facing.

Total Built up Area: 1850 sq.ft

Ground floor  
BUA: 835 sq.ft



First floor  
BUA: 630 sq.ft



Second floor  
BUA: 385 sq.ft

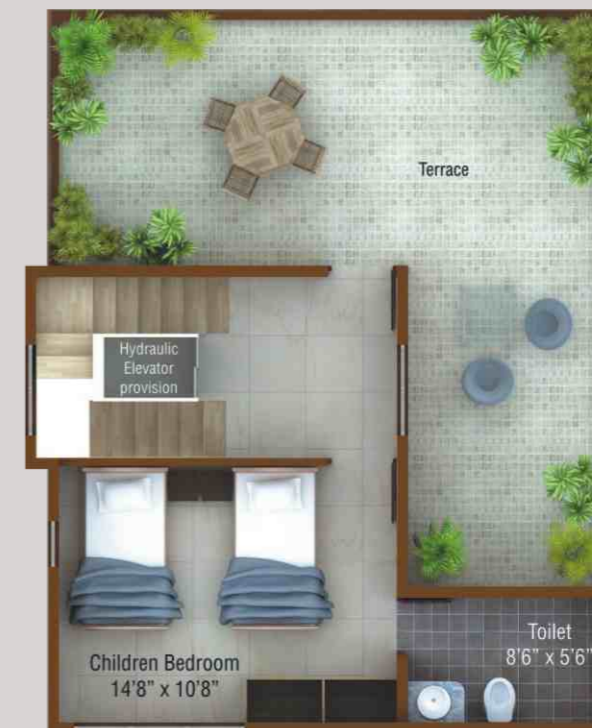



## Joshua

The villas in the Joshua range are built in the dimensions of 30x40 sq. ft. and are east-facing.

Total Built up Area: 1850 sq.ft







## Walnut

The villas in the Walnut range are built in the dimensions of 30x50 sq. ft. and are north-facing.

Total Built up Area: 2115 sq.ft

Ground floor  
BUA: 940 sq.ft



First floor  
BUA: 675 sq.ft



Second floor  
BUA: 500 sq.ft





## Juniper

The villas in the Juniper range are built in the dimensions of 30x50 sq. ft. and are east-facing.

Total Built up Area: 2115 sq.ft

Ground floor  
BUA: 940 sq.ft



First floor  
BUA: 675 sq.ft



Second floor  
BUA: 500 sq.ft





## Catalina

The villas in the Catalina range are built in the dimensions of 30x50 sq. ft. and are south-facing.

Total Built up Area: 2125 sq.ft

Ground floor  
BUA: 885 sq.ft



First floor  
BUA: 685 sq.ft



Second floor  
BUA: 555 sq.ft





## Hazel

The villas in the Hazel range are built in the dimensions of 30x50 sq. ft. and are west-facing.

Total Built up Area: 2125 sq.ft

Ground floor  
BUA: 885 sq.ft



First floor  
BUA: 685 sq.ft



Second floor  
BUA: 555 sq.ft







## Apricot

The villas in the Apricot range are built in the dimensions of 40x50 sq. ft. and are east-facing.

Total Built up Area: 2605 sq.ft

Ground floor  
BUA: 1165 sq.ft



First floor  
BUA: 890 sq.ft



Second floor  
BUA: 550 sq.ft





## Cottonwood

The villas in the Cottonwood range are built in the dimensions of 40x50 sq. ft. and are north-facing.

Total Built up Area: 2605 sq.ft

Ground floor  
BUA: 1165 sq.ft



First floor  
BUA: 890 sq.ft



Second floor  
BUA: 550 sq.ft





## Desert Willow

The villas in the Desert Willow range are built in the dimensions of 40x50 sq. ft. and are south-facing.

Total Built up Area: 2605 sq.ft

Ground floor  
BUA: 1165 sq.ft



First floor  
BUA: 890 sq.ft



Second floor  
BUA: 550 sq.ft





## Cliffrose

The villas in the Cliffrose range are built in the dimensions of 40x50 sq. ft. and are west-facing.

Total Built up Area: 2605 sq.ft

Ground floor  
BUA: 1165 sq.ft



First floor  
BUA: 890 sq.ft



Second floor  
BUA: 550 sq.ft







## Muller Oak

The villas in the Muller Oak range are built in the dimensions of 40x60 sq. ft. and are east-facing.

Total Built up Area: 3035 sq.ft



# Master Plan





CONCORDE  
CUPPERTINO

MASTER PLAN

## Specifications

- Structure : RCC framed structure
- Main Door : Engineered teakwood door with veneer finish and good quality hinges and locks
- Internal Door : Modular shutters with veneer good quality hinges and locks
- Windows : Powder coated aluminium 3/2 track sliding windows
- Flooring : Premium vitrified tiles in kitchen, living/dining and bedrooms. Ceramic anti-skid tiles in utilities and designer anti-skid tiles for bathroom floors and upto 7 feet height dado
- Sanitary Fittings : Good quality EWC and wash basin
- Kitchen : 20mm thick sindhori/green/black of your choice granite top counter with single bowl SS sink
- Plumbing : Jaguar/Plumber/Kohler or equivalent
- Electrical Switches : ABB, Schneider or equivalent
- Wiring : Concealed copper wiring, TV and AC points in living rooms and all bedrooms
- Generators : 5 KW power supply and 1000 KV DG backup for each villa
- Sanitation : Underground drainage with sewage treatment plant (STP)
- Water Supply : Water supply through water treatment plant
- Wall finishing Internal : Plastic emulsion paint
- Exterior : Partial texture and emulsion
- Staircase : Good quality granite flooring

# Location Map





Established in 1998, The Concorde Group has always made it a core principle to commit the very best resources towards building an 'ideal home'. Although the definition of an ideal home might change constantly, The Concorde Group has always been at the forefront to not only meet, but exceed those standards. By hiring only the cream of real estate expertise, we at Concorde ensure that every microscopic detail is presided over, fussed about and eventually taken care of. Lastly, projects with so much quality deserve to look the part, so our highly skilled in-house architects do their best to ensure every Concorde project has a distinct aesthetic appeal.

## Our other landmark projects



**Electronics City, Bangalore**  
Concorde Manhattans is a property comprising 988 units spread over 13 acres.



**Off Hosur Road, Bangalore**  
Concorde Midway City is a property comprising 240 luxury apartments, covering 5.1 acres.



**Electronics City Phase 2, Bangalore**  
Concorde Sylvan View is a property comprising 205 designer villas spread over 12 acres.



**Electronics City, Bangalore**  
Concorde Silicon Valley is a property comprising 229 luxury villas sprawling over 18 acres, with 75% open space.



**Close to Sarjapur, Bangalore**  
Concorde Mist Valley is a property comprising 1442 plot developments and designer villas spanning 150 acres.





## Concorde Group

#46, 1st A Main Road, Sarakki Industrial Layout, J.P.Nagar, 3rd Phase, Bangalore – 560 076

Phone: 080-66512999, 66512888 E-mail: [marketing@concordegroun.co.in](mailto:marketing@concordegroun.co.in) [nbabu@concordegroun.co.in](mailto:nbabu@concordegroun.co.in) [nesar@concordegroun.co.in](mailto:nesar@concordegroun.co.in)

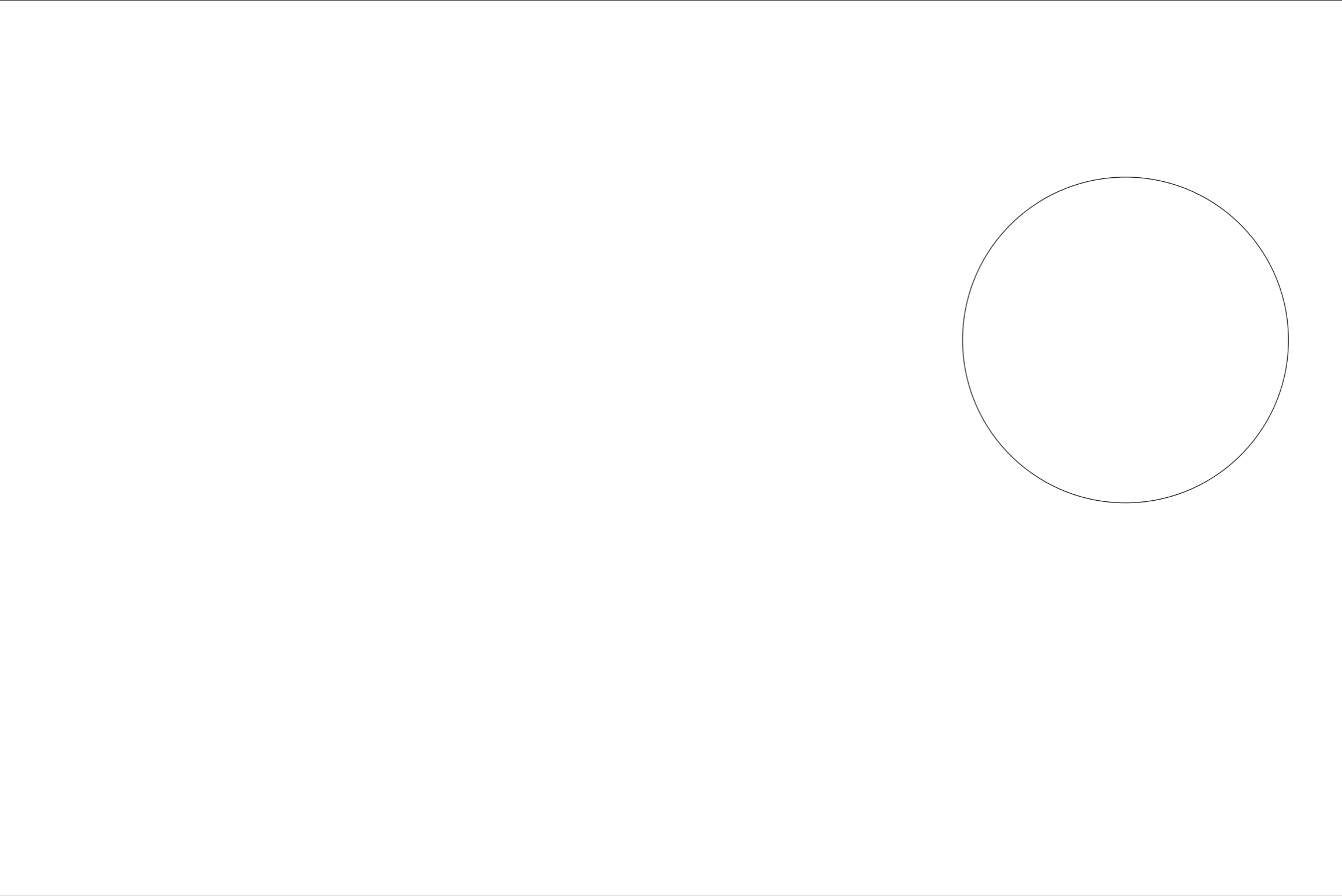

Die\_Front Cover

