



ABOUT VIHANG GROUP

As one of Thane's most trustworthy and renowned developers, Vihang Group has been shaping the city's skyline with landmark residential and commercial projects since 1989. The group's illustrious developments include Vihang Nova, Vihang Vermont, Metro Hive, Vihang Plaza, Vihang Golden Hills, Vihang Valley, Vihang Woods, Vihang Marina and many more.

Known for always being ahead of the curve, the group has become synonymous with bespoke and affordable luxury residences, that are energy-efficient and offer superior community living experiences. With a reputation for building quality landmarks and delivering on promises, Vihang Group is today one of the most sought-after developers in the city.

UPGRADE TO
AN HIGHER ORDER OF LIVING



**VIHANG
MARINA**
G.B. Road, Thane

Corporate Office Address: 12th Floor, Dev Corpora, Cadbury Junction, Eastern Express Highway, Khopat, Thane (w) – 400601.

☎ 022 2172 9000
🌐 www.vihanggroup.com

Site Address: Vihang Marina, Opp. Vihang Godrej Project, Bhayander Pada, Ghodbunder Road, Thane (w) 400615.

☎ 88790 33333 📱📷📺📺
🌐 www.vihangmarina.com

Disclaimer: The project has been registered via MAHARERA registration number P51700034747 on 28/04/2022 and is available on the website <https://maharera.mahaonline.gov.in> under registered projects.

The amenities, specifications, facilities, surrounding infrastructure, stock images and features shown and/or mentioned and the image renders used herein are purely indicative and promotional and may differ from the actuals. The images and other details herein are only indicative. The Developer / Owner reserves the right to change any or all of these in the interest of the development, as per provision of law. Artist's impressions are used to illustrate amenities, specifications, images and other details. Tolerance of +/- 3% is possible in the unit areas on account of design and construction variances. All layouts, plans, specifications, dimensions, designs, measurements and locations are indicative and not to scale and are subject to change as may be required. This printed material does not constitute any form of an agreement and all purchases/leases shall solely be governed by the terms of the agreement for sale /lease. All finishes are subject to change at the discretion of the Interior Designers, in the interest of continual improvement of the project. The Developer / Owner does not warrant or assume any liability or responsibility for the accuracy or completeness of any information contained herein. You are required to verify all the details, including area, amenities, services, terms of sales and payments and other relevant terms independently with the Developer sales team only, by physically visiting the project site and the authorised website of RERA.

A PROJECT BY



A PROGRESSIVE LANDMARK AN ABODE IN SERENITY



Ref. Image

Disclaimer: The project has been registered via MAHARERA registration number P51700034747 on 28/04/2022 and is available on the website <https://maharera.mahaonline.gov.in> under registered projects. The amenities, specifications, facilities, surrounding infrastructure, stock images and features shown and/or mentioned and the image renders used herein are purely indicative and promotional and may differ from the actuals. The images and other details herein are only indicative. The Developer / Owner reserves the right to change any or all of these in the interest of the development, as per provision of law. Artist's impressions are used to illustrate amenities, specifications, images and other details. Tolerance of +/- 3% is possible in the unit areas on account of design and construction variances. All layouts, plans, specifications, dimensions, designs, measurements and locations are indicative and not to scale and are subject to change as may be required. This printed material does not constitute any form of an agreement and all purchases/leases shall solely be governed by the terms of the agreement for sale /lease. All finishes are subject to change at the discretion of the Interior Designers, in the interest of continual improvement of the project. The Developer / Owner does not warrant or assume any liability or responsibility for the accuracy or completeness of any information contained herein. You are required to verify all the details, including area, amenities, services, terms of sales and payments and other relevant terms independently with the Developer sales team only, by physically visiting the project site and the authorised website of RERA.

UPGRADE TO A SEAMLESS CONNECTIVITY



Ref. Image

Disclaimer: The project has been registered via MAHARERA registration number P51700034747 on 28/04/2022 and is available on the website <https://maharera.mahaonline.gov.in> under registered projects. The amenities, specifications, facilities, surrounding infrastructure, stock images and features shown and/or mentioned and the image renders used herein are purely indicative and promotional and may differ from the actuals. The images and other details herein are only indicative. The Developer / Owner reserves the right to change any or all of these in the interest of the development, as per provision of law. Artist's impressions are used to illustrate amenities, specifications, images and other details. Tolerance of +/- 3% is possible in the unit areas on account of design and construction variances. All layouts, plans, specifications, dimensions, designs, measurements and locations are indicative and not to scale and are subject to change as may be required. This printed material does not constitute any form of an agreement and all purchases/leases shall solely be governed by the terms of the agreement for sale /lease. All finishes are subject to change at the discretion of the Interior Designers, in the interest of continual improvement of the project. The Developer / Owner does not warrant or assume any liability or responsibility for the accuracy or completeness of any information contained herein. You are required to verify all the details, including area, amenities, services, terms of sales and payments and other relevant terms independently with the Developer sales team only, by physically visiting the project site and the authorised website of RERA.

A PROJECT BY



VIHANG

A STRATEGICALLY
CONNECTED LOCATION
THAT OFFERS
DOORSTEP CONVENIENCES

Ref. Image

Disclaimer: The project has been registered via MAHARERA registration number P51700034747 on 28/04/2022 and is available on the website <https://maharera.mahaonline.gov.in> under registered projects. The amenities, specifications, facilities, surrounding infrastructure, stock images and features shown and/or mentioned and the image renders used herein are purely indicative and promotional and may differ from the actuals. The images and other details herein are only indicative. The Developer / Owner reserves the right to change any or all of these in the interest of the development, as per provision of law. Artist's impressions are used to illustrate amenities, specifications, images and other details. Tolerance of +/- 3% is possible in the unit areas on account of design and construction variances. All layouts, plans, specifications, dimensions, designs, measurements and locations are indicative and not to scale and are subject to change as may be required. This printed material does not constitute any form of an agreement and all purchases/leases shall solely be governed by the terms of the agreement for sale /lease. All finishes are subject to change at the discretion of the Interior Designers, in the interest of continual improvement of the project. The Developer / Owner does not warrant or assume any liability or responsibility for the accuracy or completeness of any information contained herein. You are required to verify all the details, including area, amenities, services, terms of sales and payments and other relevant terms independently with the Developer sales team only, by physically visiting the project site and the authorised website of RERA.



Artist's Impression

A PROJECT BY



AN ELEGANT LANDMARK OF LUXURY LIVING



VIHANG
MARINA

G.B. Road, Thane

PROJECT HALLMARKS

Building (A) - G + 24 Storey

Building (B) - G + 23 Storey

Exclusive 1 BHK Flats

1000+ Flats

TMC Approved Plan

G.B. Road Touch

Disclaimer: The project has been registered via MAHARERA registration number P51700034747 on 28/04/2022 and is available on the website <https://maharera.mahaonline.gov.in> under registered projects. The amenities, specifications, facilities, surrounding infrastructure, stock images and features shown and/or mentioned and the image renders used herein are purely indicative and promotional and may differ from the actuals. The images and other details herein are only indicative. The Developer / Owner reserves the right to change any or all of these in the interest of the development, as per provision of law. Artist's impressions are used to illustrate amenities, specifications, images and other details. Tolerance of +/- 3% is possible in the unit areas on account of design and construction variances. All layouts, plans, specifications, dimensions, designs, measurements and locations are indicative and not to scale and are subject to change as may be required. This printed material does not constitute any form of an agreement and all purchases/leases shall solely be governed by the terms of the agreement for sale /lease. All finishes are subject to change at the discretion of the Interior Designers, in the interest of continual improvement of the project. The Developer / Owner does not warrant or assume any liability or responsibility for the accuracy or completeness of any information contained herein. You are required to verify all the details, including area, amenities, services, terms of sales and payments and other relevant terms independently with the Developer sales team only, by physically visiting the project site and the authorised website of RERA.

AN ADDRESS OF ICONIC AMENITIES

For a privileged urban life experience

A PROJECT BY



Build a healthier lifestyle with **Jogging Track**



Celebrate your special moments at **Multipurpose Hall**



Step up into an active lifestyle with **Fully-equipped Gymnasium**



Experience the world of excitement at **Kids Play Area**



Get a splash of serenity in a **Swimming Pool**



Say goodbye to stress at **Yoga Corner**

Ref. Image

Disclaimer: The project has been registered via MAHARERA registration number P51700034747 on 28/04/2022 and is available on the website <https://maharera.mahaonline.gov.in> under registered projects. The amenities, specifications, facilities, surrounding infrastructure, stock images and features shown and/or mentioned and the image renders used herein are purely indicative and promotional and may differ from the actuals. The images and other details herein are only indicative. The Developer / Owner reserves the right to change any or all of these in the interest of the development, as per provision of law. Artist's impressions are used to illustrate amenities, specifications, images and other details. Tolerance of +/- 3% is possible in the unit areas on account of design and construction variances. All layouts, plans, specifications, dimensions, designs, measurements and locations are indicative and not to scale and are subject to change as may be required. This printed material does not constitute any form of an agreement and all purchases/leases shall solely be governed by the terms of the agreement for sale /lease. All finishes are subject to change at the discretion of the Interior Designers, in the interest of continual improvement of the project. The Developer / Owner does not warrant or assume any liability or responsibility for the accuracy or completeness of any information contained herein. You are required to verify all the details, including area, amenities, services, terms of sales and payments and other relevant terms independently with the Developer sales team only, by physically visiting the project site and the authorised website of RERA.

A PEERLESS LOCALE OF URBAN PROXIMITY

- **150 MTR. FROM** - Nagla Bunder Creek View
- **180 MTR. FROM** - Gaimukh Metro Station
- **200 MTR. FROM** - Shri Balasaheb Thackeray Chowpatty (Gaimukh Chowpatty)

5 MINS. FROM

Heart Shape Lake
Gowniwada Metro Station
Kasarvadavli Metro Station
Dhanwantri Hospital
Vedant Hospital
McDonald's
Big Bazaar
Hypercity
Decathlon
G-corp
New Horizon School & College
Saraswati School
Cambridge Intl. Pre-school

10 MINS. FROM

Pratap Sarnaik International School
Euro School
AP. Shah College
Dnyan Ganga College
Muchalla Polytechnique & HM
Parshwanath College Of Engineering
Suraj Water Park
Elvis Butterfly Garden
Domino's
D-Mart
TCS Hiranandani Estate
Currae Hospital
Hotel Vihang's Inn

15 MINS. FROM

Tikuji-ni-Wadi
Xavier's School
R-Mall
Korum Mall
Viviana Mall
Proposed Thane Borivali Tunnel
Bethany Hospital
Metropol Hospital
Jupiter Hospital
Western Express Highway
Eastern Express Highway
Vihang's Palm Club

20 MINS. FROM

Thane Station
Borivali Station
Mira Road Station



Timelines captured under specific conditions of routes, travel time and as per existing infrastructure

Disclaimer: The project has been registered via MAHARERA registration number P51700034747 on 28/04/2022 and is available on the website <https://maharera.mahaonline.gov.in> under registered projects. The amenities, specifications, facilities, surrounding infrastructure, stock images and features shown and/or mentioned and the image renders used herein are purely indicative and promotional and may differ from the actuals. The images and other details herein are only indicative. The Developer / Owner reserves the right to change any or all of these in the interest of the development, as per provision of law. Artist's impressions are used to illustrate amenities, specifications, images and other details. Tolerance of +/- 3% is possible in the unit areas on account of design and construction variances. All layouts, plans, specifications, dimensions, designs, measurements and locations are indicative and not to scale and are subject to change as may be required. This printed material does not constitute any form of an agreement and all purchases/leases shall solely be governed by the terms of the agreement for sale /lease. All finishes are subject to change at the discretion of the Interior Designers, in the interest of continual improvement of the project. The Developer / Owner does not warrant or assume any liability or responsibility for the accuracy or completeness of any information contained herein. You are required to verify all the details, including area, amenities, services, terms of sales and payments and other relevant terms independently with the Developer sales team only, by physically visiting the project site and the authorised website of RERA.



VIHANG
MARINA



Artist's Impression

Disclaimer: The project has been registered via MAHARERA registration number P51700034747 on 28/04/2022 and is available on the website <https://maharera.mahaonline.gov.in> under registered projects. The amenities, specifications, facilities, surrounding infrastructure, stock images and features shown and/or mentioned and the image renders used herein are purely indicative and promotional and may differ from the actuals. The images and other details herein are only indicative. The Developer / Owner reserves the right to change any or all of these in the interest of the development, as per provision of law. Artist's impressions are used to illustrate amenities, specifications, images and other details. Tolerance of +/- 3% is possible in the unit areas on account of design and construction variances. All layouts, plans, specifications, dimensions, designs, measurements and locations are indicative and not to scale and are subject to change as may be required. This printed material does not constitute any form of an agreement and all purchases/leases shall solely be governed by the terms of the agreement for sale /lease. All finishes are subject to change at the discretion of the Interior Designers, in the interest of continual improvement of the project. The Developer / Owner does not warrant or assume any liability or responsibility for the accuracy or completeness of any information contained herein. You are required to verify all the details, including area, amenities, services, terms of sales and payments and other relevant terms independently with the Developer sales team only, by physically visiting the project site and the authorised website of RERA.

Building A

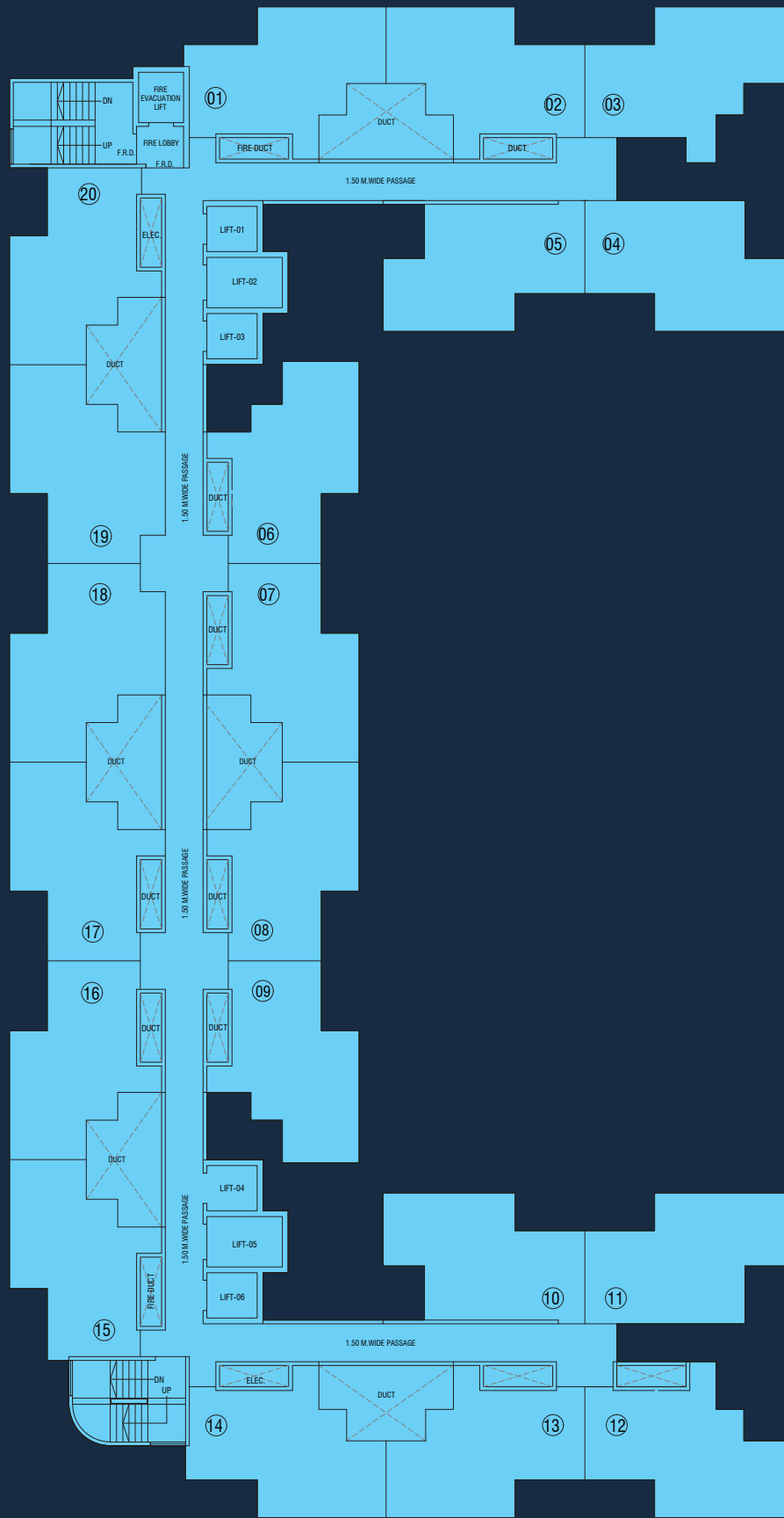

12 MTR. WIDE DP ROAD

Plan Disclaimer - "Plan not to scale, for accurate measurement of carpet area, please follow polyline method. The carpet Area is calculated assuming unfinished surfaces and any finishes may reduce the physical area accordingly. Carpet Area may vary by +/- 3% on account of construction or design tolerances."

Disclaimer: The project has been registered via MAHARERA registration number P51700034747 on 28/04/2022 and is available on the website <https://maharera.mahaonline.gov.in> under registered projects. The amenities, specifications, facilities, surrounding infrastructure, stock images and features shown and/or mentioned and the image renders used herein are purely indicative and promotional and may differ from the actuals. The images and other details herein are only indicative. The Developer / Owner reserves the right to change any or all of these in the interest of the development, as per provision of law. Artist's impressions are used to illustrate amenities, specifications, images and other details. Tolerance of +/- 3% is possible in the unit areas on account of design and construction variances. All layouts, plans, specifications, dimensions, designs, measurements and locations are indicative and not to scale and are subject to change as may be required. This printed material does not constitute any form of an agreement and all purchases/leases shall solely be governed by the terms of the agreement for sale /lease. All finishes are subject to change at the discretion of the Interior Designers, in the interest of continual improvement of the project. The Developer / Owner does not warrant or assume any liability or responsibility for the accuracy or completeness of any information contained herein. You are required to verify all the details, including area, amenities, services, terms of sales and payments and other relevant terms independently with the Developer sales team only, by physically visiting the project site and the authorised website of RERA.

Building B

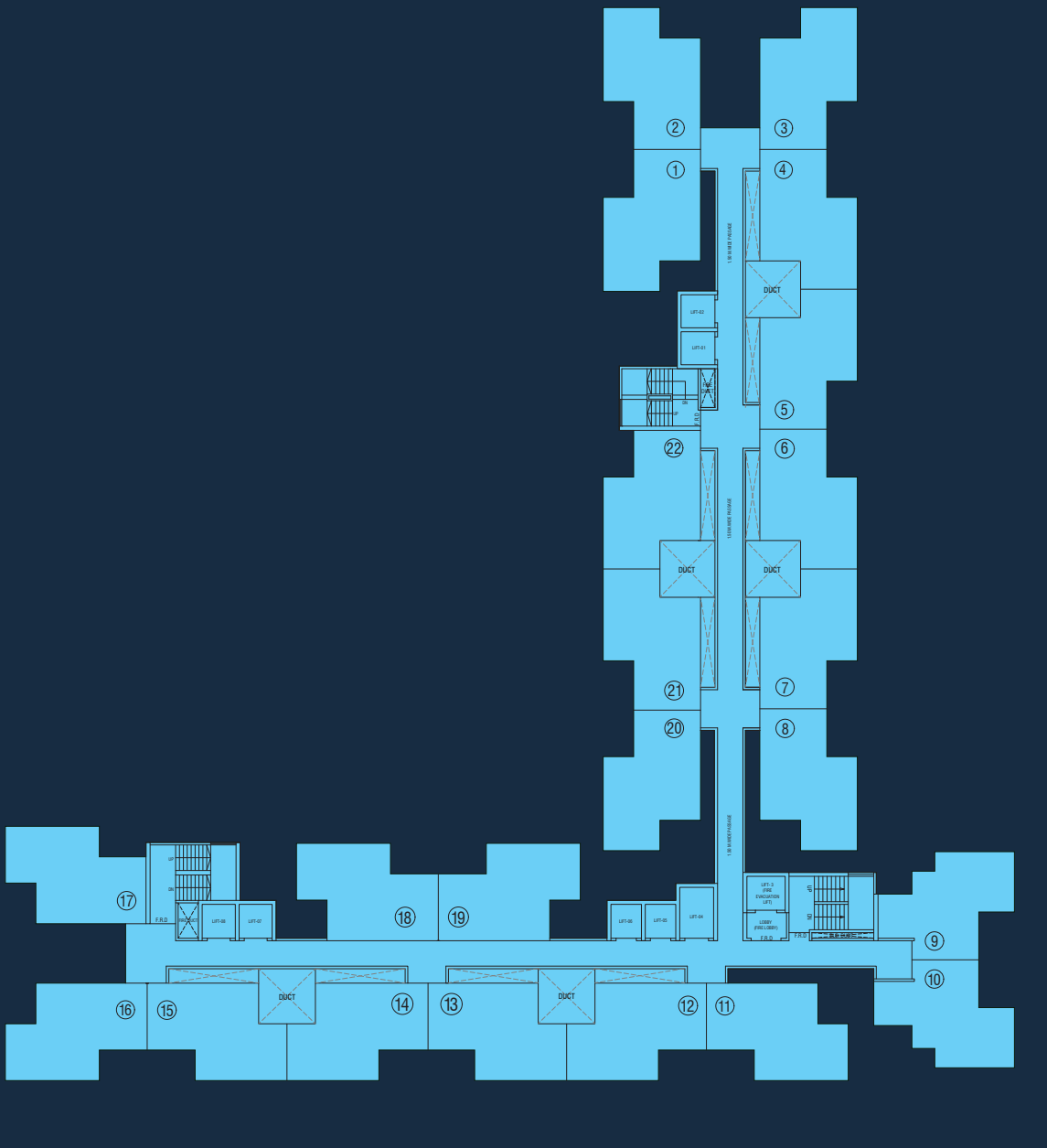

G. B. ROAD

12 MTR. WIDE DP ROAD

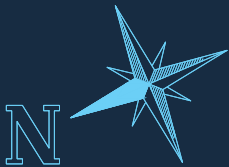

Plan Disclaimer - "Plan not to scale, for accurate measurement of carpet area, please follow polyline method. The carpet Area is calculated assuming unfinished surfaces and any finishes may reduce the physical area accordingly. Carpet Area may vary by +/- 3% on account of construction or design tolerances."

Disclaimer: The project has been registered via MAHARERA registration number P51700034747 on 28/04/2022 and is available on the website <https://maharera.mahaonline.gov.in> under registered projects. The amenities, specifications, facilities, surrounding infrastructure, stock images and features shown and/or mentioned and the image renders used herein are purely indicative and promotional and may differ from the actuals. The images and other details herein are only indicative. The Developer / Owner reserves the right to change any or all of these in the interest of the development, as per provision of law. Artist's impressions are used to illustrate amenities, specifications, images and other details. Tolerance of +/- 3% is possible in the unit areas on account of design and construction variances. All layouts, plans, specifications, dimensions, designs, measurements and locations are indicative and not to scale and are subject to change as may be required. This printed material does not constitute any form of an agreement and all purchases/leases shall solely be governed by the terms of the agreement for sale /lease. All finishes are subject to change at the discretion of the Interior Designers, in the interest of continual improvement of the project. The Developer / Owner does not warrant or assume any liability or responsibility for the accuracy or completeness of any information contained herein. You are required to verify all the details, including area, amenities, services, terms of sales and payments and other relevant terms independently with the Developer sales team only, by physically visiting the project site and the authorised website of RERA.

UNIT PLAN-1 BHK

BUILDING B | FLAT NOS.

1,2,3,4,5,6,7,8,11,12,13,14,15,16,17,18,19,20,21,22

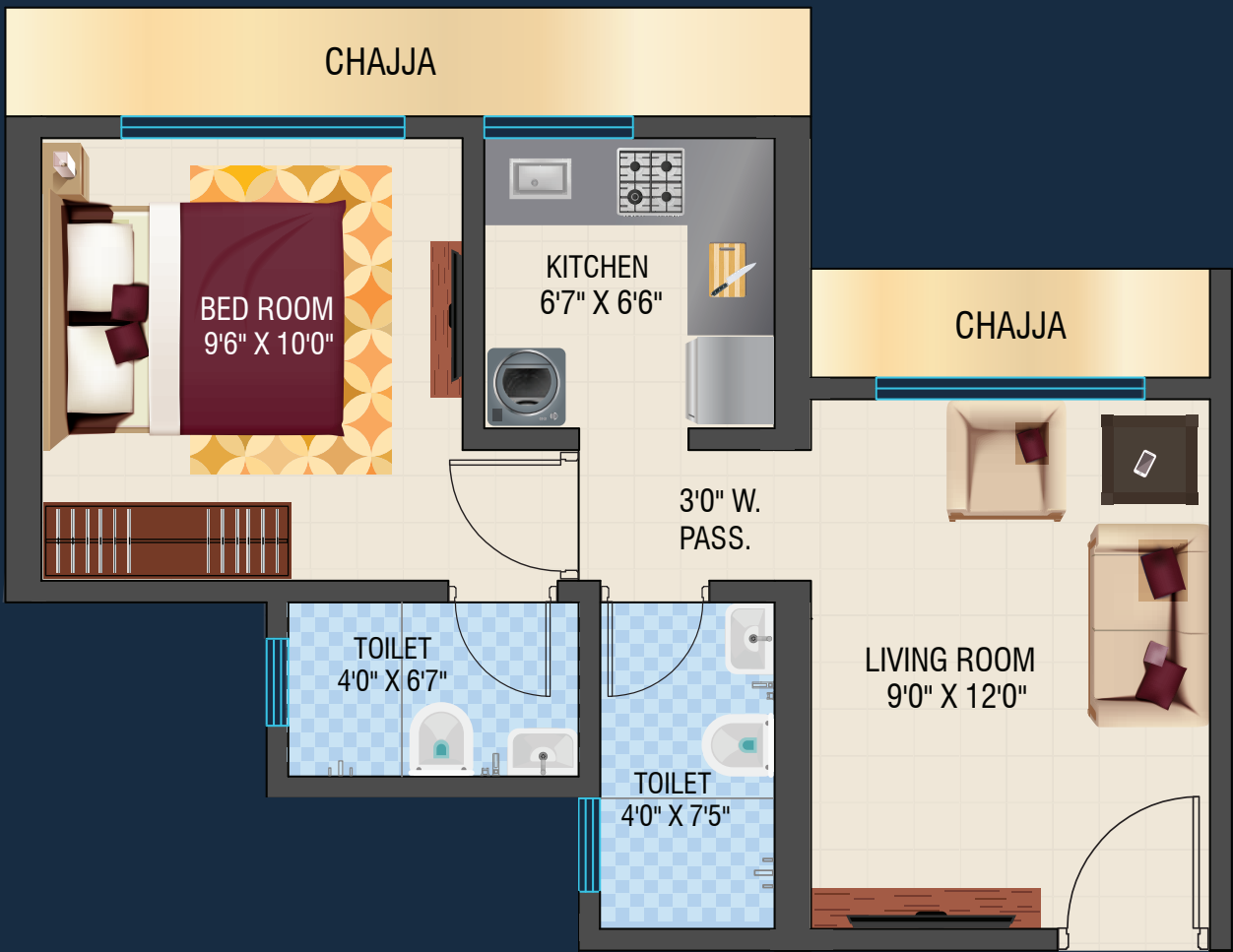

1 BHK	SQ.MT.	SQ.FT.
RERA AREA	32.29	347.56

Plan Disclaimer - "Plan not to scale, for accurate measurement of carpet area, please follow polyline method. The carpet Area is calculated assuming unfinished surfaces and any finishes may reduce the physical area accordingly. Carpet Area may vary by +/- 3% on account of construction or design tolerances."

Disclaimer: The project has been registered via MAHARERA registration number P51700034747 on 28/04/2022 and is available on the website <https://maharera.mahaonline.gov.in> under registered projects. The amenities, specifications, facilities, surrounding infrastructure, stock images and features shown and/or mentioned and the image renders used herein are purely indicative and promotional and may differ from the actuals. The images and other details herein are only indicative. The Developer / Owner reserves the right to change any or all of these in the interest of the development, as per provision of law. Artist's impressions are used to illustrate amenities, specifications, images and other details. Tolerance of +/- 3% is possible in the unit areas on account of design and construction variances. All layouts, plans, specifications, dimensions, designs, measurements and locations are indicative and not to scale and are subject to change as may be required. This printed material does not constitute any form of an agreement and all purchases/leases shall solely be governed by the terms of the agreement for sale /lease. All finishes are subject to change at the discretion of the Interior Designers, in the interest of continual improvement of the project. The Developer / Owner does not warrant or assume any liability or responsibility for the accuracy or completeness of any information contained herein. You are required to verify all the details, including area, amenities, services, terms of sales and payments and other relevant terms independently with the Developer sales team only, by physically visiting the project site and the authorised website of RERA.

UNIT PLAN-1 BHK

BUILDING B | FLAT NOS.

9, 10



1 BHK	SQ.MT.	SQ.FT.
RERA AREA	32.52	350.04

Plan Disclaimer - "Plan not to scale, for accurate measurement of carpet area, please follow polyline method. The carpet Area is calculated assuming unfinished surfaces and any finishes may reduce the physical area accordingly. Carpet Area may vary by +/- 3% on account of construction or design tolerances."

Disclaimer: The project has been registered via MAHARERA registration number P51700034747 on 28/04/2022 and is available on the website <https://maharera.mahaonline.gov.in> under registered projects. The amenities, specifications, facilities, surrounding infrastructure, stock images and features shown and/or mentioned and the image renders used herein are purely indicative and promotional and may differ from the actuals. The images and other details herein are only indicative. The Developer / Owner reserves the right to change any or all of these in the interest of the development, as per provision of law. Artist's impressions are used to illustrate amenities, specifications, images and other details. Tolerance of +/- 3% is possible in the unit areas on account of design and construction variances. All layouts, plans, specifications, dimensions, designs, measurements and locations are indicative and not to scale and are subject to change as may be required. This printed material does not constitute any form of an agreement and all purchases/leases shall solely be governed by the terms of the agreement for sale /lease. All finishes are subject to change at the discretion of the Interior Designers, in the interest of continual improvement of the project. The Developer / Owner does not warrant or assume any liability or responsibility for the accuracy or completeness of any information contained herein. You are required to verify all the details, including area, amenities, services, terms of sales and payments and other relevant terms independently with the Developer sales team only, by physically visiting the project site and the authorised website of RERA.

UNIT PLAN-1 BHK

BUILDING A | FLAT NOS.

4,5,10,11

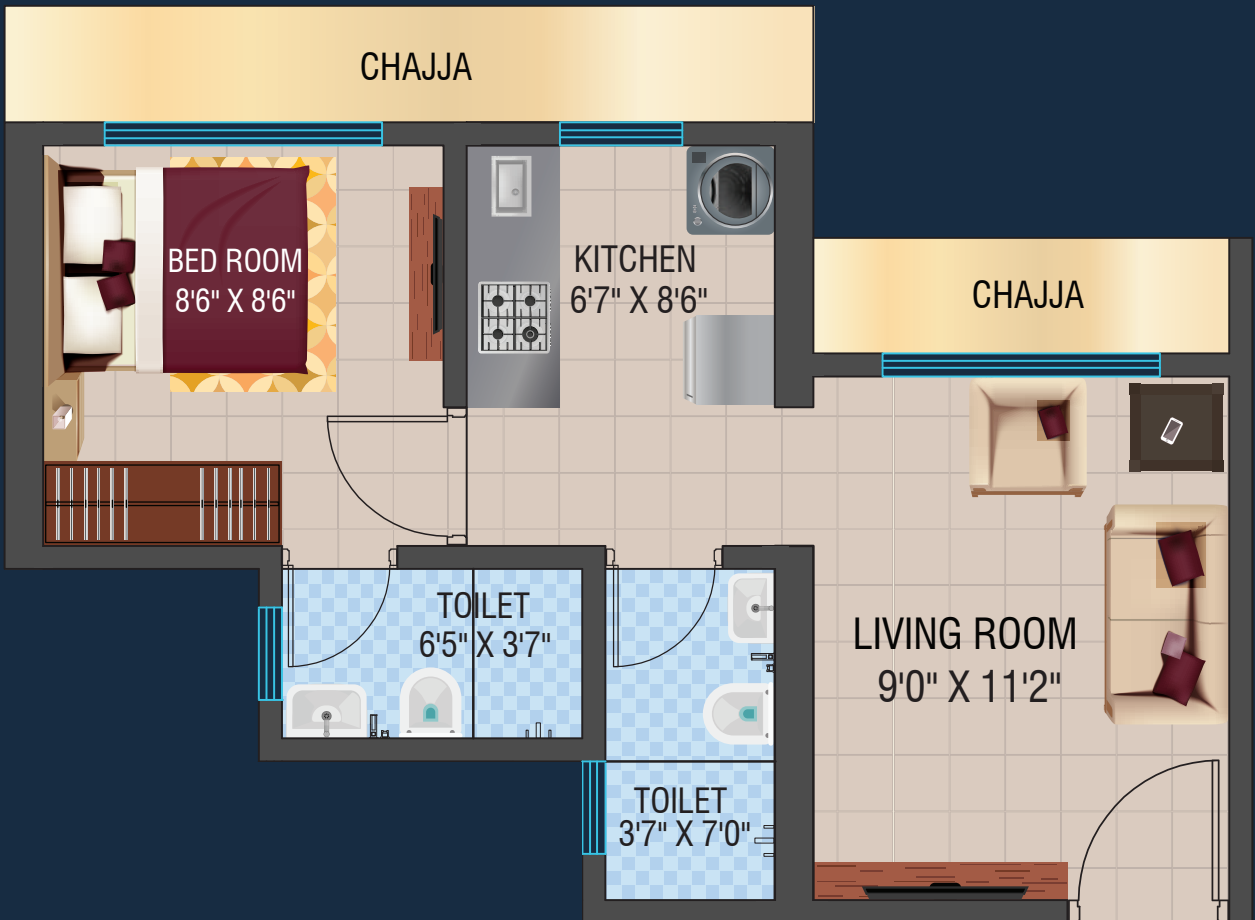

1 BHK	SQ.MT.	SQ.FT.
RERA AREA	27.69	298.05

Plan Disclaimer - "Plan not to scale, for accurate measurement of carpet area, please follow polyline method. The carpet Area is calculated assuming unfinished surfaces and any finishes may reduce the physical area accordingly. Carpet Area may vary by +/- 3% on account of construction or design tolerances."

Disclaimer: The project has been registered via MAHARERA registration number P51700034747 on 28/04/2022 and is available on the website <https://maharera.mahaonline.gov.in> under registered projects. The amenities, specifications, facilities, surrounding infrastructure, stock images and features shown and/or mentioned and the image renders used herein are purely indicative and promotional and may differ from the actuals. The images and other details herein are only indicative. The Developer / Owner reserves the right to change any or all of these in the interest of the development, as per provision of law. Artist's impressions are used to illustrate amenities, specifications, images and other details. Tolerance of +/- 3% is possible in the unit areas on account of design and construction variances. All layouts, plans, specifications, dimensions, designs, measurements and locations are indicative and not to scale and are subject to change as may be required. This printed material does not constitute any form of an agreement and all purchases/leases shall solely be governed by the terms of the agreement for sale /lease. All finishes are subject to change at the discretion of the Interior Designers, in the interest of continual improvement of the project. The Developer / Owner does not warrant or assume any liability or responsibility for the accuracy or completeness of any information contained herein. You are required to verify all the details, including area, amenities, services, terms of sales and payments and other relevant terms independently with the Developer sales team only, by physically visiting the project site and the authorised website of RERA.

UNIT PLAN-1 BHK

BUILDING A | FLAT NOS.

1,2,3,6,7,8,9,12,13,14,15,16,17,18,19,20

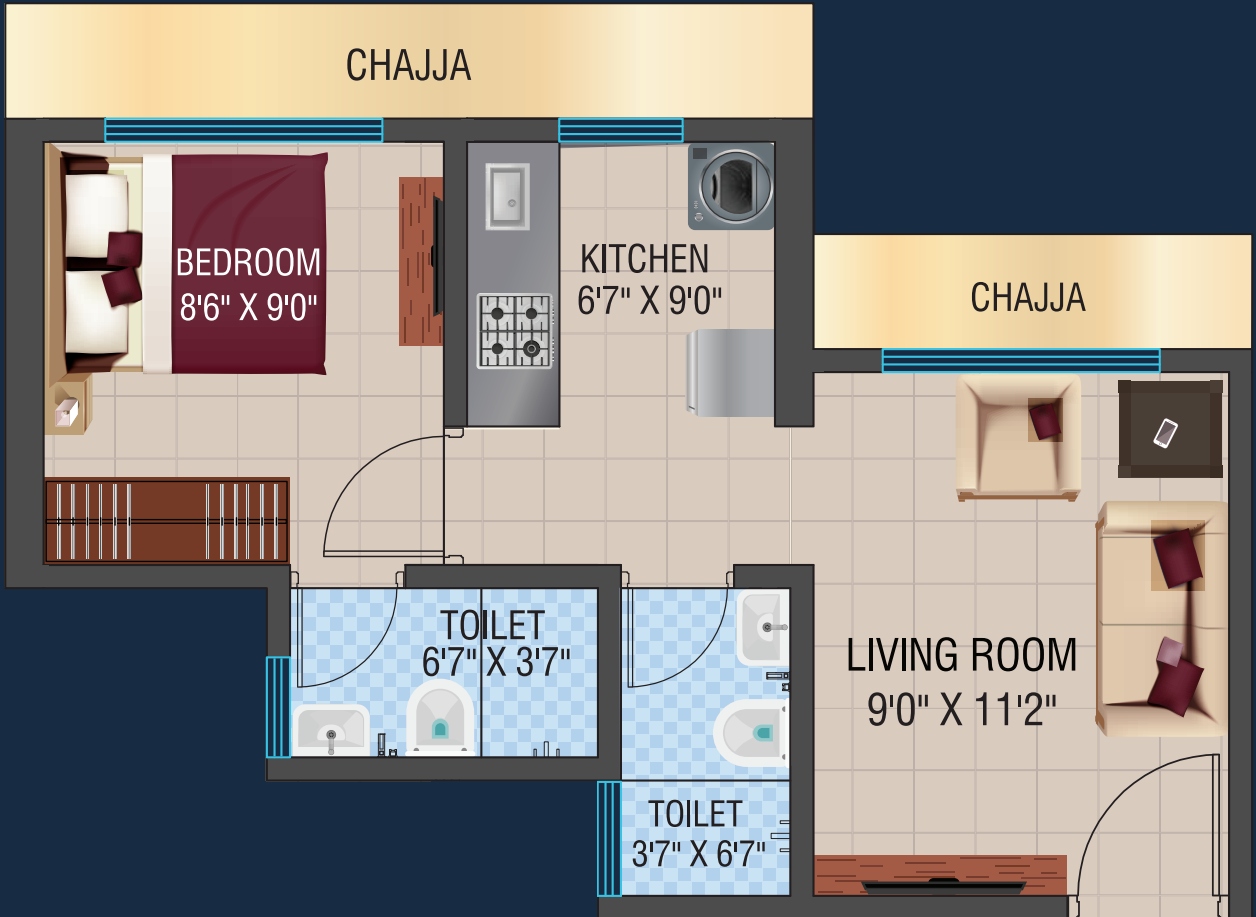

1 BHK	SQ.MT.	SQ.FT.
REERA AREA	28.09	302.36

Plan Disclaimer - "Plan not to scale, for accurate measurement of carpet area, please follow polyline method. The carpet Area is calculated assuming unfinished surfaces and any finishes may reduce the physical area accordingly. Carpet Area may vary by +/- 3% on account of construction or design tolerances."

Disclaimer: The project has been registered via MAHARERA registration number P51700034747 on 28/04/2022 and is available on the website <https://maharera.mahaonline.gov.in> under registered projects. The amenities, specifications, facilities, surrounding infrastructure, stock images and features shown and/or mentioned and the image renders used herein are purely indicative and promotional and may differ from the actuals. The images and other details herein are only indicative. The Developer / Owner reserves the right to change any or all of these in the interest of the development, as per provision of law. Artist's impressions are used to illustrate amenities, specifications, images and other details. Tolerance of +/- 3% is possible in the unit areas on account of design and construction variances. All layouts, plans, specifications, dimensions, designs, measurements and locations are indicative and not to scale and are subject to change as may be required. This printed material does not constitute any form of an agreement and all purchases/leases shall solely be governed by the terms of the agreement for sale /lease. All finishes are subject to change at the discretion of the Interior Designers, in the interest of continual improvement of the project. The Developer / Owner does not warrant or assume any liability or responsibility for the accuracy or completeness of any information contained herein. You are required to verify all the details, including area, amenities, services, terms of sales and payments and other relevant terms independently with the Developer sales team only, by physically visiting the project site and the authorised website of RERA.