



# BRINDAVAN

Live and Breathe with Nature



Rera Reg No : PRM/KA/RERA/1251/310/PR/080223/005693





# Introduction

Nandi Brindavan is the finest residential complex by Nandi Developers in Padmanabha nagar, Bangalore. The interior is designed to ensure maximum comfort by blending functionality with aesthetics. CCTV Cameras around the entrance ensure round-the-clock protection for the residents and have a dedicated play area for kids to explore and evoke their creative skills. It has a spacious deck to entertain family and friends and enjoy the great outdoors by chilling out. This abode is encircled by ample green space to reduce noise pollution and improve air quality, thus promoting a healthy lifestyle. Living in this gated community enhances better neighborhood interactions where you can meet like-minded people and strengthen relationships. Diverse amenities are wrapped in this apartment, like a swimming pool, health club, power backup, and more to provide a lap of luxury within your space. The parking slots are well-allocated to avoid unwanted traffic without bumping passersby, and there will be 24-hour surveillance ensuring a high level of protection for the residents.





NANDI BRINDAVAN

PADMANABHAGAR | BENGALURU

# Content

3 BED 2 BATH / 3 BED 3 BATH RESIDENCES

## Highlights

- Total Land : 1 Acre 4 Guntas .
- Phase- 1 , Towers-1.
- Upto 50% of open Area.
- Grand Entry Gate with Security.
- Recreational Zone.
- Amenity- Podium and Mother Earth Level.
- Situated in heart of the city Bengaluru.



## ELEMENTS OF NATURE

The sheer greenery and elements of nature surrounding the property make it a perfect abode for summer, and all year round. There are beautiful gardens, the experience of staying here, an unparalleled one.





# image of Beautiful lifestyle

NANDI BRINDAVAN

PADMANABHAGAR | BENGALURU

6.015

5.690

3.080

2.140

3200

250

**UNIT 1 - 1650 Sft**  
**FACING - EAST**







**UNIT 2,4,6 - 1660 Sft**  
**FACING - EAST**



# NANDI BRINDAVAN

PADMANABHAGAR | BENGALURU



**UNIT 3,5 - 1600 Sft**  
**FACING - EAST**



# NANDI BRINDAVAN

PADMANABHAGAR | BENGALURU



**UNIT 7- 1550 Sft**  
**FACING - EAST**



# NANDI BRINDAVAN

PADMANABHAGAR | BENGALURU



**UNIT 8- 1550 Sft**  
**FACING - EAST**



# NANDI BRINDAVAN

PADMANABHAGAR | BENGALURU



**UNIT 9- 1520 Sft**  
**FACING - EAST**

# Nandi Brindavan



# NANDI BRINDAVAN

PADMANABHAGAR | BENGALURU



**UNIT 10- 1560 Sft**  
**FACING - EAST**

NANDI  
BRINDHAVAN





# NANDI BRINDAVAN

PADMANABHAGAR | BENGALURU



**UNIT 11- 1950 Sft  
FACING - NORTH**



# NANDI BRINDAVAN

PADMANABHAGAR | BENGALURU



**UNIT 12- 1550 Sft  
FACING- NORTH**



# NANDI BRINDAVAN

PADMANABHAGAR | BENGALURU

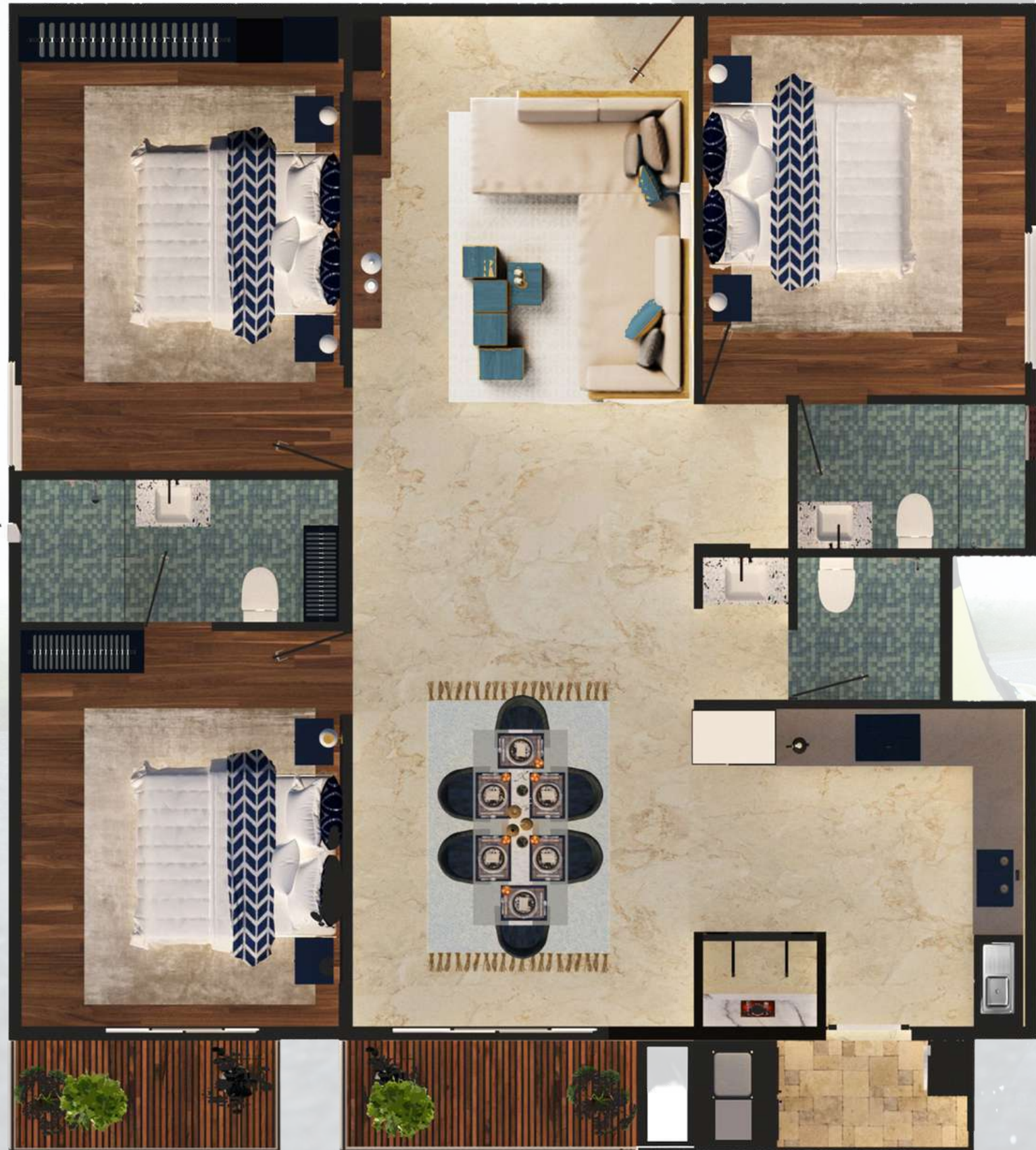

**UNIT 13- 1850 Sft**  
**FACING- NORTH**



# NANDI BRINDAVAN

PADMANABHAGAR | BENGALURU



**UNIT 14- 1700 Sft  
FACING- NORTH**



# NANDI BRINDAVAN

PADMANABHAGAR | BENGALURU

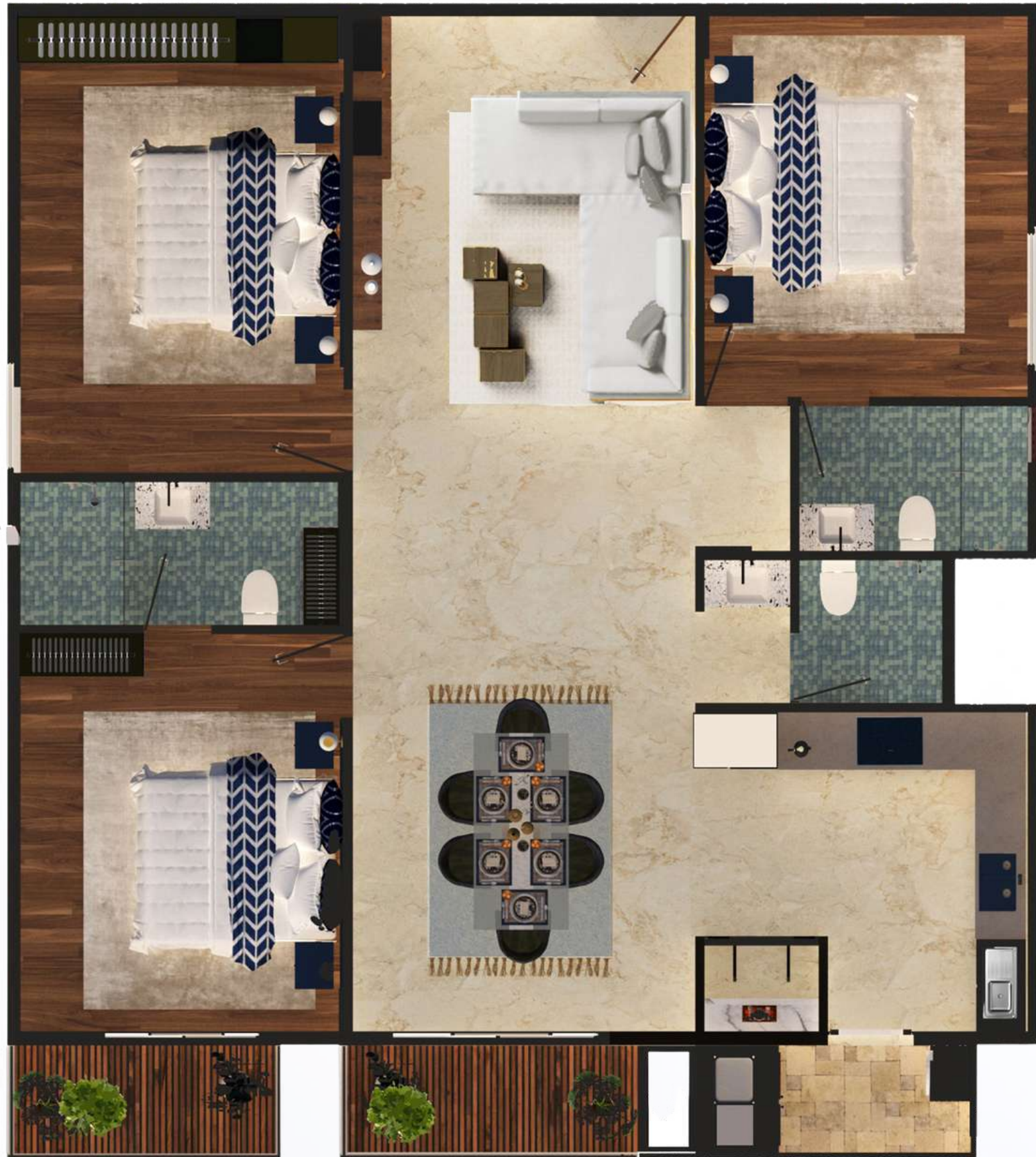

**UNIT 15- 1900 Sft  
FACING- NORTH**



# NANDI BRINDAVAN

PADMANABHAGAR | BENGALURU



**UNIT 16- 1750 Sft**  
**FACING- NORTH**



# NANDI BRINDAVAN

PADMANABHAGAR | BENGALURU



**UNIT 17- 1910 Sft  
FACING- NORTH**



# NANDI BRINDAVAN

PADMANABHAGAR | BENGALURU



**UNIT 18- 1850 Sft**  
**FACING- NORTH**



image slide

NANDI BRINDAVAN

PADMANABHAGAR | BENGALURU



**UNIT 19- 2050 Sft**  
**FACING- NORTH**



# Typical Layout



## Amenities

- Swimming Pool with toddler pool
- walking track with Jogging track
- indoor gym
- childrens play area
- outdoor seating pods
- swing Garden
- Power Backup
- immensce greenary landscape
- intercom with cctv surveillance



# REASONS TO CALL BRINDAVAN YOUR NEW HOME



Strategic location



Exceptional  
Amenities



Open Green Spaces



# SPECIFICATIONS

Masterfully set

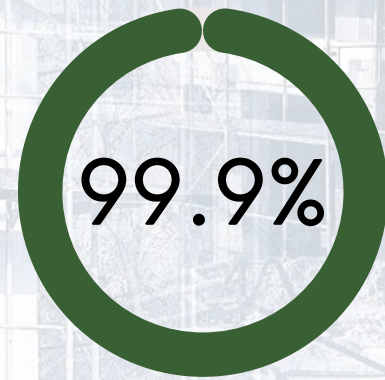

NANDI BRINDAVAN

PADMANABHAGAR | BENGALURU

## STRUCTURE

·1 STILT + 4 STOREY RCC STRUCTURE

## CAR PARKING

·COVERED CAR PARKING IN STILT FLOOR LEVEL

## FOYER /LIVING /DINING

·VITRIFIED / CERAMIC TILE FLOORING AND SKIRTING  
·EMULSION PAINT FOR WALLS AND CEILING

## BEDROOMS

·VITRIFIED / CERAMIC TILE FLOORING AND SKIRTING  
·EMULSION PAINT FOR WALLS AND CEILING

## BATHROOM

·CERAMIC TILE FLOORING  
·CERAMIC WALL TILING UPTO CEILING  
·FALSE CEILING WITH GRID PANNELS (WHEREVER APPLICABLE)

## KITCHEN

·CERAMIC TILE FLOORING  
·2 FT CERAMIC TILE DADOO ON COUNTER TOP.  
·EMULSION PAINT FOR WALLS AND CEILING

## BALCONIES /UTILITIES

· CERAMIC TILE FLOORING  
·GRANITE COPING FOR PARAPET/MS HANDRAIL AS PER DESIGN  
·WETHER PROOF EMULSION FOR CEILING  
·ALL WALLS PAINTED /TEXTURED AS PER THE DESIGN.

## DOMESTIC HELP ROOM

·COMMON DOMESTIC HELP ROOM PROVIDED IN THE STILT FLOOR OF THE COMPLEX  
(WHEREVER APPLICABLE)  
·EMULSION PAINT FOR WALLS AND CEILING

## Plumbing

·Sanitary fixtures of reputed make in all bathrooms  
·Chrome plated fittings in all bathrooms

## Lifts

·2 lifts of 8 passengers' capacity for total wing

cont...



# SPECIFICATIONS

Masterfully set



NANDI Developers takes great pride in delivering international quality standards to its customers. Please find the enclosed specifications for NANDI BRINDAVAN.

While the specifications reflect the high quality standards of Nandi Developers . employs in the project, we would request our customers to note that many of the materials used in the project -including, but not limited to, marble, granite wood etc. Are subject to variation in tone, grain, texture, colour and other aesthetic features, which are beyond our control.

We also request you to note that certain manufactured materials such as ceramic /rectified and vetrified tiles, anodized/powder coated alluminium, sanitary ware, etc.. Are subject to colour variations and this is mostly due to items being manufactured in different lots and due to the inherent manufacturing process . The final product used in the building will therefore be subject to these colour variations. which again is beyond our purview.

NANDI Developers will attempt to minimize variations to specifications, however in case of variation of the same we will not compromise in terms of standard , grade and specification.

## DOMESTIC HELP BATH ROOM

·COMMON DOMESTIC HELP ROOM PROVIDED IN THE STILT FLOOR OF THE COMPLEX (WHEREVER APPLICABLE)

- CERMAIC WALLTILE DADOO UPTO 7FT WALL HEIGHT.
- EMULSION PAINT FOR WALLS AND CEILING AS PER DESIGN.

## STAIRCASE

- CONCRETE THREADS AND RISERS.
- TEXTURED PAINT FOR WALLS
- WETHERPROOF EMULSION PAINT FOR CEILING
- MS HAND RAIL AS PER THE DESIGN

## COMMON AREAS

- CERAMIC TILE /VITRIFIED TILE /GRANITE TILE FLOORING
- CERAMIC TILE CLADDING WHEREEVER APPLICABLE AS PER THE DESIGN
- EMULSION PAINT FOR WALLS AND CEILING AS PER DESIGN
- GRANITE COPING FOR PARAPET/MS HANDRAIL AS PER DESIGN

## JOINERY

### MAIN DOOR/ BEDROOM DOORS

- FRAME- timber
- Architive-timber
- Shutters-with both side HDF Skin

### BATHROOM DOORS:

- FRAME- timber
  - Architive-timber
  - Shutters-with outside HDF and inside laminate / Wood plastic composite panel
- All other external doors to be manufactured in alluminium/UPVC extruded frames and shutter with panels aluminum /upvc glazed windows

## Landscape

- Designer landscaping for common areas.

## Common facilities

- Swimming pool
- Jogging track around the building setback area

## Electrical

### 3BHK Apartment

- Provision for Split Ac in Living and master Bedroom
- BESCOM Power supply 5KW 1 Phase supply
- Standby power of 1Kw for apartments and 100% Backup for common areas.
- Television points in living and master bed room
- Intercom facility from security cabin to each apartment.

NANDI BRINDAVAN

PADMANABHAGAR | BENGALURU



# COMPANY MESSAGE

Be part of Bengaluru's future. Live in a new community that supports your visions, where you can be an innovator and achieve your ambitions. Say hello to your future at Nandi Brindavan.





# Location And its Advantage

#1661/13, 1st MAIN ROAD , BHCS LAYOUT, UTTARAHALLI ROAD- BENGALURU-560061.

Near By Sign Marks : BIPS CCHOOL , KOMARLA BRIGADE , PANTALOONS , NU HOSPITALS



THE LOCATION THAT NEVER FAILS TO AMAZE YOU







# Thank You



GET in TOUCH

[www.prakruthishelters.in](http://www.prakruthishelters.in)

080-26633252 / +91-998655-5523

email:nandibrindavan@gmail.com

   | prakruthishelters

ARCHITECTS & ENGINEERS

SENSCAPE ARCHITECTS

&



Corporate office :

#252,46th cross, Block 8,  
Jayanagar-  
Bengaluru-560082.

Note : The content drawn in this presentation is only on the part of Developer Share .





[www.prakruthishelters.in](http://www.prakruthishelters.in)

