



KG

# IMPRESSIONS

A PICTURE PERFECT LIFE IN MOGAPPAIR

BLOCK E2 - FLOOR PLAN





## BLOCK E2 - 3 BHK ISOMETRIC VIEWS

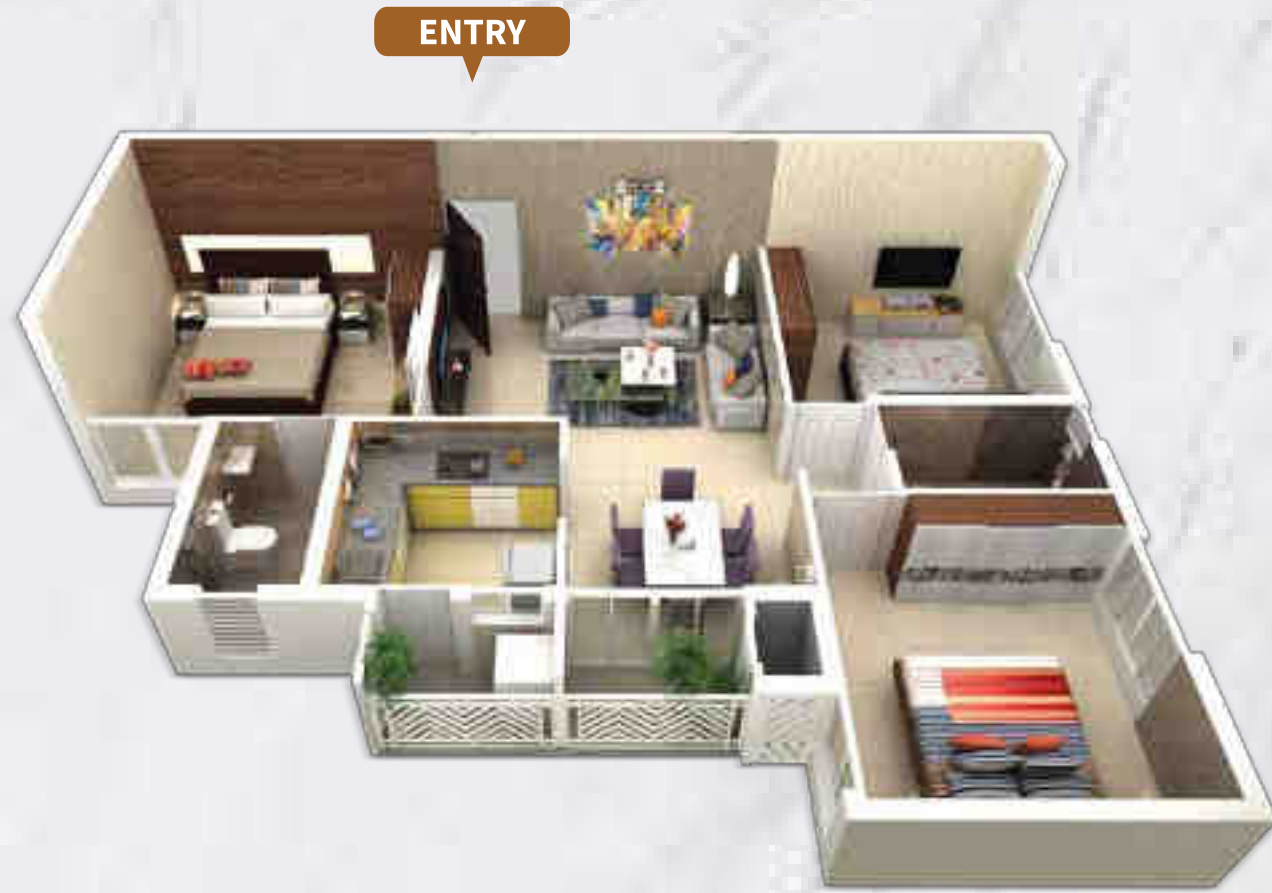

**3 BHK + 2T | 1222 Sq. Ft.**

## BLOCK E2 - 2 BHK ISOMETRIC VIEWS



**2 BHK + 2T | 992 Sq. Ft.**



**3 BHK + 3T | 1334-1412 Sq. Ft.**



**2 BHK + 2T | 1035 Sq. Ft.**



**SITE PLAN**

## PERFECT HIGHLIGHTS



Art Deco Architecture with sustainable development design



Stilt + 15 floors design structure with magnificent city and garden views



390 luxury apartments spread across 3 spacious blocks



11.8 acre project with 70% open space



1 Acre of open green spaces packed with lifestyle and sporty amenities



Over 100+ action packed lifestyle amenities for a picture-perfect life



30,000 Sq.Ft. of indoor amenity space to enhance your lifestyle



5 zones of child-friendly and sporty amenities



Specially designed wheelchair-friendly amenities for senior citizens and the differently abled



Thoughtfully crafted 2 BHK, 3 BHK, 4 BHK Apartments and 4 BHK Duplex Homes with 'Zero Dead Space' Design



Vaastu-compliant homes designed to allow maximum natural air, light, ventilation and positive energy flow



Innovative terrace garden and amenities designed for instant rejuvenation



Highly appreciating project with a beautiful and lively community of 1000+ happy families and 1070 completed apartments



Strategically located, high profile location on the main road with 360° visibility, accessibility and panoramic city views





# BLOCK E2 TYPICAL FLOOR PLAN (1<sup>ST</sup> TO 15<sup>TH</sup> FLOOR)



FLAT NO.	01	02	03	04	05	06	07	08	09	10	11
RERA AREA (SQ.FT.)	904	645	808	924	904	904	904	900	672	876	904
BALCONY AREA + SERVICE VERANDAH (SQ.FT.)	42	37	36	46	42	42	42	42	28	42	42
TOTAL CARPET AREA (SQ.FT.)	946	682	844	970	946	946	946	942	700	918	946
PRIVATE TERRACE AREA (SQ.FT.) (Only for the First Floor Flats)	61	306	52		61	61	61	47	52		61



# EXPERIENCE PICTURE PERFECT LIVING

Welcome to the E2 Block of KG Impressions. Experience picture perfect living in 15 floors of pure extravagance and beauty waiting to floor you! Our thoughtfully and aesthetically designed 100% Vaastu-compliant 2 BHK (992 to 1035 sq.ft) and 3 BHK (1222 to 1412 sq.ft) homes will transform even the most mundane moments into priceless memories.



## PERFECT DESIGN



Ergonomically designed kitchen with triangular functionality between cooking platform, fridge and sink



Ample external ventilation for all bedrooms in all apartments



Apartment interiors designed for functionality and interior aesthetics



Double-sided ventilation for corner apartments



Private terraces for first floor apartments



Privacy ensured for main door of each flat

## PERFECT VAASTU



Southwest Master Bedroom



Headboards in Bedheads in South, East and West



Apartments with South East / North West Kitchens



East facing cooking platform in kitchens

## PERFECT LOCATION



## KG IMPRESSIONS (SIGNATURE TOWERS AT KG SIGNATURE CITY)

SUPPORTED BY ALL LEADING BANKS AND FINANCIAL INSTITUTIONS

**KG FOUNDATIONS (P) LTD.** Marble Arch, Ground Floor, #5, Bishop Wallers Avenue (East), Mylapore, Chennai - 600 004, India. | [sales@kgbuilders.com](mailto:sales@kgbuilders.com) | [www.kgbuilders.com](http://www.kgbuilders.com)

42 years | 180 completed projects | Chennai and Cochin | Over 8000 delighted customers

**99627 24444 | 9014 719 719**

Disclaimer: The information and photographs are for indicative purpose only. While reasonable care has been taken in providing the information, the promoters or their agents cannot be held responsible for any inaccuracies or omissions. The promoters or their agents reserve the right to make alterations and amendments as may be necessitated without prior notice.

RERA NO: TN/02/BUILDING/0393/2021

Scan this code for more details on this project

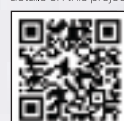

Member  
**CREDAI**

FOLLOW US ON  
@KGFFOUNDATIONS

