

# A Striking Addition to Skyline



CANDEUR  
SIGNATURE

RERA NO: PRM/KA/RERA/1251/446/PR/200121/003217

A FUTURISITIC SIGNATURE COMMUNITY BY CANDEUR CONSTRUCTIONS @ CENTRAL VARTHUR, BENGALURU



CANDEUR  
SIGNATURE

These apartments are uniquely designed with contemporary flair complementing such a destination, and the facilities are designed with relaxation and luxurious indulgence in mind. Discover an impressive variety of leisure amenities. Keep up your exercise routine with a session in the gym or a tennis match. Swim to your heart's content in an exotic pool.

Candeur Signature brings an exciting world of life to you with a mysterious choice of luxuries to enrich your stay.



It's a moment when all you can say is "wow" when you have the first look of such a brilliant creation, The signature is more than just another, it's enriched with elegance and is unmatched to the other present projects of Varthur. The sparkle and the glim, is what which will elucidate the exceptional and bestow an applauding gift to the city.

# A Gesture of Elegant Lifestyle

Your eloquent appearance of life requires an elegant lifestyle. A delightful design for your dream home. The scenic location with lush greenery bestows relaxation. Establish the crafts of an impeccable and unique lifestyle with Candeur Signature.





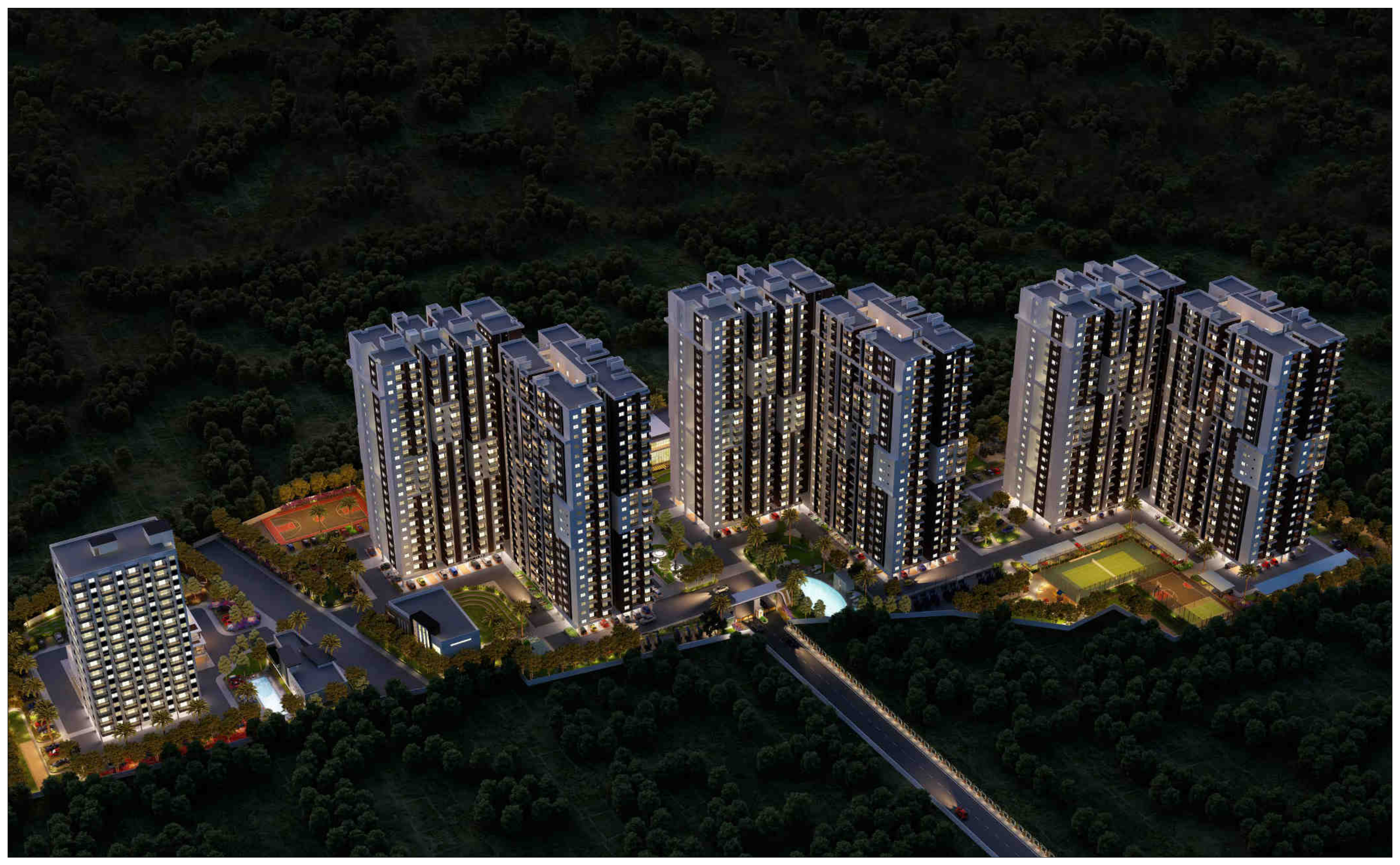



## Signature to Your Enamored Choice

Illuminate ecstatic aura in the serene locality of Candeur Signature. Mark your moments of awestruck by residing in 11.5 acres of community with 25,235 SFT lavish luxury clubhouse.

80% Open Spaces

23 Floors

1232 Units

7 Towers, 4 Blocks

100% Vaastu Compliant



CANDEUR  
SIGNATURE

Comfort that matches your every moment

CANDEUR  
SIGNATURE

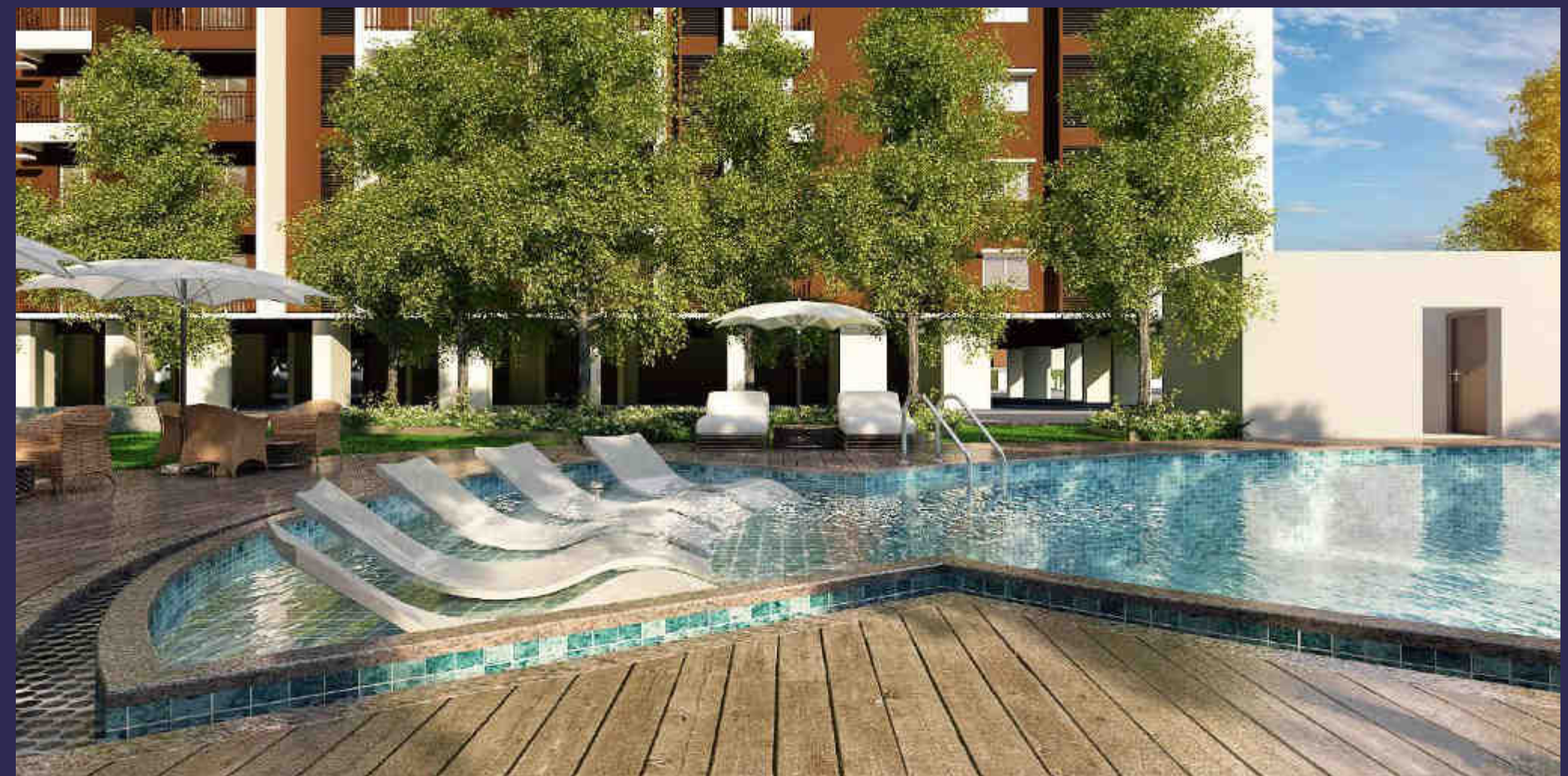
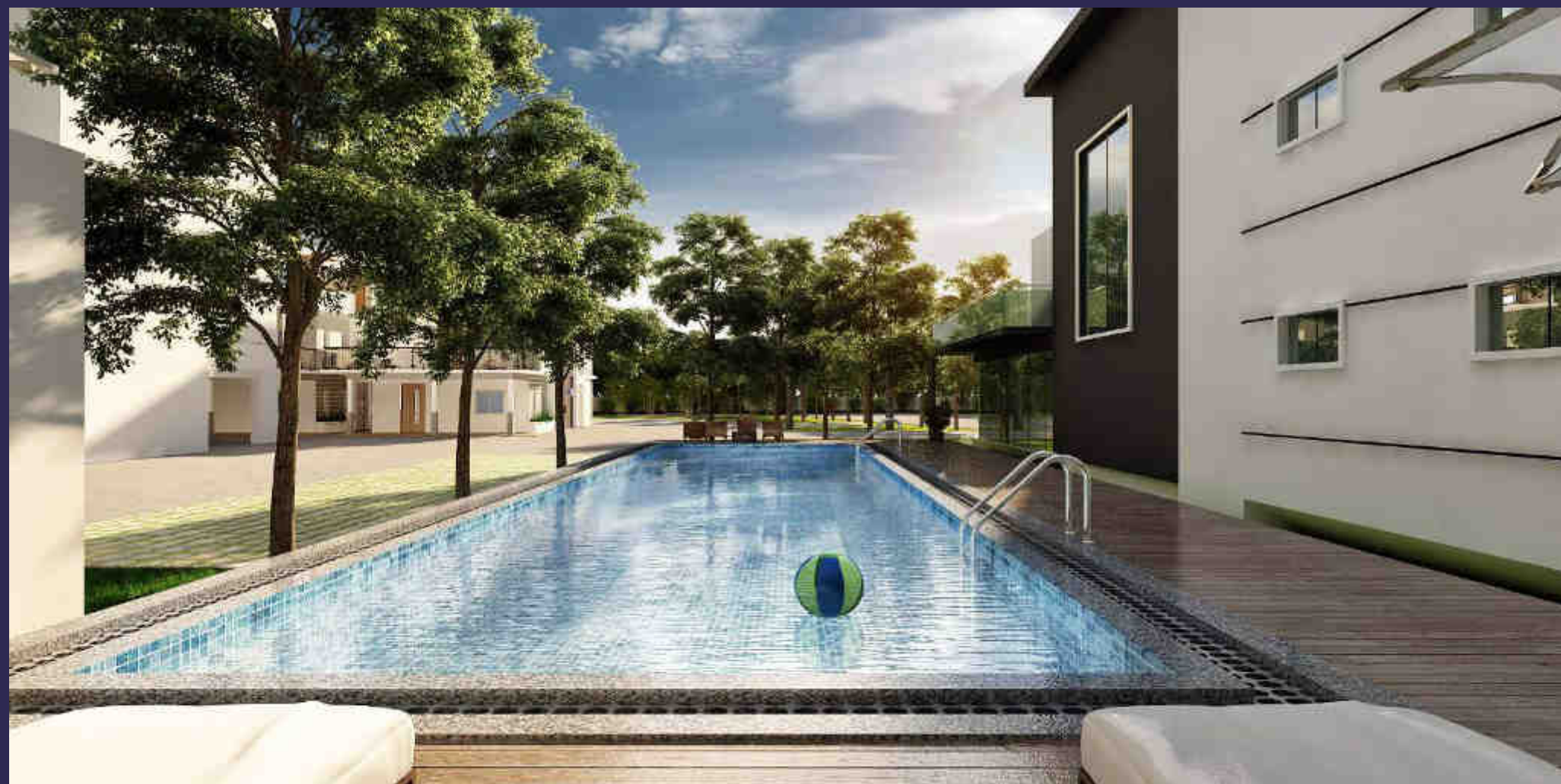
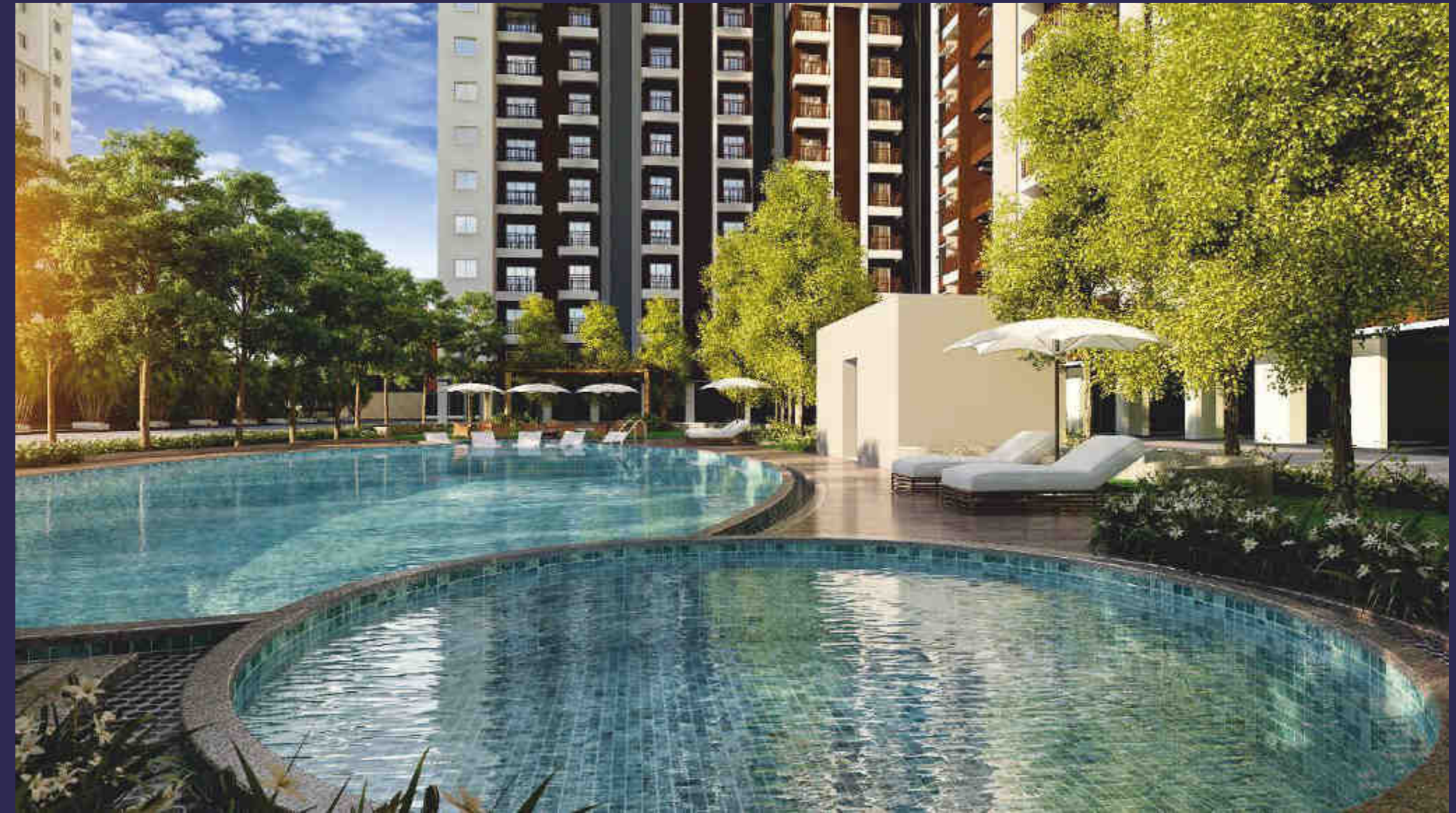
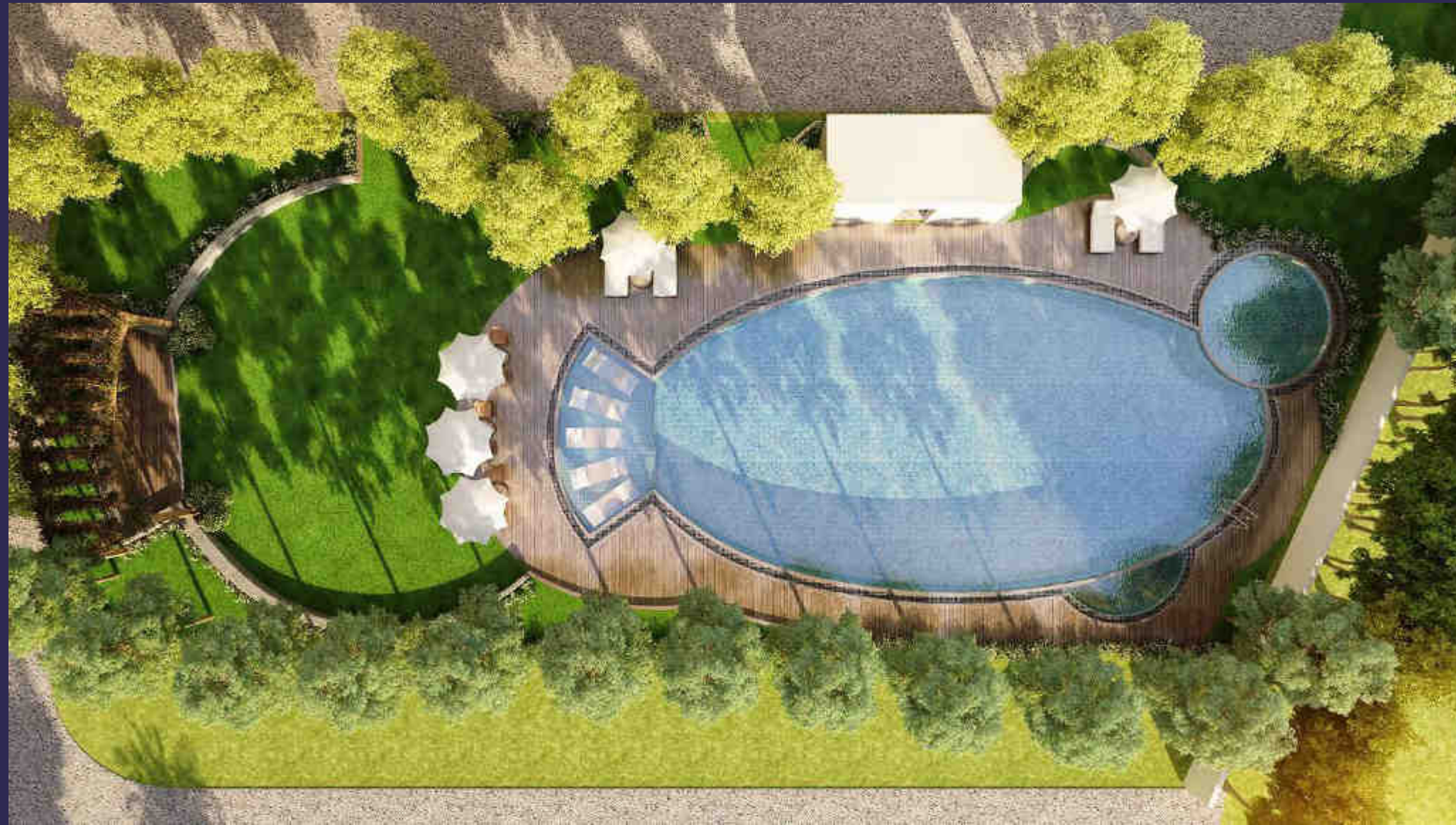

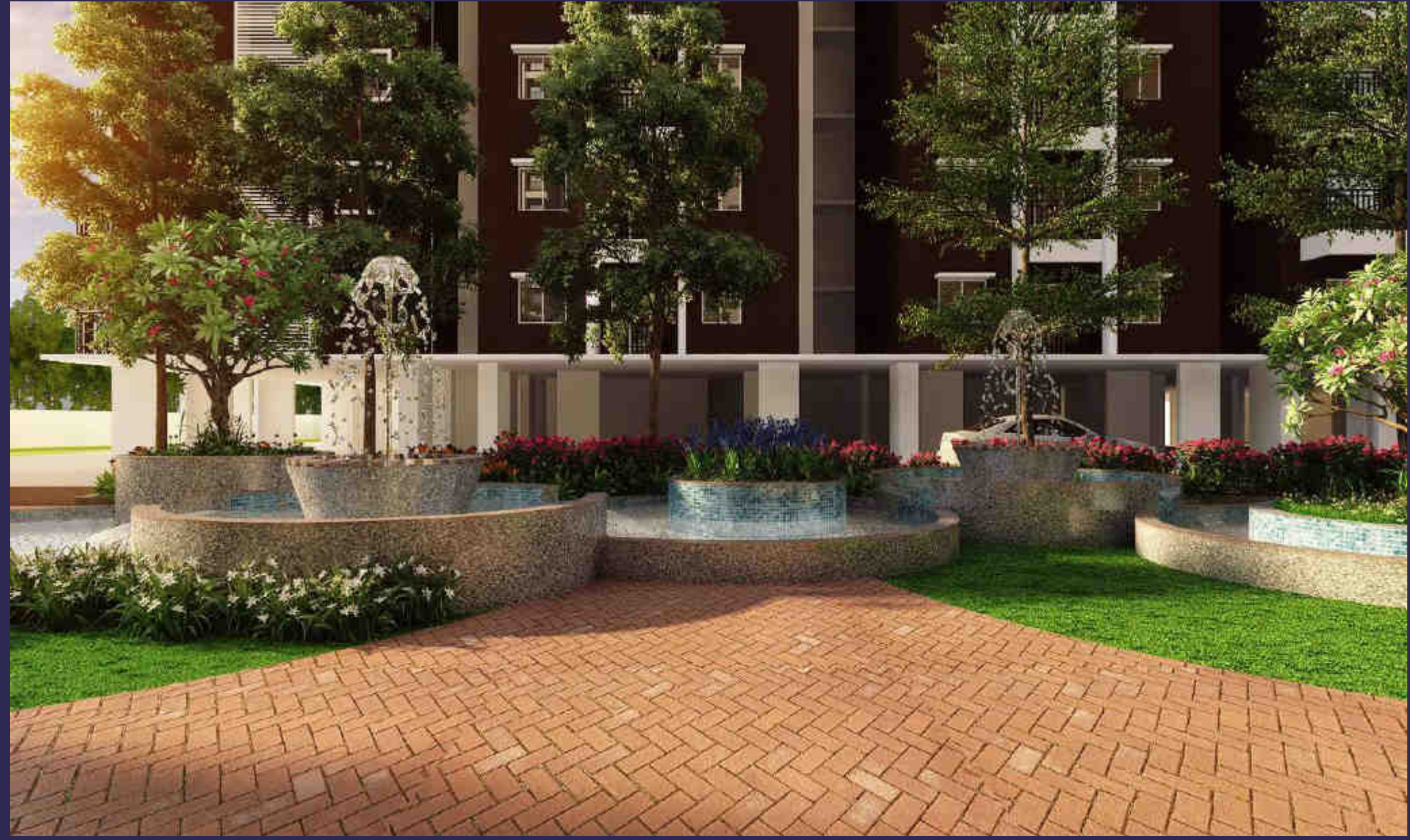

## Connect to the Creative Contour

Comfort is the perfection of home. Our modernized architecture creatively aligned your home with customized comforts. The comfort and interests of you are of paramount importance to us. Your healthy walk, gym, or yoga session now have ample space at the residential community. We add perfection to every aspect of your lifestyle at the Candeur Signature.



# The Architecture of Elite Charm



## Project Features

- |                        |                                     |
|------------------------|-------------------------------------|
| 1. Main Entrance Arch  | 12. Outdoor Amphitheater            |
| 2. Swimming Pools      | 13. Gathering lawn & Seating Area   |
| 3. Poolside Party Area | 14. Outdoor Gym                     |
| 4. Children Play Areas | 15. Skating Rink                    |
| 5. Totlot              | 16. Outdoor Workstation             |
| 6. Club Houses         | 17. Outdoor Cafeteria               |
| 7. Basket ball Court   | 18. Nature walk                     |
| 8. Tennis Court        | 19. Yoga, Aerobic & Meditation lawn |
| 9. Badminton Court     | 20. Water Fountain                  |
| 10. Volleyball Court   | 21. Sculpture Garden                |
| 11. Cricket Pitch      | 22. Theme Gardens                   |



## Clubhouse Features



Clinic



Grocery shop



Multipurpose Hall



Gym



Library



Café



Squash Court



Business Lounge



Board Games Room



Home Theatre



Spa & Saloon



Sauna



Creche



Indoor Badminton Court

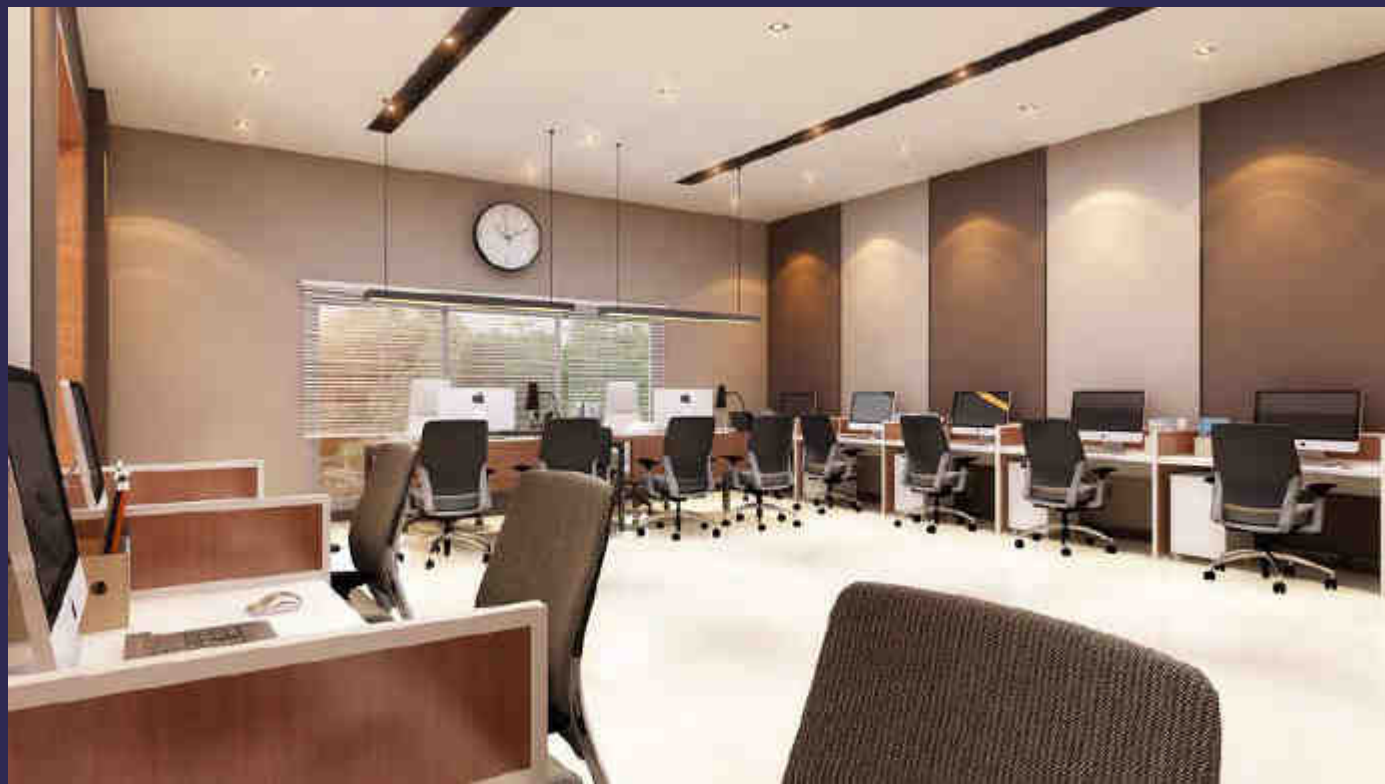

## TOWER - A



# OPAL ( Block - 1 ) Tower A & B (Typical Plan)

Floors	:	23
Total Units	:	368
Variants	:	2 BHK 2.5 BHK 3 BHK



## TOWER - B

# TOWER - C



# QUARTZ (Block - 2) Tower C & D (Typical Plan)

Floors : 23

Total Units : 368

Variants : 2 BHK  
2.5 BHK  
3 BHK



# TOWER - D

TOWER - E

# LARIMAR (Block - 3)

## Tower E & F (Typical Plan)

Floors : 23  
 Total Units : 368  
 Variants : 2 BHK  
 2.5 BHK  
 3 BHK



TOWER - F

# ZIRCON (Block - 4) Tower G (Typical Plan)

Floors : 16

Total Units : 128

Variants : 1 BHK

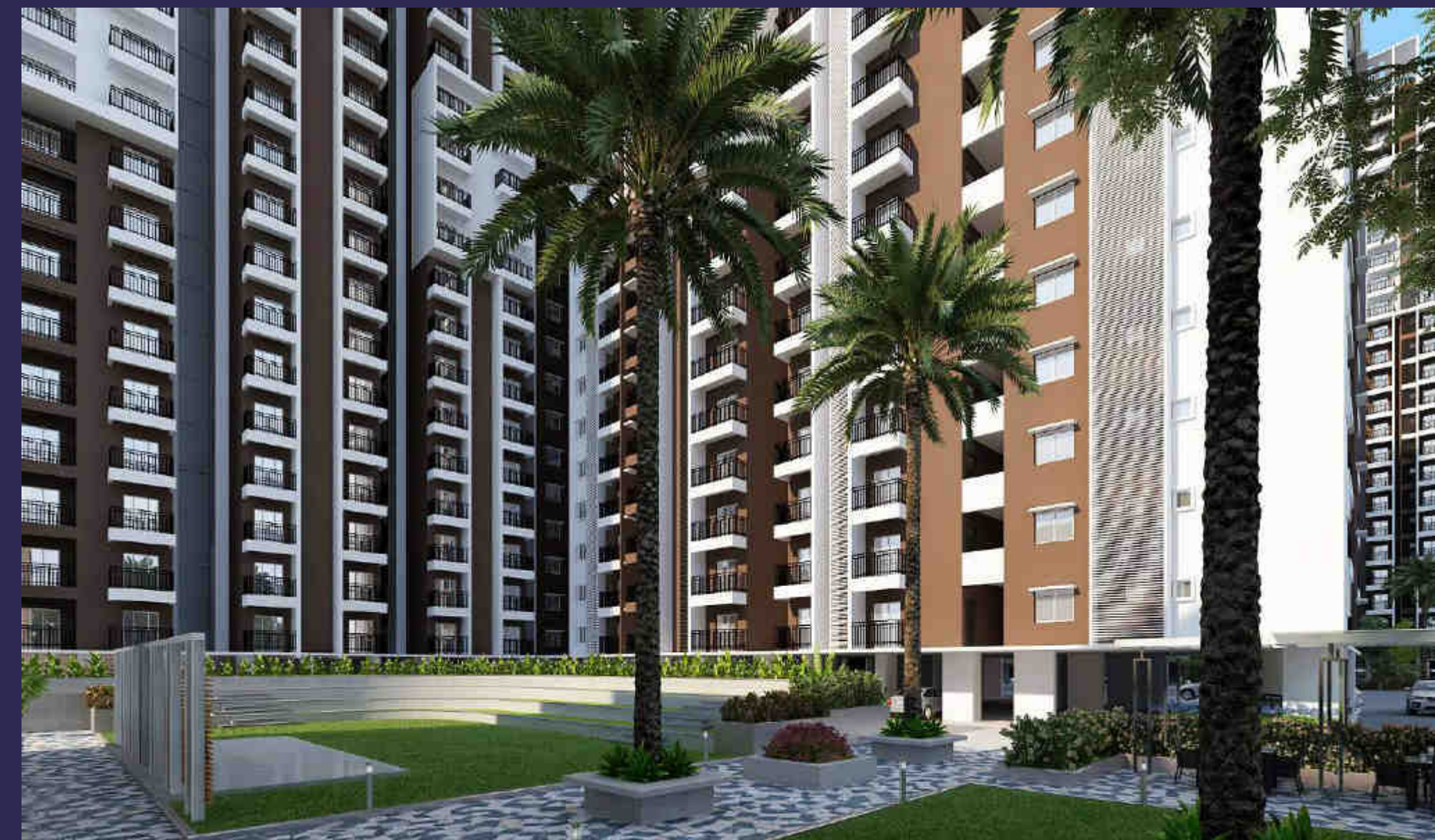

### 3 BHK 1545 East Facing

- Ⓐ Bedroom 11'0" x 11'0"
- Ⓑ Bath 5'0" x 7'4"
- Ⓒ Living 16'4" x 11'0"
- Ⓓ Bedroom 12'0" x 11'0"
- Ⓔ Bath 4'8" x 7'8"
- Ⓕ Utility 10'0" x 4'0"
- Ⓖ Kitchen 10'0" x 8'0"
- Ⓗ Dining 9'4" x 11'0"
- Ⓘ Balcony 4'0" x 10'10"
- Ⓜ Bedroom 13'0" x 12'0"
- Ⓚ Toilet 6'0" x 8'0"
- Ⓛ Balcony 4'0" x 8'4"

Wall Area (Sqft.)	Carpet Area (Sqft.)	Bal/Utility Area (Sqft.)	Built up Area (Sqft.)	Saleable Area (Sqft.)
69.13	967.57	124.62	1161.32	1545



FLATS  
A1, A2, B4, C1, C2, D4 & F4

### 2 BHK 1220 East Facing

- Ⓐ Bedroom 11'0" x 11'6"
- Ⓑ Bath 4'6" x 7'0"
- Ⓒ Living 15'0" x 11'6"
- Ⓓ M Bedroom 11'0" x 13'0"
- Ⓔ Bath 4'6" x 9'4"
- Ⓕ Utility 6'8" x 3'6"
- Ⓖ Kitchen 7'0" x 9'6"
- Ⓗ Dining 8'0" x 13'0"
- Ⓘ Balcony 10'4" x 4'0"
- Ⓛ Balcony 11'2" x 4'0"

Wall Area (Sqft.)	Carpet Area (Sqft.)	Bal/Utility Area (Sqft.)	Built up Area (Sqft.)	Saleable Area (Sqft.)
50.61	750.47	119.41	920.49	1220



FLATS  
A4, C4 & E4

### 2 BHK 1195 West Facing

- Ⓐ Bedroom 10'0" x 11'6"
- Ⓑ Bath 4'6" x 7'0"
- Ⓒ Living 16'0" x 11'6"
- Ⓓ M Bedroom 11'0" x 13'0"
- Ⓔ Bath 4'6" x 9'4"
- Ⓕ Utility 6'8" x 3'6"
- Ⓖ Kitchen 7'0" x 9'6"
- Ⓗ Dining 8'0" x 13'0"
- Ⓘ Balcony 8'0" x 4'0"
- Ⓛ Balcony 8'4" x 4'0"

Wall Area (Sqft.)	Carpet Area (Sqft.)	Bal/Utility Area (Sqft.)	Built up Area (Sqft.)	Saleable Area (Sqft.)
51.28	750.47	98.19	899.94	1195



FLATS  
A3, C3 & E3

### 2 BHK 1105 West Facing

- Ⓐ Bedroom 10'6" x 11'0"
- Ⓑ Bath 4'6" x 8'0"
- Ⓒ Living 11'0" x 15'4"
- Ⓓ M Bedroom 11'0" x 12'0"
- Ⓔ Bath 4'6" x 8'0"
- Ⓕ Utility 3'6" x 8'0"
- Ⓖ Kitchen 7'0" x 8'4"
- Ⓗ Dining 15'4" x 8'0"
- Ⓘ Balcony 8'4" x 4'0"

Wall Area (Sqft.)	Carpet Area (Sqft.)	Bal/Utility Area (Sqft.)	Built up Area (Sqft.)	Saleable Area (Sqft.)
52.64	709.45	65.01	827.1	1105



FLATS  
A5, C5 & E5



## 2.5 BHK 1450 North Facing

- A Bedroom 10'0" x 11'0"
- B Bath 4'6" x 8'6"
- C Living 11'0" x 16'4"
- D M Bedroom 11'0" x 13'0"
- E Bath 4'10" x 8'6"
- F Utility 4'0" x 8'8"

- G Kitchen 8'6" x 8'6"
- H Dining 15'8" x 9'6"
- I Balcony 9'0" x 4'0"
- J Balcony 6'0" x 9'6"
- K Bedroom 11'4" x 11'0"

Wall Area (Sqft.)	Carpet Area (Sqft.)	Bal/Utility Area (Sqft.)	Built up Area (Sqft.)	Saleable Area (Sqft.)
59.09	892.97	135.63	1087.69	1450

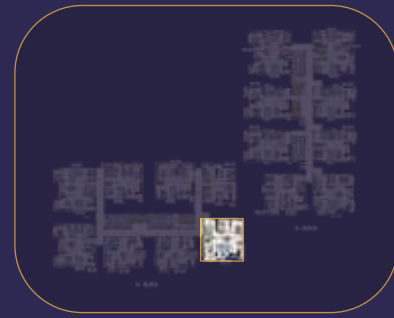

FLATS  
A6, C6 & E6

## 2.5 BHK 1380 East Facing

- A Bedroom 10'4" x 11'0"
- B Bath 7'0" x 4'0"
- C Living 11'0" x 15'4"
- D M Bedroom 11'0" x 13'0"
- E Bath 5'0" x 8'0"
- F Utility 7'0" x 4'0"

- G Kitchen 7'4" x 9'0"
- H Dining 8'0" x 13'4"
- I Balcony 8'0" x 4'0"
- J Balcony 9'0" x 4'0"
- K Bedroom 10'0" x 11'0"

Wall Area (Sqft.)	Carpet Area (Sqft.)	Bal/Utility Area (Sqft.)	Built up Area (Sqft.)	Saleable Area (Sqft.)
61.89	872.09	102.26	1036.24	1380



FLATS  
B1

## 2 BHK 1120 North Facing

- A Bedroom 11'0" x 11'0"
- B Bath 7'4" x 4'8"
- C Living 14'6" x 11'4"
- D M Bedroom 11'0" x 13'0"
- E Bath 5'0" x 8'0"
- F Utility 3'6" x 8'0"

- G Kitchen 7'6" x 8'0"
- H Dining 8'6" x 10'0"
- I Balcony 8'6" x 4'0"
- J Balcony 8'0" x 4'0"

Wall Area (Sqft.)	Carpet Area (Sqft.)	Bal/Utility Area (Sqft.)	Built up Area (Sqft.)	Saleable Area (Sqft.)
53.17	686.09	101.72	840.98	1120

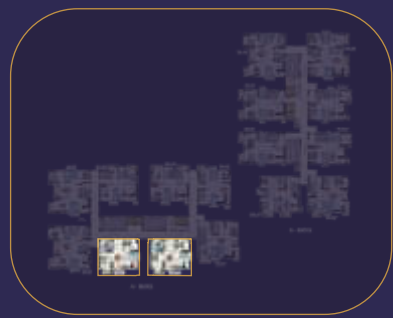

FLATS  
A7, A8, C7, C8, E7 & E8

## 2 BHK 1260 East Facing

- A Bedroom 12'0" x 11'0"
- B Bath 5'0" x 7'8"
- C Living 16'0" x 11'0"
- D M Bedroom 12'0" x 13'0"
- E Bath 5'0" x 8'0"
- F Utility 7'8" x 4'0"

- G Kitchen 7'11" x 9'0"
- H Dining 8'0" x 13'0"
- I Balcony 4'0" x 8'2"
- J Balcony 4'0" x 8'2"

Wall Area (Sqft.)	Carpet Area (Sqft.)	Bal/Utility Area (Sqft.)	Built up Area (Sqft.)	Saleable Area (Sqft.)
56.62	788.13	102.26	947.01	1260



FLATS  
B2, B3, D2, D3, F2 & F3

### 3 BHK 1520 West Facing

- A Bedroom 11'0" x 11'0"
- B Bath 5'0" x 7'4"
- C Living 16'4" x 11'0"
- D M Bedroom 13'0" x 12'0"
- E Bath 6'0" x 8'0"
- F Utility 4'0" x 7'2"
- G Kitchen 9'0" x 8'4"
- H Dining 12'4" x 9'8"
- I Balcony 4'0" x 8'2"
- J Balcony 4'0" x 8'4"
- K Bedroom 12'0" x 11'0"
- L Bath 5'0" x 8'0"

Wall Area (Sqft.)	Carpet Area (Sqft.)	Bal/Utility Area (Sqft.)	Built up Area (Sqft.)	Saleable Area (Sqft.)
6491	971.98	101.18	1138.07	1520



### 2.5 BHK 1360 North Facing

- A Bedroom 10'0" x 11'0"
- B Bath 4'0" x 8'0"
- C Living 11'0" x 15'10"
- D M Bedroom 11'0" x 12'6"
- E Bath 4'10" x 8'0"
- F Utility 4'0" x 8'2"
- G Kitchen 8'0" x 8'0"
- H Dining 15'8" x 9'0"
- I Balcony 8'2" x 4'0"
- J Balcony 5'0" x 9'0"
- K Bedroom 10'4" x 11'0"

Wall Area (Sqft.)	Carpet Area (Sqft.)	Bal/Utility Area (Sqft.)	Built up Area (Sqft.)	Saleable Area (Sqft.)
58.13	846.37	117.33	1021.82	1360



### 2.5 BHK 1425 East Facing

- A Bedroom 10'4" x 12'0"
- B Bath 7'0" x 4'0"
- C Living 11'0" x 16'4"
- D M Bedroom 11'0" x 13'0"
- E Bath 5'0" x 8'0"
- F Utility 7'0" x 4'0"
- G Kitchen 7'4" x 9'0"
- H Dining 8'0" x 13'4"
- I Balcony 8'0" x 4'0"
- J Bedroom 10'0" x 12'0"
- K Balcony 9'0" x 4'0"

Wall Area (Sqft.)	Carpet Area (Sqft.)	Bal/Utility Area (Sqft.)	Built up Area (Sqft.)	Saleable Area (Sqft.)
62.86	904.60	102.26	1069.72	1425

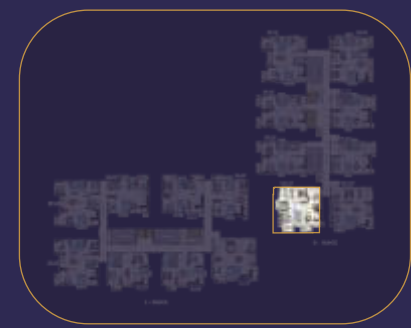

### 2 BHK 1140 North Facing

- A Bedroom 10'0" x 11'0"
- B Bath 4'6" x 7'0"
- C Living 15'10" x 11'0"
- D M Bedroom 11'0" x 13'0"
- E Bath 4'6" x 8'0"
- F Utility 6'8" x 4'0"
- G Kitchen 7'0" x 9'0"
- H Dining 7'10" x 13'0"
- I Balcony 4'0" x 11'0"

Wall Area (Sqft.)	Carpet Area (Sqft.)	Bal/Utility Area (Sqft.)	Built up Area (Sqft.)	Saleable Area (Sqft.)
54.57	726.67	74.27	855.52	1140



### FLATS B8



### FLATS D1 & F1



## 2.5 BHK 1405 North Facing

- Ⓐ Bedroom 10'0" x 12'0"
- Ⓑ Bath 4'0" x 8'0"
- Ⓒ Living 11'0" x 16'10"
- Ⓓ M Bedroom 11'0" x 12'6"
- Ⓔ Bath 4'10" x 8'0"
- Ⓕ Utility 4'0" x 8'0"
- Ⓖ Kitchen 8'0" x 8'0"
- Ⓗ Dining 15'8" x 9'0"
- Ⓘ Balcony 5'0" x 9'0"
- Ⓚ Bedroom 10'4" x 12'0"
- Ⓛ Balcony 8'2" x 4'0"

Wall Area (Sqft.)	Carpet Area (Sqft.)	Bal/Utility Area (Sqft.)	Built up Area (Sqft.)	Saleable Area (Sqft.)
59.09	878.98	117.33	1055.4	1405



FLATS  
D8 & F8

## 1 BHK 615 East Facing

- Ⓐ Bedroom 11'6" x 10'0"
- Ⓑ Bath 8'0" x 4'0"
- Ⓒ Living & Dining 11'6" x 12'0"
- Ⓓ Foyer 8'0" x 4'0"
- Ⓔ Kitchen 8'0" x 7'8"
- Ⓛ Balcony 2'6" x 10'0"

Wall Area (Sqft.)	Carpet Area (Sqft.)	Bal/Utility Area (Sqft.)	Built up Area (Sqft.)	Saleable Area (Sqft.)
40.36	394.82	26.91	462.09	615



FLATS  
G1, G2, G3 & G4

## 3 BHK 1590 East Facing

- Ⓐ Bedroom 11'0" x 11'0"
- Ⓑ Bath 4'10" x 7'4"
- Ⓒ Living 11'0" x 16'4"
- Ⓓ M Bedroom 13'0" x 12'0"
- Ⓔ Bath 8'0" x 6'0"
- Ⓚ Utility 10'0" x 4'0"
- Ⓖ Kitchen 10'0" x 8'0"
- Ⓗ Dining 9'4" x 11'0"
- Ⓘ Balcony 10'10" x 4'0"
- Ⓚ Bedroom 12'0" x 11'0"
- Ⓛ Balcony 4'0" x 12'2"
- Ⓛ Bath 4'8" x 7'4"

Wall Area (Sqft.)	Carpet Area (Sqft.)	Bal/Utility Area (Sqft.)	Built up Area (Sqft.)	Saleable Area (Sqft.)
66.74	984.9	138.85	1190.49	1590



FLATS  
E1 & E2

## 1 BHK 615 West Facing

- Ⓐ Bedroom 11'6" x 10'0"
- Ⓑ Bath 8'0" x 4'0"
- Ⓒ Living & Dining 11'6" x 12'0"
- Ⓓ Foyer 8'0" x 4'0"
- Ⓔ Kitchen 8'0" x 7'8"
- Ⓛ Balcony 2'6" x 10'0"

Wall Area (Sqft.)	Carpet Area (Sqft.)	Bal/Utility Area (Sqft.)	Built up Area (Sqft.)	Saleable Area (Sqft.)
40.36	394.82	26.91	462.09	615



FLATS  
G5, G6, G7 & G8

# Specifications

---

## FRAMED STRUCTURE

RCC framed structure to withstand wind & seismic loads.

## SUPER STRUCTURES

6" thick bricks / first class Solid Brick / Porotherm Brick Masonry in Cement Mortar  
4" thick bricks.

## DOORS

**Main Door frame:** Best Quality Teak Wood frame with veneer finish.

**Main Door Shutter:** Hard wood with veneer finish.

**Internal Door Frame:** Best Quality Hardwood door frame with veneer finish.

**Internal Door Shutter:** BWP Grade Best Quality Hardwood door with veneer finish.

**French Doors:** UPVC door systems with sliding shutters & provision for mosquito mesh track.

**Windows:** UPVC door systems with sliding shutters & provision for mosquito mesh track.

## PAINTING

**External:** Finish with two coats of exterior emulsion paint with architectural features.

**Internal:** Smooth wall putty finish with two coats of premium acrylic emulsion paint of best brands over a coat of primer.

## FLOORING

**Living, Dining, Bedroom & Kitchen:** 600mmx600mm double charged vitrified tiles.

**Bathrooms:** Acid resistant, Anti-skid ceramic tiles.

**Corridors:** Vitrified tiles flooring.

**Balconies:** Anti-skid vitrified tiles

**Ground Floor Lobby:** Granite Flooring.

## TILE CLADDING

**Bathrooms:** Glazed ceramic tile dado up to 7' height.

## KITCHEN

- Provision for fixing of water RO system, exhaust fan & chimney.
- **Utilities/Wash:** Washing machine provision in utility area.

## BATHROOMS

- Provision for geysers in all bathrooms.
- All C.P fitting are chrome plated (Jaguar or equivalent).
- **Sanitary:** Jaguar or equivalent.

## ELECTTRICAL

- Concealed Copper Wiring (Polycab or KEI or equivalent).
- Air conditioners point
  - 3 BHK, 2 POINTS
  - 2.5 BHK, 2 POINTS
  - 2 BHK, 2 POINTS
  - 1 BHK, 1 POINT
- Power outlets for geysers in all bathrooms.
- Power plugs for cooking range chimney, refrigerators, microwave ovens, mixer/grinders in kitchen.
- Elegant designer modular electrical switches of ANCHOR or equivalent.

## TELECOM

- Provision for Telephone points, Internet, DTH.
- Intercom facility to all the units connecting Security.

**CABLE TV:** Provision for cable connection in Master Bedroom & Living room.

## LIFTS

Two high speed automatic passenger lifts with rescue device for energy efficiency, and one service lift in each tower (make of/Johnson/Kone/equivalent).

## WTP & STP

- Fully treated water made available through exclusive water softening & purification plants for each unit.
- A Sewage Treatment plant of adequate capacity as per norms will be provided inside the project; treated sewage water will be used for the landscaping & flushing purpose.

**GENERATOR:** 100% DG set backup for common area and 1KV for each unit.

## SECURITY / BMS

- Sophisticated round-the-clock security system.
- Panic button and intercom is provided in the lifts connected to the security room.
- Surveillance cameras at the main security & entrance of each block to monitor.
- Separate rooms for associations, maintenance, and servant toilets

# Conventional to Comfortable Lifestyle



# Connect with Creative Space



## NEARBY EDUCATIONAL INSTITUTIONS

- + Gear International
- + Vibgyor, Chrysalis
- + TISB, Oakridge
- + Green Wood High
- + Indian Global International
- + DPS
- + Krupanidhi College
- + SGR Dental College
- + New Horizon College of Eng. & Gurukul School



## TIMELY HEALTHCARE

- + Columbia Asia Hospital
- + Vydehi Institute of Medical Sciences
- + Yashomati Hospital
- + Sankara Netralaya
- + Sakra World Hospital



## ENTERTAINMENT / RETAIL

- + Virgina Mall
- + Forum Value Mall
- + Bangalore Central
- + Hope Farm Circle
- + Phoenix Mall
- + Total Mall
- + Marathahalli Junction
- + Innovative Multiplex
- + Park Square Mall



## EASY CONNECTIVITY

- + Equidistant from City Centre and International Airport
- + Bellandur Railway Station
- + K.R. Puram Railway Station
- + Outer Ring Road (ORR)
- + Carmelaram Railway Station



## CLOSE TO IT HUBS

- + Many Tech Parks in the neighbouring Marathahalli, Bellandur, Whitefield and ITPL
- + Prestige Tech Park II
- + Embassy Tech Village
- + Sigma Tech Park
- + RMZ Ecospace
- + Pritech Park
- + Cessna Tech Park



# Location Plan

(Not to Scale)





*Corporate Office:*

183/1A, 183/1B, Gunjur Main Road,  
Next to Vinayaka Theatre, Varthur,  
Bangalore-560087.

*Site Address*

**Candeur Signature**

Sy No. 219/1(P), 219/6A, 219/6B,  
224/2, 226/1(P), 227/1(P),  
Gunjur Village, Varthur Hobli,  
Bangalore East Taluq, Ward No. 149.

Call: +91 6364718222, 6364736333

Mail: [info@candeursignature.com](mailto:info@candeursignature.com)  
[sales@candeursignature.com](mailto:sales@candeursignature.com)

Web: [www.candeursignature.com](http://www.candeursignature.com)