

**DNR**



Art of Building Spaces

Premium Plotted Development  
at Devanahalli, Bengaluru



**DNR SOLACE**

DEVANAHALLI, BENGALURU

# Project Profile

Extent of the Land: 30 Acres

Clubhouse + Amenities : 35,000 sqft

Total Number of Plots: 432

## Types of Plots

30 X 40 sqft. - 63 Plots

30 X 45 sqft. - 24 Plots

30 X 50 sqft. - 269 Plots

30 X 60 sqft. - 3 Plots

40 X 50 sqft. - 20 Plots

Odd Sites - 52 Plots



## Beyond DNR Solace: Your Neighborhood Unveiled

DNR Solace's strategic location is your gateway to a world of convenience. Our location map showcases the proximity of DNR Solace to key landmarks and destinations. Whether it's the ease of reaching the international airport in just 15 minutes or the accessibility to major tech parks within a 40-minute drive, Solace's central location ensures you're always well-connected to the city.

# Unveiling Our Visionary Master-plan: Crafting the Blueprint for Exceptional Living

Our visionary master-plan is a testament to our commitment to crafting an environment where every facet of life is elevated. We believe that the foundation of exceptional living lies in thoughtful planning, and our master-plan is the blueprint for realizing this vision.

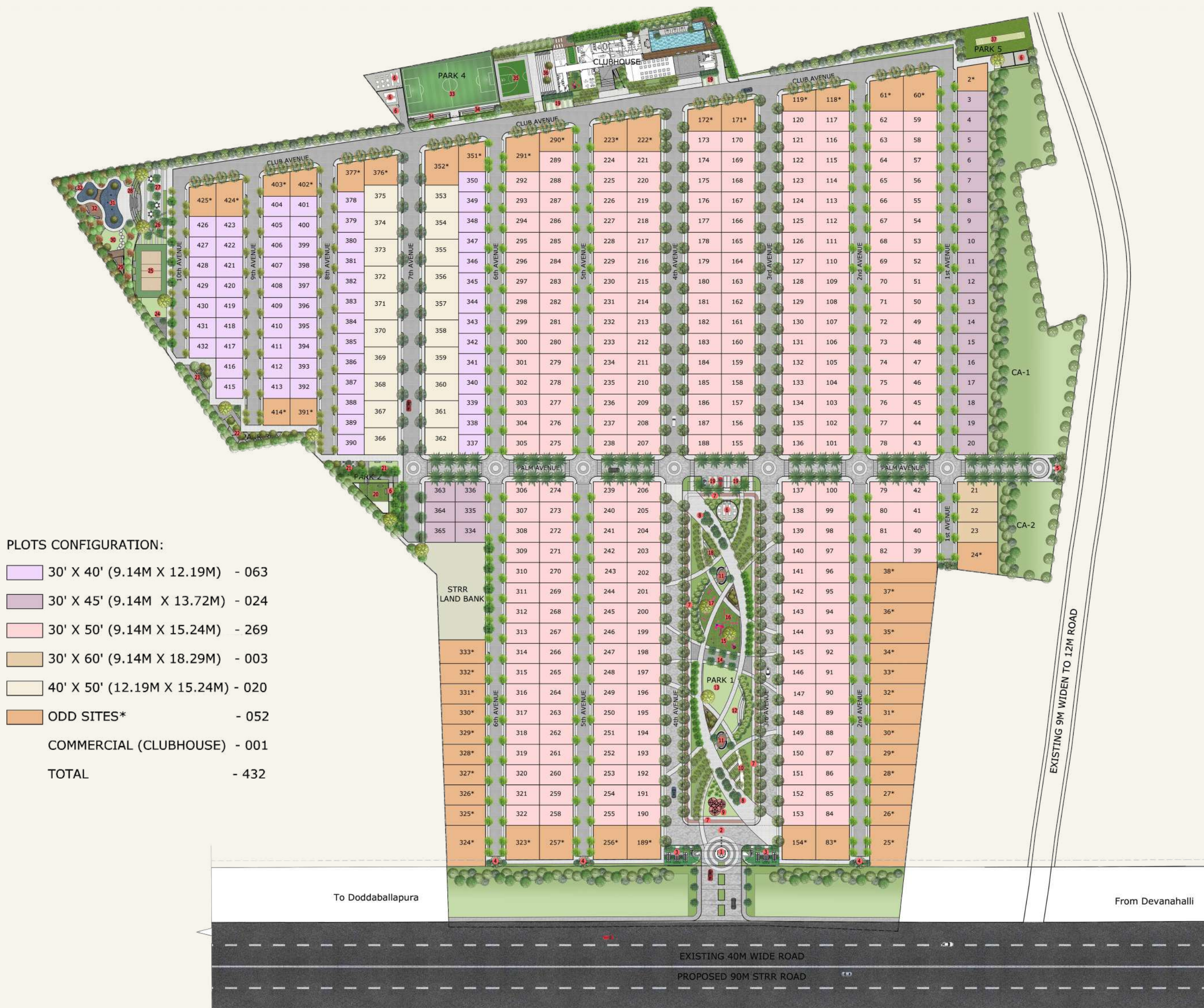

# Celebrating Elevated Living



## Corporate Office

### DNR Corporation Pvt. Ltd.

304, 'A' Wing, Queen's Corner  
# 3, Queens Rd, Bengaluru 560001  
Phone : +91 80 222 68786  
Phone : +91 80 222 65647  
Email : [info@dnrgroup.in](mailto:info@dnrgroup.in)  
[www.dnrgroup.in](http://www.dnrgroup.in)



**DNR SOLACE**  
DEVANAHALLI, BENGALURU

## Site Address

### DNR Solace

Lakshmipura, Uttarahalli Hobli, Devanahalli,  
Bengaluru, Karnataka - 562110  
For sales enquiries  
Phone : +91 90199 66000  
Email : [sales@dnrgroup.in](mailto:sales@dnrgroup.in)



Disclaimer: The Company does not guarantee or represent the information contained in this document, which is to be used for general information only. The Company does not guarantee or represent that the information contained within this document is correct. Any interested party should verify all the information including designs, plans, specifications, facilities, features, payment schedule, terms of sale, etc. independently with the Company prior to concluding any decision for buying in the project. The user of the brochure confirms that he/she has not relied on this information alone when making any booking/purchase in any project of the Company. The information, visuals, renders and creative depictions contained herein are artistic impressions, indicative in nature and are for general information purposes only. The actual design/colour/finish/construction/landscape could undergo changes based on changes in design, layouts, materials, site conditions, etc. Any furniture, paintings, or any items of personalised nature not specifically mentioned in the contract and shown in the images are only for the purpose of illustration and does not form part of the offering. Further, the renders/ visuals of the area beyond the project site are artistic in nature and may not depict the actual visuals. While every reasonable care has been taken in providing the information, under no circumstances the Company or its employees, managers or representatives shall be held liable for any loss or damage, special or consequential or otherwise, arising from the use of or reliance on information provided in the brochure without verifying the same independently with the Company. The contents provided herein are with all faults and on an "as is" and "as available" basis. No information given in this brochure creates a warranty or expand the scope of any warranty that cannot be disclaimed under the applicable laws.