

WELCOME TO THE TOWNSHIP OF THE FUTURE

LOCATED NEXT TO ELCOT SEZ,
PERUMBAKKAM, CHENNAI



greens

greens

NURTURE YOUR DREAMS FOR THE FUTURE IN THE TOWNSHIP OF TOMORROW

Bring alive a world of endless possibilities for your family when you move into this thoughtfully planned integrated township. Choose a world of amenities, an active and healthy lifestyle, tech-enabled infrastructure, eco-friendly environment and more. Discover the future of living at Greens!

One of Ozone Group's latest residential projects in Chennai, Greens offers 1-bedroom, 2-bedroom, 2.5-bedroom, 3-bedroom and 4-bedroom apartments within an integrated township for a fabulous living experience.



greens

DISCOVER A SAFE, SUSTAINABLE AND FUTURISTIC LIVING ENVIRONMENT BUILT ON THE 5 PILLARS OF OZONE



• INFRASTRUCTURE

At Ozone, we ensure that every home is built on strong physical and virtual infrastructure by bringing together advanced technology and thoughtful designs. We've built a world that will cater to every need of yours.





• AMENITIES

At Ozone Group, we focus not only on creating homes but lifestyles too. This is why providing your family and you with varied amenities are fundamental to us. From sports to entertainment, there's a whole lot of amenities waiting to be discovered at every Ozone property.



• ECO-FRIENDLY DEVELOPMENTS

Nature is at the heart of everything we do. And that's why eco-friendly developments are one of Ozone's five pillars. We take extra care to create vast, open spaces of lush greenery, including parks, gardens, and mini forests.



• CULTURE

Life finds meaning in the discovery of new bonds and sharing memorable moments together. And that's why community & culture is one of the five pillars we pride ourselves on. We dedicate ourselves to creating special spaces and zones that will nurture some of life's best moments.



greens

AMENITIES DESIGNED FOR THE NEW AGE

Once at Greens, you need not look further for that much needed break. A host of modern and contemporarily designed amenities await you, like a dynamic clubhouse with tennis, badminton, squash, basketball, billiards, state-of-the-art gym, a yoga centre, swimming pool and a whole cricket pitch. Did we mention jogging tracks around the property? Yes, that too!



IMAGES SHOWN ARE FOR REPRESENTATION PURPOSE ONLY

greens

LET YOUR WISHES GET WINGS, IN THE TOWNSHIP OF TOMORROW

Located at the heart of it all in Perumbakkam, Chennai, all your daily needs and important landmarks are right next door. Because when you live at Greens, you enjoy unprecedented convenience. Schools, institutes, malls, cafés, shopping centres, cinemas, restaurants, general stores, banks, ATMs, medical centres, hospitals, you name it!

Easy access to a wide array of public transport makes it even more irresistible. Strategically located near the ELCOT SEZ, off OMR, Greens is in the fastest-developing IT hub. It is an ultra-modern residential development spread over several acres. So, go ahead, move into the township of the future today!

- 1.5 KM FROM ELCOT SEZ
- 1.5 KM FROM GLOBAL HEALTH CITY AND NATIONAL PUBLIC SCHOOL
- EASY ACCESS FROM OMR, VELACHERY TAMBARAM, ECR AND GST ROAD
- WITHIN CMDA CITY LIMITS

LOCATION MAP



MASTER PLAN



TYPICAL FLOOR PLAN - TOWER D1 & D2 (1st Floor to 7th Floor)

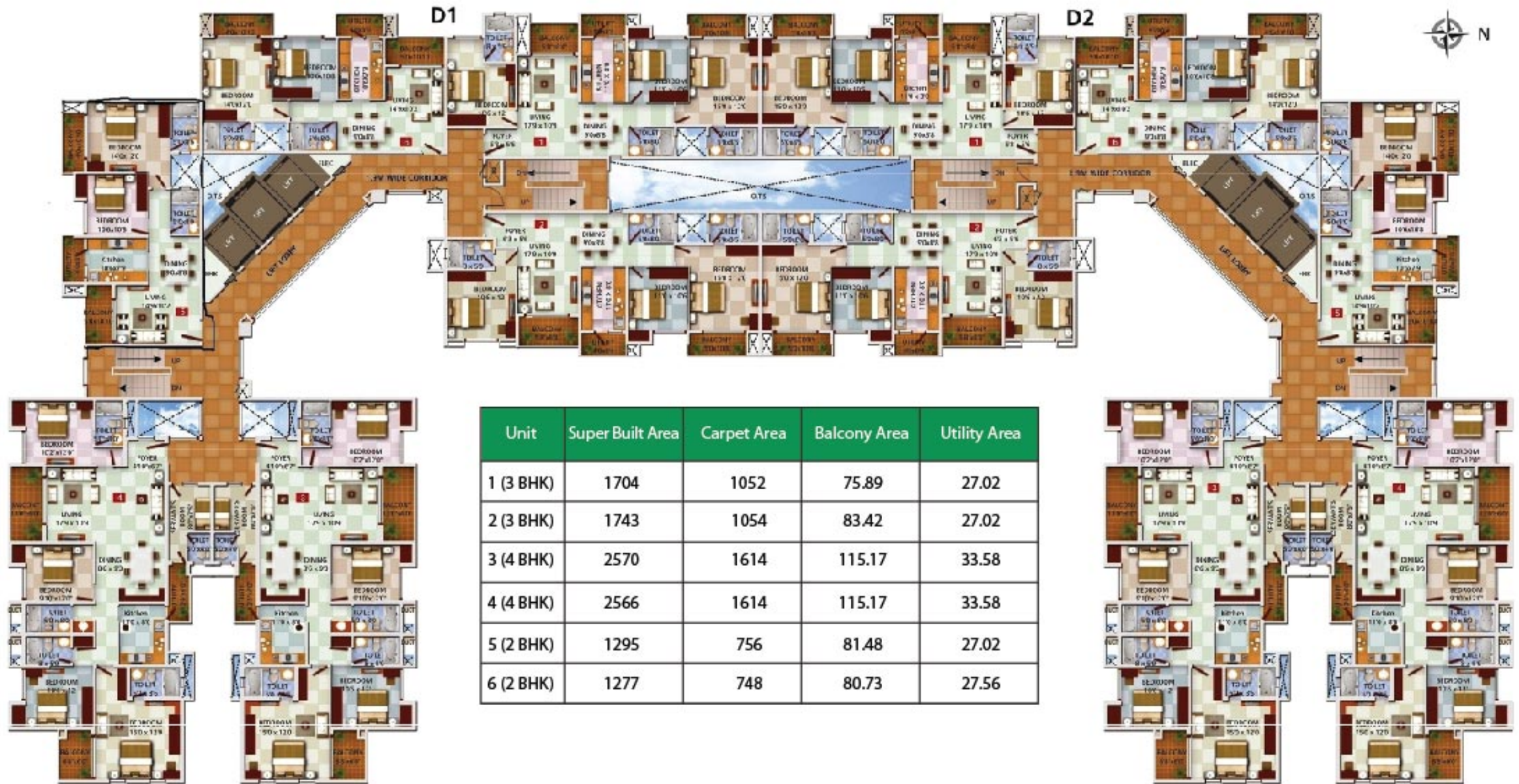

| Unit | Super Built Area | Carpet Area | Balcony Area | Utility Area |
|-----------|------------------|-------------|--------------|--------------|
| 1 (3 BHK) | 1704 | 1052 | 75.89 | 27.02 |
| 2 (3 BHK) | 1743 | 1054 | 83.42 | 27.02 |
| 3 (4 BHK) | 2570 | 1614 | 115.17 | 33.58 |
| 4 (4 BHK) | 2566 | 1614 | 115.17 | 33.58 |
| 5 (2 BHK) | 1295 | 756 | 81.48 | 27.02 |
| 6 (2 BHK) | 1277 | 748 | 80.73 | 27.56 |

TYPICAL FLOOR PLAN - TOWER D1 & D2 (8th Floor to 19th Floor)

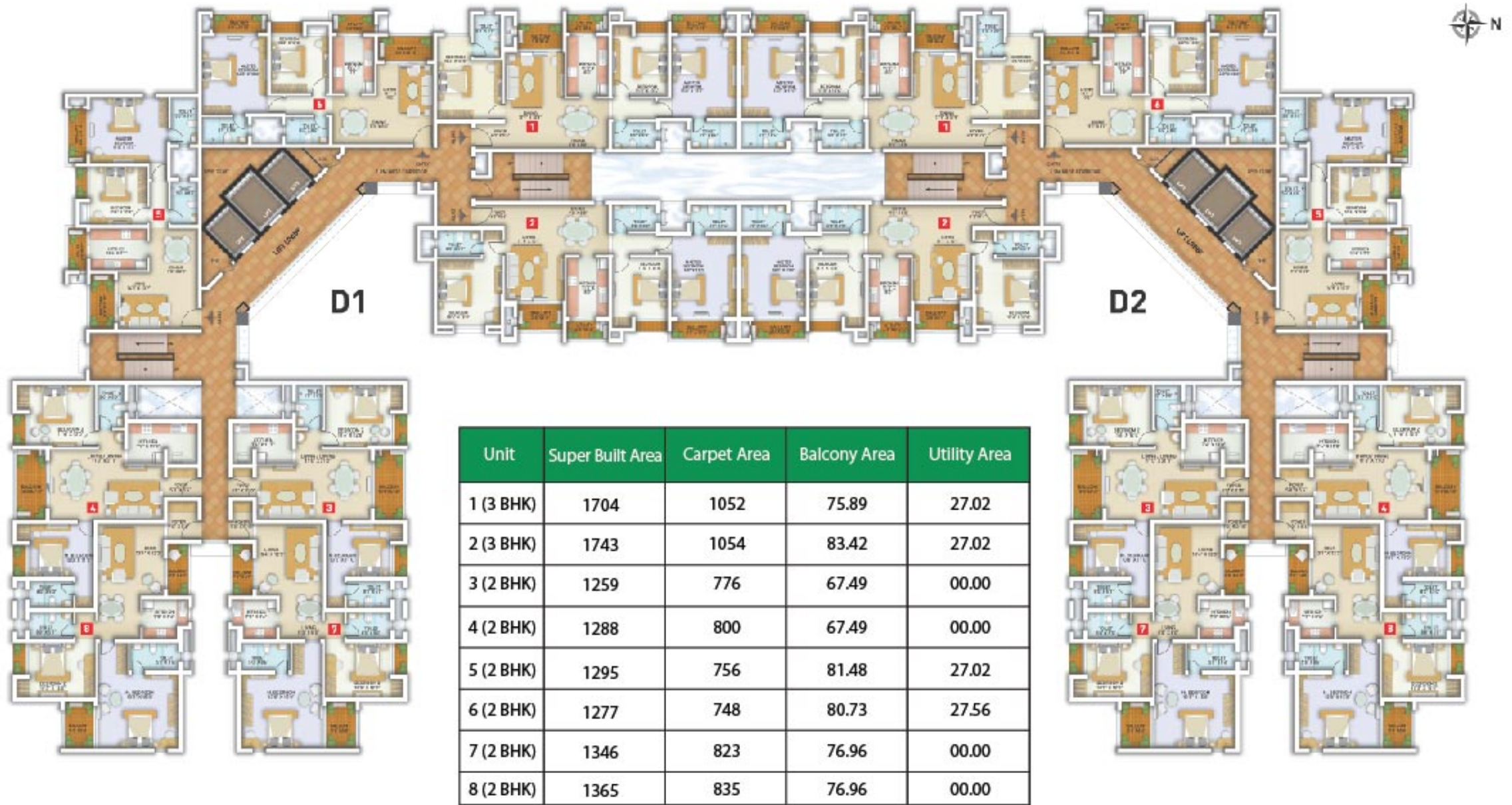

TYPICAL UNIT FLOOR PLAN FOR BLOCK - D3 (1st Floor to 19th Floor)

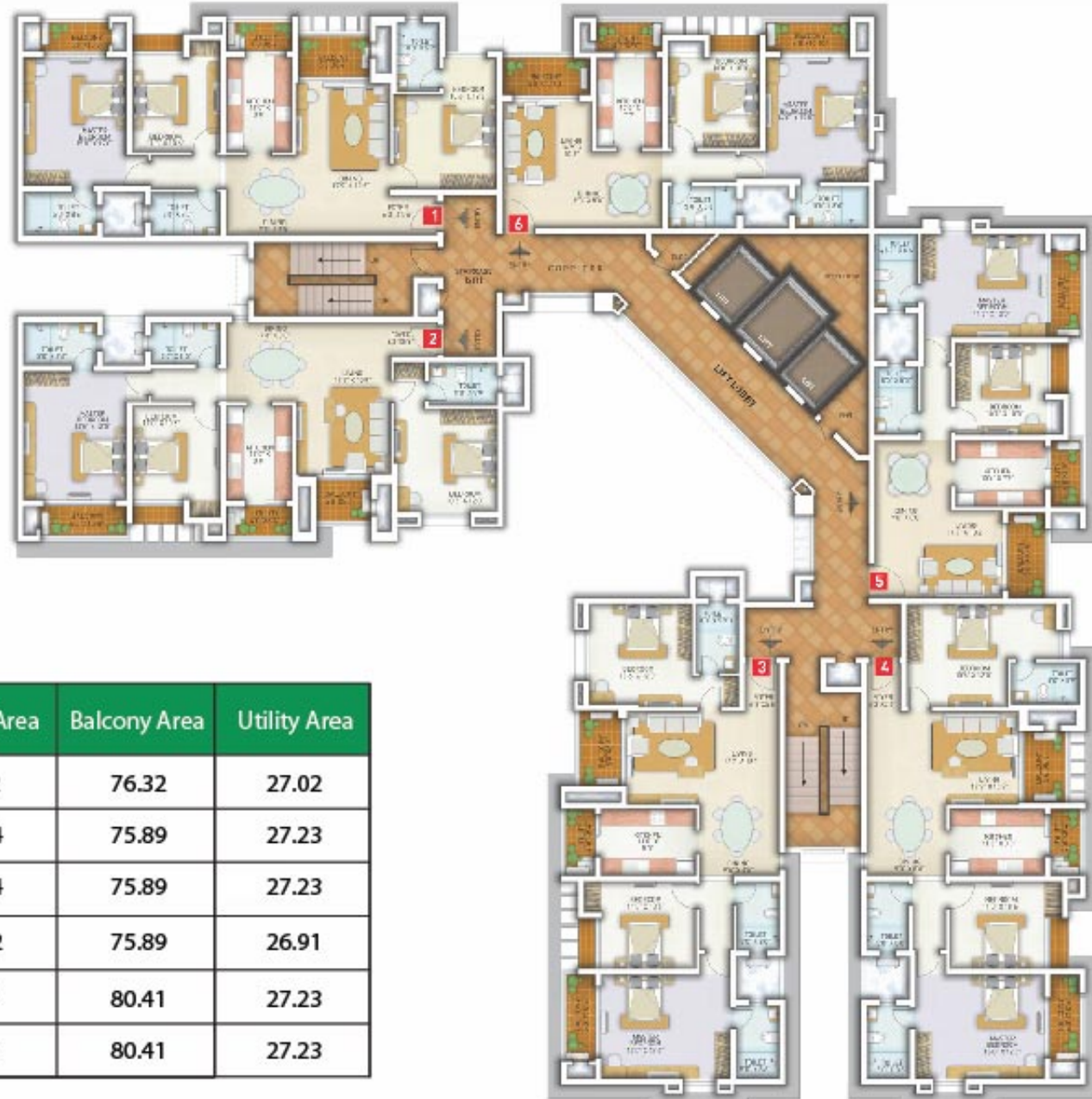

| Unit | Super Built Area | Carpet Area | Balcony Area | Utility Area |
|-----------|------------------|-------------|--------------|--------------|
| 1 (3 BHK) | 1751 | 1052 | 76.32 | 27.02 |
| 2 (3 BHK) | 1786 | 1054 | 75.89 | 27.23 |
| 3 (3 BHK) | 1786 | 1054 | 75.89 | 27.23 |
| 4 (3 BHK) | 1755 | 1052 | 75.89 | 26.91 |
| 5 (2 BHK) | 1331 | 756 | 80.41 | 27.23 |
| 6 (2 BHK) | 1331 | 756 | 80.41 | 27.23 |

TYPICAL FLOOR PLAN - TOWER E I (1st Floor to 7th Floor)



| Unit | Super Built Area | Carpet Area | Balcony Area | Utility Area |
|----------|------------------|-------------|--------------|--------------|
| 1 (3BHK) | 1753 | 1059 | 78.49 | 27.02 |
| 2 (3BHK) | 1753 | 1059 | 78.47 | 27.02 |
| 3 (3BHK) | 1753 | 1059 | 78.47 | 27.02 |
| 4 (2BHK) | 1326 | 756 | 81.38 | 27.02 |

TYPICAL FLOOR PLAN - TOWER E I (8th Floor to 19th Floor)



| Unit | Super Built Area | Carpet Area | Balcony Area | Utility Area |
|-------------|------------------|-------------|--------------|--------------|
| 1 (2.5 BHK) | 1489 | 886 | 75.35 | 25.73 |
| 2 (2 BHK) | 1376 | 812 | 75.35 | 25.73 |
| 3 (3 BHK) | 1753 | 1059 | 75.35 | 25.73 |
| 4 (2 BHK) | 1326 | 756 | 78.25 | 25.73 |
| 5 (1 BHK) | 706 | 434 | 23.25 | 00.00 |

TYPICAL FLOOR PLAN - TOWER E 2 & TOWER E 6 (1st Floor to 7th Floor)



| Unit | Super Built Area | Carpet Area | Balcony Area | Utility Area |
|-----------|------------------|-------------|--------------|--------------|
| 1 (3 BHK) | 1753 | 1059 | 78.47 | 27.02 |
| 2 (3 BHK) | 1753 | 1059 | 78.47 | 27.02 |
| 3 (3 BHK) | 1753 | 1059 | 78.47 | 27.02 |
| 4 (2 BHK) | 1326 | 756 | 81.38 | 27.02 |

TYPICAL FLOOR PLAN - TOWER E 2 & TOWER E 6 (8th Floor To 19th Floor)



| Unit | Super Built Area | Carpet Area | Balcony Area | Utility Area |
|-------------|------------------|-------------|--------------|--------------|
| 1 (3 BHK) | 1753 | 1059 | 75.35 | 25.73 |
| 2 (2 BHK) | 1376 | 812 | 75.35 | 25.73 |
| 3 (2.5 BHK) | 1489 | 886 | 75.35 | 25.73 |
| 4 (2 BHK) | 1326 | 756 | 78.25 | 25.73 |
| 5 (1 BHK) | 706 | 434 | 23.25 | 00.00 |

TYPICAL FLOOR PLAN - TOWER E 3 & TOWER E 4 (1st Floor To 7th Floor)



| Unit | Super Built Area | Carpet Area | Balcony Area | Utility Area |
|-----------|------------------|-------------|--------------|--------------|
| 1 (3 BHK) | 1753 | 1059 | 78.47 | 27.02 |
| 2 (3 BHK) | 1753 | 1059 | 78.47 | 27.02 |
| 3 (3 BHK) | 1753 | 1059 | 78.47 | 27.02 |
| 4 (2 BHK) | 1326 | 756 | 81.38 | 27.02 |

TYPICAL FLOOR PLAN - TOWER E 3 & TOWER E 4 (8th To 19th Floor)



| Unit | Super Built Area | Carpet Area | Balcony Area | Utility Area |
|-------------|------------------|-------------|--------------|--------------|
| 1 (3 BHK) | 1753 | 1059 | 75.35 | 25.73 |
| 2 (2 BHK) | 1376 | 812 | 75.35 | 25.73 |
| 3 (2.5 BHK) | 1489 | 886 | 75.35 | 25.73 |
| 4 (2 BHK) | 1326 | 756 | 78.25 | 25.73 |
| 5 (1 BHK) | 706 | 434 | 23.25 | 00.00 |

TYPICAL FLOOR PLAN - TOWER E 5 (1st Floor To 7th Floor)



| Unit | Super Built Area | Carpet Area | Balcony Area | Utility Area |
|-----------|------------------|-------------|--------------|--------------|
| 1 (3 BHK) | 1753 | 1059 | 78.68 | 27.23 |
| 2 (3 BHK) | 1753 | 1059 | 78.68 | 27.23 |
| 3 (3 BHK) | 1753 | 1059 | 78.68 | 27.23 |
| 4 (2 BHK) | 1326 | 756 | 81.59 | 27.23 |

TYPICAL FLOOR PLAN - TOWER E 5 (8th to 19th Floor)



| Unit | 1 | 2 | 3 | 4 | 5 |
|-----------|-------|-------|---------|-------|-------|
| Unit Type | 3 BHK | 2 BHK | 2.5 BHK | 2 BHK | 1 BHK |
| Sale Area | 1753 | 1376 | 1489 | 1326 | 706 |

SPECIFICATIONS



STRUCTURE:

RCC framed structure with solid concrete, blocks/brick masonry panelled walls.

FLOORING:

Vitrified tiles in living, dining, bedrooms and kitchen.

Ceramic tiles in balcony and utility.

Kitchen/utility: Highly polished granite counter top tile up to 2ft. height over the countertop.
Stainless steel sink.

TOILETS:

Ceramic tiles on the floor and on the walls up to 7 ft. height from the floor. Good quality ceramic ware for toilets and wash basins with CP (chromium plated) fittings.

DOORS:

Flush door/MDF doors with ply or MDF frames

Windows: Powder-coated aluminum frames with clear float glass.

FINISHES:

Interior walls: Putty finish with paint in pleasing shades.

Exterior walls: Plaster with exterior grade paint.

Generator back-up: 24-hour generator back-up for common areas lifts and pumps.

ELECTRICAL:

Concealed copper wiring in PVC conduits, modular sockets and switches with adequate number of points for lights.

Telecommunication and data

CONNECTIVITY:

Fibre optic connectivity provided. Provision for telephone connection provided in living area and master bedroom.

SECURITY SYSTEM:

24-hour security

INTERCOM:

The intra-communication systems will provide an efficient security cover.

At Ozone Group, we are committed to providing you a better quality of life and redefining the standard of living through innovative real estate products. We distinctively differentiate ourselves through our committed focus on three core values – Customer Centricity, Quality and Transparency. Fortified by our 5-pillar approach, we have raised the bar for functionality, infrastructure and eco-friendliness. Our offerings range from residential condominiums, hotels, resorts to business parks, integrated townships and retail malls. Our projects are currently being developed in Bengaluru, Chennai, Mumbai and Goa.

Site Address: S.No. 68/1A, Perumbakkam, Jalladiampet Joint Road, Jalladiampet, Near ELCOT SEZ, Chennai - 600 100.

Call: 8880 179 000 | Visit us at: www.ozonegroup.com/greens

Corporate Office: 38, Ulsoor Road, Bengaluru – 560 042. Phone: +91 080-4039 5600.

Chennai Office: 63, G.N. Chetty Road, T. Nagar, Chennai - 600 017. Ph: +91 44-4393 1500.

Mumbai Office: Unit No. 407, Trade Centre Bandra-Kurla Complex, Bandra East, Mumbai - 400 051. Ph: +91 22-4273 7500.

Goa Office: F-3 Villa Sol, La Campala Colony, Miramar, Panjim, Goa - 403 001. Ph: +91 832-246 1680.

International Sales: UAE, USA & Canada. Email: nrisales@ozonegroup.com