



A class apart

Site Address: Close to ITC Grand Central, E Borges Road, Parel, Mumbai - 400012.

Lodha Primo, Close to ITC Grand Central, E Borges Road, Parel, Mumbai 400012.
The project has been registered via MahaRERA registration number: P51900014910
is available on the website <https://maharera.mahaonline.gov.in> under registered projects.

PLANS & VIEWS BOOKLET

For internal circulation only

COVETED LOCATION.
STAND-ALONE TOWER.
WORLD-CLASS RESIDENCES.



Artists impression

DEVELOPMENT PLAN

- LEGEND:
1...ENTRY
2...EXIT
3...LAWN
4...SERVICE ENTRY ETC
5...SWIMMING POOL
6...KIDS POOL
7...POOL DECK
8...KIDS PLAY AREA
9...RECREATIONAL LAWN



TYPICAL FLOOR PLAN



3 BED RESIDENCE



3 BED RESIDENCE



TYPICAL FLOOR PLAN - REFUGE



3 BED RESIDENCE - REFUGE

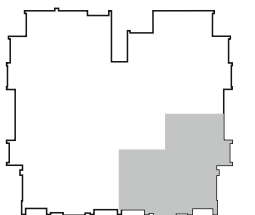

VIEWS FROM 8TH FLOOR



VIEWS FROM 15TH FLOOR



VIEWS FROM 25TH FLOOR



VIEWS FROM 35TH FLOOR

