



|| **Shlokra** Sonigara ||
1 & 2 BHK DIVINE HOMES

सर्वे
भवन्तु
सुखिनः

Our
CULTURE.

Our
HERITAGE.

Our
PRIDE.

Let's Get Back To The
ROOTS



A right address is a
PRIVILEGE

The address that
doesn't need a Landmark.
Because it is a **Landmark.**

Embrace the
TRADITIONS



OUR SHLOKA

The human species as a whole is constantly seeking to expand, go big, grow, and is most adaptable to change. But our shared roots is one thing that unites us all. No matter how far a person goes in life, he or she will always find a cause to return to the familiar surroundings!

As the name implies, Shloka draws inspiration from our shared culture, history, and golden legacy while gracefully incorporating contemporary homemaking methods! It is a construction marvel due to the careful application of contemporary technology and the attention to every last detail.

The rooms are spacious, there is adequate area, and the location is so well connected that it will entice you to return and unwind before taking on your next endeavour.



Shloka Sonigara
1 & 2 BHK DIVINE HOMES

A paradise for
EVERYONE

AMENITIES



Club House



Temple



Children's Recreation



Automation

(Elevator, Power Backup for common Utilities /Areas)



Safety & Security



Landscape Garden

1 BHK



A : Living Room
B : Balcony
C : Dining Area

D : Kitchen with Utility Area
E : Bathroom / WC
F : Master Bedroom



1 BHK
Carpet: 497 sqft

2 BHK



A : Living Room
B : Balcony
C : Dining Area

D : Kitchen with Utility Area
E : Bathroom / WC
F : Guest & Master Bedroom

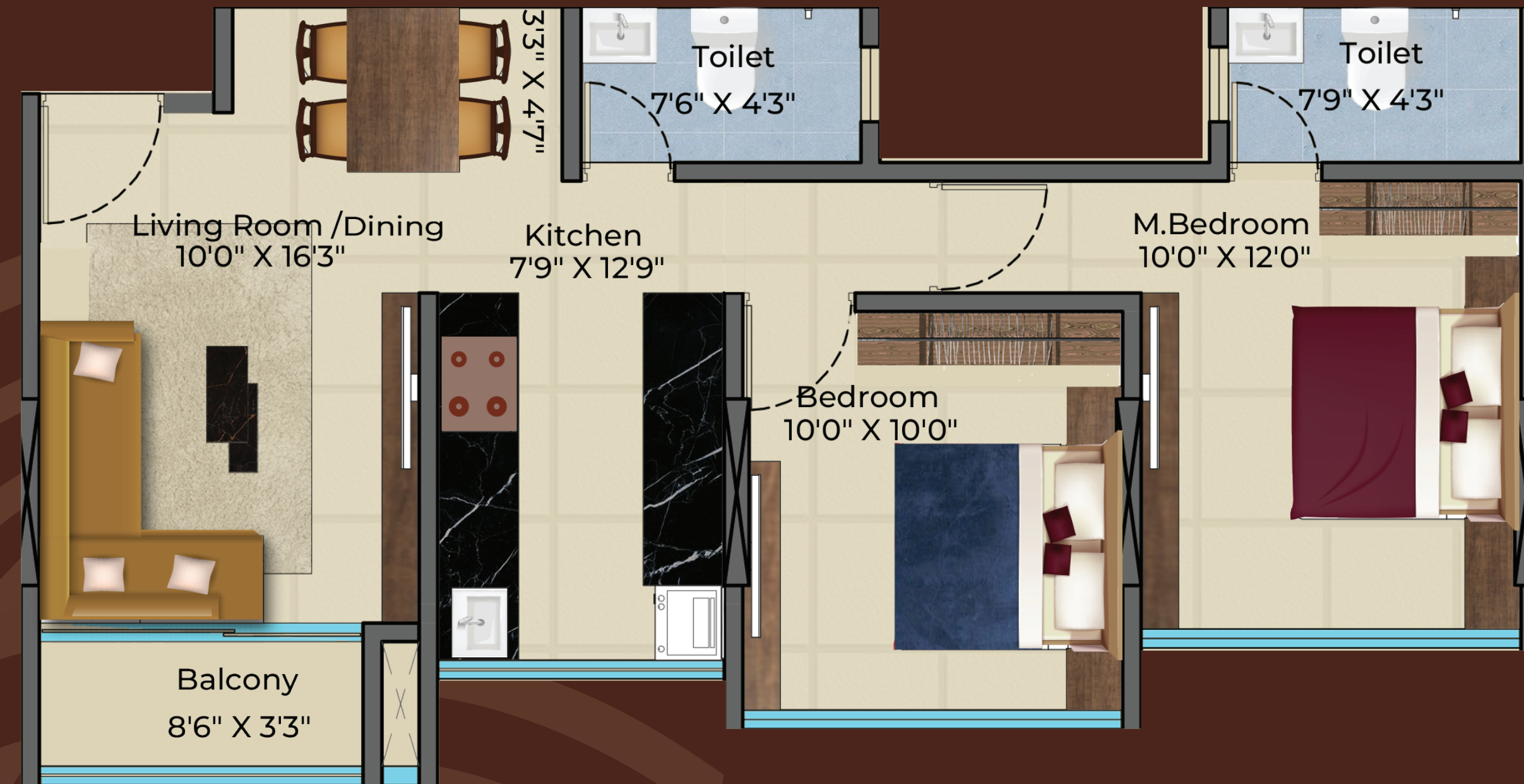

2 BHK
Carpet: 643 sqft

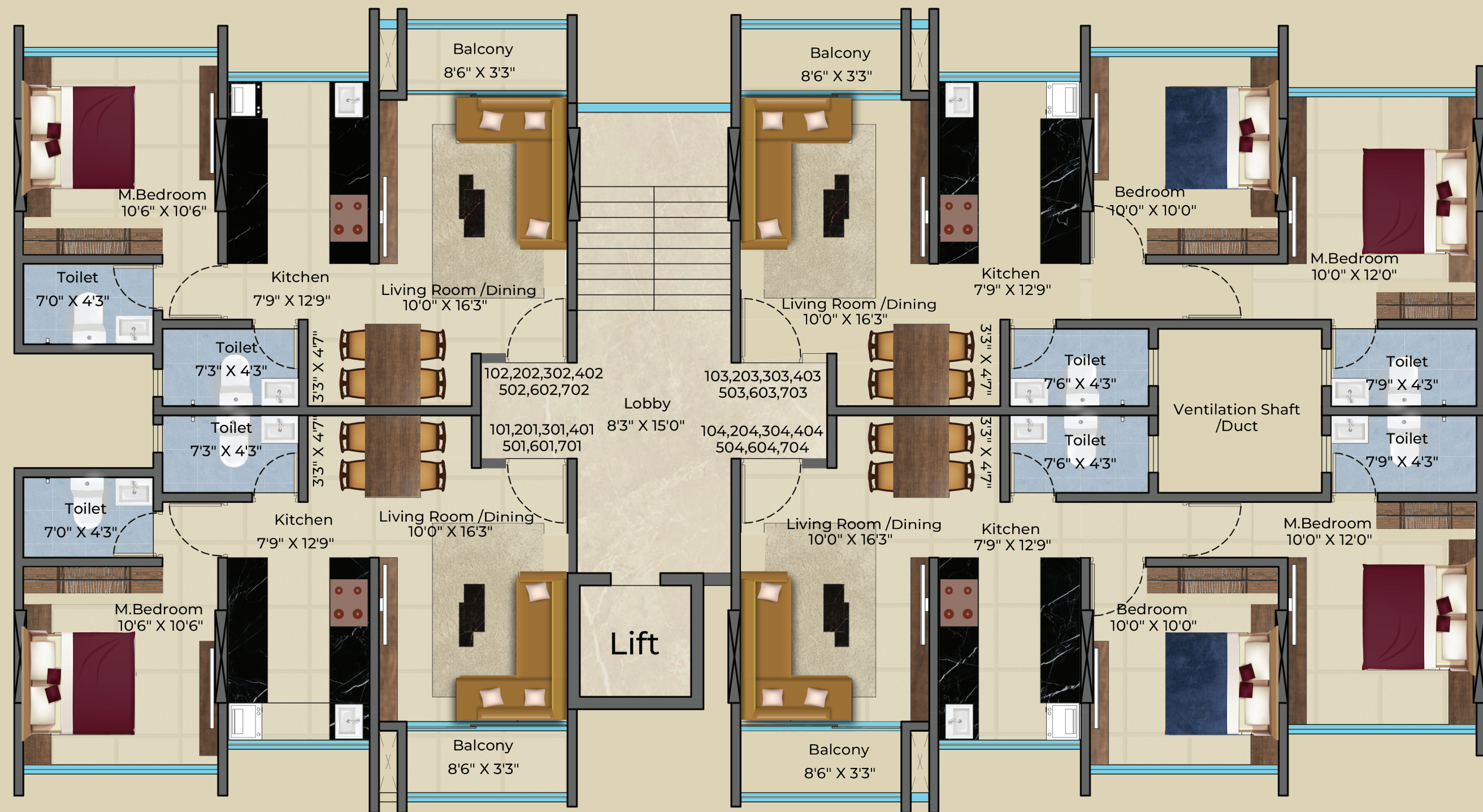

1 BHK 497 sqft carpet

2 BHK 643 sqft carpet



SPECIFICATIONS

Structure

- | Earthquake Resistant R.C.C. structure.
- | Aesthetically Designed Elevation.

Walls

- | 5" thick Internal & External walls.
- | Gypsum finished OBD in Living, Bedroom, Kitchen & Bathroom

Flooring

- | 2X2 Vitrified Tiles in Living, Bed Room & Kitchen.
- | Anti-skid Tiles in Toilet
- | Tiles in Lift Lobbies.
- | Kitchen: Granite Platform with S.S. sink

Doors

- | **Main Door:** Attractive Designer with Brass fittings/ S.S. fittings with wooden frame.
- | **Bedroom:** Wooden frame with Laminated Flush Doors.
- | **Toilet:** Granite Frame with FRP Doors.
- | Living Room Terrace with French Doors.

Windows

- | Three track Powder coated Aluminium sliding with safety Grills & Mosquito net.

Plumbing

- | Concealed with standard C.P. fittings & well make sanitary fittings.

Electrical

- | Concealed wiring with sufficient modular switches
- | Single phase supply to each flat.
- | MCB to flat for electrical safety
- | T.V. & Wi-Fi Point in Living Room.

External Facade

- | Cement Paving blocks/Concrete Roads.
- | Elevator with power backup.





LOCATION

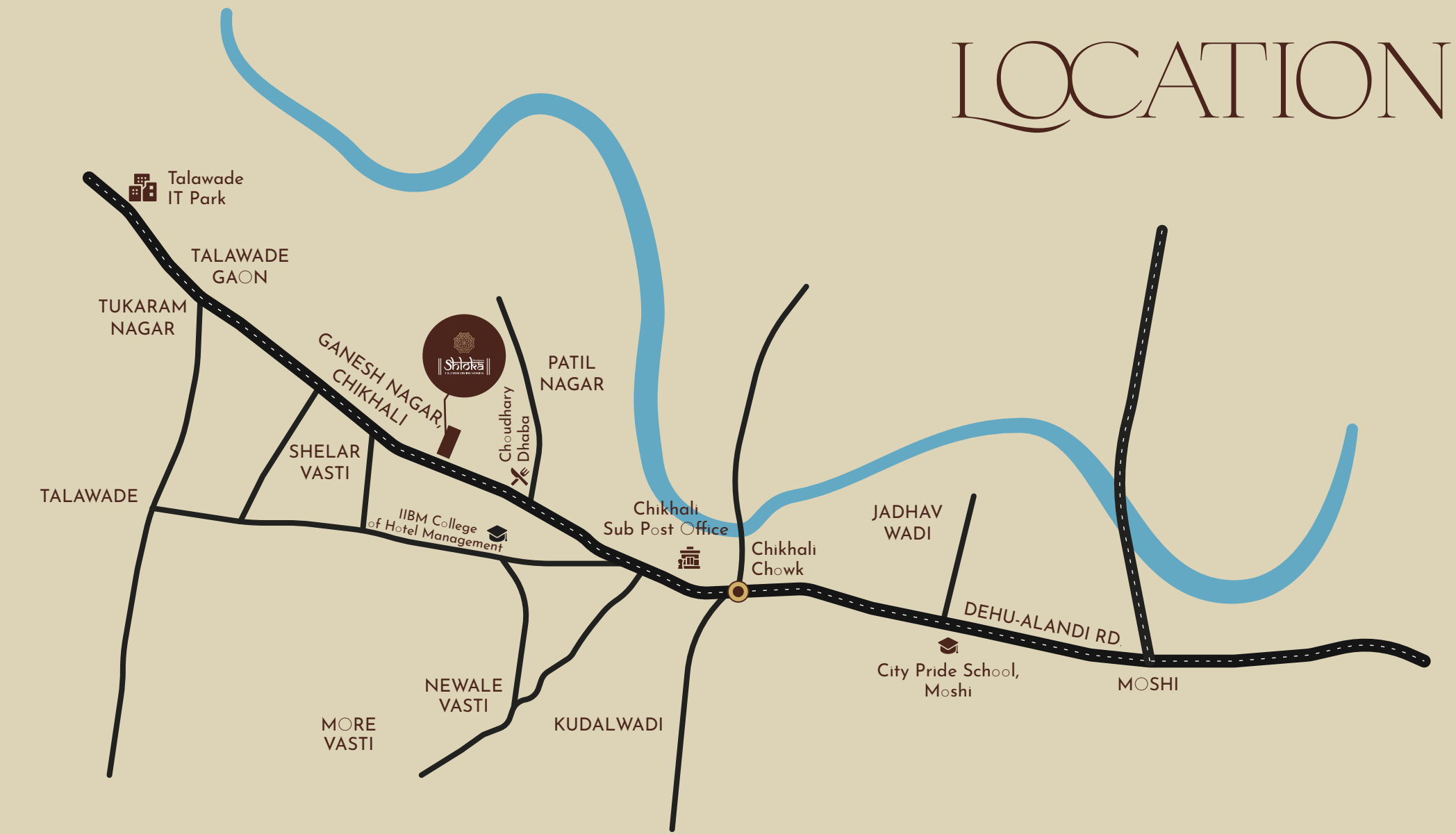

KEY DISTANCES

Schools/Colleges : 5 Mins

Talawade IT Park : 5 Mins

Chikhali Bus Stop : 5 Mins

Auditorium : 5 Mins

MIDC : 15 Mins

Hospitals/Clinics : 5 Mins

D-Mart : 10 Mins

Metro Station : 10 Mins

Tata Motors : 10 Mins

Mumbai-Pune Highway : 10 Mins

Project By



SONIGARA
CORP RISE BEYOND™



+91 7218 721 877
+91 9172 134 777



Gat. No. 1602, Near Chaudhari Dhaba,
Dehu-Alandi Road, Chikhali, Pune - 411062

Architect
STUDIO INTEGRATE

RCC Consultant
Rahul Kapse & Asso.

Legal Consultant
Adv. Savita Avagade

Strategic Partner
Rapid Realtors

Media Consultant
Tuffu Taffa Studios

This brochure is conceptual in nature & not a legal offering. The promoters reserve the right to change, delete or add any specifications or plan mentioned herein.