



Corporate Office:
A2, 2nd Floor, Madhu Estate,
Pandurang Budhkar Marg,
Lower Parel, Mumbai - 400013.

☎ : + 91 22 6291 8111
🏠 : + 91 22 6291 8260
📞 : + 91 93231 49229 | +91 99673 73591

E-Mail: sales@aristo.net.in
Website: www.aristo.net.in

Site Address: 1515 MONECO,
R . B. Desai Marg, Prabhadevi,
Mumbai - 400025.



MAHA RERA NO.: P5190003 | 13 |
<http://maharera.mahaonline.gov.in>

Architect : PANTHAKY ARCHITECTS
RCC Consultant : JW CONSULTANTS LLP

Disclaimer : This brochure/document /catalogue is meant only for promotional/illustration purpose and general information only and is subject to change without any notice. It does not constitute an offer and /or acceptance and /or contract and /or agreement and /or transaction and /or any intention thereof and /or a disclosure under any statute of any nature whatsoever by the Developer/Owner and the recipient. Artists impressions are used to illustrate the dimensions, amenities, specifications, images and other details. The same shall not be considered as an offer/promise/commitment of any nature in respect of the '1515 Moneco' project by the Developer /Owner. All the images, visuals, materials and information contained herein are purely creative/artistic concepts and may not be actual representations of the product and /or any amenities. Any reliance placed on such information is strictly at viewer's risk. None of the above may be construed to form any basis of, or serve as an inducement or invitation for payment of any advance and /or deposit to be made by a prospective customer, under relevant provisions of law or otherwise. The contents /plans /pictures /images /renderings/maps and other details herein are subject to approvals from the concerned local Authorities. Subject to approval of Authorities and in the interest of continuing improvement, the Developers/Owners reserve right to change plans, specifications or features without prior notice or obligations. The amenities and facilities to be provided shall be as decided and specified at the time of sale/lease agreement of respective flats. Our Company or its Directors or employees are not liable for any loss, damage, errors, directly or indirectly, consequential or incidental, suffered or incurred by any person/s or due to any use and /or inability to use this information.

SAN GRAPHICS : +91 98193 89437



1515 MONECO

PERFECT HOME
TO FULFILL DREAMS



*Artist's Impression

ELEVATED LIFESTYLES

Living large is a luxury that everyone covets but only a few achieve. This ambitious project by Aristo Realty radiates a lavish vibe like no other.

This 19- storey edifice offers all the possible facilities you can imagine within its regal realm.

Located at a prime area in Prabhadevi, the Heart of Mumbai 1515 Moneco brings you the best of both worlds- the old and the new.

We welcome you abode a holistic haven, exclusively designed for you by ARCHITECT PHIROZE PANTHAKY, and finished to the highest standards of international extravagance.

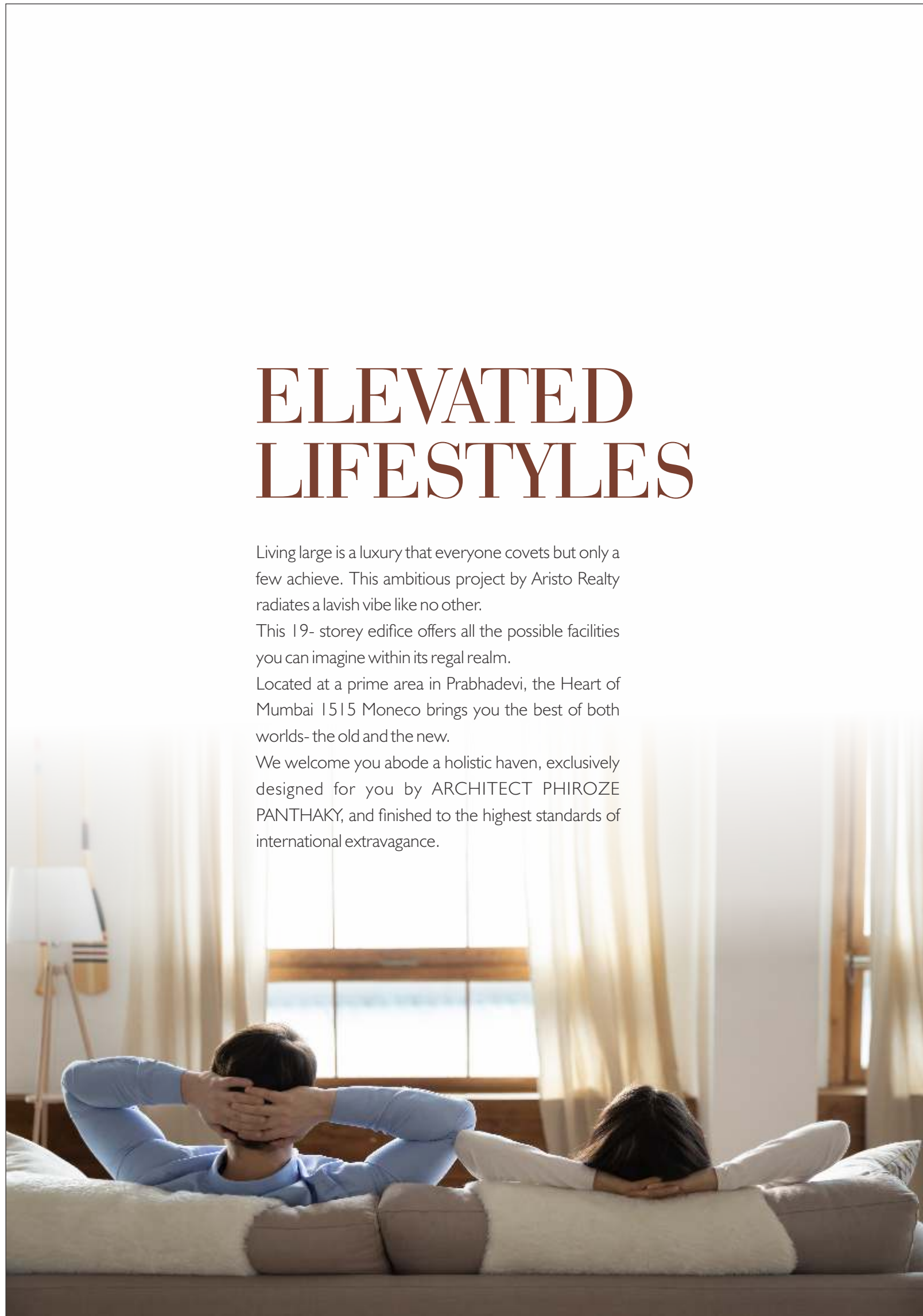

3RD FLOOR



TYPICAL FLOOR

4TH, 5TH, 7TH TO 12TH, 14TH TO 17TH

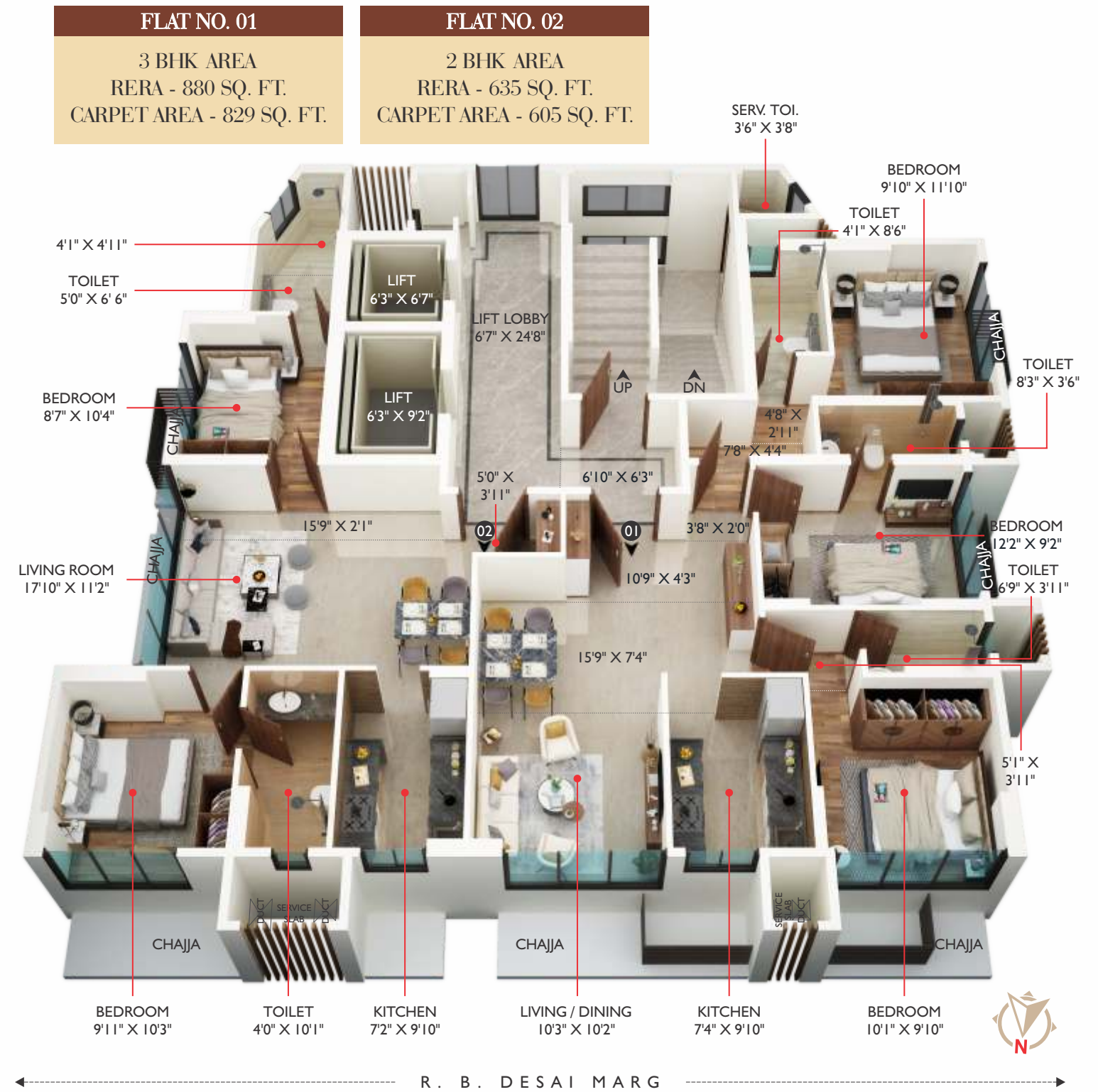

AUTOMATED CAR PARK

Enjoy the best of everything at 1515 Moneco, including a Mechanized Puzzled Car Park System! You simply have to drive into the parking bay and leave the rest to the automated car park, which will transport your car to its designated parking space by the automated system.

STATE OF THE ART SECURITY

The common areas of the building are integrated with a round the clock CCTV Monitoring System incorporated with special night vision cameras, your safety always comes first at 1515 Moneco. From Smoke Detectors with automatic gas-cut valves & Intercom System, security is undoubtedly the topmost priority.

6TH FLOOR



13TH FLOOR

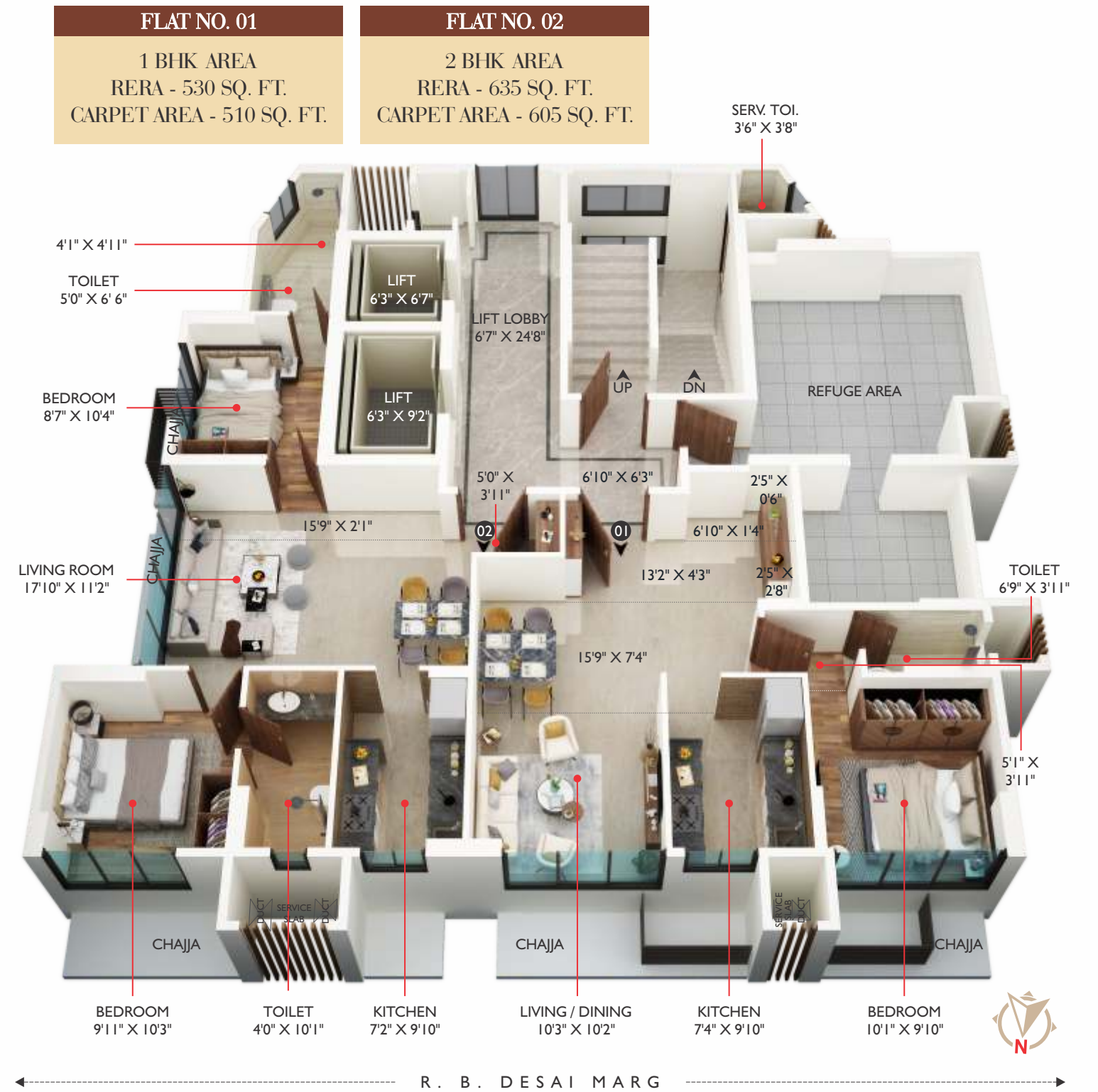

AMENITIES

- Decorative Entrance Lobby.
- Two (2) Elevators.
- Fire Resistant Main Door as specified in regulations.
- Aluminum Windows. Toilet windows shall be openable with provisions for exhaust.
- Water Supply including vertical risers, pumps and pipes.
- All sewerage and rain water connection with external disposal.
- Storm water drains.
- Fire Protection and Fire safety systems as per CFO.

- Electric Supply till the floor panel of the Allottee/s.
- Electrical Meter room.
- Society Office Room.
- Swimming Pool.
- Fitness Center and changing room.
- Servant Toilets on staircase mid-landing.
- CCTV systems for the common areas.
- DG set for essential common areas.
- Mechanized Puzzled Car Parking System.
- Security Cabin.

18TH FLOOR

GYMNASIUM



FULLY EQUIPPED GYMNASIUM

Being healthy and fit is no longer a fad or a trend, but a lifestyle! Take a health trip up to the 1515 Moneco Fitness Centre, which is equipped with state of the art gym equipment.

TERRACE FLOOR

SWIMMING POOL WITH CHANGING ROOM

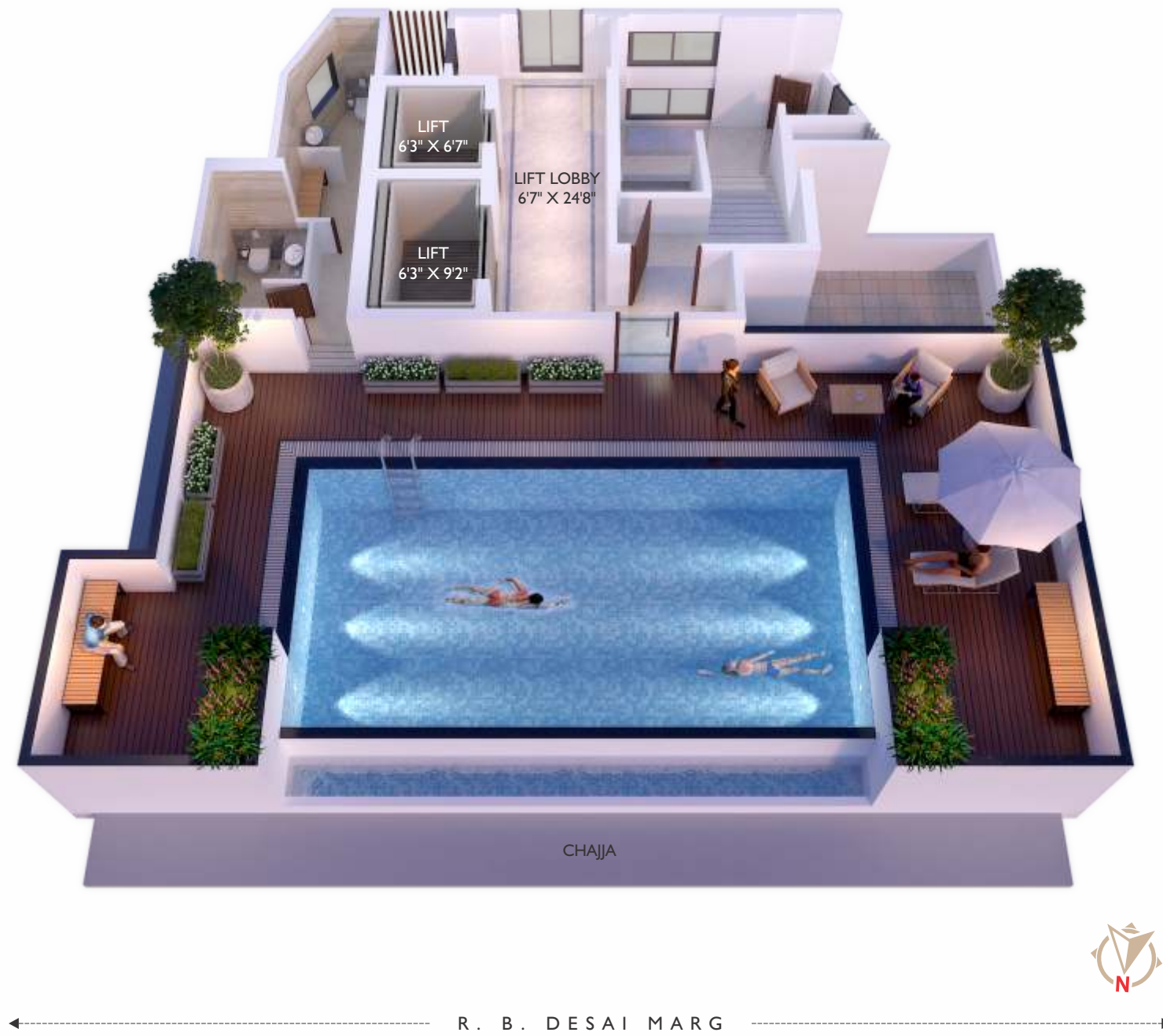

SWIMMING POOL

Unwind after hectic week lying on the pool deck and stimulate your senses. Dive into the placid blues of the 1515 Moneco swimming pool at the comfort of being on the summit of your new home and treat yourself to the rich charming view while soak up the cool goodness.



1515 MONECO



1515 MONECO can be found on Google maps.

Key
Aristo Realty Projects

SCAN TO QR CODE FOR LOCATION

LOCATION AT PAR

A new luxury project is poised to become a 21st-century contemporary landmark in the posh locality of Mumbai i.e. Prabhadevi. With its strategic location, 1515 Moneco offers you the best connectivity. Located within walking distance from the upcoming Metro and close to the Sea Link, the suburbs are just a short commute away. A niche living experience at the heart of Mumbai, one can dwell in the sacred spiritual realm of the famous Siddhivinayak Temple just a kilometer away or indulge in some serious retail therapy at High Street Phoenix, another 10 minutes away.

SOME CONVENIENT LOCATION, A STONES THROW AWAY

 Siddhivinayak Temple 1 Km. / 3 Mins.	 Bandra Worli Sea Link 2.0 Km. / 6 -7 Mins.	 Hinduja Hospital 3.1 Km. / 7 Mins.
 Bombay Scottish School 3.5 Km. / 8 Mins.	 PVR / Phoenix Mills 3.9 Km. / 11 Mins.	 BKC 6.6 Km. / 13 Mins.
 Turf Club / Racecourse 4.9 Km. / 13 Mins.	 Domestic Airport 11.7 Km. / 18 Mins.	 International Airport 14.6 Km. / 21 Mins.

Disclaimer : The Distances mentioned above are calculated by a third party application. They may vary as per the prevailing traffic conditions and /or other circumstances affecting the same.