



**Lashkaria**  
**SOLITAIRE**

Andheri (W)

Discover your luxurious haven at Lashkaria  
Solatire - Where Dreams Take Shape



## THE AMANN GROUP

The Amann Group has come a long way building on strengths, exploring market opportunities and focusing on the company's future in the field of Infrastructure, Health Care, Retail, Media and Education.

Financial strength, technical know-how, a skilled team and a touch of class to offer the finest of services brings The Amann Group closer to its goals to become one of the leading construction company in Mumbai city.

More than a decade ago, The Amann Group under the able leadership, vision and principles of Mr. Salim Y. Lashkaria, Mr. Hashem Y. Lashkaria and Mr. Raiees Y. Lashkaria, began its journey in the field of real estate construction. Today sheer hard work, perseverance, strict adherence to time constraints and obsession with the best quality architecture.

The Amann Group has come a long way down the path of success with highly satisfied clientele and is well appointed with a skilled team of well-qualified Architects, Structural Engineers, Interior Designers and consultants on board.

Using the Public Private Partnership model, The Amann Group has successfully leveraged its core strengths and implemented several iconic infrastructure projects in Mumbai city.

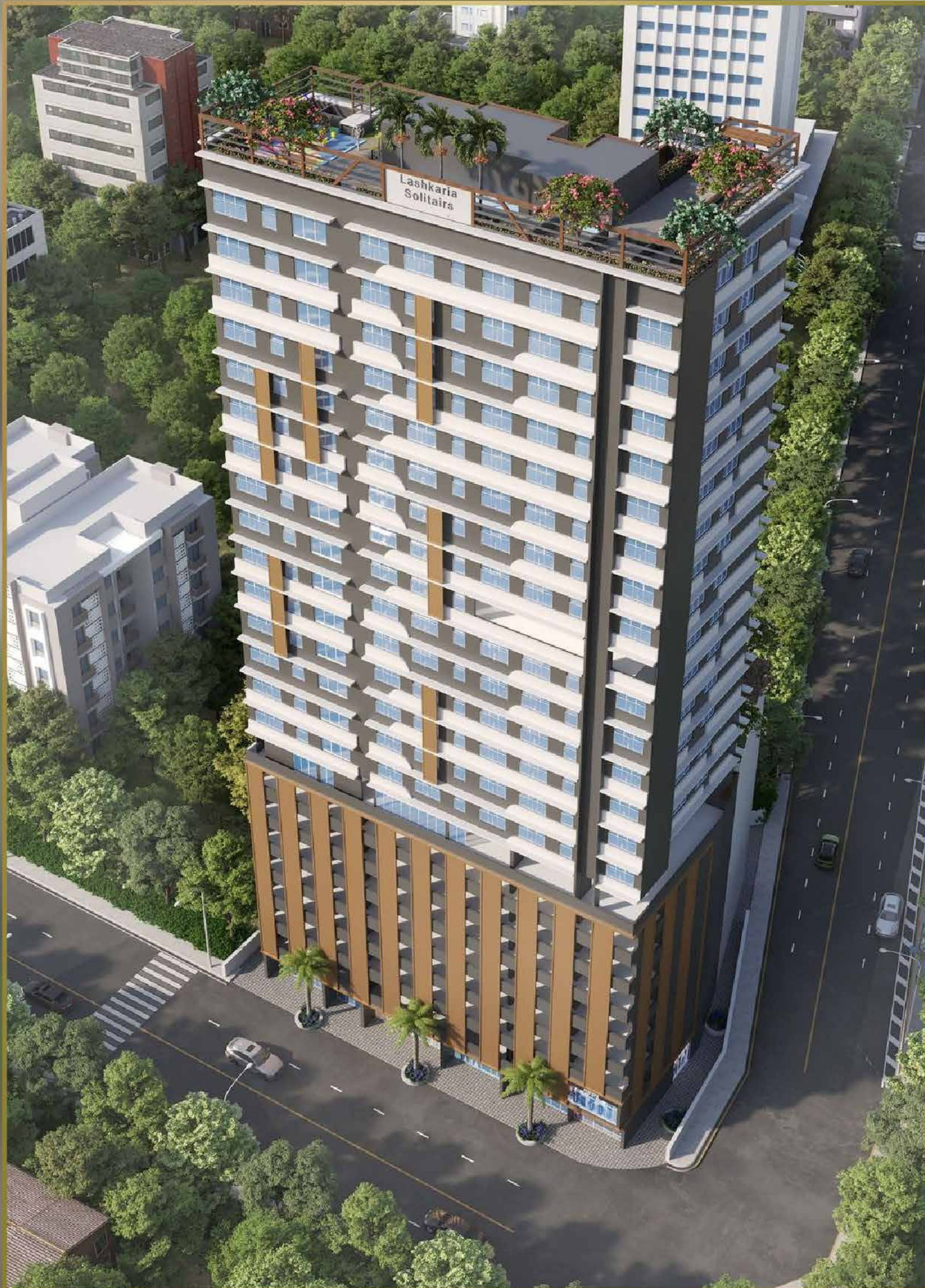

Experience International Lifestyle at its finest. Get a head start when it comes to luxurious living. Thoughtfully planned 2 & 3 bed residences intended to give your family ample room to unwind.



**COME HOME TO THE PLACE THAT BRINGS THE WORLD TO YOU.**



Attractive Elevation & Building Facade.



Luxury And Lifestyle Amenities.



Finest Connectivity.



Grand Entrance Lobby.



- Grand Entrance Lobby.
- High Speed elevators of reputed make OTIS, Schindler or Johnson equivalent shall be installed.
- A Club laced with various recreational activites, well equipped fitness center and a full furnished society office.
- Electronic security system for hassle free access and communication, firefighting systems along with host of security features will ensure your famillies security in the vent.
- Round the clock security to ensure your loved ones are secured. Mairdoor installed with door cam.



- Library
- CCTV
- Sky Garden
- Sky Cabana
- Sky Terrace
- Perfume Dispenser (Lobby)
- 24/7 Security
- Wi-Fi Ready
- Gated Community
- Double Heighted Lobby



- Games Room
- Kids Play Zone
- Gated Community
- Botanical Garden
- Cable Ready
- Fitness Centre (Gym)
- Senior Citizens Garden
- Multi Level Car Parking
- High Speed Elevators
- Furnished Society Office

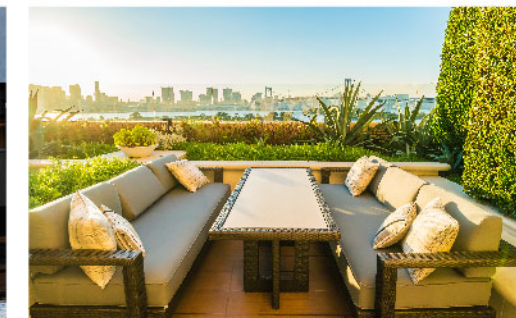
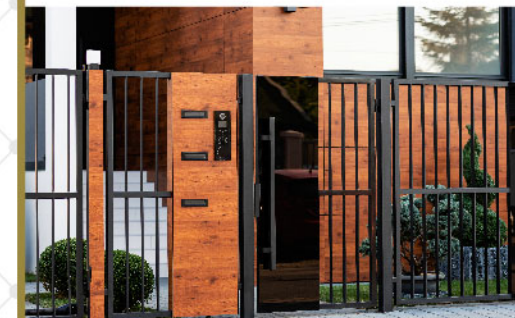

Solid R.C.C. Frames structure Designed as per seismic Zone II Standards.

Fixtures & Fittings: Premium grade fixtures & fittings to be used, utmost care and fine craftsmanship to endure a high grade and blemish free installation.

Italian flooring in hall, designer ceramic tile flooring upto door height in toilets / bathrooms along with brands like jaguar, Havell's, Roma.

Anodized aluminium / UPVC windows with tinted glass pressed designed flushed door in all rooms. Windows Protected with steel grill. Attractive main door with teak wood frames will be used to adorn your haven.

Air conditioner in all Rooms and Geyser installed in all bathrooms.

Granite platform with popular brands like Nirali make or equivalent S.S. Sink and Modular kitchen cabinets in the kitchen.

# 2 BHK

635 Sq. Ft.



# 3 BHK

905 Sq. Ft.



Flat Nos.	Flat Type	RERA Carpet Area
1	2BHK	635.00
2	2BHK	630.00
3	2BHK	630.00
4	3BHK	905.00



TYPICAL FLOOR PLAN

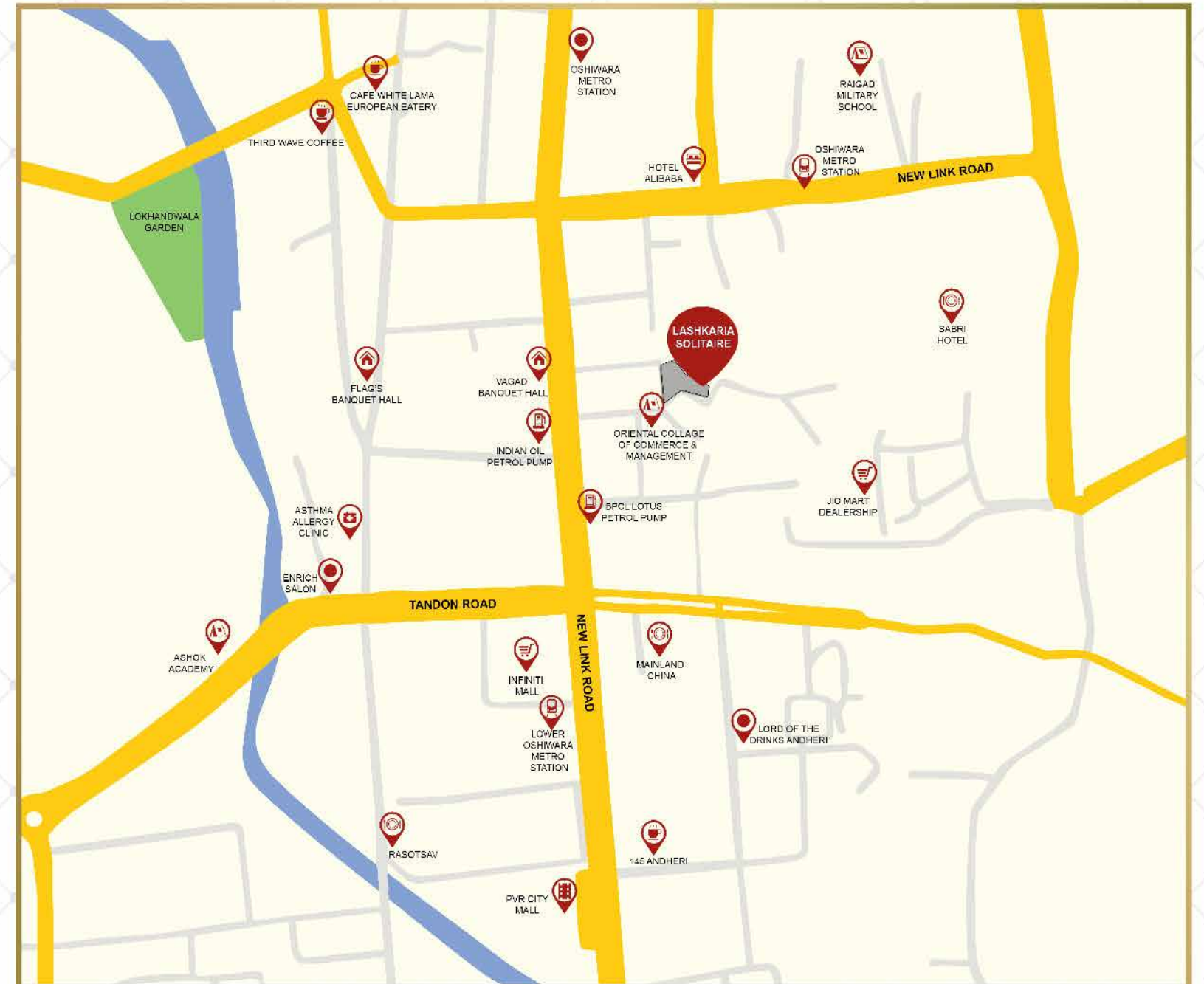

**0-5 min Education**  
 JBCN International  
 OEM International School  
 Oriental College of Commerce  
 And Managemen



**0-5 min Healthcare**  
 Kokilabhen Hospital  
 Blue Bell  
 Urban Health Care



**0-5 min Shopping**  
 Infinity Mall  
 Godrej Nature's Basket



**0-15 min Work Place**  
 Maruti Business Park  
 Veera Desai Industrial Estate  
 Cosmos Plaza



**0-5 min Restaurants**  
 Kailash Parbat  
 Starbucks Coffee



**0-5 min Entertainment**  
 Juhu Chowpatty  
 PVR Cinema  
 Club Lokhandwala



**0-5 min Connectivity**  
 Oshiwara Metro Station



**30 min Airport**  
 Chhatrapati Shivaji Maharaj



# Lashkaria SOLITAIRE

**Architects**

M/s. Kahaan Archipro Consultants

**Design Architects**

The Design Studio

**R.C.C Consultant**

Sura & Associates

**Legal Advisor**

Diamondwala & Company  
Advocates and Solicitors

Project by  
**THE AMANN GROUP**

**Head Office Address:**

1st Floor, Juhu Azad Nagar C.H.S., C. D. Barfiwala Road,  
Near New India Colony, Andheri (W), Mumbai - 400053.  
Tel.: 022 - 26256875 / 76 Email: theamanngroup@gmail.com  
Website: [www.amannhighlandpark.com](http://www.amannhighlandpark.com)  
ISO - 9001 - 2008 Company

**Site Address:**

Link Road, Next to Lotus Petrol Pump,  
Adarsh Nagar, Near Lokhandwala, Oshiwara, Andheri West