

A JOY FUL LIFE

A LANDMARK GATED COMMUNITY @ SEEGEHALLI, WHITEFIELD, KADUGODI, BANGALORE

Rera No. : PRM/KA/RERA/1251/446/PR/200817/003548





LIFE AT THE NEW EDGE OF LUXURY

The greatest designs present the greatest luxury.

Gaze upon the hustle below by from the realms of luxury, your residence your home, from where every state of art design perishes as you seek the best. The details leads to design enhancing into art.

A new edge to home. A new edge to luxury.

EXPERIENCE IT



DESAI'S
GOLDEN
SPRINGS

an artistic rendering desai golden springs night elevation view



WELCOME TO A NEW LEAGUE OF RESIDENTIAL TOWERS

Desai's Golden Springs is modern and distinct. The poetry of an alluring facade lies in the dramatic juxtaposed vertical. This quintessential design is a statement of luxury on it's own. Defined by a 'building block' pattern of balconies, clad in design, with elevated glass balconies, it is G+11 storied of pure architectural perfection. Its bold presence and sophisticated vernacular visual is a striking addition to Seegahali neighborhood of Bengaluru.

E X P E R I E N C E I T





BEAUTIFULLY CRAFTED COMMUNITY

EXPERIENCE IT

3 acres
2 guntas

2
Towers

286
units

LB+UB+G+
11 Floors

2, 2.5 & 3BHK
Flats

Clubhouse
with Swimming Pool

Indoor &
Outdoor games



an artistic rendering desai golden springs entrance gate



an artistic rendering desai golden springs elevation street view

PROJECT FEATURES

WITHIN THE SENSE OF ART LIES THE DESIGN

- ◆ Grand Entrance Lounge
- ◆ North, East and West Facing Units
- ◆ Designer Landscapes
- ◆ Swimming Pool with Toddler Pool
- ◆ Multi Purpose Hall
- ◆ Gymnasium
- ◆ Barbeque Counter
- ◆ Cycle Stand
- ◆ Adventure Climbing
- ◆ Mini Basket Ball Court
- ◆ Yoga and Meditation
- ◆ Flower Garden and Sr. Citizen Garden
- ◆ Screen/stage With Projector
- ◆ Festival Lawn
- ◆ Camp Fire
- ◆ Water Body
- ◆ Statue
- ◆ Sewage Treatment Plant
- ◆ Children's Play Area
- ◆ Welcome Lounge
- ◆ Seating Lounges
- ◆ Walking/ Jogging Track
- ◆ Resort Theme Landscape and Artifacts
- ◆ European Brand Fittings
- ◆ DG Power Backup for Flats, Lifts and Common Area Lighting
- ◆ Car Parking for Each Unit, Well-lifts
- ◆ Water Softening Plant

81%
Open
Space

Approved by
BDA

DESAI'S
**GOLDEN
SPRINGS**



an artistic rendering desai golden springs birds eye view

ELEVATED LIVING AT IT'S DESIGN BEST

Desai's Golden Springs is thoughtfully designed for your comfort and style, here each apartment is an epitome of fine living. Be it the master bedroom or the kitchen, each space is testament of form and function. From the finest fittings to every finish, here homes have been crafted keeping in the mind of the resident's ease.

INSIDE THE APARTMENT

- ◆ VITRIFIED TILES IN LIVING, DINING, ALL BEDROOMS AND KITCHEN.
- ◆ ANTI-SKID CERAMIC TILES FOR ALL BALCONIES, UTILITIES AND BATHROOMS
- ◆ PREMIUM QUALITY FITTINGS AND FIXTURES FOR THE BATHROOMS
- ◆ AIR CONDITIONING POINTS IN LIVING/DINING ROOM AND ALL BEDROOMS.

EXPERIENCE IT



MASTER PLAN

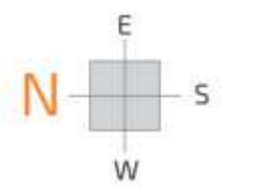

SENSES THAT TAKE YOU TO THE NEW EDGE OF LUXURY

The soul flourishes when the mind and body are at ease. The desire of world class amenities without stepping out is now real. The exclusively designed community club house welcomes you with plush interiors, artistic, tasteful ambience both indoors and outdoors along with a large pool and a lavish deck. Unleash your senses while socializing, sweating at the gym and relaxing outdoors.
A new edge A new you

EXPERIENCE IT



PLUSH FEATURES

WELCOME LOUNGE

SWIMMING POOL WITH TODDLERS POOL

CHILD SAFE PLAY AREA

MULTI-PURPOSE HALL

FULLY EQUIPPED STATE OF THE ART GYMNASIUM

SEATING LOUNGES

INDOOR GAMES
TABLE TENNIS, BILLIARDS,
FOOSBALL, CAROM AND CHESS

JOGGING / WALKING TRACK

RESORT THEME LANDSCAPE AND ARTIFACTS



an artistic rendering desai golden springs swimming pool view



DESAI'S
GOLDEN
SPRINGS

NATURE AND AMENITIES AT A NEW EDGE OF IT'S TUNE

Set yourself free in the fascinating out door spaces, with the well nourished landscaped creating beautiful panoramas of nature at it's best. Place yourself in the comfort of different flora zones and let the big leaf textures be the new retreat when you take a walk or a jog. The amphitheater and the open lawns, welcome each to small and big gatherings.

So be a social bird at this new edge of life.

A new edge A new tune.

EXPERIENCE IT



DESAI'S
GOLDEN
SPRINGS



ENJOY THE PERFECT ORIENTATION

EXPERIENCE IT

- 1) Seating Lounge
- 2) Amphitheatre
- 3) Party Lawn

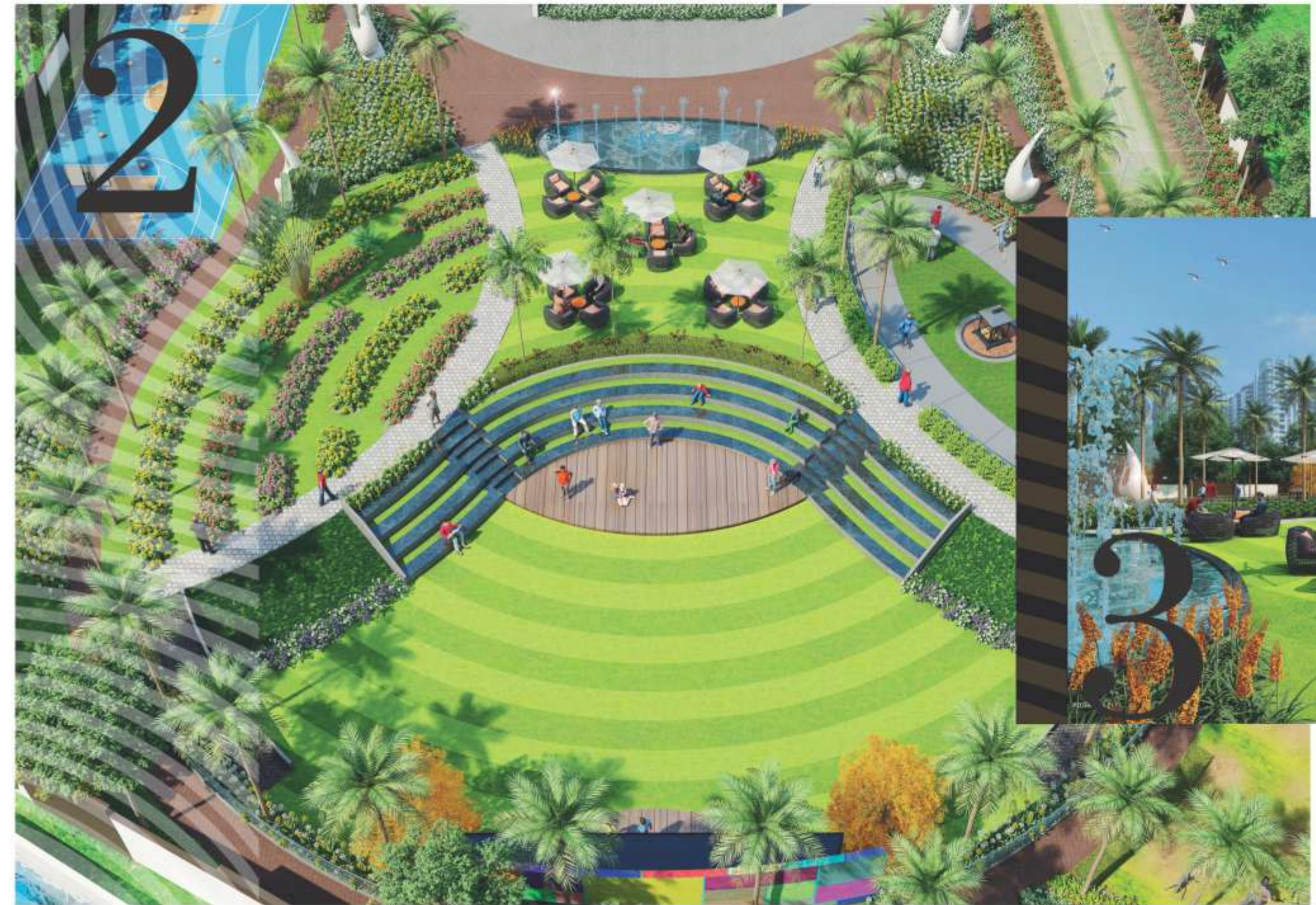

KIDS AT THE NEW EDGE OF JOY

The Desai's Golden springs are designed with kids activities in focus with large open areas and enough place where kids can jump, cycle or run. The specially designed equipment in the tot lots will keep them busy and active. Youngsters can practice cricket in nets, and play ball in different play courts. A separate kid's pool in the pool area and the large open areas for all your afternoon activities will take your kids to a new world.

A new edge A new joy of kids

EXPERIENCE IT



DESAI'S
GOLDEN
SPRINGS



ENJOY THE PERFECT ORIENTATION

EXPERIENCE IT



- 1) Mini Basket ball court
- 2) Shuttle Badminton court
- 3) Skating Rink
- 4) Kids Park
- 5) Cricket Practice nets



- 1) Elders Seating
- 2) Open Gym



WORK OUT OR RELAX



EXPERIENCE IT

TYPICAL FLOOR PLAN

Ground & First Floor Plan Tower A&B



AREA STATEMENT

| Flat No. | Flat Type | Carpet Area | Balcony | SBUP |
|----------|-------------|-------------|---------|------|
| 001 | 3BHK-North | 998 | 53 | 1441 |
| 002 | 2.5BHK-East | 798 | 51 | 1174 |
| 003 | 2.5BHK-West | 798 | 51 | 1174 |
| 004 | 2BHK-East | 777 | 47 | 1142 |

| Flat No. | Flat Type | Carpet Area | Balcony | SBUP |
|----------|-----------|-------------|---------|------|
| 005 | 2BHK-West | 795 | 48 | 1156 |
| 006 | 2BHK-East | 717 | 53 | 1058 |
| 007 | 2BHK-West | 716 | 52 | 1056 |
| 008 | 2BHK-East | 711 | 49 | 1046 |

| Flat No. | Flat Type | Carpet Area | Balcony | SBUP |
|----------|-------------|-------------|---------|------|
| 009 | 2BHK-West | 712 | 49 | 1046 |
| 010 | 2BHK-East | 779 | 46 | 1140 |
| 011 | 2.5BHK-West | 796 | 48 | 1176 |
| 012 | 2.5BHK-East | 798 | 51 | 1174 |

| Flat No. | Flat Type | Carpet Area | Balcony | SBUP |
|----------|-------------|-------------|---------|------|
| 013 | 2.5BHK-West | 798 | 51 | 1173 |
| 014 | 3BHK-West | 989 | 53 | 1428 |



TYPICAL FLOOR PLAN

2, 3, 4th Floor Plan Tower A&B



AREA STATEMENT

| Flat No. | Flat Type | Carpet Area | Balcony | SBUP |
|----------|-------------|-------------|---------|------|
| 214 | 2.5BHK-East | 798 | 51 | 1174 |
| 215 | 2.5BHK-West | 798 | 51 | 1174 |
| 216 | 2BHK-East | 777 | 114 | 1225 |
| 217 | 2BHK-West | 795 | 113 | 1241 |

| Flat No. | Flat Type | Carpet Area | Balcony | SBUP |
|----------|-----------|-------------|---------|------|
| 218 | 2BHK-East | 717 | 52 | 1057 |
| 219 | 2BHK-West | 716 | 48 | 1051 |
| 220 | 2BHK-East | 711 | 52 | 1050 |
| 221 | 2BHK-West | 712 | 48 | 1045 |

| Flat No. | Flat Type | Carpet Area | Balcony | SBUP |
|----------|-------------|-------------|---------|------|
| 222 | 2BHK-East | 779 | 104 | 1214 |
| 223 | 2BHK-West | 796 | 107 | 1234 |
| 224 | 2.5BHK-East | 798 | 51 | 1174 |
| 225 | 2.5BHK-West | 798 | 51 | 1173 |

| Flat No. | Flat Type | Carpet Area | Balcony | SBUP |
|----------|-----------|-------------|---------|------|
| 226 | 3BHK-West | 988 | 91 | 1477 |



TYPICAL FLOOR PLAN

5, 6, 7th Floor Plan Tower A&B



AREA STATEMENT

| Flat No. | Flat Type | Carpet Area | Balcony | SBUP |
|----------|-------------|-------------|---------|------|
| 513 | 2.5BHK-East | 798 | 127 | 1273 |
| 514 | 2.5BHK-West | 798 | 127 | 1273 |
| 515 | 2BHK-East | 777 | 102 | 1214 |
| 516 | 2BHK-West | 795 | 104 | 1233 |

| Flat No. | Flat Type | Carpet Area | Balcony | SBUP |
|----------|-----------|-------------|---------|------|
| 517 | 2BHK-East | 717 | 52 | 1057 |
| 518 | 2BHK-West | 716 | 48 | 1051 |
| 519 | 2BHK-East | 711 | 52 | 1050 |
| 520 | 2BHK-West | 712 | 48 | 1045 |

| Flat No. | Flat Type | Carpet Area | Balcony | Terrace | SBUP |
|----------|-------------|-------------|---------|---------|------|
| 521 | 2BHK-East | 779 | 110 | | 1225 |
| 522 | 2BHK-West | 796 | 111 | | 1241 |
| 523 | 2.5BHK-East | 798 | 88 | 624 | 2016 |
| 524 | 2.5BHK-West | 798 | 89 | 640 | 2035 |



TYPICAL FLOOR PLAN

Eighth Floor Plan Tower A&B



AREA STATEMENT

| Flat No. | Flat Type | Carpet Area | Balcony | SBUP |
|----------|-------------|-------------|---------|------|
| 801 | 2.5BHK-East | 798 | 80 | 1214 |
| 802 | 2.5BHK-West | 798 | 74 | 1207 |
| 803 | 2BHK-East | 777 | 102 | 1214 |
| 804 | 2BHK-West | 795 | 104 | 1233 |

| Flat No. | Flat Type | Carpet Area | Balcony | SBUP |
|----------|-----------|-------------|---------|------|
| 805 | 2BHK-East | 717 | 52 | 1057 |
| 806 | 2BHK-West | 716 | 48 | 1051 |
| 807 | 2BHK-East | 711 | 52 | 1050 |
| 808 | 2BHK-West | 712 | 48 | 1045 |

| Flat No. | Flat Type | Carpet Area | Balcony | SBUP |
|----------|-------------|-------------|---------|------|
| 809 | 2BHK-East | 779 | 110 | 1225 |
| 810 | 2BHK-West | 796 | 111 | 1241 |
| 811 | 2.5BHK-East | 798 | 80 | 1214 |
| 812 | 2.5BHK-West | 798 | 80 | 1214 |



N

TYPICAL FLOOR PLAN

Ninth Floor Plan Tower A&B



AREA STATEMENT

| Flat No. | Flat Type | Carpet Area | Balcony | SBUP |
|----------|-------------|-------------|---------|------|
| 901 | 2.5BHK-East | 798 | 126 | 1272 |
| 902 | 2.5BHK-West | 798 | 126 | 1272 |
| 903 | 2BHK-East | 777 | 61 | 1158 |
| 904 | 2BHK-West | 795 | 62 | 1174 |

| Flat No. | Flat Type | Carpet Area | Balcony | Terrace | SBUP |
|----------|-----------|-------------|---------|---------|------|
| 905 | 2BHK-East | 717 | 52 | 195 | 1306 |
| 906 | 2BHK-West | 716 | 48 | 179 | 1280 |
| 907 | 2BHK-East | 711 | 52 | 195 | 1300 |
| 908 | 2BHK-West | 712 | 48 | 179 | 1271 |

| Flat No. | Flat Type | Carpet Area | Balcony | SBUP |
|----------|-------------|-------------|---------|------|
| 909 | 2BHK-East | 779 | 59 | 1058 |
| 910 | 2BHK-West | 796 | 62 | 1177 |
| 911 | 2.5BHK-East | 798 | 129 | 1275 |
| 912 | 2.5BHK-West | 798 | 129 | 1276 |



TYPICAL FLOOR PLAN

10, 11th Floor Plan Tower A&B



AREA STATEMENT

| Flat No. | Flat Type | Carpet Area | Balcony | Terrace | SBUP |
|----------|-----------|-------------|---------|---------|------|
| 1001 | 2BHK-East | 777 | 65 | 1048 | 2498 |
| 1002 | 2BHK-West | 795 | 66 | 1047 | 2512 |
| 1003 | 2BHK-East | 717 | 52 | | 1057 |
| 1004 | 2BHK-West | 716 | 48 | | 1051 |

| Flat No. | Flat Type | Carpet Area | Balcony | Terrace | SBUP |
|----------|-----------|-------------|---------|---------|------|
| 1005 | 2BHK-East | 711 | 52 | | 1050 |
| 1006 | 2BHK-West | 712 | 48 | | 1044 |
| 1007 | 2BHK-East | 779 | 64 | 1080 | 2538 |
| 1008 | 2BHK-West | 796 | 66 | 1079 | 2555 |





HIGH-END IS AN UNDERSTATEMENT

IT'S ALL THE BEST THINGS THAT MAKE
THE BIG DIFFERENCE

STRUCTURE

Lower Basement, Upper Basement, Ground + 11 storied RCC framed structure with Seismic Zone II compliance (Earthquake resistance).

WALLS

Outer walls with 6" and internal walls with 4" Bricks.

PLASTERING

Internal Walls and ceiling are smoothly plastered with lime rendering.

External Walls and corridors are smoothly plastered.

PAINTING/POLISHING

Interior : Two coats of Birla putty, one coat of primer with two coats of emulsion paint with roller finish.

Exterior : One coat of primer and two coats of emulsion paint Enamel paint for MS grill/door shutters.

FLOORING

- 600 mm x 600 mm designer Kajaria make or equivalent Vitrified tiles for living, dining, all bed rooms and kitchen.

- Anti-skid ceramic tiles for all balconies, utilities, and bathrooms.

ELECTRICAL

- Fire-resistant electrical wires of Anchor make or equivalent.
- Elegant designer modular electrical switches of Anchor make or equivalent.
- Provision for geyser in all bathrooms, washing machine in utility room, refrigerator, microwave oven and water purifier in Kitchen.
- Television / cable / telephone point will be provided in living room and all bedrooms.

- Provision for air conditioning points in living / dining rooms and all bedrooms.
- For safety one Earth Leakage Circuit Breaker (ELCB) for each apartment and one miniature circuit breaker (MCB) for each room.

KITCHEN

- Provision of plumbing points for sink and electrical points to accommodate modular kitchens.
- Cladding with glazed tiles above kitchen platform with height up to 2'feet
- 30 mm thick black granite kitchen platform with stainless steel sink with bowl.

TOILET

- Superior quality of Ceramic tiles dado up to 7' height.
- EWC commode and wash basins (white color) of Hindware or equivalent make. Hot and cold valve mixer, pillar cock, health faucet in each toilet of half turn of standard make like Hindware or equivalent brand.
- Toilet ventilators are equipped with movable louvers and fixed glass with an exhaust fan point.

PLUMBING

- All water supply lines of CPVC / PVC Ashirvad or other reputed make
- Sewer line will be of reputed make
- All plumbing lines shall be pressure tested.

DOORS

- Main Door : High quality teak wood door frame with moulded skin shutter finish
- Internal Doors : Sal wood frames with moulded skin shutters and waterproof flush shutters for toilets and balconies.

SPECIFICATIONS

WINDOWS

All windows and French door are UPVC three track sliding shutters with mosquito mesh, plain glass and safety grills.

RAILING

Balcony railing with M.S
Staircase railing with M.S

LIFTS

Fully automatic passenger lifts of Kone make or equivalent.

* Amenities shall be provided within Six Months from the date of handing over the possession of the total apartment.

LOCATION PLAN
(NOT TO SCALE)



CONVENIENCE AT THE NEW EDGE OF BANGALORE

With its extraordinary location and unparalleled access to Bangalore's hottest entertainment destinations and most influential business districts, Desai Golden Springs is poised to become one of the city's most desired residential neighborhoods. Nestled at proximity to Seegahalli, Desai Golden Springs will be spoilt for choice among the Whitefield Drives and connectivity of city splendor. The Marathahalli, KR Puram and Belathur, with their lively working spaces; retail, hospitality and entertainment options are just a drive away from the community. It is also minutes from International Airport for supreme ease of traveling to other domestic or international locations.

LOCATION HIGHLIGHTS

- Educational institutions such as Deens Academy, Whitefield Global School, Sri Satya Sai Institute of Higher Learning, Valistus International School, Chrysalis High School, Delhi Public School, Pragathi School, and so on nearby
- International Technology Park Bangalore (ITPB) within 10minutes drive
- Whitefield, the IT hub of the city, in the immediate neighbour hood
- Whitefield Railway Station & Bus stop withing walking distance
- Malls such as Big Bazaar, Cosmos Mall, Forum Value Mall and Phoneix Mall are close by
- For leisure - Multiplex, family restaurants, pubs, clubs and star hotels within walking distance or 10minutes drive
- For health, many hospitals including Aaxis Hospital, Manipal Hospital, Columbia Asia hospital, Vydhehi hospital, Sri Satya Sai Super Speciality Hospital about 5-10 minute drive



KNOWING THE DETAIL.

FOCUSING AREAS WE KNOW, ENSURES
WE DELIVER A GREAT CUSTOMER EXPERIENCE

Experience extraordinary living, our homes are handcrafted with a personal touch. Everything we plan, design and build are about people. We apply ourselves to exceed their expectations and multiply their happiness. Our mission is to continue creating delightful buildings and well-crafted living spaces.

Completed Project



DESAI'S RADIANT
@ whitefield



DESAI'S GRANDEUR
@ whitefield



DESAI'S ORCHID
@ whitefield



DESAI'S BEAU MONDE
@ whitefield

for more details

Office Address

Desai Developers, No.90, K.B Homes, Green Garden Layout,
Sai Baba Temple Road, Near Kundalahalli gate,
Marathahalli, Bangalore - 560 037.

Site Address

Sy No.91/1, 91/2 and 91/3, Seegehalli Village, Opp. Mahaveer Amaze,
Behind HP Petrol Pump, Chrysalis High School Road,
Near Sri Sathya Sai Baba Ashram, Whitefield, Kadugodi, Bangalore-560 067.

Contact: **+91 9620608021, 9945500039, 9945500069, 8884455659, 8884455679**

E-mail: desaigoldensprings@gmail.com
sales@desaidevelopers.co.in

Web: www.desaidevelopers.co.in

Note :

This document has been produced by the developer for advertising and general information only. The developer and its project team do not guarantee, warrant or represent that the information contained within this document is correct. Any interested party should undertake their own enquiries as to the accuracy of this information. The developer excludes unequivocally all inferred and implied terms, conditions and warranties arising out of this document and excludes all liability for loss or damage arising there from. Images shown are Artist Impression and shown for illustrative purposes only. The plans are based on the current design for this development. Changes will undoubtedly be made through development, and dimensions, fittings, finishes and specifications are subject to change without notice. The location of all architectural features on the façade including vertical panels and fins will vary on each type plan and level. Their location on the marketing material is indicative of the design intent. The information contained herein is believed to be current, but is not guaranteed. Prospective purchasers must rely on their own enquiries. Furniture is not included. This document is for guidance and does not constitute an offer of contract.

team

architects



POORNAKRITI ARCHITECT
Ph.: +91 80 23412353

structural engineering



ADHARSHILA
ADHARSHILA STRUCTURAL
Cell : +91 94496 95192

branding



Hyderabad
Cell: +91 98491 92657



www.desaidevelopers.co.in