

आधार वैशाली एस्टेट

आपका सपना हमारा प्रयास

प्रधानमंत्री एवं मुख्यमंत्री आवास योजना के तहत



 **aadhar**
perfect homes
1&2 BHK APARTMENTS



7th Floor, Apex Mall, Lal Kothi, Tonk Road, Jaipur-302015 (Raj.)
Fax: 0141-4036320 Website : www.manglamgroup.com | email : info@manglamgroup.com

All Cheque and DD in favour of : **Manglam Home Construction Co.LLP - Aadhar Vaishali Estate**

For Site Visit & Booking : **0141-4311199**

Disclaimer: This printed material does not constitute any form of agreement and all the purchases shall solely be governed by the terms of the agreement for sale. All finishes are subject to change at the discretion of the Developer and / or the Architects. The images used in this brochure are for illustration purpose only whereas the rendered images are close to actual.

Manglam
aadhar
 perfect homes

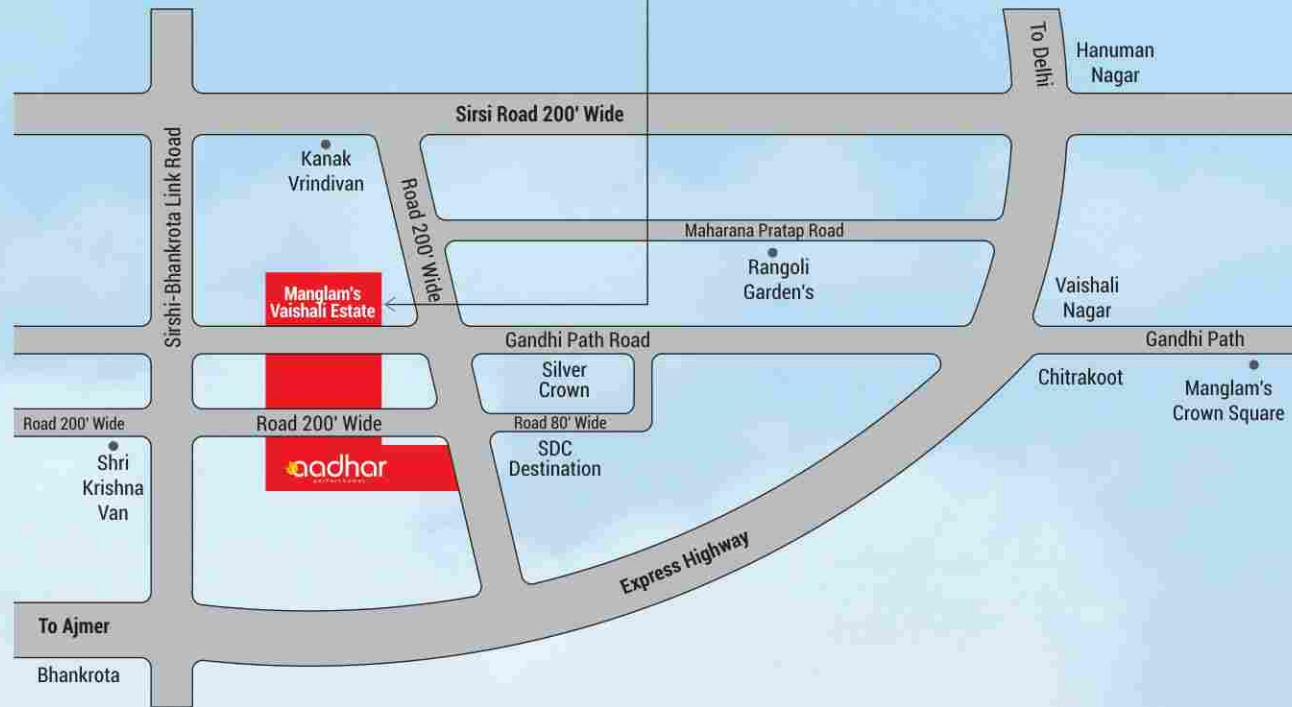

Location Map | Not to Scale

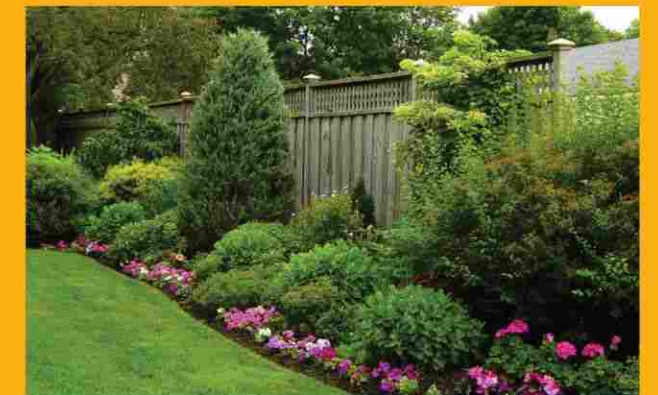

Manglam
aadhar
perfect homes

1&2 BHK APARTMENTS



Perfect Location at Perfect Price

Manglam Build Developers works on a clear vision "आपका सपना हमारा प्रयास". Manglam Aadhar work towards fulfilling the dream of every person's own home. Manglam Aadhar is not just a residential project, but it also holds a mission to give everyone their dream home. Under Pradhan Mantri Janvas Yojna Manglam Aadhar is a project which is available in 1, 2 and 3 BHK. Manglam Aadhar is located at your dream destination Gandhi Path, Vaishali Nagar which makes it easier to socialize with people along with a wide range of nearby facilities.

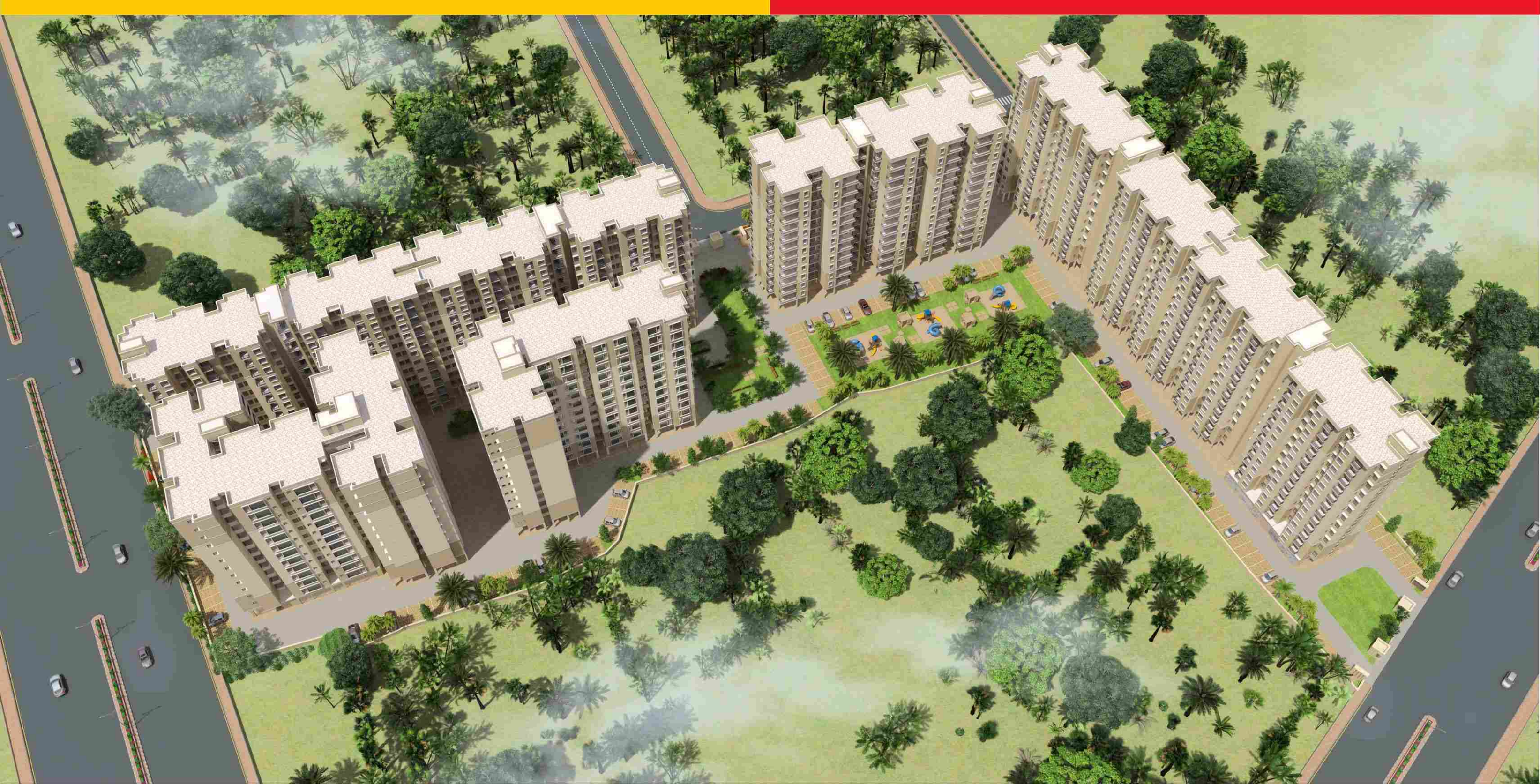

Avail Upto
₹2.67 LACS
Interest Subsidy
under **CLSS***

General Amenities

1. Community / Activity Centre
 - a) Yoga Deck
 - b) Library
 - c) Carom Room, Chess
 - d) T. T.
2. Open Gymnasium
3. Garden with Landscape
4. Children's Play Area
5. 24 Hrs Security
6. Power Back up for Common Area



SECTOR ROAD 200'-0" WIDE

ROAD 40'-0" WIDE

ROAD 40'-0" WIDE

ROAD 40'-0" WIDE

ROAD 30'-0" WIDE

ROAD 30'-0" WIDE

EXISTING ROAD 40'-0" WIDE

H.T. LINE 132 K.V. (27.00 MTR WIDE)

27.0M



Manglam
aadhar
 perfect homes
 1&2 BHK APARTMENTS



SITE PLAN



- EWS - 1 BHK = 228 Nos.
- LIG - 2 BHK - Type-1 = 600 Nos.
- LIG - 2 BHK - Type-2 = 168 Nos.
- 3 BHK = 120 Nos.



3 BHK+ 2 TOILET

Built-Up Area - **759 Sq.ft.**

50% Balcony Area **66.70 Sq.ft**

Carpent Area - **645 Sq.ft.**

Saleable Area - **918 Sq.ft.**



2 BHK TYPE-2

Built-Up Area - **654 Sq.ft.**

Carpent Area - **618 Sq.ft.**

Saleable Area - **791 Sq.ft.**





2 BHK TYPE-1

Built-Up Area - **500** Sq.ft.

Carpet Area - **450** Sq.ft.

Saleable Area - **605** Sq.ft.

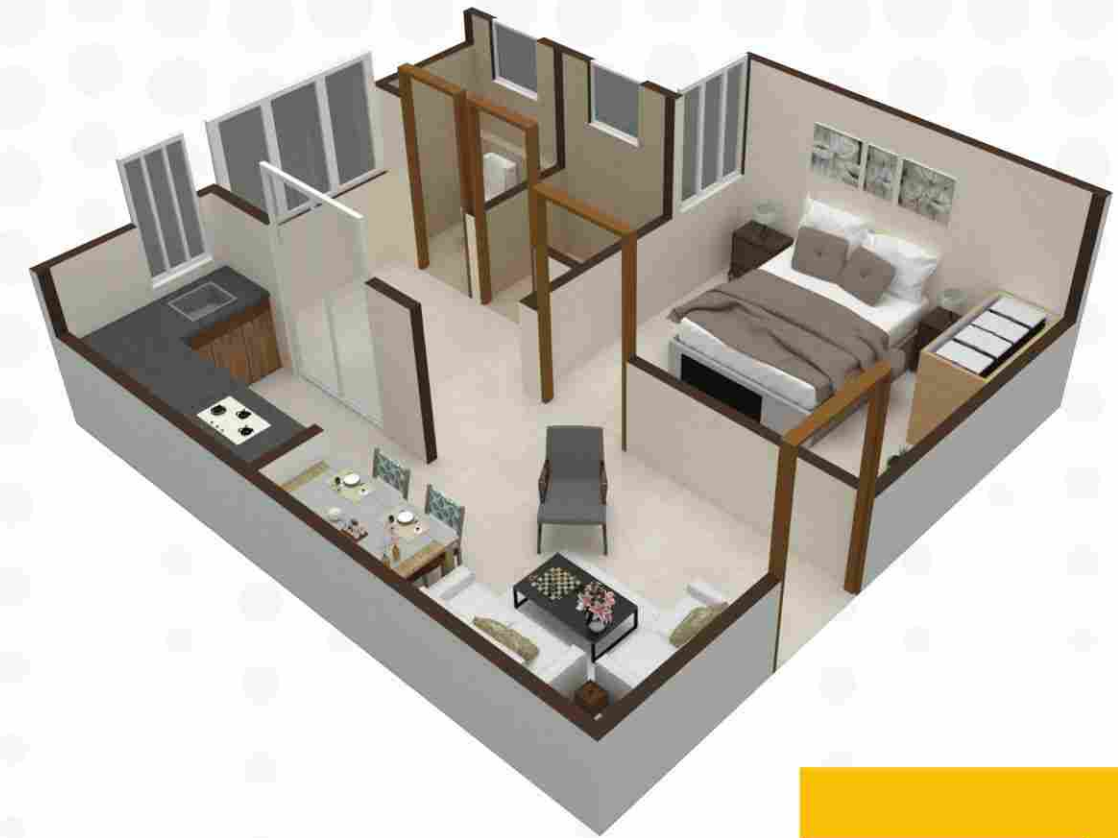

1 BHK

Built-Up Area - **348** Sq.ft.

Carpet Area - **325** Sq.ft.

Saleable Area - **421** Sq.ft.

