

VKR
Paradise
YOUR DREAM HOME



2 & 3 BHK Luxury Flats @ Uttarahalli,
Near N P S School, BSK VI Stage, off Kanakapura Main Road



Stop Dreaming...
Start Living...



GROUND FLOOR PLAN



EAST BY ROAD

NO COMMON WALLS

TYPICAL FLOOR PLAN

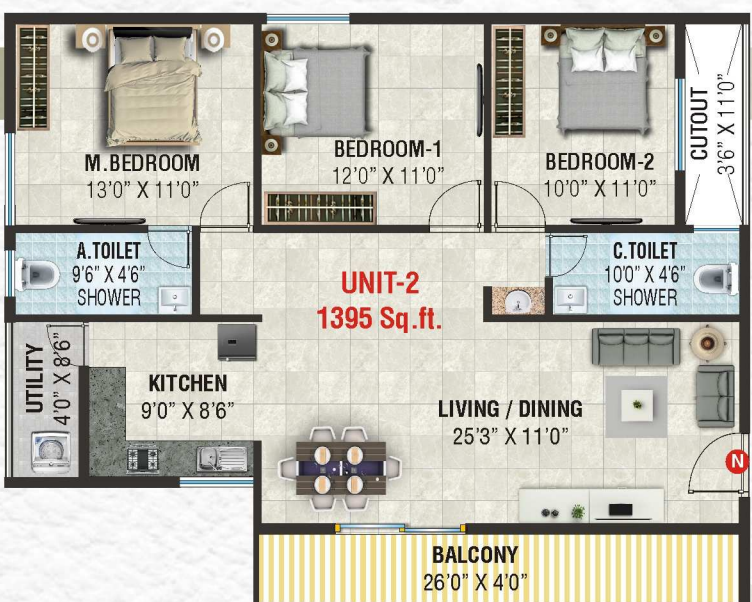

KEY PLAN

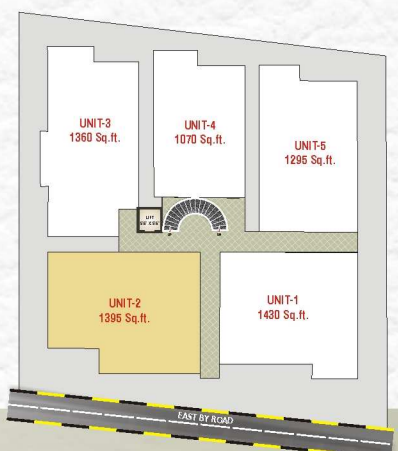

PVKR Paradise
YOUR DREAM HOME



STRUCTURE:

- RCC framed structure to withstand wind and seismic loads as per BIS.



SUPER STRUCTURE:

- Solid cement block masonry, plastering with smooth finish in cement mortar.



FLOORING :

- 2' x 2' vitrified tiles in hall, dining and in all the rooms and ceramic tiles in toilets, wash area and balconies.



PLASTERING :

- External: Weatherproof ACE paint of Asian/ICI or equivalent make.
- Internal: Smooth wall putty finish with acrylic emulsion paint of Asian/ICI along with 2 coat putty and 2 coat paint.



PAINTING:

- **Asian Paints:** Interior Emulsion Paint, External ACE, Enamel Paint for MS grill/door



ELECTRICAL:

- Providing Concealed copper wiring of good make, Power outlets for air conditioners, geysers, chimney, refrigerator, microwave, mixer etc.,
- Miniature circuit breakers (MCB) for each distribution board of reputed make.
- Providing AC point in master bedroom.
- TV and Telephone Point in living and master bedroom.
- Anchor Modular switches.
- Telecom/broadband Provision for telephone and broadband and cable TV in living and master bedroom.
- Intercom or appropriate security features will be provided.



DOORS:

- **Main Door:** Teak wood frame with teak laminate shutters, Internal Doors: Teak wood frames with best quality flush doors.



WINDOWS:

- 3 track UPVC sliding windows.



KITCHEN:

- 20mm L type Granite platform with stainless steel sink with adequate power points and provision for cabinets, exhaust fan, aqua guard and chimney.
- Dadoing in kitchen: Glazed ceramic tiles dado up to 2' height above the kitchen L type 20mm granite platform.
- Power point provision for drinking water purifier Refrigerator, cooking range and exhaust fans.



WATER SUPPLY:

- **24 Hours water supply** from bore well with overhead tank and sump & Cauvery water Provision.



COMMON AREAS:

- Staircase & common area: sadarahalli Granite in flooring with 4" skirting, and also in stairs.



BATHROOMS:

- All toilets consist of basic model of washbasin with EWC floor mounted with flush tank of reputed make, Hot and cold wall mixer with shower All ISI approved.
- Provisions for Geysers in all the toilets, all C.P. fittings of standard make.
- Glazed ceramic tiles of good quality dado up to door level.
- Utilities and wash: Glazed ceramic tile dado upto 3' height..
- Utilities/wash: Provision for washing machine and wet area for washing utensils, etc.,



GENERATOR:

- Providing 1 KVA/ flat as standby power supply to all the flats and common areas.
- Lifts: 1 lift of reputed make with power backup



Amenities, Provided at the Project



CCTV at common areas.



1 Lift of 6 passenger capacity



Car Parking

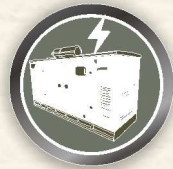

Power Backup 24 hrs



Intercom Facility



Rain Water Harvesting



24 Hrs Security

Details of the Common Areas

- Set back area and open spaces in the Project.
- Terrace. • Lobbies. • Corridors. • Staircases.
- Driveways.



How to reach our Project



DISTANCE FROM :

- Majestic-13 Km • Central Railway Station-13 Km • Airport-45 Km

NEAR BY EDUCATION INSTITUTION:

- National Public School
- Jnana Sweekar Public School • The Valley Intl. School • Kumaran's School
- Delhi Public School • Alpin Public School • Ryan Intl. School • YDIT KSIT College
- Yeshswi Intl. • School RMS School EKYA School • Insight Academy Jain College
- Jyothi Kendriya Vidyalaya

NEAR BY SHOPING MALL:

- Royal Mart • MERTO Cash & Carry
- Mantri Mall (Upcoming) • Forum Mall (Upcoming) Brand Factory

NEAR BY YOGA MEDITATION CENTRE:

- Art of Living • Siddi Samadhi
- Yoga-Doddamaralavadi • Sri Ram Chandra Mission-Sahaj Spirituality Foundation

NEAR BY ENTERTAINMENT:

- Mantri Mall (Upcoming) • Forum Mall (Upcoming)
- Angana The Country Inn • Vishranthi Dhama resort • The Club Shakthi Resort
- Amazing Karting Club & Resort

NEAR BY EAT OUTS:

- A2B Restaurant • Athithi Grand • Adigas • Pizza Hut
- New Beidgeway Family Restaurant • Swaad Restaurant
- Heavens Dhaba • Flavour of Shanghai • Swadeshi Restaurant



Parking in Basement floor Plan

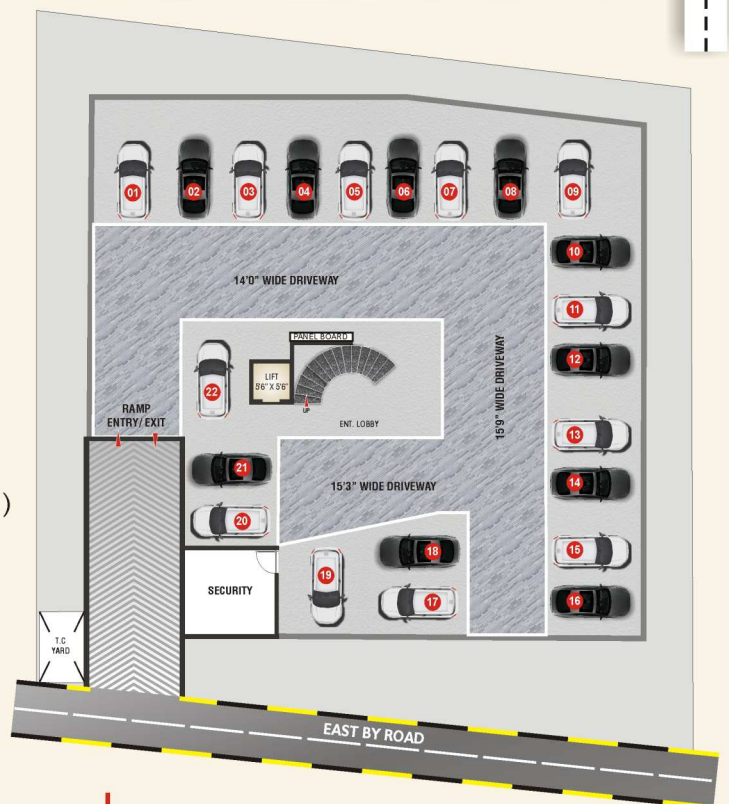

- Office @ :** # 46 Ground Floor Hemavathi Layout, Near Poornaprajna Layout, opp to Arahalli bus depot Uttarahalli Main Road Bengaluru 560061.
- Project @ :** Survey No 84, Behind Sculpture Park, BSK VI Stage, BHCS Layout, Uttarahalli Hobli, Bengaluru 560061.
- vkparadise@gmail.com**

For Booking Contact :

- +91 98455 66299**
- +91 99161 28086**