



*Renders are used for illustrative purpose only



Floor Plans

Welcome to life at Lake City

A one-of-its kind township that's just 20 minutes via outer ring road, this also happens to be one of the largest townships of its kind. Over half a kilometer of Lake frontage, it's 32 acres of sheer wow. So come check it out and we're sure you'll find something that works for you and your family. We're excited to have you over. So what's in store? 1, 2 and 3BHK units with more than 50% of the units facing the lake in the current phase.

The current phase also consists of 2 towers with 1400 units. 3 more residential towers and a commercial Tower with Multiplex are in the pipeline.

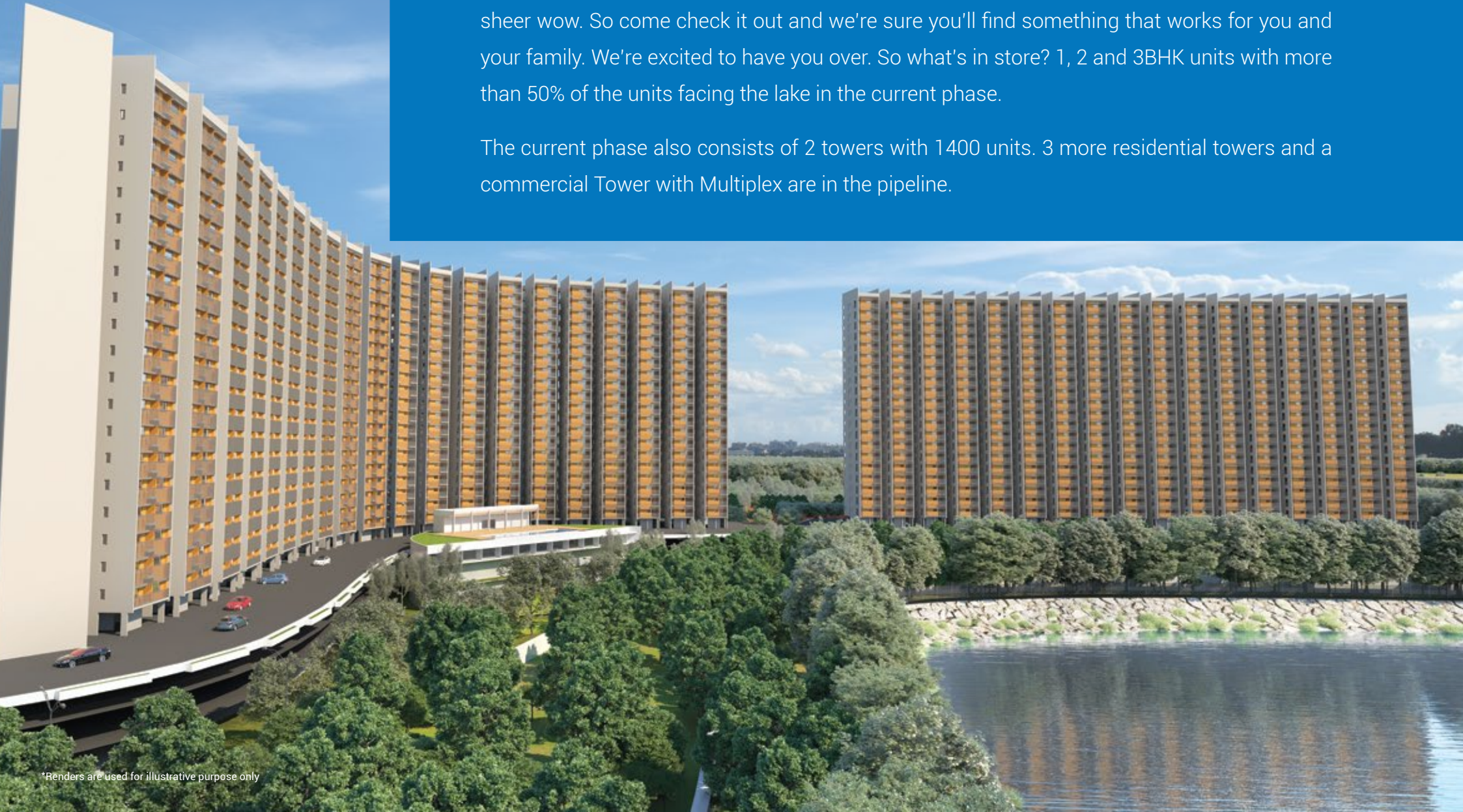

Master Plan



LEGEND

- | | | |
|-----------------------|-------------------------------|----------------------|
| 1. Apartment Entrance | 8. Court For Elderly | 15. Tower B |
| 2. Future Expansion | 9. Tower A | 16. Tower C |
| 3. Future Expansion | 10. Drive way and car parking | 17. Court for youth |
| 4. Future Expansion | 11. Transformer Yard | 18. Future Expansion |
| 5. Security Cabin | 12. Court for mother & child | 19. Future Expansion |
| 6. Lake Bund | 13. Clubhouse I | 20. Court for common |
| 7. Bund Road | 14. Court for children | 21. Future Tower E |

MASTER PLAN

SAKHI LAKE

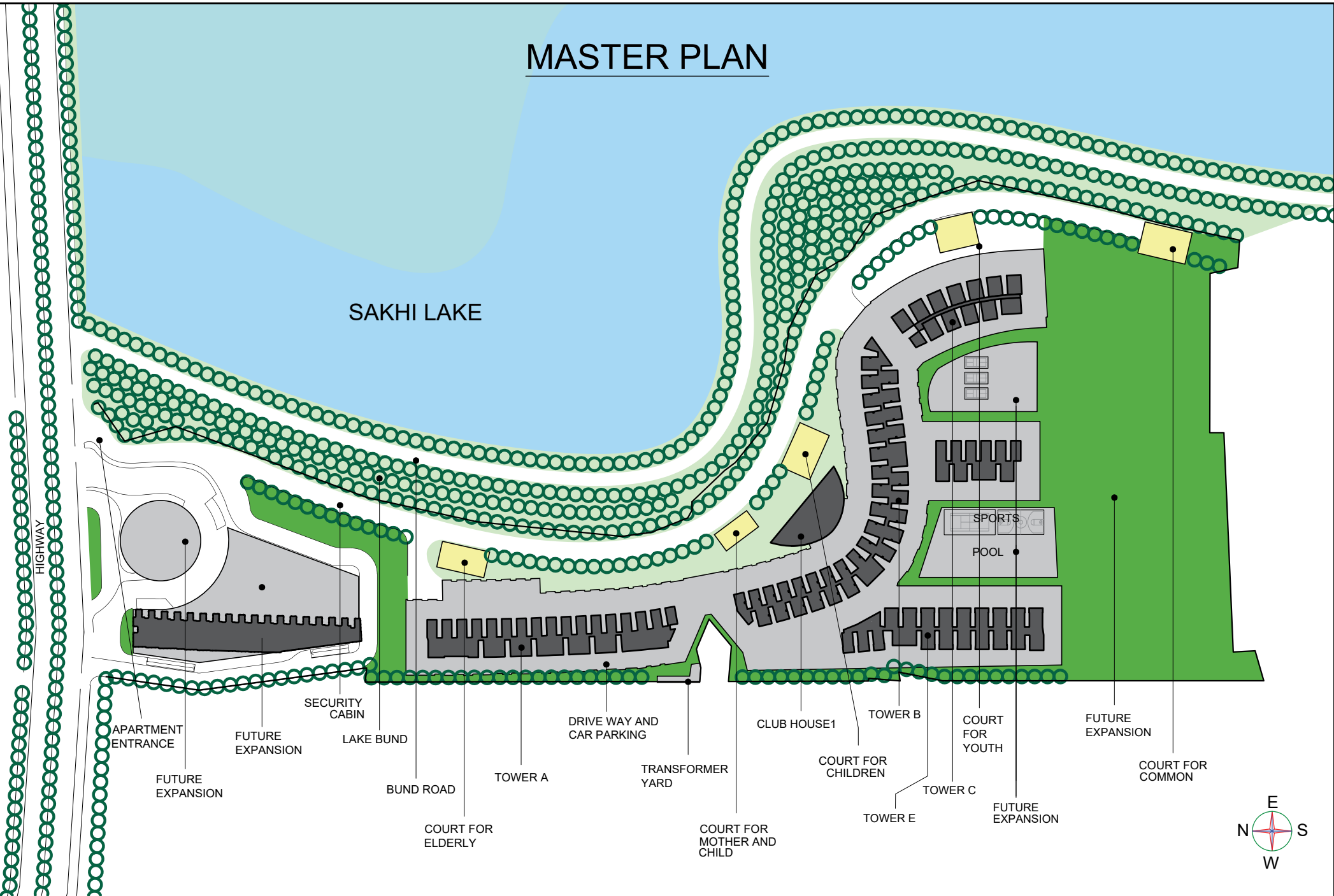

HIGHWAY

APARTMENT
ENTRANCE

FUTURE
EXPANSION

SECURITY
CABIN

LAKE BUND

BUND ROAD

COURT FOR
ELDERLY

TOWER A

DRIVE WAY AND
CAR PARKING

TRANSFORMER
YARD

COURT FOR
MOTHER AND
CHILD

CLUB HOUSE 1

COURT FOR
CHILDREN

TOWER E

TOWER B

TOWER C

COURT FOR
YOUTH

FUTURE
EXPANSION

SPORTS

POOL

FUTURE
EXPANSION

COURT FOR
COMMON

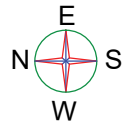

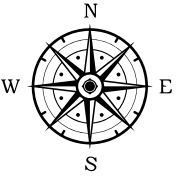

- Nearest School/College: 1 Min
- Nearest Hospital: 1 Min
- Nearest Shopping Centre: 5 Mins
- Financial District: 25 Mins
- Metro Terminus: 20 mins
- Airport: 30 Mins

TOWER A

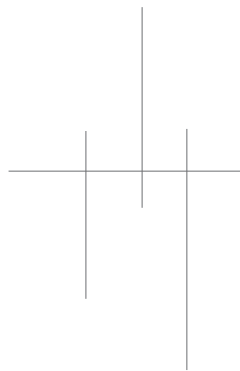
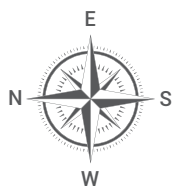

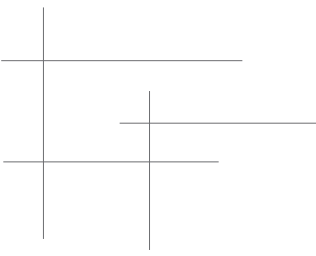
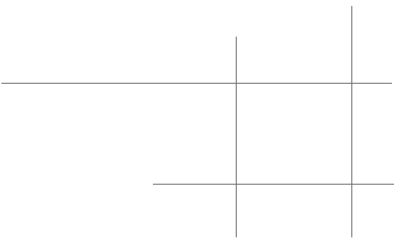

1 BHK

East Facing

Area: 794 sft

No's: 18, 19, 32, 33



KEY PLAN Tower A

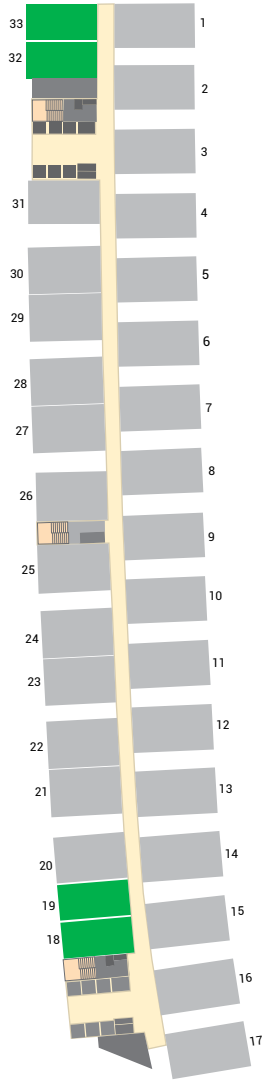

2 BHK

East Facing (N)

Area: 1062 sft

No's: 21, 23, 25, 27, 29, 31



ENTRANCE

KEY PLAN Tower A

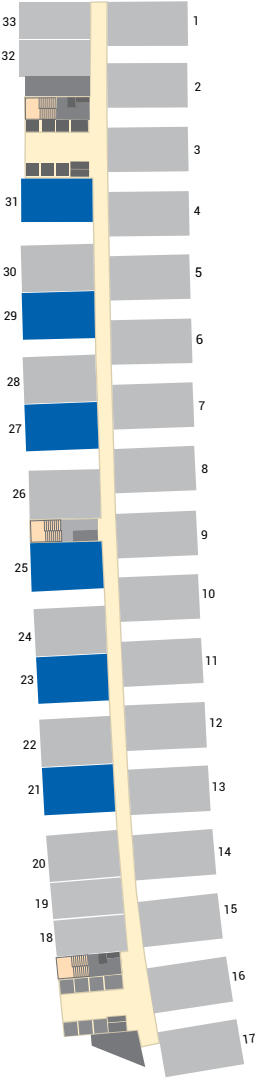

2 BHK

East Facing (S)

Area: 1113 sft

No's: 20, 22, 24, 26, 28, 30



KEY PLAN Tower A

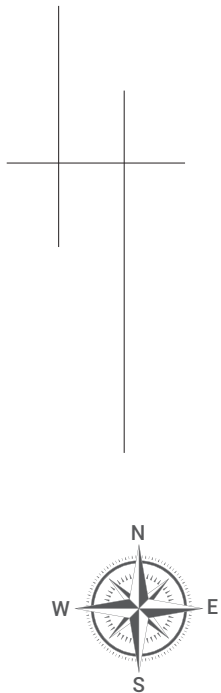
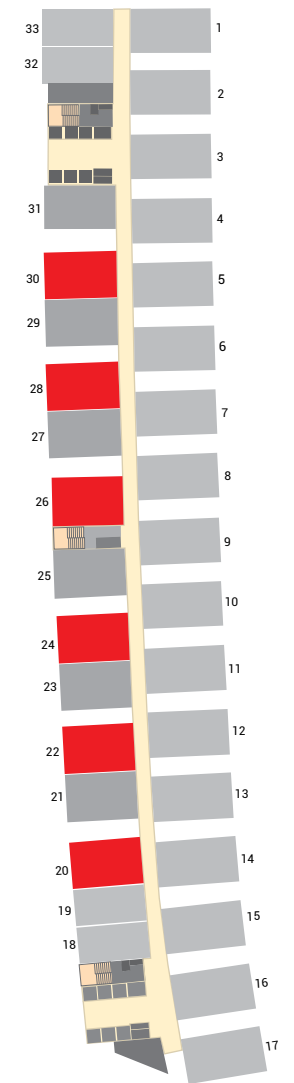

2 BHK

West Facing
 Area: 1101 sft
 Tower B: 1-10
 Tower A: 1-17



KEY PLAN
 Tower B

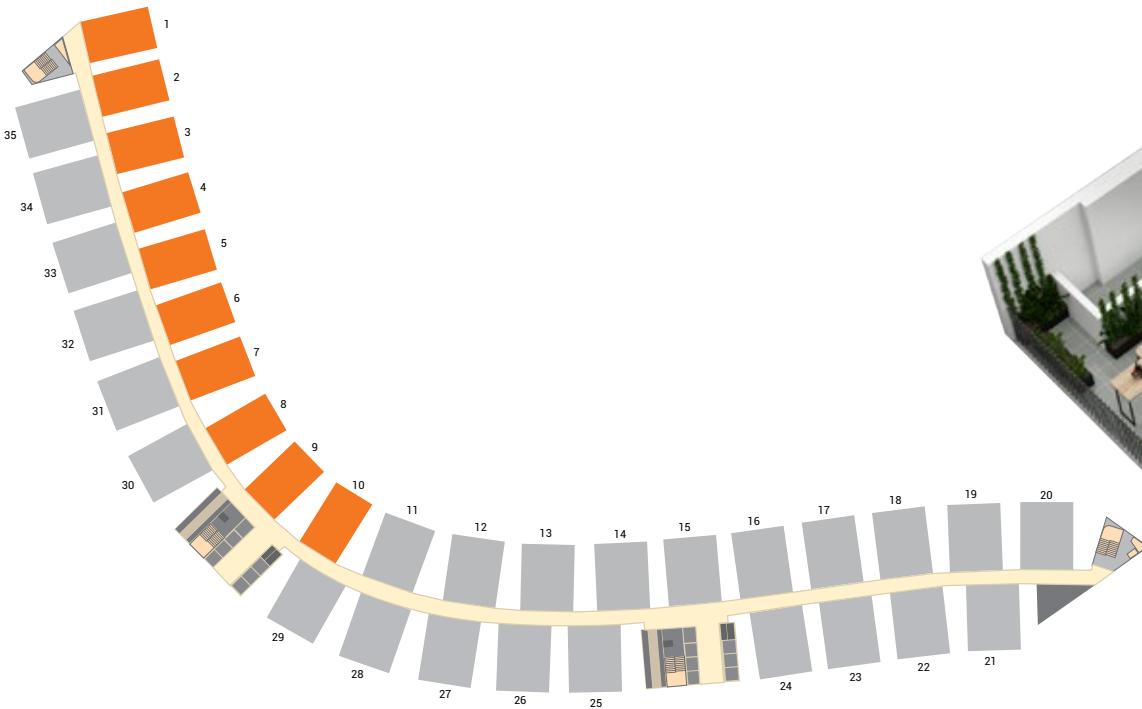

KEY PLAN
 Tower A

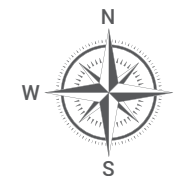
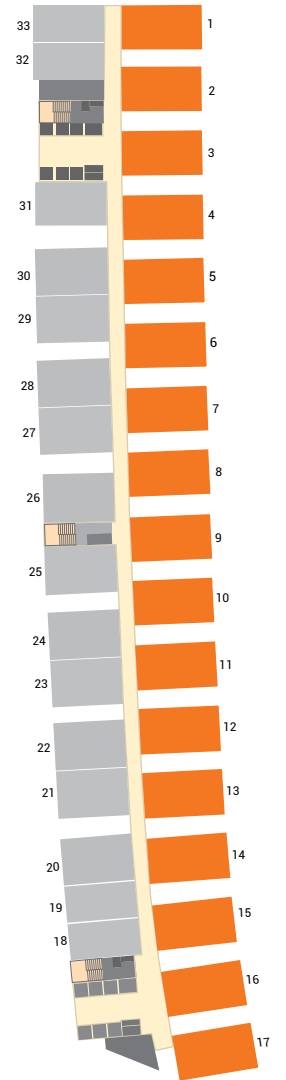

TOWER B

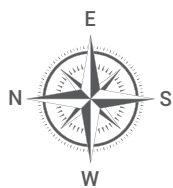
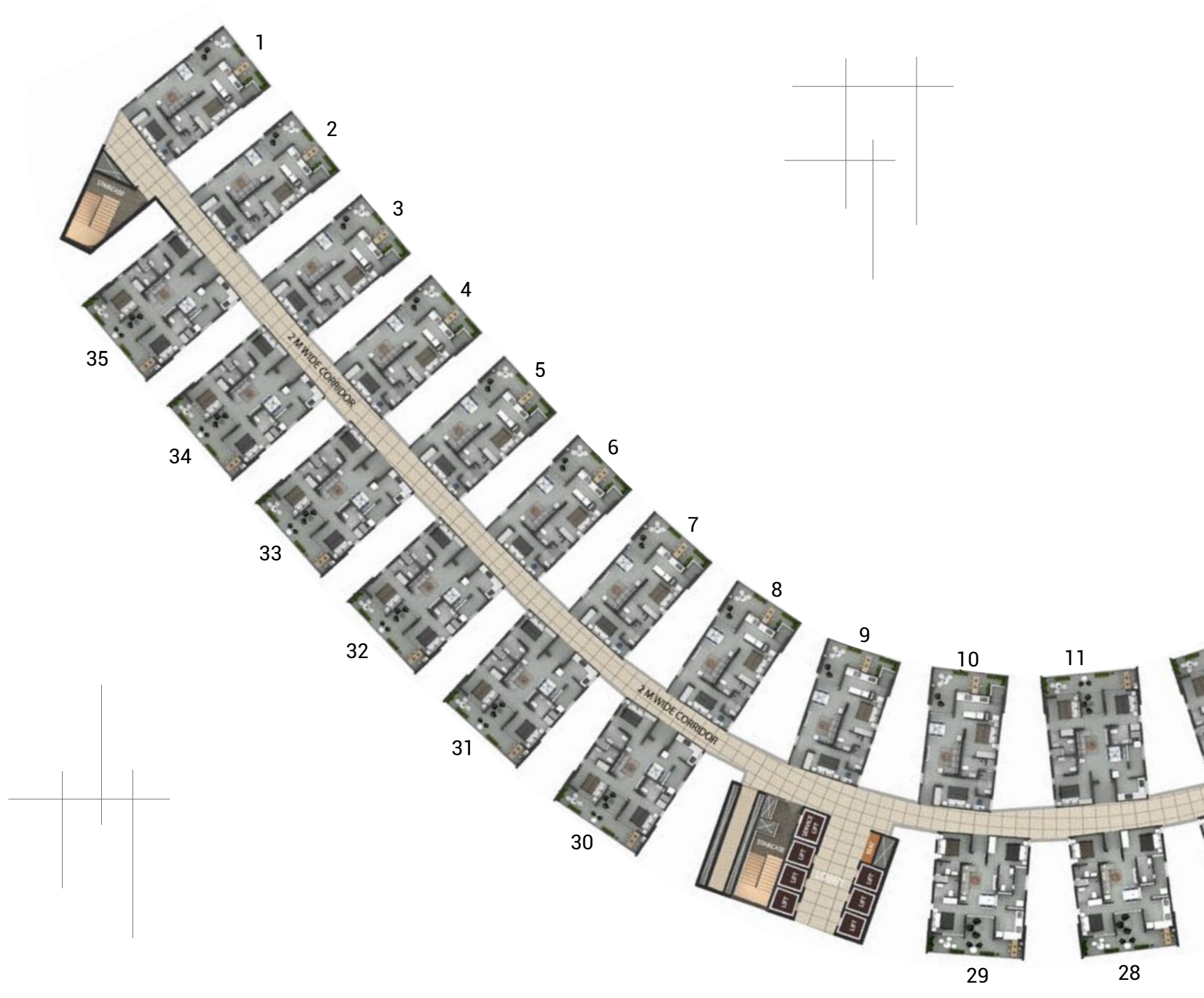

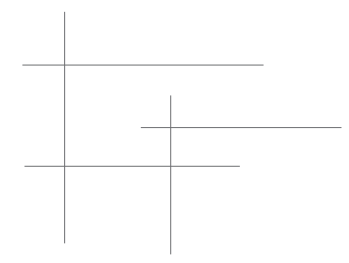
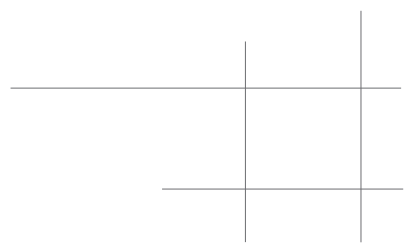
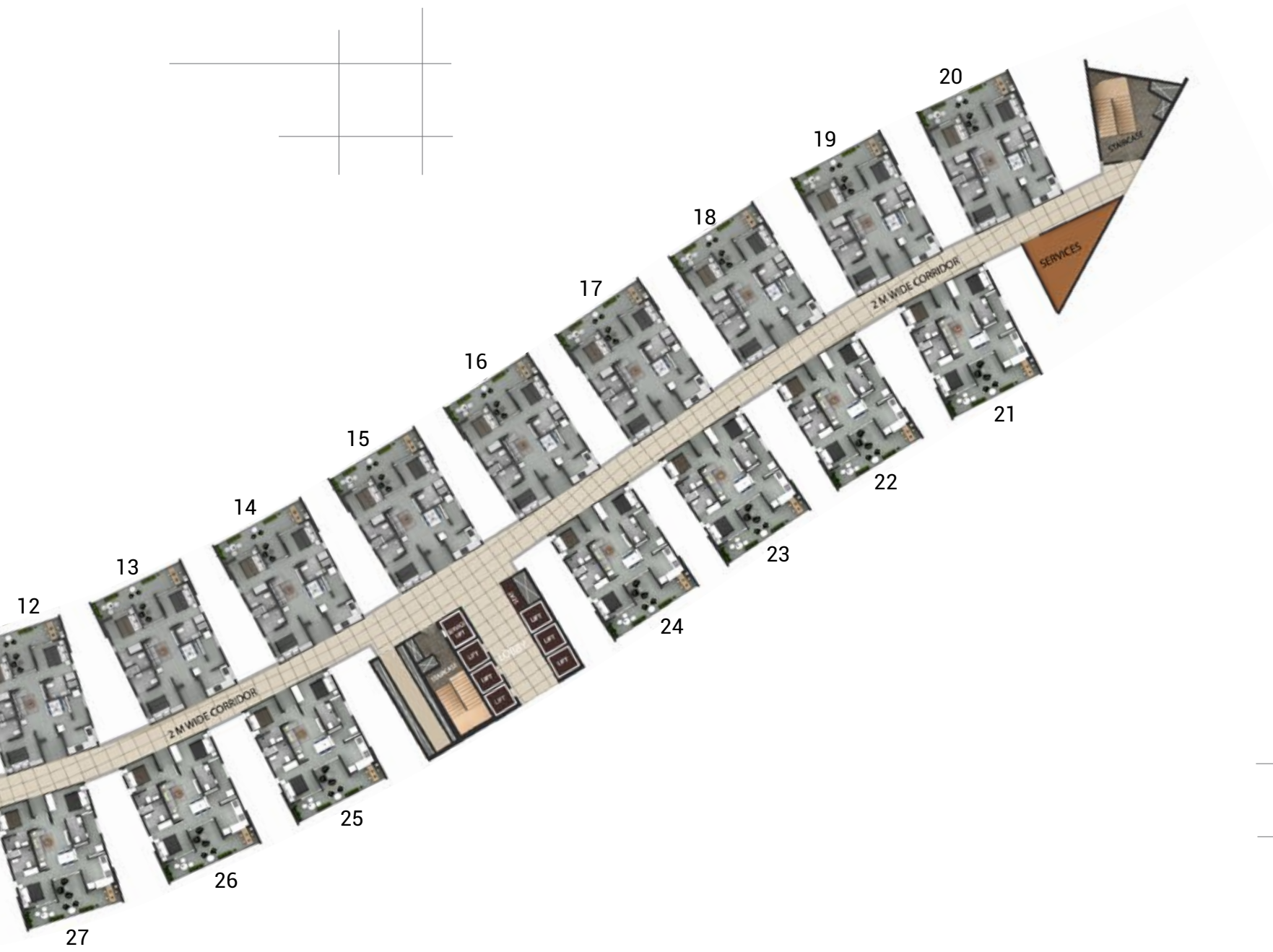

3 BHK

East Facing
Area: 1369 sft
No's: 30-35

KEY PLAN Tower B

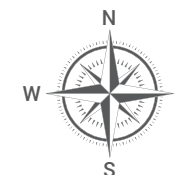
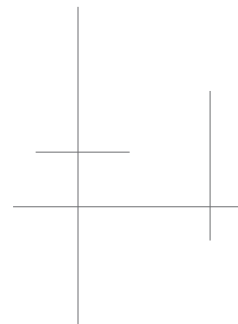
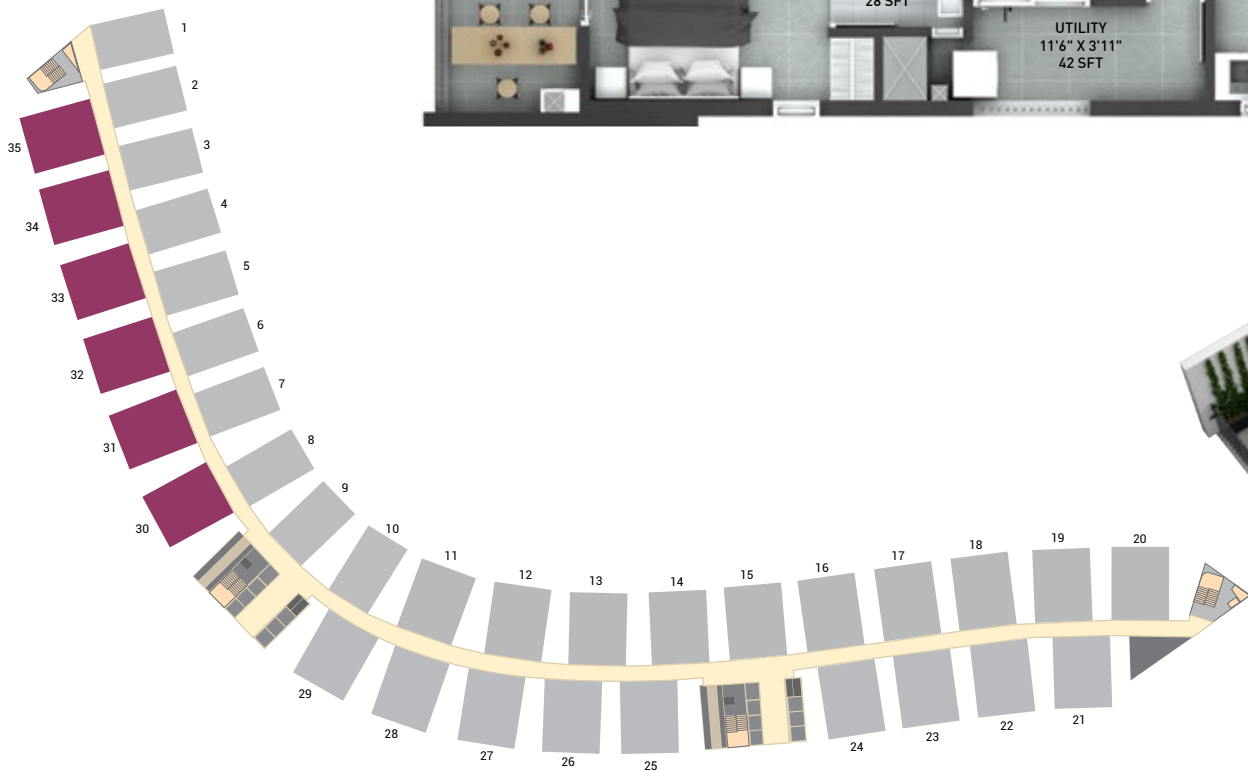

3 BHK

East Facing-2

Area: 1369 sft

No's: 11-20

KEY PLAN
Tower B

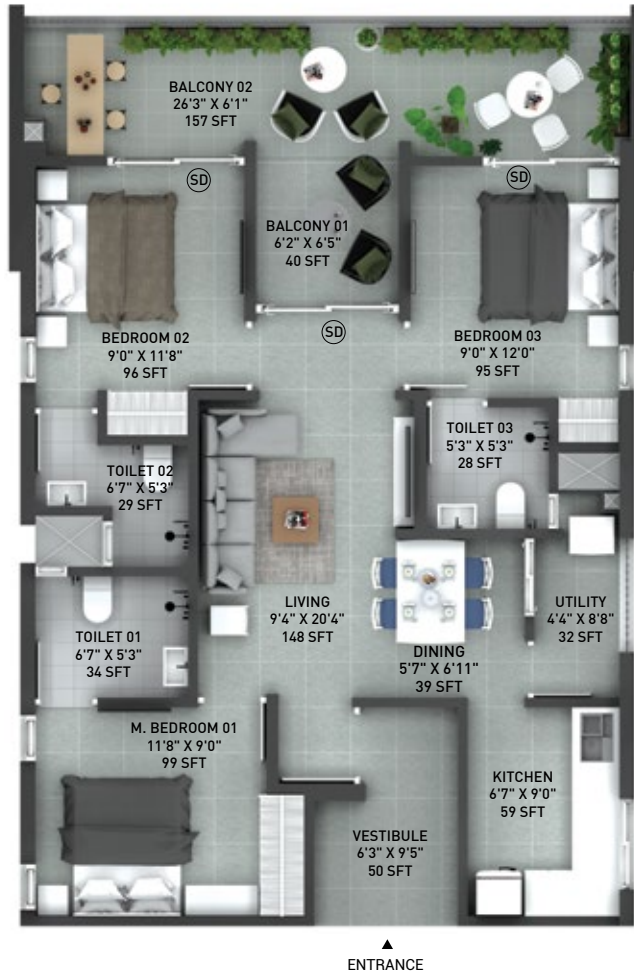
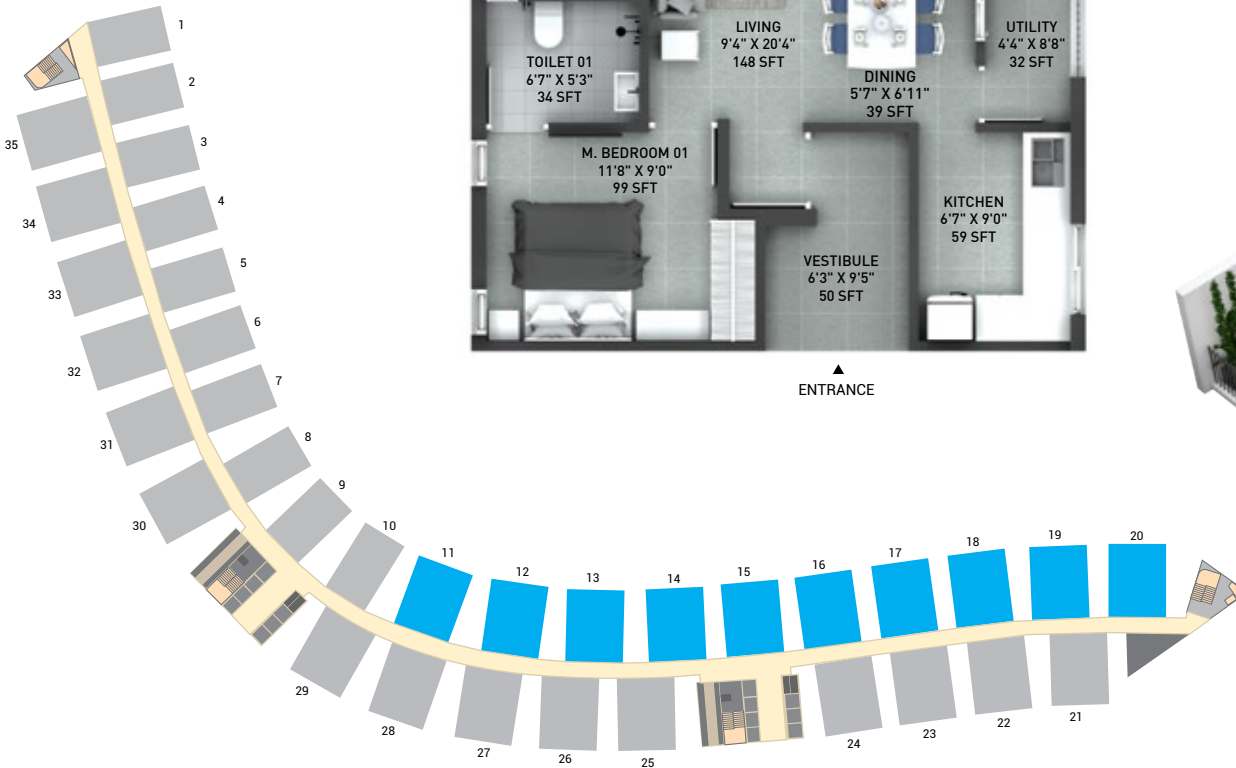

3 BHK

North Facing
Area: 1367 sft
No's: 21-29

KEY PLAN
Tower B

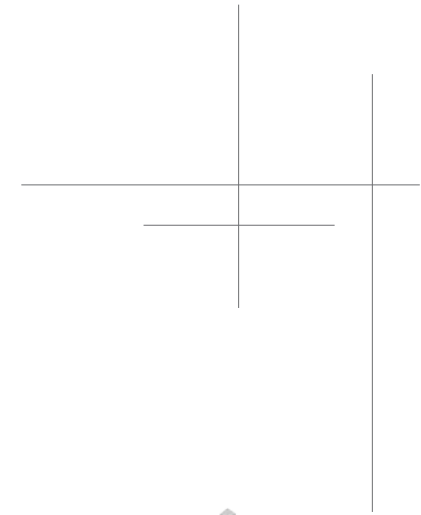
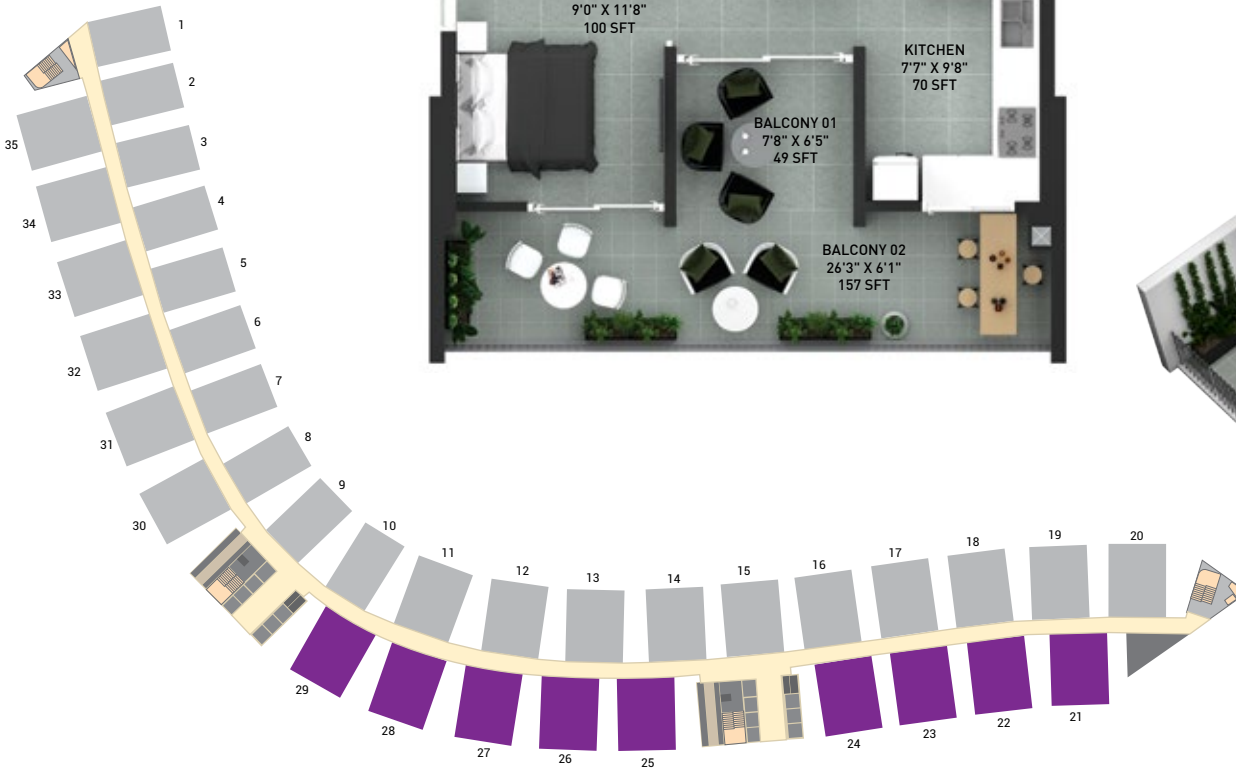

Specifications



Structure

Shear wall Structure designed as Earth Quake resistant Structure



Walls

External shear wall / light weight AAC blocks or equivalent

Internal shear walls / light weight AAC blocks or equivalent.



Wall Finishes

Internal Walls: Smooth cement plaster with acrylic emulsion Paint.

External Walls: Combination of concrete finish/ cement plastering with exterior grade Paint.



Doors

Laminated flush doors with wooden / aluminum frame or hormann factory made Doors.



Railing

MS Railing of 3' 6" [1.1 Mts]



Windows

UPVC / Aluminum sliding glazed shutters along with mosquito mesh provision.



Painting

Internal Walls: Smooth finish with acrylic emulsion and ceilings in smooth concrete finish / OBD paint.

External Finish: Weather coat paint / partial texture finish with paint.



Dado

Toilets: Ceramic tiles up to false ceiling.

Kitchen: Ceramic / vitrified tiles 2 feet above granite platform



Kitchen

Supply of granite slab for kitchen counter [Installation Excluded].

Supply of stainless steel sink single bowl in kitchen [Installation Excluded]



CP & Sanitary ware

Jaquar / Hindware / equivalent with EWC



Flooring

Master Bedroom: Vitrified tiles.

Living, Dining, Bedrooms: Vitrified tiles.

Kitchen: Anti skid vitrified tiles

Balconies & Utility: Anti skid ceramic tiles / vitrified tiles

Toilets: Vitrified tiles/ ceramic tiles.

Corridor & Common Areas: Polished concrete/ vitrified tiles 600 X 600



Security

Security room/ kiosk

CCTV at strategic locations for security and monitoring for Common Areas



Electrical

1BHK flat: 3 KW power, Single phase supply & 1KW DG back up.

2BHK flat: 5 KW power, Three phase supply & 1KW DG back up.

3BHK flat: 5 KW power, Three phase supply & 1KW DG back up.

Modular switches: MK / Legrand / Anchor / equivalent make.

15A Power points in utility: Dish washer/ Washing Machine (one point).

Visitor Management with centralized monitoring at security.

Cable TV / Internet / Telephone: One point per flat in the living room

Intercom: Through Centrex system/ dedicated EPABX / equivalent.

AC Points: Conduits with wiring, sockets and control switch in living, dining and master bedroom

TV Points: Conduits with wiring, sockets and control switch for living room.

Exhaust Fan: Provision in all toilets.

Geyser Points: Conduits with wiring, sockets and control switch in all toilets.



Lift

Elevator of reputed make with "A R D" (Automatic Rescue Device)

AMENITIES

Indoor

- Gym, yoga & meditation space
- Salon
- Crèche
- Multi-purpose hall
- Badminton court
- Indoor games
 - Carrrom
 - Chess
 - TT
 - Pool table
- Library
- Restaurants
- Coffee shops

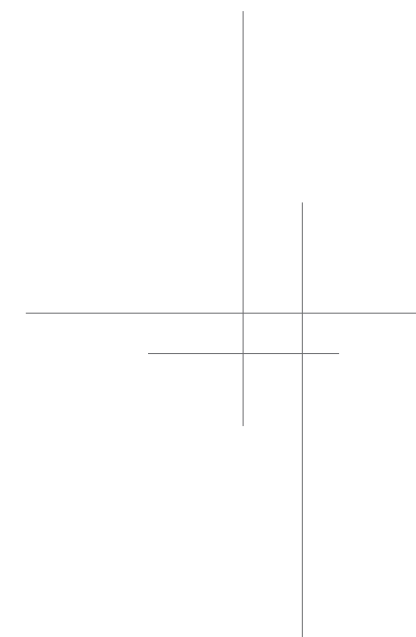

Outdoor

- Swimming pool
- Kids play area
- Elderly seating area
- Amphitheatre
- Bird watching area
- Cricket net
- Jogging track & walking track
- cycling track
- Basketball court

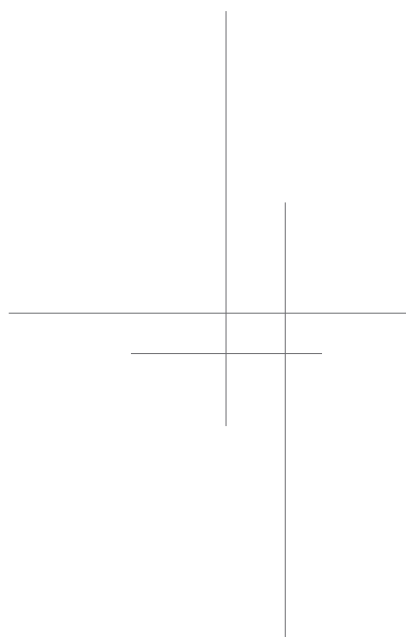

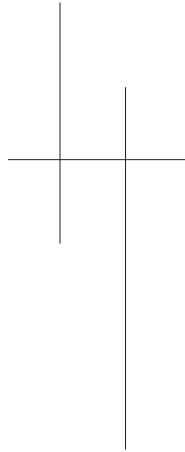
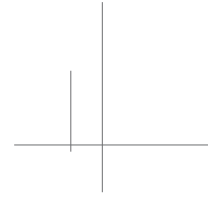

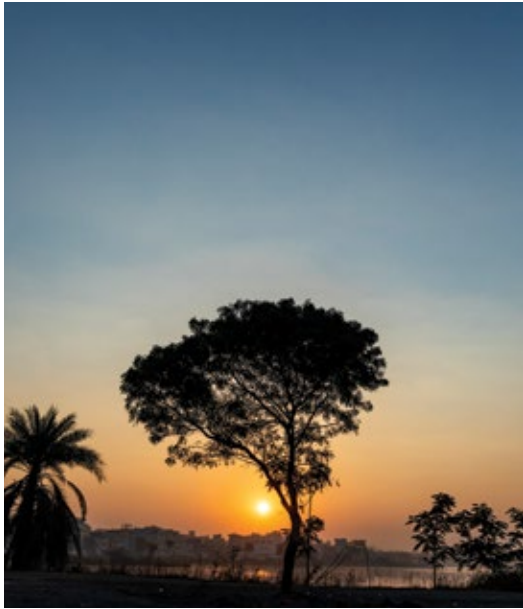

*Actual images taken from site



Site Address: Incor Lakecity office
Survey no. 699, On NH-65, Adjacent to Patancheruvu Lake, Sangareddy District, Telangana - 502 324
Corporate Address: INCOR Infrastructure Pvt. Ltd.
Plot# 69 & 70, Kavuri Hills, Madhapur, Hyderabad, Telangana - 500 033.



Project partners



Construction partners

