



PROPOSED RESIDENTIAL DEVELOPMENT FOR VSV BUILDERS

WHITE ORCHIDS AT WHITEFIELD BANGALORE

SOUTH AND WEST SIDE ELEVATION

SYSCON GROUPS
ARCHITECTS & STRUCTURAL ENGINEERS



SYSCON
PVT. LTD.

NO. 10/2, JAYANAGAR 2ND STAGE, 1ST CROSS, JAYANAGAR 2ND STAGE BANGALORE - 560029
TEL: 98450 12345
WWW.SYSCONGROUPS.COM

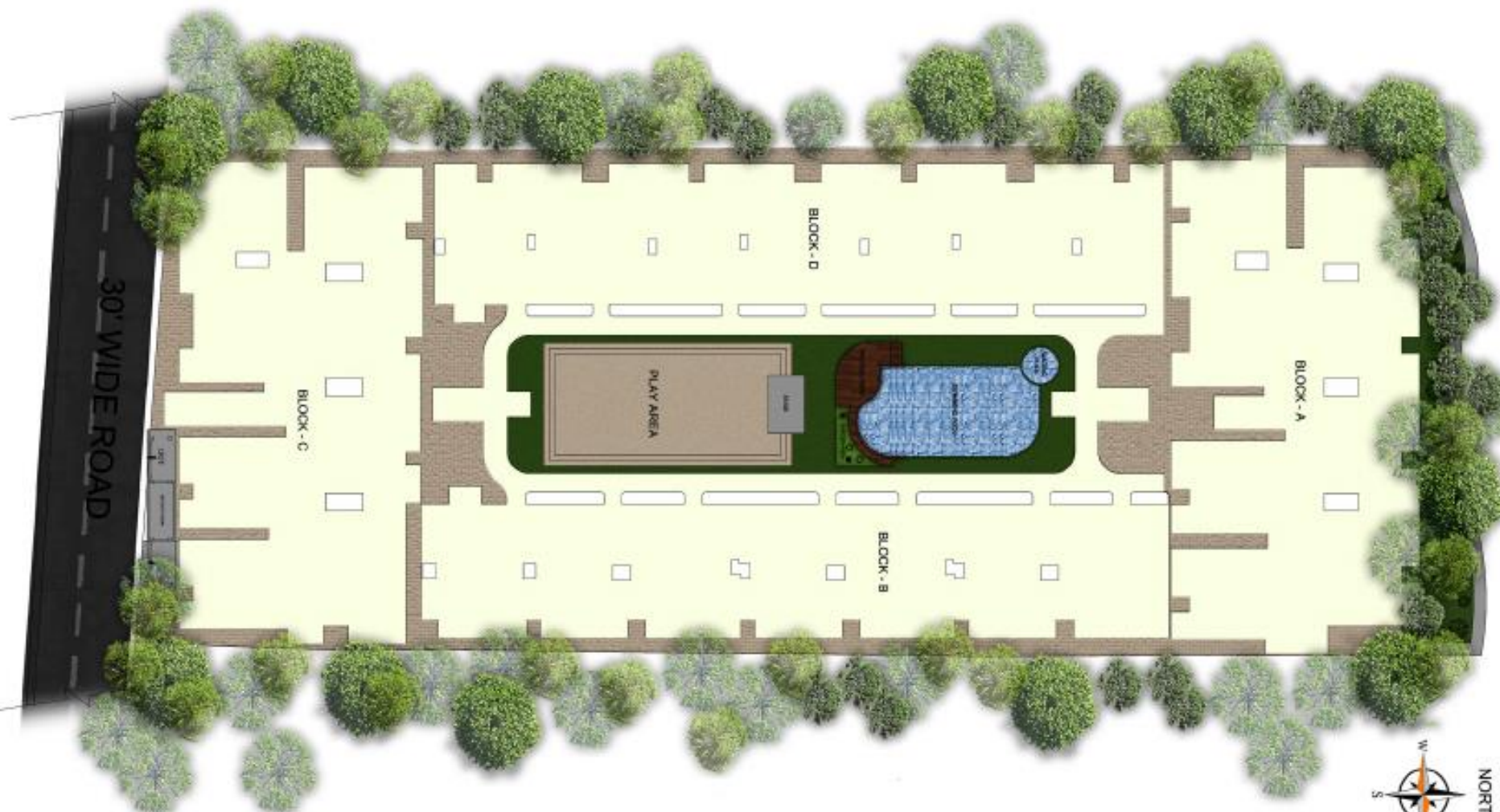

MASTER PLAN

BLOCK - A	BLOCK - B	BLOCK - C	BLOCK - D
2BHK - 07	2BHK - 04	2BHK - 07	2BHK - 04
3BHK - 01	3BHK - 03	3BHK - 01	3BHK - 03

TOTAL 3BHK - 8 Nos TOTAL 3BHK - 8 Nos X 4 FLOOR = 32 FLATS
 TOTAL 2BHK - 22 Nos TOTAL 2BHK - 22 Nos X 4 FLOOR = 88 FLATS

TOTAL -120 FLATS

SYSCON GROUPS
 ARCHITECTS & STRUCTURAL ENGINEERS



SURESH
 PROJECTS

PROPOSED RESIDENTIAL DEVELOPMENT FOR VSV PROJECTS

WHITE ORCHIDS AT WHITEFIELD BANGALORE



BLOCK - A

SYSCON GROUPS
ARCHITECTS & STRUCTURAL ENGINEERS



PROPOSED RESIDENTIAL DEVELOPMENT FOR VSV BUILDERS
WHITE ORCHIDS AT WHITEFIELD BANGALORE

SURESH
ARCHITECTS
NO. 14/12A, 13TH FLOOR, PMP COLONY, CHENNAI, JAYANAGAR 79, ROCK BAY GARDENS - 560022
081 280243423, 94481 70038889



BLOCK - C





BLOCK - D



PROPOSED RESIDENTIAL DEVELOPMENT FOR VSV BUILDERS

WHITE ORCHIDS AT WHITEFIELD BANGALORE

SYSCON GROUPS
CONCRETE & STRUCTURAL ENGINEERS



SURESH
No. 11/2A, 11th Cross, 11th Stage, 11th Block, Whitefield, Bangalore - 560091
Ph: 98456 45678 | Fax: 98456 78901
Email: info@suresh.com | www.suresh.com

VSV Builders
White Orchids



AMENITIES :

- Gym
- Party Hall
- Swimming Pool
- Children / Basket Ball Play Area
- Intercom
- Power Back Up
- Car Parking



LOCATION ADVANTAGES :

- | | |
|----------------------|--------------------|
| CLUB | SCHOOLS |
| MALLS | HOTEL |
| OFFICES | HOSPITAL |
| PETROL PUMP | SERVICE APARTMENTS |
| CONVENIENCE SHOPPING | PARK |
| NURSERY & CRECHE | MULTIPLEX |
| MULTILEVEL PARKING | |

Location Map
(Not to Scale)



White Orchids



Cheerful Community Living

VSV Builders
White Orchids
2 & 3 BHK Luxury Apartments

@ Near Siddapura Shell Petrol Bunk, Whitefield Road



Builders & Developers :



Site Address : Sy.No. 525A, Near Borewell Road, Nallurhally, Whitefield, Bangalore - 560 065

Architect :



White Orchids is a project of VSV Builders, a leading real estate developer in Bangalore. The project is located in Whitefield, Bangalore, near Siddapura Shell Petrol Bunk. The project consists of 2 & 3 BHK luxury apartments. The project is currently under construction and is expected to be completed in 2015. The project is a prime location for living and working. The project is a great investment opportunity. The project is a great choice for those who want to live in a luxurious and modern environment. The project is a great choice for those who want to live in a safe and secure environment. The project is a great choice for those who want to live in a green and healthy environment. The project is a great choice for those who want to live in a community-oriented environment. The project is a great choice for those who want to live in a convenient and accessible environment. The project is a great choice for those who want to live in a beautiful and scenic environment. The project is a great choice for those who want to live in a peaceful and quiet environment. The project is a great choice for those who want to live in a vibrant and lively environment. The project is a great choice for those who want to live in a sophisticated and elegant environment. The project is a great choice for those who want to live in a modern and stylish environment. The project is a great choice for those who want to live in a comfortable and cozy environment. The project is a great choice for those who want to live in a spacious and bright environment. The project is a great choice for those who want to live in a well-furnished and equipped environment. The project is a great choice for those who want to live in a secure and protected environment. The project is a great choice for those who want to live in a convenient and accessible environment. The project is a great choice for those who want to live in a beautiful and scenic environment. The project is a great choice for those who want to live in a peaceful and quiet environment. The project is a great choice for those who want to live in a vibrant and lively environment. The project is a great choice for those who want to live in a sophisticated and elegant environment. The project is a great choice for those who want to live in a modern and stylish environment. The project is a great choice for those who want to live in a comfortable and cozy environment. The project is a great choice for those who want to live in a spacious and bright environment. The project is a great choice for those who want to live in a well-furnished and equipped environment. The project is a great choice for those who want to live in a secure and protected environment.

SPECIFICATIONS

VSV Builders
White Orchids

- Structure** : R.C.C. Framed structure designed for seismic forces zone-III earth quakes/stand using steel according to National Building Code of India. Bangalore is in zone-III.
- Walls** : 6" B.4 " solid concrete blocks for external and internal walls.
- Plastering** : Sponge finish for external walls and neat finish for internal walls.
- Flooring** : Vitrified tiles in hall, dining & other rooms and antiskid tiles in toilets.
- Main Door** : Teakwood frame and flush door, polish finishing with fittings
- Other Doors** : Sal Wood frames and flush doors with powder coated aluminium fittings and one side film coated flush doors for toilets.
- Windows** : Powder coated two track aluminium frames and aluminium glass shutters along with safety grills. For Bedrooms three track along with mosquito net.
- Painting** : Asian plastic emulsion paint for internal walls, OBO for ceiling, Asian ace for external walls and Asian enamel paint for doors.
- Kitchen** : Polished granite stone platform with stainless steel sink, Glazed tiles dado upto 2 feet height above Platform. Water connection will be provided in the kitchen. Provision for Aqua Guard, Switch and Socket for electrical Chimney and Microwave Oven will be provided.
- Toilets** : Glazed tiles dado upto door height is provided. Solar water connection in master toilet will be provided. Provision for geyser in all toilets. Sanitaryware of Parryware or equivalent and C.P. bathroom fittings of Mark or equivalent will be provided. Switch & Socket for Geyser and Exhaust fan will be provided in all Toilets.
- Electrical** : Concealed copper wiring and electrification with adequate light & fan points in all rooms and TV Points in hall and master bed room of. Anchor Roma modular switches or equivalent will be provided. Switch and socket for fridge, Washing machine and A.C. (in master bedroom only) will be provided. ELCB (ROCB) & MCB for safety.
- Elevator** : Four nos. of 6 passenger lifts or equivalent.
- Generator** : Stand by Generator for lifts, pumps, common area lighting and power backup to each flat during power failure.
- Car Parking** : Ample space for car parking with a wide drive way. Extra parking also available.
- Security** : Intercom facility for flat to flat and also all flats to security.
- Staircase & Corridors** : Granite or Tiles Flooring.



White Orchids is a registered trademark of VSV Builders. All rights reserved. © 2023 VSV Builders. All other trademarks are the property of their respective owners.



Builders & Developers :



VSV Builders
White Orchids
2 & 3 BHK Luxury Apartments
@ Near Siddapura Shell Petrol Bunk, Whitefield Road