



LIVE XL IN THE MOST CONNECTED PART OF MUMBAI CHEMBUR-GHATKOPAR

OSWAL HEIGHTS is an ideally located, well planned and an extravagant Tower. Oswal Heights has a total of 16 floors that comprises of 1BHK, 2 BHK and 3.5 BHK flats along with commercial shopping area on ground and first floor and a separate mechanise parking tower.



LUXURIOUS 1 & 2
BHK APARTMENTS



16 STOREY
5 STAR ELEVATION

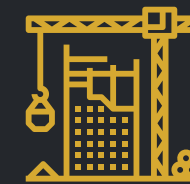

GRADE "A"
CONSTRUCTION QUALITY



TOWER CAR
PARKING AVAILABILITY



15+ LIFESTYLE
AMENITIES



TERRACE GARDEN
AT 171 FT HEIGHT



OSWAL HEIGHTS

Oswal Heights is an extravagant residential and commercial project launched by Oswal Realty in the most connected part of the city of dreams Ghatkopar - Chembur. A remarkably beautiful tower and a magnificent landmark, Oswal Heights is built to suit the comfort and lifestyle of your dreams. A Standalone Project. No Comparison.



Railway and Mono Stations

- Chembur Mono Station 1.2 Kms
- Ghatkopar Railway Station 2.3 Kms
- Sion-Railway Station 5.2 Kms
- Wadala Station 8.6 Kms
- Metro Coming Soon 100 m



Education

- The Universal School 1.1 Kms
- KJ Somaiya College 1.3 Kms
- NIIT Chembur 2.2 Kms



Food

- H-Lounge 90 m
- McDonald's Opposite 100 m
- Flaming 5 Fine Dining & Lounge 140 m
- IVY Restaurants & Banquets 240 m
- Hotel Galaxy Avenue



Hospitals

- Kankal Hospital Child Specialist 350 m
- Mumbai Heart Clinic 500 m
- Tooth-a-Dental Clinic 550 m
- Sai Maternity and Eye Clinic 600 m
- Sanjeevni Hospital 800 m



Parks and Grounds

- Pestom Sagar Jogger's Park 750 m
- Cirus Ground Municipal Park 1.4 Kms



Roads

- Bandra-Kurla Complex Street 5 0.5 Kms
- Eastern Express Highway 0.5 Kms
- Sion-Trombay Highway Road 2.3 Kms
- Santacruz-Chembur Link Road 3.7 Kms
- Eastern Freeway Highway 4.0 Kms
- Chembur- BKC Flyover 2.0 Kms



Retails

- Shoppers Stop Opposite
- R City Mall 3.8 Kms
- K-Star Mall 0.4 Kms
- Phoenix Marketcity 4.7 Kms



Temple

- Mahavirswami Jain Temple 140 m
- Bholenath Temple 170 m
- Bhatia Haveli 350 m
- Sudha Park Jain Temple 1.5 Kms



Fitness

- Sahyadri Ground 280 m
- On Toes Zumba Classes 350 m
- Zen Fitness Studio 400 m
- Edge Fitness 400 m



International Airport

4.5 Kms



In and Around

Metro Station

100 m

Eastern Express Highway

0.5 Kms

Chembur-BKC Flyover

2.0 Kms

Santacruz-Chembur Link Road

3.7 Kms

Eastern Freeway Highway

4.0 Kms



Stay Connected

Oswal Heights located at Ghatkopar-Chembur (opposite to Shoppers Stop) is a premium, opulent residential & commercial tower designed by reputed developer 'OSWAL REALTY'.

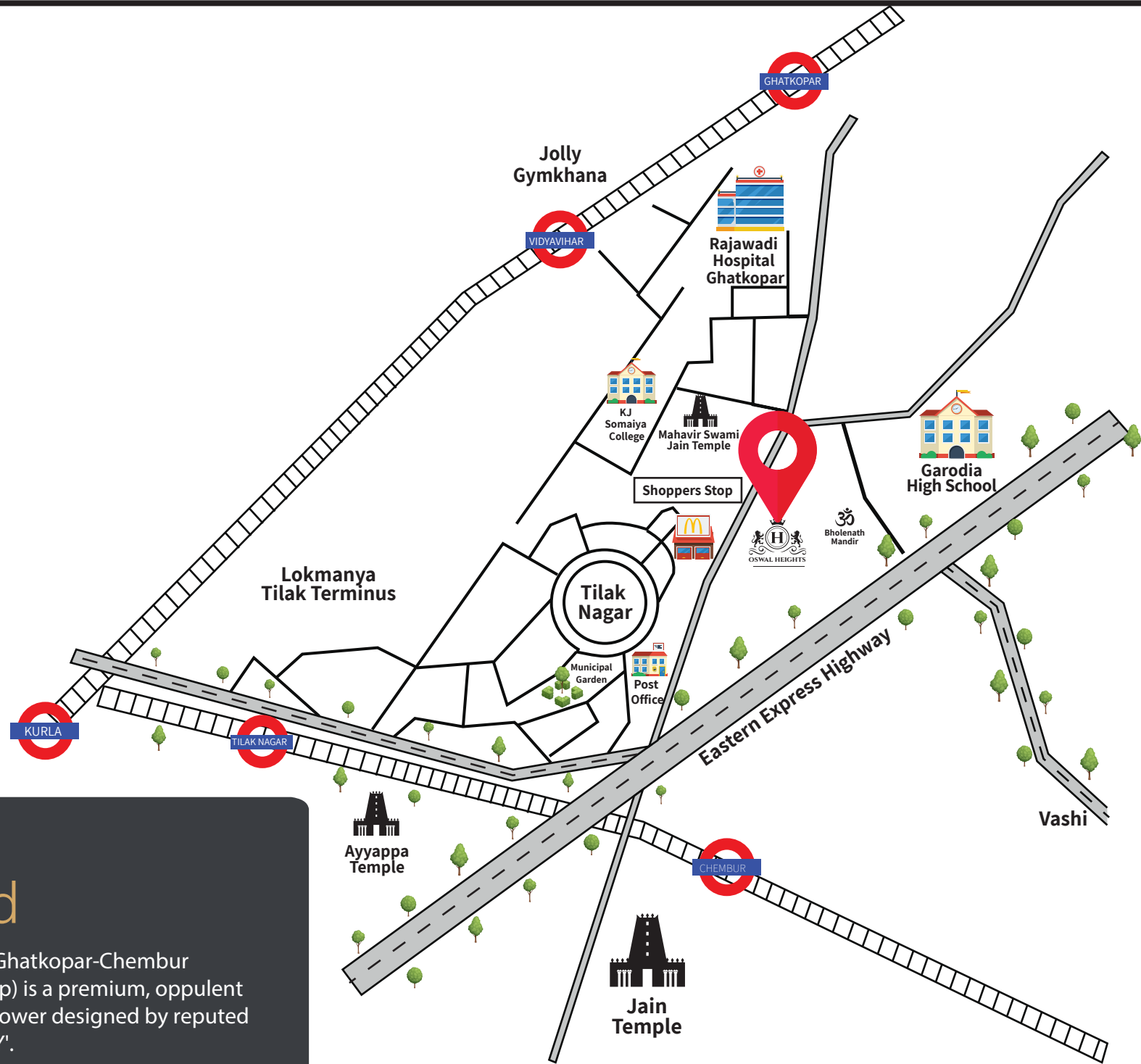



Outshining the stars in the horizon - Oswal Heights stands tall in the night, shimmering amidst the bright stars in the night sky.

Flip open to see the glamorous night view.



Glimmering Night View



*Artistic Impression



*A magnificent high-rise tower stirring the clouds in the sky. Owning property here,
in the most connected part of the city, is one-step closer to success.*

Flip open to reach heights of success.



Serene Day View



*Artistic Impression



Aerial View

Eastern Express Highway



*Artistic Impression



Terrace Garden

Thoughtfully crafted terrace gardens featuring an unmatched view from a stupendous height of 171 FT and equipped with an open gym, making it a wonderful place for yoga, exercising, and an occasional star gazing with coffee. Inhale the air of bliss at a whole different level with Unmatched View.



*Artistic Impression



Opulent Lobby

An enchanting entrance to the premises with 2 Luxurious Lifts. An avenue that has the ability to transcend you from casual to special.

*Artistic Impression



Soothing Reflexology Paving

A paving designed specifically to massage and stimulate the acupressure points on your feet, this reflexology pathway is perfect to help reduce blood pressure along with other health advantages for all age groups.

***Artistic Impression**



Zealous Rock Climbing

Scale the heights of the tower with our Rock Climbing spot within the safety of the premises. The perfect addition of adventure to your everyday life, amidst the luxury.

*Artistic Impression



Winsome Water Cascading

Positioned according to Vastu at the north-east corner of the plot. Apart from just the aesthetics and soothing effect, these water cascades are to welcome prosperity and progress in each individual resident's life with every stride they take.

***Artistic Impression**



Highstreet Shopping Plan

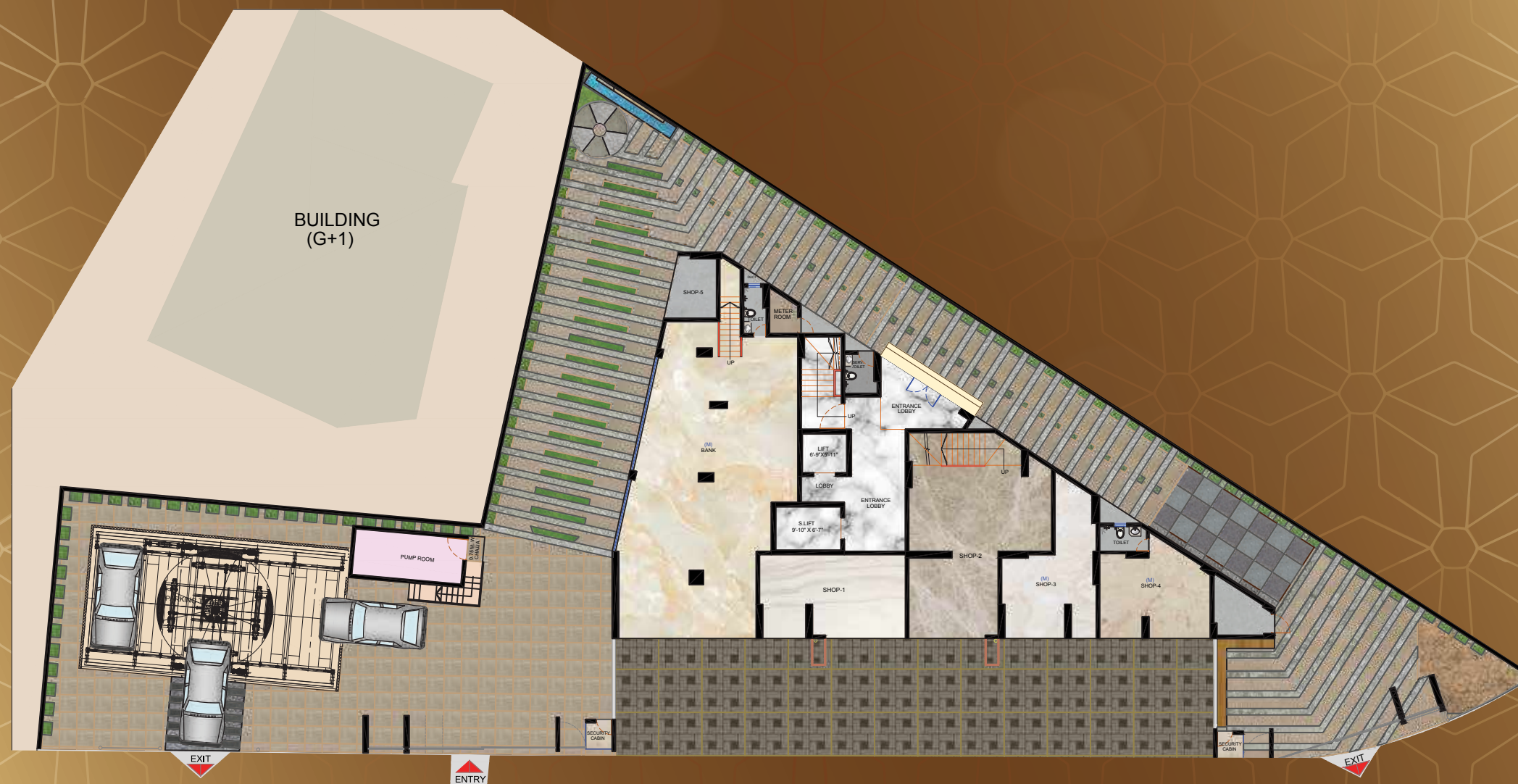

*Artistic Impression



1st Floor Plan



*Artistic Impression



Typical Floor Plan 1



*Artistic Impression



Typical Floor Plan 2



*Artistic Impression



1 BHK Flat 2D & 3D View



*Artistic Impression



2 BHK Flat 2D & 3D View



*Artistic Impression



Project Amenities

Top class amenities to delight, relax and unravel you.

Tower Puzzel Parking

Roof-Top Open Yoga/Gym.

Kids Play Area.

Zealous Rock Climbing.

Soothing Accupressure Paving Area.

2 HiSpeed Passenger Lifts.

Skydeck Stargazing Sitting Lounge.

Cascade Waterfall Fountain.

Project Vastu Compliant by Famous Vastu Professional.

Modern Elevation

Opulent Lobby

Walking & No Car Zone Area.

Unmatched & Unobstructed View from above.

Chess

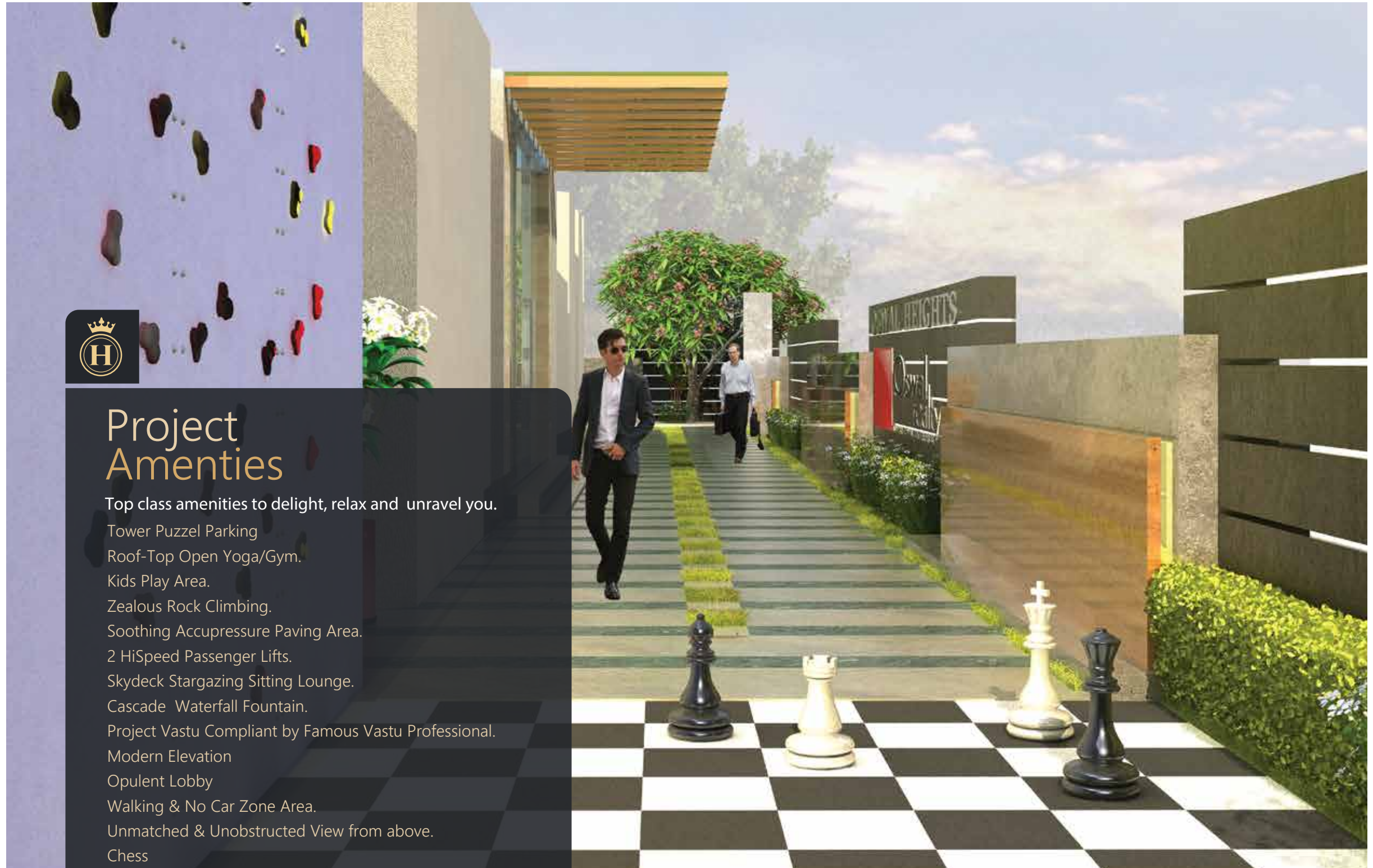



About OSWAL REALTY

A company of high repute, Oswal Realty is a prominent name in the industry delivering 'Luxury Housing with Affordable Pricing' with their latest initiative 'Oswal Heights'.

Oswal Realty promises on time delivery with superior quality. Customer satisfaction is what we thrive on, and we aim to build structures that stand through the test of time.

Platium Mall- Vapi



Prithvi Complex- Palghar



Hyde Park- Virar



Oswal Villa- Nagpur



*Artistic Impression



Message from The Leadership

Mr. Vicky Oswal,
CMD of Oswal Realty

With great pride Oswal Realty launches Oswal Heights in Ghatkopar - Chembur, Mumbai. My vision always is to ideate, build and market purposeful real estate. Our flagship landmark structure OSWAL HEIGHTS in Chembur was chosen for its exceptional ease of connectivity. Each and every project under my leadership have emerged as landmark in their own purely due to miniscule attention from inception to completion.

Use of superior quality raw materials, maximization of resources and elegant aesthetics are some standards that we follow throughout our projects, Residential or Commercial. I assure you that living or working in a property by Oswal Realty is truly unparallel.

ONE OF ITS OWN. NO COMPARISON.



Architects & Consultants

Design Architects

- Deepak Mehta & Associates

Municipal Architects

Pinnacle Associates

- Mr. Vinay Mukadam

Legal Consultants

Advocate & Solicitor

Kishore Thakordas & Co.

- Mr. Vatsal Merchant

Bank Tie-ups



Structural Consultants

- Mr. Anand Kulkarni.

M.E.P. Consultants

- Mr. Dnyanesh G. Bhave.

*Artistic Impression



Site Address:

Oswal Heights, Opp. Shoppers Stop, Ghatkoper Mahul Road, Chembur West, Mumbai - 400089
Contact : 9321459061

Corporate Office Address:

Oswal Realty, 515, 5th Floor, Commerce House, 140 Nagindas Master Road, Fort, Mumbai - 400 023, India.
Tel: 022 2263 2009 / 11 / 13 Website: www.oswalrealty.com Email ID: info@oswalrealty.com
sales@oswalrealty.com



The project has been registered via MahaRera Registration No: P51800026069
Available at website: <http://maharera.mahaonline.gov.in> under registered projects.

Disclaimer: The information and material contained herein are not intended to substitute the information available on the website of MahaRERA. Any person who is considering/evaluation any apartment in any of the registered real estate projects are required to independently analyze, acquaint and familiarize themselves with the information and disclosure uploaded on the website of MahaRERA. In the event of any conflict (whether actual or perceived) between the information and material contained herein and the details available on the website of MahaRERA, the details as available on the website of MahaRERA shall prevail. Further Oswal Heights is a brand name for the larger project and the information given herein pertains to the larger project. We will be registering separate real estate projects, from time to time.

The photographs, images, videos, plans, drawings, sketches, renderings, pictorial and graphical representations, specifications, illustrations, other information etc. contained herein are typical stock/standard photography used by the industry at large and/or pure imagination and are intended to indicate a conceptual and aspirational lifestyle. None of the aforementioned is indicative of how the larger or any part thereof looks at present and/or my eventually look in the future and/or may be designed, constructed, and/or completed.