



BEETLE
ORCHID
LIVE IN LEGACY

COMPACT LUXURY

Beetle Orchid, nestled quietly in the progressive city of Greater Noida, where beautiful buildings compliment the majestic landscape and serene natural environment.

A collection of 351 fully furnished Studio Apartments in three variations personify the sheer refinement of Beetle Orchid. Each Studio Apartment is a heavenly abode, interrupted only by natural light and air, and opens up to the Panoramic & serene views of the city. Aesthetic details like fountains and water bodies adorn the greens, making it a perfect blend of art and design. Here 'Compact' doesn't mean that you compromise on comfort, convenience or luxury, instead all these elements join hands with 'affordability' at Beetle Orchid.



STACKED BENEFITS

Compact luxury with stacked benefits defines our apartments. Beetle Orchid lives upto international standards of a 5 Star Residence by equipping its apartments with every possible comfort you could possibly desire. As you set your feet inside one, you will realise that it is indeed a perfect blend of comfort and luxury. All the equipments and gadgets are fully stacked in these apartments. Utmost care has been taken to make the best use of the available space. An overall sense of style and design take these studio apartments to a new level of hi-end living.

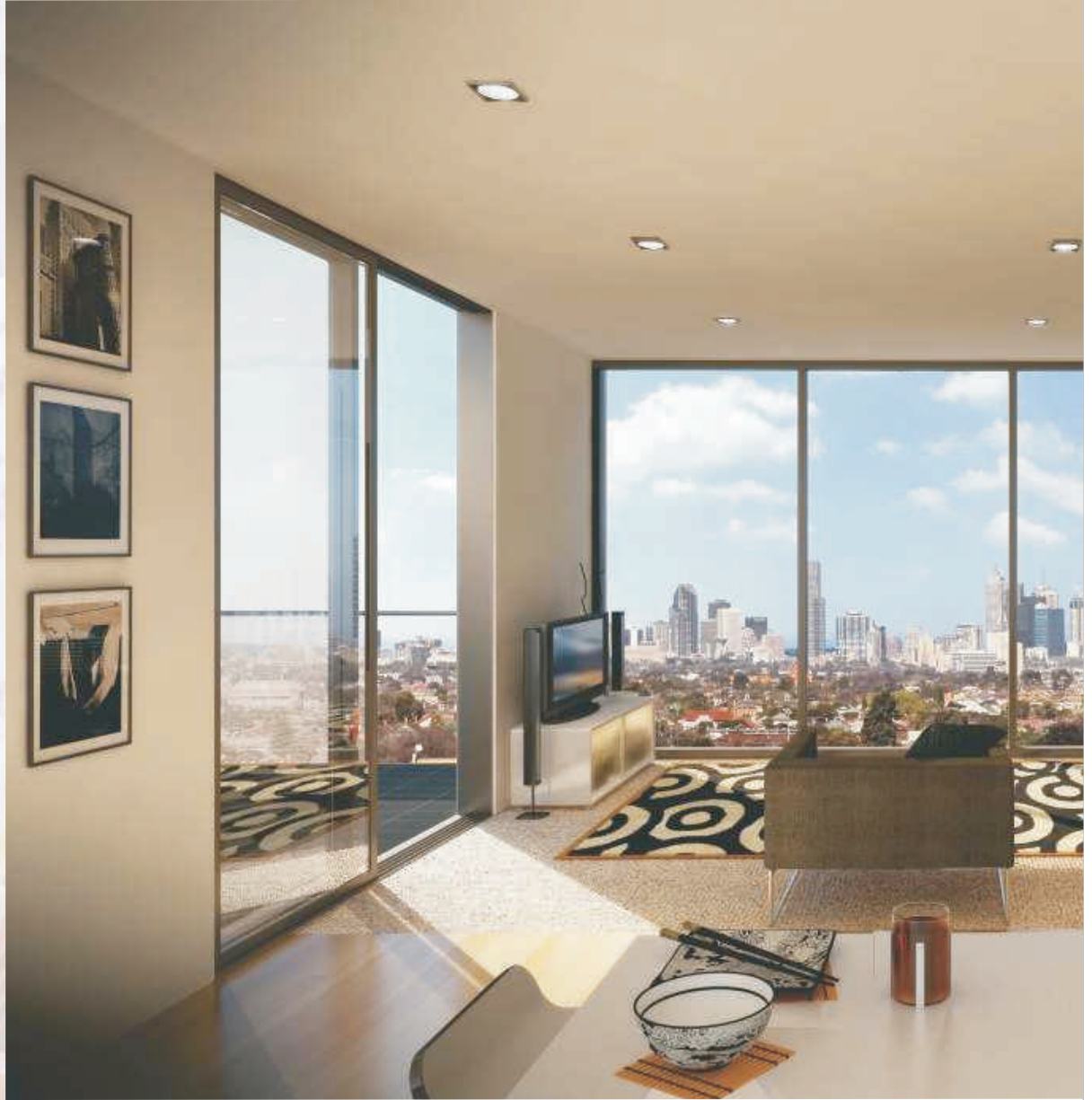

INSPIRING ENVIRON

Come home to extreme comforts. Beetle Orchid lives true to its promise of providing you with 'Compact Luxury'. In this world where our hectic life styles have made our lives monotonous, mundane and boring, here is a place which gives you enough options to unwind yourself from the tiring daily routine. A fully equipped health club with Gymnasium, SPA, Steam Sauna, Jacuzzi and a Yoga Centre to unlock your inner energy. A café lounge with modern elegance for relaxed and lazy evenings. To keep your routine hassle free, Beetle Orchid gives you the basic services of laundry & dry cleaning, housekeeping concierge all in the vicinity. Keeping up with the high-tech era, the project has provision of internet and Wi-Fi, 24x7 hi-tech security features are installed.



SUPERIOR FINISHES

STRUCTURE : Earthquake Resistant RCC Frame Structure as per Seismic zone-5.

LUXURY ROOM / DINNING ROOM

- Floor : Vitrified Tiles/ Katni/ Marble Floor
- External Door and Window : First Class Sal Wood Frame with Skin Moulded Door Shutter
- Fixture and Fitting : Chandelier, Designer Lights, Fittings & Decorative Fan
- Walls : POP Finish with Plastic Emulsion
- Internal Door : First Class Sal Wood Frame with Skin Moulded Door Shutter

BEDROOM

- Floor : Wooden Laminated / Vitrified Tiles
- External Door and Aluminium Door : Powder Coated Aluminium Window Frame Windows along with Reflective Glass
- Fixture and Fitting : Designer Lights, Fittings & Decorative Fan
- Wood Work : Wooden Cupboard

KITCHEN

: Slabs are well-finished granite stone with Stainless Steel sink and drain board. Glazed Tiles Dado on wall upto 2 ft. over counter.

BATHROOM

: Equipped with Parryware/Hindware/Cera or Equivalent, Wash basins and WCS or Equivalent. Chrome plated tap fitting of Marc/Cera or equivalent.

POWER BACK UP

: 1 KVA



SMART CHOICES

Option to choose from >>

Type: C, Area: 635 Sq. ft.

- 2 Air Conditioner
- Mini Refrigerator
- 2 LCD
- DVD Player
- EPABX System
- RO in the Kitchen
- Hot Plate (Induction)
- Juicer Mixer
- Double Bed W/Mattresses & Pillow
- Toaster
- Geyser
- Microwave
- Towel Racks in Bathroom
- Workstation W/Chair
- Curtain W/Curtain Rods
- 4 Seater Sofa W/Corner Table
- 4 Seater Dinning
- Console
- Centre Table



SMART CHOICES

Option to choose from >>

Type: B, Area: 570 Sq. ft.

- 2 Air Conditioner
- Mini Refrigerator
- 2 LCD
- DVD Player
- EPABX System
- RO in the Kitchen
- Hot Plate (Induction)
- Juicer Mixer
- Double Bed W/Mattresses & Pillow
- Toaster
- Geysar
- Microwave
- Towel Racks In Bathroom
- Workstation W/Chair
- Curtain W/Curtain Rods
- 4 Seater Sofa W/Corner Table
- 4 Seater Dinning
- Console
- Centre Table



SMART CHOICES

Option to choose from >>

Type: A, Area: 380 Sq. ft.

- Air Conditioner
- Mini Refrigerator
- LCD
- DVD Player
- EPABX System
- RO in the Kitchen
- Hot Plate (Induction)
- Juicer Mixer
- Double Bed W/Mattresses & Pillow
- Toaster
- Geyser
- Microwave
- Towel Racks in Bathroom
- Workstation W/Chair
- Curtain W/Curtain Rods

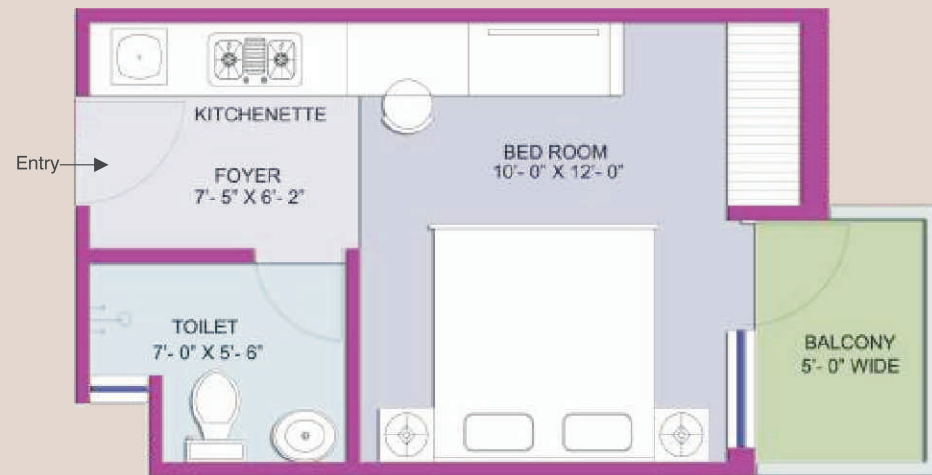

LOCATION ADVANTAGE

- Strategic location within NCR
- 5 minutes to Yamuna Expressway
- 20 minutes to DND Fly Way
- 60 minutes to Airport
- 45 minutes to Railway Station
- 5 minutes to Expo Mart
- 10 minutes to F1 Track
- 15 minutes to Night Safari

Plot No. 21, Knowledge Park-III, Greater Noida



BEST CORPORATE SITUATED

- LG Electronics • Asian Paints • Hindustan Times • Moser Baer • Denso India Ltd. • Honda Siel Cars India Ltd • HPCL Limited • Escorts Yamaha Motors • Hindustan Adhesives Limited

BEST INSTITUTE SITUATED

- Sharda University • Galgotia University • NIIT • BITS • HIMT • G.L Bajaj Institute of Technology • Delhi Public School

SITE LAYOUT & CLUSTER PLAN



- LEGEND:**
- Type-A (380 Sq.ft)
 - Type-B (570 Sq.ft)
 - Type-C (635 Sq.ft)
 - Balcony



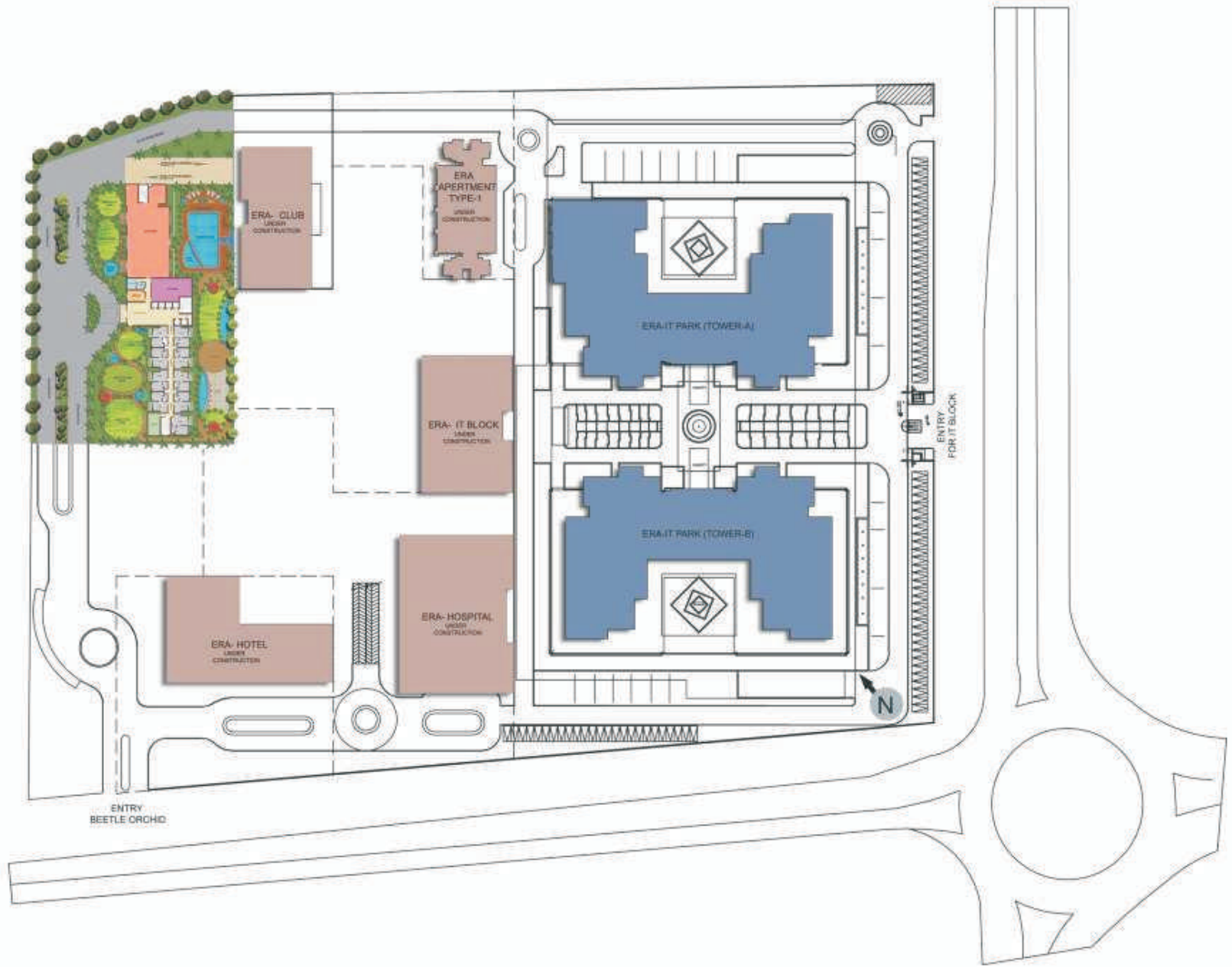



EARTHCON 
concerned living

verticallimits
Building a new world of innovation

EARTHCON CONSTRUCTIONS PRIVATE LIMITED

J-25A, Sector-18, Noida- 201 301 (U.P.) | T: +91-120-4773400 to 4773421 | E: info@earthcon.co.in | W: www.earthcon.co.in

Disclaimer: Specification and layout plans are subject to change without prior notice. Artistic impressions and photographs shown are imaginary.*
The brochure is purely conceptual and not a legal offering. Altering all right reserved.