

PASHMINA
casa

LIFE, A NOTCH HIGHER

A Dream *Home* Where The Dream Comes True.

Our design philosophy is inspired by nature's selected features and state of the art architecture; curating an experience that is a notch above from the rest. We at **Pashmina Casa**, do not redefine comfort, we provide it the way it was intended to be. Interact with nature, providing you with natural light and making your space come alive. Practical design, steadfast resolve to use the best raw materials, and meaningful use of every sq.ft distinguishes Pashmina Casa apart from the rest.



GROUND FLOOR PLAN

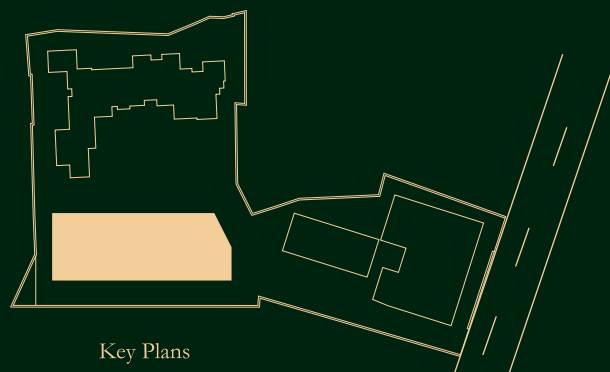

Key Plans



AMENITIES



FEATURES



MULTIPURPOSE TURF



MULTIPURPOSE HALL



GRAND ENTRANCE
LOBBY



24-HOUR SECURITY



CCTV SURVEILLANCE



FIREFIGHTING
EQUIPMENT



EXCLUSIVE
SEATING AREAS

TYPICAL FLOOR PLAN



FLATS CONFIGURATION

UNIT NUMBER	TYPES	RERA CARPET AREA
UNIT 1	2 BHK	644 Sq.ft.
UNIT 2	2 BHK	643 Sq.ft.
UNIT 3	2 BHK	554 Sq.ft.
UNIT 4	2 BHK	615 Sq.ft.
UNIT 5	2 BHK	615 Sq.ft.
UNIT 6	2 BHK	674 Sq.ft.

Designer Tiles • CP & Sanitary Fittings of a Reputed Brand • Light Fixtures & Fans of a Reputed Brand
Premium Windows with Grill

PASHMINA DEVELOPERS

One of the Finest
Builders in Mumbai & Bangalore

The inspiration behind the brand and its ideology come from the famous Kashmiri wool known for its quality, craftsmanship and class - Pashmina. These signature ethos are what make Pashmina Developers a unique brand in real estate. Whether it's residential or commercial properties, there is a signature touch that embodies each project. The amalgamation of quality, design & technology in every function gives the customer a reason for delight.

Established in 2007, we are a young and dynamic company with signature projects in Mumbai, Bangalore and Pune. Finding your unique space with us is a matter of 'when' and not 'if'. Your signature landmark is waiting for you at Pashmina.



PASHERINA
CASA

LOCATION MAP

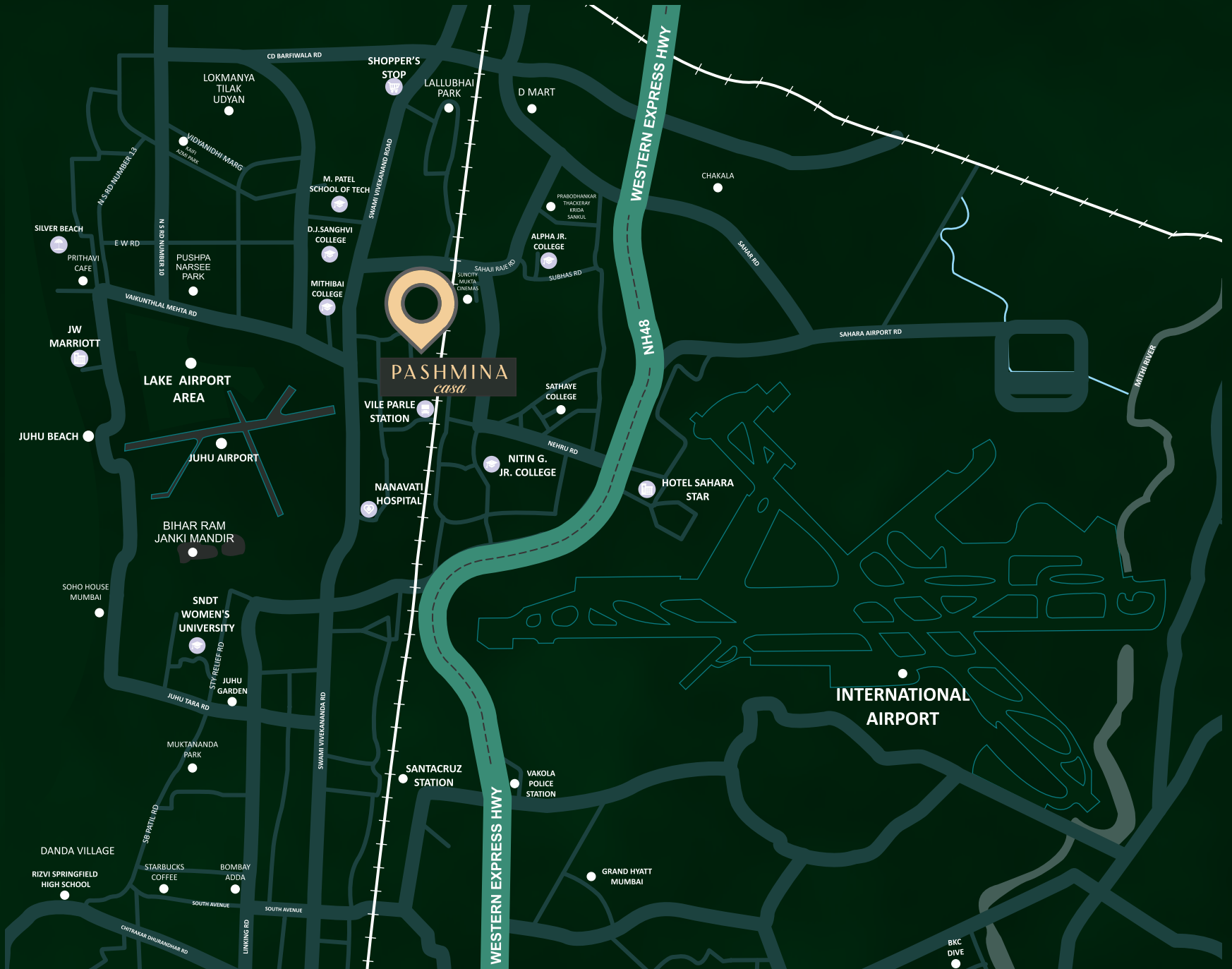

Office Address

PASHMINA DEVELOPERS
3rd Floor, Bandbox House,
Dr Annie Besant Rd, Opp Sasmira College,
Hanuman Nagar, Worli, Mumbai - 400 030.

Site Address

PASHMINA CASA
VP Road, Vile Parle - West, Mumbai 400 056
Tel: +91 98199 81159 | +91 98199 81172
Email: casa@pashminadevelopers.com

MahaRERA Number: **P51800047054** and available on the website <https://maharera.mahaonline.gov.in>

Any and all representations, images, plans, specifications, design, and other details as mentioned herein, etc. ("Outline") herein are tentative and an artist's impression of the project and for illustrative purposes only. The Outline is only indicative and is subject to change without prior notice. All plans are subject to any amendments approved by the relevant authorities. The actual design/construction may vary including in fit and finish. This printed material doesn't constitute an offer and/or contract of any type between the promoter and the recipient. The recipient hereof is requested to verify all the details, including but not limited to amenities, services, area, payments and other relevant terms independently with the sales team prior to concluding any decision for buying any unit(s) in the project. The recipient hereof is expected to satisfy himself/herself/itself with the terms and conditions of the agreement for sale and project details as uploaded on the RERA website. Any prospective sale shall be governed by the terms and conditions of the agreement for sale to be entered into between the parties.