

ATS GREENS PARADISO



GREATER NOIDA

for more details : info@atsgreens.com

ATS GREENS PARADISO

ATS Greens Paradiso - is about all the colours of life. ATS Greens Paradiso is the pioneer project in Greater Noida. Plush 32 acres of prime land will have 1000 apartments in 24 towers. Three fourth of the land is dedicated landscaping and greens. With modern and

state-of-the-art features and facilities,

ATS Greens Paradiso is slated to,
be a landmark of Greater

Noida. Non

Resident

Indians,

Sports persons,

Service & Business class,

professional Artists, Architects,

Designers, IT specialists, Industrialists

and personalities have made ATS their first choice.

FACILITIES

Essentials

- 24 Hours Treated Water
- 100 % Power Backup
- Broad Band connectivity
- Wired phone
- Cable TV



Security

- 24 Hours Security
- CCTV installed at strategic locations
- Fire Fighting Systems
- High Walled Compound.

Community

- Air conditioned
- Community Hall
- Library
- Club House
- Shopping Arcade
- Café

Recreational

- Swimming Pool
- Gymnasium
- Joggers Track
- Squash Court
- Tennis Court



ATS GREENS PARADISO LOCATION MAP

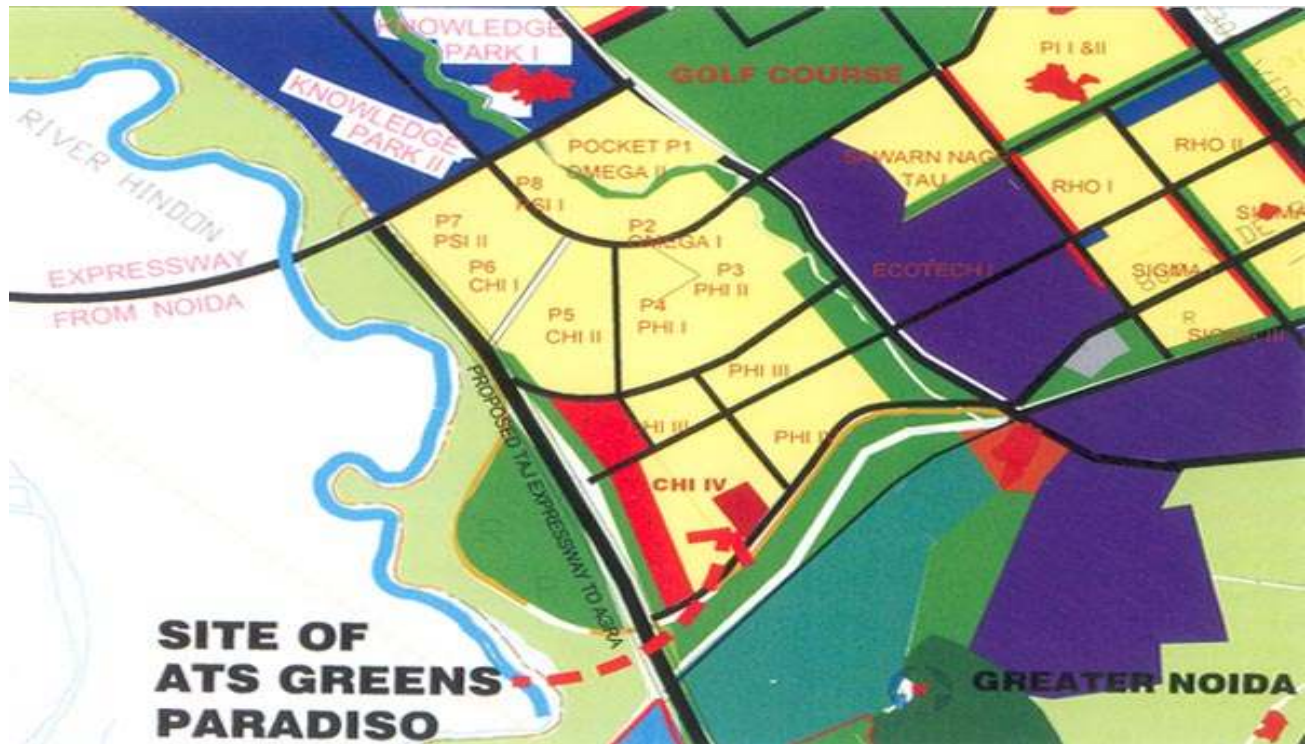

ATS GREENS PARADISO SITE MAP

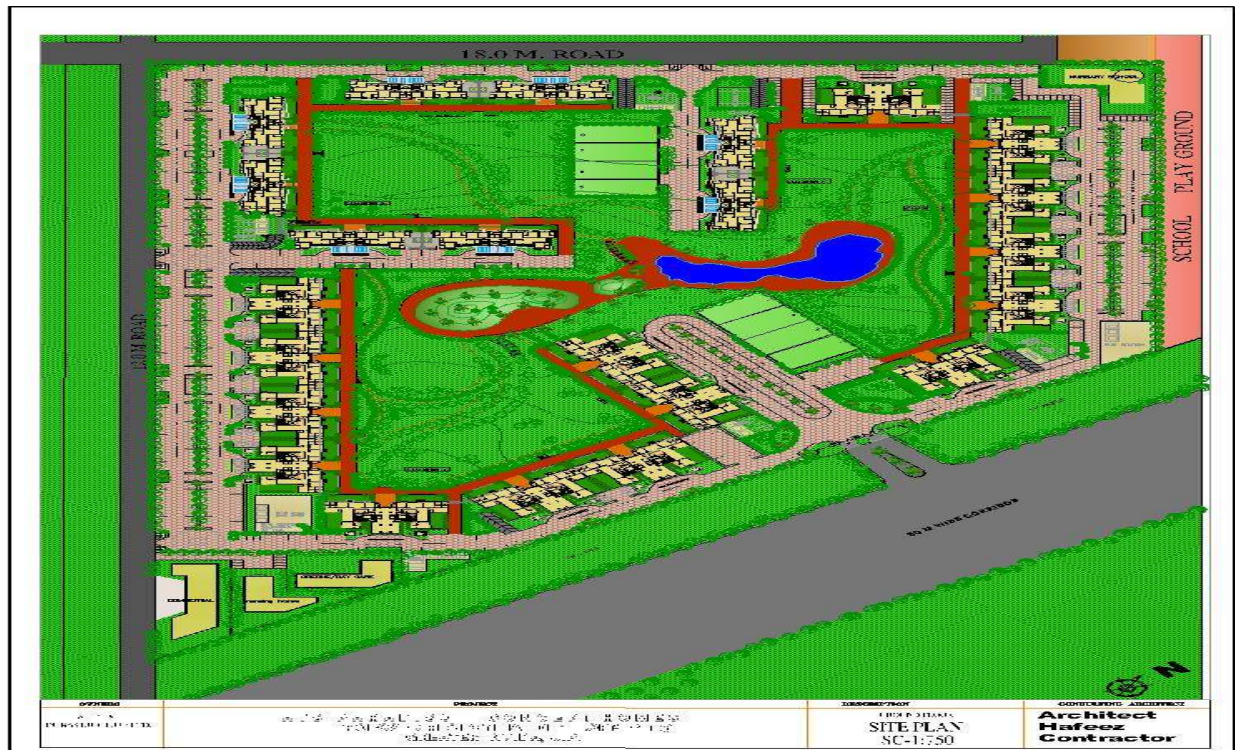

DESCRIPTION AND SPECIFICATIONS OF APARTMENTS

The apartments in the multistoried complex are two bedrooms, three bedrooms and three bedrooms with servant quarter/study. Their brief Specifications are listed below :

- FLOORING** Marble slab flooring in the whole apartment except Kitchen & Bathroom where marble floor tiles of 1' x1' or approximate size to be used. All staircases and common landings to be of marble stone
- DADO** Glazed/Ceramic tiles up to 7'-0" height in toilets and 2'-0" height above kitchen slab in appropriate colour and print.
- EXTERIOR** Permanent Finished.
- PAINTING** Oil bound Distemper paint of appropriate colour on interior walls of the apartment.
- KITCHEN** All Kitchen slabs in Udaipur Green stone with Granite Polish. Points for washing machine and fridge to be provided. Woodwork in kitchen cabinets to be in 3/4" commercial ply board with appropriate finish.
- DOORS & WINDOWS** Flush doors with Spirit Polish/Enamel Paint; with aluminum powder coated hardware fittings and locks of Golden/Secure or equivalent make. Door frames and window panels of Champ/Kail/Sal/Assam Teak wood. Windows to have Aluminum powder coated handles and T-bolts. Size and section as per design of the architect.
- PLUMBING** As per standard practice, all G.I. pipes to be painted with Anti-corrosion paint to use. All C.I. joints to have molten lead hammered to give water tight joints.

- TOILET** *Parryware/Hindustan/Cera or equivalent wash basins and W.C.s (of appropriate shades kingstar). All taps and fittings to be of Chrome Plated Jaquar or equivalent make. Mirrors and appropriate lights will also be provided.*
- ELECTRICALS** *Multi-strand electrical (copper) wiring to be as per I.S.code. Anchor or equivalent switches with equivalent switch plates, circuits to have M.C.B. of approved make, T.V., Telephone points will be provided in drawing, dining and all bedrooms.*
- LIFTS** *Lifts with stainless steel exterior and interior will be provided for access to all floors.*
- GENERATOR** *Generator to be provided for backup of lifts & other Common Areas.*
- WATER TANKS** *Underground water tanks with pump house and tube wells for uninterrupted supply of water.*
- CLUB HOUSE** *Club House with Swimming Pool to be provided.*
- INTERNET** *Broadband connectivity will be available.*

TYPE A UNIT 2800 FT

- 4 Bedrooms
- 4 Toilets
- Living Room
- Dining Room
- Kitchen
- Servant Room with Toilet



TYPE B UNIT 2000 SQ. FT

- 4 Bedrooms
- 4 Toilets
- Living Room
- Dining Room
- Kitchen
- Servant Room with Toilet

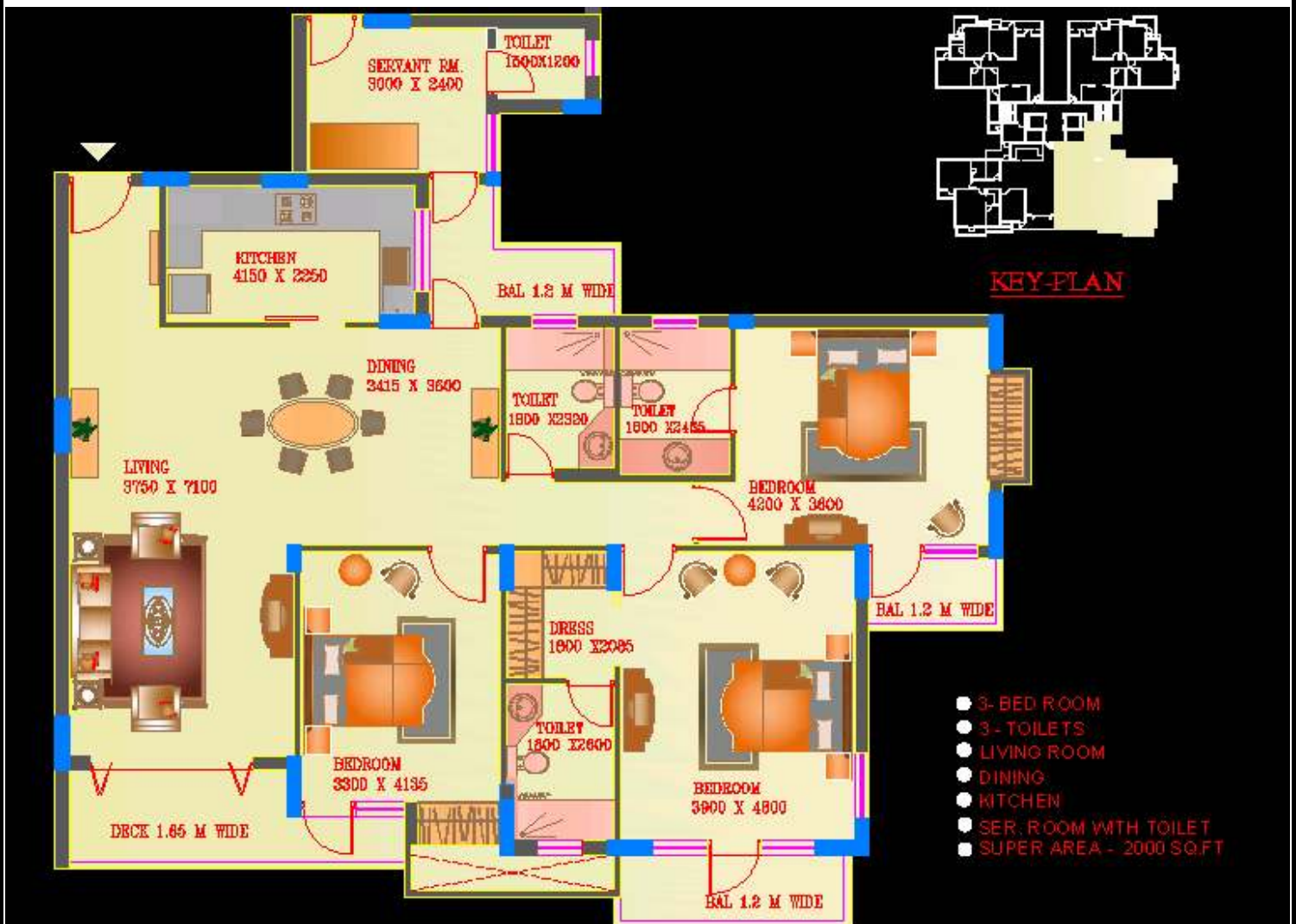

TYPE C UNIT 1600 SQ. FT

- 3 Bedrooms
- 3 Toilets
- Living Room
- Dining Room
- Kitchen

