



Rayan Park

To make your dream come true

Your Budget HOME At Govandi - West





TYPICAL FLOOR PLAN

M A I N R O A

ENTRANCE LOBBY

- Designed - finish entrance lobby at ground floor.

FLOORING

- 600X600 mm vitrified tile in living, kitchen & bedrooms.
- Matt-finished ceramic tile flooring in toilet.

DOORS

- Solid wood, wide- jamb door frame with wood shutter for main door.

WALL & CEILING

- Gypsum punning on walls.
- Acrylic Emulsion paint for walls & ceilings.

EXTERNAL FINISH

- Entire building painted with acrylic paint of external grade.

KITCHEN

- Vitrified tile dado with Granite platform.

WINDOWS

- Powder-coated aluminum sliding windows with MS railings.

LIFTS

- Modern, automatic lifts of Tyssen / OTIS Equivalent make.

CONSTRUCTION

- Grade A, earthquake-resistant construction.

SAFETY

- Entrance lobby located at ground floor has access control entry with CCTV camera.

HOME...where love resides & memories are cherished

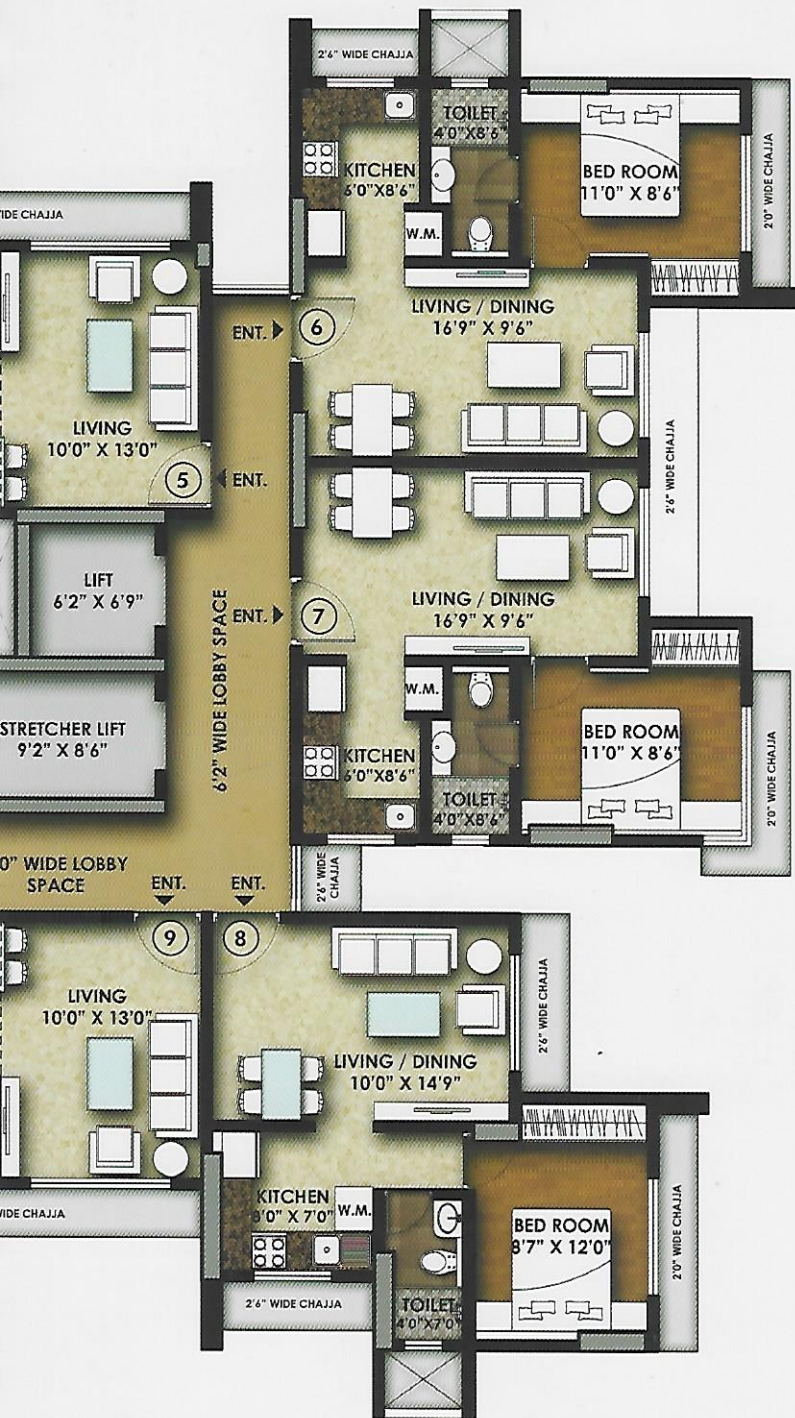

INTERNAL ROAD

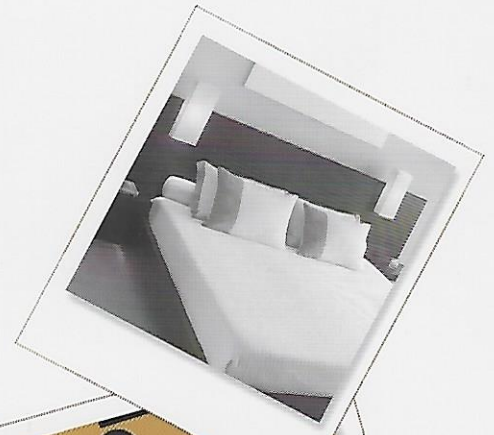

PLUMBING, BATHROOM & TOILET

- Concealed plumbing system.
- White ceramic sanitary ware of reputed brand.
- Single lever diverter in shower areas along with single lever basin for all toilet.
- Wall hung E. WC unit with concealed flush tanks.
- 7' height toilet dado with combination of Vitrified & Ceramic tiles.
- Provision for instant geysers & exhaust fans in all toilets.

ELECTRICAL

- Concealed copper wiring in the entire flat with ELCB & MCB switches in the distribution board.
- Premium range modular switches & sockets.
- Adequate point for lights, fans & TV.
- Telephone points in the living rooms & bedrooms.
- Provision for cable TV & broadband connectivity.

A Home where
all the necessities are within reach

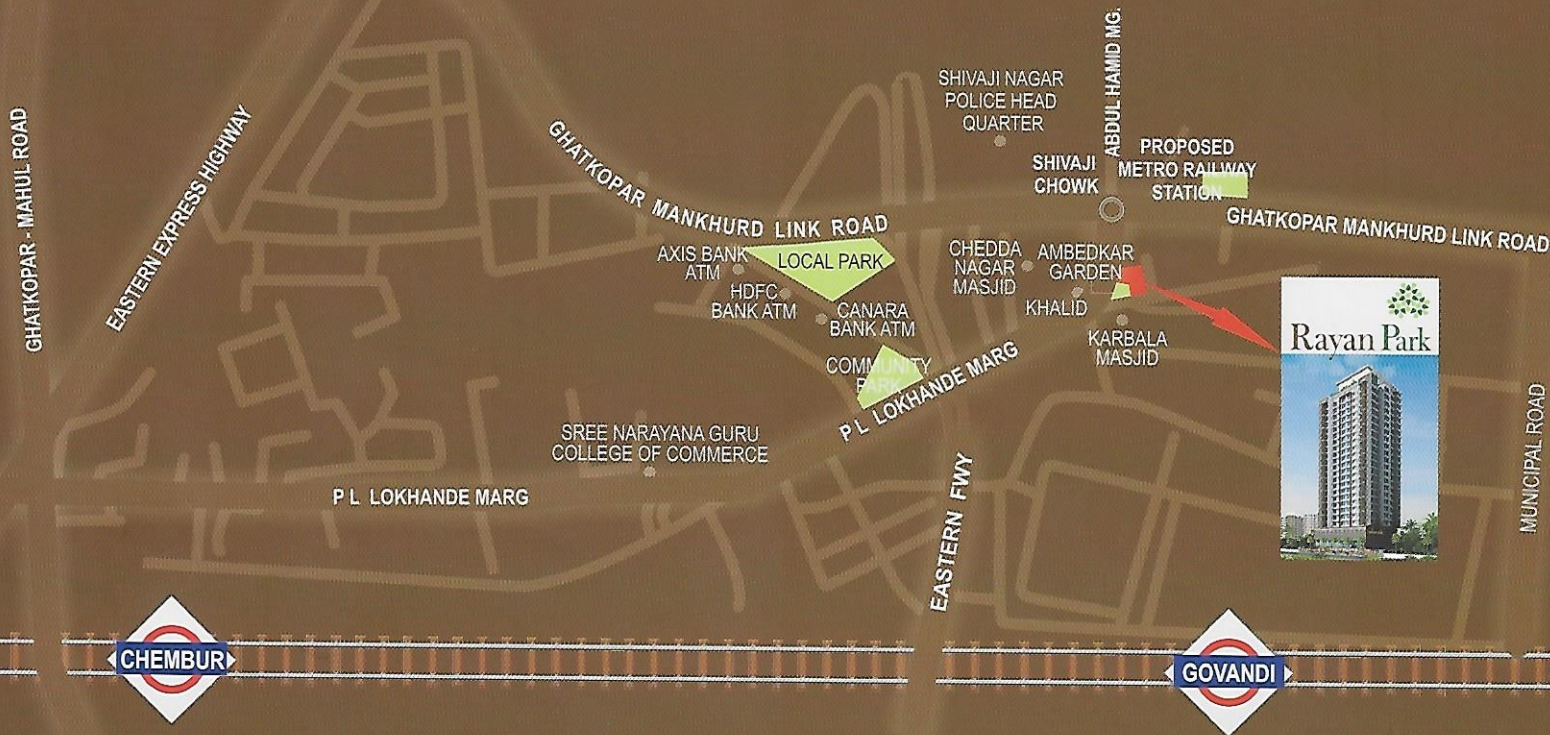

A rare combination of prime location and practical lifestyles.

Located at Govandi, on the main arterial link between Ghatkoper and Mankhurd, connectivity to Mumbai and beyond is seamless. It's proximity to the Eastern Freeway, Govandi station, upcoming Metro Station at Shivaji Chowk and numerous bus routes add to the ease of commuting. RAYAN PARK has compact 1 BHK homes, at budget prices, housed in an exclusive tower. Live in the best of both worlds.

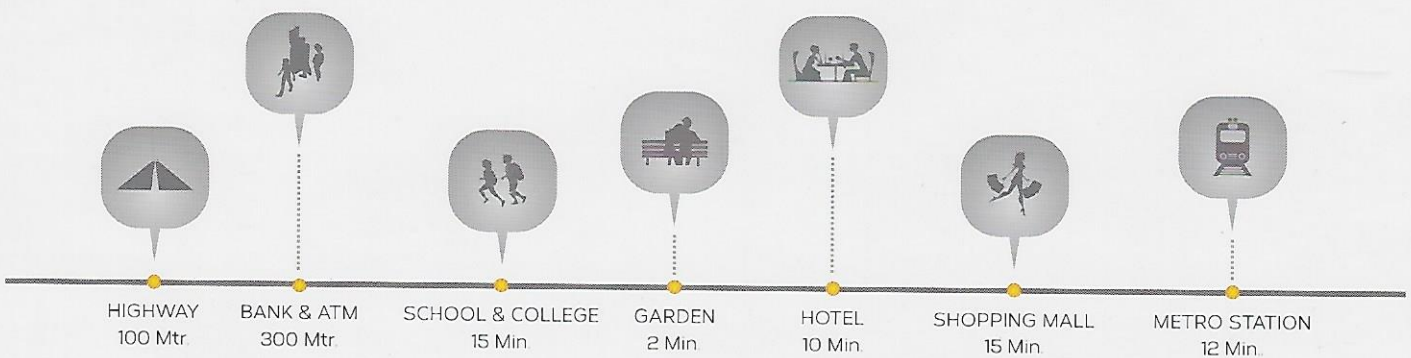

Admin Address : G/3 Shree Saimartand Chs,
next to Jain temple, Hanuman Road,
Vile Parle - East, Mumbai - 4000 57.
Tel: +91 22 2611 0009 | Mob.: 81694 06526

DESIGNE ARCHITECT
AV ARCHITECTS

ARCHITECT
SHANTANOO RANE &
ASSOCIATES

STRUCTURAL CONSULTANT
JW CONSULTANTS LLP

LEGAL ADVISER
KAMDHENEU
ASSOCIATES