

The taste of
LUXURIOUS
LIVING is now
SPREADING
its wings.



B-11, Sector-1, Noida- 201 301(U.P) | T: +91-120-4773400 |M:+91 9266179797 | E: info@earthcon.co.in | W: www.earthcon.co.in
Site Office : Plot no.21, Knowledge Park-III, Greater Noida (UP)



RERA Registration - UPRERAPRJ4491



This image displayed is only an artistic impression & not the actual photograph. Elevation, Colour Scheme and/or exterior appearances are subject to change and can be altered at the sole discretion of the company. This is purely conceptual & constitute no legal offering.



If you ever thought that luxury couldn't come at affordable price, then think again. At Beetle Suites, we are offering world-class suites at an exciting price. So that, when somebody comes to your suite, it's not just one object that showcases your love for luxury but the entire suite.



This image display is only an artistic impression & not the actual photograph. Elevation, Colour Scheme and/or exterior appearances are subject to change and can be altered at the sole discretion of the company. This is purely conceptual & constitute no legal offering.

Experience life in its most luxurious form

*I*n tune with changing time Beetle Suites have acquired an International look. These suites will forever redefine luxury living, set new standards and raise the bar for a true International living with its Swimming Pool. This urban oasis is the perfect place for the fun & relaxation both. Whether you plan to exercise, or merely relax and bask in the sun on the pool deck, its location offers spectacular views.



Stimulating Environment

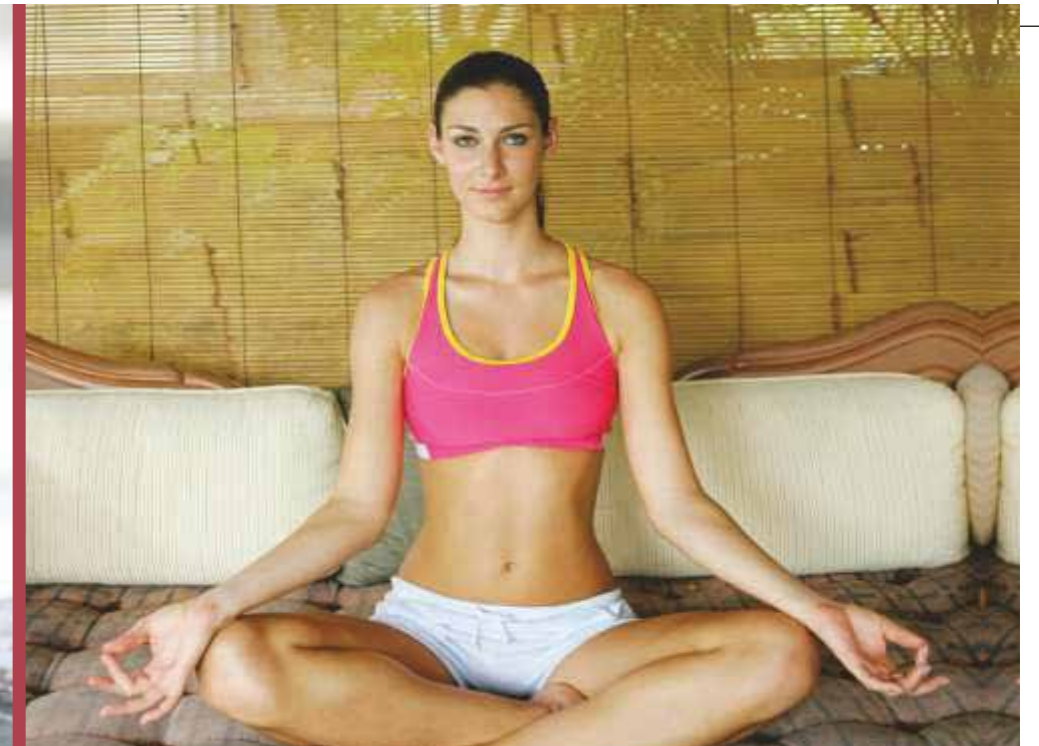

This image displayed is only an artistic impression & not the actual photograph. Elevation, Colour Scheme and/or exterior appearances are subject to change and can be altered at the sole discretion of the company. This is purely conceptual & constitute no legal offering.

The Beetle Suites provide its residents with the perfect setting for a recreational & leisure pursuits. You can unwind at the exclusive Clubhouse Lounge accompanied by a cup of coffee or a neighborhood friend. Be it energizing workout at the gym or relaxation for your mind, you get it all here within the gated community. So choice is yours!

Site Layout

1. Entry/ Exit
2. Parking
3. Guard Room
4. Club
5. Drop Off
6. Green Pathway
7. Pavement
8. Water Features
9. Jogging Track
10. Lawn
11. Green
12. Infinity Pool
13. Pool Deck
14. Kid's Pool
15. Jacuzzi
16. Kid's Playing Area
17. Water Play Area
18. Sculpture & Water Body

TYPE	UNIT AREA
■ SILVER SUITE	370 SQ.FT.
■ GOLD SUITE	575 SQ.FT.
■ PLATINUM SUITE	615 SQ.FT.
■ 2 BHK + SERVANT	1205 SQ. FT.
■ 2 BHK	1060 SQ. FT.
■ 3 BHK + SERVANT	1880 SQ. FT.
■ 3 BHK	1645 SQ. FT.



Note: All above layouts are tentative & are subject to change without any prior notice. These are purely conceptual and constitute no legal offering. Balconies are subject to change as per elevation drawings.
 1 Sq.mtr. = 10.764 sq.ft.; 1 acre = 4047 sq.mtrs.(approx).

Master Plan Layout



Note: All above layouts are tentative & are subject to change without any prior notice. These are purely conceptual and constitute no legal offering. Balconies are subject to change as per elevation drawings. 1 Sq.mtr. = 10.764 sq.ft. ; 1 acre = 4047 sq.mtrs.(approx).

Gold Suite

S. AREA 575 sq.ft.



Note: All above layouts are tentative & are subject to change without any prior notice. These are purely conceptual and constitute no legal offering. Balconies are subject to change as per elevation drawings.
 1 Sq.mtr. = 10.764 sq.ft. ; 1 acre = 4047 sq.mtrs.(approx).



S. AREA 370 sq.ft.

Silver Suite



Note: All above layouts are tentative & are subject to change without any prior notice. These are purely conceptual and constitute no legal offering. Balconies are subject to change as per elevation drawings.
 1 Sq.mtr. = 10.764 sq.ft. ; 1 acre = 4047 sq.mtrs.(approx).

Location Plan

Features

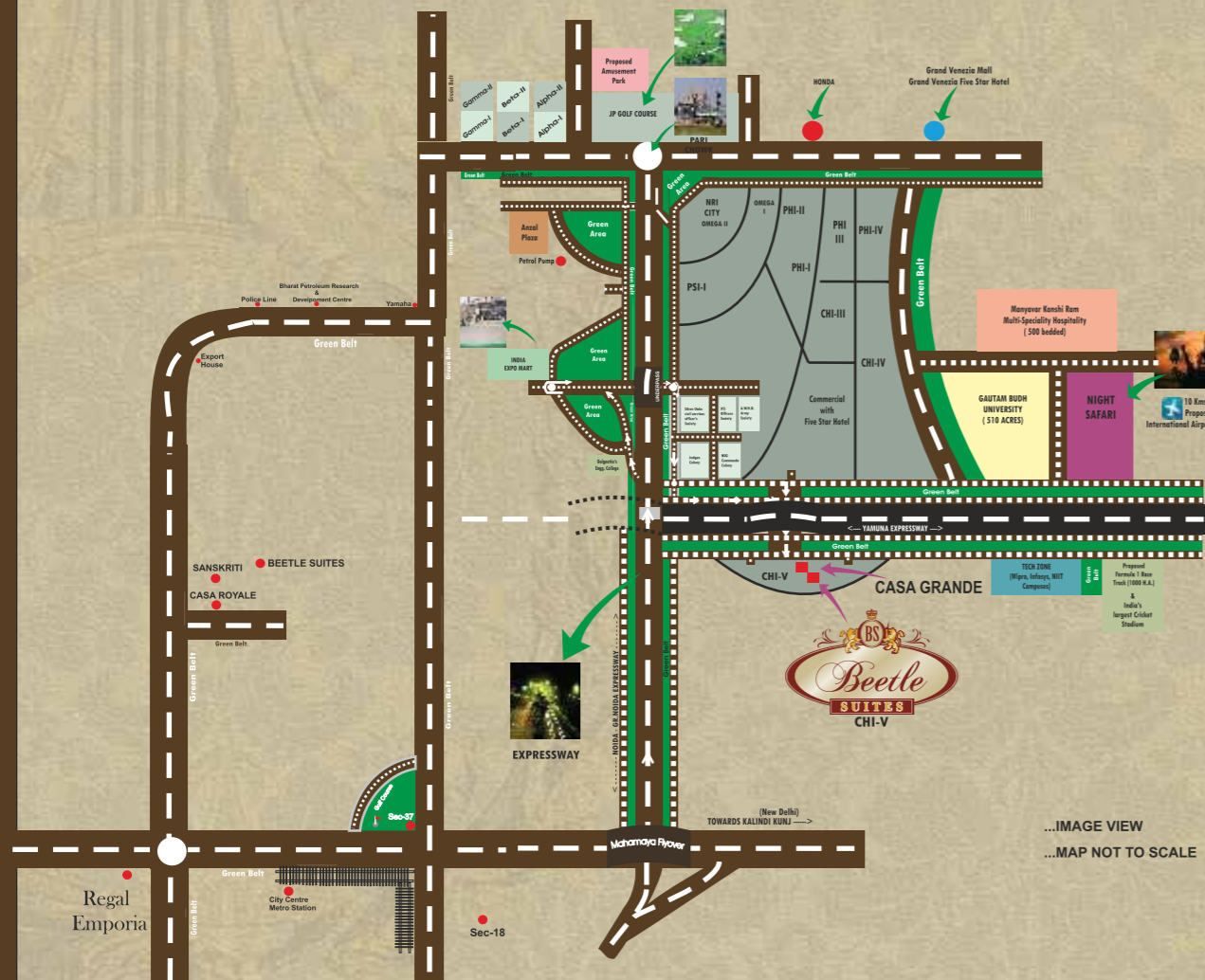

...IMAGE VIEW
...MAP NOT TO SCALE

- ✿ Fully Equipped Gymnasium
- ✿ Swimming Pool
- ✿ Spa Centre
- ✿ Yoga Centre
- ✿ Café Lounge
- ✿ Exclusive Residents Club Lounge
- ✿ Laundry And Dry Cleaning Service
- ✿ Concierge Service
- ✿ Housekeeping Service
- ✿ Broadband Internet Connections
- ✿ Wi-Fi Connectivity
- ✿ 24-Hour Security and Closed-Circuit Monitoring

Note: All above layouts are tentative & are subject to change without any prior notice. These are purely conceptual and constitute no legal offering. Balconies are subject to change as per elevation drawings.
1 Sq.mtr. = 10,764 sq.ft. ; 1 acre = 4047 sq.mtrs.(approx).

Specifications

SIZE 575 SQ.FT

❁ 2 AIR CONDITIONERS

❁ MODULAR KITCHEN

❁ REFRIGERATOR

❁ RO IN THE KITCHEN

❁ 2 LCDs

❁ EPABX SYSTEM

❁ GEYSER

❁ DOUBLE BED WITH MATTRESSES AND PILLOW

❁ WORKSTATION WITH CHAIR

❁ 4 SEATER SOFA WITH CORNER TABLE

❁ CENTRE TABLE

❁ 4 SEATER DINNING

❁ CONSOLE

❁ CURTAIN WITH CURTAIN RODS

❁ TOWEL RACK IN THE BATHROOM

SIZE 370 sq.ft.

❁ 1 AIR CONDITIONERS

❁ MODULAR KITCHEN

❁ MINI REFRIGERATOR

❁ RO IN THE KITCHEN

❁ 32" LCD

❁ EPABX SYSTEM

❁ DOUBLE BED WITH MATTRESSES AND PILLOW

❁ CURTAIN WITH CURTAIN RODS

❁ TOWEL RACK IN THE BATHROOM

❁ GEYSER

Specifications

Disclaimer: Color & Design can be changes without any prior notice. All products such as Marble/Granite/Wood/Tiles have inherent characteristics of slight variation in texture color and grain variations and cracks and behavior. Specifications are indicative and are subject to change as decided by the Company/Architect or Competent Authority. Marginal Variation may be necessary during construction. The extent/number/variety of the equipments/appliance and their make/brand thereof are tentative and liable to change at sole discretion of the company. Applicant/Allotee shall not have any right to raise objection in this regard.

Disclaimer: Color & Design can be changes without any prior notice. All products such as Marble/Granite/Wood/Tiles have inherent characteristics of slight variation in texture color and grain variations and cracks and behavior. Specifications are indicative and are subject to change as decided by the Company/Architect or Competent Authority. Marginal Variation may be necessary during construction. The extent/number/variety of the equipments/appliance and their make/brand thereof are tentative and liable to change at sole discretion of the company. Applicant/Allotee shall not have any right to raise objection in this regard.

Living Room/dinning room

- ❁ **Floor** : Vitrified Tiles
- ❁ **External Door and Window** : UPVC Doors/Windows/Flush
- ❁ **Fixture and Fitting** : Chandelier, Designer Lights, Fittings & Decorative Fan
- ❁ **Walls** : POP Finish with Plastic Emulsion
- ❁ **Internal Door** : First Class Sal Wood Frame with Skin Molded /Flush Door Shutter

Bedroom

- ❁ **Floor** : Wooden Laminated/Vitrified Tiles
- ❁ **External Door and Window** : Powder coated UPVC/ Aluminum Frame Windows Along UPVC / Aluminum Door
- ❁ **Fixture and Fitting** : Designer Lights, Fittings & Decorative Fan
- ❁ **Wood Work** : Wooden Cupboard