

## LOCATION MAP

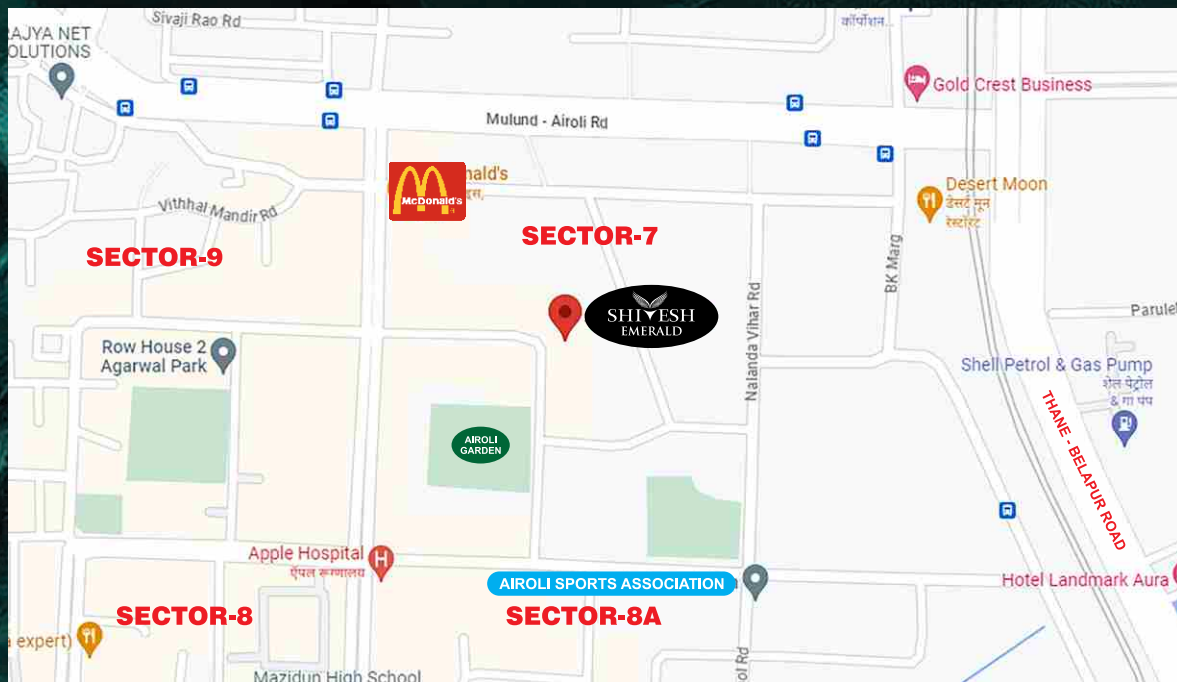

## COMPLETED PROJECTS



**ORCHID BLISS**  
PLOT 72, SECTOR 5, ULWE



**ORCHID HEIGHTS**  
PLOT 145, SECTOR 23, ULWE



**SHIV JINAL**  
PLOT 169, SECTOR 23, ULWE



**SHIVESH AURA**  
PLOT 298, SECTOR 17, ULWE

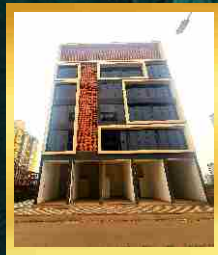

**SHIVESH ANANDI**  
PLOT 300, SECTOR 24, ULWE

## ONGOING PROJECTS



**SHIVESH EMERALD**  
PLOT 271, SECTOR 26, ULWE



**SHIVESH AURUM**  
PLOT 96 & 102, SECTOR 11, KHARGHAR



**SHIVESH ANANTA**  
PLOT 175, SECTOR 24, ULWE



**SHIVESH DAMODAR**  
PLOT 178, SECTOR 24, ULWE



**SHIVESH REVATI**  
PLOT 310, SECTOR 24, ULWE

# SHIVESH EMERALD

PLOT NO. 11B, SECTOR-7, AIROLI

Project By

**SHIVESH**  
REALTY PVT LTD  
- building thoughtful homes -

Head Office Add:  
A-411 Groma House, Sec-19, APMC Market,  
Vashi, Navi Mumbai

Email : [emerald@shiveshrealty.com](mailto:emerald@shiveshrealty.com)  
Website : [www.shiveshrealty.com](http://www.shiveshrealty.com)  
Contact : 9222 222 077 | 9372 327 954

Architect : ARCH-CONS  
Legal Advisor : Adv. Sagar Pawar  
Rcc Consultant : B.S. Sukhtankar

Disclaimer : All Plans, Drawing, Amenities, Facilities Etc. Are subject to approve of the respective authorised it would be changed, if necessary, They this creation remain with the developer. All rendering Pictures & Maps are the artist constructions & not actual depictions of the plot, roadways are landscaping. The brochure is for guidance & not a legal document the brochure should also reproduced, copied or made available other any form of transmission. The design & specification depicted in the brochure are subject to change without prior notice. Proposed development as mentioned in the brochure is subject to approved of complete authorities .

# ABOUT US

“

Today, the company enjoys a strong presence in Navi Mumbai, and has made its position as one of the growing companies in the real estate industry today with over 3,00,000 Sq.ft. Area delivered. We don't believe in creating just real estate projects. Instead, we believe in creating lifespaces that will stimulate your imagination and bring positive and higher energies into your life. As a group, we derive inspiration from nature and people. We believe in creating homes that give positive vibes, where people from all walks of life can surround themselves to the beauty of natural and peaceful surroundings, and get refreshed and recharged. We are a group that give high regards to morals and ethics. We believe in staying true to our inner conscience by being true to our work, our customers, our associates, our investors, partners and our employees, and creating harmonious benefits for all. Embark on a journey to self realization.

”





# PROJECT MODERN AMENITIES

- Open to Sky Garden
- Kids Play Area
- Open Gymnasium
- Sitting Area
- Indoor Games

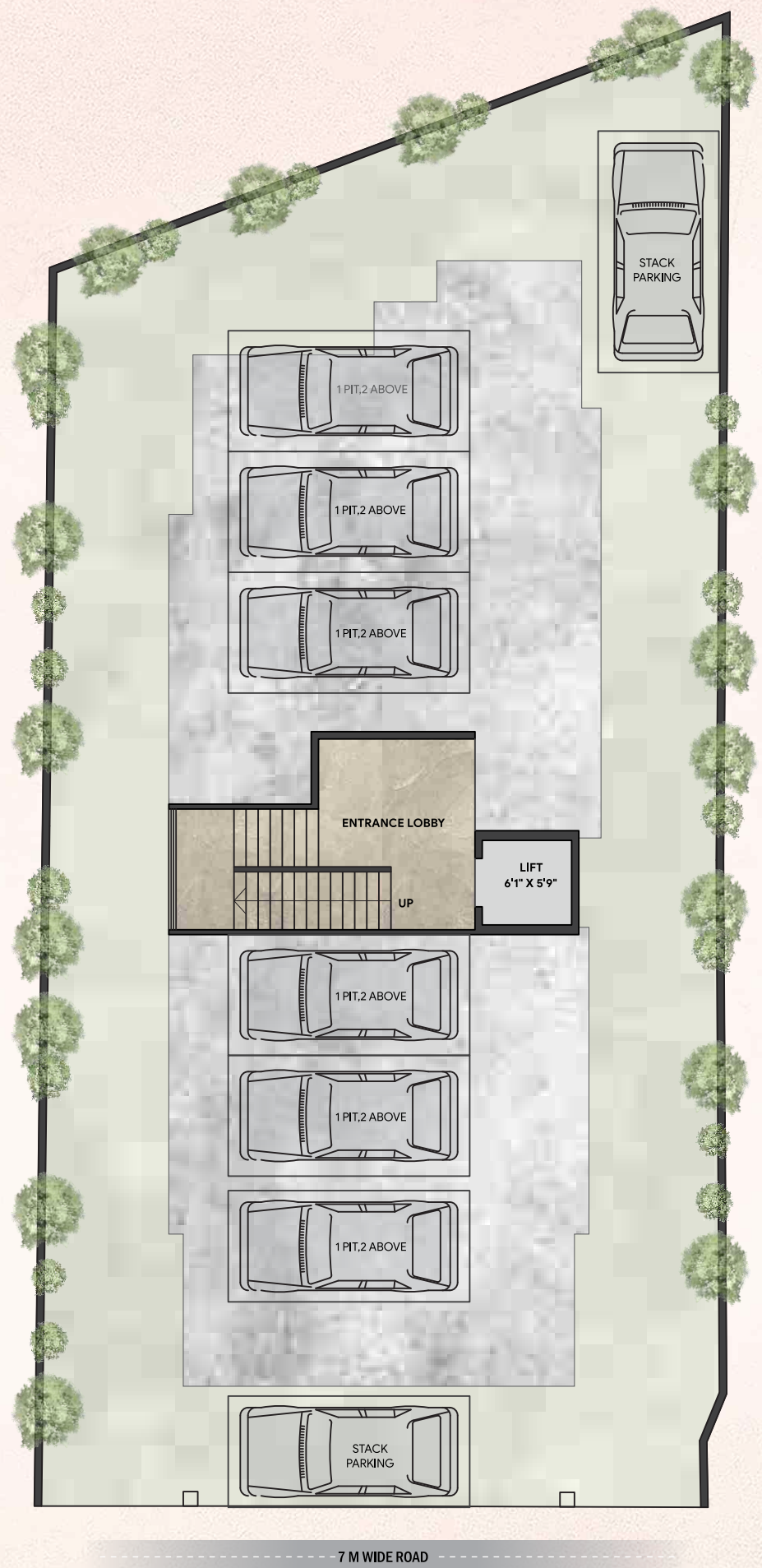

GROUND FLOOR PLAN

