

# STEP-IN TO A WORLD THAT SPELLS HAPPINESS ALL THE WAY

WHETHER IT IS AN APARTMENT THAT MAKES THAT FIRST IMPRESSION OR A DAILY ERRAND MADE EASY, LIVING AT 'EVITA' IS A PRIVILEGE IN ITSELF. ADD TO THAT, ITS SUPERIOR CONSTRUCTION VALUES, FIRST CLASS LAYOUT AND A CONVENIENT LOCATION, THAT MAKE IT ONE OF THE MOST DESIRED ADDRESS IN NAVI MUMBAI, TODAY.

## HAPPINESS IS AN ADDRESS THAT KEEPS YOU CONNECTED

Right from making every day travel to your work place or schools or entertainment, easy; to reaching you to your loved ones within minutes, Evita is conveniently located amidst a host of transport facilities. May we add, it has markets, medical facilities, shopping zones, educational institutions, in close proximity.



### WELL-CONNECTED

- Vashi – 30 Mins Drive
- Proposed Ranjanpada Railway Station - 2 Kms
- Proposed Dronagiri Railway Station in the vicinity
- JNPT - 1 Km
- Proposed Nhava-Sheva Sealink - 1.5 Km
- Proposed International Airport - 15 Mins Drive



Site Add.: Plot No. 01, Sector-54, Dronagiri, Navi Mumbai  
Corporate Office: 225, Second Floor, Big Splash, Plot No. 78 & 79, Sector 17, Vashi, Navi Mumbai- 400 705.  
Tel.: +91-22-2788 9991-98 | Fax: +91-22-2788 9982 | Email: info@akshardevelopers.com  
MahaRERA Registration No : P51700004758

Disclaimer: All specifications, drawings, amenities, facilities, parameters, etc., shown in this leaflet are subject to change as per the approval from the respective authorities. The final discretion remains with the developers.

www.akshardevelopers.com



## A LIFE CLOSE TO HAPPINESS

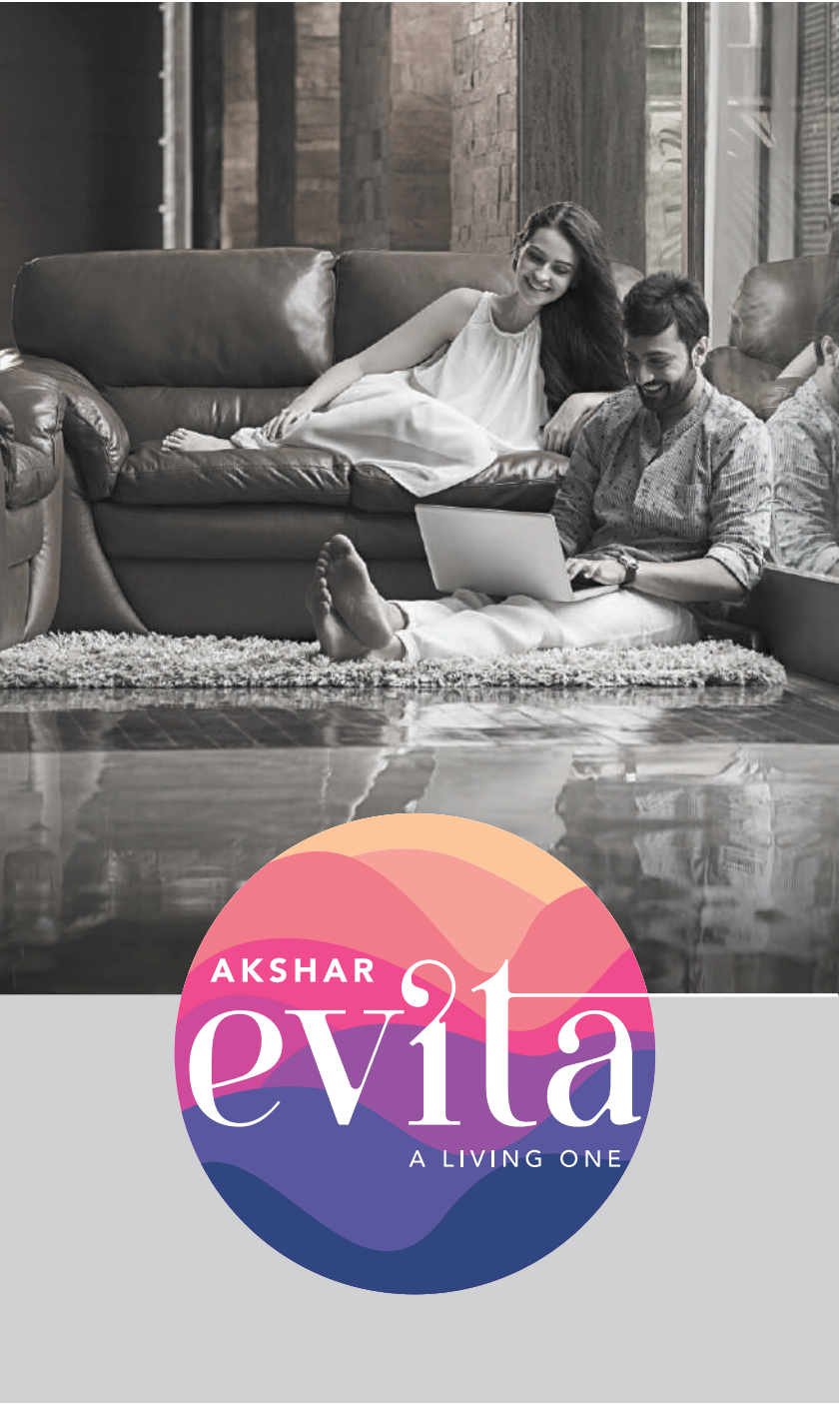

D R O N A G I R I





HAPPINESS IS,  
OWNING A  
LIFESTYLE THAT  
HAS IT ALL

- 1 BHK BOUTIQUE RESIDENCES ACROSS 12 LEVELS
- 6 SHOPS & OFFICE SPACES ON GROUND LEVEL
- LAVISH STILT AND OPEN CAR PARKS
- 24X7 MANNED SECURITY AND CCTV



## GROUND FLOOR PLAN

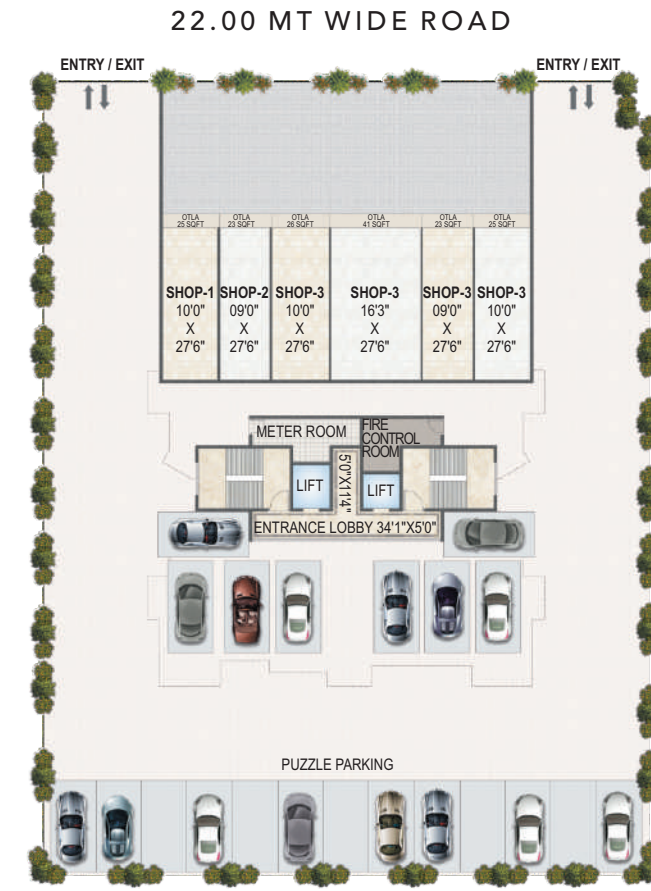

## EVEN FLOOR PLAN



Note: On 8<sup>th</sup> Floor, Flat No. 805 is Fire Refuge Flat



## TOP-OF-THE-LINE APARTMENT FEATURES

### FLOORING

- Vitrified flooring in Living room, Bed room & Kitchen.
- Ceramic finish tiles in all Terrace/Balcony flooring.

### DOORS & WINDOWS

- Panelled Main Door
- All Internal Doors are Commercial Laminate Finished Flush Doors.
- Anodized Aluminium Sliding Windows
- Window provided with Chajja & Railings (as per building elevation).

### KITCHEN

- Granite Kitchen Platform
- Branded SS Sink
- Full height glazed tiles till beam level

### BATHROOMS

- Spartex/Glazed tiles in flooring & full height glazed wall tiles.
- Premium Fittings and hot/cold water mixture in all attached Bathrooms.
- Non-wood FRP doors
- Louvered Glass Window in anodized Aluminium/Powder-coated frame.

### WALLS & PAINT

- Internal Walls with POP finish.
- Premium Quality Paints on Interior Walls
- High Quality Acrylic Paints on External Walls

### ELECTRIFICATION

- Concealed Copper Wiring with adequate points for Fridge, Geyser, TV/cable, Telephone etc.
- Concealed Copper Wiring with Modular Switches.

### PLUMBING

- Concealed Piping system in Kitchen & Bathrooms
- C.P. Fittings of reputed make

### SECURITY

- Intercom and 24 x 7 Security

## 1<sup>st</sup> FLOOR PLAN



## 2<sup>nd</sup> FLOOR PLAN



## ODD FLOOR PLAN

