



THE FIRST INDO-JAPANESE MEGA REAL ESTATE PROJECT

SUMITOMO CORPORATION, JAPAN AND KRISHNA GROUP,
INDIA JOINT VENTURE



WATERFALL RESIDENCES

Krisumi. The name brings together the finest Indian and Japanese values.
'Kri' comes from 'Kriya' - Sanskrit for creation.
And 'Sumi' is Japanese for fine living.
As with the name,
so with the company. Krisumi brings together the finest Japanese craftsmanship and the warmest Indian hospitality to create a unique experience for the discerning home owners of today.
Krisumi is backed by names you can trust: Sumitomo Corporation is a Fortune 500 company, with a legacy that goes back 400 years, and has the proven experience of having delivered over 300 successful projects worldwide. Krishna Group is an automobile behemoth, with Krishna Maruti Ltd as its flagship company. The Group is renowned for its focus on customers, stringent quality processes and strict adherence to commitments. Krisumi Waterfall Residences is characterised by highest Japanese quality standards, with contemporary global aesthetics and thoughtful touches to make every moment richer and fuller. The project is designed by Nikken Sekkei, Japan's No. 1 architectural firm and the name behind the landmark Tokyo Skytree. Construction is being carried out by Tata Projects Ltd., assuring impeccable execution.

Come, discover the unique world of
Krisumi Waterfall Residences...

KRISUMI CITY

Krisumi City is an urban development project that seamlessly blends Japanese craftsmanship and Indian hospitality, to create a living that's simply sophisticated. Conceptualized as a truly integrated project, the inter-component synergy arising from high quality residential, office, retail, hospitality, education and health care options shall position Krisumi City as the showcase for urban living.

Designed by the world-class designer's Nikken Sekkei, Krisumi City will be designed with the highest standards of Japanese quality and aesthetics.

Arrive at Krisumi City and experience life, the way it is meant to be.



| LEGEND | DISTANCE (Approx) |
|-------------------|-------------------|
| NH48 | 1.8 Kms |
| IGI Airport | 24.8 Kms |
| Cyber City | 17 Kms |
| Dwarka | 19 Kms |
| IFFCO Chowk | 13.6 Kms |
| Ambience Mall | 18 Kms |
| NPR | 1 Kms |
| Pataudi Road | 1.6 Kms |
| MG Road | 14.6 Kms |
| Medanta Hospital | 9.6 Kms |
| Karma Lakeland | 6.9 Kms |
| Hero Honda Chowk | 5.6 Kms |
| Rajiv Chowk | 8.6 Kms |
| Rockland Hospital | 9.2 Kms |

DIRECTIONS

- 4 minutes from Kherki to right turn
- 5 minutes to Dwarka EL Road
- 5 minutes to Krisumi

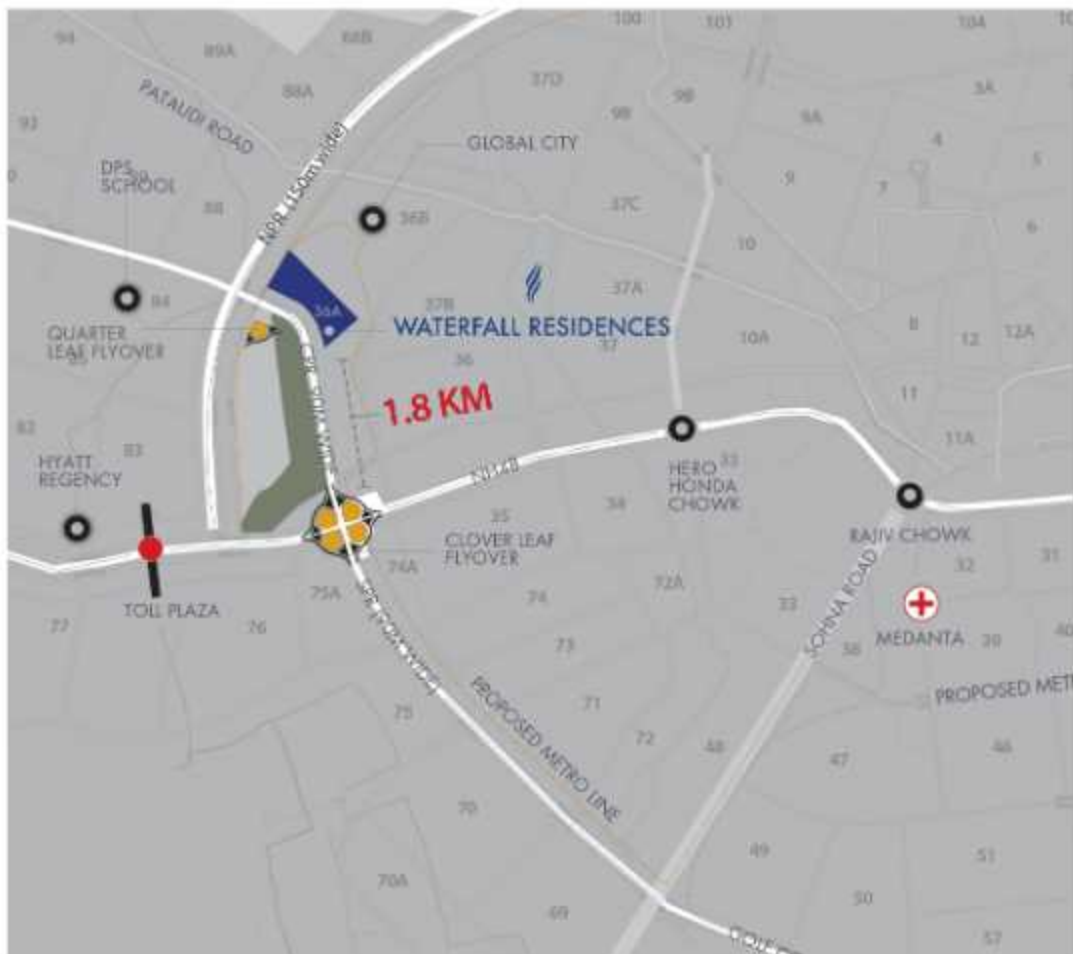





TRUMPET JUNCTION

National Highway Authority of India is building a trumpet junction between Dwarka Expressway and CPR. This junction will merge with the clover leaf connecting COR, NH-48 and SPR, providing unrestricted access to all parts of Gurugram.



CLOVER LEAF FLYOVER

A network of roads and flyovers including a clover leaf is being built to provide seamless access between Southern Peripheral Road (SPR), Central Peripheral Road (CPR) and NH-48. This would be the largest road infrastructure initiative in the city of Gurugram, making it a landmark in itself.

UNPARALLELED CONNECTIVITY

- 2 of the widest roads in Gurugram – Northern Peripheral Road (CPR)
- National Highway-48 (NH-48) is the main arterial road for the city of Gurugram
- 3 minutes drive to NH-48
- Mass Rapid Transit System is planned along NPR and CPR
- CPR links Dwarka Expressway (NPR), with Southern Peripheral Road (SPR)
- Flanked by 220 acres of Green Zone and 50 meters Green Belt
- Spread between 2 commercial zones
- Adjacent to Global City- the newest business center-in Gurugram
- Unhindered connectivity to Indira Gandhi International

EXCLUSIVITY OF GLOBAL CITY

- Better work opportunities
- Malls, entertainment, retail and other utilities
- School, hospitals, police/fire stations
- Poised to be another big IT/ITES centre



THE JAPANESE ART OF LIVING

Some of the terms synonymous with Japan are quality, reliability, timelessness, efficiency, finesse, aesthetics, sustainability and longevity. It is this view that Waterfall Residences have been designed based on the Japanese style of art and architecture to provide enduring value to the residents.





JAPANESE STYLE OF ART & ARCHITECTURE

滝



TAKI (WATERFALL)

Taki meaning waterfall represents the formless things of the world while being the epitome of simplicity and purity. Incorporated in the design, TAKI is the landscape theme of the project and has been interpreted at several places including the façade.

結界

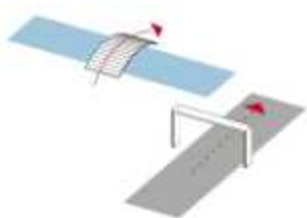

KEKKAI (TRANSITION)

Kekikai denoting transition combines the elements of water and bridge to create a different world, separating inside from outside.

光
影



HIKARI, KAGE (LIGHT & SHADOW)

Hikari means light and Kage means shadow. This concept has been incorporated in the design across multiple areas to create an attractive mix of light and shadow.

縁
側

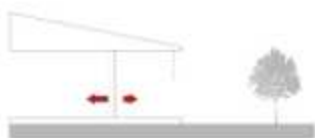

ENGAWA (CONNECTION)

Engawa acts as a connecting element between the architecture and landscape. This design element has been incorporated to seamlessly blend the interior architecture with the landscaping outside.



JAPANESE STYLE OF ART & ARCHITECTURE

坪庭



TSUBONIWA (SMALL GARDEN)

The concept of Tsuboniwa or small garden is in line with the Japanese philosophy of sophisticated minimalism which signifies "less is more"

回遊性

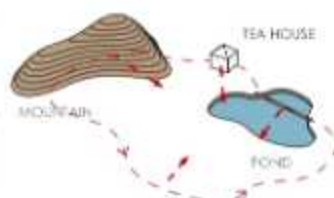

KAIYUUSEI (STROLL GARDEN)

The aesthetic and philosophical concept behind Kaiyuusei or Japanese Stroll Garden is to highlight natural landscaping elements while avoiding artificial ornamentation.

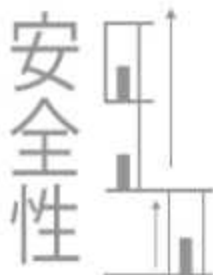

ANZEN (SECURITY)

Special attention has been paid in designing a multi-level security system. Access control system and high-speed shuttle elevators are some of the unique feature.

対比

粹

IKI

GREY

OR

然

ZEN

BEIGE

TAIHI (CONTRAST)

Taihi meaning contrast is widely used in Japanese architecture, contrasting colours and elements are put together to engage the user's attention.



ARCHITECTURE BASED ON CONCEPTS

The project Waterfall Residences has been formulated using the concepts of Japanese form of art and architecture. The minimal design aesthetics beautifully cover the different areas of Waterfall Residences and therefore, shall provide you a life, simply sophisticated.



1 Areas Covered

- Facade

TAKI WATERFALL



TSUBONIWA (SMALL GARDEN)



2 Areas Covered

- Theatre
- Gymnasium
- Spa
- Treatment Room
- Jacuzzi

3 Areas Covered

- Tower A & B Drop-Off
- Tower C Drop-Off
- Main Entrance

KEKKAI TRANSITION



KARYUSEI (STROLL GARDEN)



4 Areas Covered

- Pool Area
- Terrace Garden
- Kid's Playroom/Kid's Playground
- Refreshment Corner
- Convenience Store
- Landscape Near The Pool
- Squash Court
- Tennis Court

5 Areas Covered

- Clubhouse Drop-Off
- Tower A & B Lobby
- Tower C Lobby
- Café
- Banquet
- Clubhouse Lobby

HIKARI, KAGE (LIGHT & SHADOW)



ANZEN (SECURITY)



6 Areas Covered

- Main Entrance
- Tower Lobbies
- Apartment Entrance

7 Areas Covered

- All-in-one Dining With Pool View
- Restaurant
- Bar lounge

ENGAWA (CONNECTION)



TAIJI (CONTRAST)



8 Areas Covered

- Living & Dining Room
- Kitchen
- Master Bedroom
- Washroom
- TV lounge
- Kid's Room



Taki represents the primary life force, water in its unrestricted and unhindered mode. In Japanese philosophy, waterfall is believed to incarnate the purity and simplicity of life while being a sacred cleansing agent through its unrelenting release of energy and emotions.

Waterfall, in the context of architectural design highlights its most notable aspect- permanence of form despite the change on content. The "stepped tower crown" represents the steps in a waterfall while the podium represents the base. Besides, the clubhouse sudare mirrors the glittering water splash.

Areas Covered- Facade



TAKI (WATERFALL)

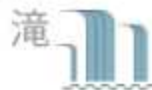

KIKUKI (TRANSITION)



HUAI, ERGE (LIGHT & SHADOW)



SHIGAMA (CONNECTIONS)



TUBUCHENG (SMALL GARDENS)



KAYUSHI (BIG GARDEN)



ANZEN (SECURITY)



TAKI (CONTRAST)





Kekkai means transition. The elements of water and bridge come together to signify the movement from one world to another. While the water represents the passage of time through its natural flow, the bridge is symbolic of the pathway of one's journey.

The architectural context of this concept is to provide a sense of arrival literally to a new environment, and metaphorically to a new life. With this context, the architectural design for Waterfall Residences incorporates Kekkai across all key entrance points.

Areas covered-

- Tower A&B Drop-Off • Tower C Drop Off • Main Entrance

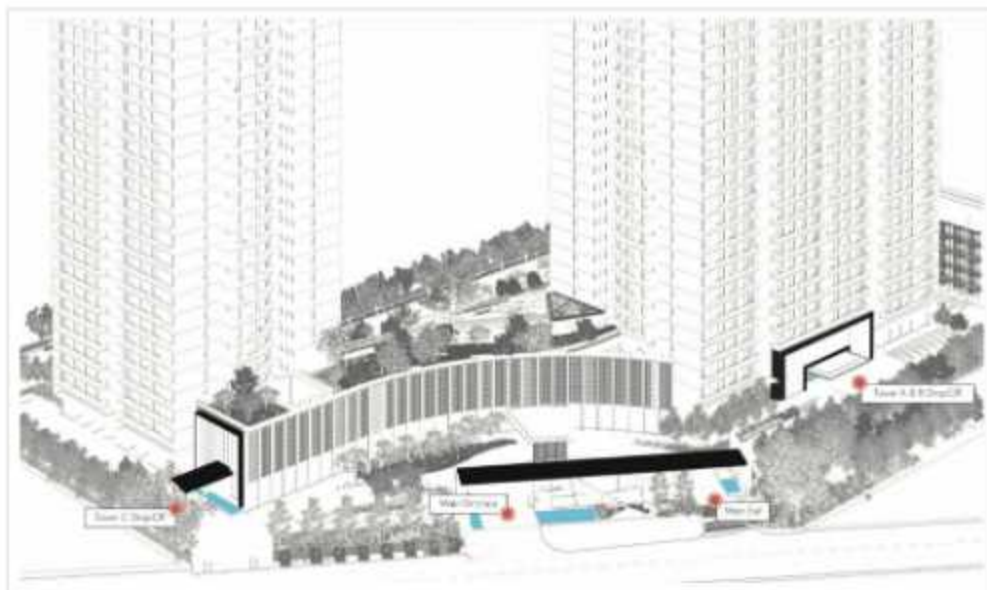

SAKI (WATERFALL)



KEKKAI (TRANSITION)

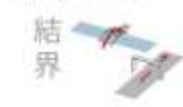

HUARI, ERGE (LIGHT & SHADOW)



SHIGAMA (CONNECTIONS)



TUBOCHENG (PAAL GARDENS)



KAYUSHI (POOL GARDEN)



ANZEN (SECURITY)



SAKI (CONTRAST)





Tower A & B Drop-Off



Tower C Drop-Off



Main Entrance

SHI (WATERFALL)



KIKU (TRANSITION)

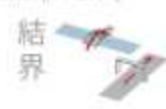

HWAI, KAGE (LIGHT & SHADOW)



ENJANA (CONNECTIONS)



TUBUCHANA (SMALL GARDENS)



KAYUSHI (WIDE GARDEN)



ANZEN (SECURITY)



SAHI (CONTRAST)





Hikari means light and Kage means shadow. While symbolically the play between light & shadow represents everyday life, in the architectural context, this concept has been utilized to depict the idioms of "keeping the focus on what is important" and "revealing everything in due time". The use of wooden louvers and sudare in the tower lobbies and clubhouse creates an attractive mix of light and shadow which apart from its aesthetic appeal also keeps the temperature cool.

Areas Covered-

- Clubhouse Drop-off • Tower A&B Lobby • Tower C Lobby
- Café • Banquet • Clubhouse Lobby



Club Drop-Off

SAI (WATERFALL)



KIKUJI (TRANSITION)



HIKARI, KAGE (LIGHT & SHADOW)



ENIGAMA (CONNECTIONS)



TSUBCHINA (SMALL GARDENS)



KAYUSUJI (POOL GARDEN)



ANZEN (SECURITY)



SAKI (CONTRAST)





Tower A & B lobby

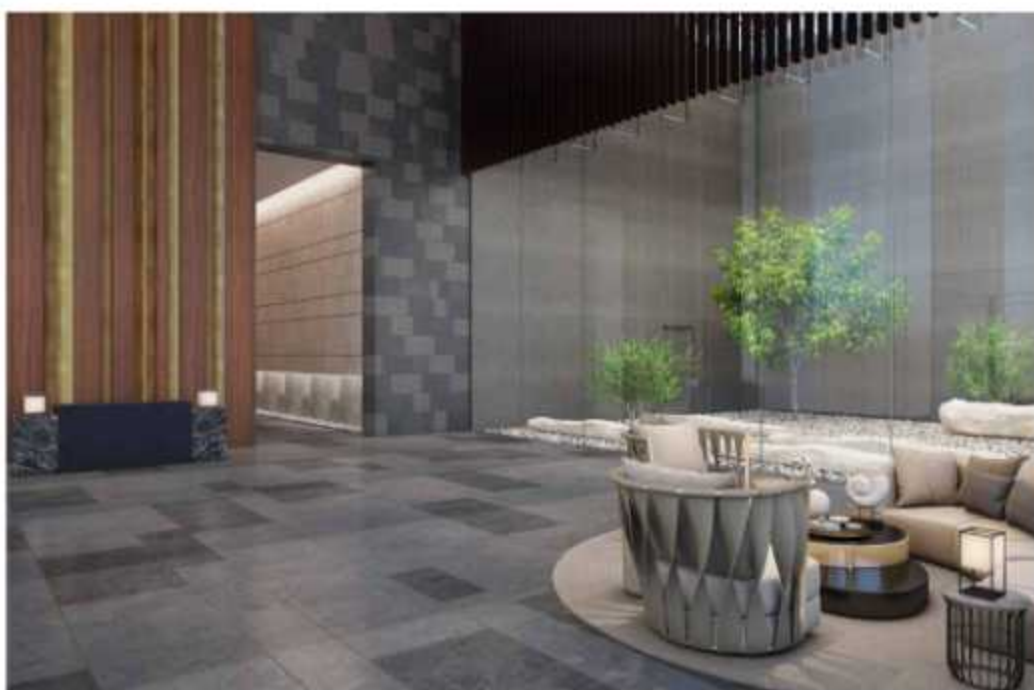

Tower C lobby

SHI (WATERFALL)



KIKU (TRANSITION)



HIKARI, KAGE (LIGHT & SHADOW)



ENOSAKA (CONNECTIONS)



TSUBOKIWA (SMALL GARDENS)



KAYUJIKI (WOOD GARDEN)



ANZEN (SECURITY)



SAKI (CONTRAST)





Cafe



Banquet



Clubhouse Lobby

SHI (WATERFALL)



KIKUJI (TRANSITION)



HUAI, ERGE (LIGHT & SHADOW)



SHIGAMA (CONNECTIONS)



TUBOCHINA (PAVILION GARDEN)



KAYUSHI (POND GARDEN)



ANZEN (SECURITY)



SHI (CONTRAST)





The concept of Engawa literally translates as the edge of the building which provides the connection between the interior and exterior. Traditionally, in Japan, Engawa was used as a casual space to have spontaneous conversations or enjoy the weather. The idea behind this design element is to seamlessly blend the interior architecture with the landscaping outside, thus merging the structures with surrounding nature.

Area Covered-

- Alfresco Dining with pool view • Restaurant • Bar lounge



Alfresco Dining with pool view

SAI (WATERFALL)



KIKUJI (TRANSITION)



HIKARI, EDGE (LIGHT & SHADOW)



ENGAWA (CONNECTION)



TSUBOHANA (SMALL GARDENS)



KAYUJIKI (WOOD GARDEN)



ANZEN (SECURITY)



SAKI (CONTRAST)





Restaurant



Bar Lounge

SHI (WATERFALL)



KIKU (TRANSITION)



HUAI, KONG (LIGHT & SHADOW)



SHANG (CONNECTIONS)



TUBOCHENG (PAAL GARDENS)



KAYUSHI (POND GARDEN)



ANZEN (SECURITY)



SHI (CONTRAST)





The concept of Tsuboniwa or small garden is in line with the Japanese philosophy of sophisticated minimalism which signifies "less is more". Representation of larger than life elements are reduced to a more understandable scale where a rock can become a mountain, raked sand or gravel can represent ocean and pebbles can represent a rushing stream. In Waterfall Residences, this Japanese landscaping element has been utilized across a plethora of public spaces, internal and external, since careful thought and deliberation has gone in the design of every small corner.

Areas Covered-

• Theatre • Gymnasium • Spa • Treatment Room • Jacuzzi



TAKE (WATERFALL)



KIKKAI (TRANSITION)



HUARI, KAGE (LIGHT & SHADOW)



ENSHUWA (CONNECTIONS)



TSUBONIWA (SMALL GARDEN)



KAYUJIKI (WOOD GARDEN)



ANZEN (SECURITY)



TAIJI (CONTRAST)





Theatre



Gymnasium

SHI (WATERFALL)



KIKUAI (TRANSITION)



HIKARI, KAGE (LIGHT & SHADOW)



ENOSAKA (CONNECTIONS)



TSUBOHARA (YARD GARDEN)



KAYUJIKI (WOOD GARDEN)



ANZEN (SECURITY)



SAKI (CONTRAST)





Jacuzzi



Spa



Treatment Room

SAE (WATERFALL)



KIKKAI (TRANSITION)



HYAKU, EAGE (LIGHT & SHADOW)



ENIGAMA (CONNECTIONS)



TSUBOHARA (WALL GARDEN)



KAYUJIKI (WOOD GARDEN)



ANZEN (SECURITY)



SAHI (CONTRAST)





The aesthetic and philosophical concept behind Kaiyuusei or Japanese Stroll Garden is to highlight natural landscaping elements while avoiding artificial ornamentation. Materials found organically in nature are used to suggest an ancient and faraway natural landscape and to express the fragility of existence and time's unstoppable advance. Scattered throughout the development, these stroll gardens have been designed to provide pure harmony with nature in its truest form.

Areas Covered-

- Pool area • Terrace Garden • Kid's Playroom/Kid's Playground • Refreshment Corner • Convenience Store • Landscape Near The Pool • Squash Court • Tennis Court





Terrace Garden



Pool Area

SHI (WATERFALL)



KIKUJI (TRANSITION)



HUAI, LAO (LIGHT & SHADOW)



SHANGA (CONNECTIONS)



TUBOCHENG (SMALL GARDENS)



KAYUKUJI (POOL GARDEN)



ANZEN (SECURITY)



SAHI (CONTRAST)





Kid's Playroom



Refreshment Corner



Convenience Store

TAI (WATERFALL)



KIKUJI (TRANSITION)



HIKARI, KAGE (LIGHT & SHADOW)



ENKANA (CONNECTIONS)



TUBUCHIWA (SMALL GARDENS)



KAYUSHI (BIG GARDEN)



ANZEN (SECURITY)



TAI (CONTRAST)





Landscape near the pool



Squash Court



Tennis Court

SAHI (WATERFALL)



KIKKAI (TRANSITION)



HVARI, EAGE (LIGHT & SHADOW)



ENIGAMA (CONNECTIONS)



TSUBCHINA (PAVILION GARDENS)



KAYUKUSHI (POND GARDENS)



ANZEN (SECURITY)



SAHI (CONTRAST)





Anzen means safety. Careful thought and deliberation has gone into designing a three-tiered security system to enhance the sense of safety for the residents.

Areas Covered-

- Main entrance • Tower Lobbies • Apartment Entrance



Main Entrance



Lift Lobby



Lift Interior

SAKI (WATERFALL)



KIKUAI (TRANSITION)



HVARI, KAGE (LIGHT & SHADOW)



ENKANA (CONNECTIONS)



TSUBCHINA (SMALL GARDENS)



KAYUJIKI (WOOD GARDEN)



ANZEN (SECURITY)



SAKI (CONTRAST)



Tire 1: Perimeter security

The guards along with the CCTV will provide the highest level of vigilant perimeter surveillance round the clock. Boom barriers will block the Vehicular access by using controlled point. There is separate service entry and exit for support staff.

Tier 2: access control

There will be access cards, each numbered and coded to unblock the residents access zones. The visitors during their registration at the main entry will get an access card to the specified zones for a given timeframe.

Tier 3: circulation control

To enhance security, the vertical circulation has been divided into shuttle elevators connecting just the basements with the lobbies, and tower elevators. They will provide access to the residential zone only after screening by the lobby concierge. To restrict movement, the driver room, the driver washroom, the main room and their respective shower areas are in the basement.

Main Entrance

SAI (WATERFALL)



KIKUAI (TRANSITION)



HUAI, LAZE (LIGHT & SHADOW)



SHIGAMA (CONNECTIONS)



TUBOCHINA (SMALL GARDENS)



KAYUJISEI (BIGG GARDEN)



ANZEN (SECURITY)



SAHI (CONTRAST)





"Taihi" is a sophisticated and substantiated design, based on the concepts of Zen and Iki.

Zen Beige: "Zen" means a part of nature.

IKI Grey: "IKI" stands for sophistication. The unity of these two styles create a luxurious and tranquil space.

Areas Covered-

- Living & Dining Room • Kitchen • Master Bedroom
- Wahroom • TV Lounge • Kid's Room

IKI GREY

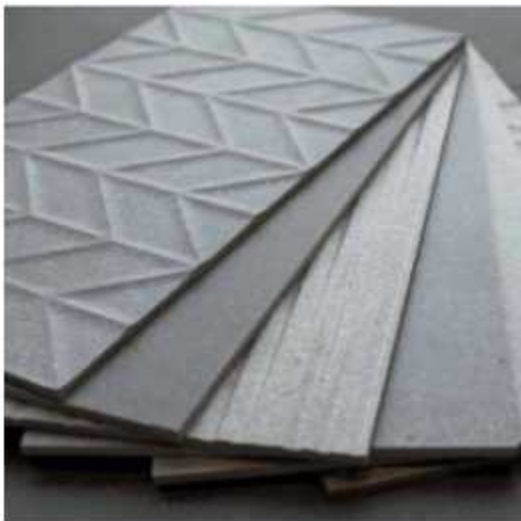

ZEN BEIGE

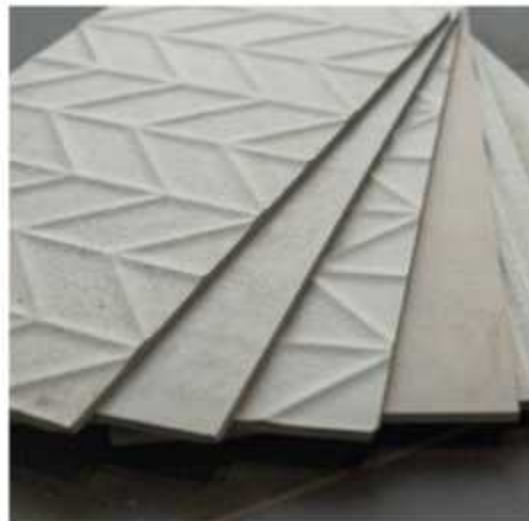

SAI (WATERFALL)



KIKU (TRANSITION)



HIKARI (LIGHT & SHADOW)



ENKANA (CONNECTIONS)



TSUBOKI (SMALL GARDEN)



KAYU (WOOD GARDEN)



ANZEN (SECURITY)



TAIHI (CONTRAST)





Living & Dining



Kitchen

SHI (WATERFALL)



KIKUJI (TRANSITION)



HUAI, LAOGE (LIGHT & SHADOW)



SHIGAMA (CONNECTIONS)



TUBUCHENG (SMALL GARDEN)



KAYUJIKI (BIG GARDEN)



ANZEN (SECURITY)



SAHI (CONTRAST)



[illegible]

Rotate Your Phone

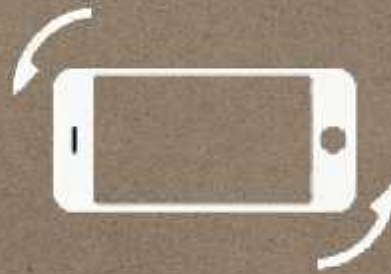

This E-Brochure is Horizontal





WATERFALL SUITES

SUMITOMO CORPORATION, JAPAN X KRISHNA GROUP, INDIA
THE FIRST INDO-JAPANESE MEGA REAL ESTATE JV

KRISUMI
CORPORATION

CONTENTS



KRISUMI CORPORATION

A NEW BEGINNING...
OF CREATING
FINE LIVING WITH
SIMPLICITY





When the perfect blend of renowned Japanese craftsmanship meets the warmth and colour of Indian hospitality, simplicity is rediscovered as the ultimate level of sophistication.

This blend - **Krisumi Corporation** - is an enterprising collaboration between the renowned Japanese conglomerate **Sumitomo Corporation**, with a legacy hundreds of years old, and **Krishna Group**, the Automotive Component behemoth in the Indian manufacturing landscape. The word *Krisumi* is derived from a combination of the Sanskrit word *Kriyā* meaning 'creation' and the Japanese word *Sumi* meaning 'fine living', perfectly expressing the very spirit of the enterprise in its name itself.

From the 'U' to the 'I', Krisumi believes in working together to create simple & elegant sophistication in modern residential life.

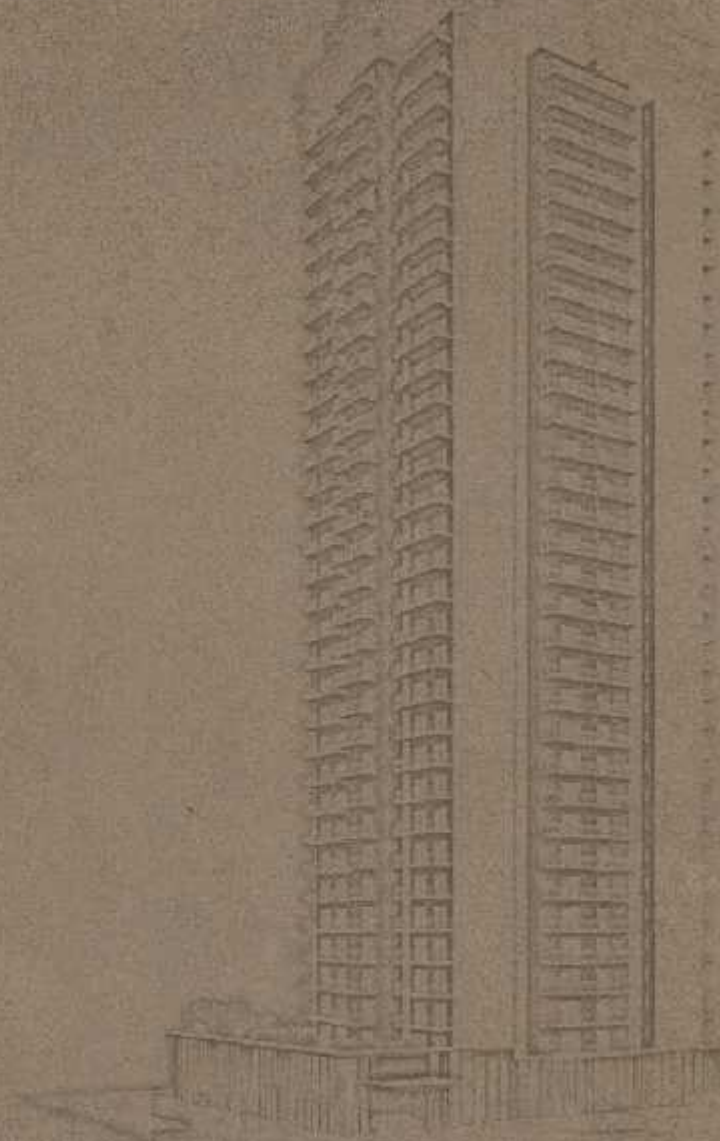



A NEW VOW... IN A HISTORIC COMMITMENT TO QUALITY

The **Krishna Group** is renowned as one of the largest automotive component manufacturers in India. With **Krishna Maruti Limited** as its flagship company, Krishna is leading automotive manufacturing in the country for many decades now. The group has diversified interests in automotives, travel, media, entertainment seating and real-estate among various other successful ventures.

Driven by a philosophy of collaboration, Krishna Group services marquee clients across the world today, with **17** successful joint ventures with global leaders in each of their fields. The group is renowned for its customer orientation, quality products and strict adherence to commitments.

www.krishnagroup.co.in



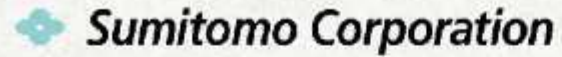

A NEW TALE... IN A LEGACY SPANNING CENTURIES

A scion of the revered 400-year-old **Sumitomo Group**, Sumitomo Corporation embodies the traditional Japanese heritage of attention to detail, skilled craftsmanship and an incessant drive for perfection. A Fortune 500 company with an annual Revenue exceeding **\$51.263 Billion** (FY 2022-2023), Sumitomo Corporation employs **75,487 personnel** across **883 Group Companies** spread across a vast geographical expanse spanning **66 countries**.

Sumitomo Corporation has successfully delivered over **300 World-Class** projects spread over Japan, USA, China & Indonesia. With its global network built on trust from companies in various industries and from consumers, Sumitomo Corporation engages in multifaceted business activities by making the most of its integrated corporate strength.

www.sumitomocorp.com





NIKKEN
EXPERIENCE, INTEGRATED

A NEW EXPERIENCE... IN MODERN ARCHITECTURE

A giant in the realm of architecture & real estate design internationally, **Nikken Sekkei** is an architectural, planning and engineering firm from Japan, with headquarters in Tokyo. With a rich legacy spanning over **120 years**, Nikken ranks as the **second largest architectural practice in the world**.

The group has completed over **25,000 projects** in **250+ cities** across more than **50 countries**. Nikken Sekkei's imprint on city skylines all over the world includes such iconic projects as the landmark **Tokyo Skytree** in Tokyo, Japan; the **Bank of China Tower** in Shanghai, China and the astounding **One Zabeel Project** in Dubai, U.A.E. among countless others.

www.nikken.co.jp

ONLY THE BEST FOR YOU



TOTO

TOSTEM

AGC



BOSE



Kajaria

Disclaimer: Above brands were used in our flagship project 'Waterfall Residences' and we are committed to using similar brands that meet or exceed the quality and performance of the tested brands.





A NEW VISION

LEGACY • COMMITMENT • ZEAL

WHEN THE BEST IN THE WORLD COME TOGETHER
IN A FLOW OF SIMPLICITY & ELEGANCE,
MODERN LIVING FINDS ITS TRUE HOME.

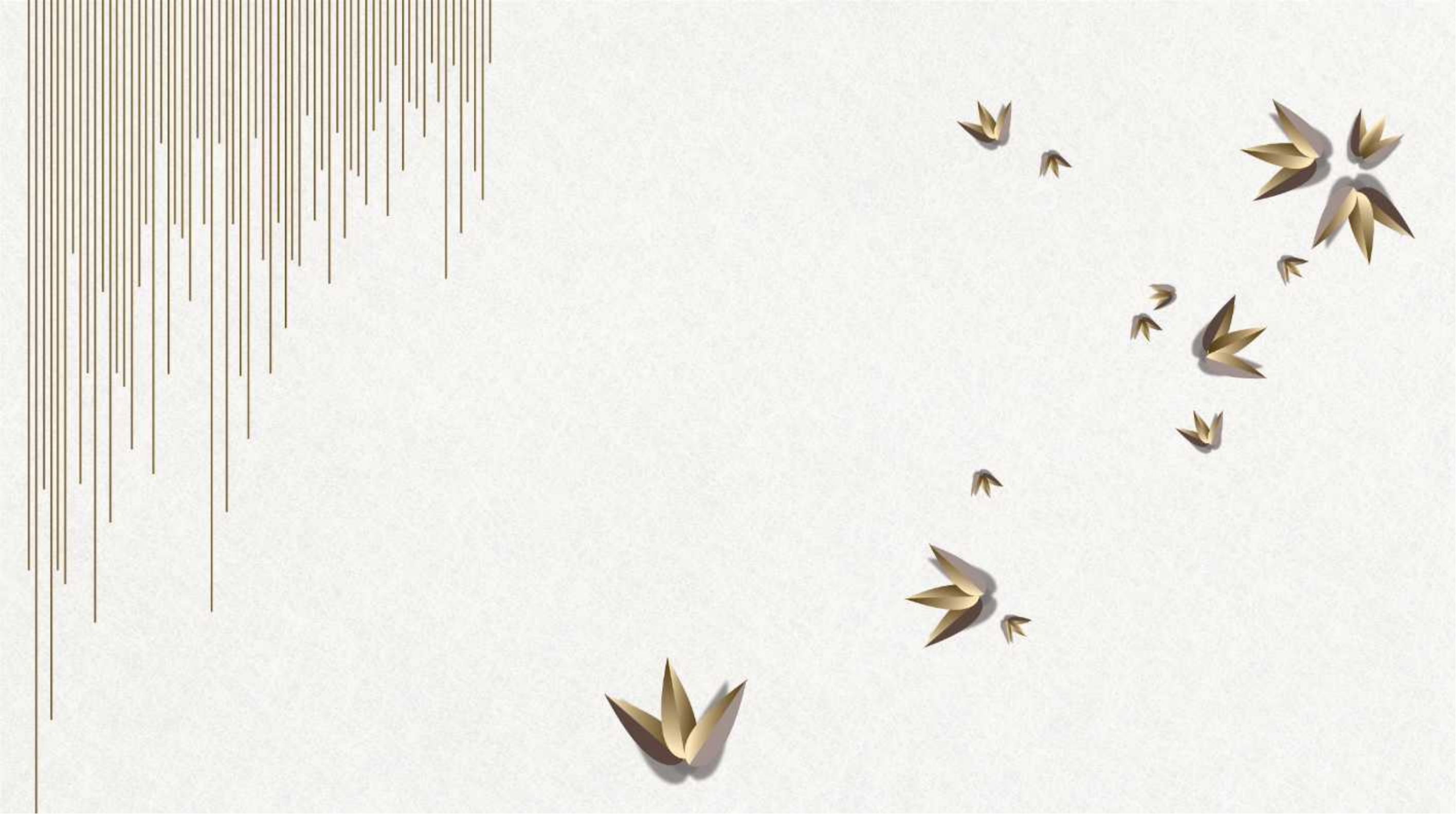

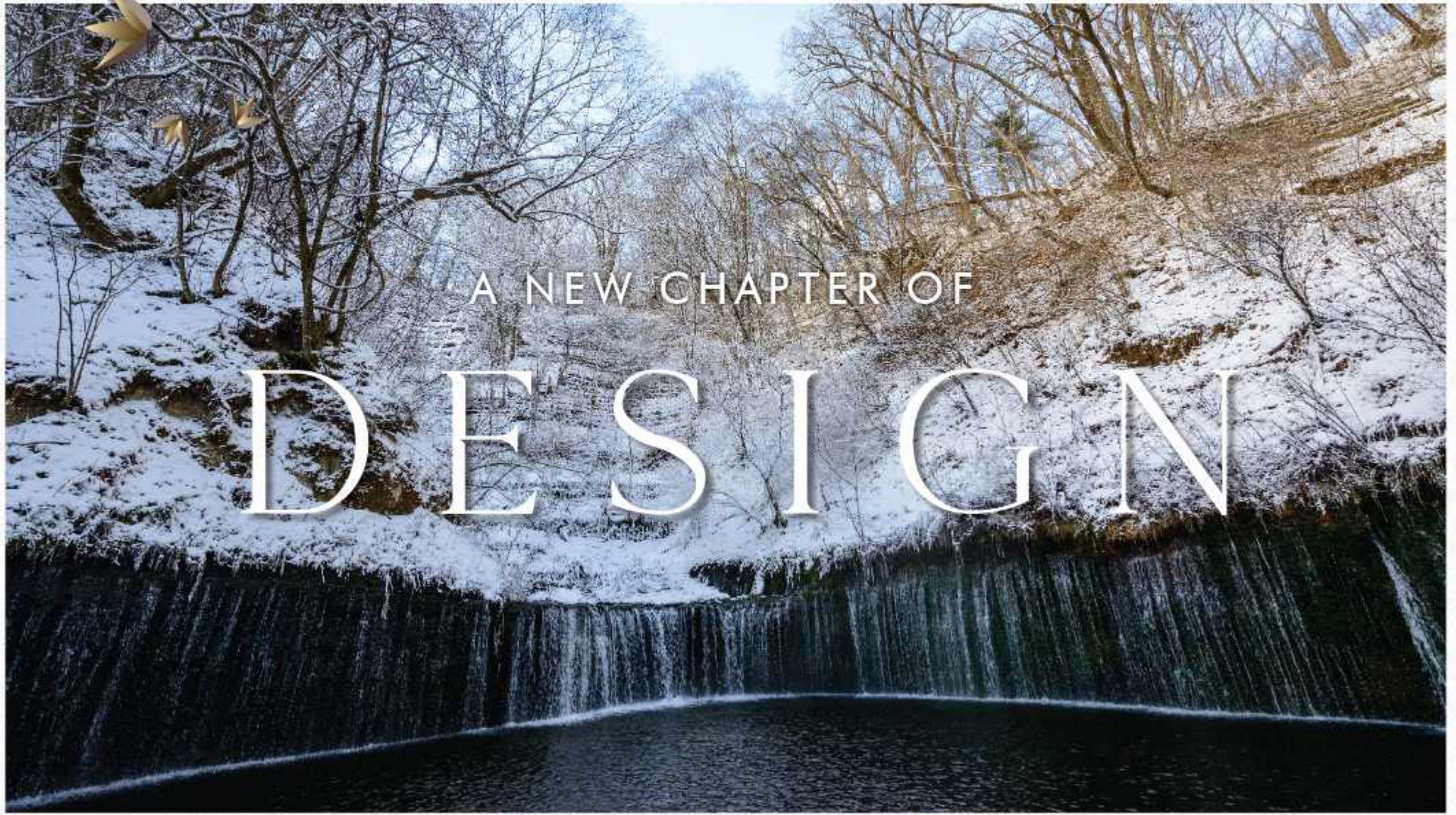

A NEW CHAPTER OF
DESIGN

Inspired by the serene **Shiraito Waterfall**, located near Mount Fuji in Japan, the design of Waterfall Suites weaves in elements of the stream, thread and calmness of water into a graceful façade. The waterfall represents the versatility of formless things within our world while being the epitome of simplicity and purity. *Shiraito no Taki* is the landscape theme of the project and it has been interpreted at several places, incorporated into the design itself.

FAÇADE DESIGN | Shiraito no Taki



WHITE
SNOW

WHITE
THREAD
BLACK
CLIFF

BLACK
WATER
BASIN

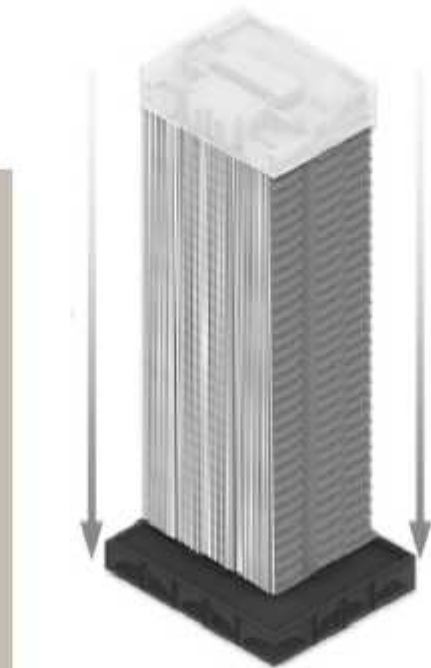

WHITE GLOWING CROWN

VERTICAL FAÇADE

BLACK REFLECTIVE PODIUM



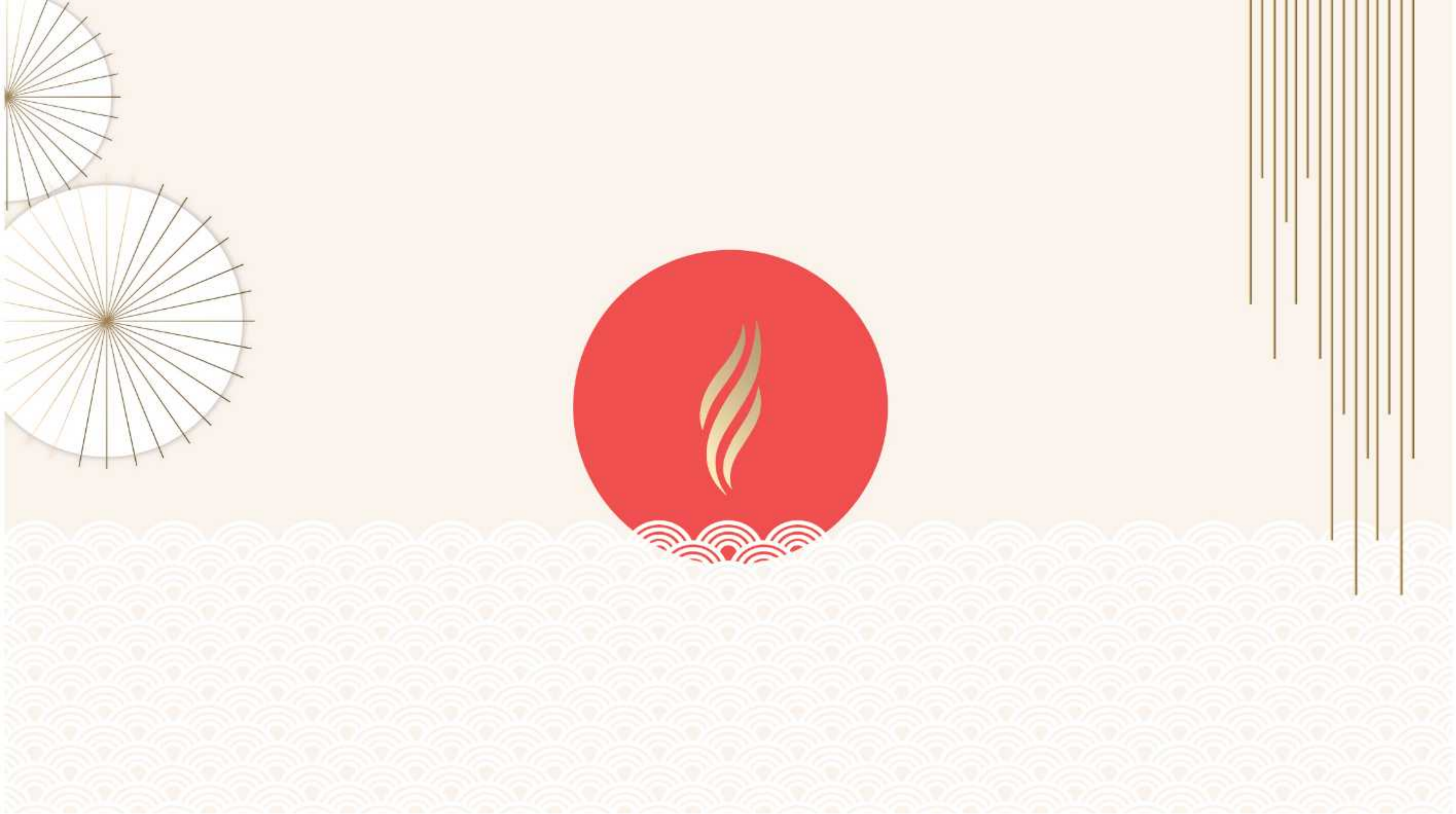

TOWER VIEW



PODIUM DESIGN



Drop Off - The top of the façade frame and canopy with a white top white edge-line represent the falling water colliding with the reservoir beneath.

Glass wall Frame & Mullion - A stone-clad wall behind the curtain wall depicts the water falling over the rocks and creating a black silhouette.



The depiction of the Crown
of the tower is inspired by
the Snow-White Crown
(Snow laden trees) of the
Shiraito Waterfall.

CROWN DESIGN





MAIN GARDEN WITH WATERFALL



A NEW CHAPTER... OF NATURE

CELEBRATING GARDENS THAT USE NATURAL ELEMENTS AS MOTIFS TO CREATE STUNNING LANDSCAPES (ZEN GARDENS). THROUGH THESE SERENE GARDENS, THE PEOPLE AROUND FEEL THE TRANQUILITY OF NATURE ENRICHING THEIR LIVES WITH EVERY STEP AND EVERY BREATH.

Major areas of the landscape include :

- Main garden with waterfall
- Podium rooftop garden
- Tower drop-off area

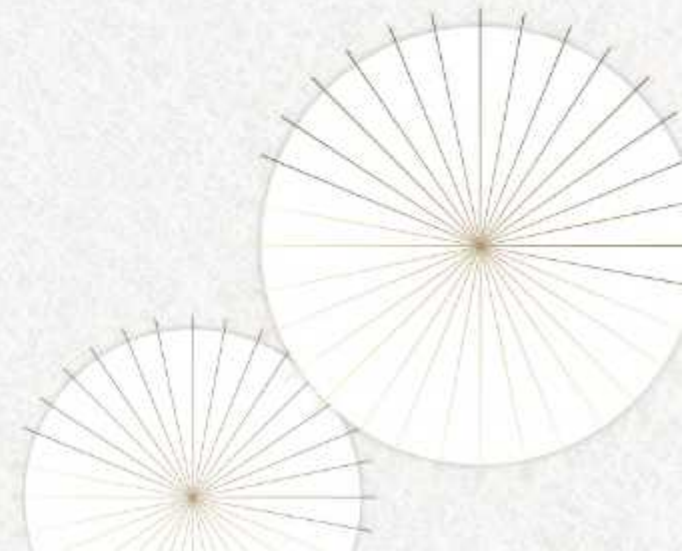



PODIUM ROOFTOP GARDEN

The planting zones follow the landscape design on the ground, with organic lines and natural elements such as black granite and lush greenery recreating the Shiraito magic in the heart of a metropolis.

CONSISTS OF A STONE WALL,
A SYMBOL TREE WITH A WATER FEATURE
TO EXPRESS GROWTH AND VITALITY.

TOWER DROP OFF AREA



| LEGEND | DISTANCES (APPROX) |
|-------------------|--------------------|
| NH8 | 1.8 Kms |
| IGI Airport | 24.8 Kms |
| Cyber City | 17 kms |
| Dwarka | 19 kms |
| IFFCO Chowk | 12.6 kms |
| Ambience Mall | 18 kms |
| NPS | 1 Kms |
| Pataudi Road | 1.6 kms |
| MG Road | 14.6 kms |
| Medanta Hospital | 9.6 kms |
| Karma Lakeland | 6.9 kms |
| Hero Honda Chowk | 5.6 kms |
| Rajiv Chowk | 8.6 kms |
| Rockland Hospital | 9.2 kms |



A NEW CHAPTER... OF LOCATION

PRIME LOCATION

Located in Sector 36-A at the confluence of the widest roads of Gurugram, Waterfall Suites offers unparalleled connectivity to Delhi and the other sectors of Gurugram without having to navigate clogged internal roads ever again.

CLOVER LEAF FLYOVER

A network of roads and flyovers including a Clover Leaf is being built to provide seamless access between Southern Peripheral Road (SPR), Central Peripheral Road (CPR) and NH-48. This would be the largest road infrastructure initiative in the city of Gurugram, making it a landmark in itself.

TRUMPET JUNCTION

National Highway Authority of India is building a trumpet junction between Dwarka Expressway and CPR. This junction will merge with the Clover Leaf connecting CPR, NH-48 and SPR, providing unrestricted access to all parts of Gurugram

UNPARALLELED CONNECTIVITY

- 2 of the widest roads in Gurugram – Northern Peripheral Road (NPR) and Central Peripheral Road (CPR)
- 3 minute drive to NH-48
- Mass Rapid Transit System planned along the NPR and CPR
- Flanked by 220 acres of Green Zone and 50 meters Green Belt
- Spread between 2 commercial zones
- Adjacent to Global City - the newest business center in Gurugram
- Unhindered connectivity to Indira Gandhi International Airport





A NEW CHAPTER... OF LIFESTYLE

- Entrance Area
- Lift Lobby
- Meeting Area Corridor
- Meeting Rooms
- Restaurant
- Treatment Room/Female Change Room
- Gym/Spa Reception



THE NEW LUXE

Stone Wall, Symbol Tree with Water Feature
Island and colorful flowering plants.





ENTRANCE LOBBY



ELEVATOR LOBBY

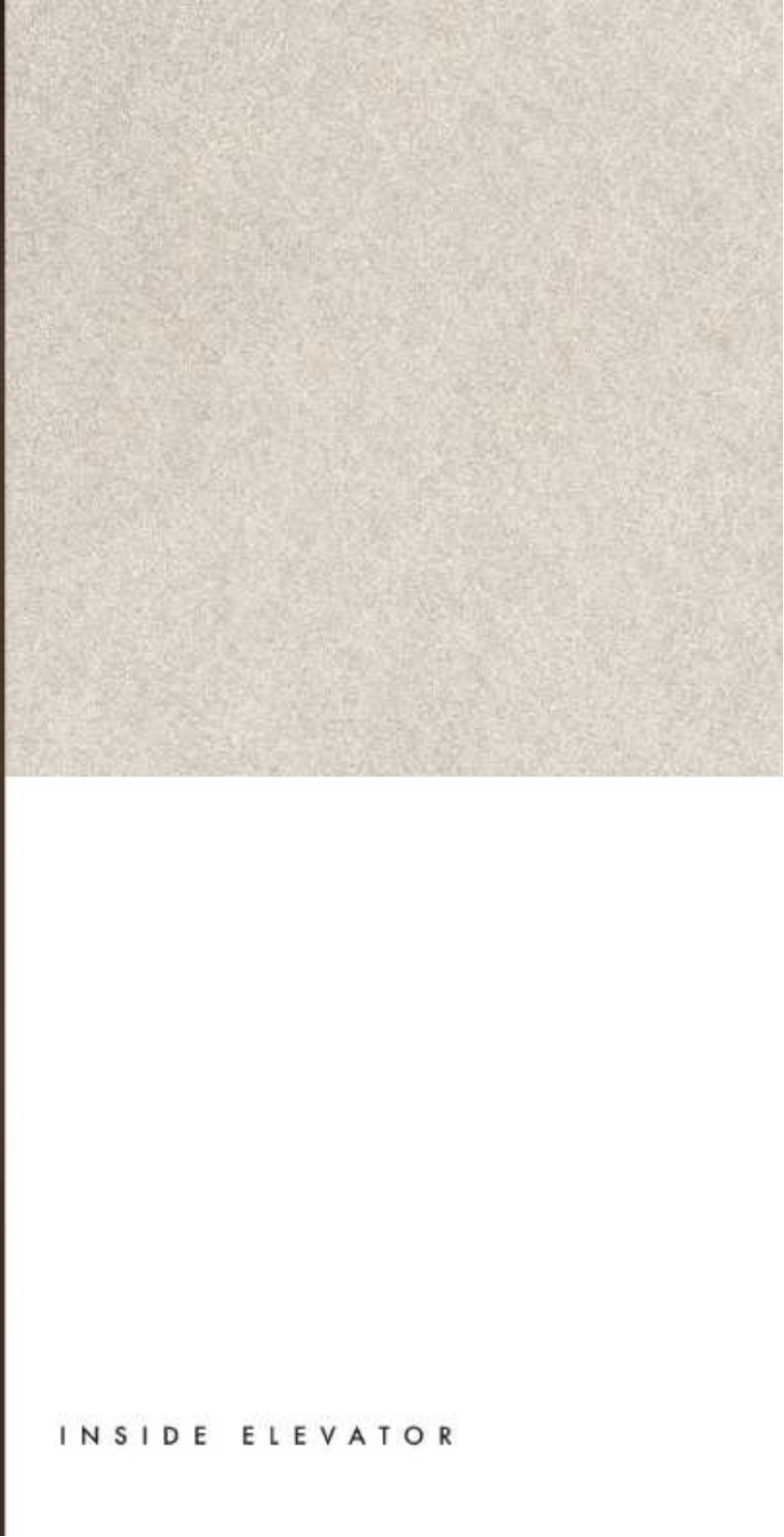
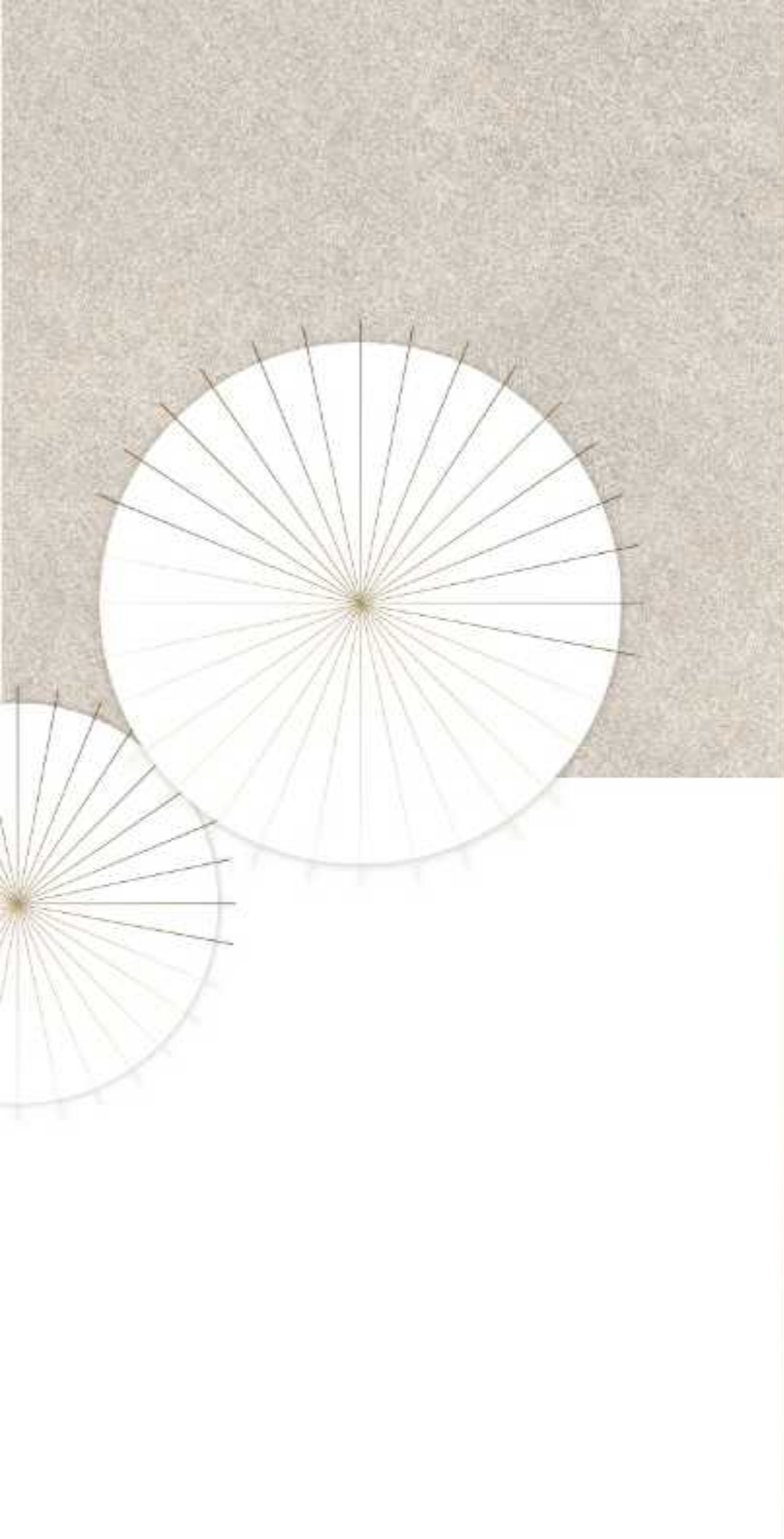

INSIDE ELEVATOR



SHUTTLE ELEVATOR LOBBY

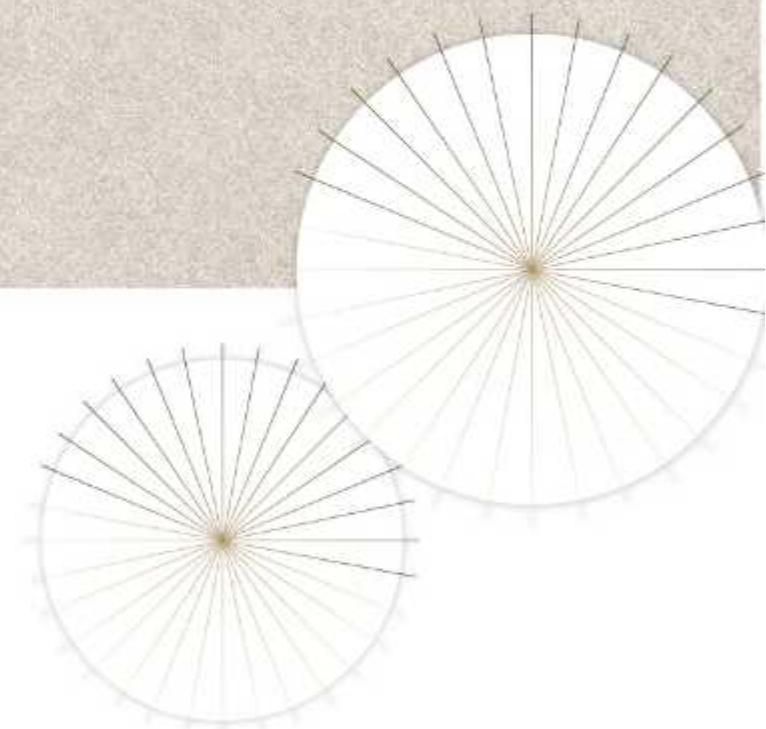

MEETING AREA CORRIDOR



MEETING ROOM



CONFERENCE ROOM



RESTAURANT



BAR/LOUNGE



GYMNASIUM



SPA GYM
RECEPTION

SPA RECEPTION



TREATMENT ROOM



W E T S P A

A series of thin, vertical, gold-colored lines of varying lengths are positioned on the left side of the page, extending from the top to the bottom.

A NEW CHAPTER...

TRANQUILITY

WATERBODY IN ORGANIC FORM
SWIMMING POOL



EXCLUSIVITY REDEFINED

POOLSIDE BAR



AQUEOUS REJUVENATION

LAP POOL



TROPICAL VIEWS

WATERFALL ISLAND DECK





SHADES OF SHIRAITO

THE WATERFALL LOUNGE



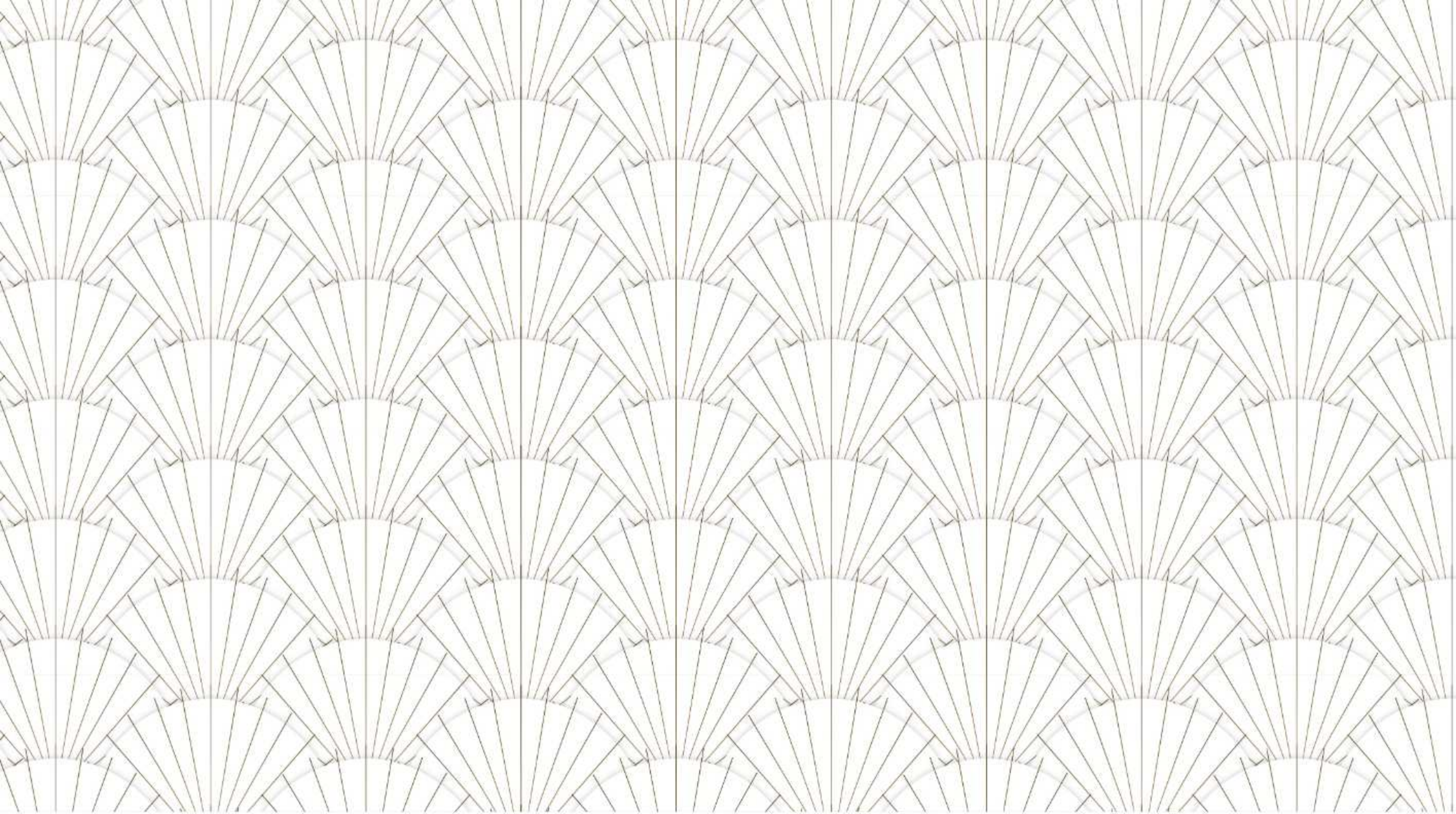

A NEW CHAPTER...
OF YOUR LIFE

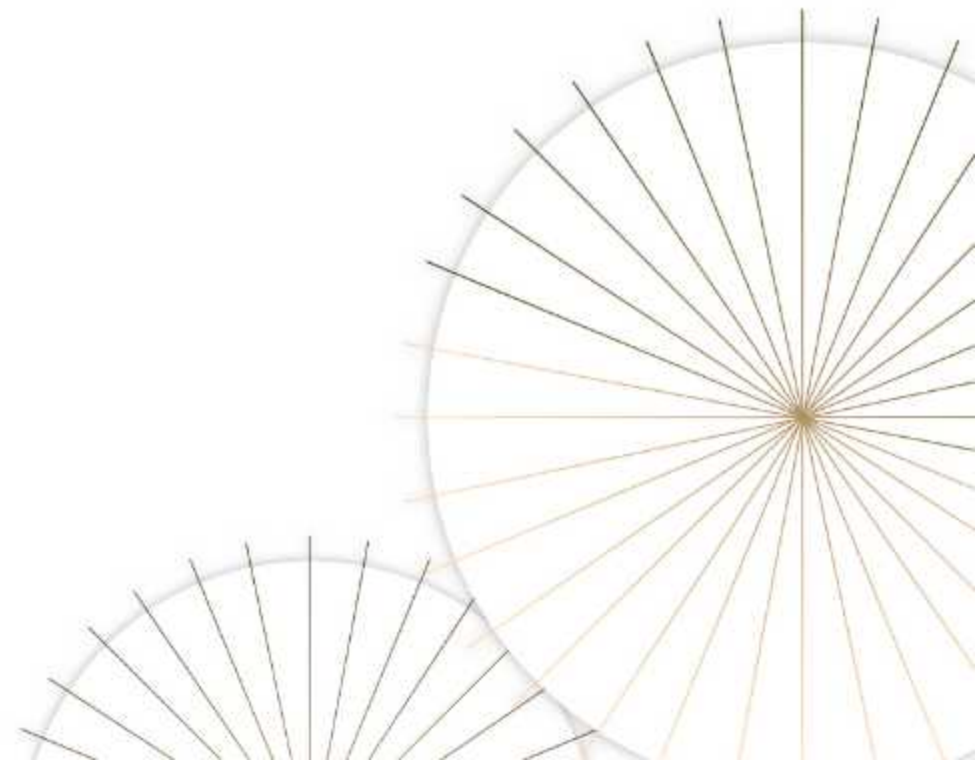



Disclaimer: This architect's perspective view of the apartment is purely conceptual and does not represent in any manner an offer or promise.

BEDROOM



LIVING ROOM



Disclaimer: This architect's perspective view of the apartment is purely conceptual and does not represent in any manner an offer or promise.



WATERFALL SUITES | 1 LDK + 1T



Disclaimer: This architect's perspective view of the apartment is purely conceptual and does not represent in any manner an offer or promise.

BEDROOM



LIVING ROOM



Disclaimer: This architect's perspective view of the apartment is purely conceptual and does not represent in any manner an offer or promise.



WATERFALL SUITES

1LDK + 2 Toilet

1 LDK + 2 T

Carpet Area 591.58 Sq.ft (54.96 Sq.mtr)

Exclusive Area 856.17 Sq.ft (79.54 Sq.mtr)

Saleable Area 1181.51 Sq.ft (109.76 Sq.mtr)



WATERFALL SUITES

1LDK + 1 Toilet

Type-1

1 LDK + 1 T (Type 1)

Carpet Area 464.14 Sq.ft (43.12 Sq.mtr)

Exclusive Area 650.90 Sq.ft (60.47 Sq.mtr)

Saleable Area 921.02 Sq.ft (85.56 Sq.mtr)



WATERFALL SUITES

1LDK + 1 Toilet

Type-2

1 LDK + 1T (Type 2)

Carpet Area 493.53 Sq.ft (45.85 Sq.mtr)

Exclusive Area 692.34 Sq.ft (64.32 Sq.mtr)

Saleable Area 979.66 Sq.ft (91.01 Sq.mtr)



- 1 POOL AREA
- 2 ENTRANCE LOBBY
- 3 RESTAURANT & BAR
- 4 SPA
- 5 GYM
- 6 CONVENIENT SHOP
- 7 MEETING ROOMS
- 8 LAP POOL
- 9 POOL SIDE BAR
- 10 WATERFALL LOUNGE



SITE PLAN WITH GROUND FLOOR PLAN

- WS 01 1LDK+2T
- WS 02 1LDK+1T (TYPE-1)
- WS 03 1LDK+1T (TYPE-1)
- WS 04 1LDK+2T
- WS 05 1LDK+1T (TYPE-2)
- WS 06 1LDK+2T
- WS 07 1LDK+1T (TYPE-1)
- WS 08 1LDK+1T (TYPE-1)
- WS 09 1LDK+2T
- WS 10 1LDK+1T (TYPE-2)



SITE PLAN WITH FIRST FLOOR PLAN

APARTMENT SPECIFICATIONS:

LIVING/DINING/FOYER

| | | |
|---------|---|----------------------------|
| Floor | : | Engineered Wooden Flooring |
| Walls | : | Acrylic Emulsion Paint |
| Ceiling | : | Acrylic Emulsion Paint |

BEDROOM

| | | |
|---------|---|----------------------------|
| Floor | : | Engineered Wooden Flooring |
| Walls | : | Acrylic Emulsion Paint |
| Ceiling | : | Acrylic Emulsion Paint |

TOILET

| | | |
|---------------|---|---|
| Floor | : | Vitrified Tiles |
| Walls | : | Vitrified Tiles |
| Ceiling | : | Acrylic Emulsion Paint on False Ceiling |
| Counters | : | Granite/Vitronite/Quartz |
| Sanitary Ware | : | TOTO or Equivalent |
| C.P fittings | : | Grohe or Equivalent |

KITCHEN

| | |
|---------------------|--|
| Floor | : Vitrified Tiles |
| Walls | : Tiles and Acrylic Emulsion Paint |
| Ceiling | : Acrylic Emulsion Paint |
| Counter | : Granite/Vitronite/Quartz |
| Fittings & Fixtures | : Premium quality CP fittings, sink with drain board |
| Appliances | : Modular Kitchen with hob and chimney |

BALCONIES (MAIN/UTILITY)

| | |
|-----------------|-----------------------------------|
| Floor | : Anti-skid Tiles |
| Walls & Ceiling | : Exterior Paint |
| Railing | : Glass railing with SS balusters |

DOORS

| | |
|----------------|---|
| Entrance door | : Modular Door with Veneer & Polish (2.4m High) |
| Internal doors | : Modular Door with Laminate (2.4m High) |

EXTERNAL GLAZING

Aluminium Glazed Door and Window



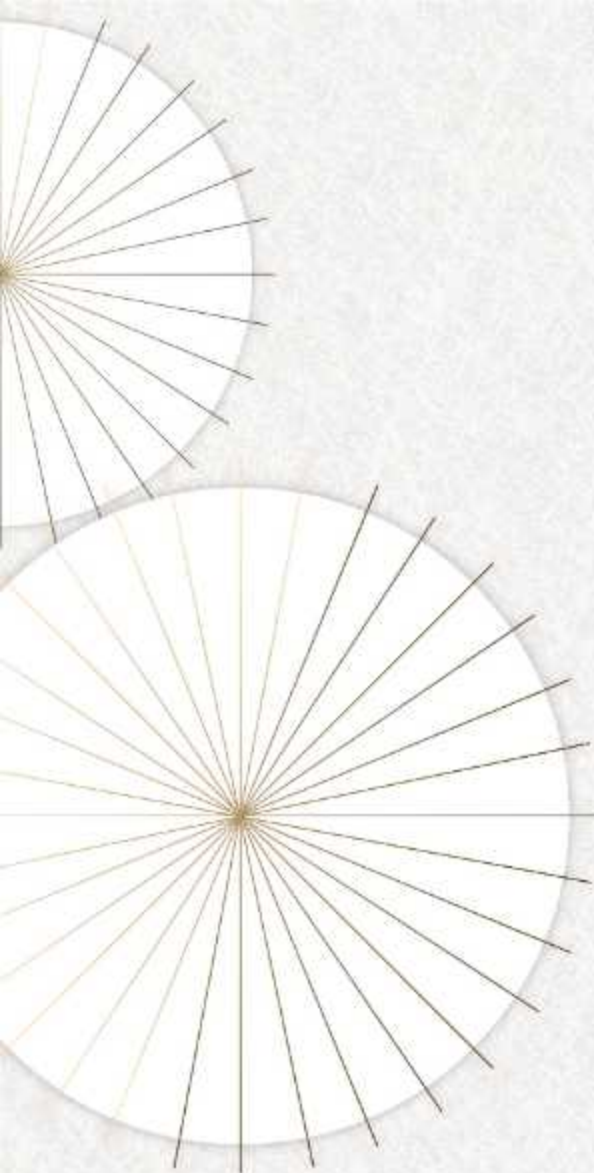

AIR CONDITIONING

VRV air-conditioning system with one outdoor module for the entire apartment.

ELECTRICAL FIXTURES & FITTINGS

Modular switches

LED lighting fixtures in Balconies, Toilet, Kitchen and Corridor

POWER BACK-UP

100% Power back up

GAS PIPELINE

Uninterrupted gas supply to every Kitchen through a network of safe piping with individual gas meter

ENTRANCE LOBBIES

Floor : Stone flooring

Walls : Combination of stone, veneered panelling, metal, and acrylic emulsion paint

Ceiling : Veneered panelling and false ceiling with acrylic emulsion paint

All lobbies are Air-conditioned



COMMON AREAS SPECIFICATIONS:

APARTMENT FLOOR LOBBIES

Floor : Vitrified Tile
Walls : Acrylic Emulsion Paint
Ceiling : False Ceiling with Acrylic Emulsion Paint
All lobbies are Air-conditioned

ELEVATORS

4 High-Speed Passenger Elevators
2 Service Elevators
2 Shuttle Elevators from the basement
Total 8 Elevators in one tower

FIRE FIGHTING SYSTEM

A Synchronized Fire Fighting system with fire sprinkles, hydrant, hose reel, smoke detector, heat detection and fire curtain system as per norms, Pressurized staircases, lift lobbies and lift Shafts for better Fire safety



A NEW CHAPTER... OF SERVICES

- Round-the-clock security
- Concierge
- F&B delivery from the club
- EV charging
- Doctor-on-call
- Medicine-on-call
- Bartenders-on-call
- Chef-on-call
- Servers-on-call
- Laundry











SAVOUR THE PERFECT BLEND OF
JAPANESE BRILLIANCE & INDIAN VIBRANCE
COME, EXPERIENCE THE JOY OF SIMPLE &
SOPHISTICATED LIVING...

Reach out to us for enquiries & bookings

-  +91 87226 87226 | + 91 70262 14214
-  sales@krisumi.com
-  Krisumi Sales Lounge, Sector 36 A, Gurugram, Haryana - 122004
-  www.krisumi.com



Disclaimer: "Waterfall Suites " has been registered with HARERA Gurugram vide registration number RC/REP/HARERA/GGM/715/447/2023/59 dated 08.05.2023 and is available on the website <https://haryanarera.gov.in/> under HRERA Gurugram – Registered Projects| The License No. 39 of 2013 dated 04.06.2013 valid upto 03.06.2026 and Licence No. 85 of 2014 dated 08.08.2014 valid upto 07.08.2024| Revised Building Plan Approval vide Memo No.: ZP-915-II/PA(DK)/2023/2405 dated 25.01.2023 issued by DTCP, Chandigarh. Waterfall Suites is part of Group Housing Colony namely "Krisumi City" in Sector 36A, Gurugram, Haryana, India and is being developed on land admeasuring 1.5726 hectares (ha) (3.886 acres) owned by M/s. Krisumi Corporation Private Limited ("Company") pursuant to Order dated September 22, 2020, passed by NCLT, Chandigarh Bench, Chandigarh, sanctioning the amalgamation of M/s. Bluejays Realtech Private Limited and P G Propmart Private Limited into the Company. Waterfall Suites consists of 320 nos. of residential units/apartments, 58 nos. EWS units, Convenient Shopping, Club and Nursery School. This advertisement contains artistic impressions and no warranty is expressly or impliedly given that the completed development will comply in any degree with such artist's impression as depicted. The furniture, accessories, items, goods, additional fittings/fixtures, decorative items including finishing materials, specifications, shades, sizes and colour of the files, etc. shown in the image are only indicative in nature and are only for the purpose of illustrating/indicating a conceived layout and do not form part of the standard specifications/amenities/services to be provided. All plans and images shown in the advertisement is indicative and are subject to changes at the discretion of the Company or competent authorities. The Company shall not assume any responsibility of information provided by third parties and reliance shall be placed only on the information provided on the Company's official website i.e. www.krisumi.com. Conversion Scale: 1 square meter (m2) = 10.764 square feet.