



Dhoot Infrastructure Projects Limited  
904 - 907 Time Tower,  
M.G. Road, Sector - 28,  
Gurgaon - 122001 (Haryana)  
Phone : 0124 - 4966700  
Fax : 0124 - 4966799  
Web site : [www.dhootgroup.net](http://www.dhootgroup.net)

**Disclaimer**

The brochure is purely conceptual and not a legal document. The company reserves the right to add, delete or alter any details and/or specifications. Images shown in this brochure are for representation purpose only.

The logo for "TIME RESIDENCY". It features a circular emblem at the top composed of several small, overlapping leaf-like shapes. Below the emblem, the word "TIME" is written in a large, bold, gold-colored, sans-serif font. Underneath "TIME", the word "RESIDENCY" is written in a smaller, gold-colored, sans-serif font, with wide letter spacing.



A RESTFUL MOMENT.

TAKE YOUR TIME.

PAUSE.



HERE, IT'S NOT JUST TIME OUT.

IT'S ALL THE TIME IN THE WORLD.





FROM QUAIN SURROUNDINGS TO SIMPLE PLEASURES

FROM ONE QUIET MOMENT TO THE NEXT

The heart feels at home  
space and tranquility at the heart of Gurgaon  
Welcome to



**TIME**  
RESIDENCY  
SECTOR 63, GURGAON



## CLEAR SKIER. AN OPEN MIND

A VIEW OF THE HORIZON

A distinctive address set privately apart in a vibrant urban center.

Time Residency welcomes you into a select community of more than 500 residences. A harmony of well-planned spaces and refreshing views, here homes are a perfect accompaniment to your life.

A composition of space, planning and detail, you will find your place in tune with the time.



## LOCATION AND VICINITY

Sector 63, Gurgaon  
 2 side 84 mtr road  
 1.5 km from extended golf course road  
 Surrounded by high end group housing  
 30 mins from International Airport  
 15 mins from NH 8 and IFFCO Chowk  
 Proximity to prominent schools & hospitals  
 Proposed metro 1.8 kms



Actual photograph of the site approach road





## HERE, ITS NOT A LIVING ROOM

IT'S ROOM FOR LIVING

Time Residency will have some of the most comfortable and luxurious places to live in Gurgaon. The design is based on creating exceptional views combined with essential privacy. Controlled light will flood into the spacious rooms to produce joyful living spaces.

A combination of vibrant community and contemplative privacy

SPACIOUS HOMES  
LARGE WINDOWS  
UNMATCHED PRIVACY  
PROPER CROSS VENTILATION  
STUDY / SERVANT ROOM  
ABUNDANCE OF NATURAL DAYLIGHT  
GATED ENTRY WITH CCTV  
FINE BATHROOM FITTINGS  
ENTRANCE LOBBY  
UTILITY AREA

## HERE, IT'S NOT DAY DREAMING IT'S LIVING YOUR DREAM EVERYDAY

Time Residency is in league of its own, from the moment you drive in. Experience life of indulgence in beautifully landscaped environment, lush gardens and serene expanse of green. A world class clubhouse will keep you and your guests entertain in absolute style, without leaving home. Among other recreation and leisure facilities you always remain cocooned in serenity and peace, enjoying ultimate lifestyle you could always dream of.







## UNDISTURBED THOUGHT

JUST AS YOU PLEASE

---

- CLUBHOUSE
- SWIMMING POOL
- PLAY COURT
- YOGA CENTRE
- PARTY VENUE WITH LAWN
- CHILDREN'S PLAY AREA
- GARDENS AND OPEN LAWNS
- MULTI-LEVEL PARKING
- HIGH SPEED ELEVATORS
- POWER BACKUP
- STATE-OF-THE-ART SECURITY
- PEDESTRIAN WALKWAYS
- FACILITIES MANAGEMENT
- CONVENIENCE STORE
- CONTROL ENTRY/EXIT POINTS

## PREMIUM TOWER 'A' TYPICAL APARTMENT

4 + S Bed Room Apartment  
 Unit No. 1 – Super Area 2288 sq. ft.  
 Unit No. 2 – Super Area 2291 sq. ft.  
 Unit No. 3 – Super Area 2297 sq. ft.



## PREMIUM TOWER 'B' TYPICAL APARTMENT

3 + S Bed Room Apartment  
 Unit No. 1 – Super Area 1717 sq. ft.  
 Unit No. 2 – Super Area 1717 sq. ft.  
 Unit No. 3 – Super Area 1712 sq. ft.  
 Unit No. 4 – Super Area 1708 sq. ft.



**Disclaimer**  
 The floor plans, layout plans, areas, dimensions and specifications are indicative and are subject to change as decided by the company or by any competent authority. Soft furnishing, cupboards, kitchen cabinets, furniture and gadgets are not part of the offering. This does not constitute a legal offer.

## TOWER 'C' TYPICAL APARTMENT

4 + S Bed Room Apartment  
 Unit No. 1 – Super Area 2212 sq. ft.  
 Unit No. 2 – Super Area 2203 sq. ft.  
 Unit No. 3 – Super Area 2212 sq. ft.

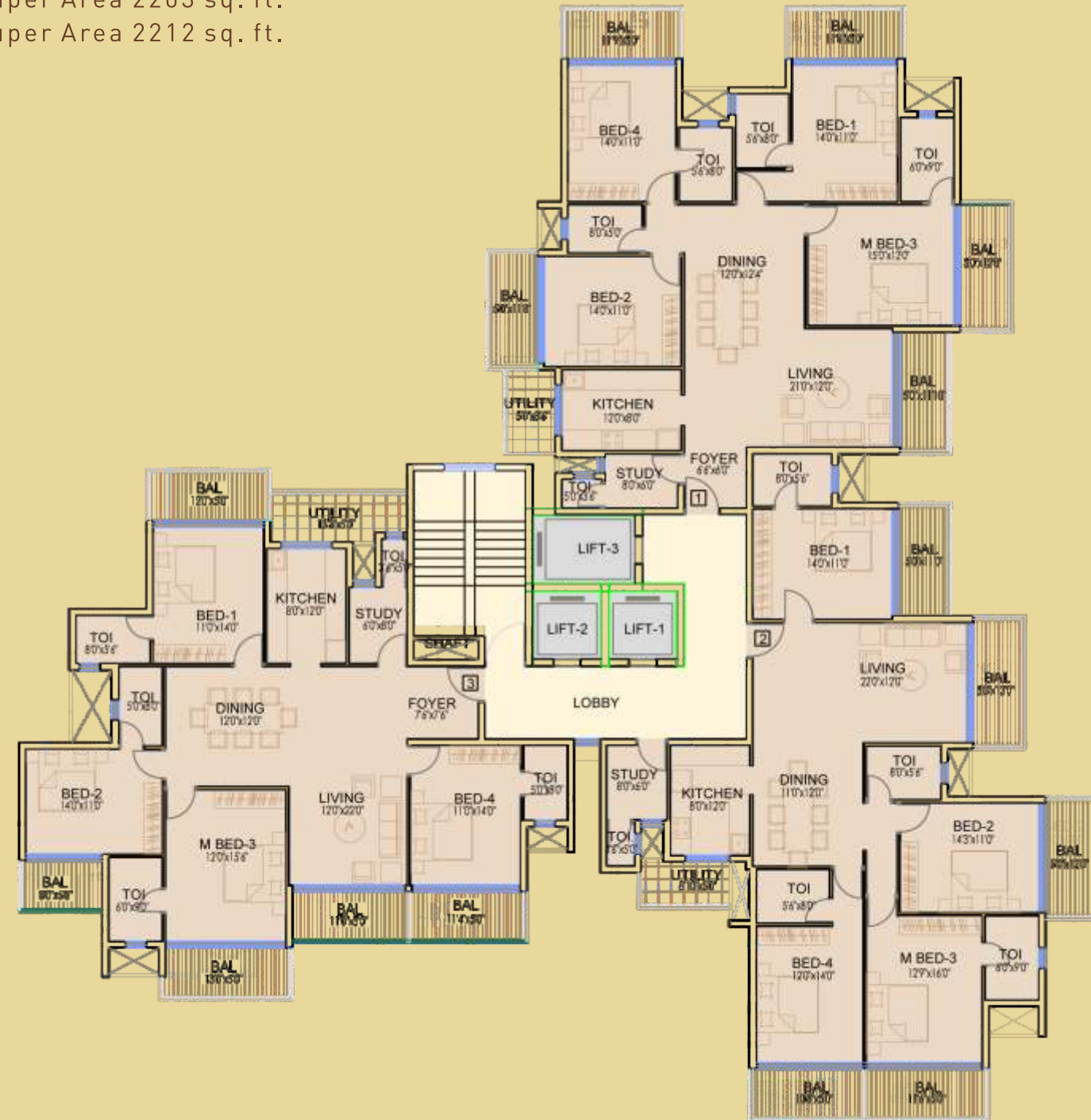

## TOWER 'D', 'E' & 'F' TYPICAL APARTMENT

3 + S Bed Room Apartment  
 Unit No. 1 – Super Area 1642 sq. ft.  
 Unit No. 2 – Super Area 1642 sq. ft.  
 Unit No. 3 – Super Area 1642 sq. ft.  
 Unit No. 4 – Super Area 1642 sq. ft.



**Disclaimer**  
 The floor plans, layout plans, areas, dimensions and specifications are indicative and are subject to change as decided by the company or by any competent authority. Soft furnishing, cupboards, kitchen cabinets, furniture and gadgets are not part of the offering. This does not constitute a legal offer.

## TOWER 'G' TYPICAL APARTMENT

3 Bed Room Apartment  
 Unit No. 1 – Super Area 1502 sq. ft.  
 Unit No. 2 – Super Area 1502 sq. ft.  
 Unit No. 3 – Super Area 1502 sq. ft.  
 Unit No. 4 – Super Area 1502 sq. ft.



## TOWER 'H' TYPICAL APARTMENT

3 & 2 Bed Room Apartment  
 Unit No. 1 – Super Area 1480 sq. ft.  
 Unit No. 2 – Super Area 1181 sq. ft.  
 Unit No. 3 – Super Area 1181 sq. ft.  
 Unit No. 4 – Super Area 1480 sq. ft.



Disclaimer  
 The floor plans, layout plans, areas, dimensions and specifications are indicative and are subject to change as decided by the company or by any competent authority. Soft furnishing, cupboards, kitchen cabinets, furniture and gadgets are not part of the offering. This does not constitute a legal offer.

## TOWER 'I' TYPICAL APARTMENT

2 Bed Room Apartment

Unit No. 1 – Super Area 1208 sq. ft.

Unit No. 2 – Super Area 1208 sq. ft.

Unit No. 3 – Super Area 1208 sq. ft.

Unit No. 4 – Super Area 1208 sq. ft.



### Disclaimer

The floor plans, layout plans, areas, dimensions and specifications are indicative and are subject to change as decided by the company or by any competent authority. Soft furnishing, cupboards, kitchen cabinets, furniture and gadgets are not part of the offering. This does not constitute a legal offer.



# SPECIFICATIONS

For premium tower A & B

Description	Area	Finish	Description	Area	Finish
<b>Flooring</b>	Entry / Living / Dining, Corridor MBR & Other Bed Rooms Kitchen Balcony & Powder room Bath Rooms / Toilets Servant Room & Servant toilet Utility Area Staircase Lift Lobby	Imported Marbles Laminated Wooden Floor / Vitrified Tiles. Vitrified Tiles Anti-skid Tiles Anti Skid / Ceramic Tiles Ceramic Tiles Ceramic Tiles Kota stone Indian Marble / Granite	<b>External Paint</b>	All External surface	Partly Textured Paint /Weather shield paint/ Weather coat or equivalent, as per elevation requirements.
<b>Wall Cladding</b>	MBR & Other Bath rooms Powder Room Kitchen Servant Bath room Lift Lobby Lift doors opening	Ceramic / Vitrified tile up to 2.1m Height Ceramic / Vitrified tile up to 2.1m Height Ceramic / Vitrified tile up to 1.50 m Height Ceramic tile up to 2.1m Height Marble / Granite skirting Marble / Granite up to 2.1m Height	<b>Doors</b>	Main Entry Internal Door External Door	Paneled Door Shutter Moulded Door Shutters. Aluminium Frame & Shutter
<b>Counters</b>	MBR, Other Bath rooms, Powder room Kitchen	Marble / Granite Counter & Wash Basin. Granite Counter Top with Double Bowl Stainless Steel Sink and Drainage, CP Fittings, Modular Kitchen with Hob and Chimney	<b>Door Hardware</b>	All Doors	Aluminium powder coated
<b>Internal Painting Walls</b>	All area's Except Servant room Master bath & Other Bath rooms, Powder room above 2.1m Height Servant room	POP punning with Acrylic Emulsion Paint. Acrylic Emulsion Paint  OBD	<b>Windows</b>	All	Aluminium Frame & Shutter
<b>Ceiling</b>	Total Ceiling area, except Servant Room Servant room Staircase & Lift Lobby	Acrylic Emulsion Paint OBD OBD	<b>Railing</b>	Balcony / Stair	M.S
			<b>Plumbing</b>	Sanitary Hardware Soil and Waste Pipes Water Supply Line Storm Water Drain Overhead Tank	Preimum C SWR / HDPE Pipes CPVC Pipes Covered Drains RCC Tank (common over roof)
			<b>Electrical</b>	Switches + DB	Modular Switches
			<b>Others</b>	Living Room/Dining/MBR and other Bed Rooms	Spilt AC of reputed make

ISI mark / imported equipments/materials shall be used for construction.



**Disclaimer**  
The floor plans, layout plans, areas, dimensions and specifications are indicative and are subject to change as decided by the company or by any competent authority. Soft furnishing, cupboards, kitchen cabinets, furniture and gadgets are not part of the offering. This does not constitute a legal offer.



## About

### Dhoot Group

Kolkata based well-known business conglomerate "DHOOT GROUP" engaged in Real Estate Development, Infrastructure, Power, Manufacturing, Ground Handling, Solid Waste Management, Investments, Healthcare, Education and Hospitality.

Management transparency and professional approach, commitment to excellent quality and service, timely deliveries, high quality construction standards and efficient systems with latest infrastructure have helped the Group to achieve high Brand reputation all over the country. Today, the Group is credited with delivering several landmark projects across the country.

Dhoot Group firmly believes that structures and buildings with architectural merit, quality of spaces and superior construction command higher returns and attract more satisfied users.





# Projects

Dhoot Group

## Delivered Projects



Time Tower, Gurgaon  
7 Star Office Complex



Time Centre, Gurgaon  
Office Complex and Shopping



Silver Spring, Kolkata  
540 high end luxury lifestyle apartments



The Spring Club, Kolkata  
Finest Club of Kolkata



Time Arcade, Sector 37C, Gurgaon  
Office Complex and Shopping



Vistara, Indore  
Modern integrated township

## Ongoing Projects



Olympia Opaline, Chennai  
1000 apartments in a modern self sufficient township



Resort at Dhamdama, Gurgaon  
100 acres of pure nature