

Codename \_\_\_\_\_  
**THE ULTIMATE  
CORPORATE**  
WAGLE ESTATE, THANE



WAGLE'S  
LARGEST  
CORPORATE  
PARK

# GOODBYE BKC

## THE MAJESTIC PAST

### A HERITAGE OF VISIONARY GRIT

Bandra Kurla Complex, or BKC, is more than just a business center in Mumbai; it is a symbol of the city's resilience and determination. BKC was created in the 1970s to alleviate travel chaos caused by the concentration of commercial establishments in South Mumbai. The administration displayed remarkable foresight and valor to execute their vision and create a state-of-the-art business hub. BKC has become an iconic location in Mumbai where businesses flourish, and people join hands to craft a better future. For the people of Mumbai, BKC is a testament to the city's stability and indomitable spirit.

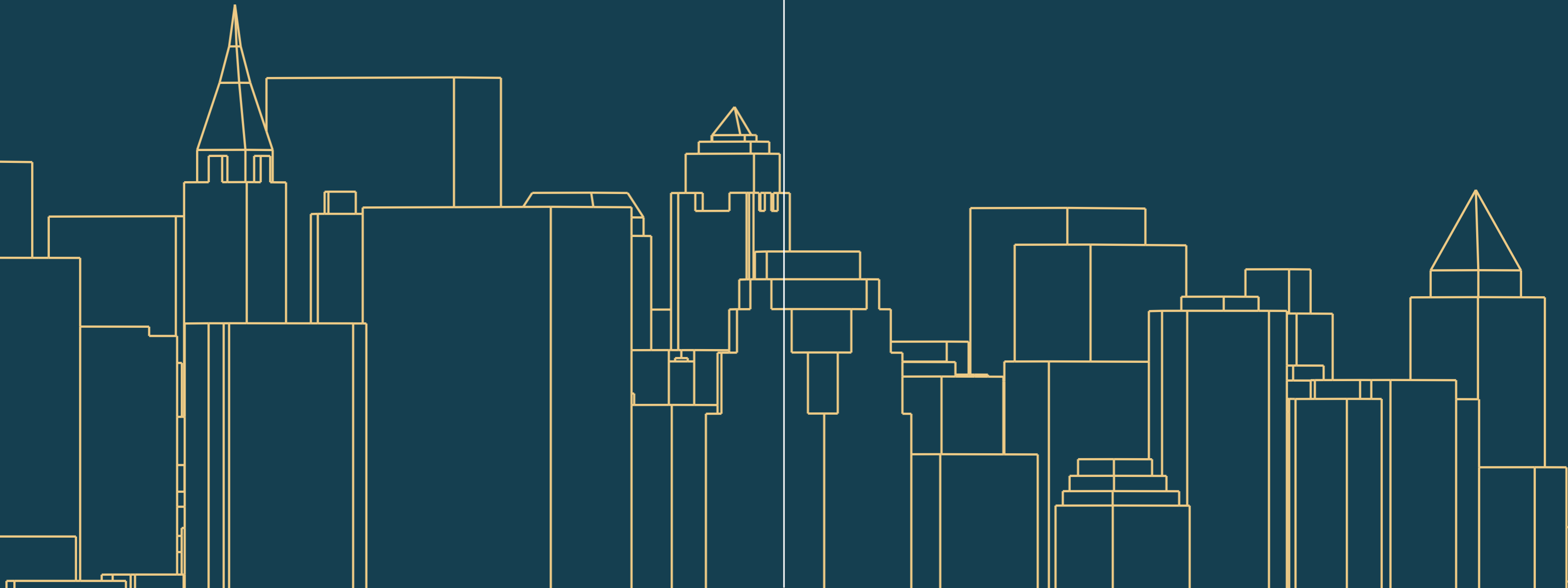

# THE NEW LEADER OF PROGRESS

## THE EPITOME OF RESILIENCE

Thane, which was once a quiet town with dusty streets, has transformed into a bustling business and innovation hub with skyscrapers that blend in with lush greenery. The town's rapid development has attracted major corporations such as TCS, Bayer, and Raymond.

Thane's excellent connectivity to other regions makes it an attractive location for businesses seeking affordable office spaces without compromising on quality. However, as Thane continues to grow, there are concerns that Mumbai's primary commercial hub, BKC, may lose its status. Wagle, with its strategic location, modern infrastructure, and competitive pricing, has become a strong business center that rivals BKC.

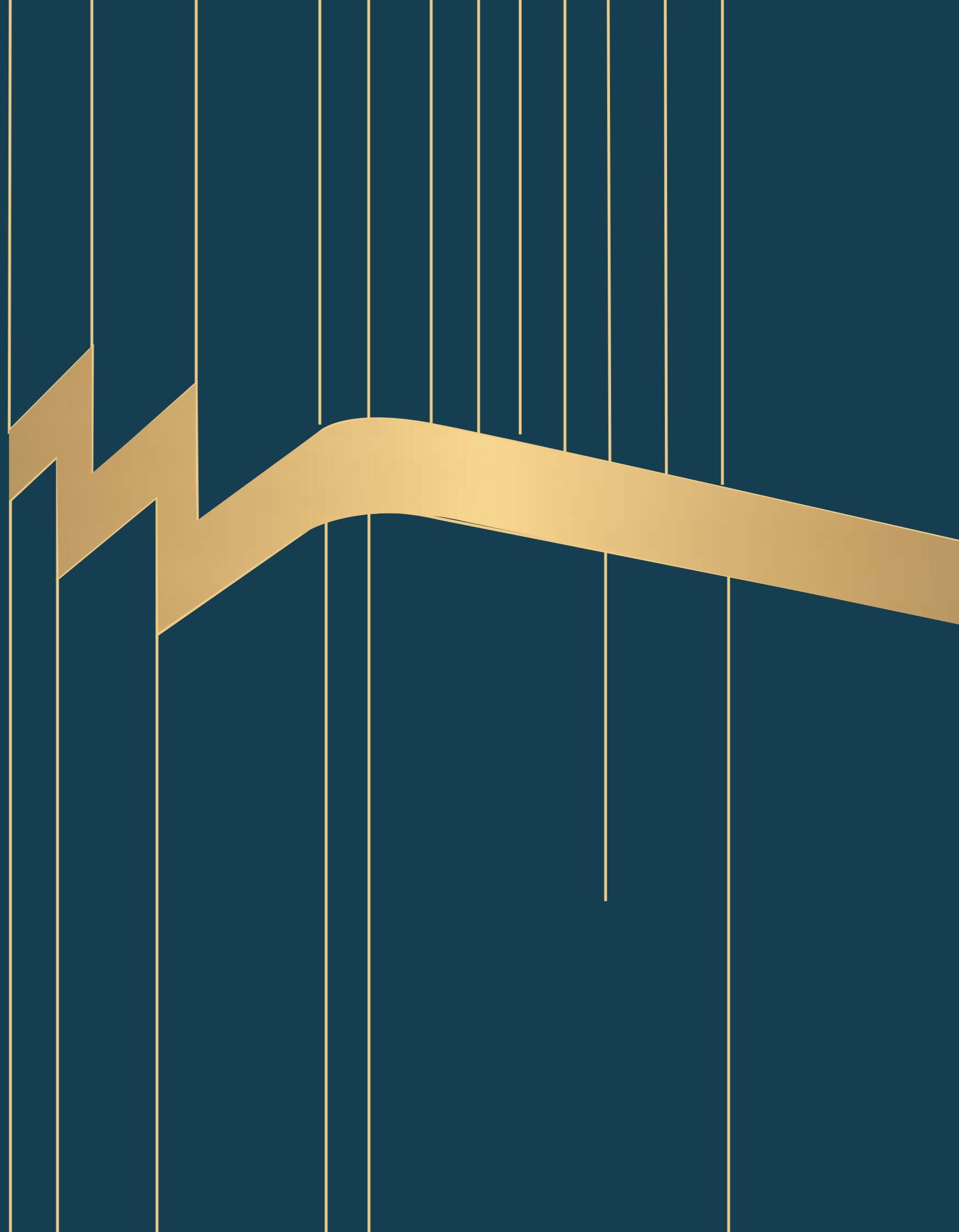

# ELEVATED STANDARDS OF OPULENCE

The Ultimate Corporate is a unique business hub that offers extravagant amenities tailored to the needs of modern companies. It features state-of-the-art office spaces, co-working areas, and conference rooms designed to foster invention and affiliation. In addition to top-notch business facilities, The Ultimate Corporate also offers leisure activities, including a fitness center, food court, and outdoor spaces that balance work and play. The establishment is committed to sustainability, creating a positive impact on the environment. If you're seeking the ultimate experience in success and luxury, The Ultimate Corporate is the ideal community to join.

---

Grade A Commercial Park with 5 Towers

---

Retail & Commercial Spaces

---

14 ft. Floor to Floor Height

---

10 Ace Quality Amenities

---

Exceptional Connectivity

---

100,000 sq. ft. of Landscape Garden

---

Premium & Upscale

---

Flexible Exit Strategy for Investors

## THE ULTIMATE CORPORATE OASIS

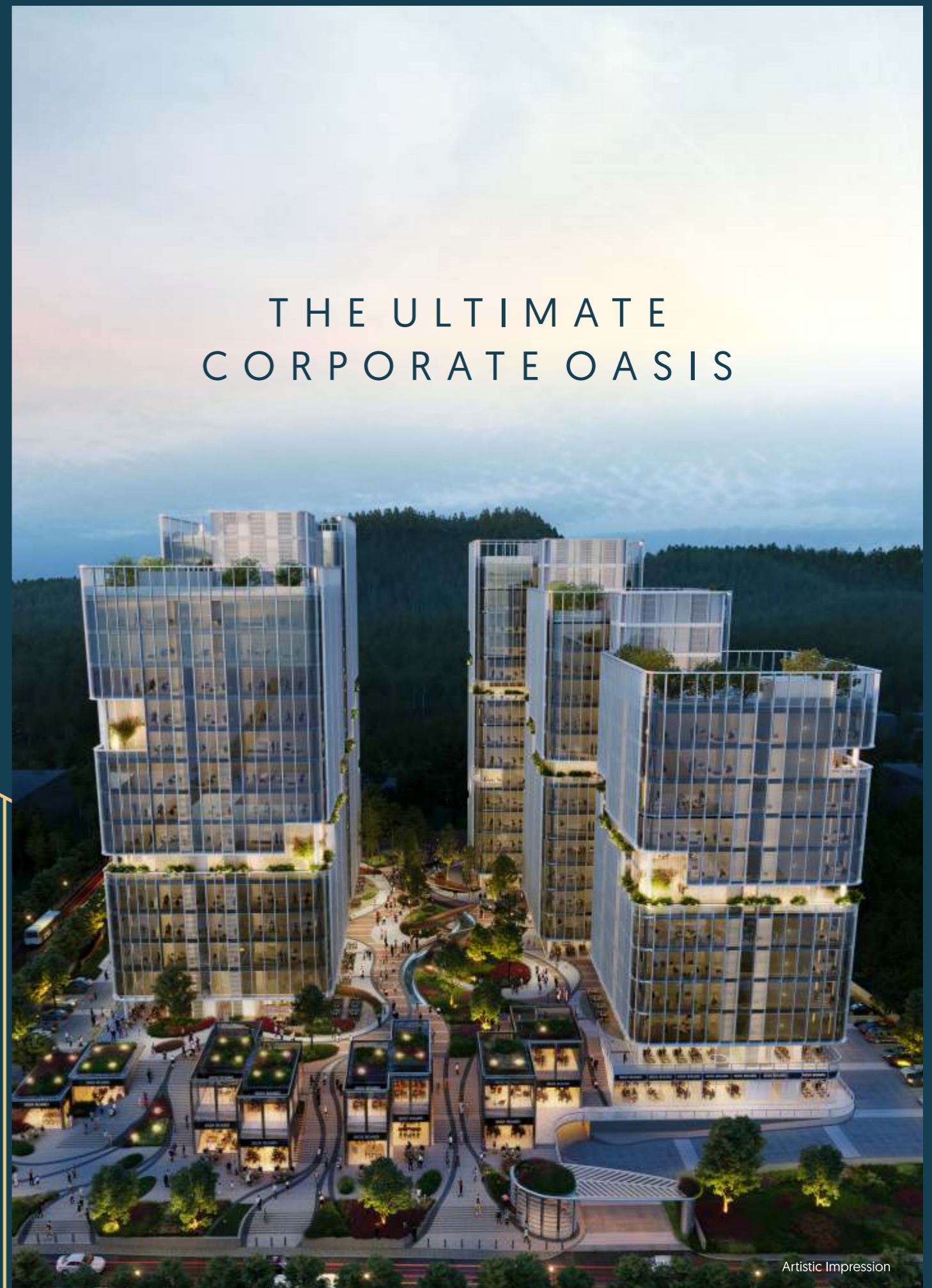

Artistic Impression





Artistic Impression



100,000 SQ. FT.  
OF  
LANDSCAPE  
GARDEN

Artistic Impression



# REFINED PREMIUM FACILITIES

## BASK IN ELEGANT EXTRAVAGANCE

Step into a refined work environment that blends productivity with enjoyment. Our fully functional amenities such as library, common wifi spaces, indoor & outdoor game zone, yoga & meditation spaces, high street retail spaces, and more, cater to your every need, ensuring optimal and efficient results. Join us at one of the most happening workplaces and experience the essence of a fruitful work-life balance.



Crèche



Electric Cars and  
Charging Station



Fitness Center



Shared Conference  
Room



Café and  
Meeting Spaces



Shuttle  
Bus Service to the  
Nearest Metro Station

# THE APEX OF GROWTH

## PRIME ADDRESS

Thane's strategic location provides excellent accessibility and opportunities for growth. With reliable transport links, the sky's the limit in exploring unlimited possibilities and reaching greater heights.



- Mulund Railway Station - 5 km
- Thane Railway Station - 4.1 km
- Thane Korum Mall - 2.9 km
- Thane R Mall - 2 km
- Eastern Express Highway - 2.6 km
- LBS Road - 1.8 km
- Income Tax Office - A 15 mins walk
- Passport Office - A 10 mins walk
- BKC via Santacruz Chembur Link Road - 40 mins
- International Airport via JVLR - 54 mins
- Proposed Mahapalika Marg Metro Station - 2.9 km
- Proposed RTO Thane Metro Station - 2.3 km
- Wagle Bus Depot - 550 m
- Mulund Road Close-by
- Proposed Ghodbunder Road Close-by



EMBRACE THE ZENITH OF  
OPULENCE AND GRANDEUR



**SUNRISE**

Raising Standards, Enriching Lives

YOUR PARTNER  
IN EXCELLENCE

### A legacy of greatness, a promise of fulfilment

Sunrise Group is a prominent real estate developer in Mumbai and its surroundings, known for delivering high-quality residential and commercial properties on time. The company comprises various enterprises, including Sunrise Housing Constructions Ltd., Quantum IT Park Pvt. Ltd., and Sunrise Developers. The company's success is attributed to its commitment to quality and innovation, as well as a dedicated team of professionals. Being a debt-free company, Sunrise Group has greater financial control and self-sufficiency, which allows it to make strategic decisions and navigate economic uncertainties with ease. As a result, the company has earned a reputation as a trusted and reliable name in the real estate industry.

10+ Years

9+ Projects

20 Lac+ Sq. Ft. Sold

2000+ Happy

Customers

Artistic Impression





Codename \_\_\_\_\_  
**THE ULTIMATE  
CORPORATE**  
WAGLE ESTATE, THANE

---

E5/E-5/1, Road No. 27, Wagle Estate, Thane (W) | 

---

 The Project has been registered with Maha RERA under registration no. P51700050406 and is available on the website <https://maharera.mahaonline.gov.in> under registered projects

Disclaimer - The plans, specifications, images and other details herein are only indicative and the developers reserve their rights to change any or all of these in the interest of the development. The printed material does not constitute an offer and/or contract of any type between the developer and the recipient. Any purchase/lease of this development shall be governed by the terms and conditions of the agreement entered into between of this development shall be governed by the terms and conditions of the agreement for sale/lease entered into between parties and no detail mentioned in this printed material shall in any way govern such transaction. The stadium, hospital, school and restaurant are a few features that are under the 'proposed' status, which will be confirmed with the upcoming plans.