

RERA NO. : UPRERAPRJ8960



Apex Court

2-3 Bedroom Luxury Apartments

A BOUTIQUE PROJECT

**Vision to your
Future Paradise**

**MODERN
INTERIOR**



**MODERN
GYM**



**LUSH GREEN
ENVIRONS**



**CLUB
AMENITIES**





Apex Court

2-3 Bedroom Luxury Apartments
A BOUTIQUE PROJECT

HIGHLIGHTS

- Located on Plot No. GH 01A, Sec-12, GNIDA on 130 mtr. wide road.
- 1 Min. drive from proposed Metro Station of Greater Noida.
- 15 Min. drive from Noida City Centre Metro Station.
- Land allotted by Greater Noida Authority.
- Full land payment made to Greater Noida Authority.
- Two side open plot.
- No price escalation for booked flat.
- Timely delivery.
- 100 Mtr. commercial belt near the project.
- Two tier 24x7 security with CCTV camera.
- Club with Gym, Swimming Pool, Pool Table, Table Tennis.
- Housing loan facilities from leading banks.
- Separate play area for toddlers & Kids.
- Lifts in each tower by OTIS/KONE or equivalent.
- Plumbing done with CPVC pipe or equivalent to avoid corrosion.
- Covered reserved parking.
- IIT certified earthquake resistant building.
- Convenient shopping within the project.
- Each flat is three side open.
- Kids Play Area.



SPECIFICATIONS

STRUCTURE

Earthquake resistant RCC framed.

LIVING / DINING / LOBBY PASSAGE

FLOOR : Vitrified tiles / Equivalent.

WALLS : OBD paint.

CEILING : Designer POP.

BEDROOM

FLOOR : Vitrified tiles / Laminated wooden flooring in master bedroom.

WALLS : OBD.

CEILING : Designer POP.

KITCHEN

WALLS : Designer ceramic tiles upto 2 ft. above counter.

FLOOR : Combination of anti skid ceramic tiles / vitrified tiles.

COUNTERS : Granite working platform.

FITTINGS / FIXTURES : CP fittings, stainless steel sink.

WOOD WORK : Semi modular kitchen.

BALCONY

FLOOR : Anti skid ceramic tiles / Terrazzo tiles.

WALL & CEILING : OBD paint.

WATER

Drinking water treatment facility by individual R.O. System.

NOTES :

- The colour and design of the tiles and motifs can be changed without any prior notice.
- Variation in colour and size of vitrified tiles / granite may occur.
- Area in all categories of apartments may vary up to +3% without any change in cost.
- However, in case the variation is beyond + 3% pro-rata charges are applicable.
- Variation in colour in mica may occur.

TOILET

WALLS : Designer ceramic tiles.

FLOOR : Combination of anti skid ceramic tiles / Vitrified tiles.

FITTINGS / FIXTURES : ISI fittings, standard chinaware fixtures & fittings for geyser water supply.

WATER : Hot and cold water pipeline provision.

DOORS

ENTRANCE DOORS : Polished skin doors.

INTERNAL DOORS : Hardwood frame with flush door shutter.

WINDOWS

Powder coated aluminum glazing.

LIFT LOBBY

FLOOR : Combination of different colours of marble / Stone in pattern.

WALLS : Granite tiles cladding upto 3 ft. and texture paint above.

ELEVATOR : High speed elevator.

ELECTRICAL

Modular Switches

Protection with MCB

Copper wire in concealed PVC conduits

Adequate light and power points with modular switched.



AUTHORITY PARK

24.0 M WIDE ROAD

- 2 BHK 880 SQFT
- 2 BHK + STUDY 970 SQFT
- 3 BHK + 2TOI 1175 SQFT
- 3 BHK + 3TOI 1485 SQFT

Apex Court
2-3 Bedroom Luxury Apartments
A BOUTIQUE PROJECT



24.0 M WIDE ROAD

COMMERCIAL BELT

130 M WIDE ROAD

Floor Plans



2 Bedrooms + 2 Toilets
 Super Area : 880 Sqft.
 Built Up Area : 708.07 Sqft.
 Carpet Area : 518.77 Sqft.

2 Bedroom + 2 Toilets + Study
 Super Area : 970 Sqft.
 Built Up Area : 780.41 Sqft.
 Carpet Area : 590.46 Sqft.



3 Bedrooms + 2 Toilets
 Super Area : 1175 Sqft.
 Built Up Area : 923.54 Sqft.
 Carpet Area : 706.06 Sqft.

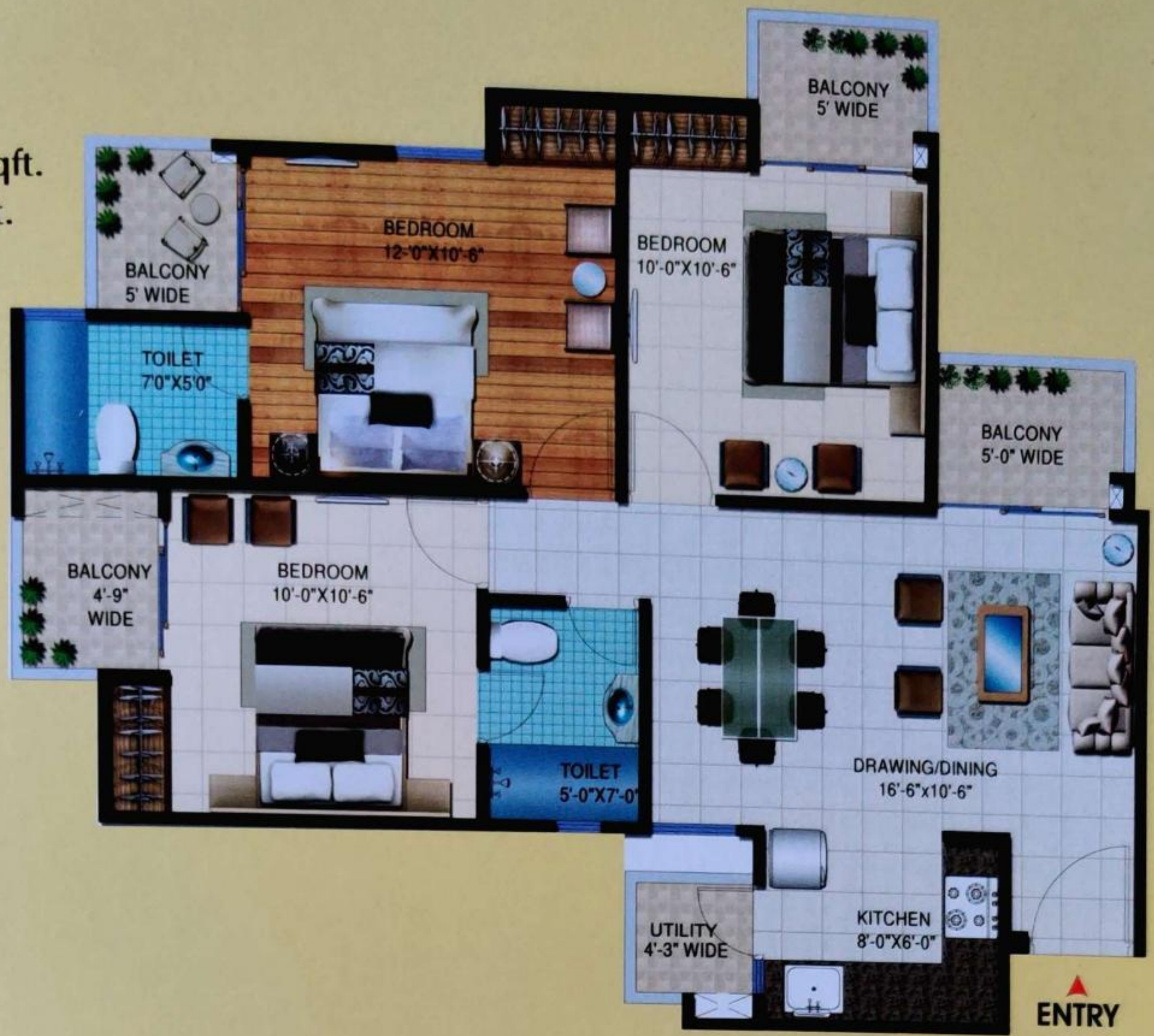

3 Bedrooms + 3 Toilets
 Super Area : 1485 Sqft.
 Built Up Area : 1171.95 Sqft.
 Carpet Area : 898.48 Sqft.



LOCATION MAP



LOCATION MAP NOT TO SCALE



Project Approved by :



HDFC BANK

&



ANDHRA BANK

Apex Court a unit of APEX INFRAVENTURES PVT. LTD.

Plot No. GH-01A, Sec-12, Greater Noida West | Ph.: +91 9810161713, 7428312826

Email : apex.courtgreaternoida@gmail.com | Website : www.apexcourtgreaternoida.com