

A PROJECT BY DASPALLA GROUP

A seashell is placed on the sand in the foreground, with the ocean and a bright sun setting on the horizon in the background. The entire scene is bathed in a warm, golden light.

GANGAPUR  
**Royal  
Palace**  
Adj. VUDA Park, East Point Colony

ENJOY A RELAXED LIFESTYLE  
ON BEACHFRONT





## AN ICONIC HOME IN ENVIABLE DESTINATION

Live a relaxed life in an iconic home at idyllic location. The Beach Road is not only home to star hotels, corporate offices, fine dining and the beach, but also connects the new IT cluster, SEZ, and a proposed International Airport at Bhogapuram. Promoted by Vizag's prominent builders, **Gangapur Royal Palace** celebrates your life in an address meant for the accomplished.







## PROJECT HIGHLIGHTS

- GVMC-Approved
- Luxury Residential Project
- 2 Blocks, 5 Floors each
- 85 Three-BHK apartments
- 1563 Sft – 3019 Sft areas
- Premium quality construction
- 100% Vastu
- No common walls
- Children play area
- Designer landscaping
- Two level parking
- Generator for Power Backup
- Central location
- Reputed Promoters



ONE-OF-A-KIND HOME AWAITS YOU





## MANY DREAM ABOUT BEACHFRONT LIVING ONLY A FEW CAN REALIZE...

The two block **Gangapur Royal Palace** redefined the way we live in apartments. The king size 3 BHK apartments presents 1563 sft to 3019 sft areas for refined living. Futuristic space planning, premium quality construction make your home truly exceptional. Enjoy glorious sunrises over Bay of Bengal as you relax in wind swept balconies. VUDA park next to your home is a boon for fitness minded. You are invited to explore beachfront living at Gangapur Royal Palace.





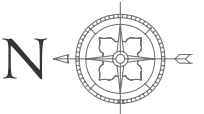
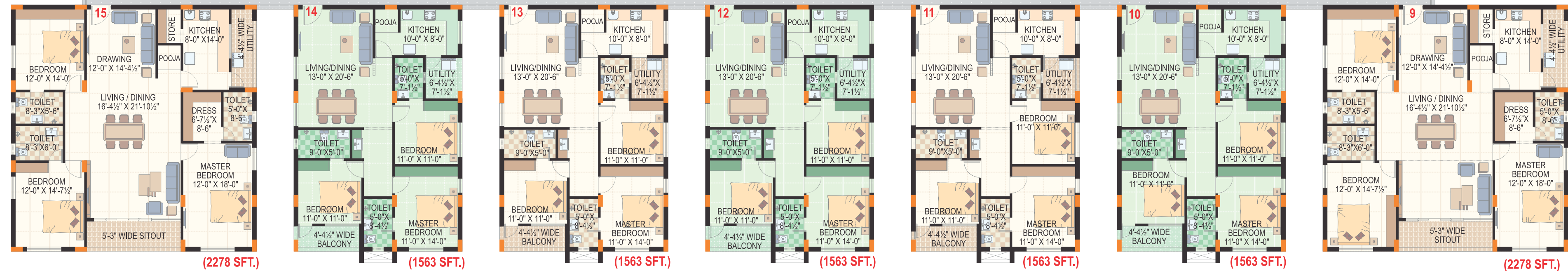
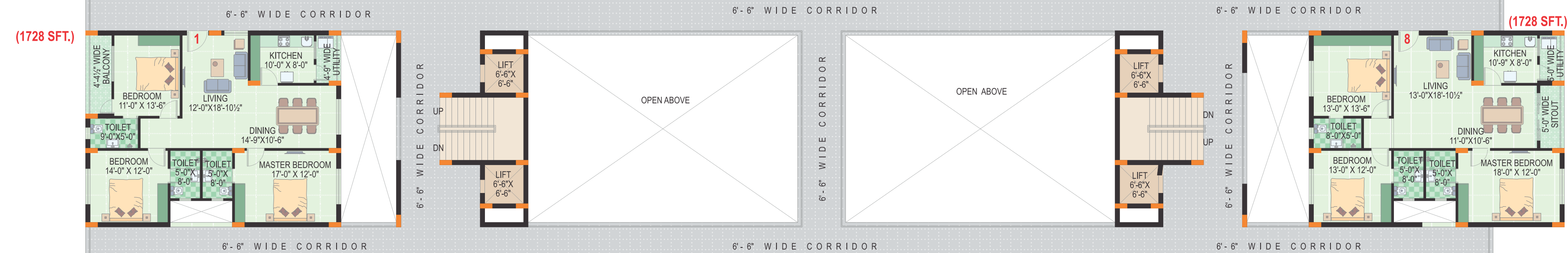
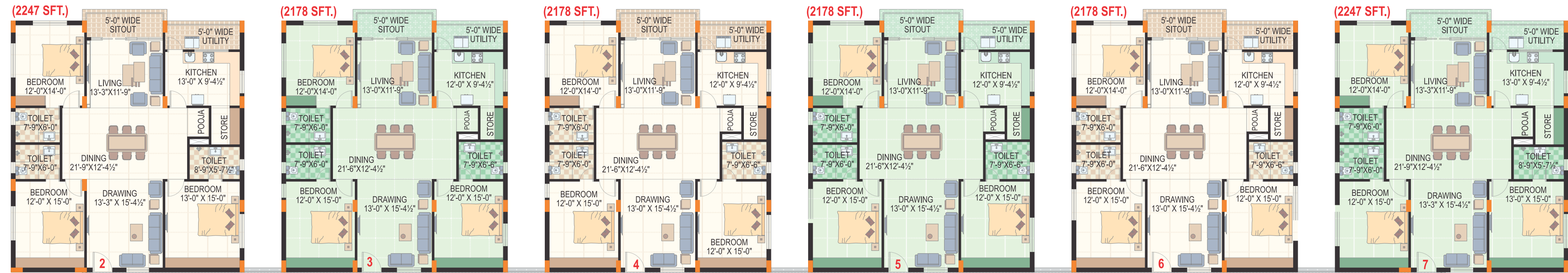

TYPICAL FLOOR PLAN  
BLOCK A















**TYPICAL FLOOR PLAN  
BLOCK B**





## SPECIFICATIONS

 <b>STRUCTURE</b> RCC framed structure	 <b>BACKUP GENERATOR</b> Soundproof generator for total flat area including common area, lifts and water pumps(except air conditioners and geysers)
 <b>WALLS</b> 4 1/2" Internal/9" external light weight table moulded brick masonry	 <b>KITCHEN SINK</b> 2' Wide black granite kitchen platform. Single bowl stainless steel sink
 <b>PLASTERING</b> Single coat smooth finished cement plastering for inside and double coat smooth finish cement plastering for outside walls	 <b>LIFTS</b> Lifts of standard make(Johnson/Otis)
 <b>PAINTING</b> <b>INTERIOR WALLS:</b> One coat of primer and two coats of plastic emulsion paint with smooth luppum finish using reputed brands like Birla or JK White etc. <b>EXTERIOR WALLS:</b> One coat of primer and two coats of Apex or equivalent paint with smooth exterior luppum finish or texture	 <b>ELECTRICALS</b> Electrical: White colour modular switches and distribution board. Cables(wiring) of Finolex/Havells make Master Bedroom: Two light points (one light point 2-way), one fan point(2-way), one A/c point, four 5A sockets, telephone + TV point(concealed conduit for DTH like Tata Sky) Children Bedroom: Two light points, one fan point, one A/c point, three 5A sockets, telephone Hot Water: Solar hot water supply for all toilets Guest B/R: Two light points, one fan point, three 5A socket + A/c point+ telephone point Living Room: Two light points, one fan point, one TV, one telephone and four 5A sockets Foyer: One light point, one socket Dining Room: Two light points, one fan point, one 15A socket for fridge and three 5A sockets Kitchen: Two lights, two 15A sockets and three 5A sockets One 15A socket for refrigerator Utility: One light point, one 15A(washing machine) Master Bathroom: Two light, one 15A socket for geyser, two 5A sockets Children Bathroom: Two light, one 15A socket for geyser, two 5A sockets Guest Bathroom: Two light points, two 5A sockets, 15A socket for geyser Pooja Room: Two light points, one 5A socket Balcony: One light point, one fan point and 5A socket in each balcony One light point(2 way) to be provided outside Entrance door.
 <b>FLOORING</b> Vitrified tiles 2'x2' Johnson / Naveen / Kajaria / Restile / Nitco (premium quality). Range up to Rs 55/- per Sft. 2'6"x2'6" Johnson / Naveen / Kajaria / Restile / Nitco (premium quality). Range up to Rs 70/- granite / marble for common areas and staircase. SS railing for staircase	<b>Note:</b> 1. All electrical fittings should be purchased by the owner at his own cost, only provisions for the above electrical fixtures will be made by the Builder. 2. Shifting of outdoor and indoor A/c units are not allowed. Erection of any type of structures for A/c outdoor unit and others are not allowed.
 <b>TOILETS &amp; ACCESSORIES</b> <b>ALL TOILETS:</b> Jaquar sanitary ware and Jaquar fixtures of Florentine Series. One wall mounted WC(white colour) with flush valve. One wash basin with pillar cock(white colour). One single lever diverter with spout and overhead shower. One health faucet with two way bib cock. <b>POWDER ROOM:</b> One wall mounted WC(white colour) with flush valve. One wash basin with pillar cock(white colour). One health faucet with two way bib cock. <b>DINING ROOM:</b> One wash basin(white colour) with pedestal. <b>DADO:</b> Toilets: 6' Height Concept tiles along with matching floor tiles of Johnson make or equivalent(premium quality) range up to Rs 45/- per Sft.	
 <b>JOINERY</b> <b>MAIN DOOR:</b> Teak wood frames and Teak wood paneled shutter with designer hardware of reputed make <b>INTERNAL DOORS:</b> Teak wood frames with company made flush shutters with Sun make laminate on both sides and standard SS hardware <b>WINDOW:</b> UPVC/Powder coated Aluminum window <b>GRILLS:</b> Window grill (MS / Aluminum / SS / others) shall be fixed at inside of the window at extra cost. Balcony enclosures are not allowed.	



## TRANQUIL LIVING IN HAPPENING LOCATION

The East Point Colony on beach road connects the past with the future. Wide driveways lead to reputed schools, corporate hospitals and the IT SEZs beyond Madhurawada. Shopping and fine dining are just a few minutes away from your home. Walking on beach and watching the evening life on spectacular Beach Road is an exclusive experience for **Gangapur Royal Palace** residents.



VIEW FROM SEASHORE





## THE PRIDE OF VIZAG VUDA PARK NEXT TO YOUR HOME

Vizag's prestigious VUDA Park is located next to your home. Your leisure times are enriched as you go for jogging and work out yoga every day. The sprawling park is heaven sent for children. Play in landscaped gardens, enjoy sea breeze and socialize as every moment is a pleasure at **Gangapur Royal Palace**.



- Andhra University – 2 Kms | Waltair Club – 2.5 Kms
- Dwaraka Bus Stand – 3.5 Kms | Indira Gandhi Zoological Park – 7 Kms
- Health City – 8 Kms | GITAM University – 9 Kms
- Cricket Stadium – 12 Kms | Vizag Airport – 15 Kms
- Hotel Daspalla - 4.7 Kms







## OUR PREVIOUS PROJECTS



Vepa Heights @ Kirlampudi



Red Creek @ Harbor Park Road



Sahiti Residency @ Lawsons Bay Colony



Sagar Sitara @ Beach Road



East Coast Apartments @ East Point Colony



Majestic Towers @ RK Beach



Sarada Kutir @ -----

### PROMOTERS

#### DASPALLA CONSTRUCTIONS

Flat No: G-5, Sunny Side Homes Apartments, Waltair Main Road, Visakhapatnam-2  
Ph: 2568350, 2747824, Email: [daspallaconstructions@gmail.com](mailto:daspallaconstructions@gmail.com)  
[www.daspallaconstructions.com](http://www.daspallaconstructions.com)

### ARCHITECTS



#### VISTAAS ARCHITECTURAL CONSULTANTS

Mumbai - Hyderabad - Pune - Vizag  
[www.vac-india.com](http://www.vac-india.com)

### STRUCTURAL DESIGNER

#### DR T. VENKATESWARLU

Ph: 0891-2701753

Note: This brochure is only a conceptual presentation and not a legal offering.  
The promoters reserve the right to alter and make changes in elevation, highlights, plans and specifications as deemed fit.