



SBR GROUP

Opp Sandeep Vihar Apartment, Seegehalli Village,
Bidarahalli Hobli, Bangalore- 560 067

Hotline No: +91 888 0936936

www.sbrgroup.in,
e-mail: enquiry@sbrgroup.in

Promoted & Developed
SBR Group

Architects
Think Designs

Legal Advisor
Kusuma Advocates



RERA No: PRM/KA/RERA/1251/446/PR/171123/000625

SBR
Horizon



Disclaimer: This Brochure is purely conceptual. It's by no means a legal document. The Promoters, Developers and the Architects reserve the right to add, delete or alter any specifications, elevation or areas mentioned here in if required.

A WORLD OF **INFINITE** OPPORTUNITIES

RERA No: PRM/KA/RERA/1251/446/PR/171123/000625

DESIGNED FOR HIGHER LIVING

From the architect planning to the smallest comfort, every little detail has been carefully thought out to give you an unparalleled living experience.

This Magnificent combination of pleasure and entertainment project offers elegant **Studio, 2, 3 & 4BHK Apartments.**



HOW FAR DO YOU WANT TO GO?

Get Connected with all Whitefield offerings in mins

HOSPITALS

| | |
|---------------------|---------|
| Cloud 9 Clinic | 10 mins |
| Sathya Sai Hospital | 11 mins |
| Columbia Asia | 14 mins |

SHOPPING

| | |
|--------------------|---------|
| Casio Hyper Market | 1 mins |
| Nilgiris | 2 mins |
| Park Square Mall | 9 mins |
| Forum Value Mall | 14 mins |

HOTELS

| | |
|------------------|---------|
| Sheraton 4Points | 9 mins |
| Taj Vivanta | 9 mins |
| Zuri Hotel | 11 mins |
| ALILA | 15 mins |

OFFICES

| | |
|-----------------|---------|
| Bearys Global | 6 mins |
| ITPL | 9 mins |
| KIADB | 10 mins |
| Sigma tech park | 12 mins |

FUEL

| | |
|-------|--------|
| Shell | 1 mins |
| HP | 2 mins |

RAILWAYS

| | |
|----------------------------|---------|
| Whitefield Railway Station | 4 mins |
| KR Puram Railway Station | 22 mins |

SCHOOLS

| | |
|---------------------------|--------|
| VIBGYOR School | 4 mins |
| Ujwal School | 6 mins |
| St. Joseph Convent | 8 mins |
| Delhi Public School | 9 mins |
| White Field Global School | 9 mins |

BANKS & ATM

| | |
|----------------------|--------|
| KVB | 0 mins |
| ICICI Bank ATM | 1 mins |
| Axis Bank ATM | 2 mins |
| State Bank of Mysore | 2 mins |
| State Bank of India | 2 mins |
| HDFC Bank | 4 mins |
| Axis Bank | 7 mins |

LOCATION MAP

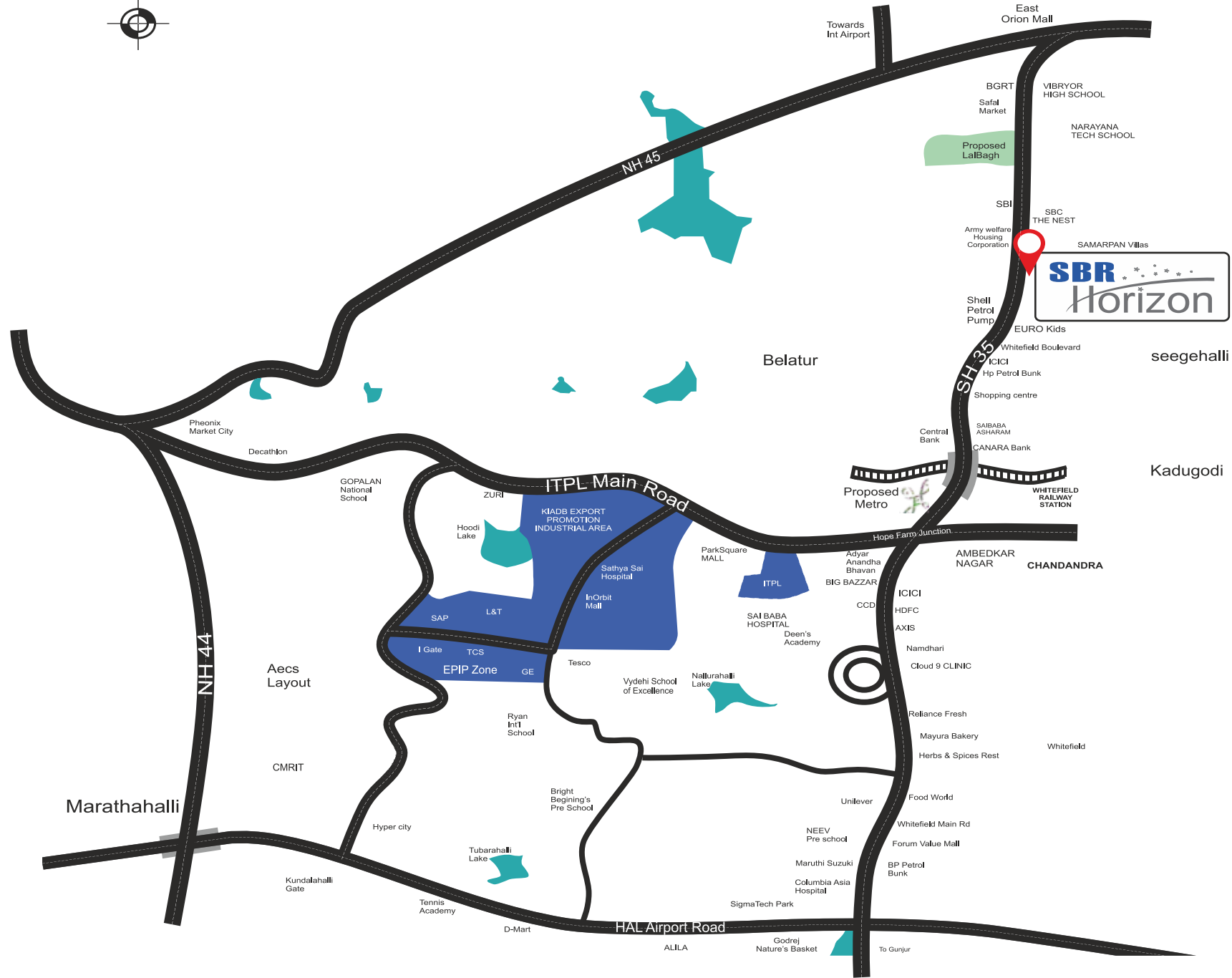

RERA No: PRM/KA/RERA/1251/446/PR/171123/000625

RERA No: PRM/KA/RERA/1251/446/PR/171123/000625



VISION

**CRAFTED TO PERFECTION,
FOR THE DISCERNING FEW**

It is often said, the best things in life come to those who wait. We understood and have saved the best for last. It's time to celebrate your success. And what better celebration than the perfect home?

A home you'll be proud to call your own



An address that celebrates your success in the most happening place of Bangalore - Whitefield.

A mixed development with contemporary Architecture for Residential Complex & Elegantly designed commercial building with ample space for shopping, entertainment, dining, health club & corporate office.

An infinity pool, 5 Multiplex's, 20,00 sqft hyper market and many more.

SBR Horizon is poised to be more than just an address in Whitefield.

- it will be a landmark.

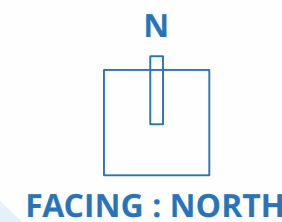
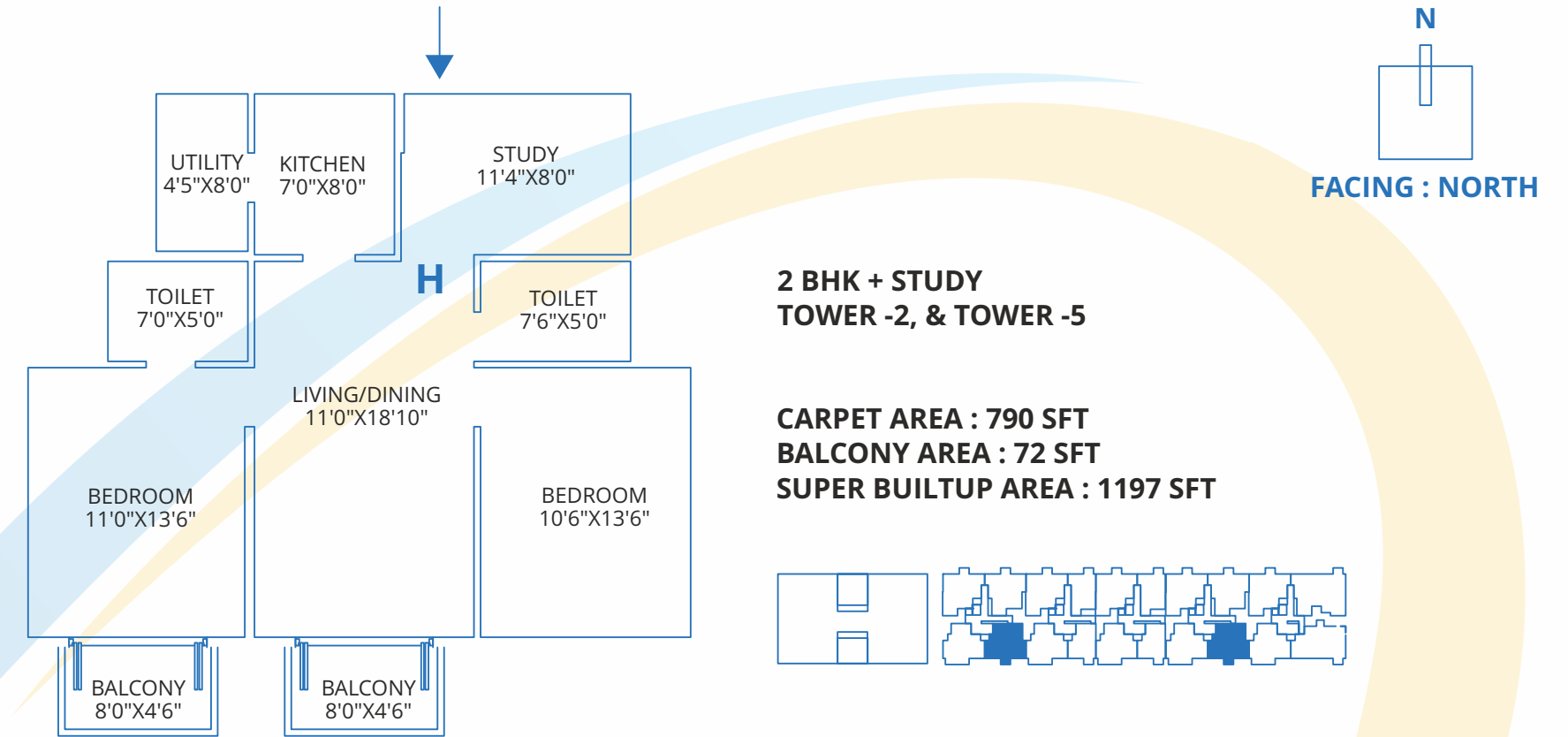

**1 BHK + Study
TOWER -3 & TOWER -4**

**CARPET AREA : 481 SFT
BALCONY AREA : 48 SFT
SUPER BUILTUP AREA : 747 SFT**

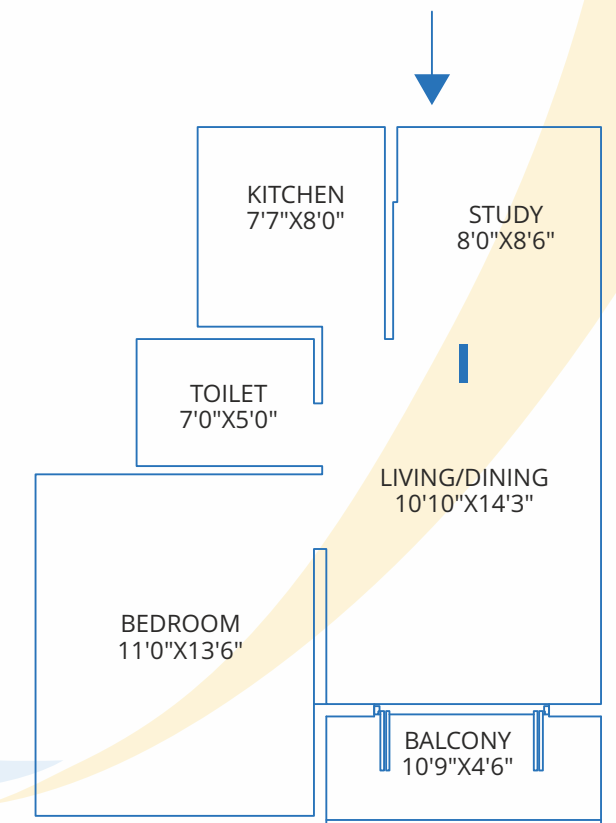

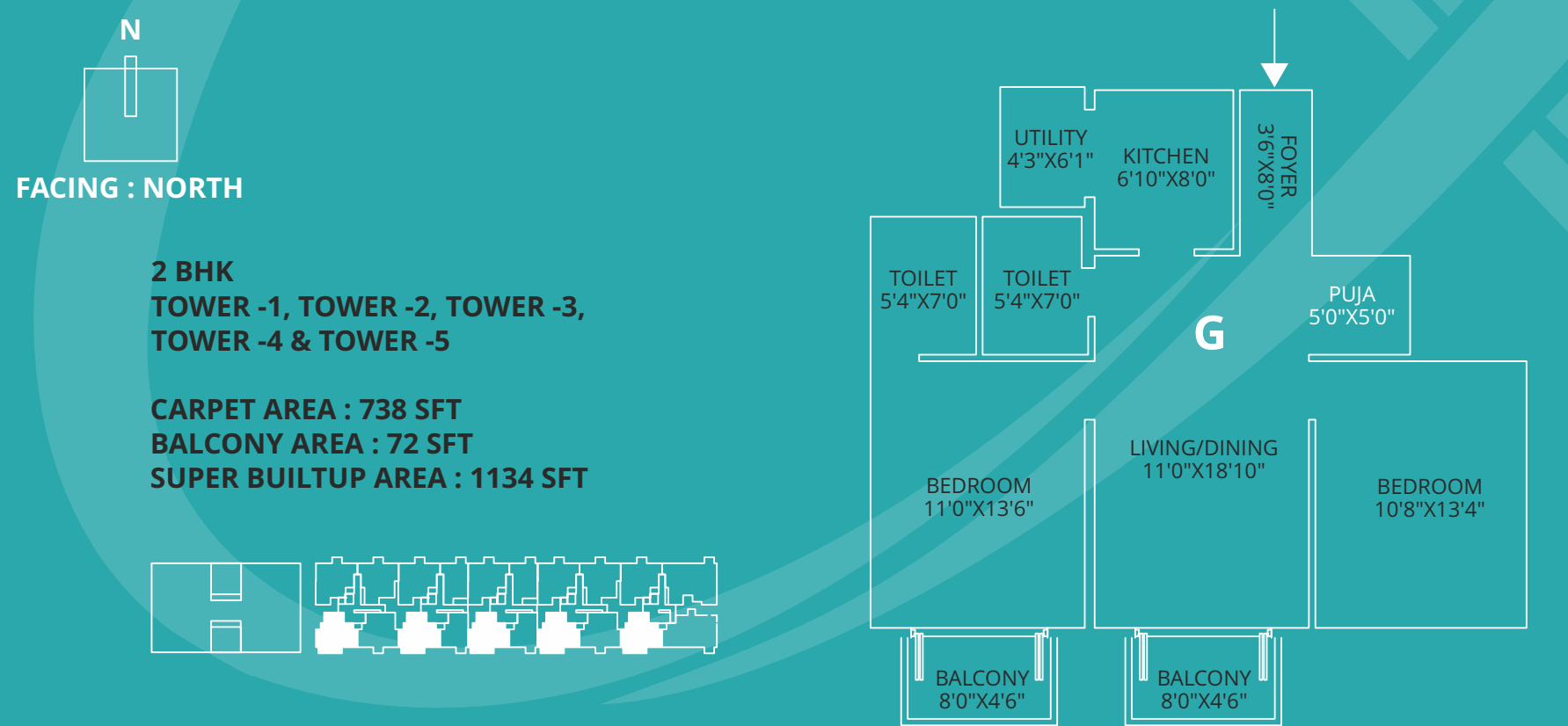
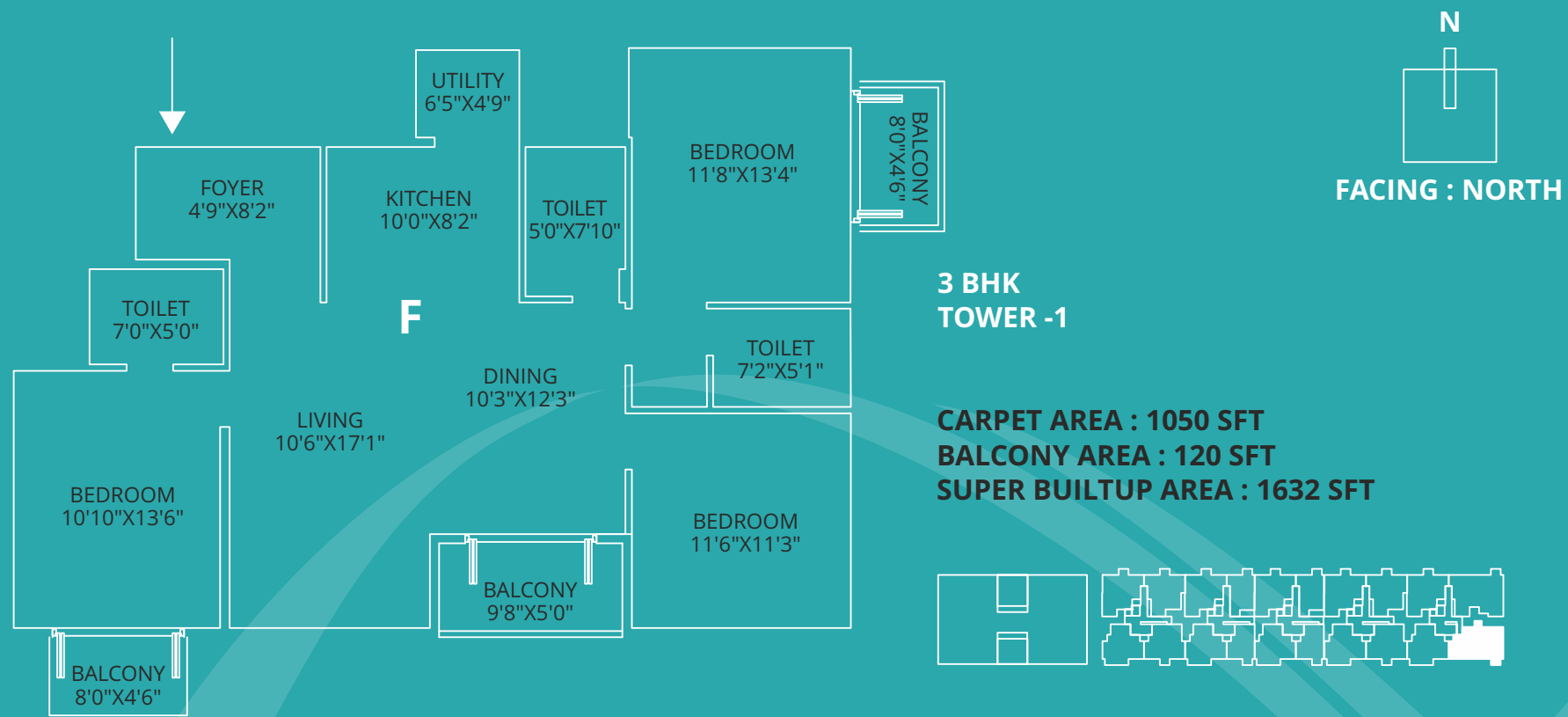

RERA No: PRM/KA/RERA/1251/446/PR/171123/000625



INDIVIDUALITY

IT'S THE SMALL THINGS
THAT SETS US APART

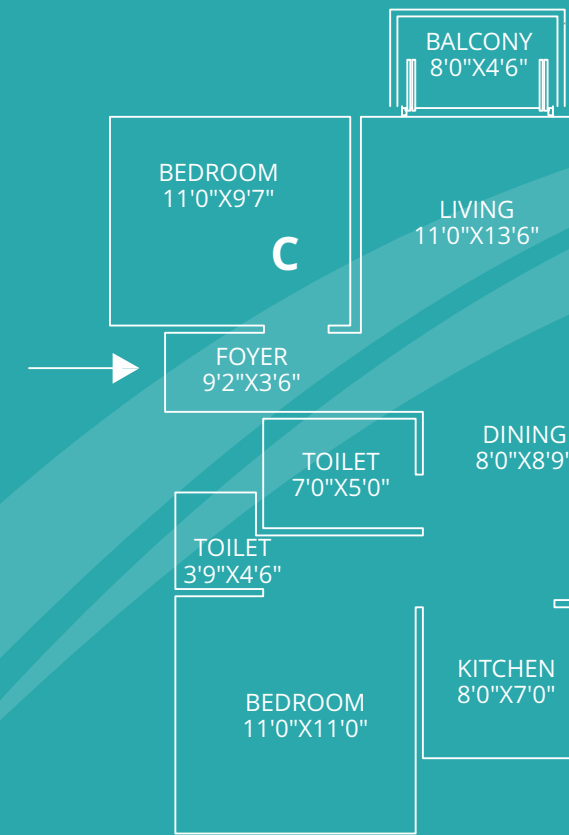

**2 BHK
TOWER -3, & TOWER -4**

**CARPET AREA : 618 SFT
BALCONY AREA : 36 SFT
SUPER BUILTUP AREA : 910 SFT**

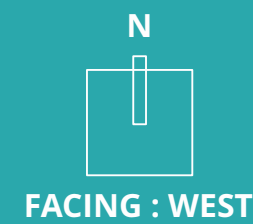

**4 BHK
TOWER -1**

**CARPET AREA : 1205 SFT
BALCONY AREA : 84 SFT
SUPER BUILTUP AREA : 1792 SFT**

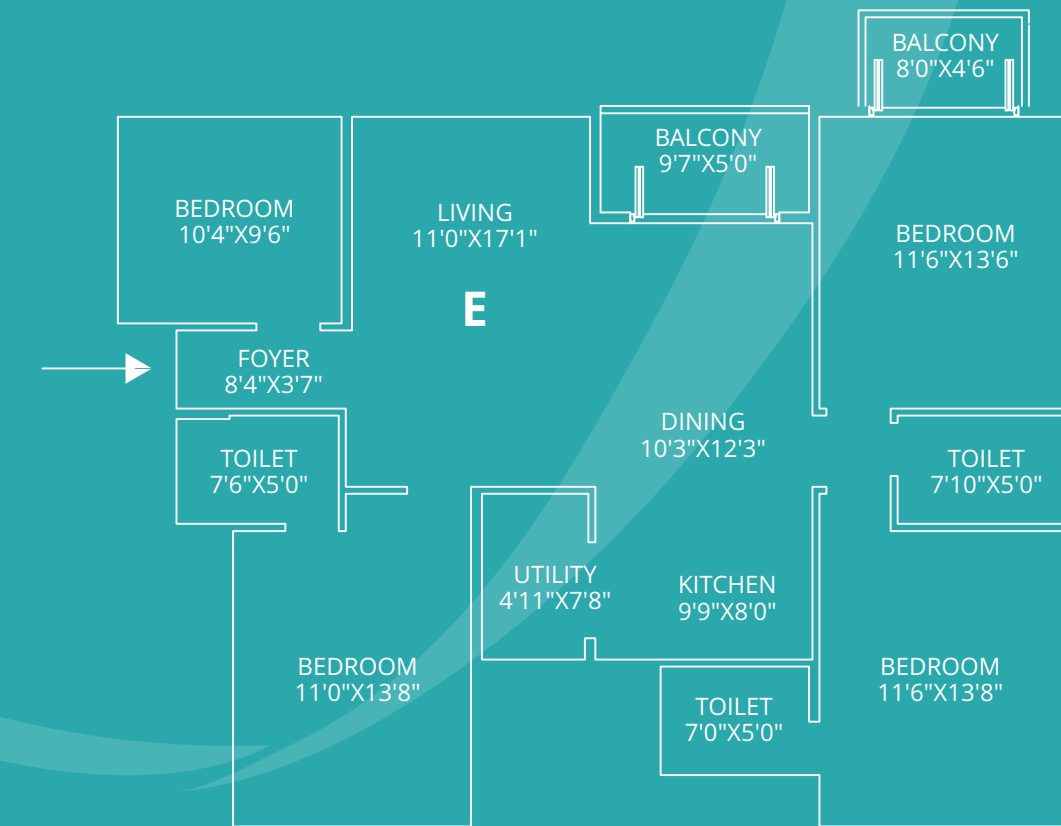

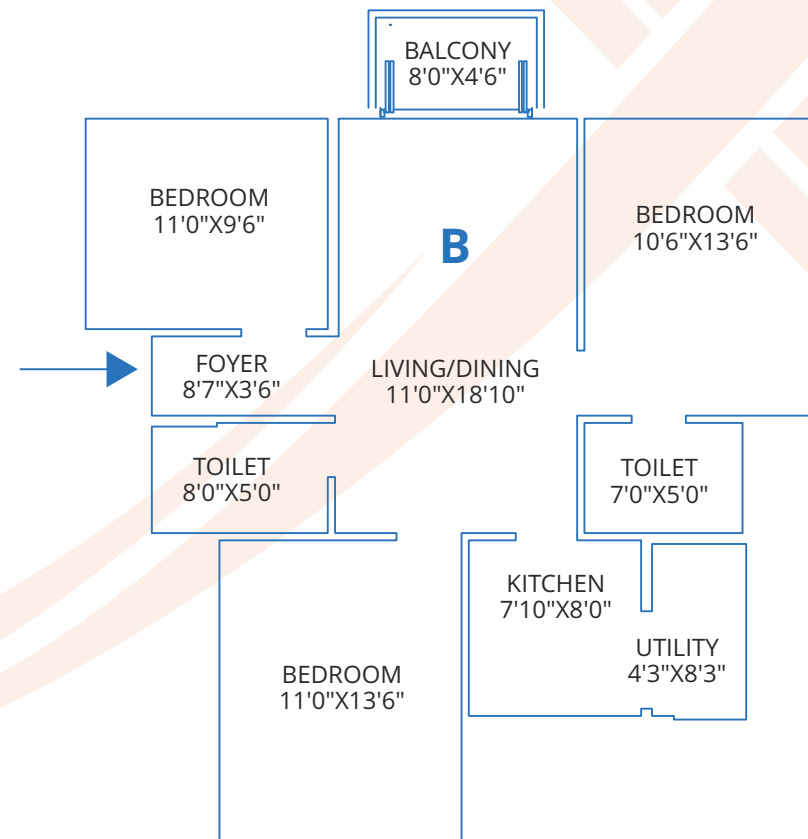
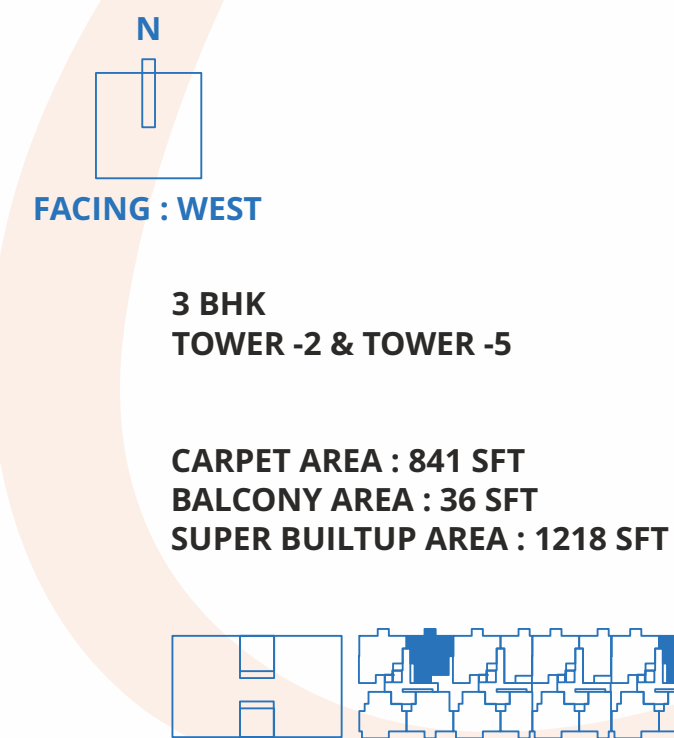
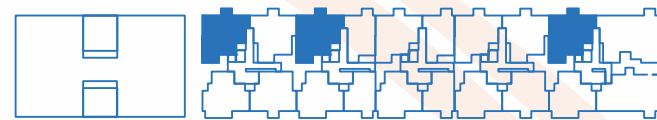
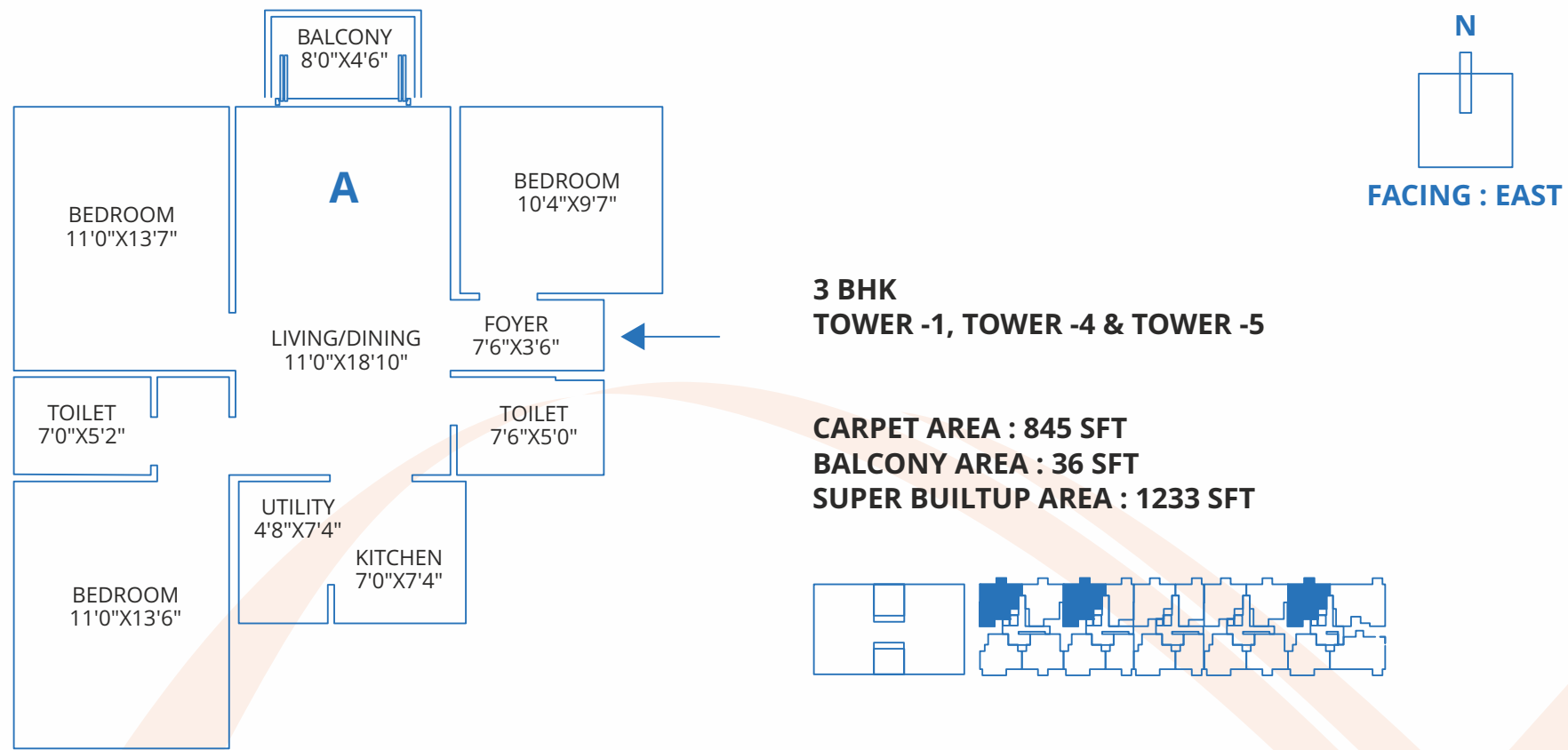

RERA No: PRM/KA/RERA/1251/446/PR/171123/000625

STRUCTURE

RCC Framed structure, designed for seismic zone 2. External & internal walls of solid concrete blocks, external walls & internal walls with cement plaster.

FLOORING

Vitrified tiles for living | dining, bedrooms and kitchens. Laminated Wooden flooring for master bedroom. Anti-skid tiles for toilets, balconies & utility.

LOBBY & STAIRCASE

A combination of granite and vitrified tiles. Granite cladding for lift facia.

DOORS & WINDOWS

Main Doors: Teak wood frame with HDF moulded design shutter. Internal Doors: Hardwood frame with HDF moulded design door shutters. Windows: UPVC windows / Equivalent.

ELECTRICAL

In concealed conduits with copper wiring of Finolex or equivalent make. Elegant modular switches of Anchor or equivalent make, 1.5 KW power provided for 1BHK, 3 KW power provided for 2 BHK apartments, 5 KW power provided for 3 & 4BHK apartments.

TOILETS

Anti skid flooring and glazed tile dadoing up to 7ft height. Sanitary ware of parryware or equivalent make. Chrome plated taps of Jaquar or equivalent make. PVC False ceiling with grid panels.

WALL FINISHES

Internal Walls: Acrylic distemper for all smooth walls and ceilings. External Walls: Exterior grade cement paint on all rough walls.

GENERATOR

Backup power for all common services in addition to 1 KW for Studio & 2 BHK, 1.5 KW for 3 & 4 BHK apartments for lighting circuits.

WATER SUPPLY

Underground and overhead storage tanks of suitable capacity. Water supply source is through Borewell's.

LIFTS

One stretcher Lift & One passenger lift of reputed make for each block.

SECURITY SYSTEM

Round the clock security with provision for intercom facility. CCTV in common areas.

COMMON UTILITIES

Water Softener & Treatment Plant | Sewage Treatment Plant | Organic Waste | Converter | Rain Water Harvesting

KITCHEN

Granite cooking counter with stainless steel sink. Glazed tile dadoing of 2ft. Provision for chimney.

IMPRESSION

AMENITIES

Accentuating the appeal and charm,
are pleasant diversions and upscale refinements.

- GYM / AEROBICS
- INFINITY & TODDLERS POOL
- KIDS PLAY AREA
- OUTDOOR PARTY DECK
- SENIOR CITIZEN LOUNGE
- JOGGING TRACK

