

Specifications

- Structure** : RCC framed structure, recommended by structural engineer
- Walls** : 9" red brick for exterior walls and 4" red brick for internal walls.
- Doors & Windows** : Main door & main window : **Polish quality teak wood** frame and shutters.
Other doors : **Teak wood frames** & flush door shutters.
Other windows : UPVC windows with safety grills.
Water-proof WPVC doors for bathrooms.
- Flooring** : Flats Internal : **Vitrified, Double-Charged** tiles of 2'x2' with 4" skirting.
Wash area & Balcony : Ceramic tiles.
Corridors & Steps : Anti-skid tiles / Granite
- Kitchen** : Granite cooking platform, glazed digital tiles dadoing upto 2'-6" height & Stainless steel sink.
- Bathroom** : Flooring : Anti-skid tiles, Walls: Digital tiles dadoing upto 7' height.
White-colored **Parryware / Hindware** / equivalent sanitary fittings.
- Cupboards** : RCC cement planks will be provided.
- Ceiling** : POP Ceiling only in 5th floor (in Hall and Bedrooms).
- Electrification** : Modular switches of **Anchor / Legrand** / equivalent make with concealed **Finolex / Anchor** / equivalent copper wiring
2 TV, 3 AC, Geyser, Aquaguard & Chimney Points provision for flat.
- Generator** : Backup for common areas, lifts and five backup points for each flat.
- Plumbing & Sanitary** : Concealed **Astral / Ashirwad** make CPVC pipelines with **Hindware / Cera** equivalent make CP fittings
- Painting** : Internal : Wallcare putty and **Asian / Berger** emulsion Paints
External : Asian / Berger exterior emulsion paints.
Wallcare putty and texture for elevation
- Water Supply** : Bore water supply from over head tank
- Lift** : **Johnson / Kone** make, Three lifts each of 6 passenger capacity.
- Special Features** : Epoxy adhesive flooring in bathrooms
CCTV Camera surveillance in parking area
Intercom facility for all flats
Rear open area - for children's play area and garden
- Owner's Cost** : Electrical service connection charges, Corpus fund, Club House membership, Registration charges, GST or other taxes are extra at buyer's cost

Previous Projects

SUNRISE TOWERS

Kunchanapalli



50 Flats
July - 2015
December - 2016
18 Months

60 Flats
September - 2017
February - 2019
18 Months

AASRITHA PARADISE

Mangalagiri



V CUBE CONSTRUCTIONS

Varsha Elite

Location Map



Y. Raviteja B.Tech, M S (BITS Pilani)
Managing Partner
Mobile : +91-9885138042

Y. Krishna Teja
Partner
Mobile : +91-9490907883



Project Developers / Builders -

V CUBE CONSTRUCTIONS

D.No.41-5-24, Old Police Station Road,
Krishna Lanka, Vijayawada - 520013.
Email : info@vcubeconstructions.com
Website: vcubeconstructions.com

Project Architects
K.P.V. RATNAM,
Jai Durga Planners & Consultants,
Vijayawada. Mobile : +91-9848457675

Structural Engineer -
R. VENU,
M.tech. (structures), Gold Medalist

Note : This brochure is only conceptual presentation of the project and not a legal offering.
The promoters reserve the right to make changes in the elevation, internal plan and specifications as deemed fit

Location Highlights

- ★ 2 km from DGP Office, Happy Resorts
- ★ 3 km from AIMS Hospital & Medical College
- ★ 3 km from KL University, Vaddeswaram
- ★ 6 km from APIIC & IT Hub, Mangalagiri
- ★ 6 km from Manipal Hospital, Tadepalli
- ★ Just 10mins. drive to Lakshmi Narasimha Swamy Temple, Temple Eco Park Mangalagiri
- ★ Just 10mins. drive to Vijayawada



Varsha Elite

Atmakuru - Ippatam Main Road,
Atmakuru, Mangalagiri Mandal

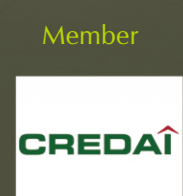

Varsha Elite

TYPICAL FLOOR PLAN

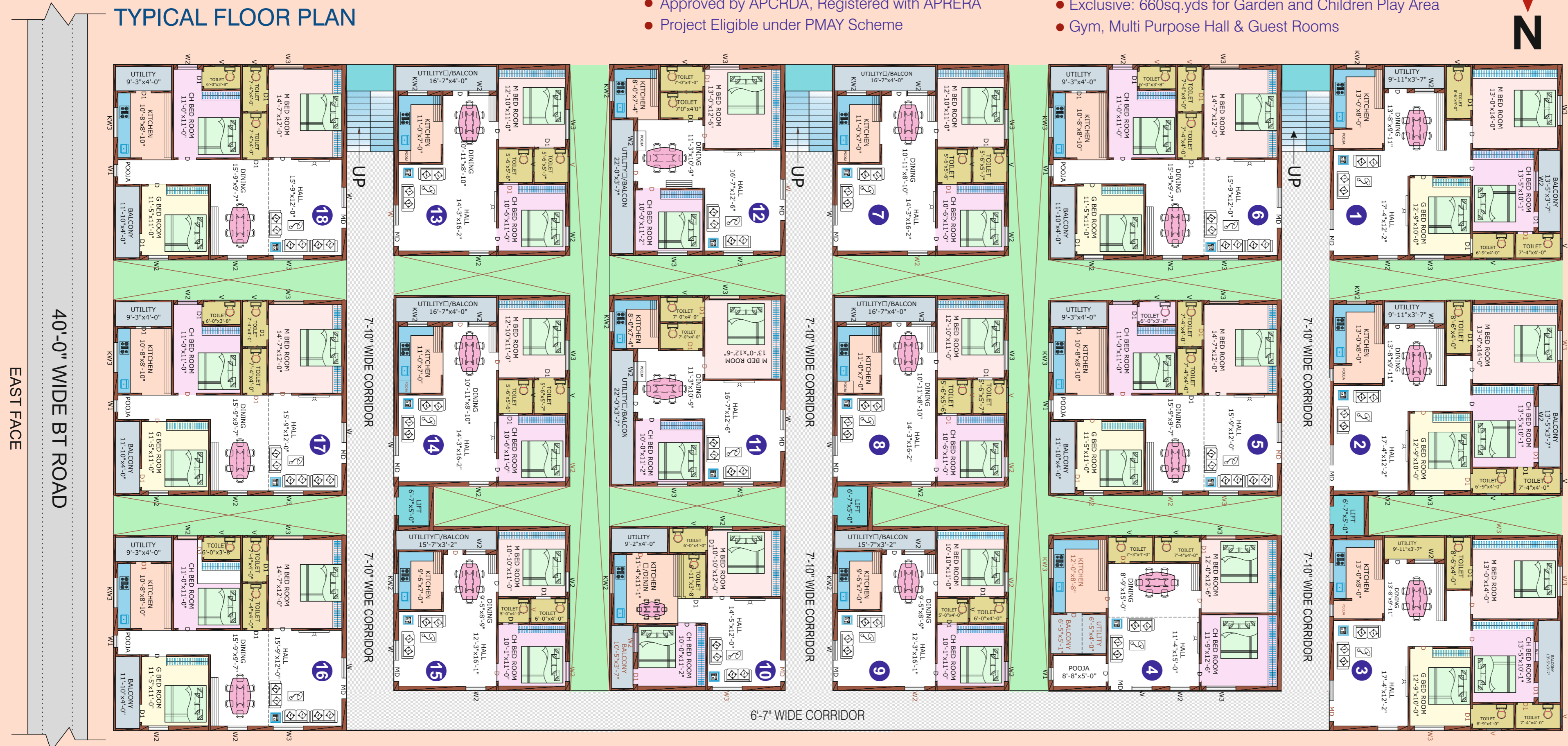

Project Highlights

- Peaceful and Pollution free environment
- Approved by APCRDA, Registered with APRERA
- Project Eligible under PMAY Scheme

- Club House Facility - at affordable pricing
- 7-10" wide corridors
- Exclusive: 660sq.yds for Garden and Children Play Area
- Gym, Multi Purpose Hall & Guest Rooms



AMENITIES



**TOTAL SITE AREA - 5368 sq.yds.,
90-flats with Club House**

	3 BHK	2 BHK	2 BHK	2 BHK
Total Area Sft	1725	1396	1303	1140
Plinth Area Sft	1235	982	910	785
UDS Sq.yds	63.15	50.10	46	40
Flat No's	1,2,3, 5,6,16, 17,18	4	7,8, 11,12, 13,14	9 10 15