

Life at the top



1 BHK / 2 BHK
RESIDENCES WITH
A ROOF TOP GARDEN

*Artistic Representation

Welcome to blissful living...



Welcome to 'Balaji Krishna'

A blissful abode for people who have liking for great things in life. Balaji Krishna is very conveniently located at a walkable distance from Thakurli Railway Station, overseeing a proposed 24 meter wide road. Here you are always very close to everything important in life and hence you will spend less time commuting and more time with your family.

Balaji Krishna offers you high class living standard with it's unique **"ROOF TOP GARDEN AND FITNESS AREA"** which is proposed to have an open gymnasium with a roof top garden with designated yoga, meditation & sun bath areas for your health benefits.

You have option to choose from intelligently planned 1BHK, 2BHK apartments, most suitable to your need and budget. Every apartment is equipped with best quality construction and modern amenities for the **TOP CLASS LIVING EXPERIENCE.**

Apartments at Balaji Krishna is planned for best air circulation, great ventilation and abundance of sun light to brighten your day to day life. Every apartment is designed to give maximum space utilization with only the best amenities for comfort and happiness all around.

	Thakurli Railway Station	5 Mins
	Omkar International School	3 Mins
	Model College	2 Mins
	Metro Mall	10 Mins
	AIMS Hospital	5 Mins
	Savitribai Phule Natyagruha	5 Mins
	KDMC Gymkhana	5 Mins
	Bank (SBI, AXIS, HDFC, ICICI)	5 Mins



COME, DISCOVER THE MOST HEALTHY WAY OF LIFE

*#opengymnasium #yoga
#meditation corner*



**Artistic Representation*

PROJECT SPECIFICATION

- Designer Laminated Main Doors, Bedroom Doors and Bath room doors
- Best quality Vitrified flooring in apartment
- Tiles from reputed manufacturers for bathrooms and Kitchen
- Heavy Duty Anodized Aluminium windows
- Concealed electrical wiring with electrical fittings from reputed manufacturers
- Adequate electric points for AC, TV, Lights, Fans, Fridge, Geysers, Water Purifiers
- Best quality paints on putty finished internal walls
- Video Door Phones & Intercom
- Designer False Ceiling in Living room and Bed rooms

COMMON AMENITIES

- Grand elegantly designed entrance lobby
- World class Lifts / Elevators
- Power back up for common areas
- Solar Water Heating System
- Rain water harvesting system
- Weather resistant Acrylic paints on External walls
- Fire Fighting Equipments
- 24 x 7 surveillance by CCTV Security System
- Common Society office



*Artistic Representation



SS LIFE SPACES

—• *Building Space for Life* •—

Balaji Krishna is being developed by S. S. Life Spaces which is a group of construction companies developing residential apartments & commercial spaces.

It has completed & on going projects in Kharghar, Navi Mumbai, Dombivali, Kalyan & Thakurli in Central Mumbai Suburbs. The group is proud of it's journey, spread over around 20 years. From a "Stand Alone" building in 1998 to now Residential Complexes with multiple buildings, it has been a quite enriching experience.

Today the group is developing multiple projects with all the modern lifestyle facilities like recreational gardens, Health club, gymnasium and swimming pool. The group has successfully completed over 30 residential projects and delivered around 2000 apartments till date. The group has progressed leaps & bound in these 20 years, purely on the basis of its remarkable goodwill with its customers and construction associates.



S S Life Spaces Group - Inspiring blind trust since last 20 years . .

**Artistic Representation*

OUR PROJECTS



Balaji Aangan Complex - Thakurli (E)
Completed



Balaji Residency - Thakurli (E)
Completed



Trilok Heights - Thakurli (E)
Completed



Dream Heights - Kharghar
Completed



Balaji Siddhivinayak Complex
Dombivali (W) - Ongoing



Balaji Emerald - Thakurli (E)
Ongoing



Balaji Annex - Thakurli (E)
Ongoing



Balaji Emerald - Thakurli (E)
Ongoing

*Artistic Representation

PROJECT LAYOUT PLAN



*Artistic Representation

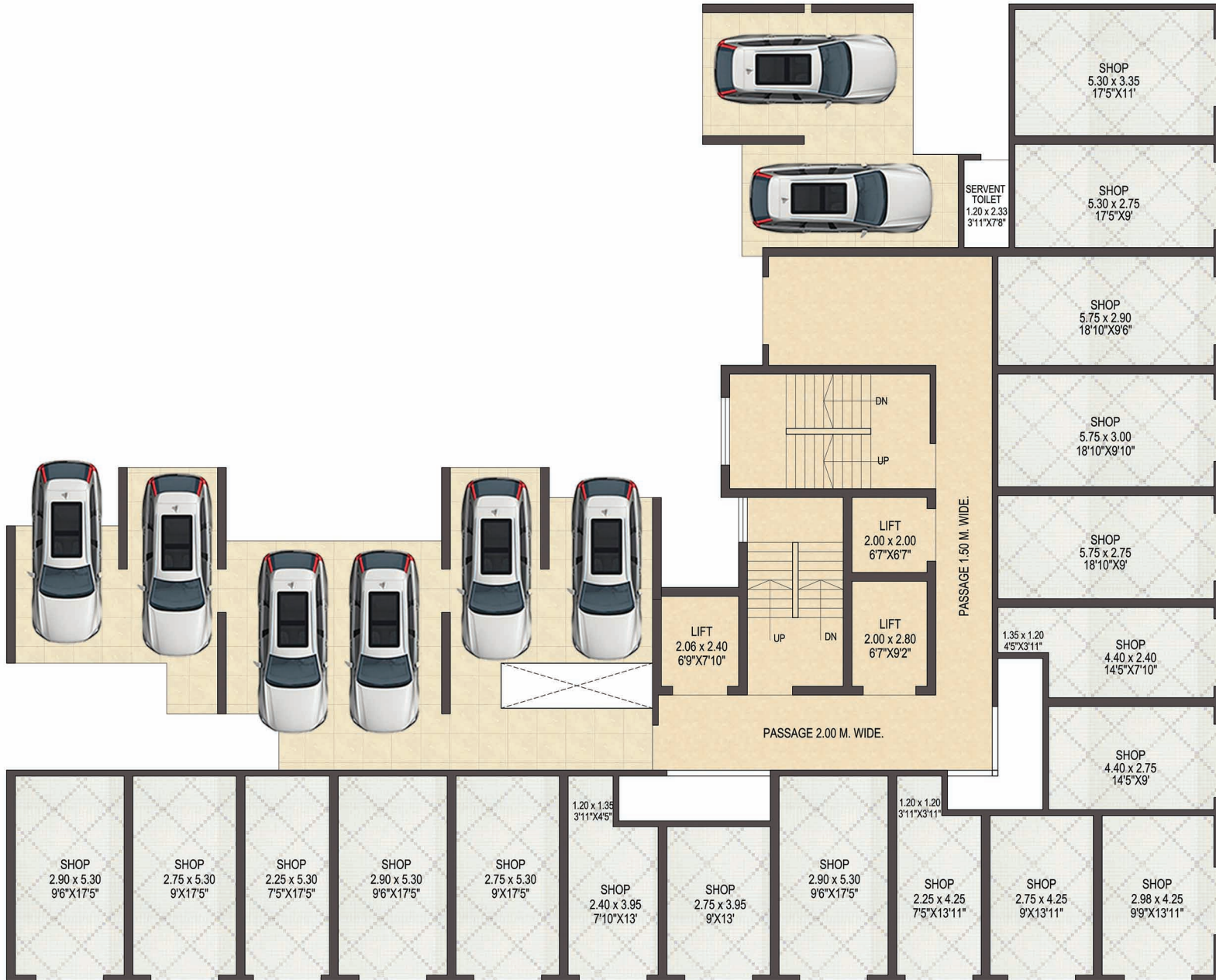

GROUND FLOOR PLAN.





FIRST FLOOR PLAN





SECOND FLOOR PLAN





3RD, 5TH, 7TH, 9TH, 11TH, 13TH, 15TH, 17TH, 19TH, 21TH & 23TH FLOOR PLAN.





4TH, 6TH, 8TH, 10TH, 12TH, 14TH, 16TH, 18TH, 20TH & 22ND FLOOR PLAN.





1 BHK
Isometric View



2 BHK
Isometric View

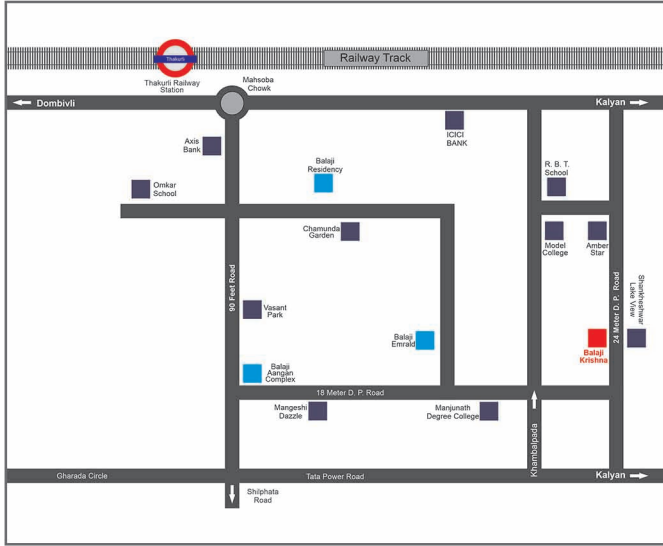

Site – Sales Office Address :

Balaji Krishna,
S. No.: 29, Hissa No. 5,
Behind Model College,
Khambalpada,
Thakurli (E) 421201

MahaRera Regd. No.
P51700026423

Available at website:
<https://maharera.mahaonline.gov.in>



Office Address:

Shop no. 5,6,7. Padmavati building ,
Balaji Emerald, Behind Balaji Aangan Complex,
Thakurli (E) 421201

Office Contact No.
0251 2971937 / 47 / 57

Sales Contact No.
+91 7738720565

Website:
www.sslifespaces.in

Architects
Sthaptya Nirman

RCC Consultant
Shanti Consultant

Legal Consultant
Ray Legal

Disclaimer : The plans, specifications, images, and other details herein are only indicative and subject to the approval of the concerned authorities. The developer / owner reserves the right to change any or all of these in the interest of the development. Without prior notice or obligation. Artist' s impression is used to illustrate the amenities, specification, images, and other details and these may be applicable to select apartments only. Tolerance of +/- 3% is possible in the unit areas on account of design and constructions variances. All brand stated are subject to final decision of project architect. This printed material does not constitute an offer and / or contract of any type between the developer / owner and the recipient. Any purchaser / lessee of this development shall be governed by the terms and conditions of the agreement for sale / lease entered between the parties, and no details mentioned in this printed material shall in any way govern such transactions.