

*Come home
to a spa holiday
every evening.*





Actual Photograph

*From EKTA World the makers of
Lake Homes, Powai.*



Lake Riviera is not just another luxury project;
it is an idea in superlative living brought to life
by the makers of Lake Homes – Powai.

Lake Homes is a landmark project spread
over 2.2 million sq. ft. and home to 2000+ families,
that has redefined the idea of lakeside living.

And now with Lake Riviera, luxury living
will have a new benchmark.



*Enrobed in mist and dew of dawn
a sprig afresh each day, reborn*



Image used for representational purposes only



Artist's Impression



*Stay nestled in
unbridled luxury.*



Lake Riviera isn't just a project of lavish residences but a way of life that is relaxed, unhurried and enveloped by scenic views. The tastefully furnished residences here come equipped with the most contemporary features and lifestyle amenities. While the surrounding environs of the development will bring one close to nature, the comfort and luxury of the residences along with the Spa will teleport you to an oasis of calm.

*Residences designed to
reflect your personality.
And complement it.*







Image used for representational purpose only

JEAN-CLAUDE
BIGUINE
PARIS
SALON & SPA

*Erase the wrinkles
from your mind.*



Introducing
The Jean-Claude Biguine Spa.

The hallmark of Lake Riviera lies in its promise of an immersive spa experience. The fully functional International Spa operated by Jean-Claude Biguine within the property will soothe your senses, calm your nerves and leave you feeling replenished after a tiring day. Escape the din of city life and pamper yourself with the finest therapies.





Image used for representational purpose only



Image used for representational purpose only

*Not just a landmark address,
but a destination poised for appreciation.*



Lake Riviera at Powai is an address with the finest neighbourhood. Over the years, Powai has evolved from being a lakeside recreation destination to one of the most developed upscale neighbourhoods of the city.

With salubrious climate, vibrant social life and excellent infrastructure, Powai is a great locality to find appreciable value in. Its cosmopolitan vibe and easy access to South Mumbai as well as eastern and western suburbs, makes it an attractive investment opportunity.

Actual Aerial view from the site





Image used for representational purposes only.

Powai - In and Around



Leading banks such as ICICI Bank, Kotak Mahindra Bank, Axis Bank, SBI, HSBC and HDFC Bank.



Premier educational Institutions like IIT Bombay, Podar International School, Bombay Scottish School, and ICFAI Business School are in its immediate neighbourhood.



Luxury hotels such as Renaissance Hotel, and Ramada Powai.



Mega stores like D Mart and Haiko Supermarket.



Corporate offices such as Deloitte, CRISIL and Bayer.





Artist's Impression

Comforts Inside

AUTOMATED HOMES

- Control lighting and fans in the entire home using an integrated digital panel

ELECTRICAL

- Concealed conduit with PVC insulated copper wiring - Sufficient power outlets and light points provided

TV, TELEPHONE & INTERNET BROADBAND POINTS

- Provision of cable TV & telephone points in living room and bedrooms
- Provision for internet connection

AIR CONDITIONING

- Split A/C in living room & each bedroom

KITCHEN

- Modular kitchen with accessories
- Electric light points along with premium light fixtures and fan
- Digital marble tile flooring
- Ceramic tiles on the wall
- Water purifier
- Stainless steel sink

WASHROOM

- Combination of designer tiles and digital marble tile flooring
- Premium sanitary ware
- Elegant fittings & diverter for hot and cold water mixing unit
- Separate shower section with toughened glass partition
- Large capacity boiler
- Exhaust fan
- Electric light points along with premium light fixtures

LIVING & BEDROOM

- Digital marble tile flooring
- Electric light points along with premium light fixtures
- Gypsum on all walls and false ceiling in all rooms
- Emulsion painting in the entire apartment

DOORS

- Wooden flush doors
- Premium hardware fittings

WINDOWS

- Heavy section aluminium windows



*Bright red blossoms
in radiant hue,
go forth in bursts
and bloom, anew.*

indespinch



Artist's Impression



Artist's Impression



Image used for representational purpose only

Homes that comes with immersive experiences.



Jean-Claude Biguine spa



Zen garden



Clubhouse



Outdoor gym



Swimming pool and kid's pool



Squash court



Gymnasium



Outdoor chess garden



Lawn Tennis / Badminton Court



Jacuzzi



Lawn



Meditation lawn



Children's play area



Acupressure pathway



Landscaping & tree planting





*Detach yourself from the city.
Stay connected to it.*



Positioned in the centrally located suburb of Powai, Lake Riviera residents can have the best of all worlds when it comes to connectivity. It's an address with the finest access, equidistant to all pockets of Mumbai.



Swift connectivity to the prime suburbs of Mumbai via Jogeshwari Vikhroli Link Road (JVLR) and LBS (Lal Bahadur Shastri) Marg. The Eastern Express Highway (EEH), which connects the eastern suburbs, passes close to Powai.



Kanjurmarg and Vikhroli railway stations at a distance of 4.0 kms and 5.0 kms respectively. Metro stations of Marol, Saki Naka just a few kilometres away.



The International Airport is about 6.0 kms away.





LOCATION MAP



CONNECTIVITY

- Sakinaka Metro Station - 3.0 kms
- Eastern Expressway - 6.2 kms
- Western Expressway - 7.3 kms
- Central Avenue - 1.2 kms
- JVLR - 2.2 kms
- Kanjurmarg - 3.3 kms



AIRPORTS

- Domestic - 8.0 kms
- International - 6.0 kms



CORPORATES

- Crisil - 1.2 kms
- Nomura - 1.8 kms
- Deloitte - 1.4 kms
- Boomerang - 1.6 kms
- BKC - 8.9 kms
- MIDC - 5.9 kms
- Seepz - 4.6 kms
- NESCO - 8.9 kms



SHOPPING/ENTERTAINMENT

- Haiko - 1.2 kms
- Galleria - 1.2 kms
- D Mart - 1.1 kms
- R City Mall - 4.2 kms
- Hakone - 1.6 kms



EDUCATIONAL INSTITUTIONS

- IIT Bombay - 2.7 kms
- NITIE - 4.0 kms
- Hiranandani Foundation School - 0.7 kms
- S.M. Shetty - 0.3 kms
- Bombay Scottish - 1.8 kms
- Nahar International School - 1.7 kms
- Pawar Public School - 0.8 kms



HEALTH

- Dr. L. H. Hiranandani Hospital - 2.0 kms



HOTELS

- Meluha the Fern - 1.2 kms
- Renaissance by Marriott - 4.0 kms
- Rodas - 1.2 kms

Disclaimer: All distances are approximate.

MASTER LAYOUT PLAN



LAYOUT PLAN - AMENITIES DECK



- 1) Stage
- 2) Yoga & Meditation Area
- 3) Senior Citizen's Area
- 4) Acupressure Pathway
- 5) Children's Play Area
- 6) Lawn
- 7) Kid's Pool
- 8) Jacuzzi
- 9) Wooden Deck With Sun Beds
- 10) Swimming Pool With Glass Edge
- 11) Gymnasium
- 12) Squash Court
- 13) Indoor Games
- 14) Dressed Stone Wall With Gargoyle Water Body
- 15) Entry To Club Aqua
- 16) Wooden Pergolas
- 17) Lawn Tennis / Badminton Court
- 18) Main Entry / Exit
- 19) 1.5 M. Wide Jogging Track
- 20) Outdoor Gymnasium
- 21) Outdoor Chess Board
- 22) Zen Garden
- 23) Sculpture
- 24) Main Entrance To E-Deck



FLOOR PLANS

TYPICAL FLOOR PLAN - A WING

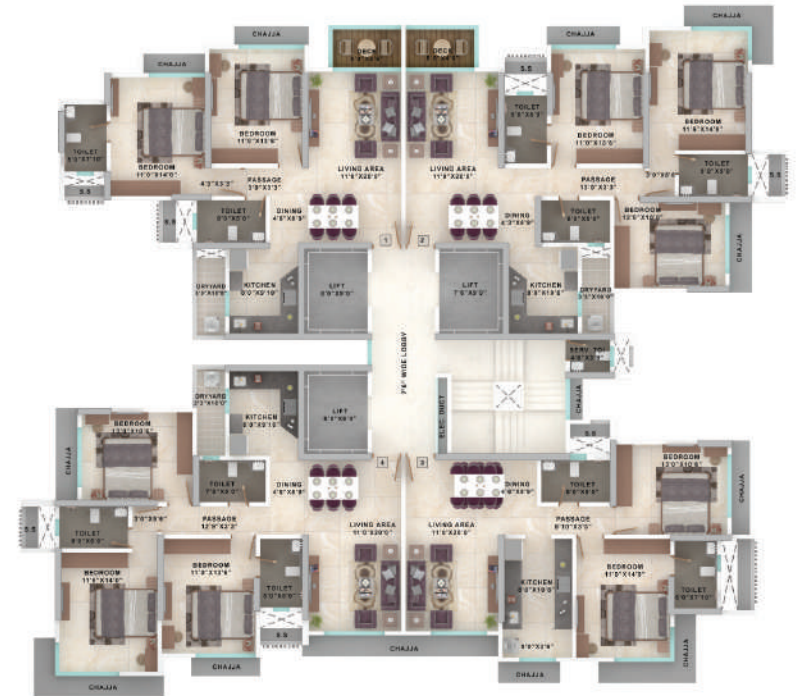

TYPICAL FLOOR PLAN - B WING

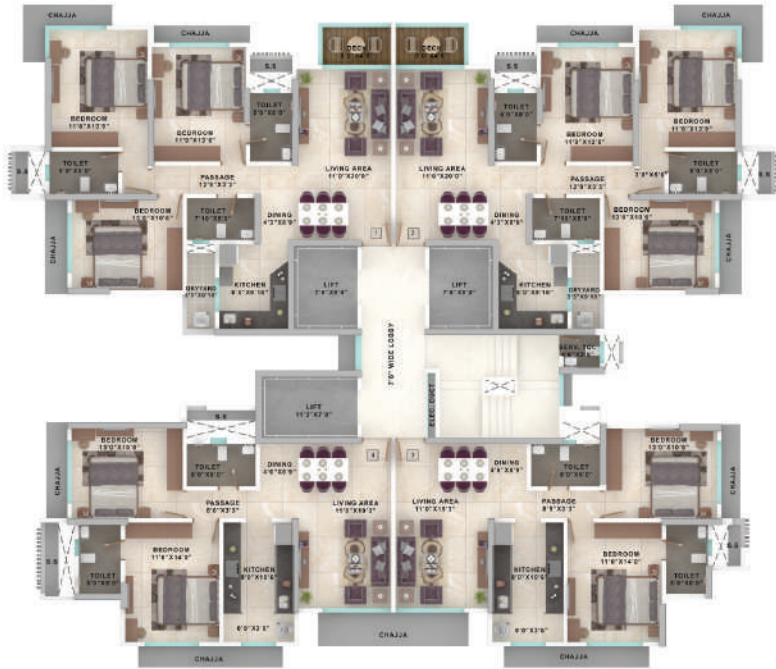

TYPICAL FLOOR PLAN - C WING

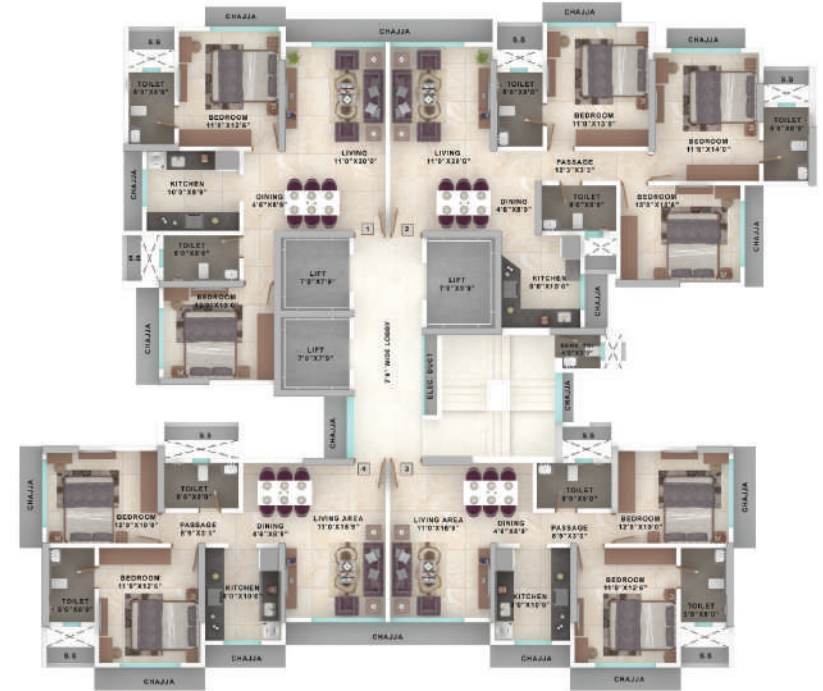

2 BHK GRANDE: A & B Wing



2 BHK GRANDE: A Wing



3 BHK GRANDE: A Wing



3 BHK GRANDE: A & B Wing



2 BHK GRACIA: C Wing



3 BHK GRACIA: C Wing



2 BHK GRACIA: C Wing



2 BHK GRACIA: C Wing



*EKTA World -
Modern approach.
Rooted values.*



Towering structures can be built in the span of a few years. Building a towering reputation however, takes a whole lot longer. At EKTA World, we have persevered for three decades to stay synonymous with values of quality, trust, innovation and commitment for home buyers across Mumbai, Pune and Nashik. At the foundation of our success lies our steadfast drive to deliver value in a way that's better than the times, better than the world.

*Pashmina Developers -
Delivering delight
since a decade.*



Founded in the year 2007, Pashmina Developers is a new generation real estate developer with entrepreneurial values and strong corporate governance that has created a niche in the Indian real estate sector.

With specialization in offering luxurious lifestyle solutions across Mumbai & Bangalore, it is the Group's vision to 'delight all stakeholders with creativity, compassion, integrity and conscience, consistently'.

Team Credits



DESIGN ARCHITECT

Reza Kabul

LIASONING ARCHITECT

Aakar Architects and Consultants

STRUCTURAL CONSULTANTS

J + W Consultants

LANDSCAPE ARCHITECTS

Vikas Bhosekar

CREATIVE PARTNERS

Young

Percept

LAKE RIVIERA

~ The Spa Life ~

POWAI

SITE OFFICE: Lake Riviera, Adjacent to Lake Homes, Near S. M. Shetty School, Powai, Mumbai - 400076.



CORPORATE OFFICE: EKTA World, 401, Hallmark Business Plaza, Off Western Express Highway, Near Bandra Kurla Complex, Kalanagar, Bandra (East), Mumbai 400 051.
T: 022 6115 2424 E: info@ektaworld.com W: lakeriviera.com



PASHMINA REALTY PRIVATE LIMITED
CORPORATE OFFICE: 3rd Floor, Bengal Chemical Building, 502, Veer Savarkar Marg, Prabhadevi, Mumbai – 400 025.
T: 022 66166700



Maha RERA Registration No.: Wing A & B - P51800009353
Wing C - P51800018480
<https://maharera.mahaonline.gov.in>

SMS Lake to 57575