

MITHUNA



White Bells





About Us

We, Mithuna Constructions Pvt. Ltd., registered with the Registrar of Companies under the provisions of the Companies Act, is an association of like-minded people who share their expertise and dedication to deliver quality homes. Together, we come with an experience of 20 years in the field of construction.

Over the years, we have built up a solid reputation for consistently delivering quality work, on time and within the budget allocation. A very high percentage of repeat business across the board from satisfied customers is testimony of our all-round quality performance. We plan, anticipate and adapt to the situation on site to adhere to schedules. We treat our customers with respect and honour our commitments.



“With kids, you begin all over again and so there is something more to life again.”

Hit the play area with your children and let them have a fun time on the swings, sand boxes, slides and more. There is something for each one. The sandpit for toddlers has been designed to keep the little ones busy, with what they love do to most! The seamless blending of the children's play area.



Master Plan



Legend

- 1. Entry
- 2. Exit
- 3. Block-A
- 4. Block-B
- 5. Driveway
- 6. Children's Play Area
- 7. Sand pit for totlot
- 8. Party Lawn
- 9. Amphitheatre
- 10. Pedestrian Pathway
- 11. Tennis court
- 12. Basket Ball Court
- 13. Swimming pool
- 14. Elder exercise space with tree court
- 15. Club House (Gym/ Multipurpose Hall & Etc.)

BLOCK - A

TYPICAL FLOOR PLAN
3- Bedroom Unit

SUPER BUILT-UP AREA
1290.00 Sq.ft

CARPET AREA
921.15 Sq.ft

UNIT NUMBERS
001, 101, 201, 301
002, 102, 202, 302

KEY PLAN

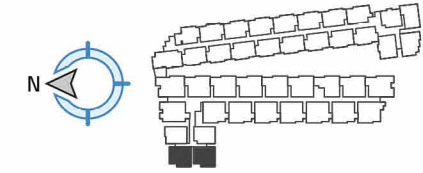

- 1. BED ROOM : 11'2" x 10'0"
- 2. BED ROOM : 11'2" x 10'0"
- 3. BED ROOM : 11'6" x 10'0"
- 4. LIVING : 9'10" x 10'4"
- 5. BALCONY : 9'10" x 4'5"
- 6. UTILITY : 4'0" x 9'10"
- 7. DINING : 13'9" x 8'0"
- 8. FOYER : 4'7" x 7'3"
- 9. TOILET : 7'7" x 5'0"
- 10. TOILET : 7'7" x 5'0"
- 11. KITCHEN : 12'4" x 7'3"
- 12. BALCONY : 11'4" x 4'5"

BLOCK - A

TYPICAL FLOOR PLAN
2- Bedroom Unit

SUPER BUILT-UP AREA
1112.00 Sq.ft

CARPET AREA
777.05 Sq.ft

UNIT NUMBERS
003, 103, 203, 303

KEY PLAN

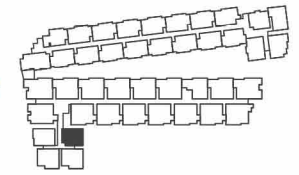
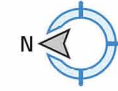

- 1. BED ROOM : 10'0" x 13'0"
- 2. BED ROOM : 13'3" x 10'6"
- 3. LIVING : 13'3" x 12'0"
- 4. BALCONY : 7'9" x 4'5"
- 5. UTILITY : 4'0" x 9'0"
- 6. DINING : 8'4" x 10'0"
- 7. TOILET : 5'1" x 7'7"
- 8. TOILET : 7'7" x 5'0"
- 9. KITCHEN : 9'2" x 9'2"

BLOCK - A

TYPICAL FLOOR PLAN
2- Bedroom Unit

SUPER BUILT-UP AREA
1148.00 Sq.ft

CARPET AREA
805.97 Sq.ft

UNIT NUMBERS
004, 104, 204, 304

KEY PLAN

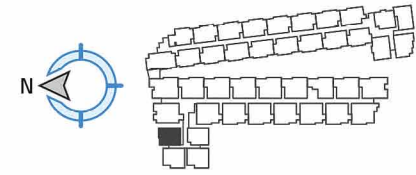

- 1. BED ROOM : 9'10" x 10'6"
- 2. BED ROOM : 12'0" x 10'6"
- 3. BALCONY : 4'5" x 14'3"
- 4. UTILITY : 4'0" x 9'0"
- 5. LIVING / DINING : 14'5" x 14'5"
- 6. TOILET : 8'4" x 5'0"
- 7. TOILET : 4'0" x 7'0"
- 8. KITCHEN : 9'10" x 9'2"
- 9. FOYER : 4'0" x 10'0"

BLOCK - A

TYPICAL FLOOR PLAN 3- Bedroom Unit

SUPER BUILT-UP AREA
1537.00 Sq.ft

CARPET AREA
1128.81 Sq.ft

UNIT NUMBERS
005, 105, 205, 305

1. BED ROOM : 11'0" x 11'6"
2. BED ROOM : 11'2" x 11'6"
3. BED ROOM : 11'2" x 12'6"
4. LIVING : 11'4" x 11'10"
5. BALCONY : 11'2" x 4'5"
6. UTILITY : 4'0" x 7'10"
7. DINING : 11'10" x 13'3"
8. TOILET : 7'3" x 5'0"
9. TOILET : 7'5" x 5'0"
10. TOILET : 6'9" x 7'9"
11. KITCHEN : 10'10" x 12'6"
12. BALCONY : 4'5" x 11'6"



BLOCK - A

TYPICAL FLOOR PLAN
3- Bedroom Unit

SUPER BUILT-UP AREA
1452.00 Sq.ft

CARPET AREA
1071.79 Sq.ft

UNIT NUMBERS

006, 106, 206, 306
007, 107, 207, 307
008, 108, 208, 308
009, 109, 209, 309
010, 110, 210, 310
011, 111, 211, 311

KEY PLAN

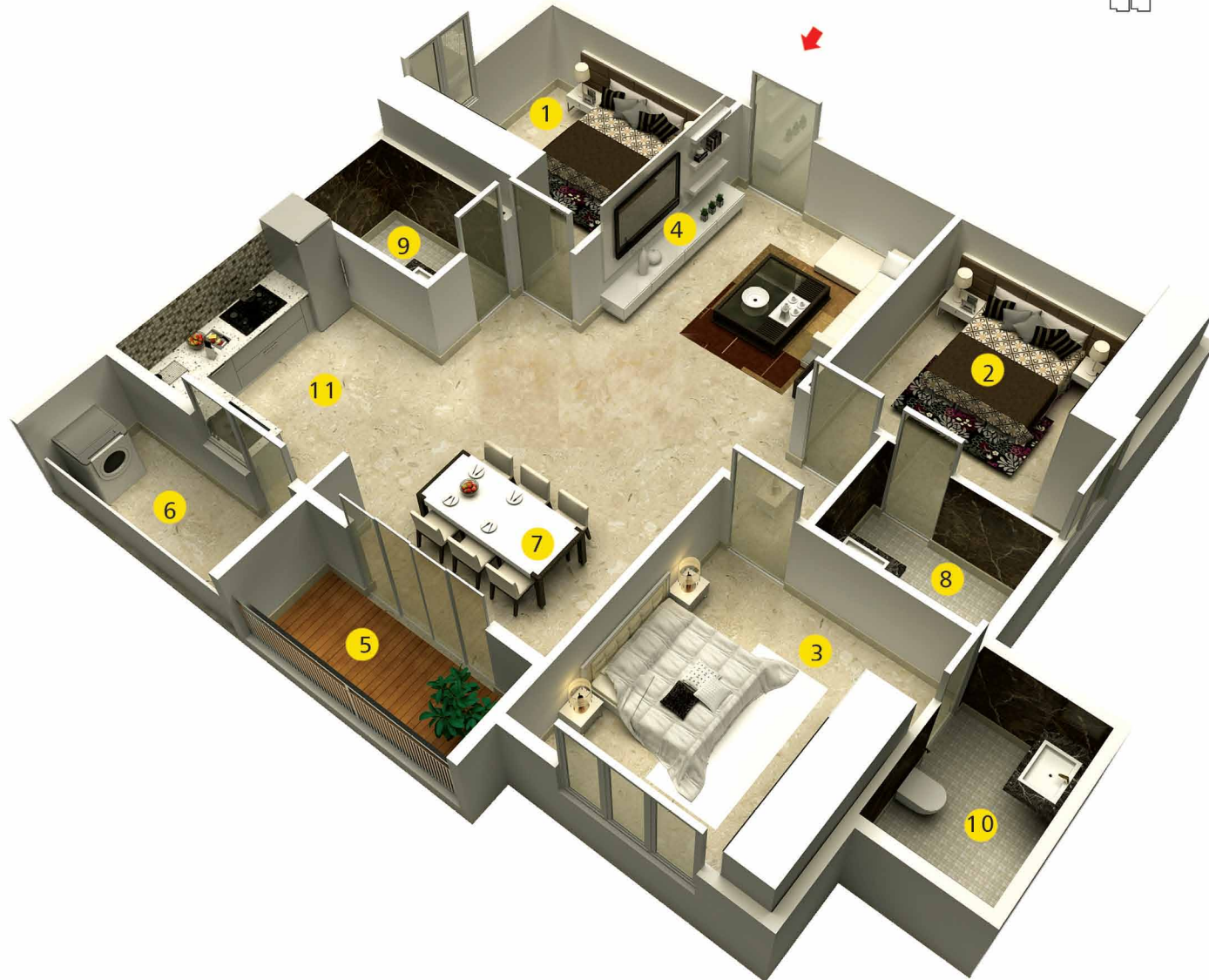
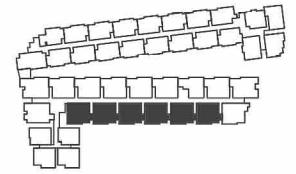
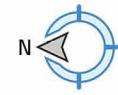

- 1. BED ROOM : 11'0" x 11'6"
- 2. BED ROOM : 11'2" x 11'6"
- 3. BED ROOM : 11'2" x 12'6"
- 4. LIVING : 11'4" x 11'10"
- 5. BALCONY : 11'2" x 4'5"
- 6. UTILITY : 10'10"x 4'0"
- 7. DINING : 11'10"x 15'3"
- 8. TOILET : 7'3" x 5'0"
- 9. TOILET : 7'5" x 5'0"
- 10. TOILET : 5'1" x 7'10"
- 11. KITCHEN : 10'10" x 10'0"

BLOCK - A

TYPICAL FLOOR PLAN
3- Bedroom Unit

SUPER BUILT-UP AREA
1481.00 Sq.ft

CARPET AREA
1092.86 Sq.ft

UNIT NUMBERS

014, 114, 214, 314
016, 116, 216, 316
017, 117, 217, 317
018, 118, 218, 318
019, 119, 219, 319
020, 120, 220, 320

- 1. BED ROOM : 11'2" x 12'0"
- 2. BED ROOM : 11'4" x 12'0"
- 3. BED ROOM : 11'0" x 11'0"
- 4. LIVING : 11'4" x 12'2"
- 5. KITCHEN : 7'9" x 9'8"
- 6. BALCONY : 11'2" x 4'5"
- 7. UTILITY : 10'10"x 4'0"
- 8. DINING : 15'0" x 15'0"
- 9. TOILET : 7'7" x 5'0"
- 10. TOILET : 7'5" x 5'0"
- 11. TOILET : 7'9" x 5'0"

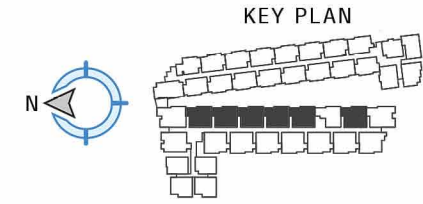

BLOCK - B

TYPICAL FLOOR PLAN

2- Bedroom Unit

SUPER BUILT-UP AREA

1189.00 Sq.ft

CARPET AREA

846.01 Sq.ft

UNIT NUMBERS

035, 135, 235, 335
036, 136, 236, 336
037, 137, 237, 337
038, 138, 238, 338
039, 139, 239, 339
040, 140, 240, 340
041, 141, 241, 341

KEY PLAN

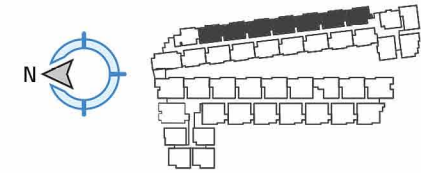

1. BED ROOM : 10'8" x 12'10"
2. BED ROOM : 11'2" x 12'10"
3. LIVING : 15'7" x 9'10"
4. UTILITY : 5'0" x 7'1"
5. KITCHEN : 11'2" x 11'10"
6. DINING : 10'2" x 10'8"
7. TOILET : 5'1" x 7'7"
8. TOILET : 5'0" x 9'10"
9. BALCONY : 9'6" x 4'5"

BLOCK - B

TYPICAL FLOOR PLAN
2- Bedroom Unit

SUPER BUILT-UP AREA
1189.00 Sq.ft

CARPET AREA
846.01 Sq.ft

UNIT NUMBERS

023, 123, 223, 323
024, 124, 224, 324
025, 125, 225, 325
026, 126, 226, 326
027, 127, 227, 327
028, 128, 228, 328
029, 129, 229, 329

- 1. BED ROOM : 11'2" x 12'0"
- 2. BED ROOM : 10'8" x 12'10"
- 3. LIVING : 15'7" x 9'10"
- 4. KITCHEN : 11'2" x 11'10"
- 5. UTILITY : 5'0" x 7'1"
- 6. DINING : 9'10" x 10'8"
- 7. TOILET : 5'0" x 7'7"
- 8. TOILET : 5'0" x 9'10"
- 9. BALCONY : 9'6" x 4'5"

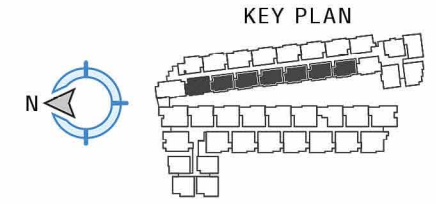

BLOCK - B

TYPICAL FLOOR PLAN 3- Bedroom Unit

SUPER BUILT-UP AREA
1270.00 Sq.ft

CARPET AREA
904.44 Sq.ft

UNIT NUMBERS
032, 132, 232, 332

1. BED ROOM : 10'0" x 11'10"
2. BED ROOM : 10'0" x 11'10"
3. BED ROOM : 9'10" x 11'10"
4. LIVING / DINING : 13'1" x 9'10"
5. KITCHEN : 10'0" x 12'8"
6. FOYER : 10'4" x 4'7"
7. UTILITY : 9'10" x 4'0"
8. BALCONY : 4'5" x 11'10"
9. BALCONY : 4'5" x 9'6"
10. TOILET : 5'0" x 7'7"
11. TOILET : 5'0" x 7'10"

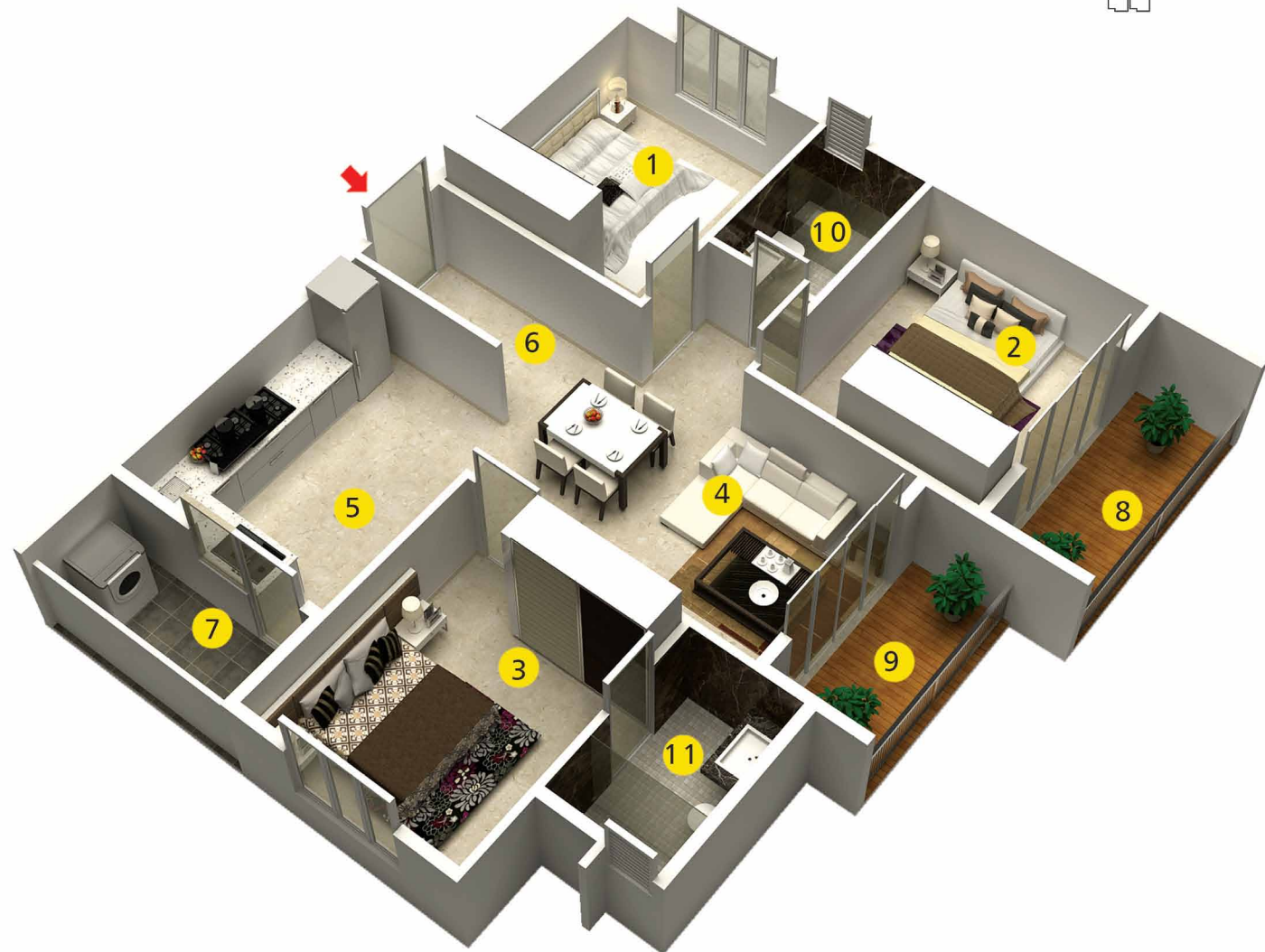
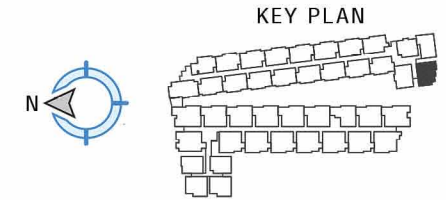



SPECIFICATIONS

BUILDING STRUCTURE

Seismic Zone II compliant (Earthquake) RCC framed structure with 6" block for external walls & 4" block for internal walls.

DOORS AND WINDOWS

Pre-engineered wooden doors & frames with architrave for all the doors | 3 track UPVC sliding doors with mosquito mesh for living, dining & all balconies of Fenesta or equivalent make, 3 track windows with mosquito mesh in other areas | Hardware: Quality hardware for doors and windows.

BATHROOM FITTING

Wash basin

White color wash basins- RAK or equivalent.

Water closet

Wall mounted /Floor mounted water closets RAK or equivalent, Provision for geysers & exhaust fans in toilets.

CP Fittings

Kludi RAK or equivalent, Single lever hot & cold water mixer unit.

FLOORING

Common Areas

Granite or equivalent flooring in lobbies | Staircase – granite or equivalent finish | Granite cladding for lift lobby | Living, Dining, Master bedroom, Family & Bedrooms: Premium quality vitrified tile flooring & skirting.

Kitchen

Premium quality vitrified flooring and skirting | Granite platform with ceramic tile dado above the platform up to 2 feet | Supreme or equivalent stainless steel sink with Kludi RAK or equivalent basin mixer | Provision for water filter and chimney exhaust | Reticulated LPG system.

Utility and Balcony

Superior quality anti-skid ceramic tile flooring and skirting matt finished | Provision for washing machine & dishwasher in utility | M.s railing for balconies.

Bathrooms & Toilets

Premium matt finished ceramic tile flooring, and ceramic dado up to false ceiling.







Major Connectivity

- Embassy Manyata Park
- Metro station
- Bengaluru International Airport
- Karle Township
- Kirloskar Tech Park
- Hebbal
- Lumbini gardens
- Jakkur aerodrome

Malls

- Elements mall
- RMZ mall

Health Care

- Aster Multi Speciality Hospital
- Columbia Asia Hospital
- Baptist Hospital

Educational Institutions

- Vibgyor High
- Dps school
- Jawaharlal Nehru Centre for Advanced Scientific Research
- vidya nikethan
- vidya shilp
- Sindhi High School
- Jain Heritage School
- Mallya Aditi International School
- Kensri School
- National School of Journalism
- Kristu Jayanti College
- Presidency College
- REVA University



Location

MITHUNA 
White Bells

RERA Number : PRM/KA/RERA/1251/309/PR/180728/001956



MITHUNA CONSTRUCTIONS PVT.LTD.

 mithunacons@gmail.com

 [www:mithuna.co](http://www.mithuna.co)

#1342, Skanda Towers, 5th Floor, MCEHS Layout,
Dr. Shivaramkaranthnagar, Jakkur Post, Bangalore- 560 064.



Architects | Structural Engineer
DSK | N.K.Sreenivasulu