

TOUCH THE LIFE
YOU SEEK



Presented by:

EARTHEN
HUES



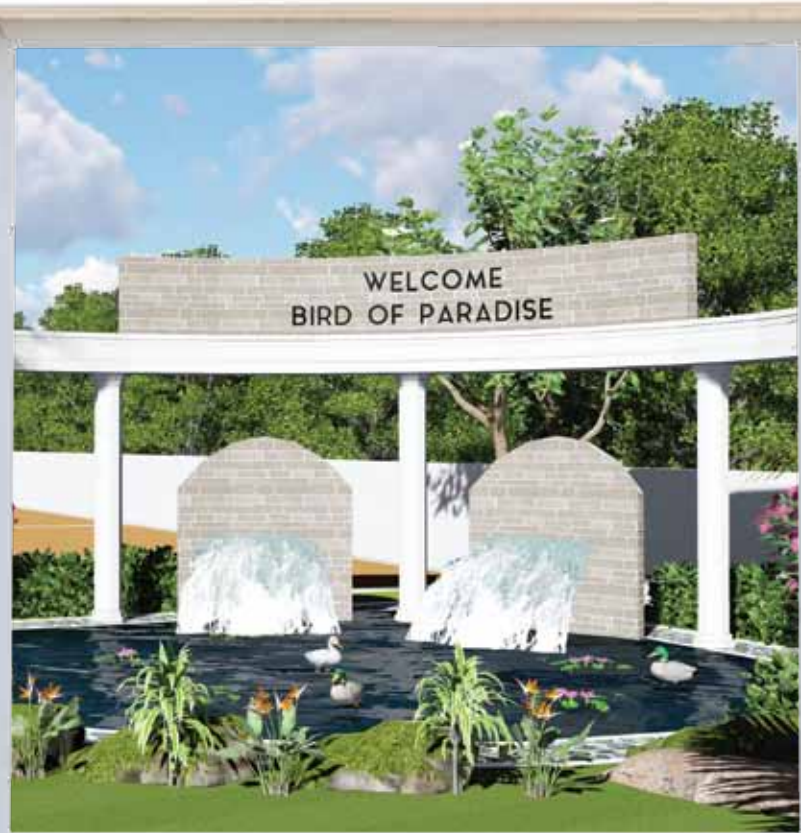

WHEN IT IS ABOUT
BUILDING A HOME,
WHERE COMES BEFORE **HOW**.

Presenting '**Bird of Paradise**', a premium Residential Township in North Bengaluru which is at the threshold of development. High on amenities and convenience, this township is all set to become the most sought after address in Bengaluru. Whether you are looking for making a lifestyle change or an investment of a lifetime, **Bird of Paradise** is the place to be.

THE SOURCE OF INSPIRATION

Meet the minds behind the land of serenity. Earthen Hues.

The team at Earthen Hues comes with a strong background in IT, Telecom and Real Estate, with the founders possessing immense knowledge on what their customers expect while looking to settle into a place that they can call 'home'.

Earthen Hues has always believed in innovative ideas.

Taking ordinary spaces and transforming them into something spectacular. Something that is evident in their other projects.

**EARTHEN
HUES**







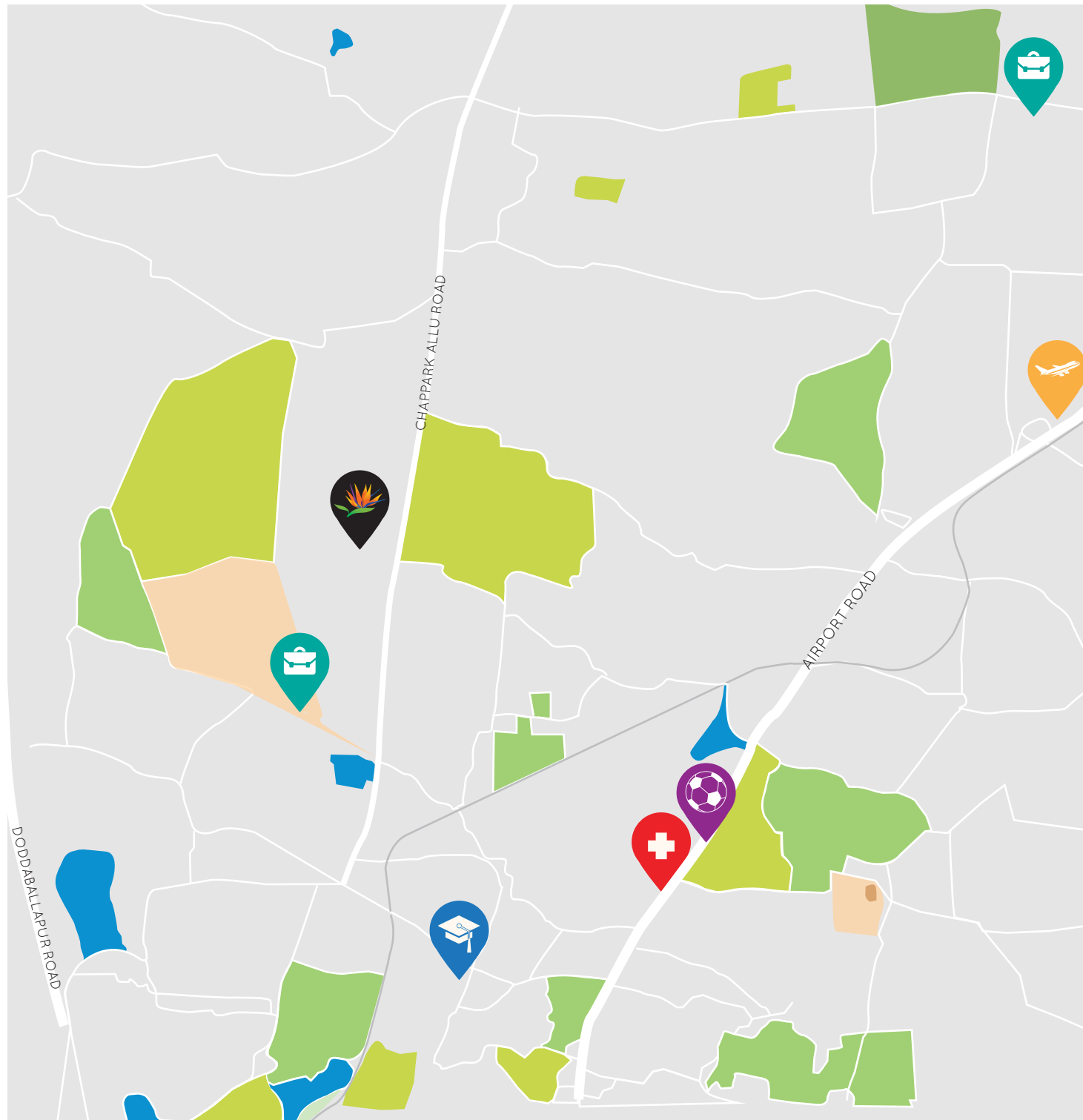

COMFORT & CONVENIENCE WITHIN YOUR REACH



Schools: Ryan International School, Canadian International School, Delhi Public School, Stonehill International School, Vidyashilp Academy, BMS School of Architecture



Colleges: MVIT Engineering College, Reva Institute of Technology, Nagarjuna Institute of Technology



Offices: A host of commercial spaces including Shell, Ecopolis, Brigade Magnum, RMZ Latitude, Aerospace SEZ, IT & Hardware Park by KIADB and many upcoming prestigious projects in the neighbourhood



Hospitals: Army Hospital, Columbia Asia, Aster CMI, Cytecure, Motherhood



Malls: RMZ Mall, Esteem Mall



Hotels & Restaurants: Angsana Spa & Resort, Clarke's Exotica, Olde Bangalore, Hotel Presidency, Oberoi Trident, Club Cabana, Gold Finch Retreat, McDonalds, A2B, Cafe Coffee Day



Sports: Padukone-Dravid Centre for Sports Excellence, Decathlon, Embassy Riding School



Located before the Bengaluru International Airport, it is just a 5 minute drive to the airport



A LOCATION THAT'S WORTH YOUR INVESTMENT

Bird of Paradise is conveniently located just off the NH7 (Bengaluru-Hyderabad Highway), about **4 km** away from the express highway, just **5 minutes** before hitting the airport and a **40-minute** drive from MG Road. Flanked by the best hospitals, schools, malls, hotels, famous upcoming projects and with KIADB industrial area just **8 km** away; **Bird of Paradise** is set to be part of a prime hotspot soon.

An aerial rendering of a residential development. In the foreground, a paved road with white lane markings and numbers '23' and '53' runs horizontally. To the right, a large yellow and white water tower stands on a concrete base. Below the tower is a children's playground with a red rubber mat, swings, and a slide. The area is landscaped with numerous palm trees, other greenery, and a paved walkway. In the background, there are more green spaces, a white gazebo-like structure, and a building with a brown roof. The overall scene is bright and sunny.

FRIENDLY AMENITIES FOR YOUR CONVENIENCE

- Premium gated community with security
- Peripheral compound wall
- Blacktop roads with pavers
- Adequate footpath with 'sensor-controlled' street lights
- Water, power and sewerage connections up to the plot
- Underground cabling
- Well planned sewerage and storm water drains
- Overhead water tank
- Rain water harvesting
- Children's play area
- Sewage treatment plants
- Exquisite landscaped gardens with pleasant sit-outs



ADDING VALUE AN EXTENSION TO OUR BELIEF

Bird of Paradise is not just about earthiness, it's also about how to make your life easier and creating that perfect surrounding for you. Our much researched and executed landscaping includes 4 amazing themed parks:

- Butterfly Park
- Paradise Park
- Aroma Garden
- Yoga Park

With all important amenities to help you kickstart building your new home, you can settle sooner and be part of a luxurious township.



Earthen Hues & Estates Pvt. Ltd.
1, OVH Road, Basavanagudi
Bengaluru - 560 004

E-mail: sales@earthenhues.net
www.earthenhues.net
Tel: +91 76767 63011

Presented by:

**EARTHEN
HUES**

