



**Corporate Address :**  
Ground Floor, Shivashish Indl Premises, Andheri Kurla Road,  
Beside Latia Rubber Factory, Saki Naka, Andheri East, Mumbai - 400 072

**Site Add :**  
Plot No. 64B To 650, Near Aerocity,  
Andheri-Kurla Road, Saki Naka, Andheri East, Mumbai - 400 072.

Email : [infosales.somani72east@gmail.com](mailto:infosales.somani72east@gmail.com) | Tel : 74002 39824

MAHARERA :

**SOMANI**



AT SAKINAKA, ANDHERI EAST



# FEEL THE PRIDE AND LIVE IT

---

Welcome to Somani 72 East at Andheri East,  
owning an address that gives moments  
that make our living worthwhile,  
moments that give us a sense of pride every day and  
becomes a symbol of your proud achievements.

An address that promises you the pride of more

# THE PRIDE OF MORE LUXURY

The luxury of owning a home is in itself, a huge moment of pride.

At Somani 72 East, this pride of luxury rises 10 storeys high,  
making the iconic address in Andheri East.

A single resident tower of ultra-spacious 1, 1.5 & 2 bedroom  
apartment, its altitude is sure to remain unmatched, in the near future.







# THE PRIDE OF MORE SERENITY

---

As living in the city becomes more cluttered and the only thing one sees is tall buildings all around, getting a peaceful neighbourhood dotted with greens, evokes a sense of pride. This pride is seen in the eyes of others, when they come to know about the address and imagine the calm surroundings it offers.



# THE PRIDE OF MORE LIFESTYLE

---

The sense of pride at Somani 72 east, in terms of luxury and serenity, gets a new dimension with the easy access to lifestyle it offers.





# FLOWING & SPACIOUS INTERIOR

---

Somani 72 East is build in sprawling premises to over an envious lifestyle to match your aspiration. Large apartments, sun soaked spaces, shining interiors and thoughtful amenities fill excitement at every moment. Luxury comes with supreme quality & aesthetic refinement in these apartments that treat you to royalty.



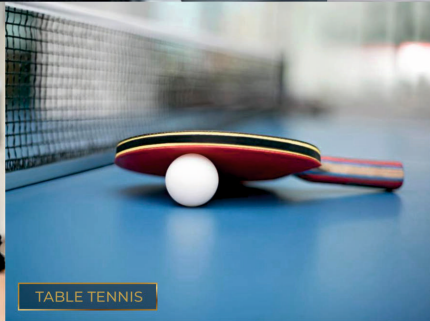

GYMNASIUM

JOGGING TRACK

CHESS

TABLE TENNIS

CARROM

# SPECIFICATIONS



RCC Frame structure as per seismic standard.



Exquisite vitrified / granamite tile flooring in all rooms.



Reputed elevator.



Entrance lobby



Adequate light / power point using modular switches



Colour Anodized aluminum sliding windows



Designer main door.



Designed ceramic tile flooring & Dado up to door height in toilet with latest bath fittings.



Acrylic or equivalent paint on external surface of building



Concealed plumbing with hot and cold water in all toilets and Branded C. P. Fittings



Earthquake resistant structure



Kitchen platform with Granite top & S. S. sink and Ceramic tiles up to door height above kitchen platform



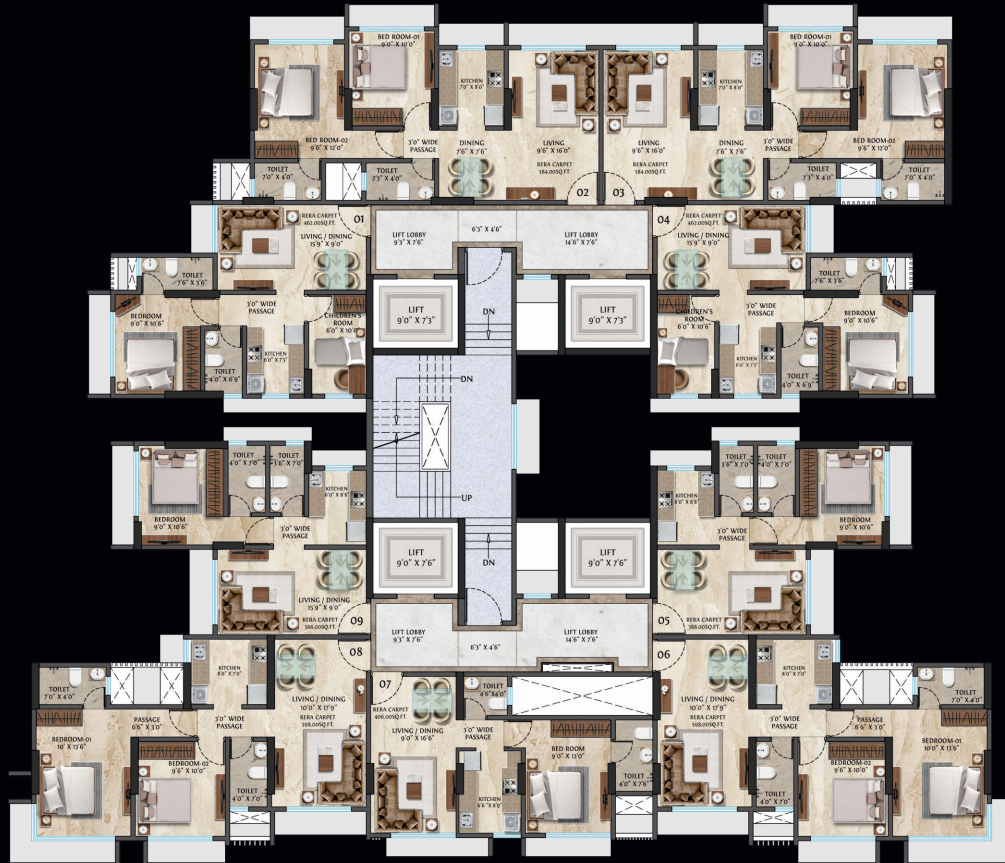

# INSPIRED LIVING

It's all in the name! Somani 72 East is a unique concept where all aspects of decision making, when you pick up a real estate, come to full circle.

Be it the excellence in design, the centrality of location, the sense of details, the luxurious features,

Somani 72 East makes life easy and wonderful. At Somani 72 East we have all these integrated into an overing of fine living.



TYPICAL FLOOR PLAN



**GRAND - 2BHK**

RERA CARPET : 584 Sq. Ft.



**ELITE - 1.5BHK**

RERA CARPET : 462 Sq. Ft.



**APEX - 1BHK**

RERA CARPET : 388 Sq. Ft.

# THE PRIDE OF MORE

The landmarks of the city surround Somani 72 east as if they are trying to impress the residents of Somani 72 east. While Chatrapati Shivaji Airport stand on one side, the heart of the city Marol Naka, Saki Naka, Maxus Cinema, MTNL, Banquet Hall, etc - are easily accessible on the other side.

- |  |  |   |
|--|--|---|
|  AIRPORT : 1 KM         |  THEATER : 0.5 KM |  MTNL : 0.4 KM   |
|  METRO STATION : 0.6 KM |  HOTEL : 0.5 KM   |  MASJID : 0.5 KM |

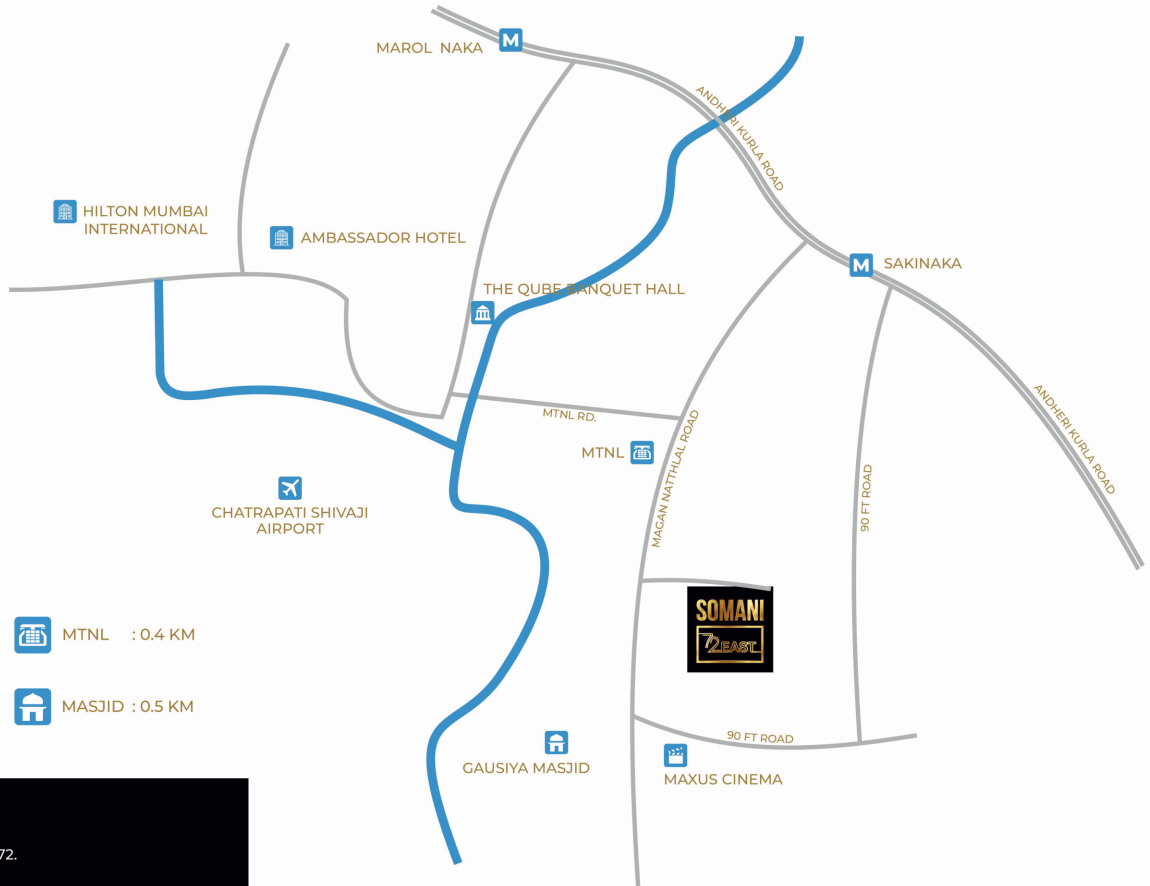

Site Add :  
PLOT NO. 648 TO 650, NEAR AEROCITY,  
ANDHERI-KURLA ROAD, SAKI NAKA, ANDHERI EAST, MUMBAI - 400 072.





# DRIVEN BY DILIGENCE

Masterpieces are built on the expertise of industry leaders.  
Creating a residential landmark requires no less.  
Empowered by the finesse of our best partners,  
meet the maestros behind the coin!

Principal Architect



ARK is a comprehensive global design studio with three decades of proven expertise in project design and delivery ranging from master plans and townships, to industrial, hospitality, commercial, institutional, educational and residential segments.



*Aapka Ghar Aapke Budget mein*

# THE MAKERS OF LUXURY

The city of Mumbai has a rich legacy when it comes to historic landmarks.

Since its inception in 2005, Somani Developers, has taken the lead in providing this new lease of life to residents, giving them a premium makeover. With an extremely transparent & legally sound process, and timely delivery of high-quality homes, Somani Developers has become the most preferred and trusted name in real estate developments.

Mumbai | Pune | Goa | Panvel | Lonavala



**SOMANI**  
**Residency**

Punawale, Mumbai - Pune Highway



**SOMANI**  
**TOWERS**

Punawale, Mumbai - Pune Highway



**SOMANI**  
**PARADISE**

Karade Khurd, Panvel



**Somani's**  
**TRADE CENTER**

TATHAWADE

Tathawade, Mumbai - Pune Highway



**Somani DREAMHOME**  
Pune