



MANMOHAN RESIDENCY

RERA No.: P52100050793



*Artist's Impression

The harmony of bliss is the source of life itself. You see it in the union of nature and soul, in a baby's sweet smile, in a mother's loving eyes and in a father's caring hands.

You experience the bliss of harmony, when your mind, body and soul are in-sync with your home.

Welcome to MANMOHAN RESIDENCY. A home where the bliss of harmony resides. More than that, it is the source of spiritual bliss and a happy community.



MANMOHAN RESIDENCY
By Home Developers & Reality



*Artist's Impression



HANMOHAN
RESIDENCY

*Artist's Impression



*Artist's Impression

Customize two homes to make a spacious 4 BHK home.

Our custom-built homes allow you to customize two 2BHK homes into a spacious 4BHK home. With our unique layout, you're guaranteed to find the perfect home for your family.

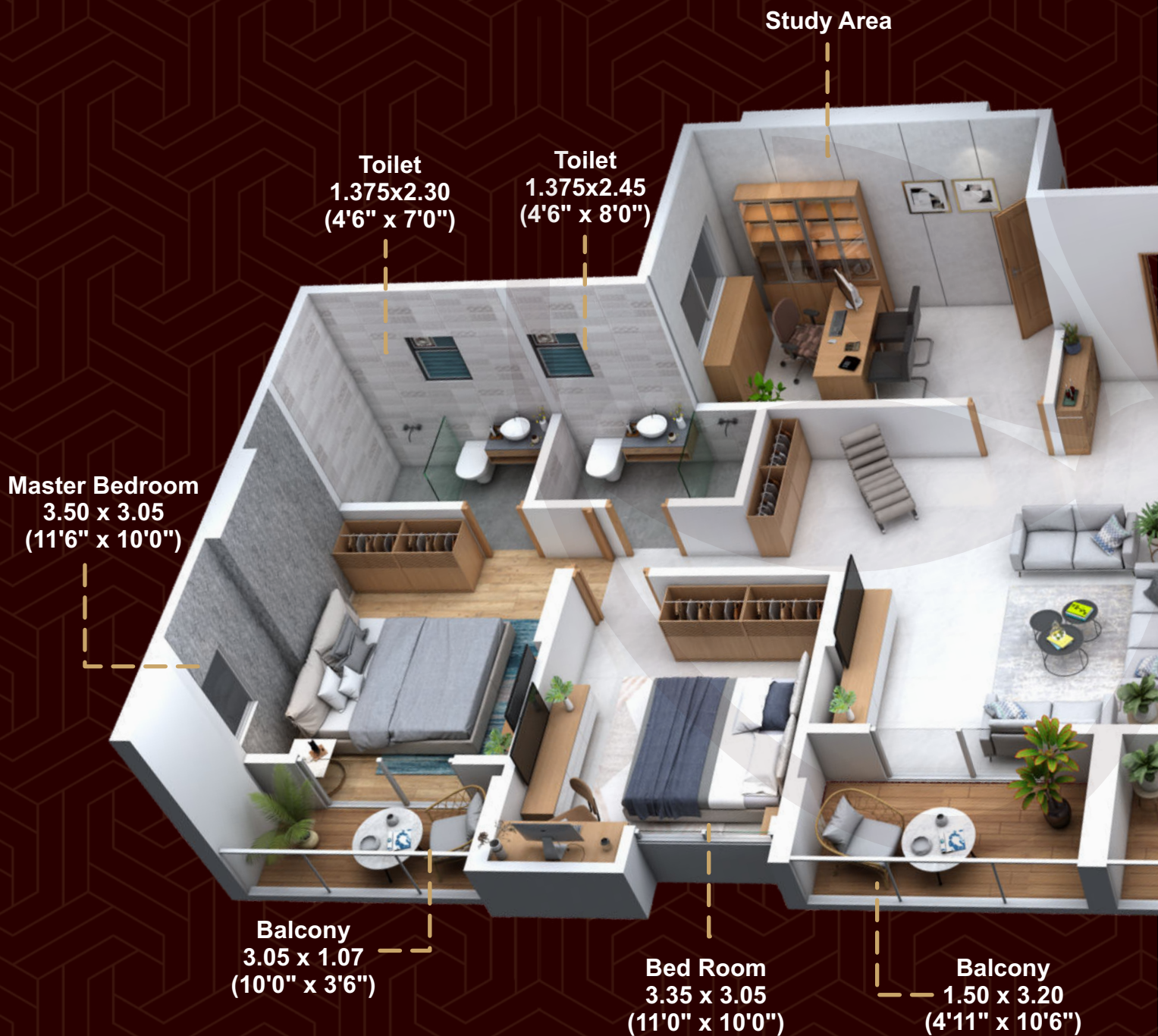

2 BHK HOMES

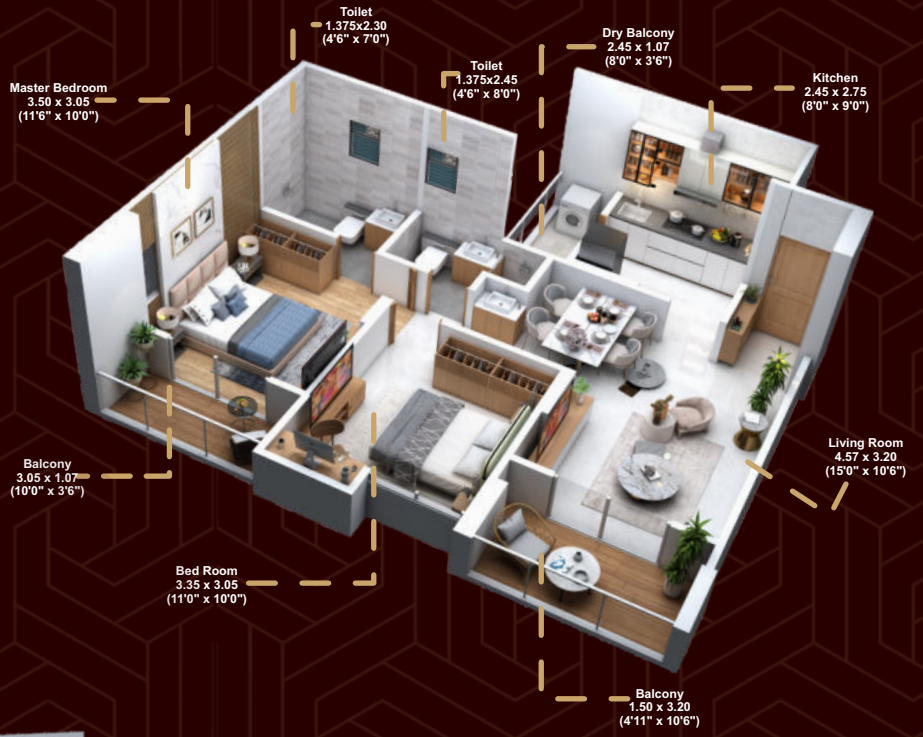

----- KEY FEATURES AND SPECIFICATIONS -----

RCC

- Earthquake Resistance RCC frame structure.

Walls

- 5" thick external wall with double coated sand - Faced Plaster
- 5" thick internal wall with sand and gypsum - Faced Plaster.

Electrical

- Concealed Copper wires
- Fire resistant wires/ cables
- Modular switches
- Earth Leak circuit breaker
- Distribution board with MCB

Doors

- Decorative Main door with Designer Fitting & Lock
- Internal laminated door with molding
- FRP door for bathroom & toilet
- Powder coated galvanized folding door for the terraces in living and bedrooms.

Painting

- Internal Plastic paint
- External Texture Paint

Living & Bedrooms

- TV & telephone / Intercom provision in living room
- Provision for AC
- Glass railing for living and bedroom balcony

Kitchen

- Parellel granite platform
- S.S. sink with drainboard
- Provision of washing machine in dry balcony
- Provision for exhaust fan

Bathroom & Toilet

- Concealed CPVC plumbing
- Hot and cold mixer unit in bathroom
- C.P fittings or jaquar or equivalent
- Sanitary fittings of CERA or equivalent
- Provision for exhaust fan in each bathroom
- Provision for Boiler/Geyser

Tiles

- 600mm x 1200mm vitrified floor tiles for living , bedroom & kitchen.
- Anti-skid floor tiles for bathrooms and balconies.
- Ceramic/glazed tiles up to lintel level for kitchen & bathroom

Windows

- 3 track powder coated aluminum sliding window with mosquito mesh and safety grill
- Granite sills for windows
- Powder coated aluminium windows for bathrooms and toilets
- Powder coated aluminium ventilators in bathrooms and toilets

----- SPECIAL AMENITIES -----



**3200 sqft of Club House With Multipurpose Hall
Gymnasium & Gaming Room At Terrace**



**3700 sqft of Area Landscaped With
Terrace Garden And Walkway**

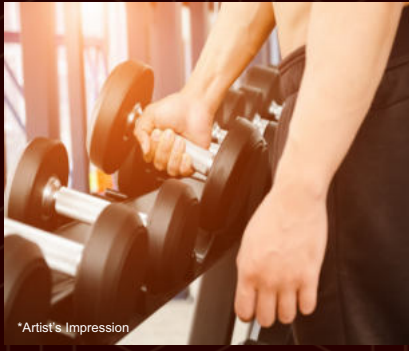

**CCTV Camera In Parking & All Common Areas
Inverter Provision For Each Flat**



**Intercom Security Facility For Each Flat
Video Door Phone**



**3 Lifts For The Building With ARD System,
Backup For Lift & Common Area**



Fire Fighting System

Rain Water Harvesting

Solar Water Heating System

Name Plates & Letter Box For Each Flat

4 Wheeler Parking With EV Charging Point

THE BLISS OF A COSY HOME



*Artist's Impression



NEAR BY LOCATED

SCHOOLS

- Aaryans World School - 1km
- Euro-kids pre school - 1 km
- PGKM School - 1.4 kms

COLLEGES

- VIIT College - 0.75kms
- Bharati Vidhyapeet College - 3.5 kms

GROCERIES

- Every day essentials - 100mtrs
- D-Mart - 1.7kms
- Market Yard - 4kms

RESTAURANTS:

- Gokul Hotel - 450mtrs
- Cream Corner - 500mtrs
- Kanha Hotel - 650mtrs

BANKS

- HDFC - 0.7kms
- State Bank of India - 3.4kms

HOSPITALS

- Bharti Vidhyapeet Hospital - 3.5 kms
- Ruby Hall Clinic - 6.4kms

TEMPLES

- Shatrunjay Jain Temple - 850mtrs
- Iskcon Temple - 1kms

CONNECTIVITY

- Mumbai - Bangalore Highway - 2kms
- Railway Station - 10kms
- Pune Airport - 17kms



*Artist's Impression



NEXT LEVEL CONVINIENCE

Manmohan Residency is located near Gangadham-Shatrunjay road, one of the most well-known areas of Pune. With its close proximity to all your living needs it is the perfect place for you to settle and call it home. With premium location and a convenient lifestyle, this project will surely be a sweet home for you.

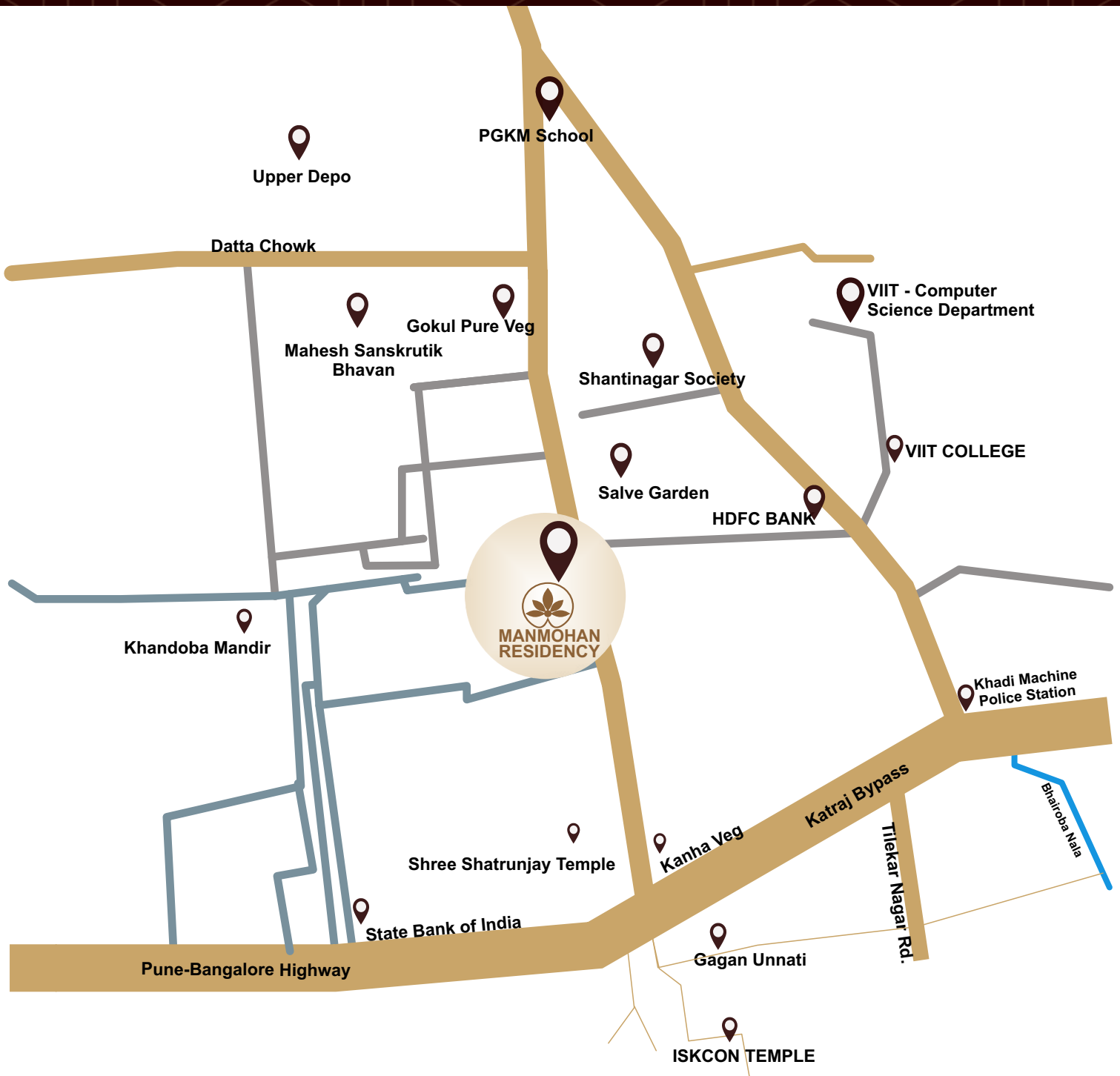



MANMOHAN RESIDENCY

Site Address: Survey No. 59, Near Shantinagar Society, Kondhwa Bk, Pune-411048.

	 RERA No.: P52100050793	Strategic Partner:	 TRISTAR REALTORS
--	----------------------------	--------------------	----------------------

Disclaimer: "Manmohan Residency" a real estate project is developed by The said real estate project has been registered on the MAHA RERA website and details of the same are available on the link <http://maharera.mahaonline.gov.in/> under registered project having MAHARERA registered. Allottee/s are requested to visit the said link for details and update themselves with all the necessary details in respect of the project from time to time. Specifications and amenities mentioned in this brochure are only representational and informative. Information, images, visuals, drawings plans or sketches shown in this brochure is/are indicative in nature. All dimensions mentioned in the drawings may vary/differ due to construction variances and site conditions. Actual product/development and any other aspect may differ from what is portrayed in the brochure. All layouts, plans, specifications, dimensions, designs, measurements and locations are indicative and not to scale and are subject to change as may be requested by the competent authority and regulatory authority. The pictures of the proposed Residential Flat and all furniture items, electronic goods, accessories, etc. specified therein are only for the purpose of showcasing the interior layout of the residential flat and the developer is not liable to provide the same as displayed in the pictures. All intending allottee/s are bound to inspect and apprise themselves of all plans and approvals and other relevant information prior to making any booking and/or purchase decisions and nothing in the brochure is intended to substitute the actual plans and approvals obtained from time to time. Map is not meant to be scaled or measured. The common layout will be developed and delivered as per the timelines disclosed on the MAHA RERA website provided all required approvals are received to the same from the appropriate approving authorities within the said timeline. The relationship between the developer and the actual allottee/s will be governed strictly by the agreements to be executed from time to time and not on the terms of the brochure. This brochure is merely conceptual and the developer reserves the right to change, amend and modify the contents of this brochure from time to time. It cannot be treated as part of the booking and/or final purchase agreement/s that may be executed from time to time. The brochure and its content shall not be construed as any offer/promise/commitment of any nature in respect of the project and the project's offerings.