

హిం సాయిరాం

హిం శ్రీ మాత్రయోనమః

AN ELEGANT
LIFESTYLE
IN THE LAP OF
NATURE



ANANTHALAKSHMI
GREENS

— LIFESTYLE VILLAS —

@ Edupugallu

Chairman Message

When I ventured into the business of real estate and constructions over 27 years ago, I had only one dream – to provide quality residential and commercial units that are utilitarian, purposeful and that stand the test of time.

Sri Sessa Sai Constructions and Projects has been striving to keep up the high standards of constructions, making use of the changes and developments that take place from time to time.

Thousands of satisfied customers are our brand ambassador and is our endeavor to continue to exceed their expectation. The latest venture from the group **"Ananthalakshmi Greens"** Luxury Lifestyle Villas at Edupugallu, Vijayawada, is designed to be your own world, where you can have the best of facilities yet be close to nature.



Green Homes





Saleable Area: 1639 Sft

Site Area: 167 Sq. Yds

Ground floor plan

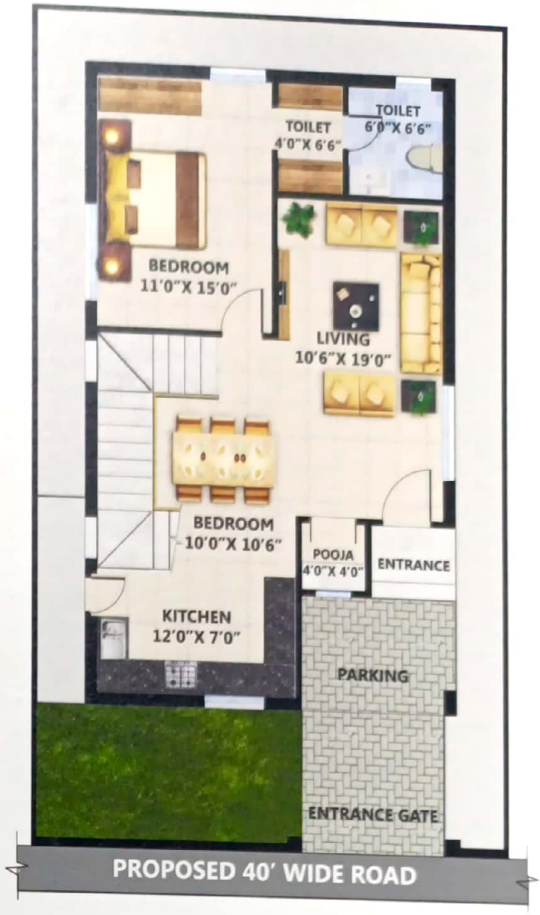

Ground floor Area: 894 Sft

Area : 1639 Sft

First floor plan



First floor Area: 745 Sft

Area : 1639 Sft



West facing

Salea

Site



Ground floor plan

Saleable Area: 1759 Sft

Site Area: 167 Sq. Yds



Ground floor
Area: 879 Sft

PROPOSED 40' WIDE ROAD

Area : 1759 Sft

First floor plan



First floor
Area: 880 Sft

Area : 1759 Sft







Club House

WELL EQUIPPED GYM / LUXURY ROOMS
MINI SUPER MARKET / MULTIPURPOSE HALL
MINI FUNCTION HALL / GAMES ROOM

Paying homage to your lifestyle, the clubhouse at "**Ananthalakshmi Greens**" is truly a flagship addition. A marvel of architectural excellence, it had spared no effort to make it the best it can be. Here sophistication and elegance complement world-class leisure and recreation, highlighting the art of Luxury living in different modes.







To ensure this, provision for solar fencing has been made around the gated community. The project is designed to use the nature friendly, green energy by installing solar panels to draw green solar energy.

Highlight of the Project

As a part of being close to nature and healthy living, Roof Top Gardens/Vertical Gardens are the first of its kind in Vijayawada, thus providing a green canopy to the entire venture.



Hi-lights

SOLAR FENCING / SOLAR GREEN ENERGY
ROOF TOP GARDENS
VERTICAL GARDENS



"Ananthalakshmi Greens", the Luxury Lifestyle Villas at, Edupugallu, Vijayawada, is a gated community. The safety and security of the resident is of prime important.



Specifications

STRUCTURE



RCC framed structure with RCC slabs and beams system

Super Structure:

External walls in brick masonry, 9" thick using solid fly ash blocks/light weight bricks/ AAC blocks. Internal walls in brick masonry 4½" thick using solid fly ash blocks/light weight bricks/ AAC blocks.

Wall Finishes:

Internal walls: Double coat plastering, exposed surfaces shall be finished with two coats of roller applied plastic emulsion of Asian paints of equivalent made over smoothly prepared surface with putty.

External Walls: Weather proof paint in smooth or textured finish of Asian paints or equivalent make.

Water Proofing:

Water proofing in all toilets, other wet areas.



JOINERY



Frames:

Main door: Frame in solid teak wood with architraves finished with melamine polish
Internal door: Frames TATA Pravesh or equivalent make.

Shutters:

Main door: Medium Teak wood shutter with melamine polish.
Bedroom doors: TATA Pravesh or equivalent make solid colour or wood finished look and feel.
Toilets and utility door: TATA Pravesh or equivalent make.

Hardware: Door hinges and tower bolts in SS/ Brass SS coated of door set or equivalent make.

RAILINGS:

External and internal railings in mild steel with spray enamel paint.



FLOORING AND SKIRTING



Foyer, drawing, living and dining:
Vitrified tiles 2'x2' RAK or equivalent.

Master Bedroom:

Engineered wood flooring.
Other bedrooms, Kitchen, Home theater and Office room: 2'x2' full body vitrified tiles of RAK/SIMPOLO or Equivalent make.

Sit-outs:

2'x1' anti skid full body vitrified tiles of RAK/SIMPOLO or equivalent make/natural stone.

Toilets and Utility:

1'x1' anti skid full body full body vitrified tiles of RAK/SIMPOLO or equivalent make.

Parking areas: RAK or SIMPOLO equivalent parking tiles.

Dado:

Toilets:

Dado up to 8' (lintel height) in glazed ceramic tiles of RAK/SIMPOLO or equivalent make.
Kitchen: Dado up to 2' in quartz or equivalent.

Counter Tops:

Toilet washbasins: In 15/18 mm thick quartz or black granite slabs.



BATH & SANITARY FIXTURES:

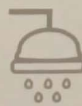

Plumbing:

Washbasins: Bedroom toilet washbasins of Jaquar or Cera or equivalent of counter below/above type.

EWC: Wall mounted EWC of Jaquar/Cera or equivalent with concealed flush tank, health faucet and angle stop clocks.

CP Fixtures/ Faucets:

Basin mixers: Jaquar/Cera basin mixer for hot and cold water and angle stop cocks.

Shower: Concealed single lever divert or for hot and cold water, overhead shower and spout of Jaquar/Cera or equivalent.



KITCHEN AND UTILITY



Counter in 18 mm thick polished black granite slab.

Kitchen Bowls:

Kitchen: Single bowl with drain board of size 40"x20" of FRANKE make or equivalent with table mounted sink cock with swinging spout, angle stop clocks below counter.

Utility:

Single bowl without drain board of size 20"x20" of FRANKE make or equivalent with table mounted sink cock, angle stop clocks below counter. Necessary plumbing provision shall be made for washing machine.

Geyser:

Provision for geyser in all toilets and utility.

ELECTRICAL FIXTURES & LIGHT POINTS



One light point for every 70 sft of BUA for each unit. Two way light points one in each bedroom.

Cables: Light points one in each bedroom.

Fan points: One point each in drawing/living, all bedrooms, dining, kitchen.

Exhaust Fan: Points in all toilets.

Foot lamps: In all bedrooms.

Bell: One call bell point with buzzer outlet in drawing room.

Power Sockets: Amps: 2 nos. of 5 Amps in each bedroom, 1 no. 5 Amp in each toilet, 2 each in dining and drawing, 1 each in sit-outs, 3 nos. in kitchen (for cock top, chimney and RO Unit)

15 Amps: 1 in each toilet for geysers, 6 nos. for refrigerator, washing machine, oven and other kitchen appliances in kitchen and utility.

20 Amps: Split type AC points in all bedrooms, dining/ living and drawing rooms TV cable outlets: conduit for TV Cable in living room/drawing and master bedroom.

Telephone :

Points in master bedroom and drawing room

Internet:

Cable conduit provision in living room

Earthing:

Multi strand copper wire for earthing by means of loop system
Separate earthing for transformer, DG set and lighting protection.

Distribution Boards:

With ELCBS and MCBS of MDS Legrand/ABB/ Havells or equivalent make.

Switches:

MDS mosaic/Legrand/Schinder/Panasonic or equivalent make.

Cables:

Concealed copper wiring of Polycab/Fenolex or equivalent.

SERVICES



Water Supply: water supply shall be by means of OHT/ time related pump up system from the central tank.

Supply of water shall be from borewell. Supply from bore well shall be treated as a requirement.

Septic Tank:

Centralised sewerage septic tank.







Drainage:

Internal and external drainage lines in Grade B UPVC of Supreme make or equivalent.

Location Plan (not to scale)

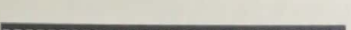

PROXIMITY

- Near by Chaitanya, Narayana Schools & Colleges.
- Very close to Sri Chaitanya NEET Academy and Sri Chaitanya e techno School
- Vijayawada International Airport around  9 kms
- Kamineni Multi Speciality Hospital around  10 kms
- Capital Multi Speciality Hospital around  6 kms
- Edupugallu to Benz Circle around  13 kms
- Vijayawada Bus Stand around  17 kms
- Vijayawada Railway Station around  18 kms



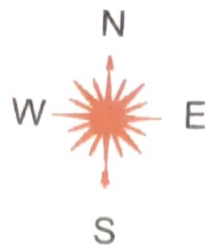

P No	Plot-Sq.Mts	Plot-Sq.Y	P No	Plot-Sq.Mts	Plot-Sq.Y
1	531.73	635.96	36	264.87	316.79
2	517.18	618.56	37	170.38	203.78
3	145.43	173.94	38	139.45	166.79
4	151.57	181.28	39	139.45	166.79
5	123.40	147.59	40	139.45	166.79
6	122.81	146.88	41	139.45	166.79
7	122.23	146.19	42	139.45	166.79
8	121.65	145.50	43	139.45	166.79
9	121.06	144.79	44	139.45	166.79
10	120.48	144.10	45	139.45	166.79
11	119.90	143.40	46	139.45	166.79
12	119.31	142.70	47	139.45	166.79
13	118.73	142.00	48	139.45	166.79
14	118.14	141.30	49	139.45	166.79
15	117.24	140.22	50	139.45	166.79
16	116.17	138.94	51	139.46	166.80
17	115.09	137.65	52	139.46	166.80
18	114.03	136.38	53	139.45	166.79
19	139.46	166.80	54	139.45	166.79
20	139.45	166.79	55	139.45	166.79
21	139.45	166.79	56	139.45	166.79
22	139.45	166.79	57	139.45	166.79
23	139.45	166.79	58	139.45	166.79
24	139.45	166.79	59	139.45	166.79
25	139.45	166.79	60	139.45	166.79
26	139.45	166.79	61	139.45	166.79
27	139.45	166.79	62	139.45	166.79
28	139.45	166.79	63	139.45	166.79
29	139.45	166.79	64	139.45	166.79
30	139.45	166.79	65	139.45	166.79
31	139.45	166.79	66	170.38	203.78
32	139.45	166.79	67	264.87	316.79
33	170.38	203.78	68	153.92	184.09
34	418.80	500.90	Total	10640.6	12726.59
35	153.92	184.09		262.93	262.95