

NISARG

Palms



ARISTOCRATIC living



BLOSSOM WITH **nature**

A royal living is something cherished by many, deserved by a chosen few like you!
Nisarg Palms exceedingly fulfills all your aspirations and bestows upon you a gratifying sense of pride.

NISARG
Palms

Aristocratic Living
2 & 3 BHK LUXURY HOMES

B A V D H A N
P U N E

Grand Entrance Gate



WELCOME TO A
new world of opulence

To multiply the joys of a palatial home, we have meticulously designed premium amenities and value-added features. So that you could have refreshing breaks from your routine life and engage in rejuvenating experiences at your wish.



AN ELEVATED LIFE
AMID A soothing expanse

- Panoramic View
- Excellent Ventilation
- Surrounded by Hills and Nature
- Largest amenity in the area with best conveniences
- Just 1 Km from Chandani Chowk,
it's like living in Kothrud at Half the Cost !
- Great appreciation potential



Actual Site Photograph

AN EMBLEM OF aristocratic living

The impressions of new-age flamboyance have been crafted keeping in mind your innate desires of aristocratic living. As an emblem, a home here will be highly regarded as your signature achievement in life.

- Steam Room
- Sauna & Spa Room
- Swimming Pool & Cabanas



REDEFINE THE
charming experience called luxury

You deserve everything genuine. Even the standard of luxury that prevails in your home is no exception. In your new living suite, redefine the rules & parameters of luxury you have experienced as of yet. Be the game changer. Revolutionize luxury!

THE LAYOUT



Security Cabin Entrance Gate Grand Avenue Road

NISARG
Palms
Aristocratic Living
2 & 3 BHK LUXURY HOMES

BAVDHAN
PUNE

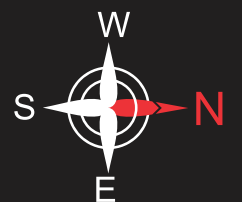

ODD FLOOR PLAN

EVEN FLOOR PLAN

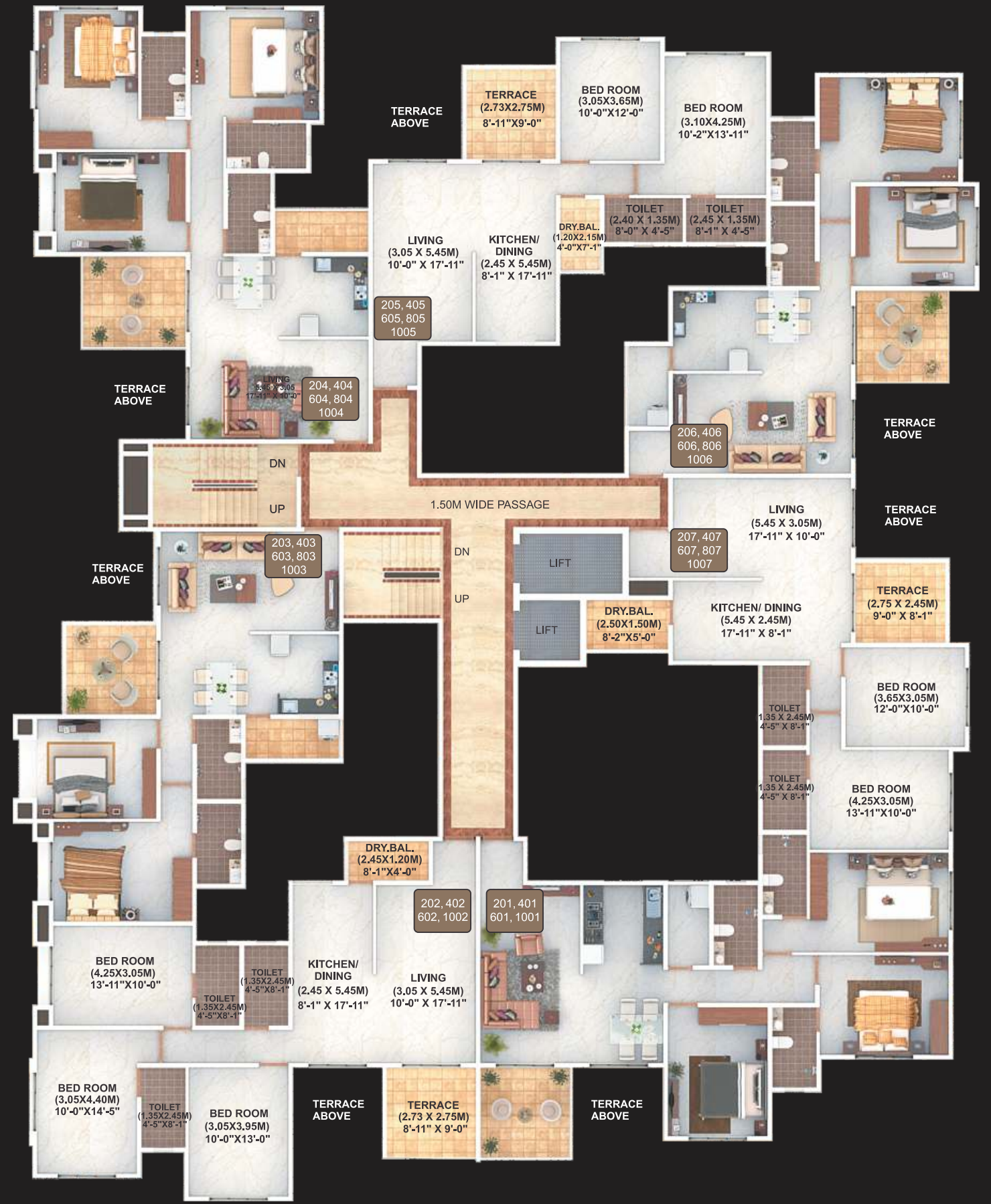
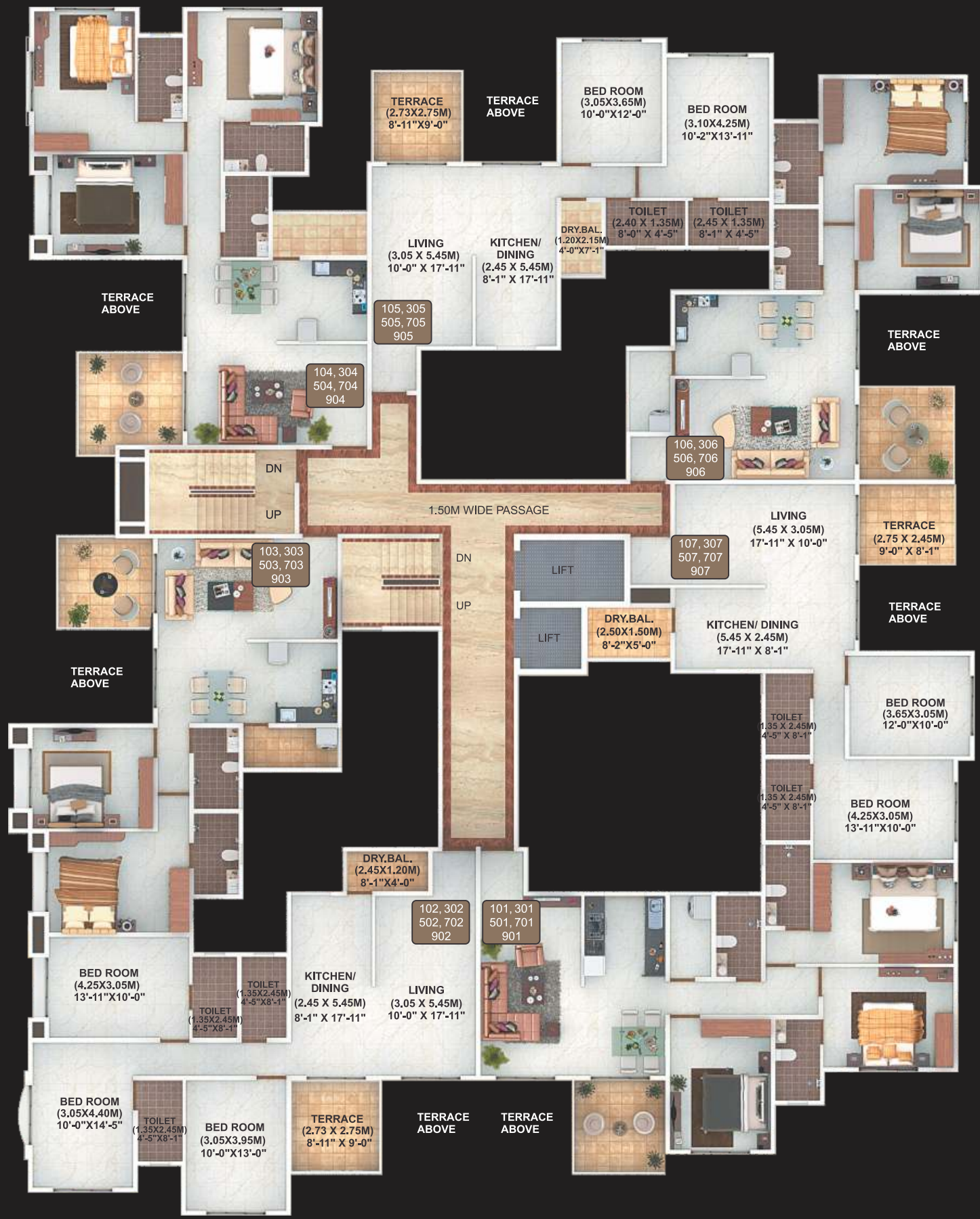

2 BHK

3D VIEW



3 BHK

3D VIEW



Specifications

FLOORING

- Vitrified Tiles in all rooms
- Anti skid Tiles in Toilet & Terrace

KITCHEN

- Modular Kitchen with Chimney & Hob
- Provision for Exhaust Fan & Water Purifier
- Designer wall tiles for full height

DOORS & WINDOWS

- Designer Main door
- Bath door frames in Granite
- Premium quality Door fittings
- Good Quality Aluminium Glass doors for terrace
- SS & Glass Railings for terraces
- Good Quality Aluminium Windows with mosquito mesh & Grills
- Granite sill for windows

PAINTING

- Internal : POP finish walls with OBD
- External : Acrylic Paint

CONVENIENCE

- DG backup for common areas
- Video door phone, Intercom & CC TV
- Solar Water heating system
- Premium Automatic Elevators

ELECTRIFICATION

- Concealed copper wiring
- Inverter for each flat
- AC points in bedrooms
- Provision for Broadband connection
- Premium Modular switches

TOILETS

- Designer wall tiles upto lintel
- Jaquar / Equivalent CP fittings
- Wall hung Commode
- Provision for Exhaust Fan
- Designer counter basin in Master Bathroom
- Concealed Hot & Cold Mixer & Shower
- Glass Partition for shower area



NISARG
Palms
Aristocratic Living
2 & 3 BHK LUXURY HOMES
BAVDHAN

A living paradise WITH A CHARACTER

If looking at the elevation is so captivating, imagine how enchanting living here would be! The architectural marvel is a work of art. The finest aesthetics has been blended with precision craftsmanship. Thus making this wonderful creation a living paradise for the chosen few like you.



Actual Site Photograph

GRAB THE LIFE OF SHEER **abundance**

If you are specific about a few, Nisarg Palms is poised to offer you aplenty! Be it visual delight of the architectural design, astute layout planning or the set of amenities, what blossoms here is a life of sheer abundance.

- Party Lawn
- Amphitheater
- Designer Landscape



Actual Site Photograph



Actual Site Photographs



Amenities

- Banquet Hall
- Table Tennis & Carrom Room
- Gymnasium
- Kids Play Park
- Walkers pathway
- Designer Entrance Lobby
- Concrete Internal Roads
- Senior Citizens park

BELONG TO A
**futuristically
forward society**



THE LOCATION



LOCATION BEYOND COMPARE,
an opportunity so rare...

www.nisargpalms.com



619, Sadashiv Peth, Bajirao Road,
Opp. Bank of Maharashtra, Pune - 411 030
Tel : 020 24490851/2 Fax : 020 24459146
E-mail : homes@adityabuilders.com
www.adityabuilders.com

Site Office

S.No.50(Part), Off Mumbai-Bengaluru
Bypass, Near First Choice Car Showroom,
Bavdhan, Pune - 411021.
E-mail : sales@nisargpalms.com

Mumbai Office

714 Gokhale Road (N), Above ICICI Bank,
Dadar (W), Mumbai - 400 028.
Telefax : 022 2445 0376
E-mail : info@adityabuilders.com



B-14, Mittal Court, Near Lal Deval,
Opp. Ashoka Pavillion, Camp, Pune - 411001.
Tel : 2605 1702/3/4/5 Fax : 2605 1707
E-mail : info@shagundevolvers.com
www.shagundevolvers.com

CREDITS

Planners & Designers
Ethique - Sanjeev Mehta

Project Architect
Dilip G. Kale

Landscaping
Jayant Dharap

RCC
J W Consultants

Brand Consultant
RJ Design Pvt. Ltd.

This brochure is purely conceptual and is designed in good faith to give a fair and general view of the project and is not a legal offering, nor will it be deemed to be part of any agreement. Photographs are not comprehensive or current. Nothing contained in this brochure will take precedence in the final agreement. Number of buildings, areas, flats / units, amenities, specifications, floors, roads, open space, etc. shall be revised at the discretion of the promoters. Promoters reserve the right to amend the layout, plans, elevations, designs, specifications, amenities, areas, etc. without notice. The clubhouse shown in the brochure is not part of the project & same is outside the project and is owned by the promoters. The purchasers shall be allowed to use clubhouse subject to terms & conditions of the clubhouse. 'Future development' may consist of high-rise buildings etc.



