



# SS WHITEWATER

**CORPORATE OFFICE**

77, SS HOUSE, SECTOR-44  
GURUGRAM, HARYANA - 122003

E SALES@SSGROUP-INDIA.COM

W SSGROUP-INDIA.COM

**BUILT ON VALUES**

SECTOR 90, NEW GURUGRAM

HARERA REG. NO. 08 OF 2024  
<https://haryanarera.gov.in>

Statutory Information: License No. 119 of 2023 granted to North Star Towers Pvt. Ltd. & Matrix Buildwell Pvt. Ltd. in collaboration with SS Group Pvt. Ltd. for a commercial project on the land measuring 3.99 Acres at Sector-90, Gurugram, Building Plan approved vide memo no. 32917 dated 04.10.2023 and Zoning Plan approved vide approval DRG No. 9304 dated 06.06.2023. The Project is registered with HARERA Gurugram vide Registration No. 08 of 2024 (<https://haryanarera.gov.in/>). Status of other approvals can be checked in the Promoter's Office.



**USHERING IN  
A NEW AGE OF  
LUXURY SHOPPING**

*Where happiness comes to life...*





Artistic Impression

ONE ADDRESS FOR  
BOUNDLESS POSSIBILITIES

*Welcome to*  
**SS WHITEWATER**

FIRST MALL IN NEW GURUGRAM

# AN IRRESISTIBLE RETAIL OPPORTUNITY

At the epicenter of New Gurugram, a legend unfolds. SS WhiteWater emerges as the radiant destination - a masterpiece that will define the future of this city.

Positioned with precision on a prime, two-sided open approx. 3.99 acres canvas, it's a vision of unrivaled magnificence, a paragon of modern mixed-use development.

Immerse yourself in a retail utopia where exclusive boutiques and multi-level retail shops beckon you. Savor the finest culinary delights and explore entertainment beyond imagination.

SS WhiteWater is destined to metamorphose into the Shopper's Paradise and Investor's Ultimate Dream.





## STYLISH RETAIL

3 Levels Of Shopping, Hypermarket  
& Anchor Stores

## DELECTABLE DINING

1 Level Dedicated To Restaurants,  
Food Court & Cafes



## MOVIES & ENTERTAINMENT

Dedicated floor for Multiplex



SS WhiteWater by SS Group will unquestionably be the brightest star in New Gurugam's ever-expanding horizon. A destination of great vision, innovation and excellence, it will add to the magnificent skyline and further elevate the world-leading metropolis of the future.

### AT A GLANCE



Spread over  
3.99 acres (Approx.)



Two Side Open  
Corner Plot



International  
Facade Design



G+4 Mall



1 Level of  
Food Court,  
Restaurants & Cafes



1 Level of Multiplex  
& Entertainment



3 Level Basement  
Parking



Landscaped Area  
with Cascading  
Water Feature



Largest Frontage  
with Maximum  
Visibility



Double Heights  
Shops



Centrally  
Air-Conditioned



Multiple  
Entry/Exit



# SS WhiteWater



## THE EXPRESSWAY OF LIMITLESS OPPORTUNITIES

SS WhiteWater ensures the world is indeed your oyster. The location ensures you stay connect, networked and in the midst of urban infrastructure. The imminent beacon of growth in the NCR region, poised to become the next major real estate hotspot.

With its strategic location and expansive scope, this corridor presents a remarkable canvas for the future. Boasting of seamless connectivity, top-notch infrastructure, and a thriving economic landscape, it offers unparalleled opportunities for investment, development, and lifestyle enrichment.

 **Situated on 75m wide road**

 **Easy access to NH-8 (now NH 48) & Dwarka Expressway**

 **Bang on Multi Utility Corridor, with direct access to Dwarka Expressway (NPR) & IMT Manesar**

 **Just off the premium townships The Leaf, SS Linden Floors, SS Cendana and SS Strada surrounding residential sectors 83, 84, 85, 86 and 90 in New Gurugram**

*Anchor Stores*

*Lifestyle Brands*

*Premium Apparel Brands*

*Multi-level Showrooms*

*Hypermarket*

*Spa & Salons*

*Gymnasium*



## A CLASS APART SHOPPING EXPERIENCE

Experience a fusion of premium outlets, international brands, and opulent interiors at SS WhiteWater – your go-to retail hub. This commercial epicenter harmoniously combines a vibrant ambience, world-class infrastructure, and tailored services, making it the nucleus of shopping, dining, and leisure.

With dynamic layouts and diverse offerings, it's your ultimate one-stop shopping hub in New Gurugram.



*Fine Dining Restaurant*

*Cafes*

*Food Court*

*Restaurants with Open Terrace*



*Artistic Impression*

## INDULGE YOUR SENSES SAVOR THE MOMENTS

From sunrise to starlight, SS WhiteWater's diverse dining options welcome everyone - urban professionals seeking a quick bite, local families craving memorable dinners or food enthusiasts from across the NCR region.





*4 Screen Multiplex*

*Open-air Restaurants*

*Eateries*



# ENTERTAINMENT, CINEMATIC EXPERIENCE LIKE NEVER BEFORE

Atop SS WhiteWater, a state-of-the-art multiplex awaits, enhancing your visits with unforgettable cinematic adventures. Whether you're a shopper, foodie, or fun-seeker, make SS WhiteWater your go-to destination. Our immersive cinema adds another layer of excitement, making it your preferred weekly retreat.



ATTENTION  
IS IN THE DETAILS



# SITE PLAN



# GROUND FLOOR



# FIRST FLOOR PLAN

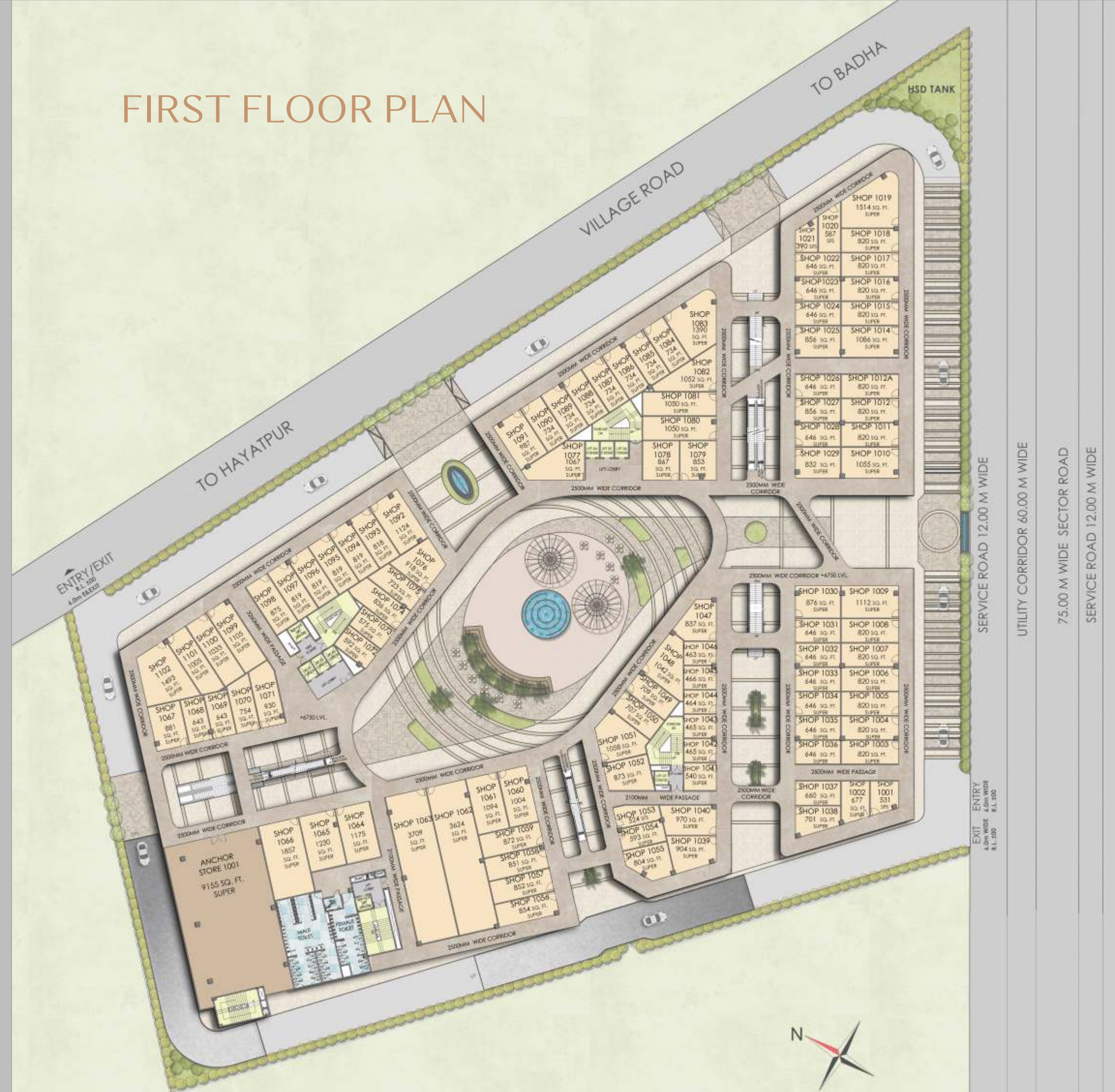

# SECOND FLOOR



# THIRD FLOOR PLAN



# FOURTH FLOOR



# SPECIFICATION

## FLOORING

Lobby / Corridors: Granite / Vitrified Tiles  
Shops: Concrete Flooring

## WALL FINISHING

Shops: Internal 12mm Plaster / Gypsum Plaster  
Lobbies & Corridors: Stone / Tile Cladding & Paint as per Appd. Shade

## DOORS & WINDOWS FRAME MATERIAL TO BE USED FOR FINISHING

Aluminium / UPVC

## GLASS WORKS

8mm/12mm Toughened Glass

## ELECTRICAL FITTINGS

Modular Type

## CONDUCTING AND WIRING DETAILS

Heavy Duty FRLS PVC Conduit shall be used in Slab & Medium Duty FRLS  
PVC Conduit shall be used in Wall.  
MS Conduit shall be used for PA System.

## LIFT DETAILS

Good Quality 07 Nos Passengers Lifts, 02 No Service Lift, 06 No Escalator  
02 No Travelator

## EXTERNAL GLAZING

Toughened Glass

## AIR CONDITIONING

Water Cooled System

## EXTERNAL FINISHING / COLOUR SCHEME

Stone Cladding / Textured Paint





- LOCATION : SECTOR - 47, GURUGRAM
- SITE AREA : 43647 SQ.FT.
- STATUS : COMPLETE



- LOCATION : SECTOR - 86, NEW GURUGRAM
- SITE AREA : 127140 SQ.FT.
- STATUS : COMPLETE



- LOCATION : SECTOR - 86, NEW GURUGRAM
- SITE AREA : 122240.25 SQ.FT.
- STATUS : COMPLETE



- LOCATION : SECTOR - 49, GURUGRAM
- SITE AREA : 56109 SQ.FT.
- STATUS : ONGOING



- LOCATION : SECTOR - 48, GURUGRAM
- SITE AREA : 15246 SQ.FT.
- STATUS : ONGOING



- LOCATION : SECTOR - 84, NEW GURUGRAM
- SITE AREA : 43560 SQ.FT.
- STATUS : ONGOING



Delivered over  
**21 Landmark**  
residential & commercial  
projects

Over  
**17 Million Sq. Ft.**  
Under construction

Armed with  
**Huge Land Bank**  
in Delhi and NCR

Architects by  
**Acclaimed Arcop**  
Montreal

27 million Sq. Ft. of  
**Upcoming Residential**  
& commercial projects

## SS GROUP: *Built on values.*

SS Group is a well-known, trusted and one of the oldest business conglomerates of Delhi NCR, with a strong presence in real estate development.

Established in the year 1992, the Group has over three decades of experience in the development & delivery of unique, innovative, high quality and user friendly residential and commercial projects in the region.

SS Group is committed to developing state-of-the-art real estate masterpieces and maintains an enviable track record. It enjoys a portfolio of happy customers, with the successful delivery of some landmarks in Gurugram, such as The Hibiscus, The Leaf, The Coralwood, The Lilac, SS Plaza, SS Omnia, SS Highpoint, Almeria and Aaron Ville. Many more gems, namely, SS Strada, SS 100 and SS Linden Floors are at different stages of development.