

"360 DEGREES"  
OPEN LIFE

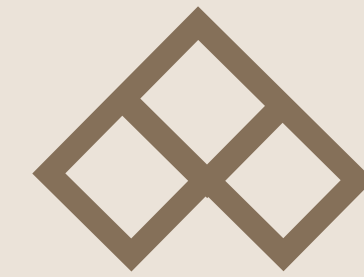

PRATHMESH  
ELITE

C H A N D N I C H O W K  
K O T H R U D



Representational Image



# PRATHMESH ELITE

Fresh and unpolluted air is here to stay. The very location is such a lifelong advantage that it would bestow upon a series of everlasting benefits to you. Cross-ventilation is just one of them. Being a high-rise and that too much above the ground level up on a hillock, Prathmesh Elite attracts cool breeze from all the directions. Making the entire living here so light & lavishly enchanted. So much so that you would always feel up & above the rest.

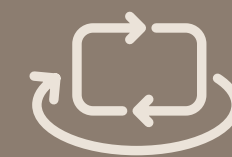

"360 DEGREES"  
BREEZY HOMES



Artistic Impression

## Lofty & Lavish. 2 & 3 Bed Up-Homes!

Prathmesh Elite is here to take plush living to a great new level. The 2 & 3 bed homes have been crafted to fulfill all your long-cherished desires, unleash your hidden fantasies and proffer you a complete contemporary life. This masterpiece is standing tall at a strategic location and has already become a landmark. Own it as your celebrated address. And everyone would look up to you with respect and envy too!



Representational Image



"360 DEGREES"  
SPACIOUSNESS  
ALL AROUND

Space is luxury. Space is a privilege, desired by all but deserved by only a few like you! Here at an open home in Prathamesh Elite, you would experience spaciousness all around you. There would be plenty of space available for all your aspirations. So much so, that roaming around this open home would be an enthralling experience! Every time, it would please you to the core and instill in your mind a feeling of pride of owning this open lifestyle.



PRATHMESH  
ELITE



Artistic Impression

**3D POWER**  
MBE NO. 9372032805  
web-3dpower.in  
info@3dpower.in  
2718-02-AR

## Exclusively for the Upper Crest

At the junction of Kothrud and the highway leading to western corridor of Pune, it is state-of-the-art creation crafted for the elites and evolved. The layout design, the architecture, the space planning and even the amenity development have been perfected keeping in mind the topnotch connoisseurs of affluent living. With high-end luxury, best-in-the-class comfort and utmost privacy to all the rooms, this masterpiece is absolutely ready for the deserving takers. Come, indulge and own. Welcome to an upper crest life...



Representational Image



"360 DEGREES"  
VIEWS OF  
CITY & NATURE

We have actually constructed a watch tower. You can call it a home! And indulge in an unmatched experience of enjoying mesmerizing views. Choose nature and explore the soothing shades of green sheathing the neighboring hillocks. Look beyond to view vistas of sierras encircling the city. Set your eyes on the highway or see the city's skyline growing taller at every direction. The options galore for you to adore...



PRATHMESH  
ELITE

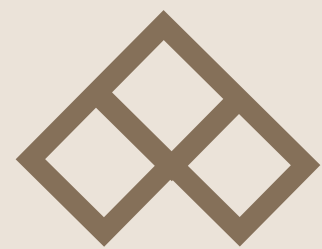

PRATHMESH  
ELITE

Actual Panoramic View From the Top

C H A N D N I C H O W K  
K O T H R U D



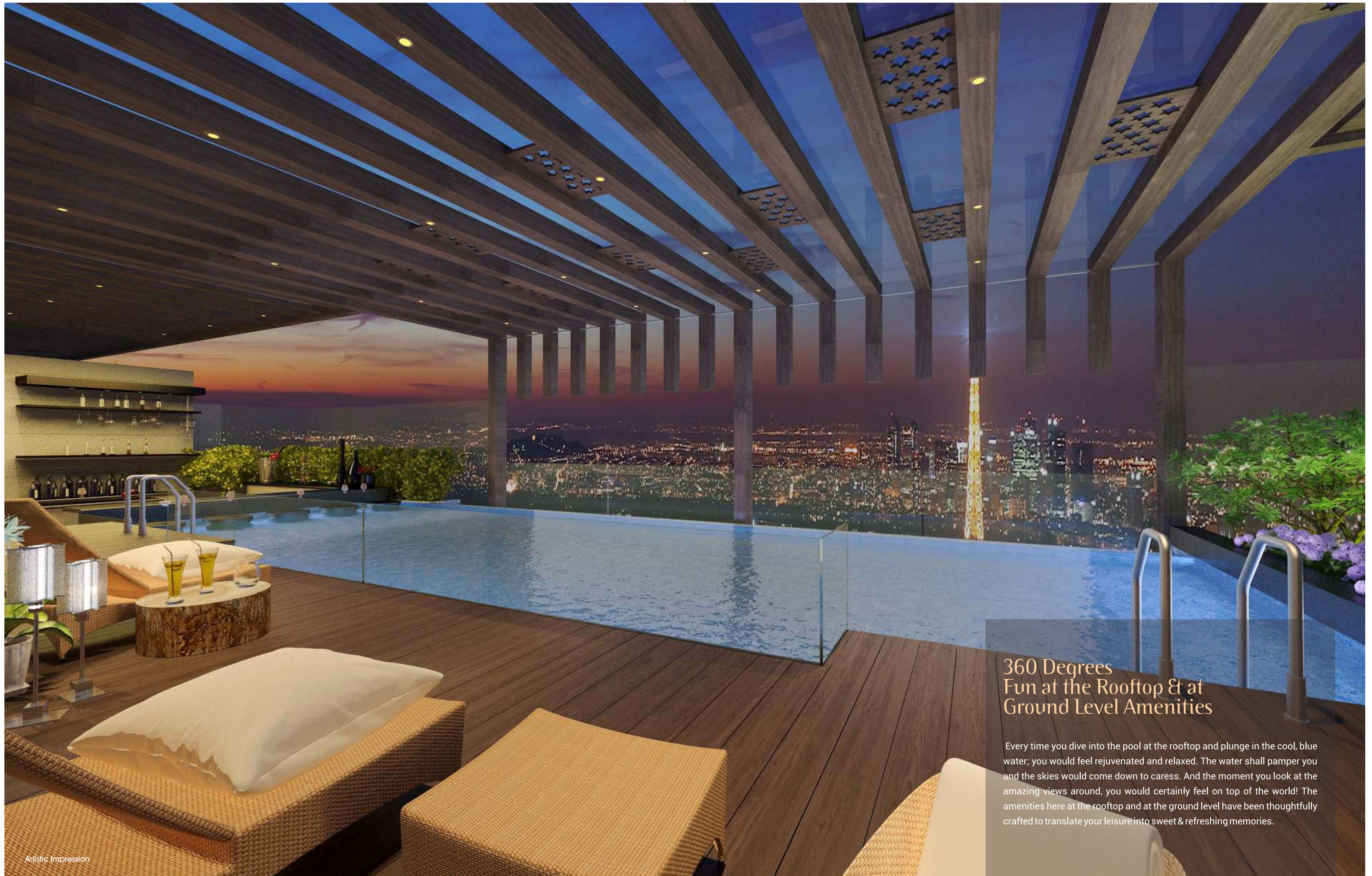

## 360 Degrees Fun at the Rooftop & at Ground Level Amenities

Every time you dive into the pool at the rooftop and plunge in the cool, blue water; you would feel rejuvenated and relaxed. The water shall pamper you and the skies would come down to caress. And the moment you look at the amazing views around, you would certainly feel on top of the world! The amenities here at the rooftop and at the ground level have been thoughtfully crafted to translate your leisure into sweet & refreshing memories.



## A M E N I T I E S

- ✦ Entrance Gate With Electronic Security System
- ✦ Multilevel Car Parking
- ✦ Visitor's Parking
- ✦ Decorative Entrance Lobbies
- ✦ Piped Gas System
- ✦ Panic Switch With Gas Leak Detector
- ✦ CCTV Camera
- ✦ Video Intercom Facility
- ✦ Generator Backup For Common Areas
- ✦ Rain Water Harvesting
- ✦ Sewage Treatment Plant
- ✦ Firefighting System
- ✦ Clubhouse With Gymnasium
- ✦ Meditation And Yoga Areas
- ✦ Roof Top Infinity Pool
- ✦ Roof Top Viewing Deck
- ✦ Kid's Play Area
- ✦ Jogging Track
- ✦ Gazebo
- ✦ Senior Citizen Park With Amphitheatre



Entrance Lobby

## SPECIFICATIONS



### FLOORING AND DADO WORK

- › Vitrified tiles for living, dining, kitchen and bed rooms
- › Ceramic floor tiles for toilet
- › Dado tiles in toilets up to lintel level
- › Dado tiles above cooking platform up to lintel level in kitchen
- › Wooden flooring in master bed room for 3 BHK



### KITCHEN

- › Granite kitchen platform with stainless steel sink



### PAINTING AND FINISHES

- › Gypsum punning and emulsion paint for all internal walls (except terrace/toilet/utility area)



### ELEVATORS

- › High speed automatic elevators



### ELECTRICAL AND PLUMBING

- › Concealed wiring with modular switches
- › Concealed plumbing with C. P. plumbing fixtures
- › Electrical and plumbing provisions for water heater and electrical provisions for exhaust fans in all toilets
- › Electrical and plumbing provisions for water purification and electrical provisions for exhaust fans in kitchen
- › TV points in living room and all bed rooms
- › Telephone points in living room and master bed room
- › AC electrical point in all bed rooms
- › Invertor point in passage



### WINDOWS

- › UPVC sliding windows with MS Safety window grills



### DOORS

- › Ready-made door frame and shutters
- › UPVC sliding shutter with glass for terrace doors

# 2 BHK



# 3 BHK





Artistic Impression

PUNE - BANGALORE ROAD

AMENITY SPACE

A

B

C

TOWARDS KOTHRUD

TOWARDS BAVDHAN

LEGENDS

- 1 AMPHITHEATER
- 2 CHILDREN'S PLAY AREA
- 3 GARDEN
- 4 SIT-OUT
- 5 SPORTS ZONE



PRATHMESH  
ELITE

The Address of 360 Degrees  
OPPORTUNITIES

Overlooking Kothrud and just kissing the bustling Bavdhan, the location of this one-of-its-kind living paradise is ideal in every respect. You would always stay connected to city, commercial hubs of western corridor and to Hinjawadi too! Not only that, you are blessed with easy access to Mumbai and Bengaluru also. All that matters for a fulfilling life including schools, institutes, restaurants, spas, gyms, parks, hospitals...is within a close circle.

## KEY DISTANCES

### AIRPORT AND RAILWAY STATION

Mumbai-Pune Highway 100 Mtrs  
 Mumbai-Bangalore Highway 100 Mtrs  
 Pune Station 10.0 Kms  
 Pune Airport 18.0 Kms  
 Mumbai Airport 153 Kms

### LANDMARKS

City Pride 5.1 Kms  
 University Circle 9.1 Kms  
 Shivaji Nagar / Swargate 9.6 Kms  
 Aundh / Baner 11.9 Kms  
 FC Road / Deccan 12.3 Kms  
 Hinjewadi IT Hub 17.0 Kms

### COLLEGES & INSTITUTIONS

Ambrosia School of Hotel Management 3.0 Kms  
 MIT School of Management 4.6 Kms  
 ILS Law College 6.2 Kms  
 SIBMT & SIMMC Campus 3.8 Kms

### SCHOOLS

New India School 1.5 Kms  
 Bharatiya Vidya Bhavan 3.1 Kms  
 Millennium National School 5.4 Kms  
 DAV Public School 11.3 Kms

### HOSPITALS

Borse Hospital 700 Mtrs  
 Bavdhan Hospital 2.0 Kms  
 Om Hospital 2.0 Kms  
 Sahyadri Hospital 2.3 Kms  
 Chellaram Diabetes Institute 3.4 Kms  
 Krishna General Hospital 3.7 Kms

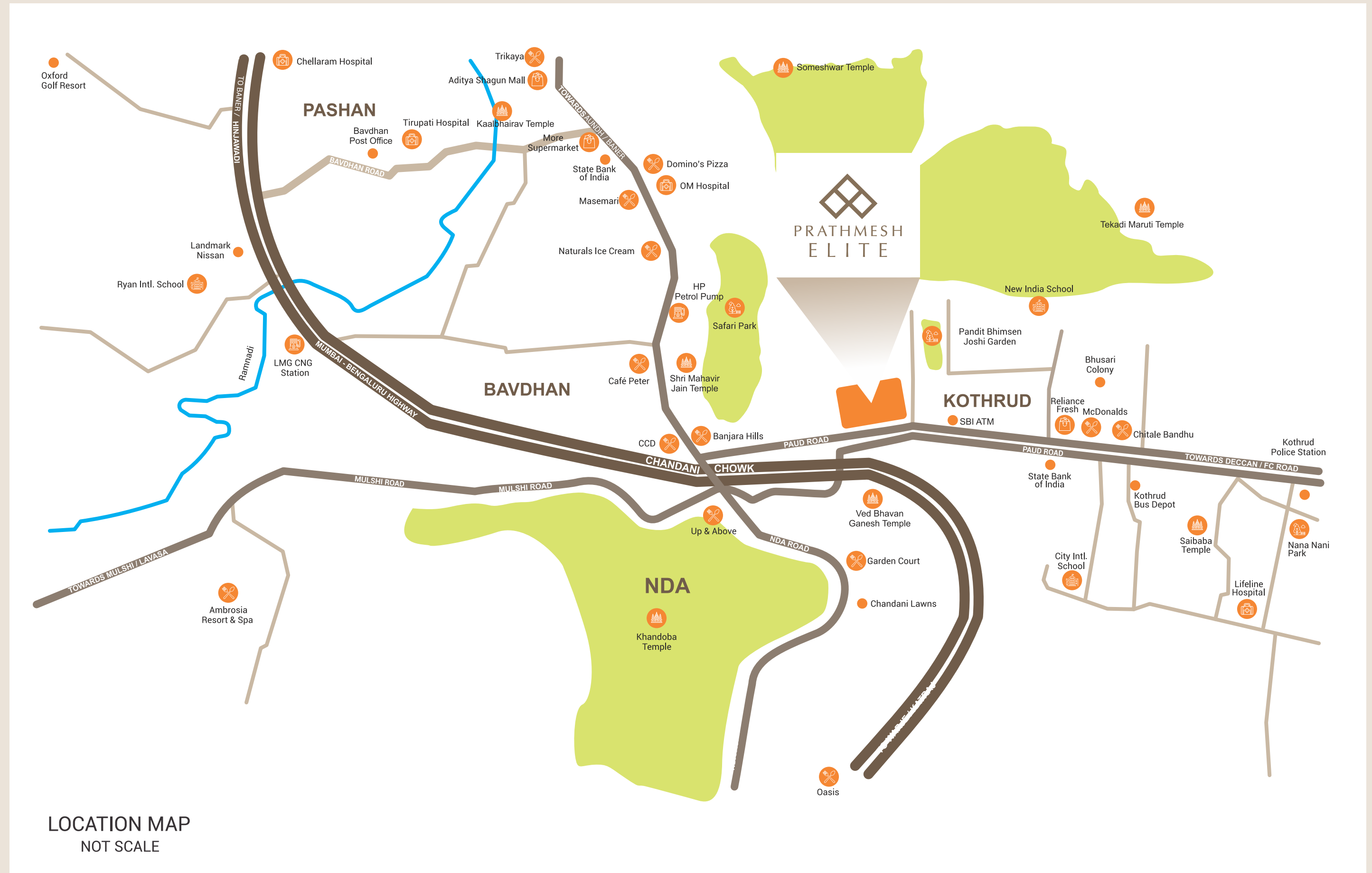

## CREDITS

Structural Designer  
Structure Vision

Architect  
Cubix Architects and Associates

Landscape Designer  
Mahesh Chinchalkar

Brand Consultant  
RJ Design

[www.prathmeshelite.com](http://www.prathmeshelite.com)

Project By



Strategic Partner



 **+91 767 635 1351**

 Site : Survey No 150/A/1/1/2 Plot no - 3, Chandani Chowk, Kothrud, Pune - 411 038.

 [sales@prathmeshelite.com](mailto:sales@prathmeshelite.com)

  
Registration No. : P52100014709  
<https://maharera.mahaonline.gov.in>

1) This brochure is purely conceptual and tentative and is designed in good faith to give a fair and general view of the project and is not a legal offering, nor will it be deemed to be part of any agreement. Photographs are not comprehensive or current. Nothing contained in this brochure will take precedence in the final agreement. Number of buildings, areas, flats/ units, amenities, specifications, floors, roads, open space, etc. may be revised. Promoters reserve the right to amend the layout, plans, elevations, designs, specifications, amenities, areas, etc. The printed material does not constitute a contract/ offer of any type between the developer/ owner and the recipient. Any purchase of this development shall be governed by the terms and conditions of the agreement of sale / lease entered between parties and no details mentioned in this printed material shall in anyway govern such transaction. 2) The viewers affirm that he/ she shall not take his/ her decision of purchase / booking by viewing this brochure. The developer/owner is not responsible for the action of the viewer's booking/ purchasing a unit relying on this brochure. 3) The brochure is an artist's imaginative set of images.