

# ZIRCON



NIRMAL





## INTERNAL AMENITIES

- Full granamite flooring
- Jaguar or equivalent quality bathroom fittings
- Plastic paint
- Pop finished walls
- Anodized sliding windows
- Video door phone with camera in main entrance lobby
- Internal wooden doors with laminate
- Black granite platform in kitchen with stainless steel sink

Nirmal Lifestyle presents Zircon, where a modern lifestyle resides in all its heavenly splendour. This 39-storey majestic tower easily translates your success into its design, elevating a sense of fine living like never before. Its location spells convenience, as it stands tall behind the Nirmal Lifestyle Mall, bringing you closer to indulgent living. Add to that, a breathtaking view of nature and the city. One look out of the window can paint a generous image of lush green trees, chirping birds and the magnificent hills. Surely, an address as unique as you.

## EXTERNAL AMENITIES

- Podium garden
- Clubhouse
- Jogging track on podium level
- Swimming pool
- Steam and sauna
- Community room
- Gated security
- Sports facilities: Table tennis | Billiards | Cards room | Multipurpose tennis | Basketball court



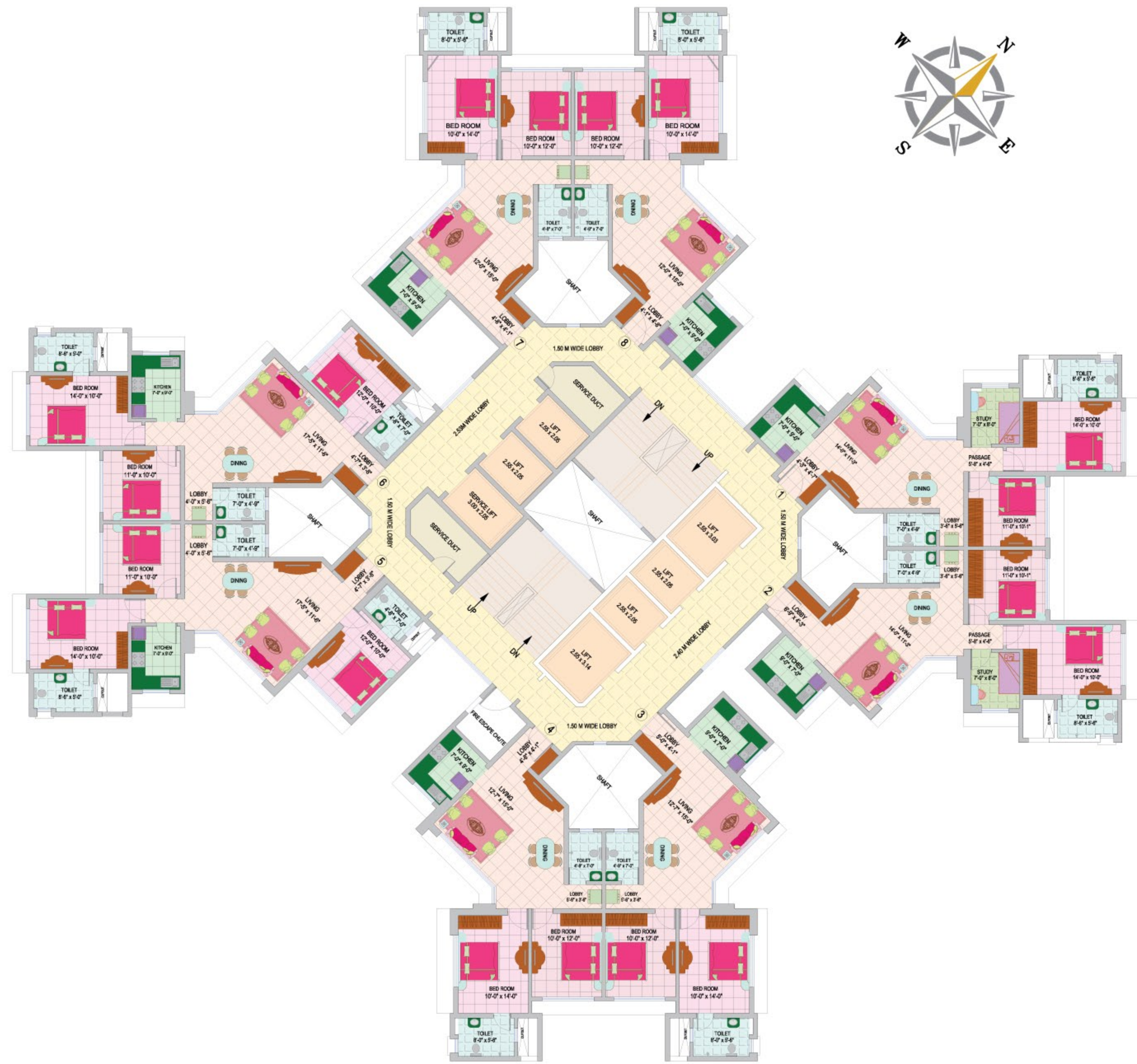

18.30 M WIDE D.P. ROAD

L. B. S. M A R G

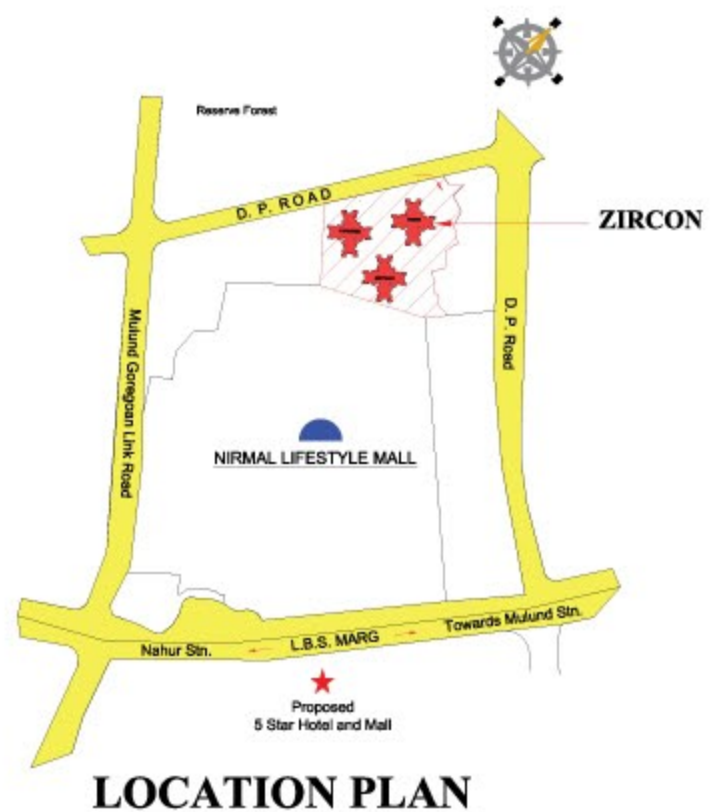

FLAT NO.	TYPE	CARPET AREA SQ.FT.
1	2 1/2 BHK	785
2	2 1/2 BHK	785
3	2 BHK	718
4	2 BHK	718
5	3 BHK	911
6	3 BHK	911
7	2 BHK	718
8	2 BHK	718



# ZIRCON TYPICAL FLOOR PLAN

**Architect**  
**Hafeez**  
**Contractor**





TURQUOISE  
ZIRCON

### Location Map

Close to Nahur and Mulund station | Walking distance to L.B.S. Marg | A few kilometers from the Mulund-Goregaon link Road  
A few minutes away from the Eastern Express highway | Next to Nirmal Lifestyle Mall

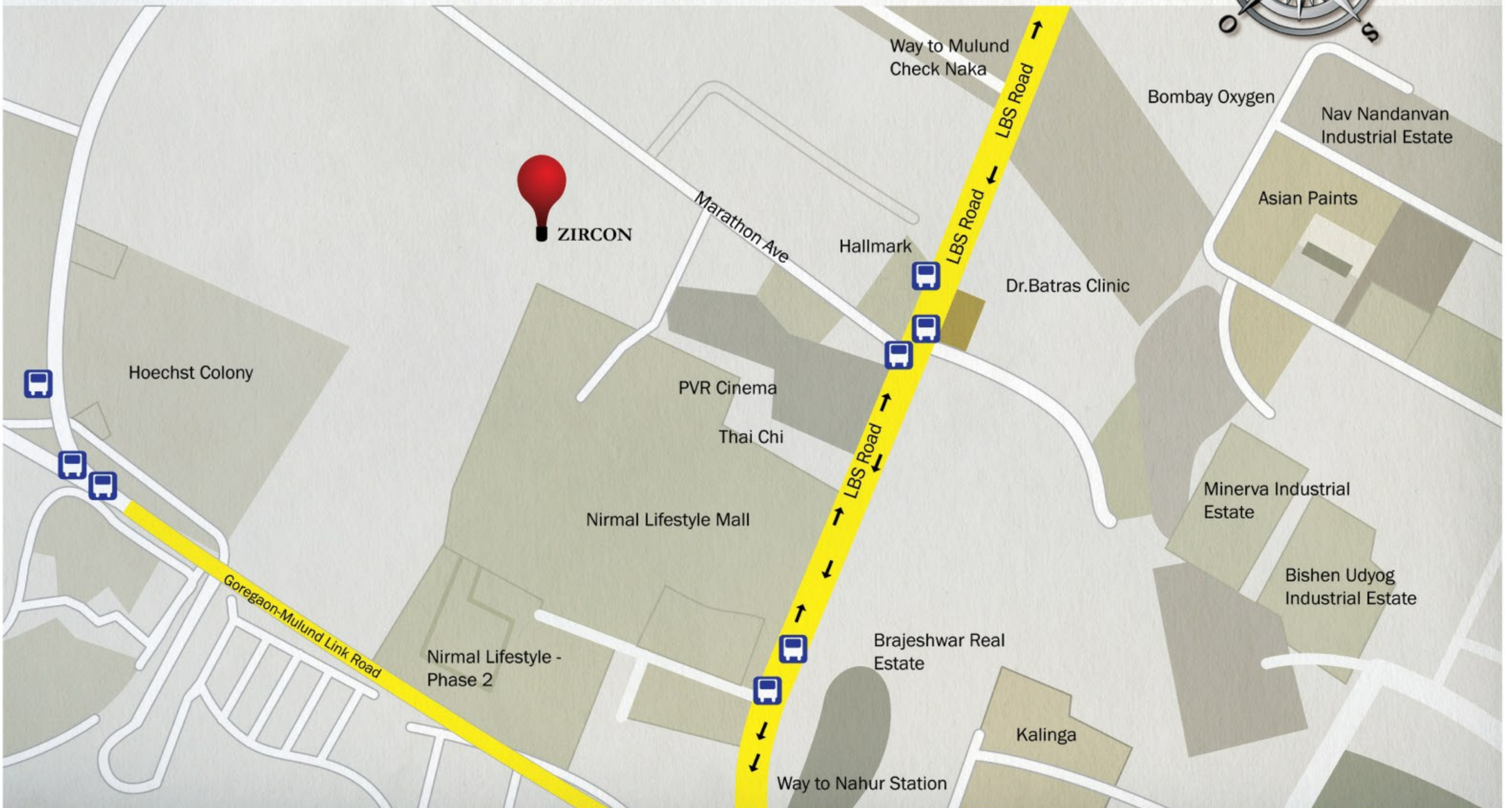

**ZIRCON**  
MULUND



Site Address: Zircon, Next to Nirmal Lifestyle Mall, L.B.S. Road, Mulund (West), Mumbai - 400080.  
Head Office: Nirmal Lifestyle Ltd., L.B.S. Marg, 3rd Floor, Multiplex Building, Mulund (W), Mumbai - 400080.  
Call 022-33209999 | [www.nirmallifestyle.com](http://www.nirmallifestyle.com)

An ISO 9001:2008 & ISO 14001:2004, Real Estate Company. All projects designed by Architect Hafeez Contractor. \*Conditions apply. Floor rise extra as applicable.

Disclaimer: The plans, specifications, images and other details are only indicative and the developer/owner reserves the right to change any or all of these in the interest of the development. This printed material does not constitute an offer and/or contract of any type between the developer/owner and the recipient. Any purchaser/lessee of this development will be governed by the terms and conditions of the agreement for sale/lease entered into between the parties and no details mentioned in this printed material shall in any way govern such transaction. Tolerance of +/-2% is possible in the unit areas on account of design and construction variances.