

*A Project By*

**RELIABLE**

**PRISM CONSTRUCTION CO.**



*... For The People Who Dream*



**RELIABLE**  
**UTKARSH**





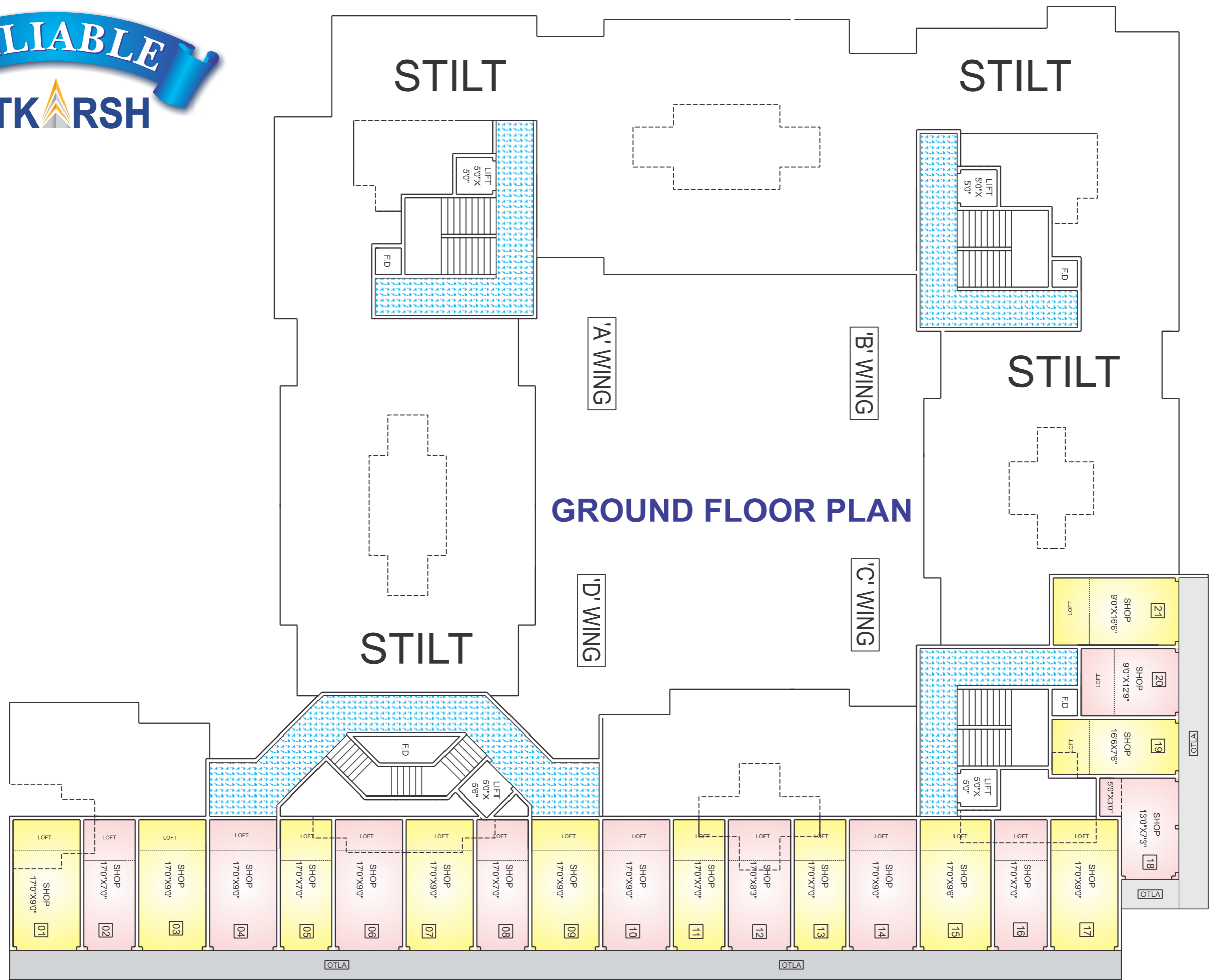

**GROUND FLOOR PLAN**

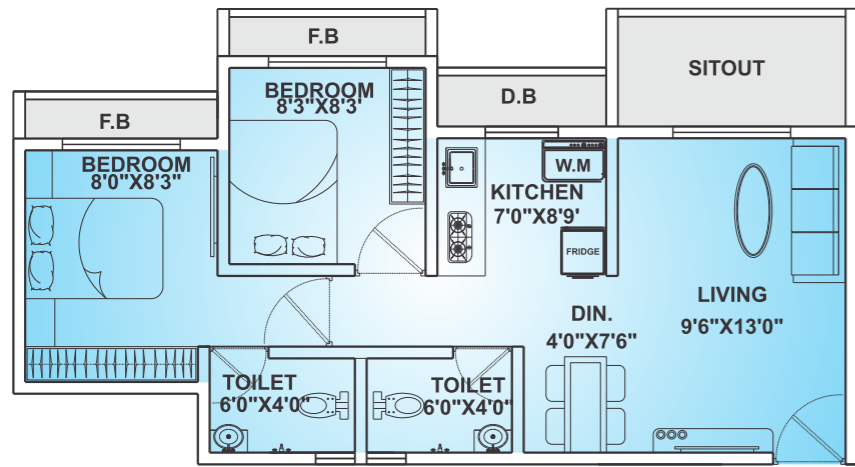

**SAMPLE FLAT**



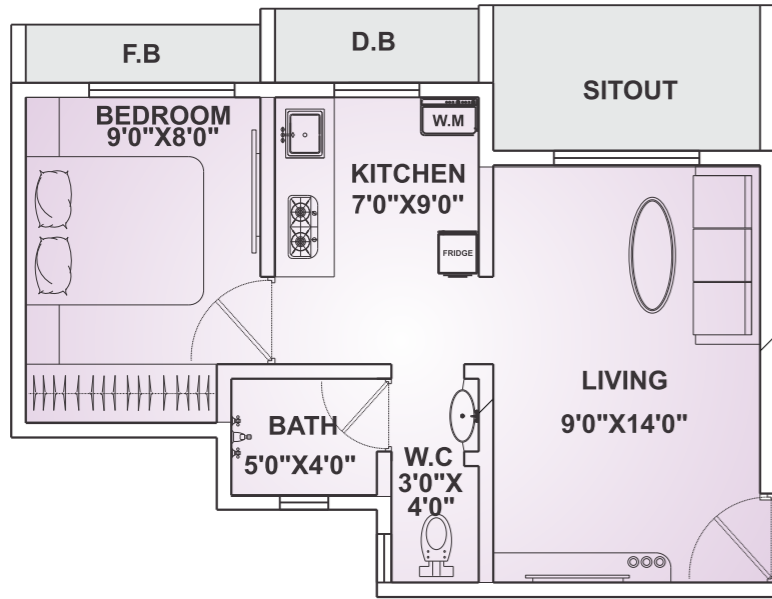

**SAMPLE FLAT**

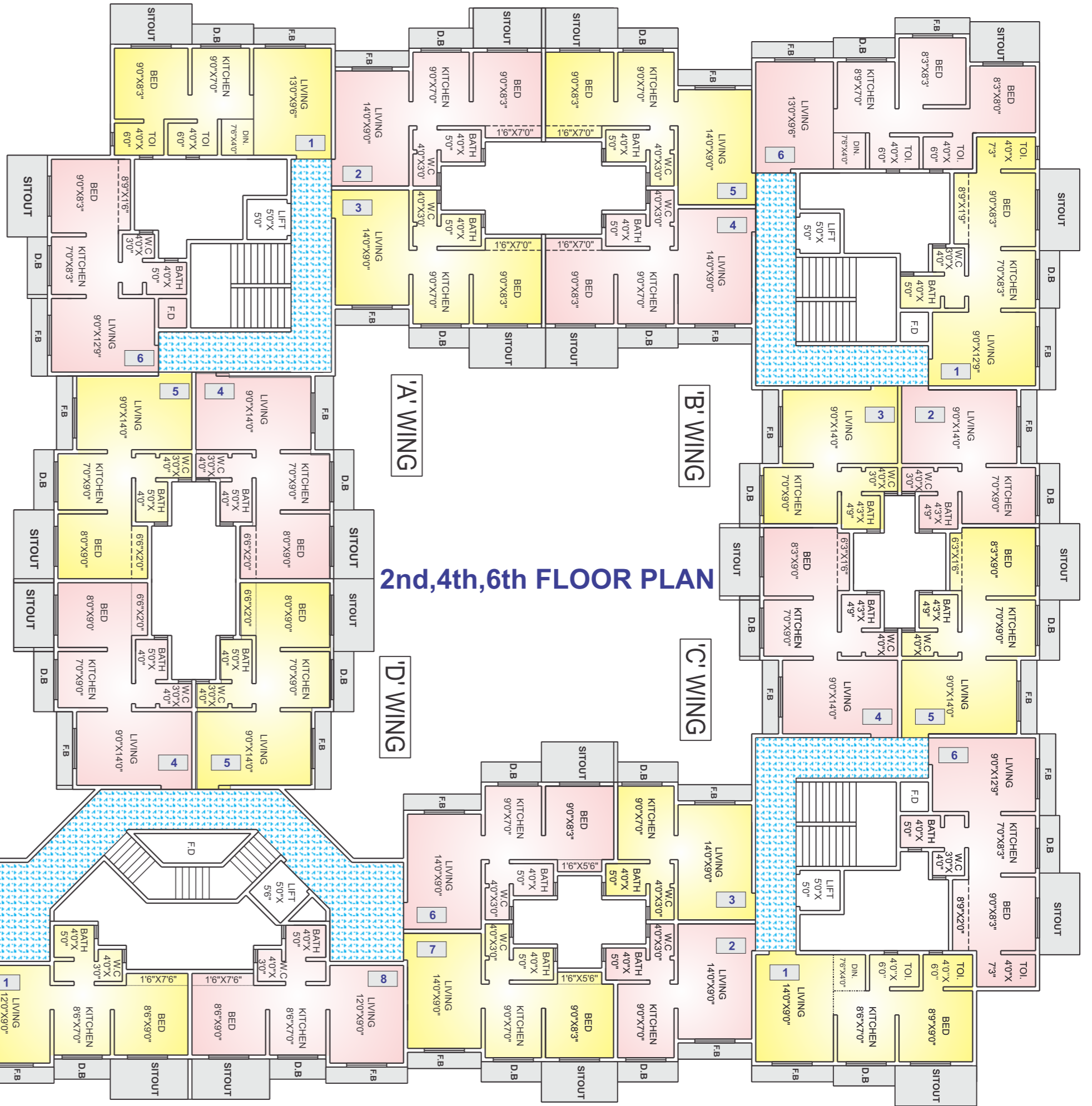

**2nd,4th,6th FLOOR PLAN**



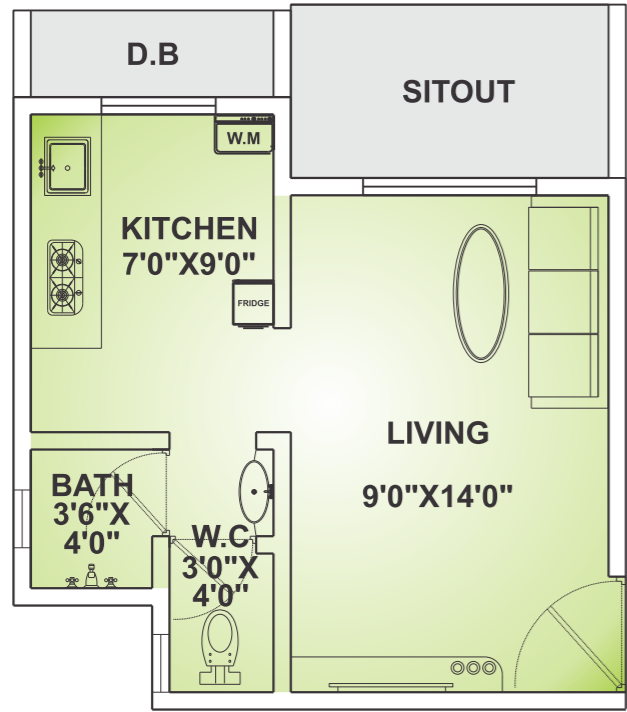

SAMPLE FLAT

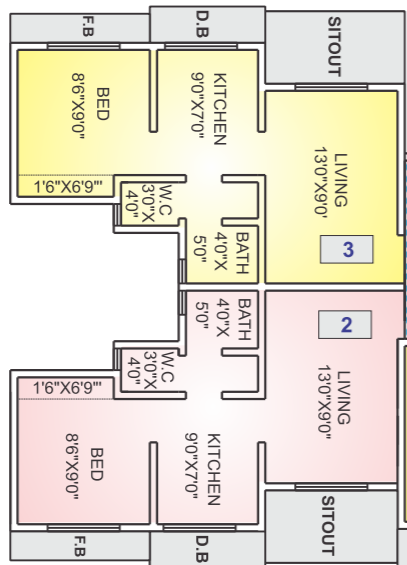

3rd 5th, 7th FLOOR PLAN



**RELIABLE**  
**UTKARSH**





## LOCATION PLAN

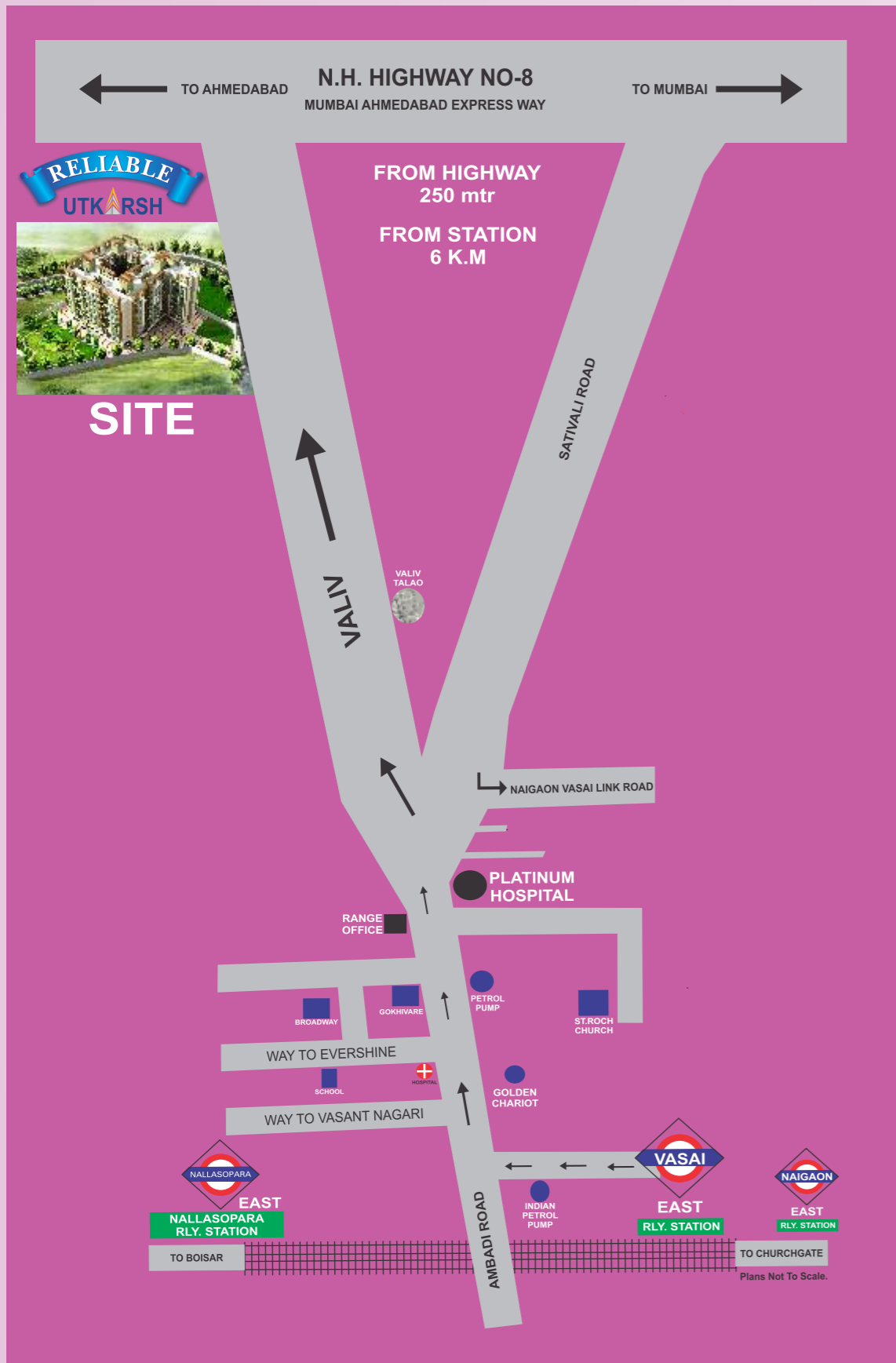

## Amenities

- Elegant Vitrified tiles flooring with skirting in all rooms
- Modular kitchen with Fine finished Granite platform with stainless steel sink
- Concealed plumbing with quality sanitaryware and attractive C.P. Fittings
- Open wall mixer and hand shower of good quality
- Designer main door and other flush doors with fittings
- Powder coated aluminium sliding windows
- Anti skid flooring in bathroom and toilet
- Full height glazed tiles in bathroom, W.C. & tiles upto beam level in the kitchen over platform
- Concealed copper wiring
- Sufficient light points with modular switches
- Corner POP False ceiling in living Room & Bedroom
- Internal walls finished with smooth POP punning finish
- Good quality paint on internal walls
- 100% acrylic waterproof anti fungal paint on external walls
- Lifestyle apartments
- Well Planned flats with proper ventilation & light
- Beautiful elevation & quality construction

A M FAROZ & ASSOCIATES  
ARCHITECTURAL &  
STRUCTURAL CONSULTANTS

Site Office.: Survey No - 155, Village - Pelhar, Vasai Phata, Vasai - East,  
Dist - Thane. PH.: +91 7768848666

Email: rhil101@yahoo.com Website: www.rhil101.com

Disclaimer : The Plans, specifications, images and other details herein are only indicative and the Developer/Owner reserve the right to change any or all of these in the interest of the development. This printed material does not constitute an offer and / or contract of any type between the Developer / Owner and the recipient. Any purchaser/lessee of this development shall be governed by the terms & conditions of the Agreement For Sale/Lease entered into between parties, and no details mentioned in this printed material shall in any way govern such transactions. Tolerance of +/-2% is possible in the unit areas on account of design & construction variances.