

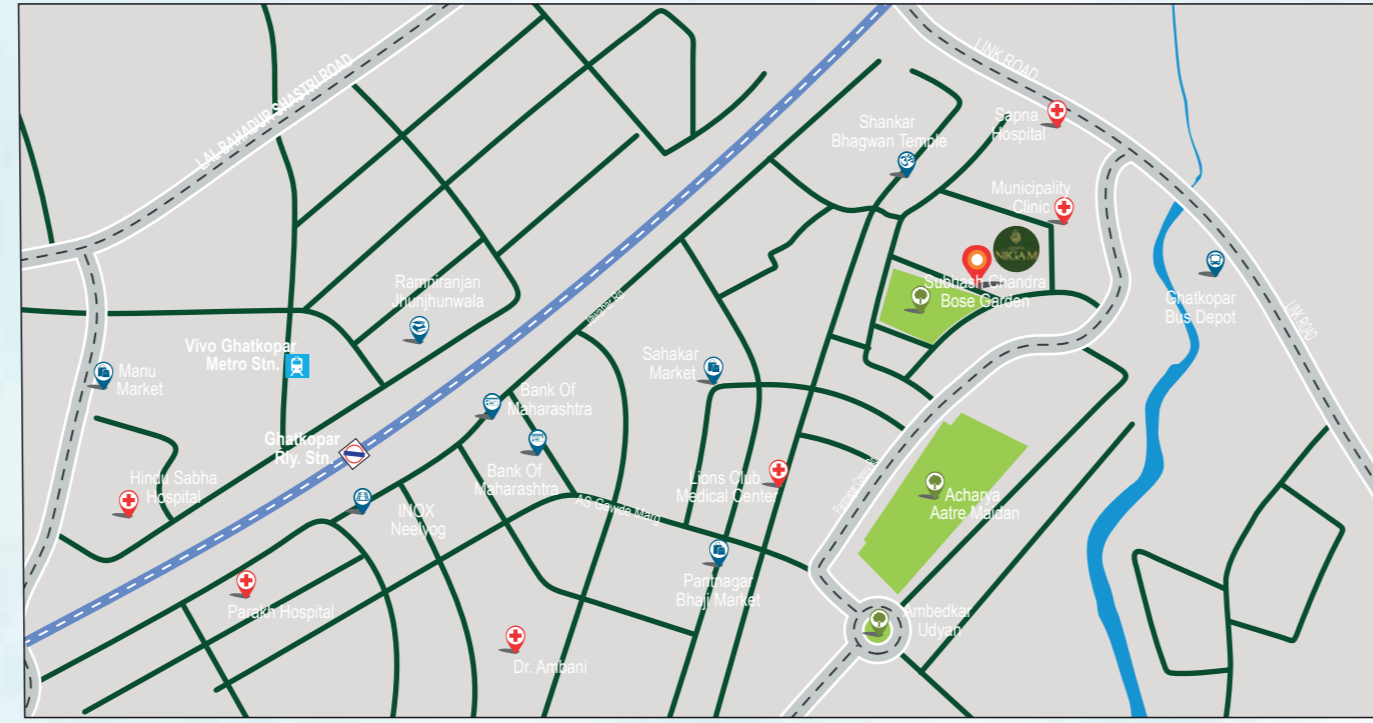

## LOCATION HALLMARKS



A Project By



**GURUKRUPA REALCON**

GURUKRUPA RELCON LIFESPACES LLP

Corp. Add. : C-106, Vashi Plaza, Sector-17, Vashi, Navi Mumbai -400703  
 Site Add.: Gurukrupa Nigam, Building 78, Opp Subhash Chandra Bose Garden,  
 Pant Nagar, Ghatkopar East, Mumbai 400075  
 Call: 7718921563 | [www.gurukrupagroup.in](http://www.gurukrupagroup.in)

MahaRERA: P51900034361 | Web Site : <https://maharera.mahaonline.gov.in/>

Disclaimer- The plan, layout plans, the number of towers, specifications, amenities, proposed amenities, images and visuals, drawings plans or sketches and other details shown in this promotional document are only indicative and for illustrative purpose and are intended to convey the concept and vision of the developer for the project. The developer reserves the right to change any or all of these in the interest of the project as per applicable laws, rules and regulations. No representation or warranty is made or intended as to the accuracy or completeness of information and no commitments are being given under this promotional document or as to its suitability or adequacy for any purpose or otherwise howsoever, that the completed project will comply in any degree with such artist's impression as depicted. This promotional document does not constitute an offer and/or contract of any type between the developer and the recipient. All images and dimensions are not intended to form part of any contract or warranty. All Flat/Unit/Shops allotted to be governed by the terms & conditions of the Agreement for Sale entered to be entered into between allottee & developer alongwith approved plans and no details mentioned in this promotional document shall in any way govern any such transaction. T&C Apply.

GURUKRUPA  
**NIGAM**  
 BEYOND IMAGINATION

## ABOUT US

At Gurukrupa Realcon we believe in delivering quality life spaces using international standards of construction along with the most trusted brands in accessories which forms the crux of our everyday work ethics.

With 14 prestigious projects across mumbai, with **9 in Ghatkopar, 4 in Vikhroli and 1 in Juhu**

We at Gurukrupa Realcon believe in revolutionizing the way people perceive affordable and quality homes

**10 LAKHS + SQ. FT**  
 AREA DEVELOPED

**45 LAKHS + SQ. FT**  
 ON GOING DEVELOPED

**1500+**  
 HAPPY FAMILIES

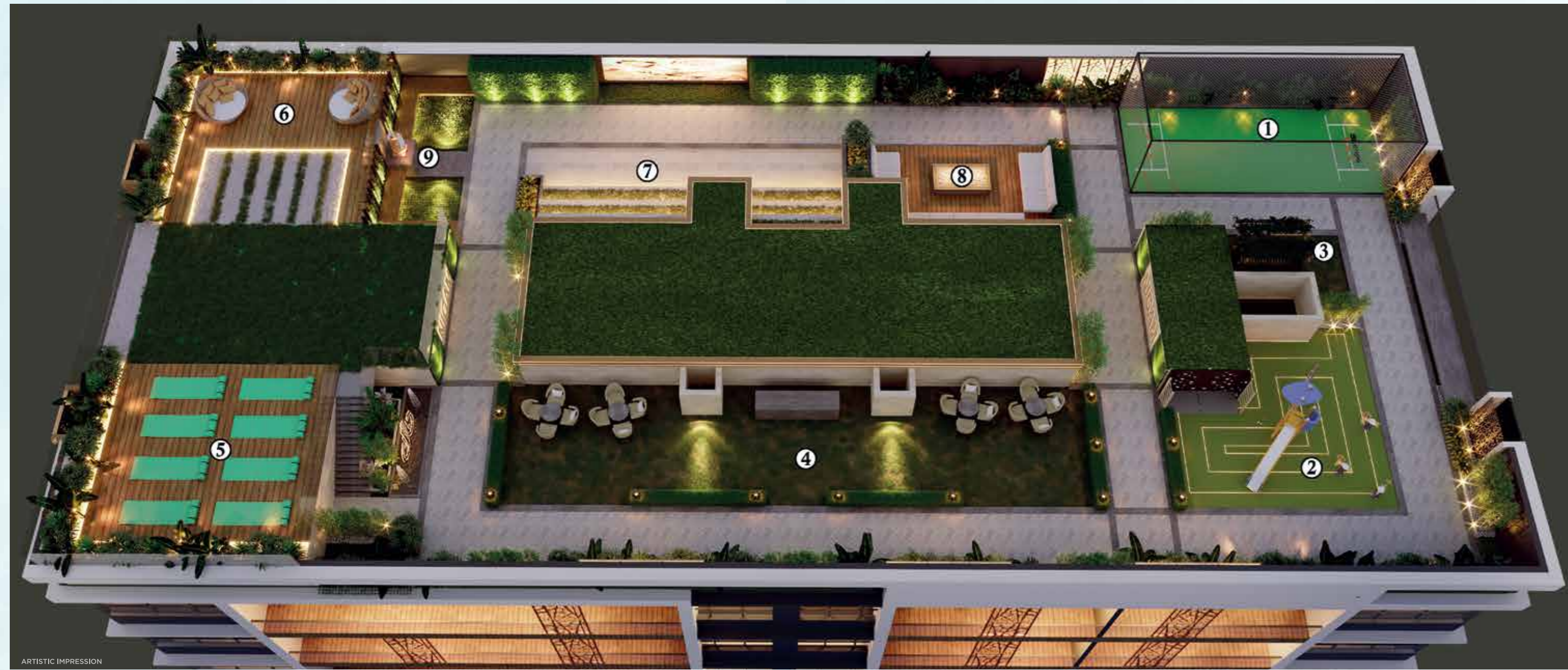

ARTISTIC IMPRESSION

## BEYOND IMAGINATION

The beauty and luxuries of Gurukrupa Nigam a 16 storey tower which is beyond your imagination. With scenic garden facing residences, Gurukrupa Nigam is an ideal place for those who are looking for an eco-friendly and green environment. Breathe in the healthy air of the surroundings & enjoy the scenic beauty, something that is a rare in Mumbai. Time to go green



YOGA & MEDITATION AREA



PARTY LAWN

- 1- Jogging Track
- 2- Meditation Zone
- 3- Zen Yoga
- 4- Seating Lounge
- 5- Swing Seat
- 6- Senior Citizen Area
- 7-Mini Party Lawn
- 8- Children's Play Area



AMPHITHEATER



### 1 BHK - 474 SQFT AREA

- LIVING - 9'6"X15'3"
- KITCHEN - 7'0"X8'0"
- PASSAGE - 7'6"X3'0"
- C.TOILET - 7'0"X4'0"
- MASTER BEDROOM - 9'3"X13'0"
- MASTER TOILET - 6'3"X4'0"
- BALCONY - 17'0"X3'0"



### 2 BHK - 647 SQFT AREA

- LIVING - 10'0"X16'3"
- KITCHEN - 7'0"X9'0"
- DINING - 3'0"X7'6"
- PASSAGE - 8'0"X3'0"
- C.TOILET - 6'9"X4'0"
- BEDROOM - 12'3"X9'6"
- MASTER BEDROOM - 12'2"X9'6"
- MASTER TOILET - 4'0"X7'0"
- BALCONY - 17'6"X3'0"



### 1 BHK - 438 SQFT AREA

- LIVING - 9'0"X15'0"
- KITCHEN - 6'3"X7'6"
- PASSAGE - 6'9"X3'0"
- C.TOILET - 6'3"X4'0"
- MASTER BEDROOM - 9'0"X12'0"
- MASTER TOILET - 4'0"X6'0"
- CUPBOARD - 4'6"X1'6"
- BALCONY - 15'6"X3'0"



### 2 BHK - 665 SQFT AREA

- LIVING - 10'0"X15'0"
- KITCHEN - 7'0"X8'6"
- DINING - 7'6"X6'6"
- PASSAGE - 3'0"X4'0"
- PASSAGE - 2'3"X4'0"
- C.TOILET - 6'6"X4'0"
- BEDROOM - 12'3"X10'0"
- MASTER BEDROOM - 12'3"X10'0"
- MASTER TOILET - 6'9"X4'6"
- BALCONY - 17'6"X2'9"