

A MATCH MADE BY THE UNIVERSE  
CREATING IN KALYAN



**WESTERN**  
ARCH COMPANY

**SAI GALAXY**

---

ELEVATING KHADAKPADA,  
TOGETHER AND BEYOND



## WHERE LUXURY MEETS THE UNIVERSE

Prepare to be stunned by its breathtaking beauty and lavish design. From the comfort of your own home, live like royalty and explore the beauty of the universe. It's an incredible living experience that will leave you speechless.



**WESTERN**  
ARCH COMPANY



A HEAVENLY FAMILY  
MAKING DREAMS  
A REALITY



At Western Arch, we are more than just a real estate company. We are a family that is dedicated to serving your needs and making your dreams come true. For over 35 years, we have been a reputable name in the real estate sector, providing high-quality homes to our valued clients in the Kalyan areas.

Our passion for excellence and commitment to your satisfaction is at the heart of everything we do. We believe that you deserve a home that is not only beautiful but also functional and equipped with all the modern amenities needed for a comfortable life.

35+ Years

1500+ Happy Homes



# WHERE LUXURY AND THE UNIVERSE COLLIDE

---

Artistic Impression

Welcome to Sai Galaxy phase 1 where luxury meets the universe! Western Arch's latest project in Kalyan is nothing short of a celestial paradise that promises to be a heaven on earth for those who seek the ultimate in luxury living.

At Sai Galaxy phase 1, we believe that luxury is not just about a physical space, but an experience that transcends the ordinary. That's why we have incorporated world-class amenities like a **Community Hall, Gymnasium, Landscape Garden & Play Area, Indoor Games, And More**, to ensure that you have an out-of-the-world experience every time you step inside your home.

We invite you to be a part of this exclusive community where luxury meets the universe. So come, be a part of Sai Galaxy phase 1, and let your dreams soar to the stars!



# STAY LINKED, EVEN FROM AFAR



- Khadakpada circle - 450 m away
- Podar International School - 750 m away.
- Birla College - 1.7 km away.
- D-Mart - 2.7 km away.
- Deepak Hotel - 3.1 km away
- Kalyan Railway Station - 3.3 km away.
- Shahad Railway Station - 3.5 km away.
- Vithalwadi Railway Station - 4.7 km away.
- Fortis Hospital - 4.7 km away.
- Metro Junction Mall - 5.4 km away.



Artistic Impression

DISCOVER THE WORLD  
IN UNRIVALED STYLE  
AND COMFORT.

UNIVERSE WITH IN  
THE CANVAS OF  
YOUR HOME



Artistic Impression



Unlock the door to a universe  
of **Extraordinary Living.**





UNITE, CONNECT,  
AND THRIVE IN  
OUR COMMUNITY.



AIR-CONDITIONED  
COMMUNITY HALL



LANDSCAPE  
GARDEN



CHILDREN'S  
PLAY AREA



GYMNASIUM



DESIGNER  
ENTRANCE GATE

Stock Image

# PROTECTING WHAT MATTERS MOST, ALWAYS.



  
BRANDED  
HIGH-SPEED LIFT

  
CCTV  
CAMERA SYSTEM

  
NEXT-GEN  
INTERCOM FACILITY

  
SECURITY  
CABIN

  
FIRE SAFETY  
SYSTEM



Artistic Impression



Stock Image

# EMBRACE A LIFE OF CONVENIENCE AND LUXURY.



CHEQUERED TILE PAVEMENT



GAS LEAKAGE DETECTORS IN THE KITCHEN



FIRE SPRINKLERS AND DETECTORS



WASHING MACHINE PROVISION



POWER BACKUP FOR LIFT AND COMMON AREA



SOLAR PANELS

# EMBRACE NATURE'S GIFTS, ONE RAINDROP AT A TIME



RAIN WATER  
HARVESTING



DRIVERS'  
RESTROOM



SPACIOUS LOFT  
AREA IN KITCHEN



BOREWELL



SOCIETY OFFICE



Stock Image



# EFFICIENCY AT YOUR FINGERTIPS



HIGH EMULSION  
PAINT FINISH



WOODEN  
LAMINATED DOORS



DESIGNER  
BALCONY RAILING



ALUMINIUM WINDOW FRAME  
WITH HIGH QUALITY GLASS



MODULAR  
ELECTRICAL SWITCHES

Artistic Impression

SAI GALAXY

Unleash the joy, laughter, games,  
and **Unforgettable Memories!**



SAI GALAXY 2 BHK SECTION VIEW



SAI GALAXY 2 BHK SECTION VIEW



SAI GALAXY 3 BHK SECTION VIEW

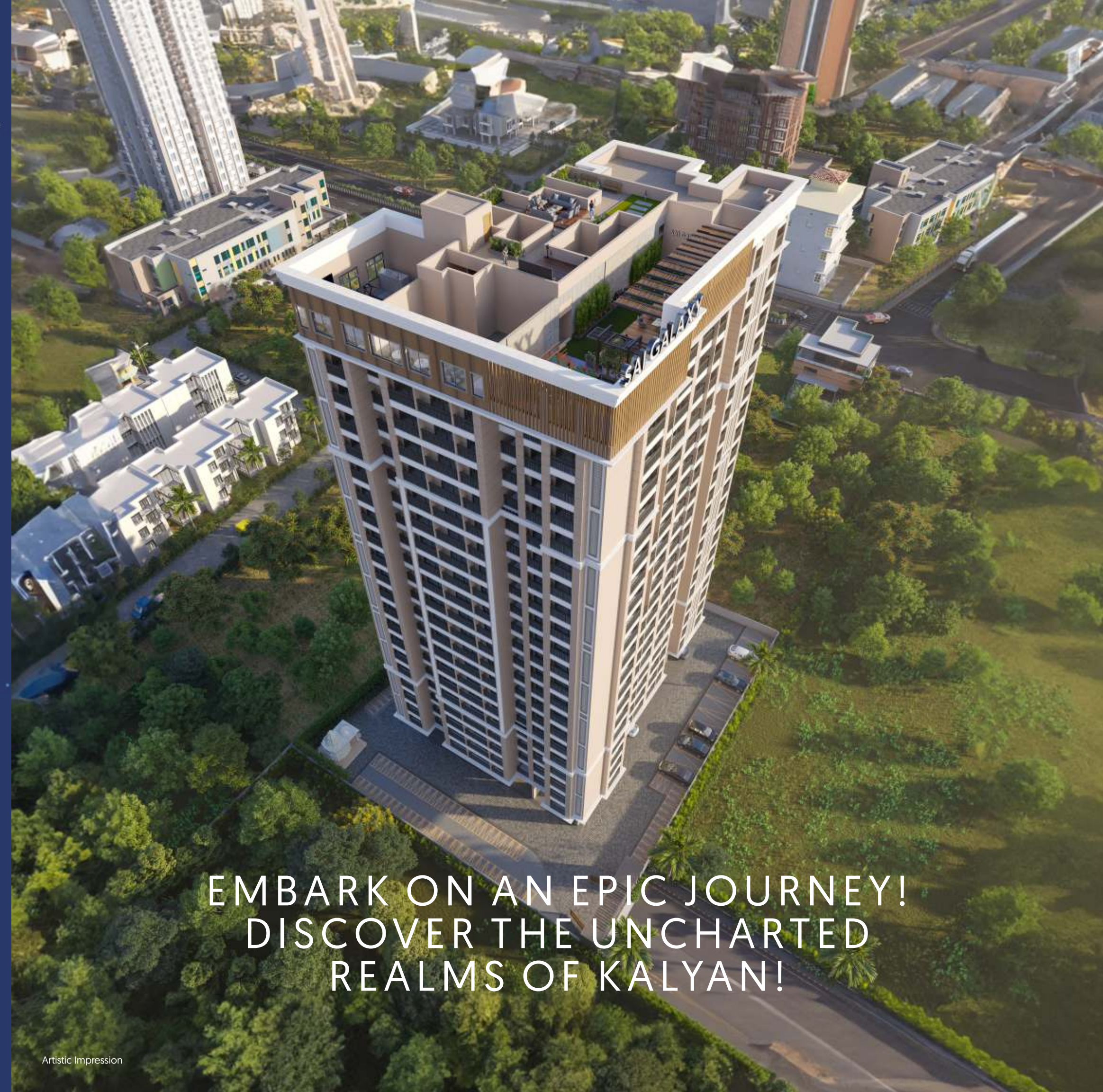

EMBARK ON AN EPIC JOURNEY!  
DISCOVER THE UNCHARTED  
REALMS OF KALYAN!



EXPERIENCE  
THE UNIVERSE IN  
YOUR HOUSE.



TYPICAL FLOOR PLAN



1<sup>ST</sup> TO 6<sup>TH</sup> AND 8<sup>TH</sup> FLOOR PLAN



9<sup>TH</sup> TO 11<sup>TH</sup>, 13<sup>TH</sup> TO 16<sup>TH</sup> FLOOR PLAN

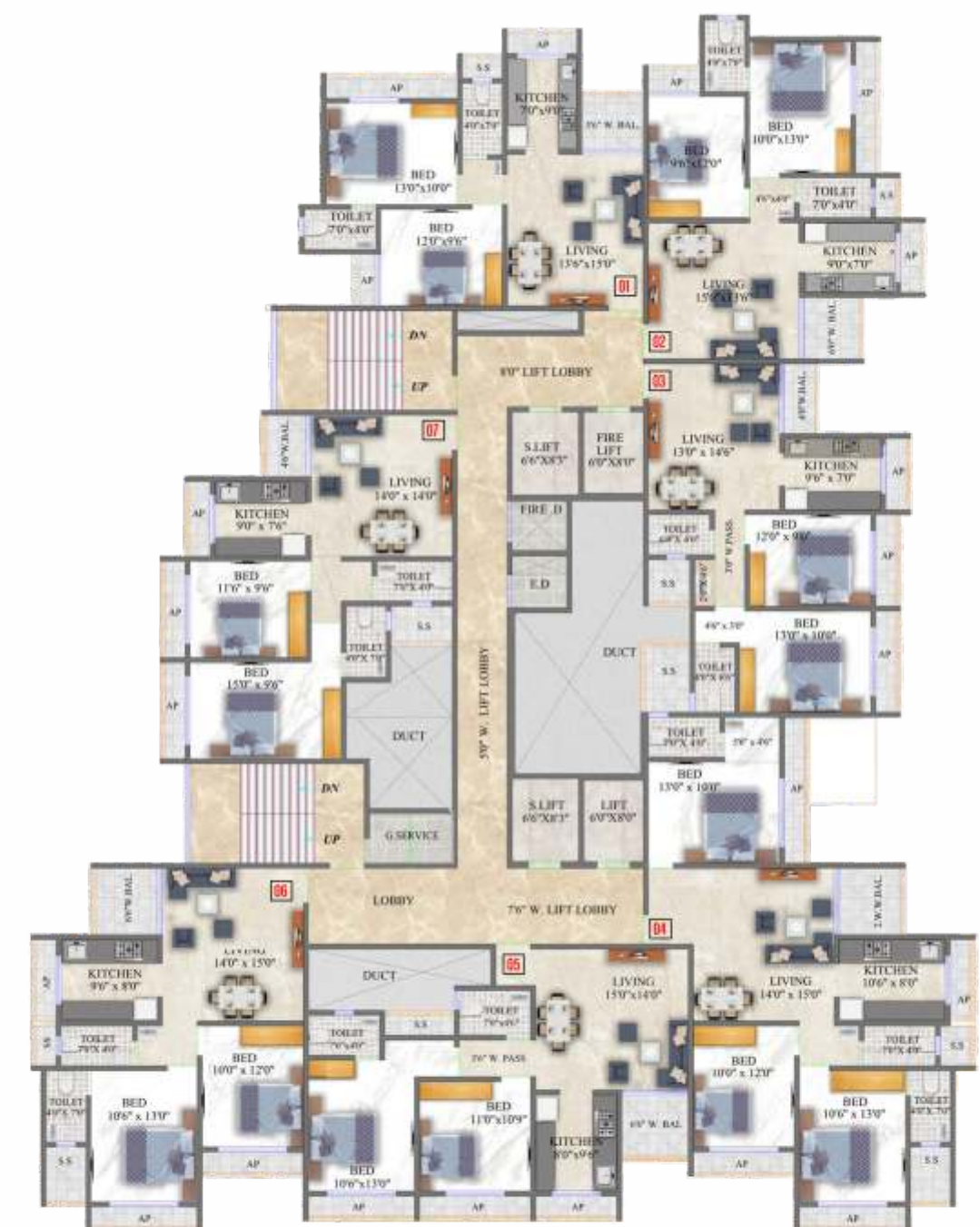

18<sup>TH</sup> TO 20<sup>TH</sup> FLOOR PLAN



**SAI GALAXY**

YOUR DREAMS, OUR QUALITY

Artistic Impression

**THAKKAR PARK -  
KOLIVALI, KALYAN**

**SHREE COMPLEX PHASE-  
2A-KOLIVALI, KALYAN**

**SAI PURAB-  
KOLIVALI, KALYAN**

**KOLIVALI**

**SAI SANKUL (PHASE 1&2) -  
KHADAKPADA, KALYAN**

**SAI PARADISE -  
KHADAKPADA, KALYAN**

**SAI SANKUL (ANNEX)-  
KHADAKPADA, KALYAN**

**SAI BRINDAVAN -  
KHADAKPADA, KALYAN**

**SAI GAURAV-  
SAI CHOWK, KHADAKPADA, KALYAN**

**KHADAKPADA**

**BALAJI PARADISE-  
RAMBAUG, KALYAN**

**RAMBAUG**

**PUNE**

**SAI ICON -  
COMMERCIAL BUILDING,  
PUNE (BANER ROAD)**

Explore Universe In Style  
with **Rooftop Amenities.**





**WESTERN**  
ARCH COMPANY

**SAI GALAXY**

WHERE LUXURY MEETS  
THE UNIVERSE

SAI GALAXY, SAI CHOWK, KHADAKPADA, THANE, 421301 | Call : +91 98 3369 1444

 MahaRERA Registration No.: P51700052053 | Available on <https://maharera.mahaonline.gov.in>

Disclaimer: The plans, specifications, images and other details herein are only indicative and the developers reserve their rights to change any or all of these in the interest of the development. The printed material does not constitute an offer and/or contact of any type between the developer and the recipient. Any purchase/lease of this development shall be governed by the terms and conditions of the agreement entered into between of this development shall be governed by the terms and conditions of the agreement for sale/lease entered into between parties and no detail mentioned in this printed material shall in any way govern such transaction. The stadium, hospital, school and restaurant are a few features that are under the 'proposed' status, which will be confirmed with the upcoming plans.

