

PROJECT BY



**SANJEEVINI GROUP**  
*Trust of Happiness*



**THE PERFECT LIFE  
NEEDS A PERFECT HOME.**



**SANJEEVINI  
SRUSHTI**



2, 2.5 & 3 BHK COMFORT HOMES

RERA : PRM/KA/RERA/1250/304/PR/150222/004712





### Perfect architecture

We shape our buildings to be world-class, with inputs from our teams of experienced professionals. Our architects are focused on making you experience wonder at first sight.

### Perfect Management

From the initial idea to the final finishing and beyond, our projects are managed with an exacting eye for detail and total customer satisfaction. Our modus operandi lies in our ability to innovate, based on a customer-devoted approach and feedback.

# “THE PERFECT HOME

337 Units of  
2, 2.5 & 3 BHK with  
B + G + 8 Floors

2 BHK  
935 - 1035 Sft.

3 BHK  
1180 - 1275 Sft.

3 Acres of Land  
with 54%  
Open Space

20,000 Sft. Plus  
Exclusive  
Clubhouse



2, 2.5 & 3 BHK COMFORT HOMES

# THE PERFECT LIFESTYLE

80 Plus Amenities

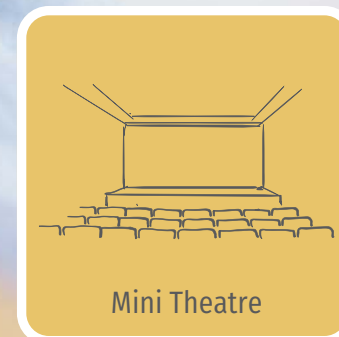
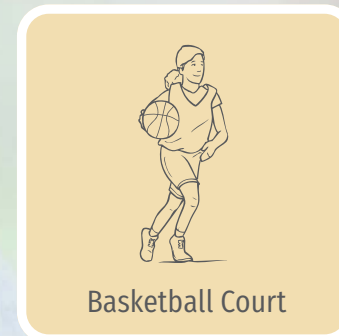
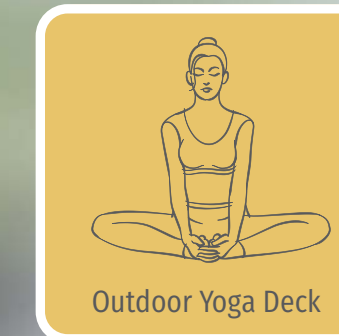
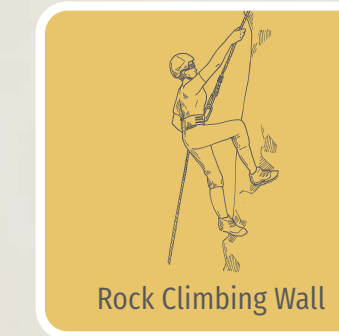
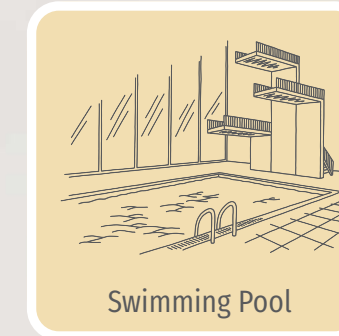
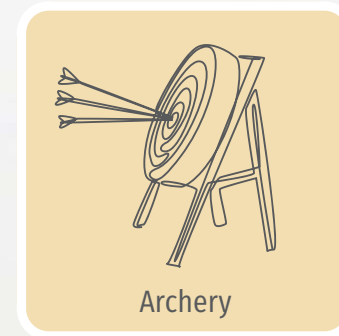
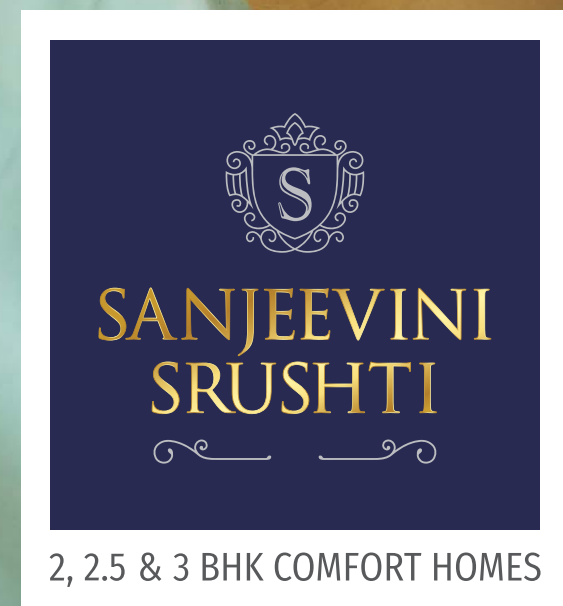



# LEGENDS

1. Entry
  2. Exit
  3. Designer Landscape
  4. Jogging/running track
  5. Basket Ball practice court-1
  6. Digital Generator
  7. Transformer Yard
  8. Organic Waste Converter
  9. Basket Ball practice court-2
  10. Aroma garden
  11. Cricket practice pitch-1
  12. Pergola seating
  13. Cricket practice pitch-2
  14. Zen garden
  15. Skating practice rink
  16. Wind chime garden
  17. Elders' Park
  18. Pets care center
  19. Hammock garden
  20. Landscaped covered walkway
  21. Gazebo
  22. Golf practice area
  23. Winding walkway
  24. Outdoor Party area
  25. Reflexology Pathway
  26. Yoga deck
  27. Communal seating
  28. Gaga ball
  29. Interactive fountain
  30. Nine Square in Air
  31. Kids' play area
  32. Rock climbing wall
  33. Outdoor Gym
  34. Trampoline
  35. Driveway
  36. Pergola Pathway
  37. Badminton practice court-1
  38. Badminton practice court-2
  39. Outdoor shower
  40. Refreshment Counter
  41. Poolside lounge seater
  42. Pool Seating with Tree
  43. Poolside deck
  44. Barbeque area
  45. Swimming pool
  46. Kids' pool
  47. Feature wall with water Cascade
  48. Sculpture Garden
  49. Performance Stage
  50. Drop & Pickup Point
  51. Provision for 24x7 Security
  52. Lifts
  53. Stairs
- Basement**
54. STP
  55. Water Softner Plant
  56. Drivers'/Maids' Toilets
  57. Laundry
  58. Car Washing Point
  59. Electric Car Charging points
  60. Necessary Places CCTV Camera surveillance near building premises

# MASTER PLAN

# CLUBHOUSE - CUT ROOF



GROUND FLOOR



**SANJEEVINI  
SRUSHTI**

2, 2.5 & 3 BHK COMFORT HOMES

## Club House Amenities

- 61. Kitchen for Party hall
- 62. Indoor Party hall
- 63. Reception with concierge
- 64. Waiting Lounge
- 65. Kids' Library / Reading Room
- 66. Indoor Kids' play area
- 67. Chalkboard wall
- 68. Hopscotch hands & feet
- 69. Spinning wheel of hope
- 70. Indoor Games
- 71. Maintenance staff room
- 72. Art/Music room/Painting
- 73. Karate/Dance room
- 74. Association Room
- 75. Indoor Yoga & Aerobics
- 76. Kids' archery/Dart room
- 77. Indoor Gym
- 78. Senior citizen gym
- 79. Kids' interactive gym
- 80. Double Height lobby
- 81. Mini Theatre lobby
- 82. Refreshment Area
- 83. Mini theatre
- 84. Business Centre
- 85. 4 Guest rooms

FIRST FLOOR



# LARGER-THAN-LIFE EXPERIENCE FOR EVERY AGE GROUP



From the youngest toddler to the most senior citizen: Sanjeevini Srushti boasts an awesome array of amenities; fun and excitement mixed with some serious exercise routines. Dedicated spaces set aside for your delight, no matter what your age is. We like to call these 'body-mind-spirit' spaces; for whatever age you feel... The child, the adult, the elder. Enjoy life throughout life, with a whopping 80+ amenities!





Kids gamezone



Kids' gamezone



Indoor Kids' play area



Skating PracticeRink



  
**SANJEEVINI  
SRUSHTI**  
2, 2.5 & 3 BHK COMFORT HOMES

PERFECT  
**PLAY TIMES**

Outdoor Kids play area



- Indoor Kids' play area
- Outdoor Kids' play area
- Spinning wheel of hope
- Art/ music/ painting
- Hopscotch hands & feet
- Kids' interactive gym
- Kids' swimming pool
- Kids' ball pool
- Kids' library
- Dance room
- Karate room/Martial arts
- Chalkboard wall





Half Basket Ball



Badminton Court



Gazebo



Hammock Garden



Golf practice space



**SANJEEVINI  
SRUSHTI**

2, 2.5 & 3 BHK COMFORT HOMES

# PERFECT YOUTH SPACES

- Jogging / Running track
- Library & reading room
- Outdoor yoga deck
- Outdoor gym
- Indoor gym
- Swimming pool
- Poolside deck
- Outdoor shower
- Pool seating
- Mini theatre
- Mini theatre lobby
- Indoor games
- Business centre
- Sculpture feature wall
- Barbeque Corner
- Gazebo
- Aerobics
- Winding walkway
- Outdoor party area
- Seating area
- Performance stage
- Feature wall with water cascade
- Poolside lounge seaters
- Refreshment area
- Reflexology garden
- Pergola Pathway



Zen Garden



Mini Theater



Business Centre



Water Fountain



Outdoor Party Area



Pool Seating with Tree

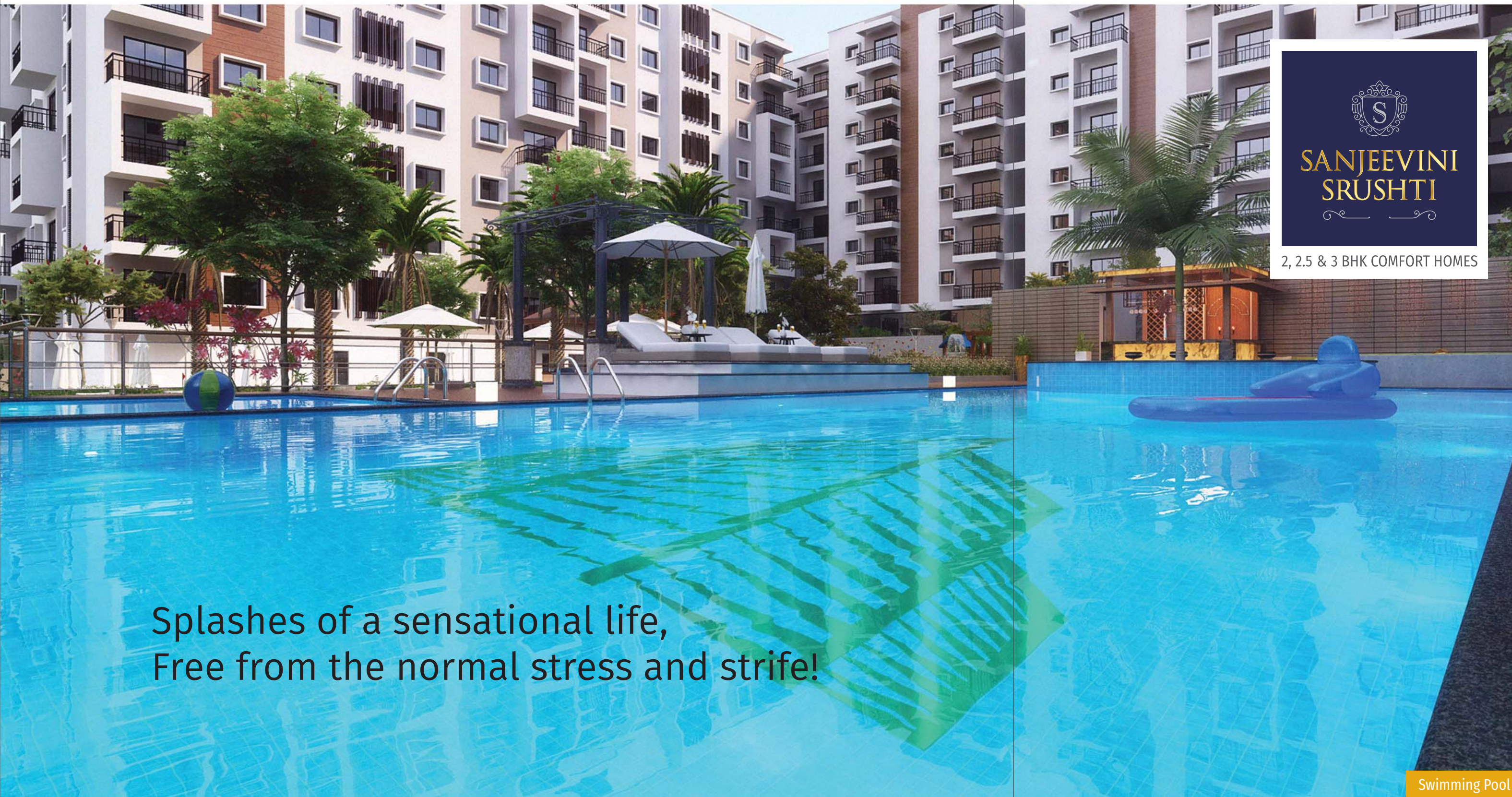

**SANJEEVINI  
SRUSHTI**  
2, 2.5 & 3 BHK COMFORT HOMES

Splashes of a sensational life,  
Free from the normal stress and strife!

Swimming Pool

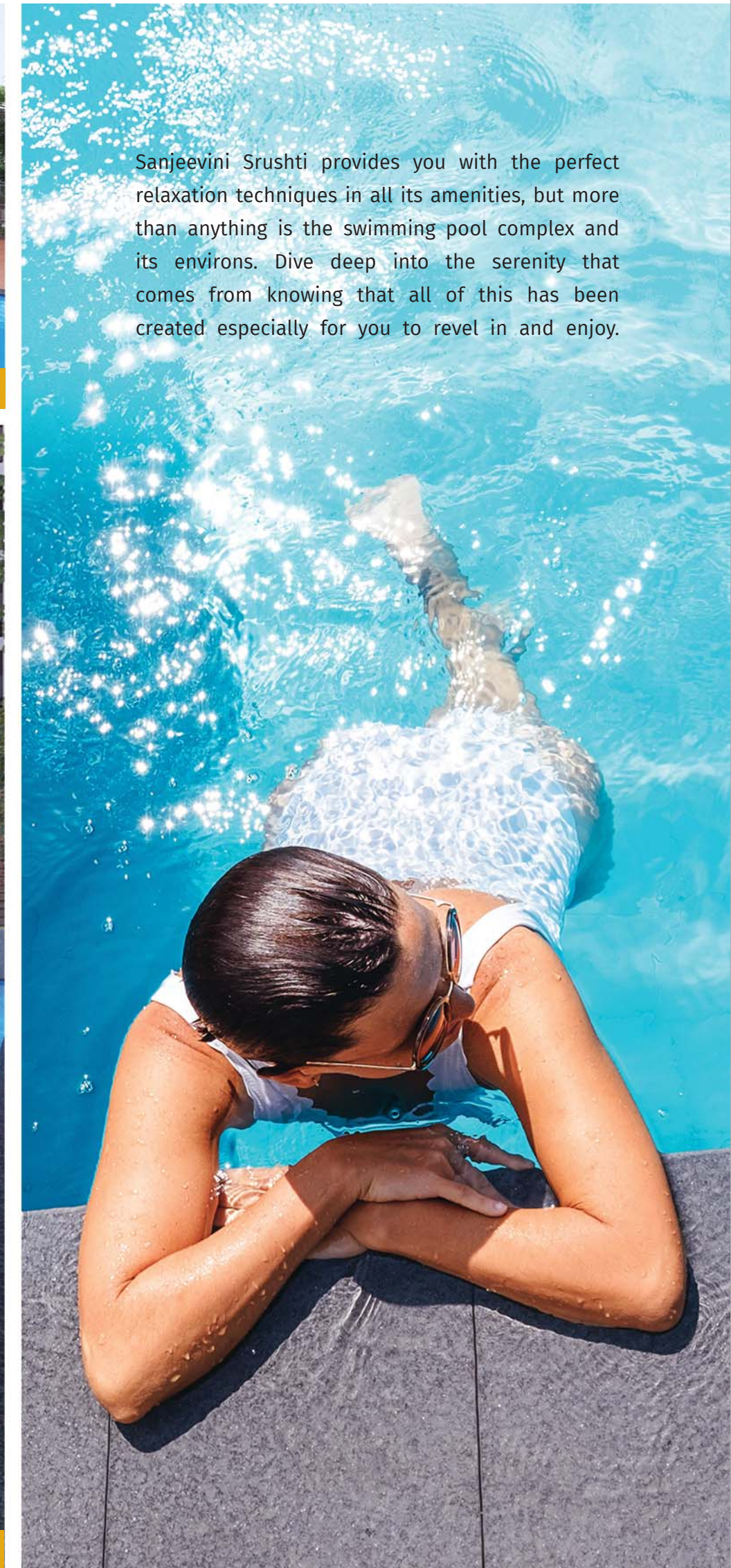

Sanjeevini Srushti provides you with the perfect relaxation techniques in all its amenities, but more than anything is the swimming pool complex and its environs. Dive deep into the serenity that comes from knowing that all of this has been created especially for you to revel in and enjoy.



SANJEEVINI  
SRUSHTI

2, 2.5 & 3 BHK COMFORT HOMES

# PERFECT ELDER STAYCATIONS

Indoor yoga  
Sr. Citizens' lounge  
Sr. Citizens' gym  
Communal seating  
Pergola pathway  
Pergola seating  
Hammock garden  
Wind chime garden  
Landscaped walkways

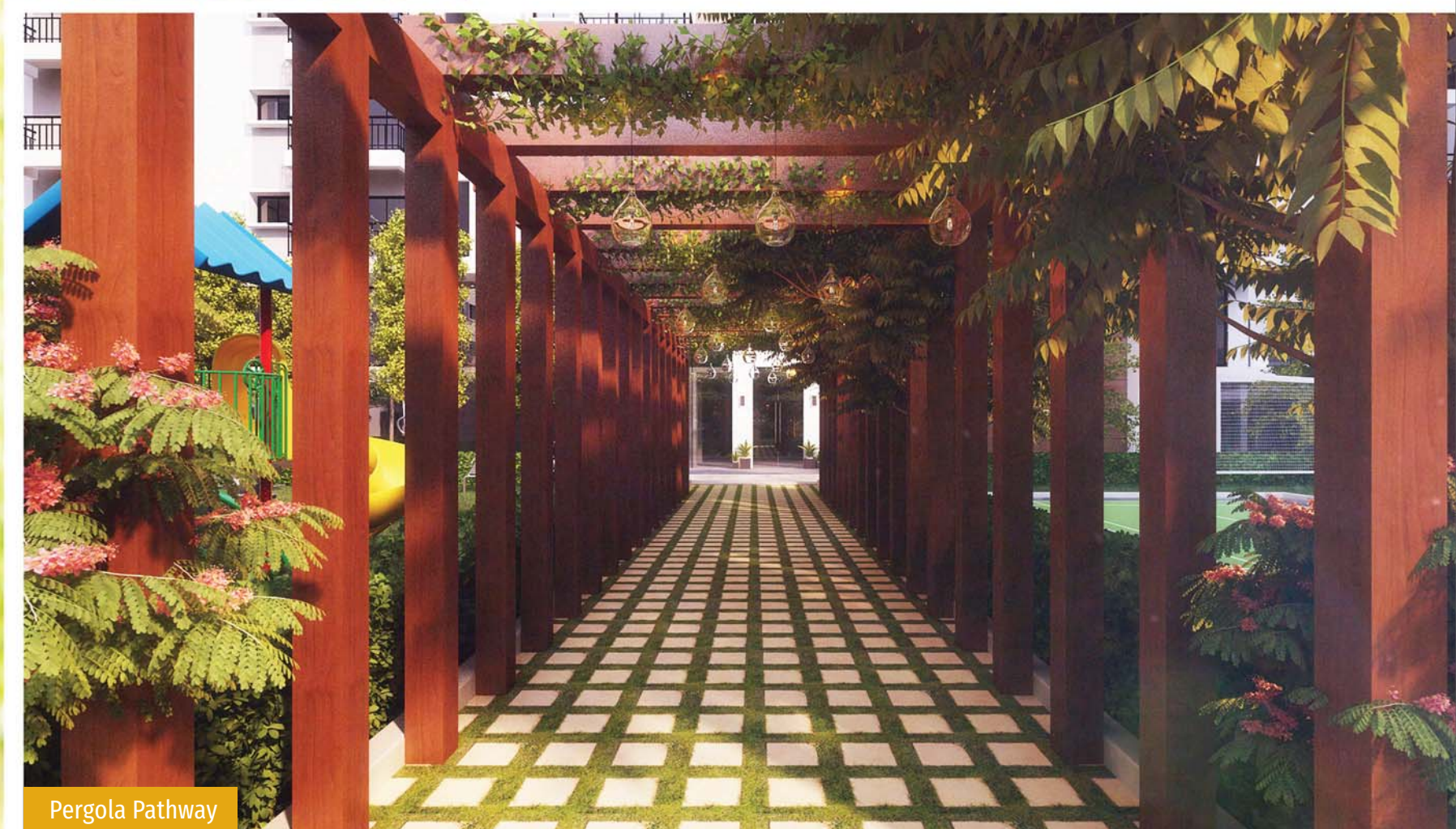

Pergola Pathway



Communal Seating

Clubhouse



**SANJEEVINI  
SRUSHTI**

2, 2.5 & 3 BHK COMFORT HOMES

PERFECT

# CLUBBING

## RIGHT AT HOME

At Sanjeevini Srushti, you don't need to go clubbing, since the club's right there on the premises. Packed with an enormous number of fantastic features, so that the "Play" aspect of your "Work-Life-Play" balance is met in full!



Indoor Gym



Reception Area



2, 2.5 & 3 BHK COMFORT HOMES

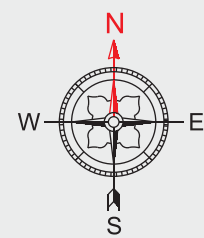

### FLOOR PLAN - BLOCK A

Flat No	A1	A2	A3	A4	A5	A6	A7	A8	A9	A10	A11	A12	A13	A14	A15	A16
Type	3BHK	2BHK	3BHK	2BHK	2BHK	2BHK	2BHK	2BHK	2BHK	2.5BHK	2.5BHK	3BHK	3BHK	3BHK	3BHK	3BHK
Facing	West	North	North	East	North	North	North	North	North	East	East	East	West	East	West	East
Carpet Area	749	621	749	581	581	581	581	581	581	749	749	749	749	749	749	749
BUA (Sft)	888	778	959	704	704	704	704	704	704	935	935	935	888	935	888	935
SBA (Sft)	1180	1035	1275	935	935	935	935	935	935	1245	1245	1245	1180	1245	1180	1245



2, 2.5 & 3 BHK COMFORT HOMES

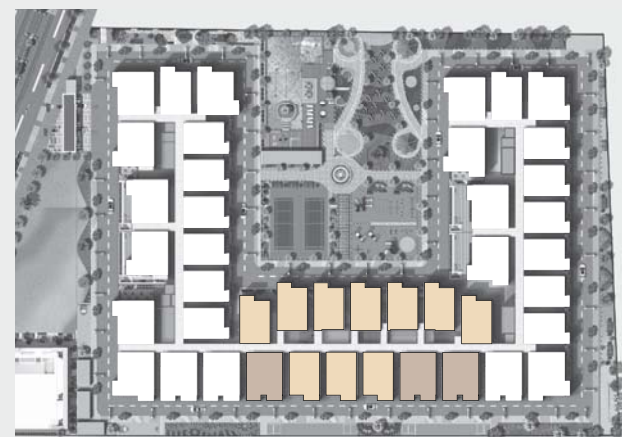
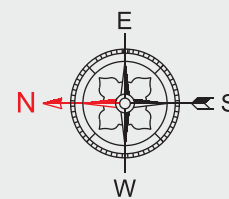

## FLOOR PLAN BLOCK B

Flat No	B1	B2	B3	B4	B5	B6	B7	B8	B9	B10	B11	B12	B13
Type	2.5BHK	2BHK	2BHK	2BHK	2BHK	2BHK	2BHK	2BHK	2.5BHK	2.5BHK	2BHK	2BHK	2BHK
Facing	East	West	West	West	West	North	West	North	East	East	East	East	East
Carpet Area	749	621	621	621	621	621	621	621	749	749	621	621	621
BUA (Sft)	935	751	751	751	751	778	751	778	935	935	755	755	755
SBA (Sft)	1245	1000	1000	1000	1000	1035	1000	1035	1245	1245	1005	1005	1005



  
**SANJEEVINI  
SRUSHTI**  
 2, 2.5 & 3 BHK COMFORT HOMES

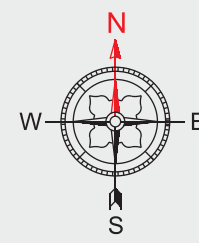

### FLOOR PLAN - BLOCK C

Flat No	C1	C2	C3	C4	C5	C6	C7	C8	C9	C10	C11	C12	C13	C14
Type	3BHK	2BHK	3BHK	2BHK	2BHK	2BHK	2BHK	2BHK	2BHK	3BHK	2.5BHK	3BHK	3BHK	3BHK
Facing	West	North	North	East	North	North	North	North	North	East	East	East	West	East
Carpet Area	749	621	749	581	581	581	581	581	578	749	749	749	749	749
BUA(Sft)	888	778	959	704	704	704	704	704	704	931	935	935	888	935
SBA (Sft)	1180	1035	1275	935	935	935	935	935	935	1240	1245	1245	1180	1245

# CUT ROOF IMAGES

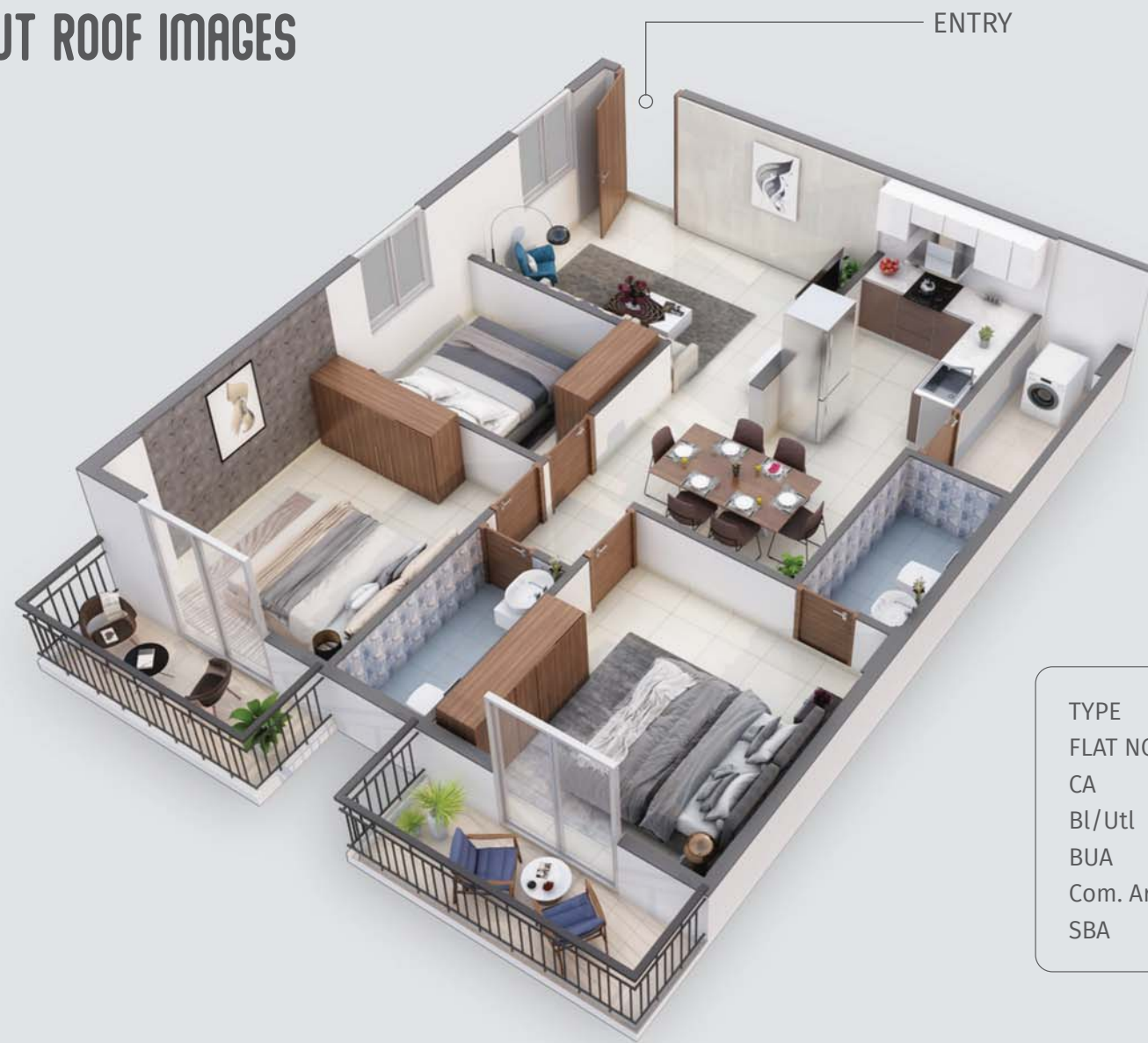

TYPE : 2.5 BHK, EAST  
 FLAT NO. : A10, A11, B1, B9, B10, C11  
 CA : 749 Sft  
 Bl/Utl : 137 Sft  
 BUA : 935 Sft  
 Com. Area : 310 Sft  
 SBA : 1245 Sft



TYPE : 2 BHK, WEST  
 FLAT NO. : B2 B3 B4 B5 B7  
 CA : 621 Sft  
 Bl/Utl : 82 Sft  
 BUA : 751 Sft  
 Com. Area : 250 Sft  
 SBA : 1000 Sft

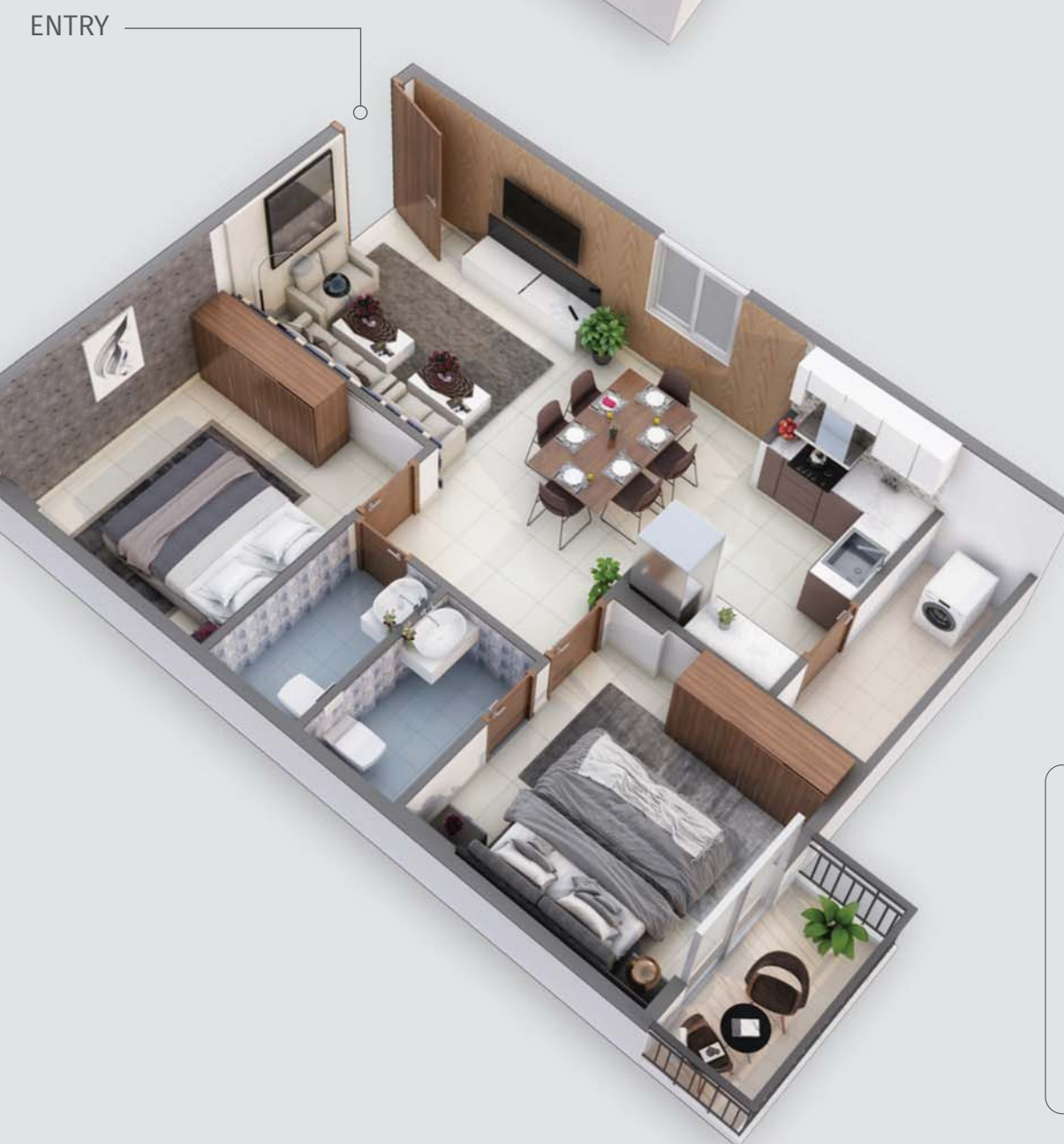

TYPE : 2 BHK, NORTH  
 FLAT NO. : A5, A6, A7, A8, A9, C5, C6, C7, C8  
 CA : 581 Sft  
 Bl/Utl : 76 Sft  
 BUA : 704 Sft  
 Com. Area : 231 Sft  
 SBA : 935 Sft

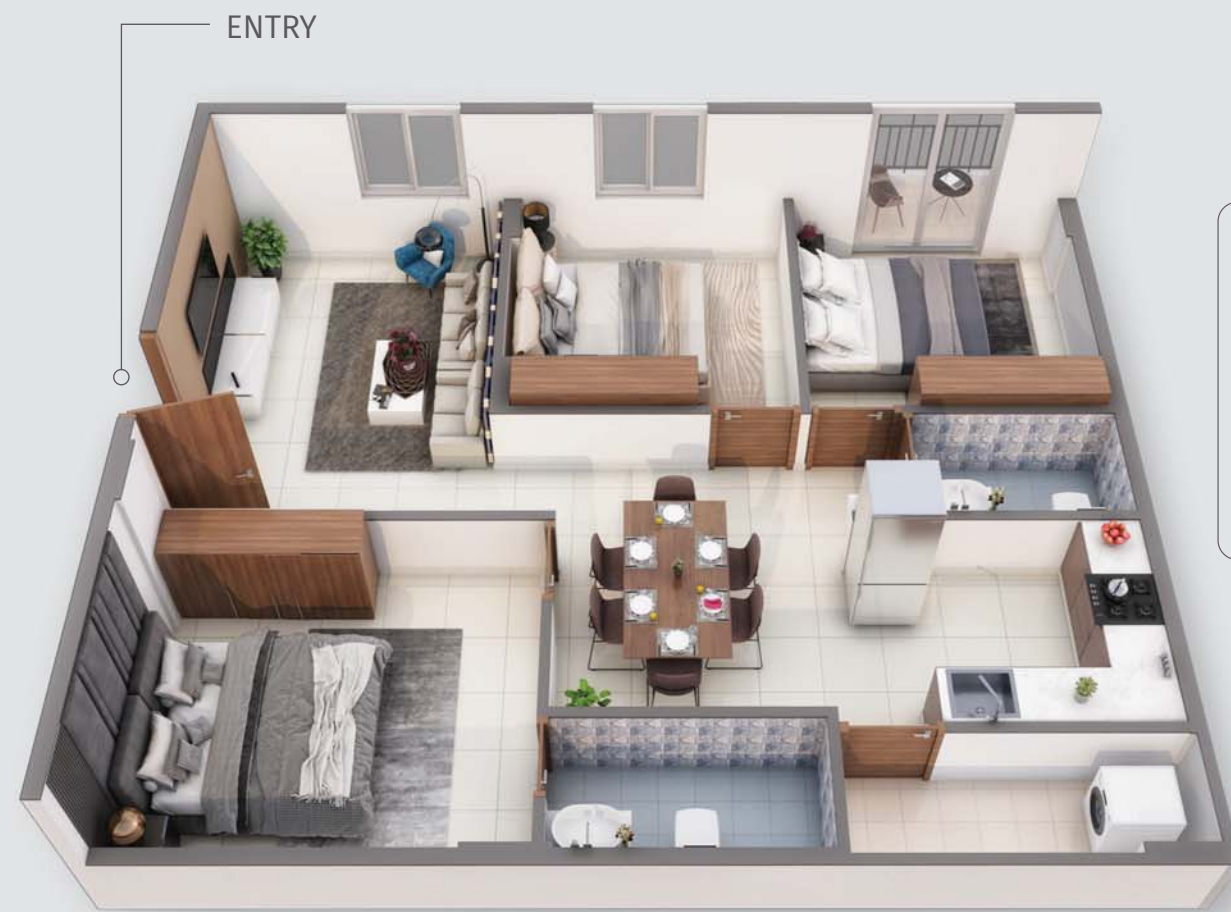

TYPE : 3 BHK, WEST  
 FLAT NO. : A1, A13, A15, C1, C13  
 CA : 749 Sft  
 Bl/Utl : 87 Sft  
 BUA : 888 Sft  
 Com. Area : 292 Sft  
 SBA : 1180 Sft







TYPE : 2 BHK, NORTH  
 FLAT NO. : A2, B6, B8, C2  
 CA : 621 Sft  
 Bl/Utl : 109 Sft  
 BUA : 778 Sft  
 Com. Area : 257 Sft  
 SBA : 1035 Sft



TYPE : 2 BHK, EAST  
 FLAT NO. : A4, C4  
 CA : 580 Sft  
 Bl/Utl : 78 Sft  
 BUA : 704 Sft  
 Com. Area : 231 Sft  
 SBA : 935 Sft

## CUT ROOF IMAGES



TYPE : 2 BHK, EAST  
 FLAT NO. : B11, B12, B13  
 CA : 621 Sft  
 Bl/Utl : 86 Sft  
 BUA : 755 Sft  
 Com. Area : 251 Sft  
 SBA : 1005 Sft



TYPE : 3 BHK, EAST  
 FLAT NO. : C10  
 CA : 749 Sft  
 Bl/Utl : 133 Sft  
 BUA : 931 Sft  
 Com. Area : 309 Sft  
 SBA : 1240 Sft



# CUT ROOF IMAGES

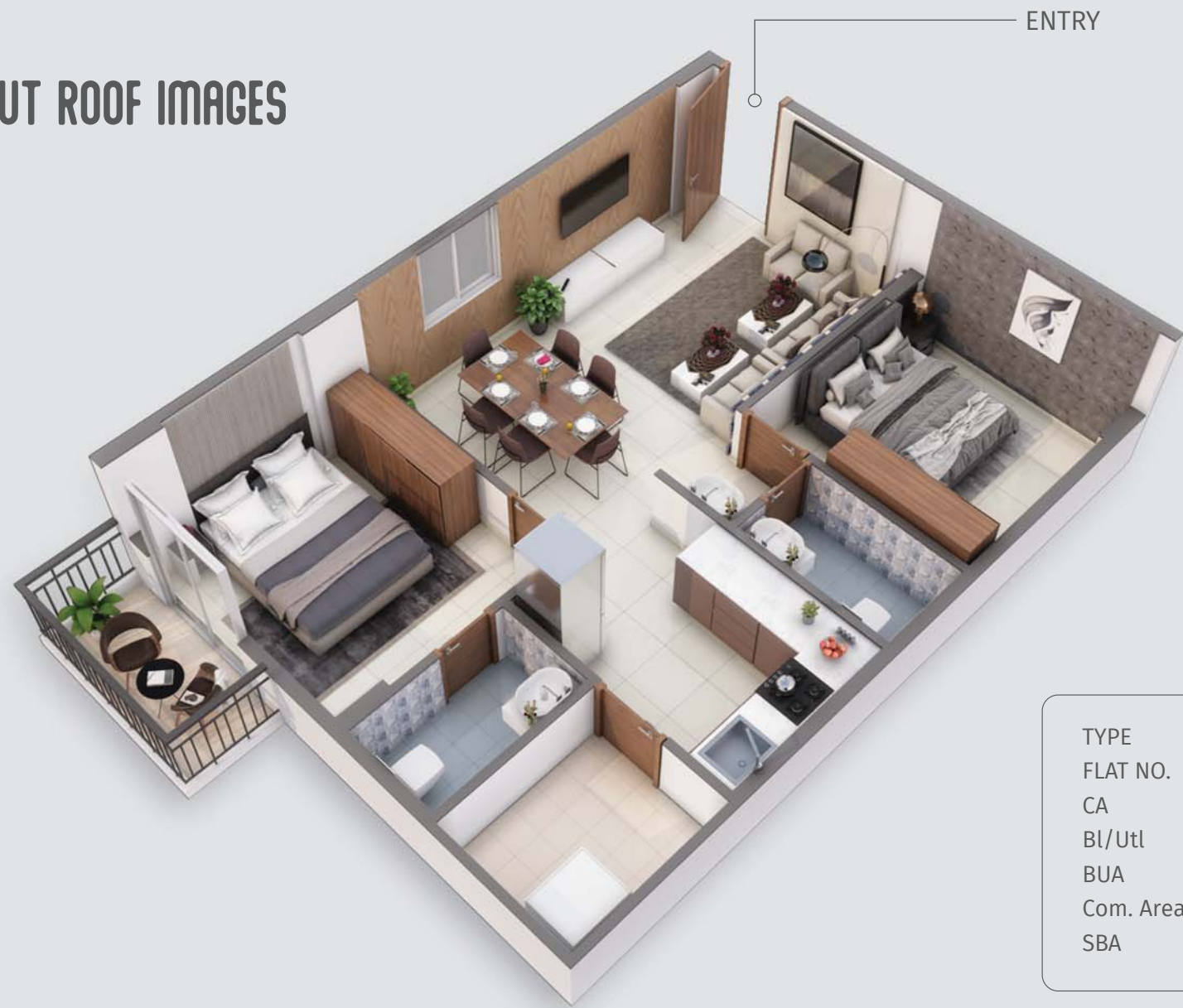

TYPE : 2 BHK, NORTH  
 FLAT NO. : C9  
 CA : 578 Sft  
 Bl/Utl : 78 Sft  
 BUA : 704 Sft  
 Com. Area : 231 Sft  
 SBA : 935 Sft



TYPE : 3 BHK, EAST  
 FLAT NO. : A12, A14, A16, C12, C14  
 CA : 749 Sft  
 Bl/Utl : 137 Sft  
 BUA : 935 Sft  
 Com. Area : 310 Sft  
 SBA : 1245 Sft





Gaga Ball



Cricket Practice Net

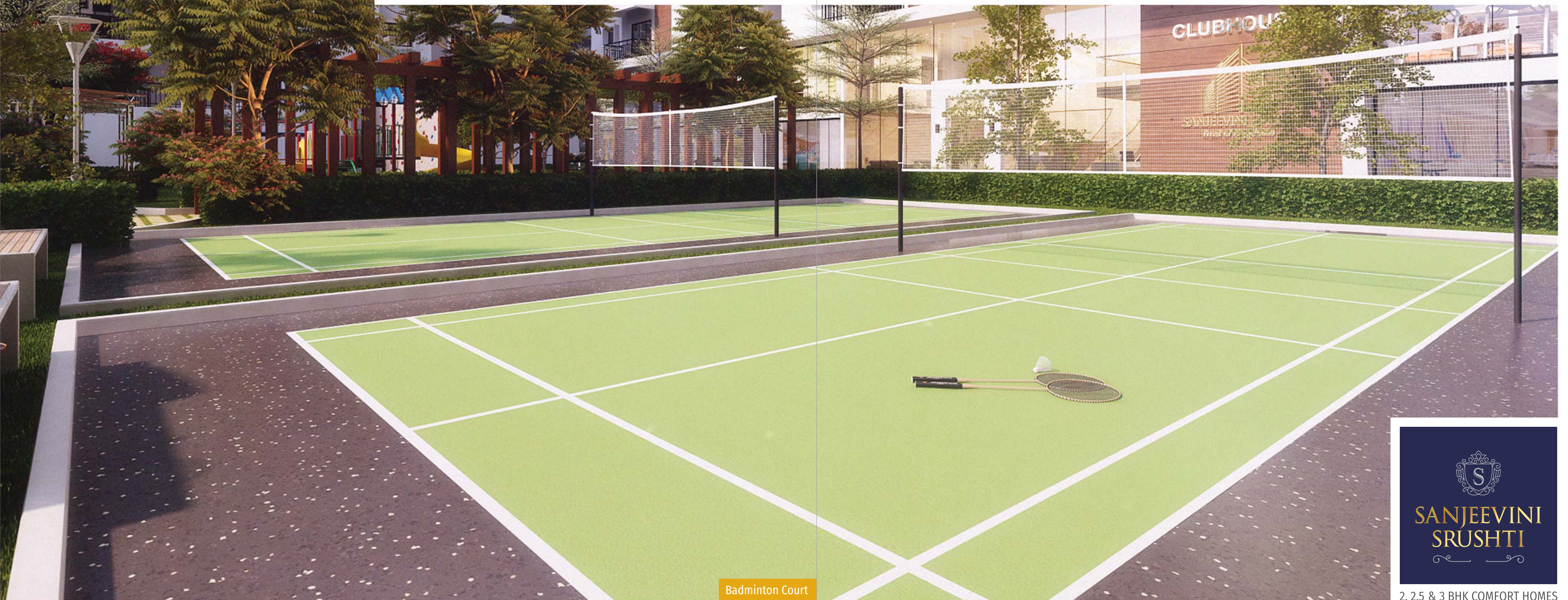

Badminton Court



**SANJEEVINI  
SRUSHTI**

2, 2.5 & 3 BHK COMFORT HOMES



**SANJEEVINI  
SRUSHTI**  
2, 2.5 & 3 BHK COMFORT HOMES

Step out of apartments that are ordinary...  
Step into living concepts that are extraordinary!

- Branded Materials
- Ontime Delivery
- Quality Construction
- Customer Satisfaction
- Exclusive Clubhouse
- Prime Location



2, 2.5 & 3 BHK COMFORT HOMES

## SPECIFICATIONS COMMON TO BUILDING COMPLEX

### Common Features:

- Lift:** Elevators of 6 passenger, 8 passenger and stretcher compatible passenger and service lift will be provided as per requirement. Make: Kone, Johnson/Equivalent.
- Backup:** 100% power backup for common amenities such as clubhouse, lifts, WSP, STP & selective common area lighting.
- Name board:** Apartment owner name will be provided in ground floor along with post box.
- Lift Fascia:** Granite cladding.
- Lobby:** Granite/Marble flooring/Vitrified tiles.
- Corridor:** Rocker finishing vitrified tiles standard make.
- Staircase floor:** Bull Nosing steptiles (Rubber Mould) standard make.
- Staircase handrail:** MS handrail with enamel paint in all floors.
- Terrace floor:** Roof cooling clay tiles/Equivalent tiles standard make.

### Outdoor Features:

- Water storage:** Centralised UG sump with WSP (min. requirement as per water test report).
- Rainwater harvesting:** Rainwater Harvesting Pit. (Rainwater catchment system)
- STP:** Centralised Sewage Treatment Plant standard make as per design.
- Intercom:** Intercom will be provided.
- Safety:**
  - CCTV surveillance cameras will be provided all around the building at pivotal locations in ground level.
  - Fire Fighting System.
- Walkway:** Walkway spaces well-defined as per landscape design intent.
- Security:** Provision for 24\*7 Integrated Security.
- Compound wall:** Site perimeter fenced by compound wall with entry gates for a height of 1800mm as per design intent.
- Landscape:** Suitable landscape at appropriate places in the project as per design intent.
- Driveway:** Convex mirror for safe turning in driveway in/out.
- Water Softner Plant:** Standard make as per design.

## SPECIFICATIONS

### FRAMED STRUCTURE

RCC framed structure with seismic compliance resistance, Anti-termite treatment will be done.

### WALLS

External wall with 6" Hydraulic pressure CC Solid concrete Blocks. Internal wall with 4" Hydraulic pressure CC Solid concrete Blocks.

### PLASTERING

**External Walls:** Two coats of Sponge Finish. Internal Walls: One coat of Smooth Finish.

### DOORS

**Main Door:** 32 mm thick flush door with both side Teak Veneer and one side metal T- patti with solid timber filler. **Internal Doors:** 32mm thick harmony design HDF skin door with tubular core filler Standard make.

### WINDOW

2.5 track UPVC Windows with mosquito Mesh Standard make.

### KITCHEN

Provide Black granite Kitchen Platform With Stainless Steel Sink (Standard Make), 2 Feet Height dado above the platform in Ceramic Glazed tiles (Standard Make), Reputed ISI CP Fittings.

### TOILET

Wall mounted commode with metropole flush valves regular & Wash basin white coloured in both toilet with Cera / Jaquar or equivalent make, Health faucet, Hot & Cold water Mixer (Diverter) and pillar cock, provision for geysers point in all toilets, all CP fittings are chrome plated of Cera /Jaquar or Equivalent Make.

### TOILET CEILING

Grid type false ceiling.

### PLUMBING

All water supply lines of CPVC/PVC Ashirvad or Other Reputed ISI Make, Sewage line wall of reputed make, all plumbing lines shall be pressure tested.

### FLOORING

Living, Dining, Bedroom & kitchen with 800\*800 mm double charged vitrified tiles Cera/Exxaro/Equivalent make.

### BATHROOM

Glazed ceramic tile up to false ceiling height of size 300x450mm Cera/Exxaro /Equivalent Make & above false ceiling will be finished with a coat of primer.

### BALCONIES & UTILITIES

Anti Skid 300\*300mm Ceramic Tiles Cera/Exxaro/Equivalent Make.

### PAINTING

**Interior Surface :** Three Coat of wall putty & One coat Primer & two coats of weather proof cement paint Asian paints/Nerolac paints/Equivalent make. **Main Door :** Teak wood Polishing, Grills and other doors : Asian enamel paint / Equivalent Make.

### ELECTRICAL

Fire resistant concealed copper wiring of Finolex/Havells/Anchor or equivalent ISI make. Adequate power plug points for lights, fans and other plugs in bedroom, toilets & kitchen. Provision of power plug points for washing machine in utility. Water purifier, Chimney, Refrigerator, Microwave oven, Mixer /Grinder in kitchen. Elegant Modular switches of Legrand/Havells/Anchor or equivalent make.

### SPLIT AIR CONDITIONER POINT

Provision for power plug points in Living, Dining and Master bedroom only.

### INTERCOM POINT

Facility to all the units connecting with security.

### CABLE TV POINT

Provision for cable connection point in living room and master bedroom.

### DATA POINT

Point in Living Room.

### EXHAUST FAN POINT

Points will be given in all bathrooms and Kitchen.

### WATER SUPPLY

Water supply from borewell with underground/overhead storage.

### GENERATOR BACKUP

Stand by sound proof automatic generator backup of 600 W for 3 BHK & 2.5 BHK & 500 W for 2 BHK.

### CAR PARKING

One Covered Car Parking space for each flat.

### SECURITY

Round the clock security (24X7), every house will be connected to security office through intercom phone, CCTV Camera surveillance.

A world of happiness unreserved;  
It's what you've earned and you deserve!

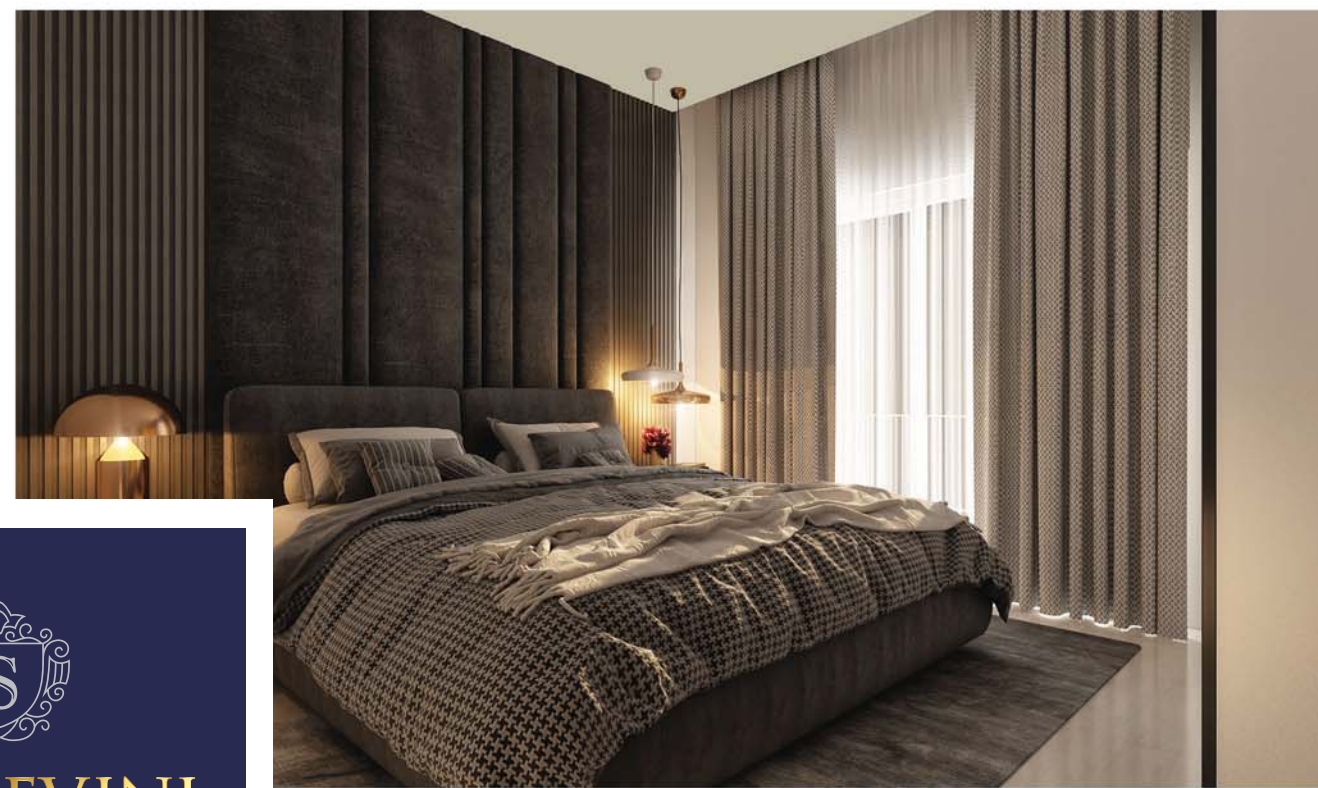
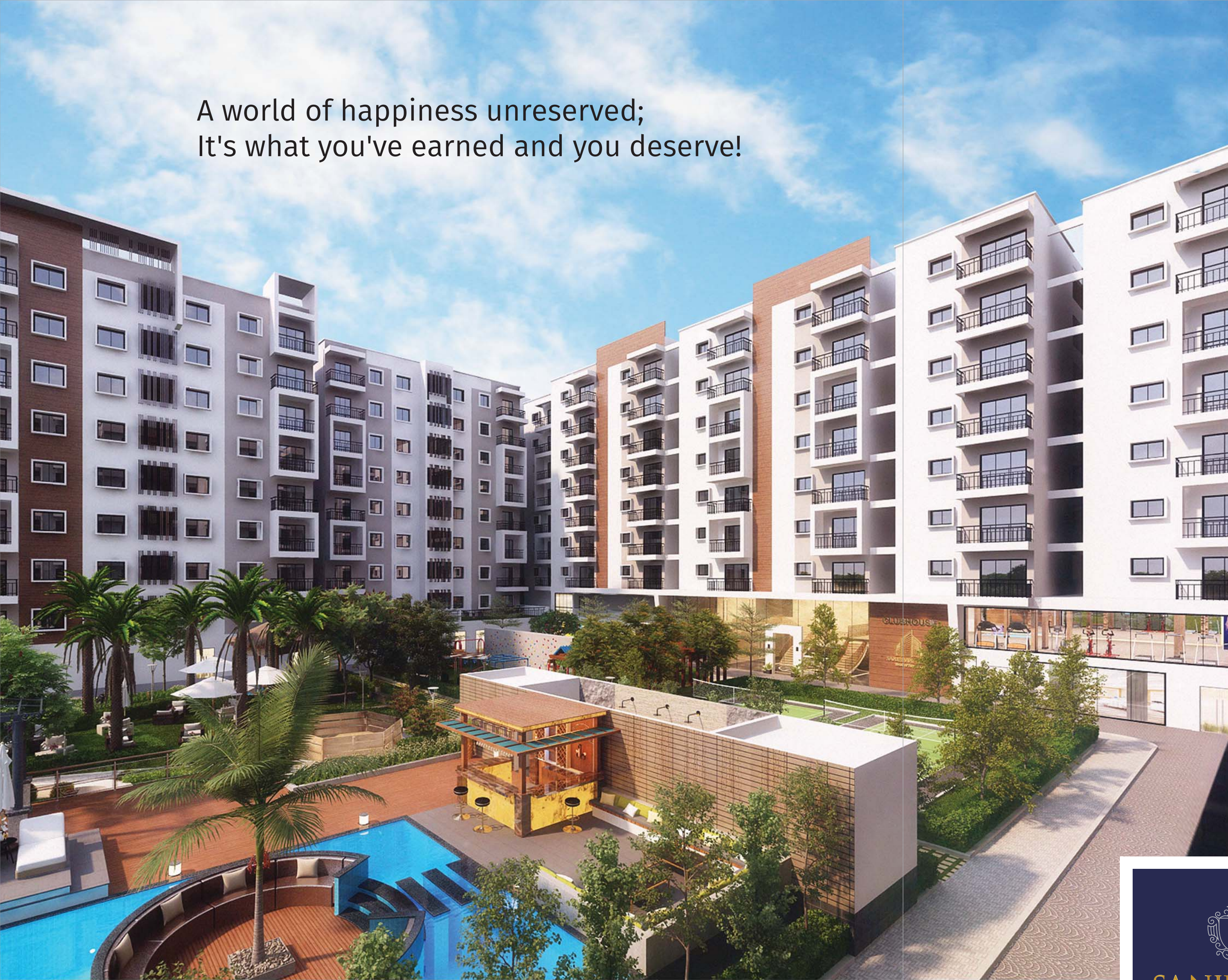

Take a look at the many floor plans on offer at Sanjeevini Srushti.  
You're sure to find one that perfectly suits your space and layout requirements.

2, 2.5 & 3 BHK COMFORT HOMES

# LOCATION MAP



## The Perfect Location

Besides the plethora of amenities available in the development, Sanjeevini Srushti is in close proximity to all the many social facilities that abound in its vicinity. From shopping malls, religious, recreation and educational institutions, to full-fledged medical facilities, you won't have to go far to find them all. Everything is just a short hop away from Sanjeevini Srushti.



### SCHOOLS

- Bangalore International Academy
- Rising International School
- Bloomers School
- DPS School
- Delhi Public School
- Shriram Global School
- Winmore Academy

### HOSPITALS

- Soukya Hospital
- RKB Sanjeevini Hospital
- Rudrappa Health Care and Diagnostics
- New Life Hospital
- Sri Satya Sai General Hospital
- Manipal Hospital

### COLLEGES

- MVJ College of Engineering
- Vidyavana PU & Degree College
- Samruddhi PU & Degree College

### SHOPPING MALLS

- Ascendas Park Square Mall
- The Forum Neighbourhood Mall
- Inorbit Mall
- Phoenix Market City
- VR Bengaluru Mall
- Forum Shantiniketan Mall

### IT PARKS

Around 6,00,000 employees work here

### CONNECTIVITY

- Whitefield Metro Station
- Whitefield Railway Station
- K.R. Puram Railway Station
- International Airport



2, 2.5 & 3 BHK COMFORT HOMES



Project by :



**SANJEEVINI GROUP**  
*Trust of Happiness*

Corporate Office :

**SANJEEVINI SRUSHTI INFRA**

No. 8, Narayanappa Garden, Whitefield, Bengaluru - 560066

Site Address :

**SANJEEVINI SRUSHTI**

Sy. no. 34/1, Kacharakanahalli, Soukhya Road, Near Whitefield,  
Hoskote Taluk, Bengaluru Rural District - 560 067.

SCAN QR



For Website

SCAN QR



For E-Brochure

SCAN QR



For Location

[www.sanjeevinigroups.com](http://www.sanjeevinigroups.com)

Architects

**FWD**  
architects

[www.fwdarchitects.com](http://www.fwdarchitects.com)

Structural Designers &  
MEP Consultants

**CRATIS**  
Designers Pvt. Ltd.

Marketing Partner

**DD** DESIGN LABS

Member

**BREDAI**  
Builders & Real Estate Developers Association of India  
Bangalore.

RERA : PRM/KA/RERA/1250/304/PR/150222/004712

Note : This Brochure is only conceptual presentation of project and not a legal offering. The promoters reserve the right to make changes in elevation, plans and specifications as deemed fit.