

आता साकार होणार... आपल्या स्वप्नातलं घर!

NEELKANTH

Vihar



Site : S. No. 00, H. No. 00, Sec-00, Vichumbe, New Panvel, Navi Mumbai.



**VICHUMBE** is heart of Panvel Taluka which comes under Raigad District. It is situated in the middle of the Panvel Taluka. As a growing and constantly progressing suburban residential hub of Navi Mumbai,

Vichumbe has been attracting many investors in Navi Mumbai real estate. The best reason to invest in Vichumbe is it's Natural Beauty. As it is also rapidly developing node, people are more and more attracted to invest here.



## LOCATIONAL FEATURES

- Pollution free natural environment
- Site surrounded with natural greenery
- Title clear land
- Earthquake resistant structural/RCC design
- Distance from Khandeshwar Rly. Stn. 2 Km
- Distance from Panvel station 2 Km
- Distance from Panvel St. stand 3 Km
- Bus services : NMMT  
(Khandeshwar Railway station to ADAI)
- International Airport 4 Km
- CKT, DAV, St. Joseph & RYAN International within 0.5 Km range.
- D Mart 1 Km
- Market Walking Distance
- Hospitals Walking Distance
- Banks Walking Distance
- Theaters 1 Km

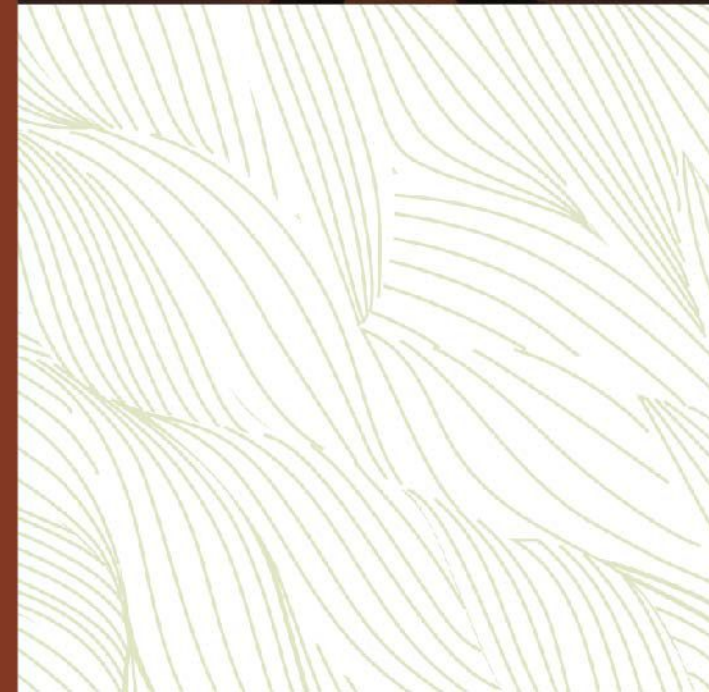

# Specifications

## FLOORING

- 2" X 2" Vitrified flooring in all rooms.

## DOORS

- The main & bedroom door with decorative laminate finish Pinewood flush doors
- Granite door frame for bedroom, toilet & Wooden door frames for main door
- Main door with good quality night latch & decorative handle.

## KITCHEN

- Granite kitchen platform with S.S. Sink
- Ceramic tiles above kitchen platform upto ceiling

## WINDOWS

- Anodized aluminum sliding windows with mosquito net shutter

## WATER TANK

- Underground & overhead tank with adequate storage capacity

## ELECTRIFICATION

- All electric points of concealed copper wiring with modular switches.
- Telephone & T.V (Cable) points in living room.

## WALLS

- Acrylic paint for the external face of the building.
- Plastic emulsion paint for the internal face of the apartments.

## BATHROOM & W.C.

- Concealed plumbing with good quality sanitary fittings.
- PVC plumbing fittings.
- Glazed tiles up to ceiling
- Ceramic tiles flooring in bath & w.c
- Good quality aluminum louvers in bath & w.c

## TERRACE

- Special water proofing treatment.



Bird's Eye View





आता साकार होणार...आपल्या स्वप्नातलं घर!



Front View

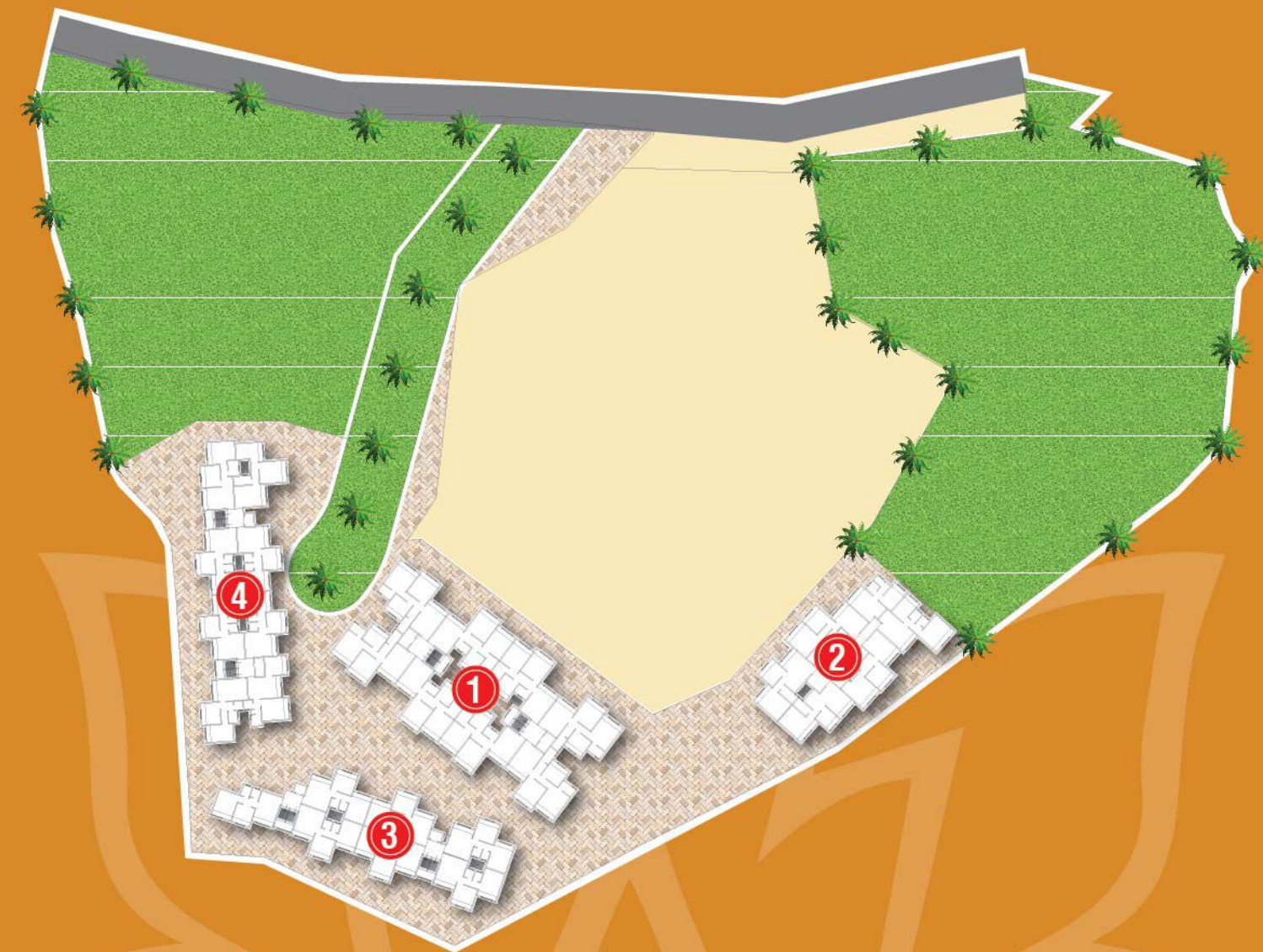

KEY LAYOUT

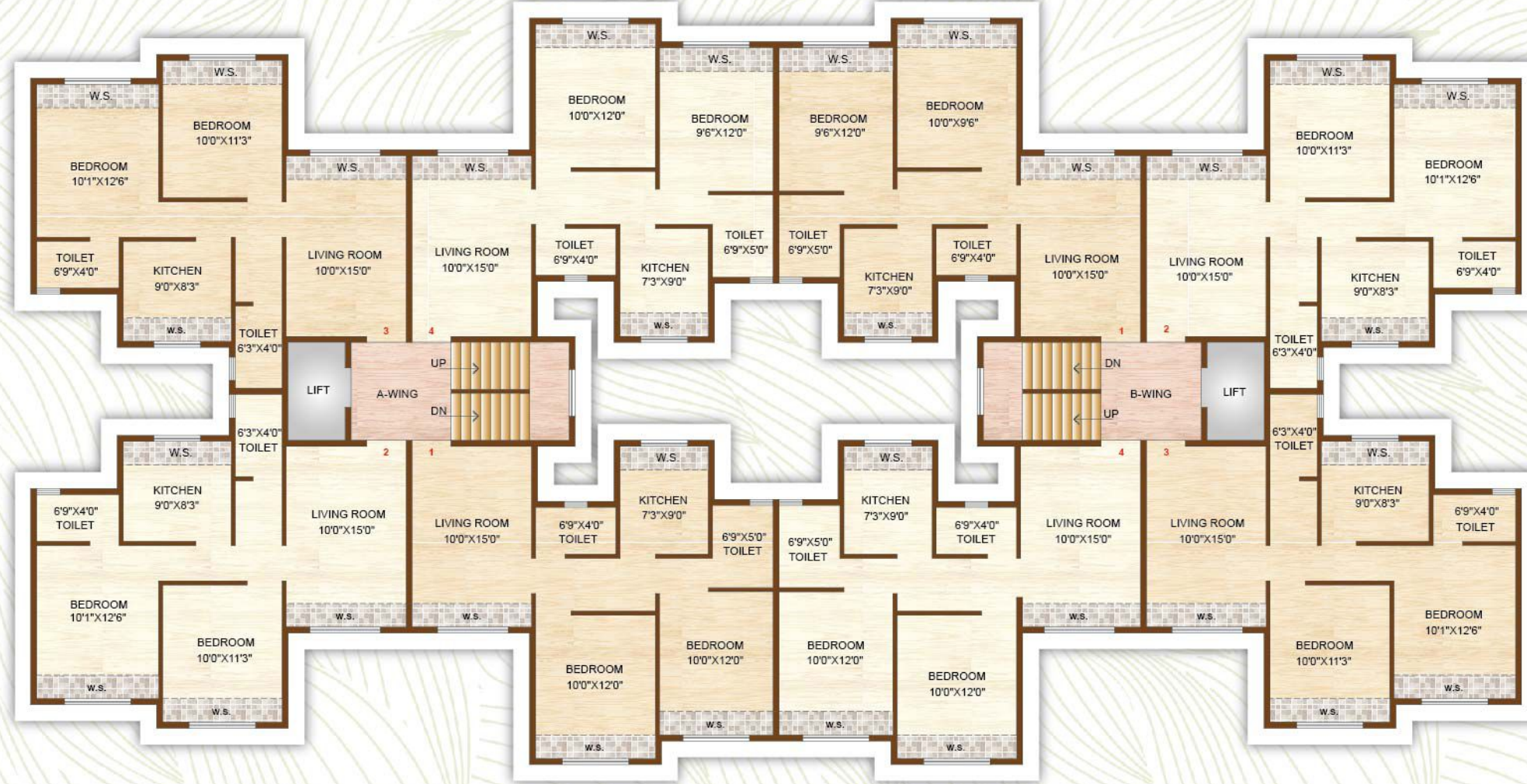

**BLDG. NO. 1**

1st to 3rd Typical Floor Plan



**BLDG. NO. 2**

1st to 3rd Typical Floor Plan





**BLDG. NO. 3**

1st to 3rd Typical Floor Plan



**BLDG. NO. 4**

1st to 3rd Typical Floor Plan

# NEELKANTH Vihar

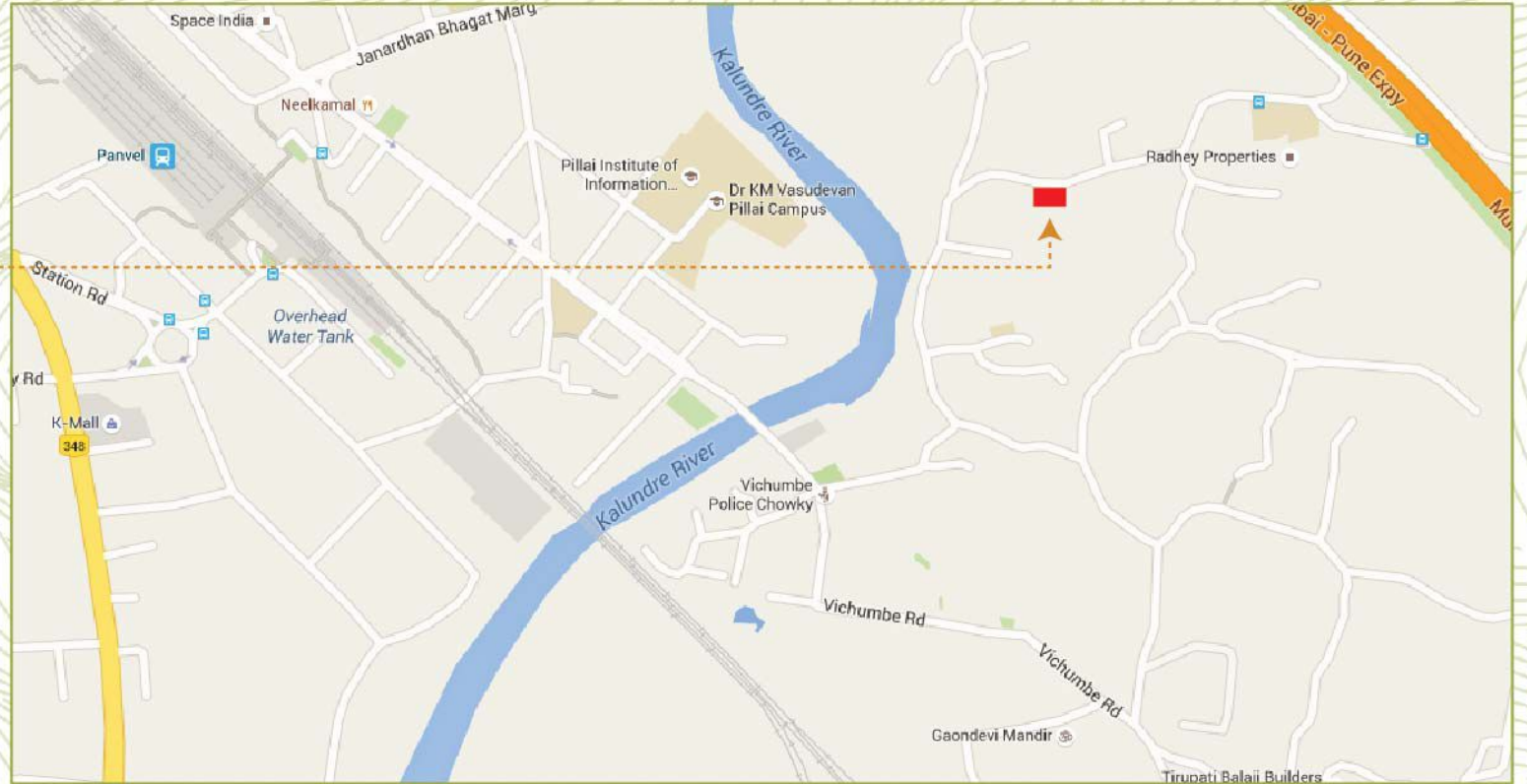

SHEMOIL - 8655001178 / 65297766

## ONGOING PROJECTS

**NEELKANTH KRUPA | NEELKANTH PRAJAKT | NEELKANTH SANSKRUTI | NEELKANTH VANDAN**

## COMPLETED PROJECTS

**NEELKANTH VISHWA | NEELKANTH LANDMARK**

PROJECT BY :



## NEELKANTH CONSTRUCTIONS

**Office :** Neelkanth Landmark, Office No. 706 to 710,  
7th Floor, Plot No. 365/1/2, Mumbai-Pune Highway,  
Near New Panvel Bridge, Panvel - 410 206.

**Architect :** Atul Patel & Associates  
**RCC Consultant :** S.R. Rao

**Contact for Booking :**  
**022-32657172 / 9820675287 / 9930499909**