





**Pashmina** - the famous Kashmiri wool known for its quality and class signifies the moving spirit behind Pashmina Developers. We conceive, build and deliver residential, commercial and retail real estate properties with a signature touch. Every apartment, row house, villa, commercial and retail property of Pashmina carries that signature touch by combining unique design aesthetics with state-of-the-art construction techniques.

Founded in 2007 Pashmina Developers was promoted by Mr. Asit Koticha & spearheaded by highly experienced industry professionals; Mr. Rajesh Turakhia (Director) and Dr. Rajendra Singh (Director). Bangalore is headed by Mr. Haresh Kumar (CEO) who has around 36 years of Experience in real estate from concept to commissioning.

At Pashmina, we strongly advocate that the quality of our organization is a reflection of its management. Today Pashmina Developers has a dedicated and experienced senior team having average industry experience of about 20 years each in their respective specialities, led by the visionaries who are designing the group's growth. It is the culmination of their passion and knowledge that has led to the phenomenal growth and expansion of Pashmina Developers. The three aspects that truly represent Pashmina and the Management's principles are -

#### **Vision**

To delight all stake holders with creativity, compassion, integrity and a quality conscience- consistently.

#### **Mission**

- Deliver exclusive lifestyle solutions exceeding expectations.
- Deliver value with integrity and transparency.
- Achieve work life balance in a challenging and rewarding environment.
- Remain a valued partner to all stake holders.

#### **Values**

- Integrity.
- Passion to excel.
- Social responsibility.





**ARIAL  
VIEW**





 pashmina  
**BROOKWOODS**

**LOCATION MAP**  
 Map not to scale

Byappanahalli  
 Metro Terminal  
 NH 4  
 KR Puram  
 Railway Station

KR Puram Cable bridge

8 Lane Expressway

Pashmina Waterfront

NH 4

Yellamma Lake

CIPLA

Bearys  
 Research  
 Center

Safal Market

Sai Baba Ashram

Hope Farm  
 Junction

ITPL

Whitefield Main Road

Grindwell  
 Norton

Siemens

Budhigere  
 cross

Hoskote

NH 4

To Chennai

To International Airport

New Baldwin  
 International School



# MASTER PLAN



TOTAL LAND AREA : 10.08 ACRES  
TOTAL NO. OF BLOCKS : 3  
APARTMENT TYPES : STUDIO  
1 BHK  
2 BHK  
3 BHK

## FEATURES & AMENITIES:

Main Entry Court with Special Paving  
Seating Alcove  
Viewing Deck  
Canal Walk  
Children's Play Area  
Party Lawn  
Reflexology Path  
Trellis  
Tea Deck  
Meditation Lawn  
Water Feature Plaza  
Play Lawn  
Basket Ball Court - half court  
Jogging Track



# BLOCK-1

# WING 'B'



# BLOCK-2

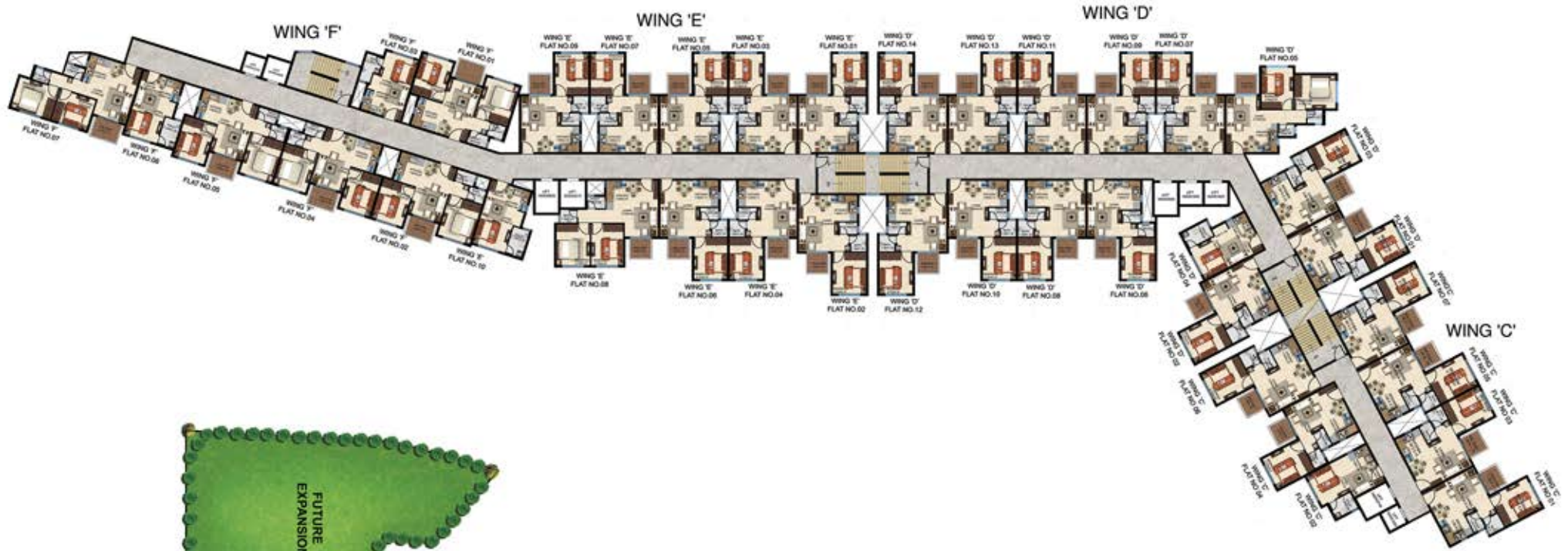



# BLOCK-3

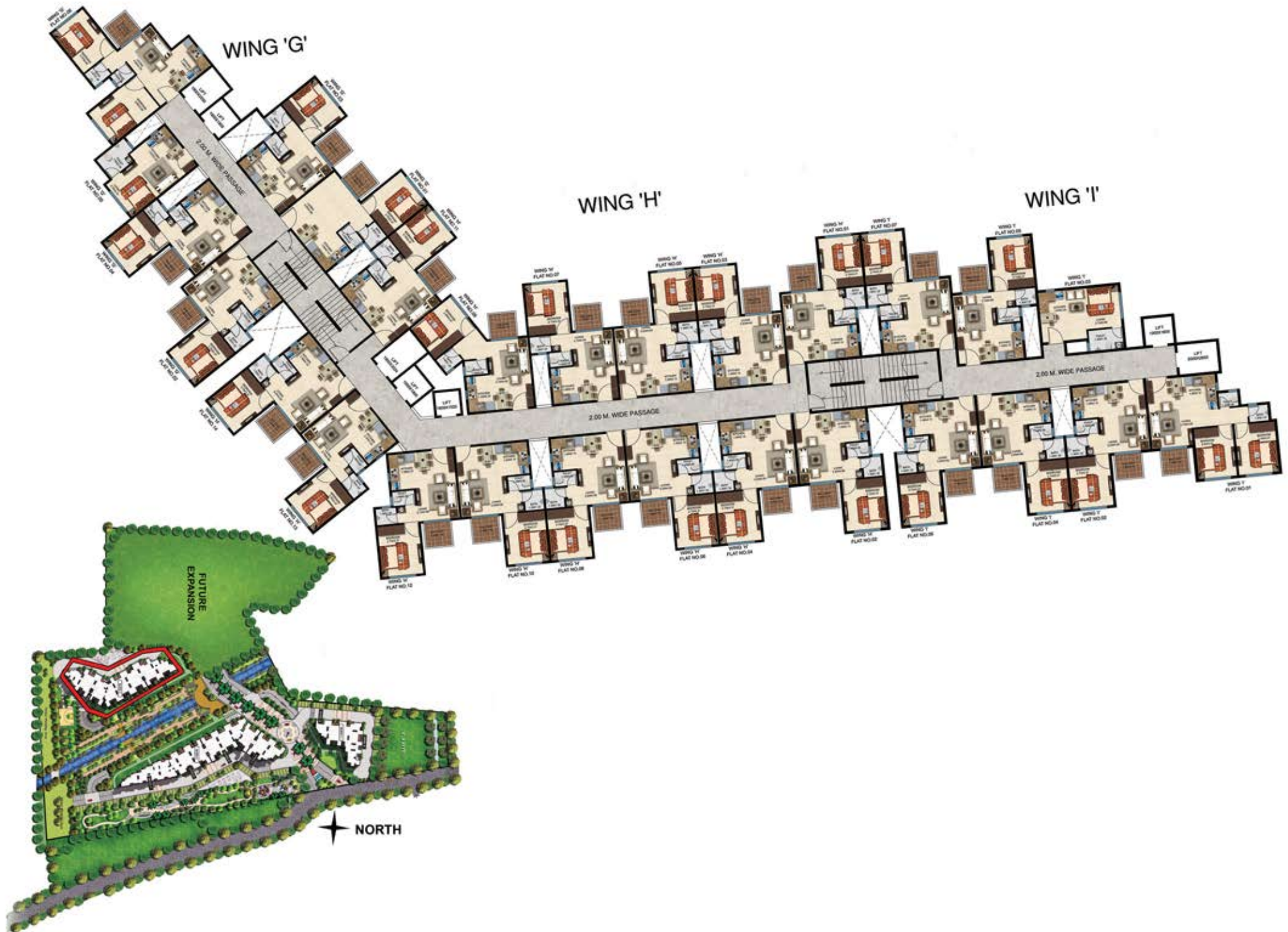



# STUDIO APARTMENT



BLOCK - 2 & 3	sq ft	sq mts
Saleable Area	315	29.26
RERA Carpet Area	212.48	19.74
Saleable Area	311	28.87
RERA Carpet Area	213.66	19.85

Interiors shown in the images will not be provided.

# 1 BHK



BLOCK - 1,2 & 3	sq ft	sq mts
Saleable Area	525	48.77
RERA Carpet Area	328.40	30.5
Saleable Area	542	50.35
RERA Carpet Area	342.51	31.82

Interiors shown in the images will not be provided.



# 1 BHK



BLOCK - 1,2 & 3	sq ft	sq mts
Saleable Area	550	51.09
RERA Carpet Area	348.75	32.34
Saleable Area	542	50.35
RERA Carpet Area	342.51	31.82

Interiors shown in the images will not be provided.

# 2 BHK



BLOCK - 1,2 & 3	sq ft	sq mts
Saleable Area	713	66.23
RERA Carpet Area	460.16	42.75
Flat no.1-A Wing, 1st Floor-14th Floor (Typical Plan)		

Interiors shown in the images will not be provided.



## 2 BHK



BLOCK - 1,2 & 3	sq ft	sq mts
Saleable Area	667	61.9
RERA Carpet Area	446.38	41.47
1st Floor		
Saleable Area	683	63.45
RERA Carpet Area	446.38	41.47
Flat no.5 - A Wing		
2nd Floor-14th Floor (Typical Plan)		



Interiors shown in the images will not be provided.

# 2 BHK



BLOCK - 1,2 & 3	sq ft	sq mts
Saleable Area	692	64.28
RERA Carpet Area	448.85	41.07
Saleable Area	696	64.70
RERA Carpet Area	448.85	41.07
Flat no.5 - D Wing		
1st Floor-14th Floor (Typical Plan)		

Interiors shown in the images will not be provided.



# 2 BHK



BLOCK - 1, 2 & 3	sq ft	sq mts
Saleable Area	696.48	64.70
RERA Carpet Area	458.54	42.06
Saleable Area	692	64.29
RERA Carpet Area	458.54	42.06
Flat no.8 - E Wing		
1st Floor-14th Floor (Typical Plan)		

Interiors shown in the images will not be provided.



# 2 BHK



BLOCK - 1 , 2 & 3	sq ft	sq mts
Saleable Area	679	63.10
RERA Carpet Area	439.17	40.8
Flat no.5 - F Wing		
1st Floor-14th Floor (Typical Plan)		

Interiors shown in the images will not be provided.



# 2 BHK



BLOCK - 1,2 & 3	sq ft	sq mts
Saleable Area	690	64.05
RERA Carpet Area	441.96	41.05
Saleable Area	692	64.29
RERA Carpet Area	441.96	41.05
Flat no.7 - F Wing		
1st Floor-14th Floor (Typical Plan)		



Interiors shown in the images will not be provided.

# 2 BHK



BLOCK - 1 , 2 & 3	sq ft	sq mts
Saleable Area	672	62.47
RERA Carpet Area	431.31	40.1
Flat no.6 - G Wing		
2nd Floor-14th Floor (Typical Plan)		

Interiors shown in the images will not be provided.



# 2 BHK



BLOCK - 1 , 2 & 3	sq ft	sq mts
Saleable Area	699	64.93
RERA Carpet Area	460.80	42.8
Flat no.1 - I Wing		
1st Floor-14th Floor (Typical Plan)		

Interiors shown in the images will not be provided.

# MODEL APARTMENT

(Actual Shots)



These are actual images of model flat. The interiors shown in the model flat will not be provided.



# MODEL APARTMENT

(Actual Shots)



These are actual images of model flat. The interiors shown in the model flat will not be provided.

## Apartment Specifications

### Living /Dining/Bedroom

Floor	Vitrified Tiles
Walls	Oil Bound Distemper
Ceiling	Oil Bound Distemper

### Master Bedroom

Floor	Vitrified Tiles
Walls	Oil Bound Distemper
Ceiling	Oil Bound Distemper

### kitchen

Floor	Anti-skid ceramic tiles /Vitrified Tiles
Fitting/Fixtures	Standard quality chrome Fittings, SS Sink (Single Blow)
Counter	Granite

### Balcony

Floor	Anti - Skid Ceramic Tiles
	MS Hand rail

### Toilets

Floor	Anti - Skid Ceramic Tiles
Walls	Dado up to 5 feet
Sanitary	EWC with health faucet / Standard quality chrome fitting Washbasin with Mirror, False Ceiling

### Bathroom

Floor	Anti - Skid Ceramic Tiles
Walls	Dado up to 7 feet
Fitting/ Fixtures	Standard quality chrome fitting False Ceiling

### Doors

Entrance	Teak Wood frame with decorative Flush door shutter
Bedroom / Kitchen door	Sal Wood frame with painted flush door
Toilet Door	Flush Door painted from outside and laminated from inside

### Windows

Powder coated aluminium windows  
with mosquito nets

### Electrical

Anchor/ Equivalent



# We have partnered with the best to give you the best

Designed by  
**HAFEEZ CONTRACTOR**



Our Financial Partner



## SOCIAL INFRASTRUCTURE

### MNCS/BUSINESS PARKS

CIPLA  
RMZ Infinity  
SIEMENS  
ITPL  
Grindwell Norton Limited  
Salarpuria GR Tech Park  
Brigade Tech Park  
SAP  
RMZ Centinnial  
Schneider  
GE  
Bagmane Tech Park  
Manyata Tech Park  
Narasapura Industrial Area

### EDUCATION INSTITUTES

Garden City College  
Cambridge Institute of Technology  
BDA School  
vibgyor international school  
East Point College  
New Baldwin International School  
Ryan International School  
pnc cognito school

### HOSPITALS

East Point Hospital  
Sathya Sai Orthopaedic  
& Multispeciality Hospital  
Koshys Hospital  
Satya Sai Baba Hospital  
Vydehi Hospital  
Columbia Asia  
Manipal Hospital

### LEISURE & CONVENIENCE

Gopalan Mall  
Decathlon  
Phoenix Mall  
Inorbit Mall  
100 ft. Street  
Hypercity  
Upcoming Orion Mall



pashmina  
**BROOKWOODS**

**Bangalore Corporate Address:**

PASHMINA BUILDERS & DEVELOPERS PVT. LTD.  
2nd Floor, Doddamane #19/1,  
Vittal Mallya Road, Bangalore 560001

**Pashmina Brookwoods - Site Address**

Survey No. 22/1, 22/2, 22/3, 23/1 & 24.  
Kammasandra Village, Bidarahalli Hobli, Bangalore.  
Phone No. : 080 – 42636363  
Mob no. : 76 76 122 122  
Email: enquiries@pashminadevelopers.com



Website: [www.pashminadevelopers.com](http://www.pashminadevelopers.com)

